



Safety
Products

Tyco Safety Products
6600 Congress Avenue
Boca Raton, FL 33487

Tele: 561 912 6097
Fax: 561 912 6000

April 27, 2010

Ms. Nicole Elliott
Southtowns Sewage Treatment Plant
S-3690 Lakeshore Blvd.
Buffalo, New York 14219

**RE: Second Quarter 2010 Discharge Monitoring Report
Scott Technologies, Inc., Groundwater Remediation Site
NYSDEC Site 9-15-149
EC/BPDES Permit No. 08-02-E4045**

Dear Ms. Elliott:

Scott Technologies, Inc. is pleased to provide you with the enclosed Second Quarter 2010 Discharge Monitoring Report for the Scott Technologies, Inc., Groundwater Remediation Site located at AVOX Systems Inc., 25A Walter Winter Drive, Lancaster, New York. This report is submitted in partial fulfillment of Erie County/Buffalo Pollution Discharge Elimination System (EC/BPDES) Permit No. 08-02-E4045, effective April 1, 2008. Scott Technologies, Inc. commissioned AECOM, with an office located in Amherst, New York, to perform the required EC/BPDES quarterly sampling during the month of April 2010.

We certify under the penalty of law that this document and all attachments were prepared under our direction or supervision in accordance with a system designed to assure that qualified personnel properly gather and evaluate the information submitted. Based on our inquiry of the person or persons who manage the system or those directly responsible for gathering the information, the information submitted is, to the best of our knowledge and belief, true, accurate, and complete. We are aware that there are significant penalties for submitting false information, including the possibility of a fine and imprisonment for known violations. We will continue to monitor the influent and effluent of the active remediation system located at the Site on a quarterly basis. The next scheduled quarterly discharge monitoring report is due by August 31, 2010.

If you have any questions regarding this submission, please do not hesitate to contact me.

Very truly yours,
Scott Technologies, Inc.

John D. Perkins
Director EHS
Tyco Safety Products

\enclosures

cc: Mr. Jim Kruszka, Buffalo Sewer Authority
Ms. Linda Ross, NYSDEC Region 9 (e-copy will be sent via email by AECOM)
Ms. Tamara Girard, NYSDOH Western Region
Mr. William Saskowski, AVOX Systems Inc.
Mr. John Perkins, Tyco Safety Products (w/out enclosures)
Mr. Eric Frauen, de maximis/O&M, Inc.
Facility File, Lancaster, NY (c/o AECOM, Amherst, NY)

TABLE

**Scott Technologies, Inc. - Groundwater Remediation Site
Lancaster, New York**

EC/BPDES Permit No. 08-02-E4045

**Second Quarter 2010 Discharge Monitoring Report
Sample Date - April 7, 2010**

Parameter	Units	Discharge Limitations Daily Max	Calculated Daily Value	Within Limits?
pH (method 160.1)	SU	5 - 12	8.22	Y
Total Extractable Hydrocarbons (method 1664 SGT)	mg/L	100	< 5.0	Y
Total Suspended Solids (method 160.2)	mg/L	250	204.0	Y
<u>VOCs (ASP00 method 8260)</u>				
Methylene Chloride	lbs/day	0.12	< 0.00006	Y
1,1,1-Trichloroethane	lbs/day	0.09	< 0.00006	Y
Trichloroethylene	lbs/day	0.04	0.00011	Y
Total 1,2-DCE (cis-1,2-DCE and trans-1,2-DCE)	lbs/day	0.02	< 0.00005	Y
1,1-Dichloroethane	lbs/day	0.0025	< 0.00006	Y
Chloroethane	lbs/day	0.025	< 0.00006	Y
Toluene	lbs/day	0.004	< 0.00006	Y
Total Daily Flow (discharge meter reading)	gallons per day	14,000	1,477	Y

Notes:

- SU standard units
- mg/L milligrams per liter
- ug/L micrograms per liter
- lbs/day pounds per day
- J Indicates analyte result was reported as an estimated concentration.
- < (value) Indicates calculated concentration less than the reported value,
using effluent reporting limit as maximum possible concentration
- DPE system was not running during sample collection.

FIGURES

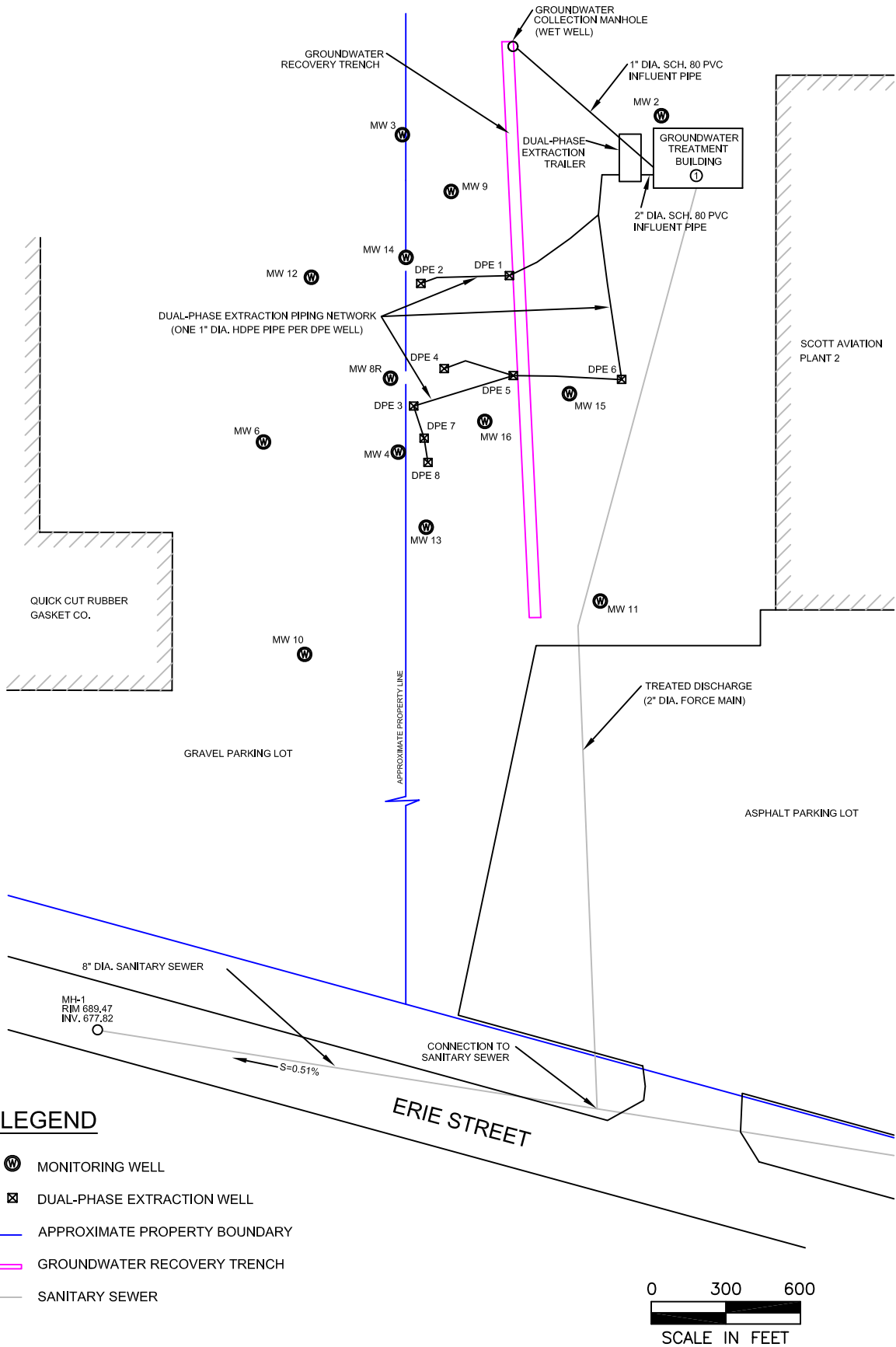

LEGEND

- MW 13 MONITORING WELL
- DPE 8 DUAL-PHASE EXTRACTION WELL
- APPROXIMATE PROPERTY BOUNDARY
- GROUNDWATER RECOVERY TRENCH
- SANITARY SEWER

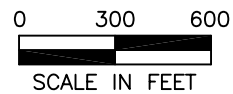

**FIGURE 1
DUAL PHASE EXTRACTION SYSTEM
LOCATION MAP**

FORMER SCOTT AVIATION FACILITY
LANCASTER, NEW YORK



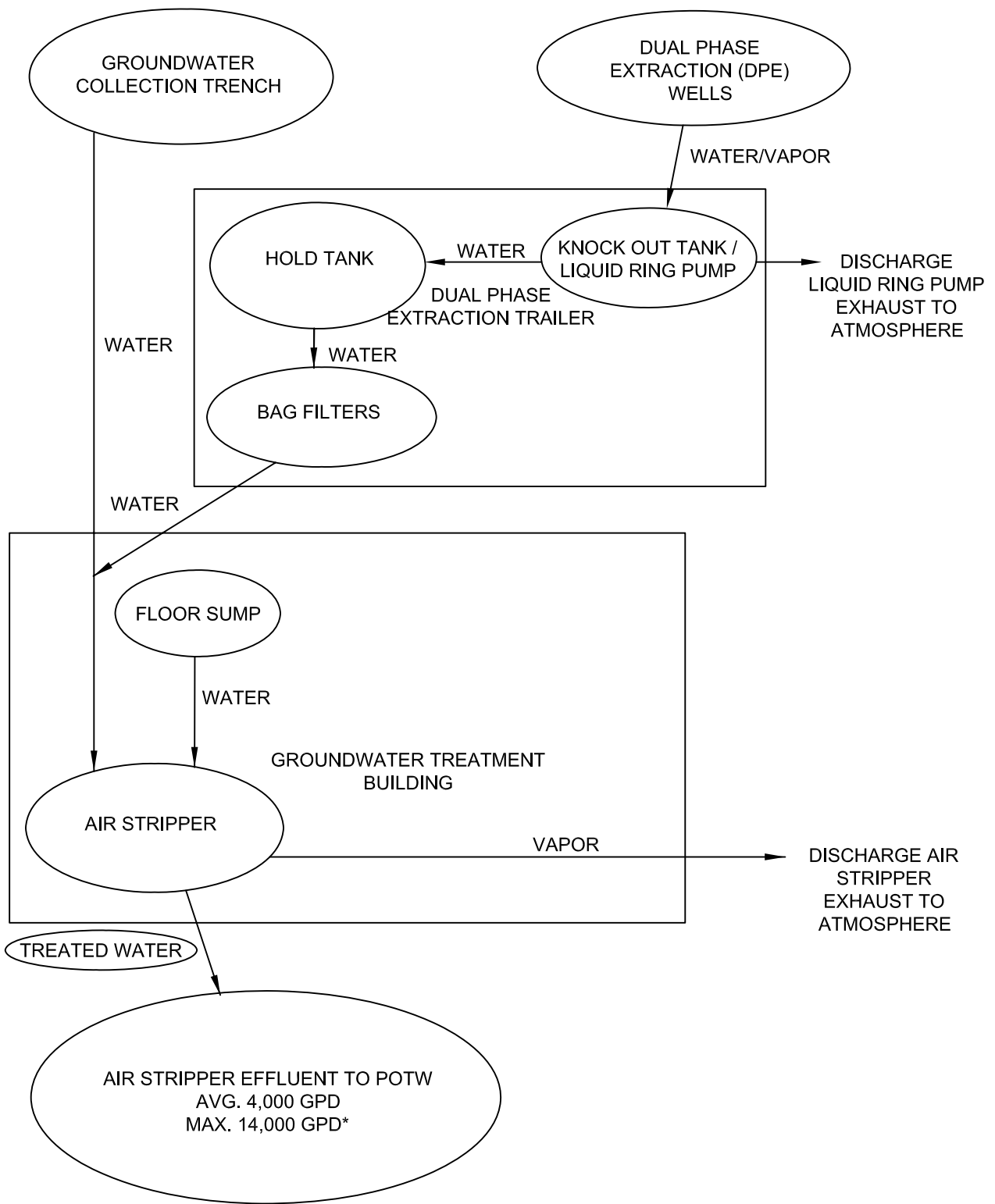

*PER DISCHARGE PERMIT NO. 08-02-E4045



FIGURE 2
COMBINED DUAL PHASE EXTRACTION
REMEDICATION SYSTEM FLOW DIAGRAM

FORMER SCOTT AVIATION FACILITY
LANCASTER, NEW YORK

DAILY FIELD LOG

DAILY FIELD LOG



Project Scott Technologies, Inc., Groundwater Remediation Site, Lancaster, NY
Date 7-Apr-10
Weather Cloudy with heavy rain
Temperature Range 60 deg F
AECOM Personnel on Site Dino Zack, Emily Laity
Time on Site 07:30 - 4:30

Air Stripper Totalizer Before Sampling 16063260 gallons (08:00 hrs)
Air Stripper Totalizer After Sampling 16064370 gallons (16:30 hrs)

Summary of Sample Activities

Time = 08:00hrs
 pH = 8.0
 Fill 2, 40-ml vials (preserved with HCl) from influent sample tap. Fill 1, 1-L clear glass bottle (preserved with H₂SO₄) 1/4 full, from influent tap. Fill 1, 500-ml plastic bottle (unpreserved) 1/4 full from influent tap. Fill 1 250-ml plastic bottle (unpreserved) 1/4 full from influent tap. Water quality is clear with slight odor (no sheen).
 Fill 2, 40-ml vials (preserved with HCl) from effluent sample tap. Fill 1, 1-L clear glass bottle (preserved with H₂SO₄) 1/4 full, respectively, from effluent tap. Fill 1, 500-ml plastic bottle (unpreserved) 1/4 full from effluent tap. Fill 1 250-ml plastic bottle (unpreserved) 1/4 full from effluent tap. Water quality is clear with no discernable odor or sheen.

Time = 10:30hrs
 pH = 8.0
 Fill 2, 40-ml vials (preserved with HCl) from influent sample tap. Fill 1, 1-L clear glass bottle (preserved with H₂SO₄) 1/4 full, from influent tap. Fill 1, 500-ml plastic bottle (unpreserved) 1/4 full from influent tap. Fill 1, 250-ml plastic bottle (unpreserved) 1/4 full from influent tap. Water quality is slightly turbid with slight odor (no sheen).
 Fill 2, 40-ml vials (preserved with HCl) from effluent sample tap. Fill 1, 1-L clear glass bottle (preserved with H₂SO₄) 1/4 full, respectively, from effluent tap. Fill 1, 500-ml plastic bottle (unpreserved) 1/4 full from effluent tap. Fill 1, 250-ml plastic bottle (unpreserved) 1/4 full from effluent tap. Water quality is slightly turbid with no discernable odor or sheen.

Time = 13:30hrs
 pH = 8.0
 Fill 2, 40-ml vials (preserved with HCl) from influent sample tap. Fill 1, 1-L clear glass bottle (preserved with H₂SO₄) 1/4 full, from influent tap. Fill 1, 500-ml plastic bottle (unpreserved) 1/4 full from influent tap. Fill 1, 250-ml plastic bottle (unpreserved) 1/4 full from influent tap. Water quality is slightly turbid with slight odor (no sheen).
 Fill 2, 40-ml vials (preserved with HCl) from effluent sample tap. Fill 1, 1-L clear glass bottle (preserved with H₂SO₄) 1/4 full, respectively, from effluent tap. Fill 1, 500-ml plastic bottle (unpreserved) 1/4 full from effluent tap. Fill 1, 250-ml plastic bottle (unpreserved) 1/4 full from effluent tap. Water quality is slightly turbid with no discernable odor or sheen.

Time = 16:30hrs
 pH = 8.0
 Fill 2, 40-ml vials (preserved with HCl) from influent sample tap. Fill 1, 1-L clear glass bottle (preserved with H₂SO₄) 1/4 full, from influent tap. Fill 1, 500-ml plastic bottle (unpreserved) 1/4 full from influent tap. Fill 1, 250-ml plastic bottle (unpreserved) 1/4 full from influent tap. Water quality is slightly turbid with slight odor (no sheen).
 Fill 2, 40-ml vials (preserved with HCl) from effluent sample tap. Fill 1, 1-L clear glass bottle (preserved with H₂SO₄) 1/4 full, respectively, from effluent tap. Fill 1, 500-ml plastic bottle (unpreserved) 1/4 full from effluent tap. Fill 1, 250-ml plastic bottle (unpreserved) 1/4 full from effluent tap. Water quality is slightly turbid with no discernable odor or sheen.

Comments

DPE system and GWCT running at time of sample collection (note sediment from DPE wells was being removed during sampling event - minor turbidity was observed in influent/effluent water).
 Air samples were collected at 12:00hrs from AS effluent and LRP effluent for TO-15 analysis.
 Maintain samples at 4 degrees C. Hand deliver samples to TestAmerica Laboratories, Inc. (Amherst, NY) under COC on 04/08/10 for analysis. Request laboratory to composite 40-ml samples and analyze for VOCs (8260; TCL and STARS). Request laboratory to analyze influent and effluent samples for TEH (1664), TSS (160.2), and pH.

Signature: 

Date: 7-Apr-10

LABORATORY REPORT

Analytical Report

Work Order: RTD0926

Project Description
Scott Aviation site - Influent/Effluent

For:

Dino Zack

AECOM - Amherst, NY
100 Corporate Pkwy-Univ Centre
Amherst, NY 14226



Brian Fischer

Project Manager

Brian.Fischer@testamericainc.com

Tuesday, April 20, 2010

The test results in this report meet all NELAP requirements for analytes for which accreditation is required or available. Any exception to NELAP requirements are noted in this report. Pursuant to NELAP, this report may not be reproduced, except in full, without the written approval of the laboratory. All questions regarding this test report should be directed to the TestAmerica Project manager who has signed this report.

TestAmerica Buffalo Current Certifications

As of 12/21/2009

STATE	Program	Cert # / Lab ID
Arkansas	CWA, RCRA, SOIL	88-0686
California*	NELAP CWA, RCRA	01169CA
Connecticut	SDWA, CWA, RCRA, SOIL	PH-0568
Florida*	NELAP CWA, RCRA	E87672
Georgia*	SDWA, NELAP CWA, RCRA	956
Illinois*	NELAP SDWA, CWA, RCRA	200003
Iowa	SW/CS	374
Kansas*	NELAP SDWA, CWA, RCRA	E-10187
Kentucky	SDWA	90029
Kentucky UST	UST	30
Louisiana*	NELAP CWA, RCRA	2031
Maine	SDWA, CWA	NY0044
Maryland	SDWA	294
Massachusetts	SDWA, CWA	M-NY044
Michigan	SDWA	9937
Minnesota	SDWA, CWA, RCRA	036-999-337
New Hampshire*	NELAP SDWA, CWA	233701
New Jersey*	NELAP, SDWA, CWA, RCRA,	NY455
New York*	NELAP, AIR, SDWA, CWA, RCRA, CLP	10026
Oklahoma	CWA, RCRA	9421
Pennsylvania*	NELAP CWA, RCRA	68-00281
Tennessee	SDWA	02970
Texas*	NELAP CWA, RCRA	T104704412-08-TX
USDA	FOREIGN SOIL PERMIT	S-41579
Virginia	SDWA	278
Washington*	NELAP CWA, RCRA	C1677
Wisconsin	CWA, RCRA	998310390
West Virginia	CWA, RCRA	252

*As required under the indicated accreditation, the test results in this report meet all NELAP requirements for parameters for which accreditation is required or available. Any exceptions to NELAP requirements are noted in this report.

AECOM - Amherst, NY
100 Corporate Pkwy-Univ Centre
Amherst, NY 14226

Work Order: RTD0926

Project: Scott Aviation site - Influent/Effluent
Project Number: EARTH

Received: 04/08/10
Reported: 04/20/10 10:49

CASE NARRATIVE

According to 40CFR Part 136.3, pH, Chlorine Residual, Dissolved Oxygen, Sulfite, and Temperature analyses are to be performed immediately after aqueous sample collection. When these parameters are not indicated as field (e.g. field-pH), they were not analyzed immediately, but as soon as possible after laboratory receipt.

A pertinent document is appended to this report, 1 page, is included and is an integral part of this report.

Reproduction of this analytical report is permitted only in its entirety. This report shall not be reproduced except in full without the written approval of the laboratory.

TestAmerica Laboratories, Inc. certifies that the analytical results contained herein apply only to the samples tested as received by our Laboratory.

AECOM - Amherst, NY
100 Corporate Pkwy-Univ Centre
Amherst, NY 14226

Work Order: RTD0926

Project: Scott Aviation site - Influent/Effluent
Project Number: EARTH

Received: 04/08/10
Reported: 04/20/10 10:49

DATA QUALIFIERS AND DEFINITIONS

CF6	Results confirmed by reanalysis.
D08	Dilution required due to high concentration of target analyte(s)
E	Concentration exceeds the calibration range and therefore result is semi-quantitative.
HFT	The holding time for this test is immediate. It was analyzed in the laboratory as soon as possible after receipt.
J	Analyte detected at a level less than the Reporting Limit (RL) and greater than or equal to the Method Detection Limit (MDL). Concentrations within this range are estimated.
P16	Lab to composite volatile samples by date/time/flow.
SL	Volatile sample was composited in the laboratory prior to analysis.
NR	Any inclusion of NR indicates that the project specific requirements do not require reporting estimated values below the laboratory reporting limit.

AECOM - Amherst, NY
100 Corporate Pkwy-Univ Centre
Amherst, NY 14226

Work Order: RTD0926

Project: Scott Aviation site - Influent/Effluent
Project Number: EARTH

Received: 04/08/10
Reported: 04/20/10 10:49

Executive Summary - Detections

Analyte	Sample Result	Data Qualifiers	RL	MDL	Units	Dil Fac	Date Analyzed	Lab Tech	Batch	Method
Sample ID: RTD0926-01 (EFFLUENT - Water)					Sampled: 04/07/10 08:00			Recvd: 04/08/10		
<u>Volatile Organic Compounds by EPA 8260B</u>										
2-Butanone	190	SL	25	1.3	ug/L	1.00	04/16/10 02:42	CDC	10D1431	8260B
Acetone	23	SL,J	25	3.0	ug/L	1.00	04/16/10 02:42	CDC	10D1431	8260B
cis-1,2-Dichloroethene	4.2	SL,J	5.0	0.81	ug/L	1.00	04/16/10 02:42	CDC	10D1431	8260B
Trichloroethene	8.6	SL	5.0	0.46	ug/L	1.00	04/16/10 02:42	CDC	10D1431	8260B
<u>General Chemistry Parameters</u>										
pH	8.22	HFT	NR	0.00	SU	1.00	04/09/10 00:15	JFR	10D0801	4500-H+ B
Total Suspended Solids	204	CF6	4.0	4.0	mg/L	1.00	04/12/10 16:40	MDM	10D1019	2540D
Sample ID: RTD0926-02 (INFLUENT - Water)					Sampled: 04/07/10 08:00			Recvd: 04/08/10		
<u>Volatile Organic Compounds by EPA 8260B</u>										
1,1-Dichloroethane	14	D08, SL,J	25	1.9	ug/L	5.00	04/15/10 12:29	LH	10D1339	8260B
2-Butanone	330	D08, SL	120	6.6	ug/L	5.00	04/15/10 12:29	LH	10D1339	8260B
Acetone	24	D08, SL,J	120	15	ug/L	5.00	04/15/10 12:29	LH	10D1339	8260B
Chloroethane	17	D08, SL,J	25	1.6	ug/L	5.00	04/15/10 12:29	LH	10D1339	8260B
cis-1,2-Dichloroethene	630	D08, SL,E	25	4.0	ug/L	5.00	04/15/10 12:29	LH	10D1339	8260B
Toluene	5.1	D08, SL,J	25	2.6	ug/L	5.00	04/15/10 12:29	LH	10D1339	8260B
Trichloroethene	340	D08, SL	25	2.3	ug/L	5.00	04/15/10 12:29	LH	10D1339	8260B
Vinyl chloride	77	D08, SL	25	4.5	ug/L	5.00	04/15/10 12:29	LH	10D1339	8260B
<u>General Chemistry Parameters</u>										
pH	7.80	HFT	NR	0.00	SU	1.00	04/09/10 00:15	JFR	10D0801	4500-H+ B
Total Suspended Solids	380	CF6	4.0	4.0	mg/L	1.00	04/12/10 16:40	MDM	10D1019	2540D
Sample ID: RTD0926-02RE1 (INFLUENT - Water)					Sampled: 04/07/10 08:00			Recvd: 04/08/10		
<u>Volatile Organic Compounds by EPA 8260B</u>										
1,1-Dichloroethane	15	D08, SL,J	50	3.8	ug/L	10.0	04/16/10 00:16	CDC	10D1431	8260B
2-Butanone	380	D08, SL	250	13	ug/L	10.0	04/16/10 00:16	CDC	10D1431	8260B
Acetone	36	D08, SL,J	250	30	ug/L	10.0	04/16/10 00:16	CDC	10D1431	8260B
Chloroethane	35	D08, SL,J	50	3.2	ug/L	10.0	04/16/10 00:16	CDC	10D1431	8260B
cis-1,2-Dichloroethene	630	D08, SL	50	8.1	ug/L	10.0	04/16/10 00:16	CDC	10D1431	8260B
Toluene	5.1	D08, SL,J	50	5.1	ug/L	10.0	04/16/10 00:16	CDC	10D1431	8260B
Trichloroethene	360	D08, SL	50	4.6	ug/L	10.0	04/16/10 00:16	CDC	10D1431	8260B
Vinyl chloride	74	D08, SL	50	9.0	ug/L	10.0	04/16/10 00:16	CDC	10D1431	8260B

AECOM - Amherst, NY
100 Corporate Pkwy-Univ Centre
Amherst, NY 14226

Work Order: RTD0926
Project: Scott Aviation site - Influent/Effluent
Project Number: EARTH

Received: 04/08/10
Reported: 04/20/10 10:49

Sample Summary

Sample Identification	Lab Number	Client Matrix	Date/Time Sampled	Date/Time Received	Sample Qualifiers
EFFLUENT	RTD0926-01	Water	04/07/10 08:00	04/08/10 08:00	P16
INFLUENT	RTD0926-02	Water	04/07/10 08:00	04/08/10 08:00	P16
TRIP BLANK	RTD0926-03	Water	04/07/10	04/08/10 08:00	

AECOM - Amherst, NY
100 Corporate Pkwy-Univ Centre
Amherst, NY 14226

Work Order: RTD0926

Received: 04/08/10
Reported: 04/20/10 10:49

Project: Scott Aviation site - Influent/Effluent
Project Number: EARTH

Analytical Report

Analyte	Sample Result	Data Qualifiers	RL	MDL	Units	Dil Fac	Date Analyzed	Lab Tech	Batch	Method
Sample ID: RTD0926-01 (EFFLUENT - Water)							Sampled: 04/07/10 08:00		Recvd: 04/08/10	
<u>Volatile Organic Compounds by EPA 8260B</u>										
1,1,1-Trichloroethane	ND	SL	5.0	0.82	ug/L	1.00	04/16/10 02:42	CDC	10D1431	8260B
1,1,2,2-Tetrachloroethane	ND	SL	5.0	0.21	ug/L	1.00	04/16/10 02:42	CDC	10D1431	8260B
1,1,2-Trichloroethane	ND	SL	5.0	0.23	ug/L	1.00	04/16/10 02:42	CDC	10D1431	8260B
1,1,2-Trichloro-1,2,2-trifluoroethane	ND	SL	5.0	0.31	ug/L	1.00	04/16/10 02:42	CDC	10D1431	8260B
1,1-Dichloroethane	ND	SL	5.0	0.38	ug/L	1.00	04/16/10 02:42	CDC	10D1431	8260B
1,1-Dichloroethene	ND	SL	5.0	0.29	ug/L	1.00	04/16/10 02:42	CDC	10D1431	8260B
1,2,4-Trichlorobenzene	ND	SL	5.0	0.41	ug/L	1.00	04/16/10 02:42	CDC	10D1431	8260B
1,2-Dibromo-3-chloropropane	ND	SL	5.0	0.39	ug/L	1.00	04/16/10 02:42	CDC	10D1431	8260B
1,2-Dibromoethane	ND	SL	5.0	0.73	ug/L	1.00	04/16/10 02:42	CDC	10D1431	8260B
1,2-Dichlorobenzene	ND	SL	5.0	0.79	ug/L	1.00	04/16/10 02:42	CDC	10D1431	8260B
1,2-Dichloroethane	ND	SL	5.0	0.21	ug/L	1.00	04/16/10 02:42	CDC	10D1431	8260B
1,2-Dichloropropane	ND	SL	5.0	0.72	ug/L	1.00	04/16/10 02:42	CDC	10D1431	8260B
1,3-Dichlorobenzene	ND	SL	5.0	0.78	ug/L	1.00	04/16/10 02:42	CDC	10D1431	8260B
1,4-Dichlorobenzene	ND	SL	5.0	0.84	ug/L	1.00	04/16/10 02:42	CDC	10D1431	8260B
2-Butanone	190	SL	25	1.3	ug/L	1.00	04/16/10 02:42	CDC	10D1431	8260B
2-Hexanone	ND	SL	25	1.2	ug/L	1.00	04/16/10 02:42	CDC	10D1431	8260B
4-Methyl-2-pentanone	ND	SL	25	2.1	ug/L	1.00	04/16/10 02:42	CDC	10D1431	8260B
Acetone	23	SL,J	25	3.0	ug/L	1.00	04/16/10 02:42	CDC	10D1431	8260B
Benzene	ND	SL	5.0	0.41	ug/L	1.00	04/16/10 02:42	CDC	10D1431	8260B
Bromodichloromethane	ND	SL	5.0	0.39	ug/L	1.00	04/16/10 02:42	CDC	10D1431	8260B
Bromoform	ND	SL	5.0	0.26	ug/L	1.00	04/16/10 02:42	CDC	10D1431	8260B
Bromomethane	ND	SL	5.0	0.69	ug/L	1.00	04/16/10 02:42	CDC	10D1431	8260B
Carbon disulfide	ND	SL	5.0	0.19	ug/L	1.00	04/16/10 02:42	CDC	10D1431	8260B
Carbon Tetrachloride	ND	SL	5.0	0.27	ug/L	1.00	04/16/10 02:42	CDC	10D1431	8260B
Chlorobenzene	ND	SL	5.0	0.75	ug/L	1.00	04/16/10 02:42	CDC	10D1431	8260B
Dibromochloromethane	ND	SL	5.0	0.32	ug/L	1.00	04/16/10 02:42	CDC	10D1431	8260B
Chloroethane	ND	SL	5.0	0.32	ug/L	1.00	04/16/10 02:42	CDC	10D1431	8260B
Chloroform	ND	SL	5.0	0.34	ug/L	1.00	04/16/10 02:42	CDC	10D1431	8260B
Chloromethane	ND	SL	5.0	0.35	ug/L	1.00	04/16/10 02:42	CDC	10D1431	8260B
cis-1,2-Dichloroethene	4.2	SL,J	5.0	0.81	ug/L	1.00	04/16/10 02:42	CDC	10D1431	8260B
cis-1,3-Dichloropropene	ND	SL	5.0	0.36	ug/L	1.00	04/16/10 02:42	CDC	10D1431	8260B
Cyclohexane	ND	SL	5.0	0.18	ug/L	1.00	04/16/10 02:42	CDC	10D1431	8260B
Dichlorodifluoromethane	ND	SL	5.0	0.68	ug/L	1.00	04/16/10 02:42	CDC	10D1431	8260B
Ethylbenzene	ND	SL	5.0	0.74	ug/L	1.00	04/16/10 02:42	CDC	10D1431	8260B
Isopropylbenzene	ND	SL	5.0	0.79	ug/L	1.00	04/16/10 02:42	CDC	10D1431	8260B
Methyl Acetate	ND	SL	5.0	0.50	ug/L	1.00	04/16/10 02:42	CDC	10D1431	8260B
Methyl-t-Butyl Ether (MTBE)	ND	SL	5.0	0.16	ug/L	1.00	04/16/10 02:42	CDC	10D1431	8260B
Methylcyclohexane	ND	SL	5.0	0.16	ug/L	1.00	04/16/10 02:42	CDC	10D1431	8260B
Methylene Chloride	ND	SL	5.0	0.44	ug/L	1.00	04/16/10 02:42	CDC	10D1431	8260B
Styrene	ND	SL	5.0	0.73	ug/L	1.00	04/16/10 02:42	CDC	10D1431	8260B
Tetrachloroethene	ND	SL	5.0	0.36	ug/L	1.00	04/16/10 02:42	CDC	10D1431	8260B
Toluene	ND	SL	5.0	0.51	ug/L	1.00	04/16/10 02:42	CDC	10D1431	8260B
trans-1,2-Dichloroethene	ND	SL	5.0	0.90	ug/L	1.00	04/16/10 02:42	CDC	10D1431	8260B
trans-1,3-Dichloropropene	ND	SL	5.0	0.37	ug/L	1.00	04/16/10 02:42	CDC	10D1431	8260B
Trichloroethene	8.6	SL	5.0	0.46	ug/L	1.00	04/16/10 02:42	CDC	10D1431	8260B
Trichlorofluoromethane	ND	SL	5.0	0.88	ug/L	1.00	04/16/10 02:42	CDC	10D1431	8260B
Vinyl chloride	ND	SL	5.0	0.90	ug/L	1.00	04/16/10 02:42	CDC	10D1431	8260B

AECOM - Amherst, NY
 100 Corporate Pkwy-Univ Centre
 Amherst, NY 14226

Work Order: RTD0926
 Project: Scott Aviation site - Influent/Effluent
 Project Number: EARTH

Received: 04/08/10
 Reported: 04/20/10 10:49

Analytical Report

Analyte	Sample Result	Data Qualifiers	RL	MDL	Units	Dil Fac	Date Analyzed	Lab Tech	Batch	Method
Sample ID: RTD0926-01 (EFFLUENT - Water) - cont.						Sampled: 04/07/10 08:00		Recvd: 04/08/10		
<u>Volatile Organic Compounds by EPA 8260B - cont.</u>										
Xylenes, total	ND	SL	15	0.66	ug/L	1.00	04/16/10 02:42	CDC	10D1431	8260B
1,2-Dichloroethane-d4	112 %	SL	<i>Surr Limits: (66-137%)</i>				04/16/10 02:42	CDC	10D1431	8260B
4-Bromofluorobenzene	109 %	SL	<i>Surr Limits: (73-120%)</i>				04/16/10 02:42	CDC	10D1431	8260B
Toluene-d8	116 %	SL	<i>Surr Limits: (71-126%)</i>				04/16/10 02:42	CDC	10D1431	8260B
<u>General Chemistry Parameters</u>										
SGT Total Petroleum Hydrocarbons	ND		5.1	2.0	mg/L	1.00	04/10/10 10:00	JME	10D0847	1664 SGT
pH	8.22	HFT	NA	0.00	SU	1.00	04/09/10 00:15	JFR	10D0801	4500-H+ B
Total Suspended Solids	204	CF6	4.0	4.0	mg/L	1.00	04/12/10 16:40	MDM	10D1019	2540D

AECOM - Amherst, NY
100 Corporate Pkwy- Univ Centre
Amherst, NY 14226

Work Order: RTD0926

Received: 04/08/10
Reported: 04/20/10 10:49

Project: Scott Aviation site - Influent/Effluent
Project Number: EARTH

Analytical Report

Analyte	Sample Result	Data Qualifiers	RL	MDL	Units	Dil Fac	Date Analyzed	Lab Tech	Batch	Method
Sample ID: RTD0926-02 (INFLUENT - Water)							Sampled: 04/07/10 08:00		Recvd: 04/08/10	
<u>Volatile Organic Compounds by EPA 8260B</u>										
1,1,1-Trichloroethane	ND	D08, SL	25	4.1	ug/L	5.00	04/15/10 12:29	LH	10D1339	8260B
1,1,2,2-Tetrachloroethane	ND	D08, SL	25	1.1	ug/L	5.00	04/15/10 12:29	LH	10D1339	8260B
1,1,2-Trichloroethane	ND	D08, SL	25	1.2	ug/L	5.00	04/15/10 12:29	LH	10D1339	8260B
1,1,2-Trichloro-1,2,2-trifluoroethane	ND	D08, SL	25	1.5	ug/L	5.00	04/15/10 12:29	LH	10D1339	8260B
1,1-Dichloroethane	14	D08, SL,J	25	1.9	ug/L	5.00	04/15/10 12:29	LH	10D1339	8260B
1,1-Dichloroethene	ND	D08, SL	25	1.5	ug/L	5.00	04/15/10 12:29	LH	10D1339	8260B
1,2,4-Trichlorobenzene	ND	D08, SL	25	2.0	ug/L	5.00	04/15/10 12:29	LH	10D1339	8260B
1,2-Dibromo-3-chloropropane	ND	D08, SL	25	2.0	ug/L	5.00	04/15/10 12:29	LH	10D1339	8260B
1,2-Dibromoethane	ND	D08, SL	25	3.6	ug/L	5.00	04/15/10 12:29	LH	10D1339	8260B
1,2-Dichlorobenzene	ND	D08, SL	25	4.0	ug/L	5.00	04/15/10 12:29	LH	10D1339	8260B
1,2-Dichloroethane	ND	D08, SL	25	1.1	ug/L	5.00	04/15/10 12:29	LH	10D1339	8260B
1,2-Dichloropropane	ND	D08, SL	25	3.6	ug/L	5.00	04/15/10 12:29	LH	10D1339	8260B
1,3-Dichlorobenzene	ND	D08, SL	25	3.9	ug/L	5.00	04/15/10 12:29	LH	10D1339	8260B
1,4-Dichlorobenzene	ND	D08, SL	25	4.2	ug/L	5.00	04/15/10 12:29	LH	10D1339	8260B
2-Butanone	330	D08, SL	120	6.6	ug/L	5.00	04/15/10 12:29	LH	10D1339	8260B
2-Hexanone	ND	D08, SL	120	6.2	ug/L	5.00	04/15/10 12:29	LH	10D1339	8260B
4-Methyl-2-pentanone	ND	D08, SL	120	10	ug/L	5.00	04/15/10 12:29	LH	10D1339	8260B
Acetone	24	D08, SL,J	120	15	ug/L	5.00	04/15/10 12:29	LH	10D1339	8260B
Benzene	ND	D08, SL	25	2.0	ug/L	5.00	04/15/10 12:29	LH	10D1339	8260B
Bromodichloromethane	ND	D08, SL	25	1.9	ug/L	5.00	04/15/10 12:29	LH	10D1339	8260B
Bromoform	ND	D08, SL	25	1.3	ug/L	5.00	04/15/10 12:29	LH	10D1339	8260B
Bromomethane	ND	D08, SL	25	3.4	ug/L	5.00	04/15/10 12:29	LH	10D1339	8260B
Carbon disulfide	ND	D08, SL	25	0.97	ug/L	5.00	04/15/10 12:29	LH	10D1339	8260B
Carbon Tetrachloride	ND	D08, SL	25	1.3	ug/L	5.00	04/15/10 12:29	LH	10D1339	8260B
Chlorobenzene	ND	D08, SL	25	3.8	ug/L	5.00	04/15/10 12:29	LH	10D1339	8260B
Dibromochloromethane	ND	D08, SL	25	1.6	ug/L	5.00	04/15/10 12:29	LH	10D1339	8260B
Chloroethane	17	D08, SL,J	25	1.6	ug/L	5.00	04/15/10 12:29	LH	10D1339	8260B
Chloroform	ND	D08, SL	25	1.7	ug/L	5.00	04/15/10 12:29	LH	10D1339	8260B
Chloromethane	ND	D08, SL	25	1.7	ug/L	5.00	04/15/10 12:29	LH	10D1339	8260B
cis-1,2-Dichloroethene	630	D08, SL,E	25	4.0	ug/L	5.00	04/15/10 12:29	LH	10D1339	8260B
cis-1,3-Dichloropropene	ND	D08, SL	25	1.8	ug/L	5.00	04/15/10 12:29	LH	10D1339	8260B
Cyclohexane	ND	D08, SL	25	0.90	ug/L	5.00	04/15/10 12:29	LH	10D1339	8260B
Dichlorodifluoromethane	ND	D08, SL	25	3.4	ug/L	5.00	04/15/10 12:29	LH	10D1339	8260B
Ethylbenzene	ND	D08, SL	25	3.7	ug/L	5.00	04/15/10 12:29	LH	10D1339	8260B
Isopropylbenzene	ND	D08, SL	25	4.0	ug/L	5.00	04/15/10 12:29	LH	10D1339	8260B
Methyl Acetate	ND	D08, SL	25	2.5	ug/L	5.00	04/15/10 12:29	LH	10D1339	8260B
Methyl-t-Butyl Ether (MTBE)	ND	D08, SL	25	0.80	ug/L	5.00	04/15/10 12:29	LH	10D1339	8260B
Methylcyclohexane	ND	D08, SL	25	0.80	ug/L	5.00	04/15/10 12:29	LH	10D1339	8260B
Methylene Chloride	ND	D08, SL	25	2.2	ug/L	5.00	04/15/10 12:29	LH	10D1339	8260B
Styrene	ND	D08, SL	25	3.6	ug/L	5.00	04/15/10 12:29	LH	10D1339	8260B
Tetrachloroethene	ND	D08, SL	25	1.8	ug/L	5.00	04/15/10 12:29	LH	10D1339	8260B
Toluene	5.1	D08, SL,J	25	2.6	ug/L	5.00	04/15/10 12:29	LH	10D1339	8260B
trans-1,2-Dichloroethene	ND	D08, SL	25	4.5	ug/L	5.00	04/15/10 12:29	LH	10D1339	8260B
trans-1,3-Dichloropropene	ND	D08, SL	25	1.8	ug/L	5.00	04/15/10 12:29	LH	10D1339	8260B
Trichloroethene	340	D08, SL	25	2.3	ug/L	5.00	04/15/10 12:29	LH	10D1339	8260B
Trichlorofluoromethane	ND	D08, SL	25	4.4	ug/L	5.00	04/15/10 12:29	LH	10D1339	8260B
Vinyl chloride	77	D08, SL	25	4.5	ug/L	5.00	04/15/10 12:29	LH	10D1339	8260B

AECOM - Amherst, NY
100 Corporate Pkwy-Univ Centre
Amherst, NY 14226

Work Order: RTD0926
Project: Scott Aviation site - Influent/Effluent
Project Number: EARTH

Received: 04/08/10
Reported: 04/20/10 10:49

Analytical Report

Analyte	Sample Result	Data Qualifiers	RL	MDL	Units	Dil Fac	Date Analyzed	Lab Tech	Batch	Method
Sample ID: RTD0926-02 (INFLUENT - Water) - cont.					Sampled: 04/07/10 08:00			Recvd: 04/08/10		
<u>Volatile Organic Compounds by EPA 8260B - cont.</u>										
Xylenes, total	ND	D08, SL	75	3.3	ug/L	5.00	04/15/10 12:29	LH	10D1339	8260B
1,2-Dichloroethane-d4	84 %	D08, SL	Surr Limits: (66-137%)				04/15/10 12:29	LH	10D1339	8260B
4-Bromofluorobenzene	79 %	D08, SL	Surr Limits: (73-120%)				04/15/10 12:29	LH	10D1339	8260B
Toluene-d8	85 %	D08, SL	Surr Limits: (71-126%)				04/15/10 12:29	LH	10D1339	8260B
<u>General Chemistry Parameters</u>										
SGT Total Petroleum Hydrocarbons	ND		5.0	1.9	mg/L	1.00	04/10/10 10:00	JME	10D0847	1664 SGT
pH	7.80	HFT	NA	0.00	SU	1.00	04/09/10 00:15	JFR	10D0801	4500-H+ B
Total Suspended Solids	380	CF6	4.0	4.0	mg/L	1.00	04/12/10 16:40	MDM	10D1019	2540D

AECOM - Amherst, NY
100 Corporate Pkwy-Univ Centre
Amherst, NY 14226

Work Order: RTD0926

Received: 04/08/10
Reported: 04/20/10 10:49

Project: Scott Aviation site - Influent/Effluent
Project Number: EARTH

Analytical Report

Analyte	Sample Result	Data Qualifiers	RL	MDL	Units	Dil Fac	Date Analyzed	Lab Tech	Batch	Method
Sample ID: RTD0926-02RE1 (INFLUENT - Water)						Sampled: 04/07/10 08:00		Recvd: 04/08/10		
<u>Volatile Organic Compounds by EPA 8260B</u>										
1,1,1-Trichloroethane	ND	D08, SL	50	8.2	ug/L	10.0	04/16/10 00:16	CDC	10D1431	8260B
1,1,2,2-Tetrachloroethane	ND	D08, SL	50	2.1	ug/L	10.0	04/16/10 00:16	CDC	10D1431	8260B
1,1,2-Trichloroethane	ND	D08, SL	50	2.3	ug/L	10.0	04/16/10 00:16	CDC	10D1431	8260B
1,1,2-Trichloro-1,2,2-trifluoroethane	ND	D08, SL	50	3.1	ug/L	10.0	04/16/10 00:16	CDC	10D1431	8260B
1,1-Dichloroethane	15	D08, SL,J	50	3.8	ug/L	10.0	04/16/10 00:16	CDC	10D1431	8260B
1,1-Dichloroethene	ND	D08, SL	50	2.9	ug/L	10.0	04/16/10 00:16	CDC	10D1431	8260B
1,2,4-Trichlorobenzene	ND	D08, SL	50	4.1	ug/L	10.0	04/16/10 00:16	CDC	10D1431	8260B
1,2-Dibromo-3-chloropropane	ND	D08, SL	50	3.9	ug/L	10.0	04/16/10 00:16	CDC	10D1431	8260B
1,2-Dibromoethane	ND	D08, SL	50	7.3	ug/L	10.0	04/16/10 00:16	CDC	10D1431	8260B
1,2-Dichlorobenzene	ND	D08, SL	50	7.9	ug/L	10.0	04/16/10 00:16	CDC	10D1431	8260B
1,2-Dichloroethane	ND	D08, SL	50	2.1	ug/L	10.0	04/16/10 00:16	CDC	10D1431	8260B
1,2-Dichloropropane	ND	D08, SL	50	7.2	ug/L	10.0	04/16/10 00:16	CDC	10D1431	8260B
1,3-Dichlorobenzene	ND	D08, SL	50	7.8	ug/L	10.0	04/16/10 00:16	CDC	10D1431	8260B
1,4-Dichlorobenzene	ND	D08, SL	50	8.4	ug/L	10.0	04/16/10 00:16	CDC	10D1431	8260B
2-Butanone	380	D08, SL	250	13	ug/L	10.0	04/16/10 00:16	CDC	10D1431	8260B
2-Hexanone	ND	D08, SL	250	12	ug/L	10.0	04/16/10 00:16	CDC	10D1431	8260B
4-Methyl-2-pentanone	ND	D08, SL	250	21	ug/L	10.0	04/16/10 00:16	CDC	10D1431	8260B
Acetone	36	D08, SL,J	250	30	ug/L	10.0	04/16/10 00:16	CDC	10D1431	8260B
Benzene	ND	D08, SL	50	4.1	ug/L	10.0	04/16/10 00:16	CDC	10D1431	8260B
Bromodichloromethane	ND	D08, SL	50	3.9	ug/L	10.0	04/16/10 00:16	CDC	10D1431	8260B
Bromoform	ND	D08, SL	50	2.6	ug/L	10.0	04/16/10 00:16	CDC	10D1431	8260B
Bromomethane	ND	D08, SL	50	6.9	ug/L	10.0	04/16/10 00:16	CDC	10D1431	8260B
Carbon disulfide	ND	D08, SL	50	1.9	ug/L	10.0	04/16/10 00:16	CDC	10D1431	8260B
Carbon Tetrachloride	ND	D08, SL	50	2.7	ug/L	10.0	04/16/10 00:16	CDC	10D1431	8260B
Chlorobenzene	ND	D08, SL	50	7.5	ug/L	10.0	04/16/10 00:16	CDC	10D1431	8260B
Dibromochloromethane	ND	D08, SL	50	3.2	ug/L	10.0	04/16/10 00:16	CDC	10D1431	8260B
Chloroethane	35	D08, SL,J	50	3.2	ug/L	10.0	04/16/10 00:16	CDC	10D1431	8260B
Chloroform	ND	D08, SL	50	3.4	ug/L	10.0	04/16/10 00:16	CDC	10D1431	8260B
Chloromethane	ND	D08, SL	50	3.5	ug/L	10.0	04/16/10 00:16	CDC	10D1431	8260B
cis-1,2-Dichloroethene	630	D08, SL	50	8.1	ug/L	10.0	04/16/10 00:16	CDC	10D1431	8260B
cis-1,3-Dichloropropene	ND	D08, SL	50	3.6	ug/L	10.0	04/16/10 00:16	CDC	10D1431	8260B
Cyclohexane	ND	D08, SL	50	1.8	ug/L	10.0	04/16/10 00:16	CDC	10D1431	8260B
Dichlorodifluoromethane	ND	D08, SL	50	6.8	ug/L	10.0	04/16/10 00:16	CDC	10D1431	8260B
Ethylbenzene	ND	D08, SL	50	7.4	ug/L	10.0	04/16/10 00:16	CDC	10D1431	8260B
Isopropylbenzene	ND	D08, SL	50	7.9	ug/L	10.0	04/16/10 00:16	CDC	10D1431	8260B
Methyl Acetate	ND	D08, SL	50	5.0	ug/L	10.0	04/16/10 00:16	CDC	10D1431	8260B
Methyl-t-Butyl Ether (MTBE)	ND	D08, SL	50	1.6	ug/L	10.0	04/16/10 00:16	CDC	10D1431	8260B
Methylcyclohexane	ND	D08, SL	50	1.6	ug/L	10.0	04/16/10 00:16	CDC	10D1431	8260B
Methylene Chloride	ND	D08, SL	50	4.4	ug/L	10.0	04/16/10 00:16	CDC	10D1431	8260B
Styrene	ND	D08, SL	50	7.3	ug/L	10.0	04/16/10 00:16	CDC	10D1431	8260B
Tetrachloroethene	ND	D08, SL	50	3.6	ug/L	10.0	04/16/10 00:16	CDC	10D1431	8260B
Toluene	5.1	D08, SL,J	50	5.1	ug/L	10.0	04/16/10 00:16	CDC	10D1431	8260B
trans-1,2-Dichloroethene	ND	D08, SL	50	9.0	ug/L	10.0	04/16/10 00:16	CDC	10D1431	8260B
trans-1,3-Dichloropropene	ND	D08, SL	50	3.7	ug/L	10.0	04/16/10 00:16	CDC	10D1431	8260B
Trichloroethene	360	D08, SL	50	4.6	ug/L	10.0	04/16/10 00:16	CDC	10D1431	8260B
Trichlorofluoromethane	ND	D08, SL	50	8.8	ug/L	10.0	04/16/10 00:16	CDC	10D1431	8260B
Vinyl chloride	74	D08, SL	50	9.0	ug/L	10.0	04/16/10 00:16	CDC	10D1431	8260B

AECOM - Amherst, NY
 100 Corporate Pkwy-Univ Centre
 Amherst, NY 14226

Work Order: RTD0926
 Project: Scott Aviation site - Influent/Effluent
 Project Number: EARTH

Received: 04/08/10
 Reported: 04/20/10 10:49

Analytical Report

Analyte	Sample Result	Data Qualifiers	RL	MDL	Units	Dil Fac	Date Analyzed	Lab Tech	Batch	Method
Sample ID: RTD0926-02RE1 (INFLUENT - Water) - cont.					Sampled: 04/07/10 08:00			Recvd: 04/08/10		
<u>Volatile Organic Compounds by EPA 8260B - cont.</u>										
Xylenes, total	ND	D08, SL	150	6.6	ug/L	10.0	04/16/10 00:16	CDC	10D1431	8260B
1,2-Dichloroethane-d4	113 %	D08, SL	Surr Limits: (66-137%)				04/16/10 00:16	CDC	10D1431	8260B
4-Bromofluorobenzene	108 %	D08, SL	Surr Limits: (73-120%)				04/16/10 00:16	CDC	10D1431	8260B
Toluene-d8	116 %	D08, SL	Surr Limits: (71-126%)				04/16/10 00:16	CDC	10D1431	8260B

AECOM - Amherst, NY
100 Corporate Pkwy-Univ Centre
Amherst, NY 14226

Work Order: RTD0926

Received: 04/08/10
Reported: 04/20/10 10:49

Project: Scott Aviation site - Influent/Effluent
Project Number: EARTH

Analytical Report

Analyte	Sample Result	Data Qualifiers	RL	MDL	Units	Dil Fac	Date Analyzed	Lab Tech	Batch	Method
Sample ID: RTD0926-03 (TRIP BLANK - Water)							Sampled: 04/07/10		Recvd: 04/08/10 08:00	
<u>Volatile Organic Compounds by EPA 8260B</u>										
1,1,1-Trichloroethane	ND		5.0	0.82	ug/L	1.00	04/15/10 12:54	LH	10D1339	8260B
1,1,2,2-Tetrachloroethane	ND		5.0	0.21	ug/L	1.00	04/15/10 12:54	LH	10D1339	8260B
1,1,2-Trichloroethane	ND		5.0	0.23	ug/L	1.00	04/15/10 12:54	LH	10D1339	8260B
1,1,2-Trichloro-1,2,2-trifluoroethane	ND		5.0	0.31	ug/L	1.00	04/15/10 12:54	LH	10D1339	8260B
1,1-Dichloroethane	ND		5.0	0.38	ug/L	1.00	04/15/10 12:54	LH	10D1339	8260B
1,1-Dichloroethene	ND		5.0	0.29	ug/L	1.00	04/15/10 12:54	LH	10D1339	8260B
1,2,4-Trichlorobenzene	ND		5.0	0.41	ug/L	1.00	04/15/10 12:54	LH	10D1339	8260B
1,2-Dibromo-3-chloropropane	ND		5.0	0.39	ug/L	1.00	04/15/10 12:54	LH	10D1339	8260B
1,2-Dibromoethane	ND		5.0	0.73	ug/L	1.00	04/15/10 12:54	LH	10D1339	8260B
1,2-Dichlorobenzene	ND		5.0	0.79	ug/L	1.00	04/15/10 12:54	LH	10D1339	8260B
1,2-Dichloroethane	ND		5.0	0.21	ug/L	1.00	04/15/10 12:54	LH	10D1339	8260B
1,2-Dichloropropane	ND		5.0	0.72	ug/L	1.00	04/15/10 12:54	LH	10D1339	8260B
1,3-Dichlorobenzene	ND		5.0	0.78	ug/L	1.00	04/15/10 12:54	LH	10D1339	8260B
1,4-Dichlorobenzene	ND		5.0	0.84	ug/L	1.00	04/15/10 12:54	LH	10D1339	8260B
2-Butanone	ND		25	1.3	ug/L	1.00	04/15/10 12:54	LH	10D1339	8260B
2-Hexanone	ND		25	1.2	ug/L	1.00	04/15/10 12:54	LH	10D1339	8260B
4-Methyl-2-pentanone	ND		25	2.1	ug/L	1.00	04/15/10 12:54	LH	10D1339	8260B
Acetone	ND		25	3.0	ug/L	1.00	04/15/10 12:54	LH	10D1339	8260B
Benzene	ND		5.0	0.41	ug/L	1.00	04/15/10 12:54	LH	10D1339	8260B
Bromodichloromethane	ND		5.0	0.39	ug/L	1.00	04/15/10 12:54	LH	10D1339	8260B
Bromoform	ND		5.0	0.26	ug/L	1.00	04/15/10 12:54	LH	10D1339	8260B
Bromomethane	ND		5.0	0.69	ug/L	1.00	04/15/10 12:54	LH	10D1339	8260B
Carbon disulfide	ND		5.0	0.19	ug/L	1.00	04/15/10 12:54	LH	10D1339	8260B
Carbon Tetrachloride	ND		5.0	0.27	ug/L	1.00	04/15/10 12:54	LH	10D1339	8260B
Chlorobenzene	ND		5.0	0.75	ug/L	1.00	04/15/10 12:54	LH	10D1339	8260B
Dibromochloromethane	ND		5.0	0.32	ug/L	1.00	04/15/10 12:54	LH	10D1339	8260B
Chloroethane	ND		5.0	0.32	ug/L	1.00	04/15/10 12:54	LH	10D1339	8260B
Chloroform	ND		5.0	0.34	ug/L	1.00	04/15/10 12:54	LH	10D1339	8260B
Chloromethane	ND		5.0	0.35	ug/L	1.00	04/15/10 12:54	LH	10D1339	8260B
cis-1,2-Dichloroethene	ND		5.0	0.81	ug/L	1.00	04/15/10 12:54	LH	10D1339	8260B
cis-1,3-Dichloropropene	ND		5.0	0.36	ug/L	1.00	04/15/10 12:54	LH	10D1339	8260B
Cyclohexane	ND		5.0	0.18	ug/L	1.00	04/15/10 12:54	LH	10D1339	8260B
Dichlorodifluoromethane	ND		5.0	0.68	ug/L	1.00	04/15/10 12:54	LH	10D1339	8260B
Ethylbenzene	ND		5.0	0.74	ug/L	1.00	04/15/10 12:54	LH	10D1339	8260B
Isopropylbenzene	ND		5.0	0.79	ug/L	1.00	04/15/10 12:54	LH	10D1339	8260B
Methyl Acetate	ND		5.0	0.50	ug/L	1.00	04/15/10 12:54	LH	10D1339	8260B
Methyl-t-Butyl Ether (MTBE)	ND		5.0	0.16	ug/L	1.00	04/15/10 12:54	LH	10D1339	8260B
Methylcyclohexane	ND		5.0	0.16	ug/L	1.00	04/15/10 12:54	LH	10D1339	8260B
Methylene Chloride	ND		5.0	0.44	ug/L	1.00	04/15/10 12:54	LH	10D1339	8260B
Styrene	ND		5.0	0.73	ug/L	1.00	04/15/10 12:54	LH	10D1339	8260B
Tetrachloroethene	ND		5.0	0.36	ug/L	1.00	04/15/10 12:54	LH	10D1339	8260B
Toluene	ND		5.0	0.51	ug/L	1.00	04/15/10 12:54	LH	10D1339	8260B
trans-1,2-Dichloroethene	ND		5.0	0.90	ug/L	1.00	04/15/10 12:54	LH	10D1339	8260B
trans-1,3-Dichloropropene	ND		5.0	0.37	ug/L	1.00	04/15/10 12:54	LH	10D1339	8260B
Trichloroethene	ND		5.0	0.46	ug/L	1.00	04/15/10 12:54	LH	10D1339	8260B
Trichlorofluoromethane	ND		5.0	0.88	ug/L	1.00	04/15/10 12:54	LH	10D1339	8260B
Vinyl chloride	ND		5.0	0.90	ug/L	1.00	04/15/10 12:54	LH	10D1339	8260B

AECOM - Amherst, NY
100 Corporate Pkwy-Univ Centre
Amherst, NY 14226

Work Order: RTD0926
Project: Scott Aviation site - Influent/Effluent
Project Number: EARTH

Received: 04/08/10
Reported: 04/20/10 10:49

Analytical Report

Analyte	Sample Result	Data Qualifiers	RL	MDL	Units	Dil Fac	Date Analyzed	Lab Tech	Batch	Method
Sample ID: RTD0926-03 (TRIP BLANK - Water) - cont.					Sampled: 04/07/10			Recvd: 04/08/10 08:00		
<u>Volatile Organic Compounds by EPA 8260B - cont.</u>										
Xylenes, total	ND		15	0.66	ug/L	1.00	04/15/10 12:54	LH	10D1339	8260B
1,2-Dichloroethane-d4	87 %		<i>Surr Limits: (66-137%)</i>				04/15/10 12:54	LH	10D1339	8260B
4-Bromofluorobenzene	84 %		<i>Surr Limits: (73-120%)</i>				04/15/10 12:54	LH	10D1339	8260B
Toluene-d8	86 %		<i>Surr Limits: (71-126%)</i>				04/15/10 12:54	LH	10D1339	8260B

AECOM - Amherst, NY
100 Corporate Pkwy-Univ Centre
Amherst, NY 14226

Work Order: RTD0926

Project: Scott Aviation site - Influent/Effluent
Project Number: EARTH

Received: 04/08/10
Reported: 04/20/10 10:49

SAMPLE EXTRACTION DATA

Parameter	Batch	Lab Number	Wt/Vol Extracte	Units	Extract Volume	Units	Date Prepared	Lab Tech	Extraction Method
General Chemistry Parameters									
1664 SGT	10D0847	RTD0926-01	980.00	mL	1,000.00	mL	04/10/10 10:00	JME	No prep Oil and Grease
1664 SGT	10D0847	RTD0926-02	1,010.00	mL	1,000.00	mL	04/10/10 10:00	JME	No prep Oil and Grease
2540D	10D1019	RTD0926-01	250.00	mL	250.00	mL	04/12/10 16:40	MDM	Solids
2540D	10D1019	RTD0926-02	250.00	mL	250.00	mL	04/12/10 16:40	MDM	Solids
4500-H+ B	10D0801	RTD0926-01	1.00	mL	1.00	mL	04/09/10 00:15	JFR	pH
4500-H+ B	10D0801	RTD0926-02	1.00	mL	1.00	mL	04/09/10 00:15	JFR	pH
Volatile Organic Compounds by EPA 8260B									
8260B	10D1431	RTD0926-01	5.00	mL	5.00	mL	04/15/10 19:21	CDC	5030B MS
8260B	10D1431	RTD0926-02RE	5.00	mL	5.00	mL	04/15/10 19:21	CDC	5030B MS
8260B	10D1339	RTD0926-02	5.00	mL	5.00	mL	04/15/10 10:24	TRB	5030B MS
8260B	10D1339	RTD0926-03	5.00	mL	5.00	mL	04/15/10 10:24	TRB	5030B MS

AECOM - Amherst, NY
100 Corporate Pkwy-Univ Centre
Amherst, NY 14226

Work Order: RTD0926
Project: Scott Aviation site - Influent/Effluent
Project Number: EARTH

Received: 04/08/10
Reported: 04/20/10 10:49

LABORATORY QC DATA

Analyte	Source Result	Spike Level	RL	MDL	Units	Result	% REC	% REC Limits	% RPD	RPD Limit	Data Qualifiers
<u>Volatiles Organic Compounds by EPA 8260B</u>											
Blank Analyzed: 04/15/10 (Lab Number:10D1339-BLK1, Batch: 10D1339)											
1,1,1-Trichloroethane			5.0	0.82	ug/L	ND					
1,1,2,2-Tetrachloroethane			5.0	0.21	ug/L	ND					
1,1,2-Trichloroethane			5.0	0.23	ug/L	ND					
1,1,2-Trichloro-1,2,2-trifluoroethane			5.0	0.31	ug/L	ND					
1,1-Dichloroethane			5.0	0.38	ug/L	ND					
1,1-Dichloroethene			5.0	0.29	ug/L	ND					
1,2,4-Trichlorobenzene			5.0	0.41	ug/L	ND					
1,2-Dibromo-3-chloropropane			5.0	0.39	ug/L	ND					
1,2-Dibromoethane			5.0	0.73	ug/L	ND					
1,2-Dichlorobenzene			5.0	0.79	ug/L	ND					
1,2-Dichloroethane			5.0	0.21	ug/L	ND					
1,2-Dichloropropane			5.0	0.72	ug/L	ND					
1,3-Dichlorobenzene			5.0	0.78	ug/L	ND					
1,4-Dichlorobenzene			5.0	0.84	ug/L	ND					
2-Butanone			25	1.3	ug/L	ND					
2-Hexanone			25	1.2	ug/L	ND					
4-Methyl-2-pentanone			25	2.1	ug/L	ND					
Acetone			25	3.0	ug/L	ND					
Benzene			5.0	0.41	ug/L	ND					
Bromodichloromethane			5.0	0.39	ug/L	ND					
Bromoform			5.0	0.26	ug/L	ND					
Bromomethane			5.0	0.69	ug/L	ND					
Carbon disulfide			5.0	0.19	ug/L	ND					
Carbon Tetrachloride			5.0	0.27	ug/L	ND					
Chlorobenzene			5.0	0.75	ug/L	ND					
Dibromochloromethane			5.0	0.32	ug/L	ND					
Chloroethane			5.0	0.32	ug/L	ND					
Chloroform			5.0	0.34	ug/L	ND					
Chloromethane			5.0	0.35	ug/L	ND					
cis-1,2-Dichloroethene			5.0	0.81	ug/L	ND					
cis-1,3-Dichloropropene			5.0	0.36	ug/L	ND					
Cyclohexane			5.0	0.18	ug/L	ND					
Dichlorodifluoromethane			5.0	0.68	ug/L	ND					
Ethylbenzene			5.0	0.74	ug/L	ND					
Isopropylbenzene			5.0	0.79	ug/L	ND					
Methyl Acetate			5.0	0.50	ug/L	ND					

AECOM - Amherst, NY
100 Corporate Pkwy-Univ Centre
Amherst, NY 14226

Work Order: RTD0926
Project: Scott Aviation site - Influent/Effluent
Project Number: EARTH

Received: 04/08/10
Reported: 04/20/10 10:49

LABORATORY QC DATA

Analyte	Source Result	Spike Level	RL	MDL	Units	Result	% REC	% REC Limits	% RPD	RPD Limit	Data Qualifiers
<u>Volatile Organic Compounds by EPA 8260B</u>											
Blank Analyzed: 04/15/10 (Lab Number:10D1339-BLK1, Batch: 10D1339)											
Methyl-t-Butyl Ether (MTBE)			5.0	0.16	ug/L	ND					
Methylcyclohexane			5.0	0.16	ug/L	ND					
Methylene Chloride			5.0	0.44	ug/L	ND					
Styrene			5.0	0.73	ug/L	ND					
Tetrachloroethene			5.0	0.36	ug/L	ND					
Toluene			5.0	0.51	ug/L	ND					
trans-1,2-Dichloroethene			5.0	0.90	ug/L	ND					
trans-1,3-Dichloropropene			5.0	0.37	ug/L	ND					
Trichloroethene			5.0	0.46	ug/L	ND					
Trichlorofluoromethane			5.0	0.88	ug/L	ND					
Vinyl chloride			5.0	0.90	ug/L	ND					
Xylenes, total			15	0.66	ug/L	ND					
<i>Surrogate:</i>							86	66-137			
<i>1,2-Dichloroethane-d4</i>											
<i>Surrogate:</i>							79	73-120			
<i>4-Bromofluorobenzene</i>											
<i>Surrogate: Toluene-d8</i>							85	71-126			
LCS Analyzed: 04/15/10 (Lab Number:10D1339-BS1, Batch: 10D1339)											
1,1,1-Trichloroethane			5.0	0.82	ug/L	ND		73-126			
1,1,2,2-Tetrachloroethane			5.0	0.21	ug/L	ND		70-126			
1,1,2-Trichloroethane			5.0	0.23	ug/L	ND		76-122			
1,1,2-Trichloro-1,2,2-trifluoroethane			5.0	0.31	ug/L	ND		60-140			
1,1-Dichloroethane			5.0	0.38	ug/L	ND		71-129			
1,1-Dichloroethene		25.0	5.0	0.29	ug/L	22.8	91	65-138			
1,2,4-Trichlorobenzene			5.0	0.41	ug/L	ND		70-122			
1,2-Dibromo-3-chloropropane			5.0	0.39	ug/L	ND		56-134			
1,2-Dibromoethane			5.0	0.73	ug/L	ND		77-120			
1,2-Dichlorobenzene			5.0	0.79	ug/L	ND		77-120			
1,2-Dichloroethane			5.0	0.21	ug/L	ND		75-127			
1,2-Dichloropropane			5.0	0.72	ug/L	ND		76-120			
1,3-Dichlorobenzene			5.0	0.78	ug/L	ND		77-120			
1,4-Dichlorobenzene			5.0	0.84	ug/L	ND		75-120			
2-Butanone			25	1.3	ug/L	ND		57-140			
2-Hexanone			25	1.2	ug/L	ND		65-127			
4-Methyl-2-pentanone			25	2.1	ug/L	ND		71-125			
Acetone			25	3.0	ug/L	ND		56-142			

AECOM - Amherst, NY
100 Corporate Pkwy-Univ Centre
Amherst, NY 14226

Work Order: RTD0926
Project: Scott Aviation site - Influent/Effluent
Project Number: EARTH

Received: 04/08/10
Reported: 04/20/10 10:49

LABORATORY QC DATA

Analyte	Source Result	Spike Level	RL	MDL	Units	Result	% REC	% REC Limits	% RPD	RPD Limit	Data Qualifiers
<u>Volatiles Organic Compounds by EPA 8260B</u>											
LCS Analyzed: 04/15/10 (Lab Number:10D1339-BS1, Batch: 10D1339)											
Benzene		25.0	5.0	0.41	ug/L	25.5	102	71-124			
Bromodichloromethane			5.0	0.39	ug/L	ND		80-122			
Bromoform			5.0	0.26	ug/L	ND		66-128			
Bromomethane			5.0	0.69	ug/L	ND		36-150			
Carbon disulfide			5.0	0.19	ug/L	ND		59-134			
Carbon Tetrachloride			5.0	0.27	ug/L	ND		72-134			
Chlorobenzene		25.0	5.0	0.75	ug/L	24.2	97	72-120			
Dibromochloromethane			5.0	0.32	ug/L	ND		75-125			
Chloroethane			5.0	0.32	ug/L	ND		69-136			
Chloroform			5.0	0.34	ug/L	ND		73-127			
Chloromethane			5.0	0.35	ug/L	ND		49-142			
cis-1,2-Dichloroethene			5.0	0.81	ug/L	ND		74-124			
cis-1,3-Dichloropropene			5.0	0.36	ug/L	ND		74-124			
Cyclohexane			5.0	0.18	ug/L	ND		70-130			
Dichlorodifluoromethane			5.0	0.68	ug/L	ND		33-157			
Ethylbenzene			5.0	0.74	ug/L	ND		77-123			
Isopropylbenzene			5.0	0.79	ug/L	ND		77-122			
Methyl Acetate			5.0	0.50	ug/L	ND		60-140			
Methyl-t-Butyl Ether (MTBE)			5.0	0.16	ug/L	ND		64-127			
Methylcyclohexane			5.0	0.16	ug/L	ND		60-140			
Methylene Chloride			5.0	0.44	ug/L	ND		57-132			
Styrene			5.0	0.73	ug/L	ND		70-130			
Tetrachloroethene			5.0	0.36	ug/L	ND		74-122			
Toluene		25.0	5.0	0.51	ug/L	24.7	99	70-122			
trans-1,2-Dichloroethene			5.0	0.90	ug/L	ND		73-127			
trans-1,3-Dichloropropene			5.0	0.37	ug/L	ND		72-123			
Trichloroethene		25.0	5.0	0.46	ug/L	23.7	95	74-123			
Trichlorofluoromethane			5.0	0.88	ug/L	ND		62-152			
Vinyl chloride			5.0	0.90	ug/L	ND		65-133			
Xylenes, total			15	0.66	ug/L	ND		76-122			
<i>Surrogate:</i>					<i>ug/L</i>		<i>85</i>	<i>66-137</i>			
<i>1,2-Dichloroethane-d4</i>											
<i>Surrogate:</i>					<i>ug/L</i>		<i>79</i>	<i>73-120</i>			
<i>4-Bromofluorobenzene</i>											
<i>Surrogate: Toluene-d8</i>					<i>ug/L</i>		<i>85</i>	<i>71-126</i>			

Volatiles Organic Compounds by EPA 8260B

AECOM - Amherst, NY
100 Corporate Pkwy-Univ Centre
Amherst, NY 14226

Work Order: RTD0926
Project: Scott Aviation site - Influent/Effluent
Project Number: EARTH

Received: 04/08/10
Reported: 04/20/10 10:49

LABORATORY QC DATA

Analyte	Source Result	Spike Level	RL	MDL	Units	Result	% REC	% REC Limits	% RPD	RPD Limit	Data Qualifiers
<u>Volatiles Organic Compounds by EPA 8260B</u>											
Blank Analyzed: 04/15/10 (Lab Number:10D1431-BLK1, Batch: 10D1431)											
1,1,1-Trichloroethane			5.0	0.82	ug/L	ND					
1,1,2,2-Tetrachloroethane			5.0	0.21	ug/L	ND					
1,1,2-Trichloroethane			5.0	0.23	ug/L	ND					
1,1,2-Trichloro-1,2,2-trifluoroethane			5.0	0.31	ug/L	ND					
1,1-Dichloroethane			5.0	0.38	ug/L	ND					
1,1-Dichloroethene			5.0	0.29	ug/L	ND					
1,2,4-Trichlorobenzene			5.0	0.41	ug/L	ND					
1,2-Dibromo-3-chloropropane			5.0	0.39	ug/L	ND					
1,2-Dibromoethane			5.0	0.73	ug/L	ND					
1,2-Dichlorobenzene			5.0	0.79	ug/L	ND					
1,2-Dichloroethane			5.0	0.21	ug/L	ND					
1,2-Dichloropropane			5.0	0.72	ug/L	ND					
1,3-Dichlorobenzene			5.0	0.78	ug/L	ND					
1,4-Dichlorobenzene			5.0	0.84	ug/L	ND					
2-Butanone			25	1.3	ug/L	ND					
2-Hexanone			25	1.2	ug/L	ND					
4-Methyl-2-pentanone			25	2.1	ug/L	ND					
Acetone			25	3.0	ug/L	ND					
Benzene			5.0	0.41	ug/L	ND					
Bromodichloromethane			5.0	0.39	ug/L	ND					
Bromoform			5.0	0.26	ug/L	ND					
Bromomethane			5.0	0.69	ug/L	ND					
Carbon disulfide			5.0	0.19	ug/L	ND					
Carbon Tetrachloride			5.0	0.27	ug/L	ND					
Chlorobenzene			5.0	0.75	ug/L	ND					
Dibromochloromethane			5.0	0.32	ug/L	ND					
Chloroethane			5.0	0.32	ug/L	ND					
Chloroform			5.0	0.34	ug/L	ND					
Chloromethane			5.0	0.35	ug/L	ND					
cis-1,2-Dichloroethene			5.0	0.81	ug/L	ND					
cis-1,3-Dichloropropene			5.0	0.36	ug/L	ND					
Cyclohexane			5.0	0.18	ug/L	ND					
Dichlorodifluoromethane			5.0	0.68	ug/L	ND					
Ethylbenzene			5.0	0.74	ug/L	ND					
Isopropylbenzene			5.0	0.79	ug/L	ND					
Methyl Acetate			5.0	0.50	ug/L	ND					

AECOM - Amherst, NY
100 Corporate Pkwy-Univ Centre
Amherst, NY 14226

Work Order: RTD0926
Project: Scott Aviation site - Influent/Effluent
Project Number: EARTH

Received: 04/08/10
Reported: 04/20/10 10:49

LABORATORY QC DATA

Analyte	Source Result	Spike Level	RL	MDL	Units	Result	% REC	% REC Limits	% RPD	RPD Limit	Data Qualifiers
Volatiles Organic Compounds by EPA 8260B											
Blank Analyzed: 04/15/10 (Lab Number:10D1431-BLK1, Batch: 10D1431)											
Methyl-t-Butyl Ether (MTBE)			5.0	0.16	ug/L	ND					
Methylcyclohexane			5.0	0.16	ug/L	ND					
Methylene Chloride			5.0	0.44	ug/L	ND					
Styrene			5.0	0.73	ug/L	ND					
Tetrachloroethene			5.0	0.36	ug/L	ND					
Toluene			5.0	0.51	ug/L	ND					
trans-1,2-Dichloroethene			5.0	0.90	ug/L	ND					
trans-1,3-Dichloropropene			5.0	0.37	ug/L	ND					
Trichloroethene			5.0	0.46	ug/L	ND					
Trichlorofluoromethane			5.0	0.88	ug/L	ND					
Vinyl chloride			5.0	0.90	ug/L	ND					
Xylenes, total			15	0.66	ug/L	ND					
<i>Surrogate:</i>							112	66-137			
<i>1,2-Dichloroethane-d4</i>											
<i>Surrogate:</i>							109	73-120			
<i>4-Bromofluorobenzene</i>											
<i>Surrogate: Toluene-d8</i>							116	71-126			
LCS Analyzed: 04/15/10 (Lab Number:10D1431-BS1, Batch: 10D1431)											
1,1,1-Trichloroethane			5.0	0.82	ug/L	ND		73-126			
1,1,2,2-Tetrachloroethane			5.0	0.21	ug/L	ND		70-126			
1,1,2-Trichloroethane			5.0	0.23	ug/L	ND		76-122			
1,1,2-Trichloro-1,2,2-trifluoroethane			5.0	0.31	ug/L	ND		60-140			
1,1-Dichloroethane			5.0	0.38	ug/L	ND		71-129			
1,1-Dichloroethene		25.0	5.0	0.29	ug/L	30.6	122	65-138			
1,2,4-Trichlorobenzene			5.0	0.41	ug/L	ND		70-122			
1,2-Dibromo-3-chloropropane			5.0	0.39	ug/L	ND		56-134			
1,2-Dibromoethane			5.0	0.73	ug/L	ND		77-120			
1,2-Dichlorobenzene			5.0	0.79	ug/L	ND		77-120			
1,2-Dichloroethane			5.0	0.21	ug/L	ND		75-127			
1,2-Dichloropropane			5.0	0.72	ug/L	ND		76-120			
1,3-Dichlorobenzene			5.0	0.78	ug/L	ND		77-120			
1,4-Dichlorobenzene			5.0	0.84	ug/L	ND		75-120			
2-Butanone			25	1.3	ug/L	ND		57-140			
2-Hexanone			25	1.2	ug/L	ND		65-127			
4-Methyl-2-pentanone			25	2.1	ug/L	ND		71-125			
Acetone			25	3.0	ug/L	ND		56-142			

AECOM - Amherst, NY
100 Corporate Pkwy-Univ Centre
Amherst, NY 14226

Work Order: RTD0926
Project: Scott Aviation site - Influent/Effluent
Project Number: EARTH

Received: 04/08/10
Reported: 04/20/10 10:49

LABORATORY QC DATA

Analyte	Source Result	Spike Level	RL	MDL	Units	Result	% REC	% REC Limits	% RPD	RPD Limit	Data Qualifiers
<u>Volatiles Organic Compounds by EPA 8260B</u>											
LCS Analyzed: 04/15/10 (Lab Number:10D1431-BS1, Batch: 10D1431)											
Benzene		25.0	5.0	0.41	ug/L	28.5	114	71-124			
Bromodichloromethane			5.0	0.39	ug/L	ND		80-122			
Bromoform			5.0	0.26	ug/L	ND		66-128			
Bromomethane			5.0	0.69	ug/L	ND		36-150			
Carbon disulfide			5.0	0.19	ug/L	ND		59-134			
Carbon Tetrachloride			5.0	0.27	ug/L	ND		72-134			
Chlorobenzene		25.0	5.0	0.75	ug/L	25.7	103	72-120			
Dibromochloromethane			5.0	0.32	ug/L	ND		75-125			
Chloroethane			5.0	0.32	ug/L	ND		69-136			
Chloroform			5.0	0.34	ug/L	ND		73-127			
Chloromethane			5.0	0.35	ug/L	ND		49-142			
cis-1,2-Dichloroethene			5.0	0.81	ug/L	ND		74-124			
cis-1,3-Dichloropropene			5.0	0.36	ug/L	ND		74-124			
Cyclohexane			5.0	0.18	ug/L	ND		70-130			
Dichlorodifluoromethane			5.0	0.68	ug/L	ND		33-157			
Ethylbenzene			5.0	0.74	ug/L	ND		77-123			
Isopropylbenzene			5.0	0.79	ug/L	ND		77-122			
Methyl Acetate			5.0	0.50	ug/L	ND		60-140			
Methyl-t-Butyl Ether (MTBE)			5.0	0.16	ug/L	ND		64-127			
Methylcyclohexane			5.0	0.16	ug/L	ND		60-140			
Methylene Chloride			5.0	0.44	ug/L	ND		57-132			
Styrene			5.0	0.73	ug/L	ND		70-130			
Tetrachloroethene			5.0	0.36	ug/L	ND		74-122			
Toluene		25.0	5.0	0.51	ug/L	26.9	108	70-122			
trans-1,2-Dichloroethene			5.0	0.90	ug/L	ND		73-127			
trans-1,3-Dichloropropene			5.0	0.37	ug/L	ND		72-123			
Trichloroethene		25.0	5.0	0.46	ug/L	27.6	110	74-123			
Trichlorofluoromethane			5.0	0.88	ug/L	ND		62-152			
Vinyl chloride			5.0	0.90	ug/L	ND		65-133			
Xylenes, total			15	0.66	ug/L	ND		76-122			
<i>Surrogate:</i>					<i>ug/L</i>		<i>111</i>	<i>66-137</i>			
<i>1,2-Dichloroethane-d4</i>											
<i>Surrogate:</i>					<i>ug/L</i>		<i>110</i>	<i>73-120</i>			
<i>4-Bromofluorobenzene</i>											
<i>Surrogate: Toluene-d8</i>					<i>ug/L</i>		<i>117</i>	<i>71-126</i>			

AECOM - Amherst, NY
 100 Corporate Pkwy-Univ Centre
 Amherst, NY 14226

Work Order: RTD0926
 Project: Scott Aviation site - Influent/Effluent
 Project Number: EARTH

Received: 04/08/10
 Reported: 04/20/10 10:49

LABORATORY QC DATA

Analyte	Source Result	Spike Level	RL	MDL	Units	Result	% REC	% REC Limits	% RPD	RPD Limit	Data Qualifiers
---------	---------------	-------------	----	-----	-------	--------	-------	--------------	-------	-----------	-----------------

General Chemistry Parameters

LCS Analyzed: 04/09/10 (Lab Number:10D0801-BS1, Batch: 10D0801)

pH		7.00	NA	0.00	SU	7.01	100	99.3-100.8			
----	--	------	----	------	----	------	-----	------------	--	--	--

General Chemistry Parameters

Blank Analyzed: 04/10/10 (Lab Number:10D0847-BLK1, Batch: 10D0847)

SGT Total Petroleum Hydrocarbons			5.0	1.9	mg/L	ND					
----------------------------------	--	--	-----	-----	------	----	--	--	--	--	--

LCS Analyzed: 04/10/10 (Lab Number:10D0847-BS1, Batch: 10D0847)

SGT Total Petroleum Hydrocarbons		12.5	5.0	1.9	mg/L	8.80	70	64-132			
----------------------------------	--	------	-----	-----	------	------	----	--------	--	--	--

General Chemistry Parameters

Blank Analyzed: 04/12/10 (Lab Number:10D1019-BLK1, Batch: 10D1019)

Total Suspended Solids			4.0	4.0	mg/L	ND					
------------------------	--	--	-----	-----	------	----	--	--	--	--	--

LCS Analyzed: 04/12/10 (Lab Number:10D1019-BS1, Batch: 10D1019)

Total Suspended Solids		578	4.0	4.0	mg/L	544	94	88-110			
------------------------	--	-----	-----	-----	------	-----	----	--------	--	--	--

TestAmerica

THE LEADER IN ENVIRONMENTAL TESTING

Chain of Custody Record

Temperature on Receipt _____
 Drinking Water? Yes No

TAL-4124 (1/00/7)

Client: **AECOM** Chain of Custody Number: **166324**
 Address: **100 Corporate Parkway, Suite 341** Date: **4/7/10**
 City: **Amherst** State: **NY** Zip Code: **14226** Lab Number: **BUF** Page: **1** of **1**
 Project Manager: **Dino Zack** Telephone Number (Area Code)/Fax Number: **716-836-4506 ext. 15**
 Site Contact: **D. Zack** Lab Contact: **B. Fisher**

Project Name and Location (State): **Scott Avinon 2010 - NY**
 Contract/Purchase Order/Quote No. _____

Sample I.D. No. and Description (Containers for each sample may be combined on one line)	Date	Time	Matrix				Containers & Preservatives				Analysis (Attach list if more space is needed)	Special Instructions/Conditions of Receipt	
			g	pg	g	pg	USPC	HSC	NON	NON			
Influent	4/7/10	0800	X					Z	Z			HWSGT TSS VOC	
Effluent	4/7/10	0800	X					Z	Z				
Trip Blank	4/7/10		X										

Possible Hazard Identification: Non-Hazard Flammable Skin Irritant Poison B Unknown

Sample Disposal: Return to Client Dispose By Lab Archive For Archive (A fee may be assessed if samples are retained longer than 1 month)

Turn Around Time Required: 24 Hours 48 Hours 7 Days 14 Days 21 Days Other: **STD**

1. Received By: **Dino Zack** Date: **4/7/10** Time: **1700hrs**
 2. Received By: _____ Date: _____ Time: _____
 3. Received By: _____ Date: _____ Time: _____

Comments: **Base Sample Influent GRAB #2 M3 NY into one sample. Same for Effluent GRAB #1 #2 M3 NY. Call w/questions 2.0.**
 DISTRIBUTION: WHITE - Returned to Client with Report. CANARY - Stays with the Sample. PINK - Field Copy