

**CORPORATE/
BUFFALO OFFICE**

5167 South Park Avenue
Hamburg, NY 14075
Phone: (716)-649-8110
Fax: (716) 649-8051

ALBANY OFFICE

P.O. Box 2199
Ballston Spa, NY 12020

5 Knabner Road
Mechanicville, NY 12118
Phone: (518) 899-7491
Fax: (518) 899-7496

CORTLAND OFFICE

60 Miller Street
Cortland, NY 13045
Phone: (607) 758-7182
Fax: (607) 758-7188

ROCHESTER OFFICE

535 Summit Point Drive
Henrietta, NY 14467
Phone: (585) 359-2730
Fax: (585) 359-9668

ASBESTOS AND LEAD-BASED PAINT SURVEY REPORT

Starlite Dry Cleaners
331 Main Street
Medina, NY 14103

Prepared for:

NYSDEC
Division of Environmental Remediation
Bureau E, Section B
625 Broadway, 12th Floor
Albany, NY 12233

Prepared by:

Empire Geo-Services, Inc.
5167 South Park Avenue
Hamburg, New York 14075

October 2015

TABLE OF CONTENTS

I. INTRODUCTION

- A. General
- B. Purpose and Scope

II. ASBESTOS CONTAINING MATERIAL SURVEY

- A. Physical Setting
- B. Background Information
- C. Sampling Strategy
- D. Survey Methodology
- E. Laboratory Analytical Results

III. LEAD BASED PAINT SURVEY

- A. Physical Setting
- B. Background Information
- C. Sampling Strategy
- D. Survey Methodology
- F. Laboratory Analytical Results

IV. SUMMARY OF FINDINGS

V. RECOMMENDATIONS

VI. CLOSING REMARKS

FIGURES

- Figure No. 1 – Asbestos Sample Locations Map
- Figure No. 2 – Lead-Based Paint Sample Locations Map

TABLES

- Table No. 1 – Summary of ACM Samples and Analytical Results
- Table No. 2 – Summary of LBP Samples and Analytical Results

ATTACHMENTS

- Attachment 1 – Asbestos Analytical Results
- Attachment 2 – Lead-Based Paint Analytical Results
- Attachment 3 – Laboratory and Personnel Certifications

I. INTRODUCTION

A. General

As per the request and authorization of Mrs. Gail A. Dieter with the New York State Department of Environmental Conservation (NYSDEC) in Albany, New York, Empire Geo-Services, Inc. (Empire) has completed a pre-demolition asbestos and lead-based paint survey of the northern portion of a fire damaged 1-story structure at 331 Main Street in the Village of Medina, Orleans County, New York. The survey consisted of visual inspections of the suspect location, along with bulk sampling of suspect materials. Presented herein are discussions of the methodologies employed and findings of the asbestos and lead-based paint survey.

B. Purpose and Scope

The purpose of this investigation was to conduct a pre-demolition asbestos and lead-based paint survey at the above referenced site. Empire understands that the structure at the site is slated for demolition.

A Pre-demolition Asbestos Survey is required in accordance with National Emissions Standards for Hazardous Air Pollutants (NESHAP) and New York State Industrial Code Rule 56 requirements to identify, quantify and assess the condition of suspect asbestos containing material (ACM). Additionally, a Lead-Based Paint (LBP) Survey was conducted in accordance with 40 CFR Part 745 (Code of Federal Regulations).

Empire conducted an asbestos and lead-based paint survey of the building that included:

- Visually inspect the areas
- Collect and analyze samples for the presence of ACM /LBP
- Quantify the amount of ACM /LBP
- Assess condition of ACM

An approved environmental laboratory provided the analytical services to Empire, with samples being collected by Empire and submitted under proper chain-of-custody protocol to the testing firm.

II. ASBESTOS CONTAINING MATERIAL SURVEY

A. Physical Setting

The subject site is located at 331 Main Street in the Village of Medina, Orleans County, New York. The subject site was not open to the public at the time of the survey. The building is one story tall in which the south portion of the building has severe fire damage. Due to the fire damage the south portion of the building had limited accessibility.

B. Background Information

Empire was authorized by Mrs. Gail A. Dieter with the NYSDEC to conduct a Pre-demolition Survey of the property.

Empire was not provided nor reviewed any drawings, floor plans, historical data, maintenance records, previous surveys, laboratory reports or other documents for information pertaining to construction history or building materials.

C. Sampling Strategy

Conventional asbestos sampling methods required in 12 NYCCR Part 56 were performed. A limited number of samples were collected of the suspect materials, including flooring; mastics; adhesives; ceiling tiles; insulations; wall papers; cementitious materials; joint compound; sheetrock; wire insulation; caulks; window glazing compounds; roof tar, coatings and roofing materials.

D. Survey Methodology

Empire visually inspected the building by walking over the areas and noting conditions. Bulk samples were discreetly collected from each listed suspect material and placed in an airtight plastic bag. Each sample was labeled with the site name, sample date and sample location and recorded on the chain-of-custody (COC). Also noted on the COC for each sample is a description of the material, color and analysis to be performed. Restoration of sample locations was not provided. See Figure 1 for ACM sample locations.

E. Laboratory Analytical Results

All asbestos bulk samples were delivered to AmeriSci Richmond located in Midlothian, Virginia via FedEx. AmeriSci is fully accredited for bulk sample analysis including polarized light microscopy (PLM) and transmission electron microscopy (TEM) under the Environmental Laboratory Approval Program (ELAP) administered by the New York State Department of Health (NYSDOH), ELAP No. 10984 and National Voluntary Laboratory Accreditation Program (NVLAP) administered by the National Institute of Standards and Technology, NVLAP No. 101904-0.

Sixty-five (65) samples were collected and analyzed for asbestos fibers using EPA Method 600/R-93/116 with New York State ELAP 198.1 revision to facilitate compliance with both AHERA (Asbestos Hazard Emergency Response Act) and NYSDOH PLM analytical techniques. This analysis was done using PLM. All fibers observed were identified to determine whether or not they contained asbestos. Eight (8) samples were not analyzed as they are of the same functional space as another sample that tested positive and therefore did not require analysis.

PLM is not consistently reliable in detecting asbestos in non-friable organically bound

(NOB) materials such as roofing, flooring, caulk and mastic compounds. Additionally, PLM is not definitive for fibrous ceiling tiles. As such, thirty-one (31) samples reported as none detected or less than 1% asbestos by PLM had additional analysis for asbestos by EPA Method 600/R-93/116 section 2.5 with New York State ELAP 198.4 and 198.6 revisions to facilitate compliance with both AHERA and NYSDOH PLM and TEM analytical techniques.

III. LEAD-BASED PAINT SURVEY

A. Physical Setting

Same as above

B. Background Information

Same as above

C. Sampling Strategy

The U.S. Environmental Protection Agency (EPA) defines an inspection as a surface-by-surface investigation to determine the presence of lead-based paint (see 40 CFR part 745). The client requested testing of the painted surfaces likely to be involved with the demolition project. The areas were inspected and several layers of various colored paints were observed on multiple surfaces. To reduce the number of samples, paint of the same color or layer were grouped together within the same room/area.

D. Survey Methodology

Each location selected for sampling had paint scraped from the substrate and placed in individual airtight plastic bags. Each sample was labeled with the site name, sample date and sample location and recorded on the chain-of-custody (COC). See Figure 2 for LBP sample locations.

E. Laboratory Analytical Results

All paint samples were delivered to Alpha Analytical Laboratories located in Westborough, Massachusetts. Alpha is fully accredited for environmental solid and hazardous waste sample analysis under the Environmental Laboratory Approval Program (ELAP) administered by the New York State Department of Health (NYSDOH), ELAP No. 11148 and National Environmental Laboratory Accreditation Conference Standards.

IV. SUMMARY OF FINDINGS

A. Asbestos-Containing Materials

The results of the laboratory analysis of the sixty-five (65) asbestos samples indicate that asbestos was detected greater than 1% in seven (7) of the samples by the PLM methodology and zero (0) samples by the TEM methodology (see Table 1). As per 29 CFR 1926.1101 (b) and 12 NYCRR Part 56-2.1 (p) any material containing more than one percent (> 1%) asbestos is an asbestos-containing material (ACM). This ACM is located in the 9" x 9" floor tiles throughout the office space; canvas duct wrap paper on duct above the office; pipe insulation and mudded fittings in the bathroom interstitial space; transite pipe in area behind the bathroom; and roof tar associated with the flashing on the roof. Thirty-one (31) other samples that were inconclusive by PLM were analyzed by TEM and found to have less than one percent (<1%) asbestos and are therefore not ACM.

B. Lead-Based Paint

As per the EPA & HUD guidelines lead based paint is defined as a dried paint film with a lead concentration of greater than or equal to 1.0 micrograms per square centimeter (mg/cm^2) or 0.5 percent by weight for this survey. Laboratory results indicate that lead concentration is above the threshold for 7 of the 10 samples collected. The results are shown in Table 2.

V. RECOMMENDATIONS

A licensed asbestos contractor prior to demolition should remove all ACM that will be impacted by the renovation of the site. New York State Department of Labor (NYSDOL) Industrial Code Rule Part 56 Asbestos Regulations section 56-5.1 (h) states:

“If the building/structure asbestos survey finds that the portion of the building/structure to be demolished, renovated, remodeled, or have repair work contains ACM, PACM, suspect miscellaneous ACM assumed to be ACM, or asbestos material, which is impacted by the work, the owner or the owner’s agent shall conduct, or cause to have conducted, asbestos removal performed by a licensed asbestos abatement contractor in conformance with all standards set forth in this Part.”

Abatement activities must be conducted in compliance with all applicable regulations, standards and generally accepted environmental and safety practices including OSHA (29 CFR 1926.1101), EPA NESHAPS (40 CFR Part 61), and NYSDOL (12 NYCRR Part 56) asbestos regulations.

If, during the course of demolition, any suspect material is discovered it must be treated as ACM and handled appropriately or sampled by an inspector according to regulations.

The owner shall transmit a copy of the asbestos survey as follows:

- One copy of the completed asbestos survey shall be sent to the local government entity charged with issuing a permit for such demolition, renovation, remodeling or repair work under applicable State or local laws.
- The completed asbestos survey for controlled demolition or pre-demolition asbestos projects shall also be submitted to the appropriate Asbestos Control Bureau district office.

BUFFALO DISTRICT

(Counties: Cattaraugus, Chautauqua, Erie, Genesee, Livingston, Monroe, Niagara, Ontario, Orleans, Wayne, Wyoming, Yates)

□ 65 Court St, Rm. 405, Buffalo, NY 14202; (716) 847-7601

- The completed asbestos survey shall be kept on the construction site with the asbestos notification and variance, if required, throughout the duration of the asbestos project and any associated demolition, renovation, remodeling or repair work.

VI. CLOSING REMARKS

This report was prepared by Empire to document the results of an asbestos and lead-based paint survey conducted at 331 Main Street in Medina, New York on September 22, 2015. This report has been prepared for the exclusive use of the NYSDEC for specific application to this site and this project only.

Documentation and preparation of this report were based upon Empire's understanding of the history and scope of work, as described herein, conditions noted during the inspection and through the application of Federal and New York State regulations pertaining to asbestos and lead including OSHA (29 CFR 1910.1001, 29 CFR 1926.1101 and 29 CFR 1926.62), EPA (40 CFR Part 61 and 40 CFR Part 745), and NYSDOL (12 NYCRR Part 56). The current property occupant granted access to the work site for Empire.

This report is limited to the conditions observed and to the information available at the time of the survey. Due to the nature of the work, there exists a possibility that there may be conditions which were not identified within the scope of work or which were not apparent at the time of the survey. This report may not represent all conditions at the subject site as it only reflects information gathered from specific locations at a specific time.

No other warranties, expressed or implied, are made.

If you have any questions or concerns, please contact our office at your convenience.

Sincerely,



David Steiner
Project Manager



Andrew Koons
NYSDOL Asbestos Inspector #14-05418

FIGURES

Figure No. 1 – Asbestos Sample Locations Map

Figure No. 2 – Lead Sample Location Map

TABLES

Table No. 1 – Summary of ACM Samples and Analytical Results

Table No. 2 – Summary of Lead Paint Samples and Analytical Results

ATTACHMENTS

Attachment 1 – Asbestos Analytical Results

Attachment 2 – Lead Paint Analytical Results

Attachment 3 – Laboratory and Personnel Certifications

FIGURES

Figure 1

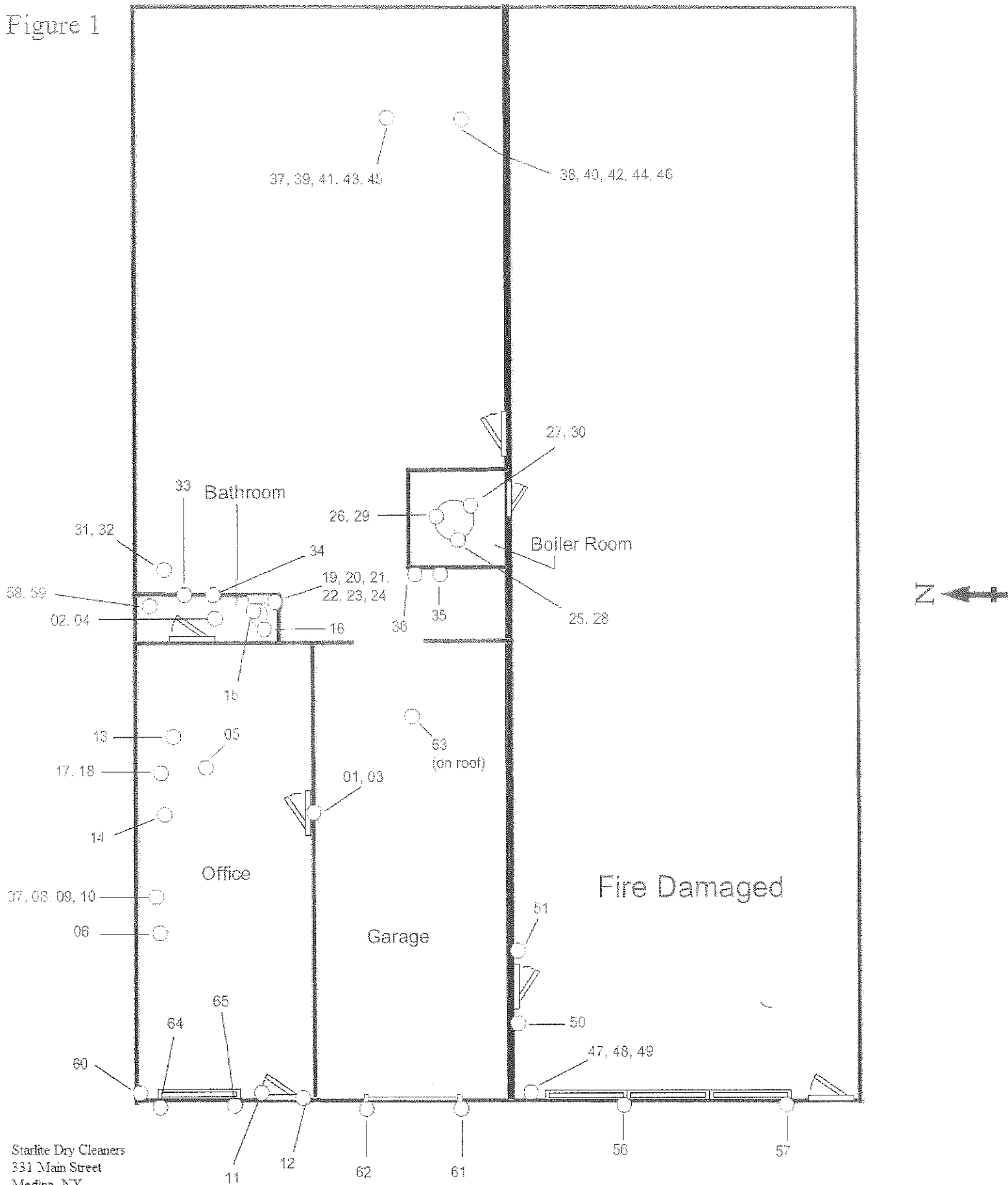

Starlite Dry Cleaners
331 Main Street
Medina, NY
ACM Sample Locations Map
September 22, 2015

Figure 2

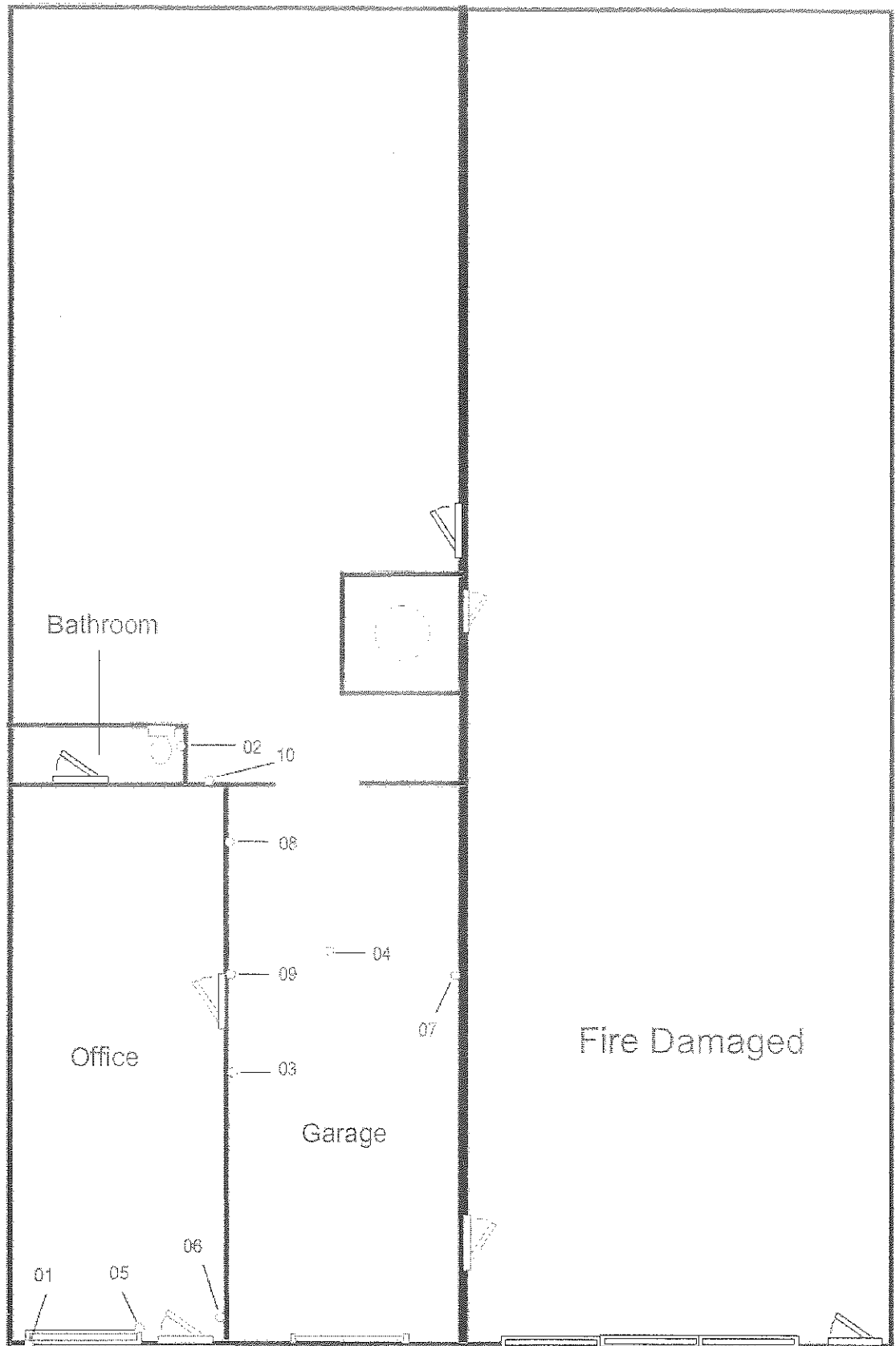

Starlite Dry Cleaners
331 Main Street
Medina, NY
LBP Sample Locations Map
September 22, 2015

TABLES

TABLE 1
SUMMARY OF ASBESTOS SAMPLES AND ANALYSIS RESULTS
331 Main Street
Medina, New York

Sample Number	Sample Description	Sample Location	Sample Analysis	Asbestos Content	Friability	Approximate Material Quantity
Star-01	9" x 9" Black Floor Tile	Entrance to Office	PLM	1.5%	Non-Friable	600 SF
Star-02	9" x 9" Black Floor Tile	Office Bathroom	PLM	NA/PS	Non-Friable	
Star-03	9" x 9" Black Floor Tile Underlayment	Entrance to Office	PLM/TEM	Trace	N/A	N/A
Star-04	9" x 9" Black Floor Tile Underlayment	Office Bathroom	PLM/TEM	Trace	N/A	N/A
Star-05	Smooth Ceiling Tile	Office	PLM/TEM	NAD	N/A	N/A
Star-06	Smooth Ceiling Tile	Office	PLM/TEM	Trace	N/A	N/A
Star-07	Pin Hole Ceiling Tile	Office	PLM/TEM	NAD	N/A	N/A
Star-08	Pin Hole Ceiling Tile	Office	PLM/TEM	NAD	N/A	N/A
Star-09	Pin Hole Ceiling Tile Mastic	Office	PLM/TEM	NAD	N/A	N/A
Star-10	Pin Hole Ceiling Tile Mastic	Office	PLM/TEM	NAD	N/A	N/A
Star-11	Door Window Glazing Compound	Office Front Door	PLM/TEM	Trace	N/A	N/A
Star-12	Door Window Glazing Compound	Office Front Door	PLM/TEM	Trace	N/A	N/A
Star-13	Ceiling Plaster Board	Office	PLM	NAD	N/A	N/A
Star-14	Ceiling Plaster Board	Office	PLM	NAD	N/A	N/A
Star-15	Drywall	Office Bathroom	PLM	NAD	N/A	N/A
Star-16	Drywall	Office Bathroom	PLM	NAD	N/A	N/A
Star-17	Canvas Paper	Office	PLM	57.1%	Friable	<10 SF
Star-18	Canvas Paper	Office	PLM	NA/PS	Friable	
Star-19	Pipe Insulation	Bathroom Interstitial Space	PLM	40.0%	Friable	<10 LF
Star-20	Pipe Insulation	Bathroom Interstitial Space	PLM	NA/PS	Friable	
Star-21	Pipe Insulation	Bathroom Interstitial Space	PLM	NA/PS	Friable	
Star-22	Mudded Fitting	Bathroom Interstitial Space	PLM	50.0%	Friable	3 Fittings
Star-23	Mudded Fitting	Bathroom Interstitial Space	PLM	NA/PS	Friable	

TABLE 1 (cont.)
SUMMARY OF ASBESTOS SAMPLES AND ANALYSIS RESULTS
331 Main Street
Medina, New York

Sample Number	Sample Description	Sample Location	Sample Analysis	Asbestos Content	Friability	Approximate Material Quantity
Star-24	Mudded Fitting	Bathroom Interstitial Space	PLM	NA/PS	Friable	3 Fittings
Star-25	Inner Boiler Tank Insulation	Boiler Room	PLM	NAD	N/A	N/A
Star-26	Inner Boiler Tank Insulation	Boiler Room	PLM	NAD	N/A	N/A
Star-27	Inner Boiler Tank Insulation	Boiler Room	PLM	NAD	N/A	N/A
Star-28	Outer Boiler Tank Insulation	Boiler Room	PLM	NAD	N/A	N/A
Star-29	Outer Boiler Tank Insulation	Boiler Room	PLM	NAD	N/A	N/A
Star-30	Outer Boiler Tank Insulation	Boiler Room	PLM	NAD	N/A	N/A
Star-31	Transite Pipe	Area behind Bathroom	PLM	22.3%	Non-Friable	30 LF
Star-32	Transite Pipe	Area behind Bathroom	PLM	NA/PS	Non-Friable	
Star-33	Paper on Batting Insulation w/ Tar	Bathroom	PLM	NAD	N/A	N/A
Star-34	Paper on Batting Insulation w/ Tar	Bathroom	PLM	NAD	N/A	N/A
Star-35	Tin and Paper on Batting Insulation	Above Boiler Room	PLM/TEM	Trace	N/A	N/A
Star-36	Tin and Paper on Batting Insulation	Above Boiler Room	PLM/TEM	Trace	N/A	N/A
Star-37	Rolled Roof Membrane and Backing	Roof	PLM/TEM	NAD	N/A	N/A
Star-38	Rolled Roof Membrane and Backing	Roof	PLM/TEM	NAD	N/A	N/A
Star-39	Roofing Shingle	Roof	PLM/TEM	NAD	N/A	N/A
Star-40	Roofing Shingle	Roof	PLM/TEM	NAD	N/A	N/A
Star-41	Tar Paper	Roof	PLM/TEM	Trace	N/A	N/A
Star-42	Tar Paper	Roof	PLM/TEM	Trace	N/A	N/A
Star-43	Built-up Roofing Material	Roof	PLM/TEM	Trace	N/A	N/A
Star-44	Built-up Roofing Material	Roof	PLM/TEM	Trace	N/A	N/A
Star-45	Tar Paper	Roof	PLM/TEM	NAD	N/A	N/A
Star-46	Tar Paper	Roof	PLM/TEM	NAD	N/A	N/A

TABLE 1 (cont.)
SUMMARY OF ASBESTOS SAMPLES AND ANALYSIS RESULTS
331 MAIN STREET
Medina, New York

Sample Number	Sample Description	Sample Location	Sample Analysis	Asbestos Content	Friability	Approximate Material Quantity
Star-47	Wire Insulation	Drycleaners Building (south)	PLM/TEM	NAD	N/A	N/A
Star-48	Wire Insulation	Drycleaners Building (south)	PLM/TEM	NAD	N/A	N/A
Star-49	Wire Insulation	Drycleaners Building (south)	PLM/TEM	NAD	N/A	N/A
Star-50	Wall Paper	Drycleaners Building (south)	PLM	NAD	N/A	N/A
Star-51	Wall Paper	Drycleaners building (south)	PLM	NAD	N/A	N/A
Star-52	Drywall	Drycleaners Building (south)	PLM	NAD	N/A	N/A
Star-53	Drywall	Drycleaners Building (south)	PLM	NAD	N/A	N/A
Star-54	Joint Compound	Drycleaners Building (south)	PLM	NAD	N/A	N/A
Star-55	Joint Compound	Drycleaners Building (south)	PLM	NAD	N/A	N/A
Star-56	Exterior Window Caulk	Drycleaners Front Window	PLM/TEM	NAD	N/A	N/A
Star-57	Exterior Window Caulk	Drycleaners Front Window	PLM/TEM	NAD	N/A	N/A
Star-58	Wrap on Ductwork (paper)	Above Office	PLM	50.0%	Friable	170 SF
Star-59	Wrap on Ductwork (paper)	Above Office	PLM	NA/PS	Friable	
Star-60	Tar associated w/ Flashing	Roof	PLM	NAD	N/A	350 LF
Star-61	Tar associated w/ Flashing	Roof	PLM	3.9%	Non-friable	
Star-62	Tar associated w/ Rolled Roofing	Roof	PLM/TEM	NAD	N/A	N/A
Star-63	Tar associated w/ Rolled Roofing	Roof	PLM/TEM	NAD	N/A	N/A
Star-64	Exterior Window Caulk	Office Front Window	PLM/TEM	Trace	N/A	N/A
Star-65	Exterior Window Caulk	Office Front Window	PLM/TEM	Trace	N/A	N/A

NOTES:

PLM = denotes Polarized Light Microscopy

NA/PS = not analyzed/positive stop

N/A = not applicable

TEM = denotes Transmission Electron Microscopy

NAD = denotes no asbestos detected above laboratory analytical detection limit

SF = square feet

LF = linear feet

TABLE 2
SUMMARY OF LEAD PAINT SAMPLES AND ANALYSIS RESULTS
331 MAIN STREET
Medina, New York

Sample Number	Sample Description	Sample Location	Result (mg/Kg)	Result (% by Wt.)
Burgundy Paint-01	Burgundy Paint	Exterior Window Frame	3700	0.37
Seafoam Paint-02	Seafoam Green Paint	Bathroom Wall	17000	1.70
DK Green Paint-03	Dark Green Paint	Garage Area Wall	7900	0.79
Black Paint-04	Black Paint	Garage Area Ceiling	200	0.02
Brown Paint-05	Brown Paint	Office Window Frame	65000	6.50
Green Paint-06	Green Paint	Office Drywall	110000	11.00
Lt Blue Paint-07	Light Blue Paint	Garage Area Wall	13000	1.30
Dk Blue Paint-08	Dark Blue Paint	Garage Area Wall	39000	3.9
Grey Paint-09	Grey Paint	Office Door Frame	680	0.07
White Paint-10	White Paint	Area behind Bathroom	1000	0.1

NOTES:

Paint is considered lead based if the concentration of lead is equal to or greater than 0.5% by weight.

ATTACHMENTS



Please Reply To:

AmeriSci Richmond

13635 GENITO ROAD
MIDLOTHIAN, VIRGINIA 23112
TEL: (804) 763-1200 • FAX: (804) 763-1800

FACSIMILE TELECOPY TRANSMISSION

To: Sherry O'Brien
SJB Services, Inc.
Fax #:
Email: akoons@sjbempire.net, sobrien@sjbempire.net

From: Donna M. Blackwell
AmeriSci Job #: 115092043
Subject: ELAP-PLM/TEM 5 day Results
Client Project: BEV-15-051; Starlite Cleaners;
331 Main St Medina, NY

Date: Monday, September 28, 2015
Time: 17:24:17

Number of Pages: 23
(including cover sheet)

Comments:

CONFIDENTIALITY NOTICE: Unless otherwise indicated, the information contained in this communication is confidential information intended for use of the individual named above. If the reader of this communication is not the intended recipient, you are hereby notified that any dissemination, distribution or copying of this communication is prohibited. If you have received this communication in error, please immediately notify the sender by telephone and return the original message to the above address via the US Postal Service at our expense. Samples are disposed of in 60 days or unless otherwise instructed by the protocol or special instructions in writing. Thank you.

Certified Analysis Service 24 Hours A Day • 7 Days A Week Competitive Prices
visit our web site - www.amerisci.com

Boston • Los Angeles • New York • Richmond

Table I
Summary of Bulk Asbestos Analysis Results
 BEV-15-051; Starlite Cleaners; 331 Main St Medina, NY

AmeriSci Sample #	Client Sample#	HG Area	Sample Weight (gram)	Heat Sensitive Organic %	Acid Soluble Inorganic %	Insoluble Non-Asbestos Inorganic %	** Asbestos % by PLM/DS	** Asbestos % by TEM
01	Star-01	1	0.283	25.7	67.0	5.8	Chrysotile 1.5	NA
Location: Entrance To North Office; Black 9x9 Floor Tile								
02	Star-02	1	0.299	25.2	33.4	41.4	NA/PS	NA
Location: Bathroom Off Office; Black 9x9 Floor Tile								
03	Star-03	2	0.196	87.1	1.1	11.7	NAD	Chrysotile Trace
Location: Entrance To North Office; Black 9x9 Floor Tile Underlayment								
04	Star-04	2	0.268	82.2	-1.0	18.8	NAD	Chrysotile Trace
Location: Bathroom Off Office; Black 9x9 Floor Tile Underlayment								
05	Star-05	3	0.255	93.3	1.1	5.6	NAD	NAD
Location: North Office; Smooth Ceiling Tile								
06	Star-06	3	0.308	80.9	2.2	16.8	NAD	Chrysotile Trace
Location: North Office; Smooth Ceiling Tile								
07	Star-07	4	0.205	94.3	0.7	5.0	NAD	NAD
Location: North Office; Pin Hole Ceiling Tile								
08	Star-08	4	0.248	75.8	8.4	15.7	NAD	NAD
Location: North Office; Pin Hole Ceiling Tile								
09	Star-09	5	0.236	51.9	-0.1	48.2	NAD	NAD
Location: North Office; Pin Hole Ceiling Tile Mastic								
10	Star-10	5	0.495	48.4	-2.2	53.9	NAD	NAD
Location: North Office; Pin Hole Ceiling Tile Mastic								
11	Star-11	6	0.105	23.6	46.1	30.2	NAD	Chrysotile Trace
Location: North Office Man Door; Door Window Glazing Compound								
12	Star-12	6	0.211	31.0	50.0	18.9	Chrysotile <0.25	Chrysotile Trace
Location: North Office Man Door; Door Window Glazing Compound								
13	Star-13	7	----	----	----	----	NAD	NA
Location: North Office Ceiling; Plaster Board								
14	Star-14	7	----	----	----	----	NAD	NA
Location: North Office Ceiling; Plaster Board								
15	Star-15	8	----	----	----	----	NAD	NA
Location: North Office Bathroom; Drywall								
16	Star-16	8	----	----	----	----	NAD	NA
Location: North Office Bathroom; Drywall								

Table I
Summary of Bulk Asbestos Analysis Results
 BEV-15-051; Starlite Cleaners; 331 Main St Medina, NY

AmeriSci Sample #	Client Sample#	HG Area	Sample Weight (gram)	Heat Sensitive Organic %	Acid Soluble Inorganic %	Insoluble Non-Asbestos Inorganic %	** Asbestos % by PLM/DLS	** Asbestos % by TEM
17	Star-17	9	---	---	---	---	Chrysotile 57.1	NA
Location: North Office; Canvas Paper								
18	Star-18	9	---	---	---	---	NA/PS	NA
Location: North Office; Canvas Paper								
19	Star-19	10	---	---	---	---	Chrysotile 40.0	NA
Location: Bathroom Interstitial Space; Pipe Insulation								
20	Star-20	10	---	---	---	---	NA/PS	NA
Location: Bathroom Interstitial Space; Pipe Insulation								
21	Star-21	10	---	---	---	---	NA/PS	NA
Location: Bathroom Interstitial Space; Pipe Insulation								
22	Star-22	11	---	---	---	---	Chrysotile 50.0	NA
Location: Bathroom Interstitial Space; Mudded Fitting								
23	Star-23	11	---	---	---	---	NA/PS	NA
Location: Bathroom Interstitial Space; Mudded Fitting								
24	Star-24	11	---	---	---	---	NA/PS	NA
Location: Bathroom Interstitial Space; Mudded Fitting								
25	Star-25	12	---	---	---	---	NAD	NA
Location: Boiler Room; Inner Boiler Tank Insulation								
26	Star-26	12	---	---	---	---	NAD	NA
Location: Boiler Room; Inner Boiler Tank Insulation								
27	Star-27	12	---	---	---	---	NAD	NA
Location: Boiler Room; Inner Boiler Tank Insulation								
28	Star-28	13	---	---	---	---	NAD	NA
Location: Boiler Room; Outer Boiler Tank Insulation								
29	Star-29	13	---	---	---	---	NAD	NA
Location: Boiler Room; Outer Boiler Tank Insulation								
30	Star-30	13	---	---	---	---	NAD	NA
Location: Boiler Room; Outer Boiler Tank Insulation								
31	Star-31	14	---	---	---	---	Crocidolite 5.6	NA
Location: Behind Bathroom; Transite Pipe								
32	Star-32	14	---	---	---	---	Chrysotile 16.7	NA
Location: Behind Bathroom; Transite Pipe								

See Reporting notes on last page

Table 1
Summary of Bulk Asbestos Analysis Results
 BEV-15-051; Starlite Cleaners; 331 Main St Medina, NY

AmeriSci Sample #	Client Sample#	HG Area	Sample Weight (gram)	Heat Sensitive Organic %	Acid Soluble Inorganic %	Insoluble Non-Asbestos Inorganic %	** Asbestos % by PLM/DS	** Asbestos % by TEM
33	Star-33	15	----	----	----	----	NAD	NA
Location: Bathroom Wall; Paper On Batting Insulation W/ Tar								
34	Star-34	15	----	----	----	----	NAD	NA
Location: Bathroom Wall; Paper On Batting Insulation W/ Tar								
35	Star-35	16	0.061	95.4	0.8	3.7	NAD	Chrysotile Trace
Location: Above Boiler Room; Tin & Paper On Batting Insulation								
36	Star-36	16	0.095	76.8	0.7	22.4	NAD	Chrysotile Trace
Location: Above Boiler Room; Tin & Paper On Batting Insulation								
37	Star-37	17	0.326	68.8	1.8	29.3	NAD	NAD
Location: Roof; Rolled Roofing Membrane & Backing								
38	Star-38	17	0.170	72.8	1.7	25.5	NAD	NAD
Location: Roof; Rolled Roofing Membrane & Backing								
39	Star-39	18	0.226	47.1	19.1	33.8	NAD	NAD
Location: Roof; Roofing Shingle								
40	Star-40	18	0.159	81.4	-0.1	16.7	NAD	NAD
Location: Roof; Roofing Shingle								
41	Star-41	19	0.181	81.8	5.0	13.1	NAD	Chrysotile Trace
Location: Roof (Under Shingle); Tar Paper								
42	Star-42	19	0.172	84.3	6.3	9.4	NAD	Chrysotile Trace
Location: Roof (Under Shingle); Tar Paper								
43	Star-43	20	0.200	62.8	4.5	32.6	NAD	Chrysotile Trace
Location: Roof; Built Up Roofing Material								
44	Star-44	20	0.217	63.4	5.9	30.6	NAD	Chrysotile Trace
Location: Roof; Built Up Roofing Material								
45	Star-45	21	0.170	86.7	0.4	12.8	NAD	NAD
Location: Roof (Under Built Up Roofing); Tar Paper								
46	Star-46	21	0.232	81.4	3.4	15.2	NAD	NAD
Location: Roof (Under Built Up Roofing); Tar Paper								
47	Star-47	22	0.089	68.6	15.8	15.6	NAD	NAD
Location: Drycleaners Building (South); Wire Insulation								
48	Star-48	22	0.330	55.6	16.6	27.8	NAD	NAD
Location: Drycleaners Building (South); Wire Insulation								

Table I
Summary of Bulk Asbestos Analysis Results
 BEV-15-051; Starfile Cleaners; 331 Main St Medina, NY

AmeriSci Sample #	Client Sample#	HG Area	Sample Weight (gram)	Heat Sensitive Organic %	Acid Soluble Inorganic %	Insoluble Non-Asbestos Inorganic %	** Asbestos % by PLM/DS	** Asbestos % by TEM	
49	Star-49	22	0.050	80.8	1.2	18.0	NAD	NAD	
	Location: Drycleaners Building (South); Wire Insulation								
50	Star-50	23	----	----	----	----	NAD	NA	
	Location: Drycleaners Building (South); Wall Paper								
51	Star-51	23	----	----	----	----	NAD	NA	
	Location: Drycleaners Building (South); Wall Paper								
52	Star-52	24	----	----	----	----	NAD	NA	
	Location: Drycleaners Building (South); Drywall								
53	Star-53	24	----	----	----	----	NAD	NA	
	Location: Drycleaners Building (South); Drywall								
54	Star-54	25	----	----	----	----	NAD	NA	
	Location: Drycleaners Building (South); Joint Compound								
55	Star-55	25	----	----	----	----	NAD	NA	
	Location: Drycleaners Building (South); Joint Compound								
56	Star-56	26	0.261	44.4	51.1	4.5	NAD	NAD	
	Location: Drycleaners Front Window; Exterior Window Caulk								
57	Star-57	26	0.405	42.9	52.4	4.7	NAD	NAD	
	Location: Drycleaners Front Window; Exterior Window Caulk								
58	Star-58	27	----	----	----	----	Chrysotile 50.0	NA	
	Location: Above Office; Wrap On Ductwork (Paper)								
59	Star-59	27	----	----	----	----	NA/PS	NA	
	Location: Above Office; Wrap On Ductwork (Paper)								
60	Star-60	28	0.189	84.5	1.5	14.0	NAD	NA	
	Location: Roof; Tar Associated W/ Flashing								
61	Star-61	28	0.167	76.8	3.7	15.6	Chrysotile 3.9	NA	
	Location: Roof; Tar Associated W/ Flashing								
62	Star-62	29	0.203	82.3	1.4	16.3	NAD	NAD	
	Location: Roof; Tar Associated W/ Rolled Roofing								
63	Star-63	29	0.343	81.0	2.6	16.4	NAD	NAD	
	Location: Roof; Tar Associated W/ Rolled Roofing								
64	Star-64	30	0.217	27.0	66.5	6.4	NAD	Tremolite Trace	
	Location: Office Front Window; Exterior Window Caulk								

AmeriSci Job #: 115092043
 Client Name: SJB Services, Inc.

Table I
Summary of Bulk Asbestos Analysis Results
 BEV-15-051; Starlite Cleaners; 331 Main St Medina, NY

AmeriSci Sample #	Client Sample#	HG Area	Sample Weight (gram)	Heat Sensitive Organic %	Acid Soluble Inorganic %	Insoluble Non-Asbestos Inorganic %	** Asbestos % by PLM/DS	** Asbestos % by TEM
65	Stat-65	30	0.376	27.0	63.1	9.8	NAD	Tremolite Trace

Location: Office Front Window, Exterior Window Caulk

Reviewed by:  Date Reviewed: 9/29/15 Analyzed By: Beverly A. Schrage Date Analyzed: 9/29/2015

Semi-Quantitative Analysis: NAD = no asbestos detected; NA = not analyzed; NAI/PS = not analyzed due to positive stop; Trace = <1%; PLM analysis by EPA 600/R-93/116 per 40 CFR 763 (NVLAP Lab Code 101904-0) or NY ELAP 198.1 for New York friable samples which includes quantitation of any vermiculite observed (198.6 for NOB samples) or EPA 400 pt ct by EPA 600/M4-82-020 (NY ELAP Lab # 10984); TEM analysis by EPA 600/R-93/116 (not covered by NVLAP Bulk accreditation); or NY ELAP 198.4 for New York NOB samples (NY ELAP Lab # 10984);

** Warning Notes: Consider PLM fiber diameter limitation, only TEM will resolve fibers <0.25 micrometers in diameter. TEM bulk analysis is representative of the fine grained matrix material and may not be representative of non-uniformly dispersed debris, soils or other heterogeneous materials for which a combination PLM/TEM evaluation is recommended; Quantitation for beginning weights of <0.1 grams should be considered as qualitative only.

BULK CHAIN OF CUSTODY



AMERISCI RICHMOND
13635 GENITO ROAD
MIDLOTHIAN, VA 23112
TOLL FREE: (800) 476-5227
PHONE: (804) 763-1200
FAX: (804) 763-1800

WWW.AMERISCI.COM

Relinquished By: Carolee Kay Date/Time: 9/25/15
 Received By: _____ Date/Time: _____
 Relinquished By: _____ Date/Time: _____
 Received By: _____ Date/Time: _____

Company: Empire Geo-Services, Inc.
 Street Address: 5167 South Park Ave
 City: Hambuda State: NY Zip: 14075
 Phone: 716.649.8888 Fax: 716.649.8051
 Cell: 5410 Fax: _____
 E-mail: _____ Verbal Results: Y / N
 Results to: akoons@sbempire.net
 Special Instructions or Comments:

Project: Starlite Cleaners AMERISCI #: 115092048
 Proj Mgr: Dave Steiner (Andrew Koons) Proj #: BEV-15-051
 Proj Address: 33 Main St Medina Proj State: NY
 Analysis: XPLM; Positive Stop; XTEM; NY ELAP PLM/TEM w/ NOB Prep.
 ASTM Dust (Microvac) (Wipe): _____ Qualitative: _____ Other (describe in comments)
 Turnaround Time: 5 Day Material Type: Bulk Dust Water
 Sampled By: A. Koons Date Sampled: 9/23/15

Lab ID	Field ID	Location	Sample Description (dust area)	Homogenous Area
	Star-01	Entrance to North office	Black 9x9 floor tile	
	Star-02	Bathroom off office	Black 9x9 floor tile	
	Star-03	Entrance to North office	Black 9x9 floor tile underlayment	
	Star-04	Bathroom off office	Black 9x9 floor tile underlayment	
	-05	Smooth North office	Smooth ceiling tile	
	-06	North office	Smooth ceiling tile	
	-07	North office	Pin Hole ceiling tile	
	-08	North office	Pin Hole ceiling tile	
	-09	North office	Pin Hole ceiling tile	
	-10	North office	Pin Hole ceiling tile Mastic	
	-11	North office man door	Pin Hole ceiling tile Mastic	
	-12	North office man door	Door window glazing compound	
	-13	North office ceiling	Door window glazing compound	
	-14	North office ceiling	Plaster Board	
	-15	North office Bathroom	Plaster Board	
	-16	North office Bathroom	Dry wall	
	-17	North office	Dry wall	
			Canvas Paper	

RECEIVED
 SEP 25 2015
 BY: [Signature] (m of 1)

BULK CHAIN OF CUSTODY

AMERISCI RICHMOND
13635 GENITO ROAD
MIDDLEBURY, VA 23112
TOLL FREE: (800) 476-5227
PHONE: (804) 763-1200
FAX: (804) 763-1800



WWW.AMERISCI.COM

Relinquished By: Andrew Kosob Date/Time: 9/23/15
 Received By: _____ Date/Time: _____
 Relinquished By: _____ Date/Time: _____
 Received By: _____ Date/Time: _____

Company: Empire Geo-Services, Inc.
 Street Address: 5167 South Park Ave
 City: Amberg State: NY Zip: 14075
 Phone: 716.649.8051 Fax: 716.649.8051
 Cell: 910 Fax: _____
 E-mail: _____ Verbal Results: Y / N
 Results to: A Kosob Site sample: not
 Special Instructions or Comments: _____

Project: Starlite Cleaners AMERISCI #: 115092048
 Proj Mgr: Dave Steiner (A. Kosob) Proj #: BEV-15-051
 Proj Address: 331 Main St Medina Proj State: NY
 Analysis: PLM; TEM; NY ELAP PLM/TEM w/ NOB Prep.
 ASTM Dust (Microvac) (Wipe): _____ Qualitative: _____ Other (describe in comments) _____
 Turnaround Time: 5 day Material Type: Bulk Dust Water
 Sampled By: A. Kosob Date Sampled: 9/22/15

Lab ID	Field ID	Location	Sample Description (dust area)	Homogenous Area
	Star-18	North office	Canvas Paper	
	-19	Bathroom interstitial Space	Pipe insulation	
	-20	Bathroom interstitial Space	Pipe insulation	
	-21	Bathroom interstitial Space	Muddled fitting	
	-22	Bathroom interstitial Space	Muddled fitting	
	-23	Bathroom interstitial Space	Muddled fitting	
	-24	Bathroom interstitial Space	Muddled fitting	
	-25	Boiler Room	Inner Boiler tank insulation	
	-26	Boiler Room	Inner Boiler tank insulation	
	-27	Boiler Room	Inner Boiler tank insulation	
	-28	Boiler Room	Outer Boiler tank insulation	
	-29	Boiler Room	Outer Boiler tank insulation	
	-30	Boiler Room	Outer Boiler tank insulation	
	-31	Behind Bathroom	Transite Pipe	
	-32	Behind Bathroom	Transite Pipe	
	-33	Bathroom wall	Paper on Bathing insulation w/ tar	
	-34	Bathroom wall	Paper on Bathing insulation w/ tar	

RECEIVED
 SEP 25 2015
 BY: _____

BULK CHAIN OF CUSTODY

AMERISCI RICHMOND
 13635 GENITO ROAD
 MIDLOTHIAN, VA 23112
 Toll Free: (800) 476-5227
 Phone: (804) 763-1200
 Fax: (804) 763-1800



WWW.AMERISCI.COM

Relinquished By: Andrew Koenig Date/Time: 9/23/15
 Received By: _____ Date/Time: _____
 Relinquished By: _____ Date/Time: _____
 Received By: _____ Date/Time: _____

Company: Empire Geo-Services, Inc. AMERISCI #: 115092043
 Street Address: 5167 South Park Ave Project: Star like Dry Cleaners
 City: Hampton State: NY Zip: 14075 Proj Mgr: Dave Steiner (Andrew Koenig) Proj #: DEU-15-051
 Phone: 716.649.2081 Fax: 716.649.2051 Proj Address: 331 Main St Medina Proj State: NY
 Cell: 8110 Fax: _____ Analysis: SEM; X Positive Stop; TEM; X NY ELAP PLM/TEM w/ NOB Prep.
 E-mail: _____ Verbal Results: Y / N ASTM Dust (Microvac) (Wipe): _____ Qualitative: _____ Other (describe in comments)
 Results to: a.koenig@sjbempire.net Turnaround Time: 5 Day Material Type: A Bulk Dust Water
 Special Instructions or Comments: _____ Sampled By: A. Koenig Date Sampled: 9/23/15

Lab ID	Field ID	Location	Sample Description (dust area)	Homogenous Area
	Star-52	Drycleaners Building (south)	Drywall	
	-53	Drycleaners Building (south)	Drywall	
	-54	Drycleaners Building (south)	Joint compound	
	-55	Drycleaners Building (south)	Joint compound	
	-56	Drycleaners front window	Exterior window caulk	
	-57	Drycleaners front window	Exterior window caulk	
	-58	Above office	Wrap on ductwork (paper)	
	-59	Above office	Wrap on ductwork (paper)	
	-60	Roof	Tar associated w/ flashing	
	-61	Roof	Tar associated w/ flashing	
	-62	Roof	Tar associated w/ rolled roofing	
	-63	Roof	Tar associated w/ rolled roofing	
	-64	Office Front window	Exterior window caulk	
	-65	Office Front window	Exterior window caulk	

RECEIVED
 SEP 25 2015
 BY: _____



AmeriSci Richmond

13635 GENITO ROAD
MIDLOTHIAN, VIRGINIA 23112
TEL: (804) 763-1200 • FAX: (804) 763-1800

PLM Bulk Asbestos Report

SJB Services, Inc.
Attn: Sherry O'Brien
60 Miller Street

Cortland, NY 13045

Date Received 09/25/15 AmeriSci Job # 115092043
Date Examined 09/28/15 P.O. #
ELAP # 10984 Page 1 of 13
RE: BEV-15-051; Starlite Cleaners; 331 Main St Medina, NY

Client No. / HGA	Lab No.	Asbestos Present	Total % Asbestos
Star-01 1	115092043-01 Location: Entrance To North Office; Black 9x9 Floor Tile	Yes	1.5 % (by NYS ELAP 198.6) by Donna M. Blackwell on 09/28/15
Analyst Description: Black, Heterogeneous, Non-Fibrous, Bulk Material Asbestos Types: Chrysotile 1.5 % Other Material: Non-fibrous 5.8 % Comment: Heat Sensitive (organic): 25.7%; Acid Soluble (inorganic): 67.0%; Inert (Non-asbestos): 5.8%			
Star-02 1	115092043-02 Location: Bathroom Off Office; Black 9x9 Floor Tile		NA/PS
Analyst Description: Bulk Material Asbestos Types: Other Material: Comment: Heat Sensitive (organic): 25.2%; Acid Soluble (inorganic): 33.4%; Inert (Non-asbestos): 41.4%			
Star-03 2	115092043-03 Location: Entrance To North Office; Black 9x9 Floor Tile Underlayment	No	NAD (by NYS ELAP 198.6) by Donna M. Blackwell on 09/28/15
Analyst Description: Black, Heterogeneous, Non-Fibrous, Bulk Material Asbestos Types: Other Material: Non-fibrous 11.8 % Comment: Heat Sensitive (organic): 87.1%; Acid Soluble (inorganic): 1.1%; Inert (Non-asbestos): 11.8%			
Star-04 2	115092043-04 Location: Bathroom Off Office; Black 9x9 Floor Tile Underlayment	No	NAD (by NYS ELAP 198.6) by Donna M. Blackwell on 09/28/15
Analyst Description: Black, Heterogeneous, Non-Fibrous, Bulk Material Asbestos Types: Other Material: Non-fibrous 18.9 % Comment: Heat Sensitive (organic): 82.2%; Acid Soluble (inorganic): -1.0%; Inert (Non-asbestos): 18.9%			

Client Name: SJB Services, Inc.

PLM Bulk Asbestos Report

BEV-15-051; Starlite Cleaners; 331 Main St Medina, NY

Client No. / HGA	Lab No.	Asbestos Present	Total % Asbestos
Star-05 3	115092043-05 Location: North Office; Smooth Ceiling Tile	No	NAD (by NYS ELAP 198.6) by Donna M. Blackwell on 09/28/15
Analyst Description: White/Tan, Heterogeneous, Non-Fibrous, Bulk Material Asbestos Types: Other Material: Non-fibrous 5.6 % Comment: Heat Sensitive (organic): 93.3%; Acid Soluble (inorganic): 1.1%; Inert (Non-asbestos): 5.6%			
Star-06 3	115092043-06 Location: North Office; Smooth Ceiling Tile	No	NAD (by NYS ELAP 198.6) by Donna M. Blackwell on 09/28/15
Analyst Description: White/Tan, Heterogeneous, Non-Fibrous, Bulk Material Asbestos Types: Other Material: Non-fibrous 16.9 % Comment: Heat Sensitive (organic): 80.9%; Acid Soluble (inorganic): 2.2%; Inert (Non-asbestos): 16.9%			
Star-07 4	115092043-07 Location: North Office; Pin Hole Ceiling Tile	No	NAD (by NYS ELAP 198.6) by Donna M. Blackwell on 09/28/15
Analyst Description: White/Tan, Heterogeneous, Non-Fibrous, Bulk Material Asbestos Types: Other Material: Non-fibrous 5 % Comment: Heat Sensitive (organic): 94.3%; Acid Soluble (inorganic): 0.7%; Inert (Non-asbestos): 5.0%			
Star-08 4	115092043-08 Location: North Office; Pin Hole Ceiling Tile	No	NAD (by NYS ELAP 198.6) by Donna M. Blackwell on 09/28/15
Analyst Description: White/Tan, Heterogeneous, Non-Fibrous, Bulk Material Asbestos Types: Other Material: Non-fibrous 15.7 % Comment: Heat Sensitive (organic): 75.8%; Acid Soluble (inorganic): 8.4%; Inert (Non-asbestos): 15.7%			
Star-09 5	115092043-09 Location: North Office; Pin Hole Ceiling Tile Mastic	No	NAD (by NYS ELAP 198.6) by Donna M. Blackwell on 09/28/15
Analyst Description: Brown, Heterogeneous, Non-Fibrous, Bulk Material Asbestos Types: Other Material: Non-fibrous 48.2 % Comment: Heat Sensitive (organic): 51.9%; Acid Soluble (inorganic): -0.1%; Inert (Non-asbestos): 48.2%			

Client Name: SJB Services, Inc.

PLM Bulk Asbestos Report

BEV-15-051; Starlite Cleaners; 331 Main St Medina, NY

Client No. / HGA	Lab No.	Asbestos Present	Total % Asbestos
Star-10 5	115092043-10	No	NAD
Location: North Office; Pin Hole Ceiling Tile Mastic			(by NYS ELAP 198.6) by Donna M. Blackwell on 09/28/15
Analyst Description: Brown, Heterogeneous, Non-Fibrous, Bulk Material			
Asbestos Types:			
Other Material: Non-fibrous 53.9 %			
Comment: Heat Sensitive (organic): 48.4%; Acid Soluble (inorganic): -2.2%; Inert (Non-asbestos): 53.9%			
Star-11 6	115092043-11	No	NAD
Location: North Office Man Door; Door Window Glazing Compound			(by NYS ELAP 198.6) by Donna M. Blackwell on 09/28/15
Analyst Description: White, Heterogeneous, Non-Fibrous, Bulk Material			
Asbestos Types:			
Other Material: Non-fibrous 30.3 %			
Comment: Heat Sensitive (organic): 23.6%; Acid Soluble (inorganic): 46.1%; Inert (Non-asbestos): 30.3%			
Star-12 6	115092043-12	Yes	Trace (<0.25 % pc)
Location: North Office Man Door; Door Window Glazing Compound			(EPA 400 PC) by Donna M. Blackwell on 09/28/15
Analyst Description: White, Heterogeneous, Non-Fibrous, Bulk Material			
Asbestos Types: Chrysotile <0.25 % pc			
Other Material: Non-fibrous 18.9 %			
Comment: Heat Sensitive (organic): 31.0%; Acid Soluble (inorganic): 50.0%; Inert (Non-asbestos): 18.9%			
Star-13 7	115092043-13	No	NAD
Location: North Office Ceiling; Plaster Board			(by NYS ELAP 198.1) by Donna M. Blackwell on 09/28/15
Analyst Description: White, Heterogeneous, Non-Fibrous, Bulk Material			
Asbestos Types:			
Other Material: Cellulose 12 %, Non-fibrous 88 %			
Star-14 7	115092043-14	No	NAD
Location: North Office Ceiling; Plaster Board			(by NYS ELAP 198.1) by Donna M. Blackwell on 09/28/15
Analyst Description: White/Brown, Heterogeneous, Fibrous, Bulk Material			
Asbestos Types:			
Other Material: Cellulose 12 %, Non-fibrous 88 %			

PLM Bulk Asbestos Report

BEV-15-051; Starlite Cleaners; 331 Main St Medina, NY

Client No. / HGA	Lab No.	Asbestos Present	Total % Asbestos
Star-15 8	115092043-15 Location: North Office Bathroom; Drywall	No	NAD (by NYS ELAP 198.1) by Donna M. Blackwell on 09/28/15
Analyst Description: Gray, Heterogeneous, Fibrous, Bulk Material Asbestos Types: Other Material: Cellulose 10 %, Non-fibrous 90 %			
Star-16 8	115092043-16 Location: North Office Bathroom; Drywall	No	NAD (by NYS ELAP 198.1) by Donna M. Blackwell on 09/28/15
Analyst Description: Off-White/Brown, Heterogeneous, Fibrous, Bulk Material Asbestos Types: Other Material: Cellulose 12 %, Non-fibrous 88 %			
Star-17 9	115092043-17 Location: North Office; Canvas Paper	Yes	57.1 % (by NYS ELAP 198.1) by Donna M. Blackwell on 09/28/15
Analyst Description: Gray, Heterogeneous, Fibrous, Bulk Material Asbestos Types: Chrysotile 57.1 % Other Material: Cellulose 20 %, Non-fibrous 22.9 %			
Star-18 9	115092043-18 Location: North Office; Canvas Paper		NA/PS
Analyst Description: Bulk Material Asbestos Types: Other Material:			
Star-19 10	115092043-19 Location: Bathroom Interstitial Space; Pipe Insulation	Yes	40 % (by NYS ELAP 198.1) by Donna M. Blackwell on 09/28/15
Analyst Description: White, Heterogeneous, Fibrous, Bulk Material Asbestos Types: Chrysotile 40.0 % Other Material: Cellulose 60 %			
Star-20 10	115092043-20 Location: Bathroom Interstitial Space; Pipe Insulation		NA/PS
Analyst Description: Bulk Material Asbestos Types: Other Material:			

PLM Bulk Asbestos Report

BEV-15-051; Starlite Cleaners; 331 Main St Medina, NY

Client No. / HGA	Lab No.	Asbestos Present	Total % Asbestos
Star-21 10	115092043-21 Location: Bathroom Interstitial Space; Pipe Insulation		NA/PS
Analyst Description: Bulk Material Asbestos Types: Other Material:			
Star-22 11	115092043-22 Location: Bathroom Interstitial Space; Mudded Fitting	Yes	50 % (by NYS ELAP 198.1) by Donna M. Blackwell on 09/28/15
Analyst Description: Gray, Heterogeneous, Fibrous, Bulk Material Asbestos Types: Chrysotile 50.0 % Other Material: Non-fibrous 50 %			
Star-23 11	115092043-23 Location: Bathroom Interstitial Space; Mudded Fitting		NA/PS
Analyst Description: Bulk Material Asbestos Types: Other Material:			
Star-24 11	115092043-24 Location: Bathroom Interstitial Space; Mudded Fitting		NA/PS
Analyst Description: Bulk Material Asbestos Types: Other Material:			
Star-25 12	115092043-25 Location: Boiler Room; Inner Boiler Tank Insulation	No	NAD (by NYS ELAP 198.1) by Donna M. Blackwell on 09/28/15
Analyst Description: Brown/White, Heterogeneous, Non-Fibrous, Cementitious, Bulk Material Asbestos Types: Other Material: Non-fibrous 100 %			
Star-26 12	115092043-26 Location: Boiler Room; Inner Boiler Tank Insulation	No	NAD (by NYS ELAP 198.1) by Donna M. Blackwell on 09/28/15
Analyst Description: Brown/White, Homogeneous, Non-Fibrous, Cementitious, Bulk Material Asbestos Types: Other Material: Non-fibrous 100 %			

PLM Bulk Asbestos Report

BEV-15-051; Starlite Cleaners; 331 Main St Medina, NY

Client No. / HGA	Lab No.	Asbestos Present	Total % Asbestos
Star-27 12	115092043-27 Location: Boiler Room; Inner Boiler Tank Insulation	No	NAD (by NYS ELAP 198.1) by Donna M. Blackwell on 09/28/15
Analyst Description: Brown/White, Homogeneous, Non-Fibrous, Cementitious, Bulk Material Asbestos Types: Other Material: Non-fibrous 100 %			
Star-28 13	115092043-28 Location: Boiler Room; Outer Boiler Tank Insulation	No	NAD (by NYS ELAP 198.1) by Donna M. Blackwell on 09/28/15
Analyst Description: Beige, Heterogeneous, Fibrous, Bulk Material Asbestos Types: Other Material: Non-fibrous 100 %			
Star-29 13	115092043-29 Location: Boiler Room; Outer Boiler Tank Insulation	No	NAD (by NYS ELAP 198.1) by Donna M. Blackwell on 09/28/15
Analyst Description: Tan-Orange, Heterogeneous, Fibrous, Bulk Material Asbestos Types: Other Material: Fibrous glass 100 %			
Star-30 13	115092043-30 Location: Boiler Room; Outer Boiler Tank Insulation	No	NAD (by NYS ELAP 198.1) by Donna M. Blackwell on 09/28/15
Analyst Description: Beige, Heterogeneous, Non-Fibrous, Bulk Material Asbestos Types: Other Material: Non-fibrous 100 %			
Star-31 14	115092043-31 Location: Behind Bathroom; Transite Pipe	Yes	22.2 % (by NYS ELAP 198.1) by Donna M. Blackwell on 09/28/15
Analyst Description: Gray, Heterogeneous, Fibrous, Cementitious, Bulk Material Asbestos Types: Crocidolite 5.6 %, Chrysotile 16.7 % Other Material: Non-fibrous 77.8 %			
Star-32 14	115092043-32 Location: Behind Bathroom; Transite Pipe		NA/PS
Analyst Description: Bulk Material Asbestos Types: Other Material:			

PLM Bulk Asbestos Report

BEV-15-051; Starlite Cleaners; 331 Main St Medina, NY

Client No. / HGA	Lab No.	Asbestos Present	Total % Asbestos
Star-33 15	115092043-33 Location: Bathroom Wall; Paper On Batting Insulation W/ Tar	No	NAD (by NYS ELAP 198.1) by Donna M. Blackwell on 09/28/15
<p>Analyst Description: Brown, Heterogeneous, Fibrous, Bulk Material Asbestos Types: Other Material: Cellulose 90, Non-fibrous 10</p>			
Star-34 15	115092043-34 Location: Bathroom Wall; Paper On Batting Insulation W/ Tar	No	NAD (by NYS ELAP 198.1) by Donna M. Blackwell on 09/28/15
<p>Analyst Description: Brown/Black, Heterogeneous, Fibrous, Bulk Material Asbestos Types: Other Material: Cellulose 90 %, Non-fibrous 10 %</p>			
Star-35 16	115092043-35 Location: Above Boiler Room; Tin & Paper On Batting Insulation	No	NAD (by NYS ELAP 198.6) by Donna M. Blackwell on 09/28/15
<p>Analyst Description: Black/Brown, Heterogeneous, Non-Fibrous, Bulk Material Asbestos Types: Other Material: Non-fibrous 3.8 % Comment: Heat Sensitive (organic): 95.4%; Acid Soluble (inorganic): 0.8%; Inert (Non-asbestos): 3.8%</p>			
Star-36 16	115092043-36 Location: Above Boiler Room; Tin & Paper On Batting Insulation	No	NAD (by NYS ELAP 198.6) by Donna M. Blackwell on 09/28/15
<p>Analyst Description: Black/Brown, Heterogeneous, Non-Fibrous, Bulk Material Asbestos Types: Other Material: Non-fibrous 22.5 % Comment: Heat Sensitive (organic): 76.8%; Acid Soluble (inorganic): 0.7%; Inert (Non-asbestos): 22.5%</p>			
Star-37 17	115092043-37 Location: Roof; Rolled Roofing Membrane & Backing	No	NAD (by NYS ELAP 198.6) by Donna M. Blackwell on 09/28/15
<p>Analyst Description: Black, Heterogeneous, Non-Fibrous, Bulk Material Asbestos Types: Other Material: Non-fibrous 29.3 % Comment: Heat Sensitive (organic): 68.8%; Acid Soluble (inorganic): 1.8%; Inert (Non-asbestos): 29.3%</p>			

PLM Bulk Asbestos Report

BEV-15-051; Starlite Cleaners; 331 Main St Medina, NY

Client No. / HGA	Lab No.	Asbestos Present	Total % Asbestos
Star-38 17	115092043-38 Location: Roof; Rolled Roofing Membrane & Backing	No	NAD (by NYS ELAP 198.6) by Donna M. Blackwell on 09/28/15
Analyst Description: Black, Heterogeneous, Non-Fibrous, Bulk Material Asbestos Types: Other Material: Non-fibrous 25.5 % Comment: Heat Sensitive (organic): 72.8%; Acid Soluble (inorganic): 1.7%; Inert (Non-asbestos): 25.5%			
Star-39 18	115092043-39 Location: Roof; Roofing Shingle	No	NAD (by NYS ELAP 198.6) by Donna M. Blackwell on 09/28/15
Analyst Description: Black, Heterogeneous, Non-Fibrous, Bulk Material Asbestos Types: Other Material: Non-fibrous 33.8 % Comment: Heat Sensitive (organic): 47.1%; Acid Soluble (inorganic): 19.1%; Inert (Non-asbestos): 33.8%			
Star-40 18	115092043-40 Location: Roof; Roofing Shingle	No	NAD (by NYS ELAP 198.6) by Donna M. Blackwell on 09/28/15
Analyst Description: Black, Heterogeneous, Non-Fibrous, Bulk Material Asbestos Types: Other Material: Non-fibrous 18.7 % Comment: Heat Sensitive (organic): 81.4%; Acid Soluble (inorganic): -0.1%; Inert (Non-asbestos): 18.7%			
Star-41 19	115092043-41 Location: Roof (Under Shingle); Tar Paper	No	NAD (by NYS ELAP 198.6) by Donna M. Blackwell on 09/28/15
Analyst Description: Black, Heterogeneous, Non-Fibrous, Bulk Material Asbestos Types: Other Material: Non-fibrous 13.2 % Comment: Heat Sensitive (organic): 81.8%; Acid Soluble (inorganic): 5.0%; Inert (Non-asbestos): 13.2%			
Star-42 19	115092043-42 Location: Roof (Under Shingle); Tar Paper	No	NAD (by NYS ELAP 198.6) by Donna M. Blackwell on 09/28/15
Analyst Description: Black, Heterogeneous, Non-Fibrous, Bulk Material Asbestos Types: Other Material: Non-fibrous 9.5 % Comment: Heat Sensitive (organic): 84.3%; Acid Soluble (inorganic): 6.3%; Inert (Non-asbestos): 9.5%			

PLM Bulk Asbestos Report

BEV-15-051; Starlite Cleaners; 331 Main St Medina, NY

Client No. / HGA	Lab No.	Asbestos Present	Total % Asbestos
Star-43 20 Location: Roof; Built Up Roofing Material	115092043-43	No	NAD (by NYS ELAP 198.6) by Donna M. Blackwell on 09/28/15
Analyst Description: Black, Heterogeneous, Non-Fibrous, Bulk Material Asbestos Types: Other Material: Non-fibrous 32.7 % Comment: Heat Sensitive (organic): 62.8%; Acid Soluble (inorganic): 4.5%; Inert (Non-asbestos): 32.7%			
Star-44 20 Location: Roof; Built Up Roofing Material	115092043-44	No	NAD (by NYS ELAP 198.6) by Donna M. Blackwell on 09/28/15
Analyst Description: Black, Heterogeneous, Non-Fibrous, Bulk Material Asbestos Types: Other Material: Non-fibrous 30.7 % Comment: Heat Sensitive (organic): 63.4%; Acid Soluble (inorganic): 5.9%; Inert (Non-asbestos): 30.7%			
Star-45 21 Location: Roof (Under Built Up Roofing); Tar Paper	115092043-45	No	NAD (by NYS ELAP 198.6) by Donna M. Blackwell on 09/28/15
Analyst Description: Black, Heterogeneous, Non-Fibrous, Bulk Material Asbestos Types: Other Material: Non-fibrous 12.8 % Comment: Heat Sensitive (organic): 86.7%; Acid Soluble (inorganic): 0.4%; Inert (Non-asbestos): 12.8%			
Star-46 21 Location: Roof (Under Built Up Roofing); Tar Paper	115092043-46	No	NAD (by NYS ELAP 198.6) by Donna M. Blackwell on 09/28/15
Analyst Description: Black, Heterogeneous, Non-Fibrous, Bulk Material Asbestos Types: Other Material: Non-fibrous 15.2 % Comment: Heat Sensitive (organic): 81.4%; Acid Soluble (inorganic): 3.4%; Inert (Non-asbestos): 15.2%			
Star-47 22 Location: Drycleaners Building (South); Wire Insulation	115092043-47	No	NAD (by NYS ELAP 198.6) by Donna M. Blackwell on 09/28/15
Analyst Description: Black, Heterogeneous, Non-Fibrous, Bulk Material Asbestos Types: Other Material: Non-fibrous 15.6 % Comment: Heat Sensitive (organic): 68.6%; Acid Soluble (inorganic): 15.8%; Inert (Non-asbestos): 15.6%			

PLM Bulk Asbestos Report

BEV-15-051; Starlite Cleaners; 331 Main St Medina, NY

Client No. / HGA	Lab No.	Asbestos Present	Total % Asbestos
Star-48 22	115092043-48 Location: Drycleaners Building (South); Wire Insulation	No	NAD (by NYS ELAP 198.6) by Donna M. Blackwell on 09/28/15
<p>Analyst Description: Black, Heterogeneous, Non-Fibrous, Bulk Material</p> <p>Asbestos Types:</p> <p>Other Material: Non-fibrous 27.8 %</p> <p>Comment: Heat Sensitive (organic): 55.6%; Acid Soluble (inorganic): 16.6%; Inert (Non-asbestos): 27.8%</p>			
Star-49 22	115092043-49 Location: Drycleaners Building (South); Wire Insulation	No	NAD (by NYS ELAP 198.6) by Donna M. Blackwell on 09/28/15
<p>Analyst Description: Black, Heterogeneous, Non-Fibrous, Bulk Material</p> <p>Asbestos Types:</p> <p>Other Material: Non-fibrous 18 %</p> <p>Comment: Heat Sensitive (organic): 80.8%; Acid Soluble (inorganic): 1.2%; Inert (Non-asbestos): 18.0%</p>			
Star-50 23	115092043-50 Location: Drycleaners Building (South); Wall Paper	No	NAD (by NYS ELAP 198.1) by Donna M. Blackwell on 09/28/15
<p>Analyst Description: Brown, Heterogeneous, Fibrous, Bulk Material</p> <p>Asbestos Types:</p> <p>Other Material: Cellulose 100 %</p>			
Star-51 23	115092043-51 Location: Drycleaners Building (South); Wall Paper	No	NAD (by NYS ELAP 198.1) by Donna M. Blackwell on 09/28/15
<p>Analyst Description: Brown/Gray, Heterogeneous, Fibrous, Bulk Material</p> <p>Asbestos Types:</p> <p>Other Material: Cellulose 10 %, Non-fibrous 90 %</p>			
Star-52 24	115092043-52 Location: Drycleaners Building (South); Drywall	No	NAD (by NYS ELAP 198.1) by Donna M. Blackwell on 09/28/15
<p>Analyst Description: Off-White/Brown, Heterogeneous, Fibrous, Bulk Material</p> <p>Asbestos Types:</p> <p>Other Material: Cellulose 10 %, Non-fibrous 90 %</p>			

PLM Bulk Asbestos Report

BEV-15-051; Starlite Cleaners; 331 Main St Medina, NY

Client No. / HGA	Lab No.	Asbestos Present	Total % Asbestos
Star-53 24	115092043-53	No	NAD
Location: Drycleaners Building (South); Drywall			(by NYS ELAP 198.1) by Donna M. Blackwell on 09/28/15
Analyst Description: Off-White/Brown, Heterogeneous, Fibrous, Bulk Material			
Asbestos Types:			
Other Material: Cellulose 10 %, Non-fibrous 90 %			
Star-54 25	115092043-54	No	NAD
Location: Drycleaners Building (South); Joint Compound			(by NYS ELAP 198.1) by Donna M. Blackwell on 09/28/15
Analyst Description: White, Heterogeneous, Fibrous, Bulk Material			
Asbestos Types:			
Other Material: Non-fibrous 100 %			
Star-55 25	115092043-55	No	NAD
Location: Drycleaners Building (South); Joint Compound			(by NYS ELAP 198.1) by Donna M. Blackwell on 09/28/15
Analyst Description: White, Heterogeneous, Fibrous, Bulk Material			
Asbestos Types:			
Other Material: Non-fibrous 100 %			
Star-56 26	115092043-56	No	NAD
Location: Drycleaners Front Window; Exterior Window Caulk			(by NYS ELAP 198.6) by Donna M. Blackwell on 09/28/15
Analyst Description: Gray, Heterogeneous, Non-Fibrous, Bulk Material			
Asbestos Types:			
Other Material: Non-fibrous 4.5 %			
Comment: Heat Sensitive (organic): 44.4%; Acid Soluble (inorganic): 51.1%; Inert (Non-asbestos): 4.5%			
Star-57 26	115092043-57	No	NAD
Location: Drycleaners Front Window; Exterior Window Caulk			(by NYS ELAP 198.6) by Donna M. Blackwell on 09/28/15
Analyst Description: Gray, Heterogeneous, Non-Fibrous, Bulk Material			
Asbestos Types:			
Other Material: Non-fibrous 4.7 %			
Comment: Heat Sensitive (organic): 42.9%; Acid Soluble (inorganic): 52.4%; Inert (Non-asbestos): 4.7%			

PLM Bulk Asbestos Report

BEV-15-051; Starlite Cleaners; 331 Main St Medina, NY

Client No. / HGA	Lab No.	Asbestos Present	Total % Asbestos
Star-58 27	115092043-58 Location: Above Office; Wrap On Ductwork (Paper)	Yes	50 % (by NYS ELAP 198.1) by Donna M. Blackwell on 09/28/15
Analyst Description: Gray, Heterogeneous, Fibrous, Bulk Material Asbestos Types: Chrysotile 50.0 % Other Material: Cellulose 25 %, Non-fibrous 25 %			
Star-59 27	115092043-59 Location: Above Office; Wrap On Ductwork (Paper)		NA/PS
Analyst Description: Bulk Material Asbestos Types: Other Material:			
Star-60 28	115092043-60 Location: Roof; Tar Associated W/ Flashing	No	NAD (by NYS ELAP 198.6) by Donna M. Blackwell on 09/28/15
Analyst Description: Black, Heterogeneous, Non-Fibrous, Bulk Material Asbestos Types: Other Material: Non-fibrous 14 % Comment: Heat Sensitive (organic): 84.5%; Acid Soluble (inorganic): 1.5%; Inert (Non-asbestos): 14.0%			
Star-61 28	115092043-61 Location: Roof; Tar Associated W/ Flashing	Yes	3.9 % (by NYS ELAP 198.6) by Donna M. Blackwell on 09/28/15
Analyst Description: Black, Heterogeneous, Non-Fibrous, Bulk Material Asbestos Types: Chrysotile 3.9 % Other Material: Non-fibrous 15.6 % Comment: Heat Sensitive (organic): 76.8%; Acid Soluble (inorganic): 3.7%; Inert (Non-asbestos): 15.6%			
Star-62 29	115092043-62 Location: Roof; Tar Associated W/ Rolled Roofing	No	NAD (by NYS ELAP 198.6) by Donna M. Blackwell on 09/28/15
Analyst Description: Black, Heterogeneous, Non-Fibrous, Bulk Material Asbestos Types: Other Material: Non-fibrous 16.3 % Comment: Heat Sensitive (organic): 82.3%; Acid Soluble (inorganic): 1.4%; Inert (Non-asbestos): 16.3%			

PLM Bulk Asbestos Report

BEV-15-051; Starlite Cleaners; 331 Main St Medina, NY

Client No. / HGA	Lab No.	Asbestos Present	Total % Asbestos
Star-63 29	115092043-63 Location: Roof; Tar Associated W/ Rolled Roofing	No	NAD (by NYS ELAP 198.6) by Donna M. Blackwell on 09/28/15
Analyst Description: Black, Heterogeneous, Non-Fibrous, Bulk Material Asbestos Types: Other Material: Non-fibrous 16.4 % Comment: Heat Sensitive (organic): 81.0%; Acid Soluble (inorganic): 2.6%; Inert (Non-asbestos): 16.4%			
Star-64 30	115092043-64 Location: Office Front Window; Exterior Window Caulk	No	NAD (by NYS ELAP 198.6) by Donna M. Blackwell on 09/28/15
Analyst Description: Gray/White, Heterogeneous, Non-Fibrous, Bulk Material Asbestos Types: Other Material: Non-fibrous 6.5 % Comment: Heat Sensitive (organic): 27.0%; Acid Soluble (inorganic): 66.5%; Inert (Non-asbestos): 6.5%			
Star-65 30	115092043-65 Location: Office Front Window; Exterior Window Caulk	No	NAD (by NYS ELAP 198.6) by Donna M. Blackwell on 09/28/15
Analyst Description: Gray/White, Heterogeneous, Non-Fibrous, Bulk Material Asbestos Types: Other Material: Non-fibrous 9.9 % Comment: Heat Sensitive (organic): 27.0%; Acid Soluble (inorganic): 63.1%; Inert (Non-asbestos): 9.9%			

Reporting Notes:

Analyzed by: Donna M. Blackwell Donna M Blackwell Date _____
*NAD = no asbestos detected, Detection Limit <1%, Reporting Limits: CVES = 1%, 400 Pt Ct = 0.25%, 1000 Pt Ct = 0.1%; "Present" or NVA = "No Visible Asbestos" are observations made during a qualitative analysis; NA = not analyzed; NA/PS = not analyzed / positive stop; PLM Bulk Asbestos Analysis by EPA 600/R-93/116 per 40 CFR 763 (NVLAP Lab Code 101904-0) and ELAP PLM Analysis Protocol 198.1 for New York friable samples which includes quantitation of any vermiculite observed (198.6 for NOB samples) or EPA 400 pt ct by EPA 600/M4-82-020 (NYSDOH ELAP Lab # 10984); CA ELAP Lab # 2508; Note: PLM is not consistently reliable in detecting asbestos in floor coverings and similar NOB materials. NAD or Trace results by PLM are inconclusive, TEM is currently the only method that can be used to determine if this material can be considered or treated as non-asbestos-containing in New York State (also see EPA Advisory for floor tile, FR 59, 146, 38970, 8/1/94). NIST Accreditation requirements mandate that this report must not be reproduced except in full without the approval of the laboratory. This PLM report relates ONLY to the items tested.
Reviewed By: DMB



ANALYTICAL REPORT

Lab Number:	L1523746
Client:	SJB Services, Inc 5167 South Park Ave. Hamburg, NY 14705
ATTN:	Dave Steiner
Phone:	(716) 649-8110
Project Name:	STARLITE CLEANERS
Project Number:	BEV-15-051
Report Date:	10/01/15

The original project report/data package is held by Alpha Analytical. This report/data package is paginated and should be reproduced only in its entirety. Alpha Analytical holds no responsibility for results and/or data that are not consistent with the original.

Certifications & Approvals: MA (M-MA086), NY (11148), CT (PH-0574), NH (2003), NJ NELAP (MA935), RI (LAO00065), ME (MA00086), PA (68-03671), VA (460195), MD (348), IL (200077), NC (666), TX (T104704476), DOD (L2217), USDA (Permit #P-330-11-00240).

Eight Walkup Drive, Westborough, MA 01581-1019
508-898-9220 (Fax) 508-898-9193 800-624-9220 - www.alphalab.com



Project Name: STARLITE CLEANERS
Project Number: BEV-15-051

Lab Number: L1523746
Report Date: 10/01/15

Alpha Sample ID	Client ID	Matrix	Sample Location	Collection Date/Time	Receive Date
L1523746-01	BURGUNDY PAINT-01	SOLID	MEDINA, NY	09/22/15 13:00	09/23/15
L1523746-02	SEAFOAM PAINT -02	SOLID	MEDINA, NY	09/22/15 13:05	09/23/15
L1523746-03	DK GREEN PAINT -03	SOLID	MEDINA, NY	09/22/15 13:10	09/23/15
L1523746-04	BLACK PAINT - 04	SOLID	MEDINA, NY	09/22/15 13:15	09/23/15
L1523746-05	BROWN PAINT - 05	SOLID	MEDINA, NY	09/22/15 13:20	09/23/15
L1523746-06	GREEN PAINT - 06	SOLID	MEDINA, NY	09/22/15 13:25	09/23/15
L1523746-07	LT BLUE PAINT - 07	SOLID	MEDINA, NY	09/22/15 13:30	09/23/15
L1523746-08	DK BLUE PAINT - 08	SOLID	MEDINA, NY	09/22/15 14:00	09/23/15
L1523746-09	GRAY PAINT - 09	SOLID	MEDINA, NY	09/22/15 14:05	09/23/15
L1523746-10	WHITE PAINT - 10	SOLID	MEDINA, NY	09/22/15 14:15	09/23/15



Project Name: STARLITE CLEANERS
Project Number: BEV-15-051

Lab Number: L1523746
Report Date: 10/01/15

Case Narrative

The samples were received in accordance with the Chain of Custody and no significant deviations were encountered during the preparation or analysis unless otherwise noted. Sample Receipt, Container Information, and the Chain of Custody are located at the back of the report.

Results contained within this report relate only to the samples submitted under this Alpha Lab Number and meet all of the requirements of NELAC, for all NELAC accredited parameters. The data presented in this report is organized by parameter (i.e. VOC, SVOC, etc.). Sample specific Quality Control data (i.e. Surrogate Spike Recovery) is reported at the end of the target analyte list for each individual sample, followed by the Laboratory Batch Quality Control at the end of each parameter. Tentatively Identified Compounds (TICs), if requested, are reported for compounds identified to be present and are not part of the method/program Target Compound List, even if only a subset of the TCL are being reported. If a sample was re-analyzed or re-extracted due to a required quality control corrective action and if both sets of data are reported, the Laboratory ID of the re-analysis or re-extraction is designated with an "R" or "RE", respectively. When multiple Batch Quality Control elements are reported (e.g. more than one LCS), the associated samples for each element are noted in the grey shaded header line of each data table. Any Laboratory Batch, Sample Specific % recovery or RPD value that is outside the listed Acceptance Criteria is bolded in the report. All specific QC information is also incorporated in the Data Usability format of our Data Merger tool where it can be reviewed along with any associated usability implications. Soil/sediments, solids and tissues are reported on a dry weight basis unless otherwise noted. Definitions of all data qualifiers and acronyms used in this report are provided in the Glossary located at the back of the report.

In reference to questions H (CAM) or 4 (RCP) when "NO" is checked, the performance criteria for CAM and RCP methods allow for some quality control failures to occur and still be within method compliance. In these instances the specific failure is not narrated but noted in the associated QC table. The information is also incorporated in the Data Usability format of our Data Merger tool where it can be reviewed along with any associated usability implications.

Please see the associated ADEx data file for a comparison of laboratory reporting limits that were achieved with the regulatory Numerical Standards requested on the Chain of Custody.

HOLD POLICY

For samples submitted on hold, Alpha's policy is to hold samples (with the exception of Air canisters) free of charge for 21 calendar days from the date the project is completed. After 21 calendar days, we will dispose of all samples submitted including those put on hold unless you have contacted your Client Service Representative and made arrangements for Alpha to continue to hold the samples. Air canisters will be disposed after 3 business days from the date the project is completed.

Please contact Client Services at 800-624-9220 with any questions.

Project Name: STARLITE CLEANERS
Project Number: BEV-15-051

Lab Number: L1523746
Report Date: 10/01/15

Case Narrative (continued)

Report Submission

All non-detect (ND) or estimated concentrations (J-qualified) have been quantitated to the limit noted in the MDL column.

I, the undersigned, attest under the pains and penalties of perjury that, to the best of my knowledge and belief and based upon my personal inquiry of those responsible for providing the information contained in this analytical report, such information is accurate and complete. This certificate of analysis is not complete unless this page accompanies any and all pages of this report.

Authorized Signature:  Kelly Stenstrom

Title: Technical Director/Representative

Date: 10/01/15

METALS

Project Name: STARLITE CLEANERS
 Project Number: BEV-15-051

Lab Number: L1523746
 Report Date: 10/01/15

SAMPLE RESULTS

Lab ID: L1523746-01
 Client ID: BURGUNDY PAINT-01
 Sample Location: MEDINA, NY
 Matrix: Solid
 Percent Solids: Results are reported on an 'AS RECEIVED' basis.

Date Collected: 09/22/15 13:00
 Date Received: 09/23/15
 Field Prep: Not Specified

Parameter	Result	Qualifier	Units	RL	MDL	Dilution Factor	Date Prepared	Date Analyzed	Prep Method	Analytical Method	Analyst
Total Metals - Westborough Lab											
Lead, Total	3700		mg/kg	5.0	0.20	1	09/25/15 11:24	09/30/15 23:31	EPA 3050B	1,6010C	JH

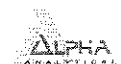

Project Name: STARLITE CLEANERS
 Project Number: BEV-15-051

Lab Number: L1523746
 Report Date: 10/01/15

SAMPLE RESULTS

Lab ID: L1523746-02
 Client ID: SEAFOAM PAINT -02
 Sample Location: MEDINA, NY
 Matrix: Solid
 Percent Solids: Results are reported on an 'AS RECEIVED' basis.

Date Collected: 09/22/15 13:05
 Date Received: 09/23/15
 Field Prep: Not Specified

Parameter	Result	Qualifier	Units	RL	MDL	Dilution Factor	Date Prepared	Date Analyzed	Prep Method	Analytical Method	Analyst
Total Metals - Westborough Lab											
Lead, Total	17000		mg/kg	73	2.9	20	09/25/15 11:24	10/01/15 14:18	EPA 3050B	1,6010C	JH



Project Name: STARLITE CLEANERS
 Project Number: BEV-15-051

Lab Number: L1523746
 Report Date: 10/01/15

SAMPLE RESULTS

Lab ID: L1523746-03
 Client ID: DK GREEN PAINT -03
 Sample Location: MEDINA, NY
 Matrix: Solid
 Percent Solids: Results are reported on an 'AS RECEIVED' basis.

Date Collected: 09/22/15 13:10
 Date Received: 09/23/15
 Field Prep: Not Specified

Parameter	Result	Qualifier	Units	RL	MDL	Dilution Factor	Date Prepared	Date Analyzed	Prep Method	Analytical Method	Analyst
Total Metals - Westborough Lab											
Lead, Total	7900		mg/kg	5.0	0.20	1	09/25/15 11:24	09/30/15 23:55	EPA 3050B	1,6010C	JH



Project Name: STARLITE CLEANERS

Lab Number: L1523746

Project Number: BEV-15-051

Report Date: 10/01/15

SAMPLE RESULTS

Lab ID: L1523746-04

Date Collected: 09/22/15 13:15

Client ID: BLACK PAINT - 04

Date Received: 09/23/15

Sample Location: MEDINA, NY

Field Prep: Not Specified

Matrix: Solid

Percent Solids: Results are reported on an 'AS RECEIVED' basis.

Parameter	Result	Qualifier	Units	RL	MDL	Dilution Factor	Date Prepared	Date Analyzed	Prep Method	Analytical Method	Analyst
Total Metals - Westborough Lab											
Lead, Total	200		mg/kg	4.0	0.16	1	09/25/15 11:24	09/30/15 23:59	EPA 3050B	1,6010C	JH



Project Name: STARLITE CLEANERS

Lab Number: L1523746

Project Number: BEV-15-051

Report Date: 10/01/15

SAMPLE RESULTS

Lab ID: L1523746-05

Date Collected: 09/22/15 13:20

Client ID: BROWN PAINT - 05

Date Received: 09/23/15

Sample Location: MEDINA, NY

Field Prep: Not Specified

Matrix: Solid

Percent Solids: Results are reported on an 'AS RECEIVED' basis.

Parameter	Result	Qualifier	Units	RL	MDL	Dilution Factor	Date Prepared	Date Analyzed	Prep Method	Analytical Method	Analyst
Total Metals - Westborough Lab											
Lead, Total	65000		mg/kg	480	19	100	09/25/15 11:24	10/01/15 14:21	EPA 3050B	1,6010C	JH



Project Name: STARLITE CLEANERS
 Project Number: BEV-15-051

Lab Number: L1523746
 Report Date: 10/01/15

SAMPLE RESULTS

Lab ID: L1523746-06
 Client ID: GREEN PAINT - 06
 Sample Location: MEDINA, NY
 Matrix: Solid
 Percent Solids: Results are reported on an 'AS RECEIVED' basis.

Date Collected: 09/22/15 13:25
 Date Received: 09/23/15
 Field Prep: Not Specified

Parameter	Result	Qualifier	Units	RL	MDL	Dilution Factor	Date Prepared	Date Analyzed	Prep Method	Analytical Method	Analyst
Total Metals - Westborough Lab											
Lead, Total	110000		mg/kg	500	20	100	09/25/15 11:24	10/01/15 14:33	EPA 3050B	1,6010C	JH



Project Name: STARLITE CLEANERS
 Project Number: BEV-15-051

Lab Number: L1523746
 Report Date: 10/01/15

SAMPLE RESULTS

Lab ID: L1523746-07
 Client ID: LT BLUE PAINT - 07
 Sample Location: MEDINA, NY
 Matrix: Solid
 Percent Solids: Results are reported on an 'AS RECEIVED' basis.

Date Collected: 09/22/15 13:30
 Date Received: 09/23/15
 Field Prep: Not Specified

Parameter	Result	Qualifier	Units	RL	MDL	Dilution Factor	Date Prepared	Date Analyzed	Prep Method	Analytical Method	Analyst
Total Metals - Westborough Lab											
Lead, Total	13000		mg/kg	6.7	0.27	1	09/25/15 11:24	10/01/15 00:11	EPA 3050B	1,6010C	JH



Project Name: STARLITE CLEANERS
 Project Number: BEV-15-051

Lab Number: L1523746
 Report Date: 10/01/15

SAMPLE RESULTS

Lab ID: L1523746-08
 Client ID: DK BLUE PAINT - 08
 Sample Location: MEDINA, NY
 Matrix: Solid
 Percent Solids: Results are reported on an 'AS RECEIVED' basis.

Date Collected: 09/22/15 14:00
 Date Received: 09/23/15
 Field Prep: Not Specified

Parameter	Result	Qualifier	Units	RL	MDL	Dilution Factor	Date Prepared	Date Analyzed	Prep Method	Analytical Method	Analyst
Total Metals - Westborough Lab											
Lead, Total	39000		mg/kg	510	20	100	09/25/15 11:24	10/01/15 14:37	EPA 3050B	1,6010C	JH



Project Name: STARLITE CLEANERS
 Project Number: BEV-15-051

Lab Number: L1523746
 Report Date: 10/01/15

SAMPLE RESULTS

Lab ID: L1523746-09
 Client ID: GRAY PAINT - 09
 Sample Location: MEDINA, NY
 Matrix: Solid
 Percent Solids: Results are reported on an 'AS RECEIVED' basis.

Date Collected: 09/22/15 14:05
 Date Received: 09/23/15
 Field Prep: Not Specified

Parameter	Result	Qualifier	Units	RL	MDL	Dilution Factor	Date Prepared	Date Analyzed	Prep Method	Analytical Method	Analyst
Total Metals - Westborough Lab											
Lead, Total	680		mg/kg	8.2	0.33	1	09/25/15 11:24	10/01/15 00:19	EPA 3050B	1,6010C	JH



Project Name: STARLITE CLEANERS
 Project Number: BEV-15-051

Lab Number: L1523746
 Report Date: 10/01/15

SAMPLE RESULTS

Lab ID: L1523746-10
 Client ID: WHITE PAINT - 10
 Sample Location: MEDINA, NY
 Matrix: Solid
 Percent Solids: Results are reported on an 'AS RECEIVED' basis.

Date Collected: 09/22/15 14:15
 Date Received: 09/23/15
 Field Prep: Not Specified

Parameter	Result	Qualifier	Units	RL	MDL	Dilution Factor	Date Prepared	Date Analyzed	Prep Method	Analytical Method	Analyst
Total Metals - Westborough Lab											
Lead, Total	1000		mg/kg	2.0	0.08	1	09/26/15 06:51	09/29/15 05:54	EPA 3050B	1,6010C	JH



Project Name: STARLITE CLEANERS
 Project Number: BEV-15-051

Lab Number: L1523746
 Report Date: 10/01/15

**Method Blank Analysis
 Batch Quality Control**

Parameter	Result Qualifier	Units	RL	MDL	Dilution Factor	Date Prepared	Date Analyzed	Analytical Method	Analyst
Total Metals - Westborough Lab for sample(s): 01-09 Batch: WG824996-1									
Lead, Total	ND	mg/kg	2.0	0.08	1	09/25/15 11:24	09/30/15 19:57	1,6010C	JH

Prep Information

Digestion Method: EPA 3050B

Parameter	Result Qualifier	Units	RL	MDL	Dilution Factor	Date Prepared	Date Analyzed	Analytical Method	Analyst
Total Metals - Westborough Lab for sample(s): 10 Batch: WG825277-1									
Lead, Total	ND	mg/kg	2.0	0.08	1	09/26/15 06:51	09/28/15 17:15	1,6010C	JH

Prep Information

Digestion Method: EPA 3050B



Lab Control Sample Analysis
Batch Quality Control

Lab Number: L1523746
Report Date: 10/01/15

Project Name: STARLITE CLEANERS
Project Number: BEV-15-051

Parameter	LCS		LCSD		%Recovery Limits		RPD	Qual	RPD Limits
	%Recovery	Qual	%Recovery	Qual	%Recovery	Limits			
Total Metals - Westborough Lab Associated sample(s): 01-09	Batch: WG824996-2	SRM Lot Number: D088-540	85						
Lead, Total									81-117
Total Metals - Westborough Lab Associated sample(s): 10	Batch: WG825277-2	SRM Lot Number: D088-540	83						
Lead, Total									81-117



Matrix Spike Analysis
Batch Quality Control

Project Name: STARLITE CLEANERS
Project Number: BEV-15-051

Lab Number: L1523746
Report Date: 10/01/15

Parameter	Native Sample	MS Added	MS Found	MS %Recovery	MS Qual	MSD Found	MSD %Recovery	MSD Qual	Recovery Limits	RPD Qual	RPD Limits
Total Metals - Westborough Lab Associated sample(s): 01-09 QC Batch ID: WG824996-4 QC Sample: L1523673-01 Client ID: MS Sample											
Lead, Total	130	70.4	140	14	Q	-	-	-	75-125	-	20
Total Metals - Westborough Lab Associated sample(s): 10 QC Batch ID: WG825277-4 QC Sample: L1521204-61 Client ID: MS Sample											
Lead, Total	18	39.9	42	60	Q	-	-	-	75-125	-	20



Lab Duplicate Analysis Batch Quality Control

Project Name: STARLITE CLEANERS
Project Number: BEV-15-051

Lab Number: L1523746
Report Date: 10/01/15

Parameter	Native Sample	Duplicate Sample	Units	RPD	Qual	RPD Limits
Total Metals - Westborough Lab Associated sample(s):	01-09 QC Batch ID: WG824996-3	QC Sample: L1523673-01		Client ID: DUP	Sample	
Lead, Total	130	86	mg/kg	41	Q	20
Total Metals - Westborough Lab Associated sample(s):	10 QC Batch ID: WG825277-3	QC Sample: L1521204-61		Client ID: DUP	Sample	
Lead, Total	18	16	mg/kg	12		20



Project Name: STARLITE CLEANERS

Lab Number: L1523746

Project Number: BEV-15-051

Report Date: 10/01/15

Sample Receipt and Container Information

Were project specific reporting limits specified? YES

Reagent H2O Preserved Vials Frozen on: NA

Cooler Information Custody Seal

Cooler

A Absent

Container Information

Container ID	Container Type	Cooler	pH	Temp deg C	Pres	Seal	Analysis(*)
L1523746-01A	Bag	A	N/A	3.8	Y	Absent	TS100(),PB-TI(180)
L1523746-02A	Bag	A	N/A	3.8	Y	Absent	TS100(),PB-TI(180)
L1523746-03A	Bag	A	N/A	3.8	Y	Absent	TS100(),PB-TI(180)
L1523746-04A	Bag	A	N/A	3.8	Y	Absent	TS100(),PB-TI(180)
L1523746-05A	Bag	A	N/A	3.8	Y	Absent	TS100(),PB-TI(180)
L1523746-06A	Bag	A	N/A	3.8	Y	Absent	TS100(),PB-TI(180)
L1523746-07A	Bag	A	N/A	3.8	Y	Absent	TS100(),PB-TI(180)
L1523746-08A	Bag	A	N/A	3.8	Y	Absent	TS100(),PB-TI(180)
L1523746-09A	Bag	A	N/A	3.8	Y	Absent	TS100(),PB-TI(180)
L1523746-10A	Bag	A	N/A	3.8	Y	Absent	TS100(),PB-TI(180)

*Values in parentheses indicate holding time in days



Project Name: STARLITE CLEANERS

Lab Number: L1523746

Project Number: BEV-15-051

Report Date: 10/01/15

GLOSSARY

Acronyms

EDL	- Estimated Detection Limit: This value represents the level to which target analyte concentrations are reported as estimated values, when those target analyte concentrations are quantified below the reporting limit (RL). The EDL includes any adjustments from dilutions, concentrations or moisture content, where applicable. The use of EDLs is specific to the analysis of PAHs using Solid-Phase Microextraction (SPME).
EPA	- Environmental Protection Agency.
LCS	- Laboratory Control Sample: A sample matrix, free from the analytes of interest, spiked with verified known amounts of analytes or a material containing known and verified amounts of analytes.
LCS D	- Laboratory Control Sample Duplicate: Refer to LCS.
LFB	- Laboratory Fortified Blank: A sample matrix, free from the analytes of interest, spiked with verified known amounts of analytes or a material containing known and verified amounts of analytes.
MDL	- Method Detection Limit: This value represents the level to which target analyte concentrations are reported as estimated values, when those target analyte concentrations are quantified below the reporting limit (RL). The MDL includes any adjustments from dilutions, concentrations or moisture content, where applicable.
MS	- Matrix Spike Sample: A sample prepared by adding a known mass of target analyte to a specified amount of matrix sample for which an independent estimate of target analyte concentration is available.
MS D	- Matrix Spike Sample Duplicate: Refer to MS.
NA	- Not Applicable.
NC	- Not Calculated: Term is utilized when one or more of the results utilized in the calculation are non-detect at the parameter's reporting unit.
NI	- Not Ignitable.
NP	- Non-Plastic: Term is utilized for the analysis of Atterberg Limits in soil.
RL	- Reporting Limit: The value at which an instrument can accurately measure an analyte at a specific concentration. The RL includes any adjustments from dilutions, concentrations or moisture content, where applicable.
RPD	- Relative Percent Difference: The results from matrix and/or matrix spike duplicates are primarily designed to assess the precision of analytical results in a given matrix and are expressed as relative percent difference (RPD). Values which are less than five times the reporting limit for any individual parameter are evaluated by utilizing the absolute difference between the values; although the RPD value will be provided in the report.
SRM	- Standard Reference Material: A reference sample of a known or certified value that is of the same or similar matrix as the associated field samples.
TIC	- Tentatively Identified Compound: A compound that has been identified to be present and is not part of the target compound list (TCL) for the method and/or program. All TICs are qualitatively identified and reported as estimated concentrations.

Footnotes

1	- The reference for this analyte should be considered modified since this analyte is absent from the target analyte list of the original method.
---	--

Terms

Total: With respect to Organic analyses, a 'Total' result is defined as the summation of results for individual isomers or Aroclors. If a 'Total' result is requested, the results of its individual components will also be reported. This is applicable to 'Total' results for methods 8260, 8081 and 8082.

Analytical Method: Both the document from which the method originates and the analytical reference method. (Example: EPA 8260B is shown as I.8260B.) The codes for the reference method documents are provided in the References section of the Addendum.

Data Qualifiers

A	- Spectra identified as "Aldol Condensation Product".
B	- The analyte was detected above the reporting limit in the associated method blank. Flag only applies to associated field samples that have detectable concentrations of the analyte at less than ten times (10x) the concentration found in the blank. For MCP-related projects, flag only applies to associated field samples that have detectable concentrations of the analyte at less than ten times (10x) the concentration found in the blank. For DOD-related projects, flag only applies to associated field samples that have detectable concentrations of the analyte at less than ten times (10x) the concentration found in the blank AND the analyte was detected above one-half the reporting limit (or above the reporting limit for common lab contaminants) in the associated method blank. For NJ-Air-related projects, flag only applies to associated field samples that have detectable concentrations of the analyte above the reporting limit. For NJ-related projects (excluding Air), flag only applies to associated field samples that have detectable concentrations of the analyte, which was detected above the reporting limit in the associated method blank or above five times the reporting limit for common lab contaminants (Phthalates, Acetone, Methylene Chloride, 2-Butanone).
C	- Co-elution: The target analyte co-elutes with a known lab standard (i.e. surrogate, internal standards, etc.) for co-extracted analyses.

Report Format: DU Report with 'U' Qualifiers



Project Name: STARLITE CLEANERS

Lab Number: L1523746

Project Number: BEV-15-051

Report Date: 10/01/15

Data Qualifiers

- D** - Concentration of analyte was quantified from diluted analysis. Flag only applies to field samples that have detectable concentrations of the analyte.
- E** - Concentration of analyte exceeds the range of the calibration curve and/or linear range of the instrument.
- G** - The concentration may be biased high due to matrix interferences (i.e. co-elution) with non-target compound(s). The result should be considered estimated.
- H** - The analysis of pH was performed beyond the regulatory-required holding time of 15 minutes from the time of sample collection.
- I** - The lower value for the two columns has been reported due to obvious interference.
- M** - Reporting Limit (RL) exceeds the MCP CAM Reporting Limit for this analyte.
- N#** - Presumptive evidence of compound. This represents an estimated concentration for Tentatively Identified Compounds (TICs), where the identification is based on a mass spectral library search.
- P** - The RPD between the results for the two columns exceeds the method-specified criteria.
- Q** - The quality control sample exceeds the associated acceptance criteria. For DOD-related projects, LCS and/or Continuing Calibration Standard exceedences are also qualified on all associated sample results. Note: This flag is not applicable for matrix spike recoveries when the sample concentration is greater than 4x the spike added or for batch duplicate RPD when the sample concentrations are less than 5x the RL. (Metals only.)
- R** - Analytical results are from sample re-analysis.
- RE** - Analytical results are from sample re-extraction.
- S** - Analytical results are from modified screening analysis.
- J** - Estimated value. The Target analyte concentration is below the quantitation limit (RL), but above the Method Detection Limit (MDL) or Estimated Detection Limit (EDL) for SPME-related analyses. This represents an estimated concentration for Tentatively Identified Compounds (TICs).
- ND** - Not detected at the method detection limit (MDL) for the sample, or estimated detection limit (EDL) for SPME-related analyses.

Report Format: DU Report with 'J' Qualifiers

Project Name: STARLITE CLEANERS
Project Number: BEV-15-051

Lab Number: L1523746
Report Date: 10/01/15

REFERENCES

- 1 Test Methods for Evaluating Solid Waste: Physical/Chemical Methods. EPA SW-846. Third Edition. Updates I - IV, 2007.

LIMITATION OF LIABILITIES

Alpha Analytical performs services with reasonable care and diligence normal to the analytical testing laboratory industry. In the event of an error, the sole and exclusive responsibility of Alpha Analytical shall be to re-perform the work at it's own expense. In no event shall Alpha Analytical be held liable for any incidental, consequential or special damages, including but not limited to, damages in any way connected with the use of, interpretation of, information or analysis provided by Alpha Analytical.

We strongly urge our clients to comply with EPA protocol regarding sample volume, preservation, cooling, containers, sampling procedures, holding time and splitting of samples in the field.



Certification Information

The following analytes are not included in our Primary NELAP Scope of Accreditation:

Westborough Facility

EPA 8260C: 1,2,4,5-Tetramethylbenzene, 4-Ethyltoluene, Iodomethane (methyl iodide) (soil), Methyl methacrylate (soil), Azobenzene.

EPA 8270D: Dimethylnaphthalene, 1,4-Diphenylhydrazine.

EPA 625: 4-Chloroaniline, 4-Methylphenol.

SM4500: Soil: Total Phosphorus, TKN, NO₂, NO₃.

Mansfield Facility

EPA 8270D: Biphenyl.

EPA 2540D: TSS

EPA TO-15: Halothane, 2,4,4-Trimethyl-2-pentene, 2,4,4-Trimethyl-1-pentene, Thiophene, 2-Methylthiophene, 3-Methylthiophene, 2-Ethylthiophene, 1,2,3-Trimethylbenzene, Indan, Indene, 1,2,4,5-Tetramethylbenzene, Benzothiophene, 1-Methylnaphthalene.

The following analytes are included in our Massachusetts DEP Scope of Accreditation, Westborough Facility:

Drinking Water

EPA 200.8: Sb,As,Ba,Be,Cd,Cr,Cu,Pb,Ni,Se,Tl; **EPA 200.7:** Ba,Be,Ca,Cd,Cr,Cu,Na; **EPA 245.1:** Mercury;
EPA 300.0: Nitrate-N, Fluoride, Sulfate; **EPA 353.2:** Nitrate-N, Nitrite-N; **SM4500NO3-F:** Nitrate-N, Nitrite-N; **SM4500F-C,**
SM4500CN-CE, **EPA 180.1,** **SM2130B,** **SM4500CI-D,** **SM2320B,** **SM2540C,** **SM4500H-B**
EPA 332: Perchlorate.
Microbiology: **SM9215B;** **SM9223-P/A,** **SM9223B-Colilert-QT,** **Enterolert-QT.**

Non-Potable Water

EPA 200.8: Al,Sb,As,Be,Cd,Cr,Cu,Pb,Mn,Ni,Se,Ag,Tl,Zn;
EPA 200.7: Al,Sb,As,Be,Cd,Ca,Cr,Co,Cu,Fe,Pb,Mg,Mn,Mo,Ni,K,Se,Ag,Na,Sr,Ti,Tl,V,Zn;
EPA 245.1, **SM4500H,B,** **EPA 120.1,** **SM2510B,** **SM2540C,** **SM2340B,** **SM2320B,** **SM4500CL-E,** **SM4500F-BC,**
SM426C, **SM4500NH3-BH,** **EPA 350.1:** Ammonia-N, **LACHAT 10-107-06-1-B:** Ammonia-N, **SM4500NO3-F,**
EPA 353.2: Nitrate-N, **SM4500NH3-BC-NES,** **EPA 351.1,** **SM4500P-E,** **SM4500P-B,** **E,** **SM5220D,** **EPA 410.4,**
SM5210B, **SM5310C,** **SM4500CL-D,** **EPA 1664,** **SM14 510AC,** **EPA 420.1,** **SM4500-CN-CE,** **SM2540D.**
EPA 624: Volatile Halocarbons & Aromatics,
EPA 608: Chlordane, Toxaphene, Aldrin, alpha-BHC, beta-BHC, gamma-BHC, delta-BHC, Dieldrin, DDD, DDE, DDT,
 Endosulfan I, Endosulfan II, Endosulfan sulfate, Endrin, Endrin Aldehyde, Heptachlor, Heptachlor Epoxide, PCBs
EPA 625: SVOC (Acid/Base/Neutral Extractables), **EPA 600/4-81-045:** PCB-Oil.
Microbiology: **SM9223B-Colilert-QT;** **Enterolert-QT,** **SM9222D-MF.**

For a complete listing of analytes and methods, please contact your Alpha Project Manager.

	<p>NEW YORK CHAIN OF CUSTODY</p>	<p>Services Centers Mahwah, NJ 07430: 35 Whitney Rd, Suite 5 Albany, NY 12205: 14 Walker Way Tonawanda, NY 14150: 275 Cooper Ave, Suite 105</p>	<p>Page _____ of _____</p>	<p>Date Rec'd in Lab: <u>9/24/15</u></p> <p>ALPHA Job # <u>1523746</u></p>		
<p>Westborough, MA 01581 8 Walkup Dr. TEL: 508-898-9220 FAX: 508-898-9193</p>		<p>Project Name: <u>Starlite Cleaners</u> Project Location: <u>Medina NY</u> Project # <u>REV-15-051</u></p>				
<p>Client: <u>SJB Empire</u> Address: <u>5167 South Park</u> <u>Hamburg NY 14075</u> Phone: <u>(162) 649-8110</u> Fax: <u>-8051</u> Email: <u>customers@sjbempire.net</u></p>		<p>Project Manager: <u>Dave Steiner</u> ALPHA Quote #: <u>Turn-Around Time</u> SJD Standard <input checked="" type="checkbox"/> Due Date: Rush (only if pre approved) <input type="checkbox"/> # of Days: <u>5 day</u></p>				
<p>These samples have been previously analyzed by Alpha <input type="checkbox"/></p> <p>Other project specific requirements/comments: <u>akoons@sjbempire.net & dsteineresjbempire.net</u></p>						
<p>Please specify Metals or TAL.</p>						
<p>ALPHA Lab ID (Lab Use Only)</p>	<p>Sample ID</p>	<p>Collection Date</p>	<p>Time</p>	<p>Sample Matrix</p>	<p>Sampler's Initials</p>	<p>Sample Specific Comments</p>
<u>2376-01</u>	<u>Burgundy Paint - 01</u>	<u>9/22/15</u>	<u>1300</u>	<u>Paint</u>	<u>AD</u>	<u>8 outside of building</u>
<u>72</u>	<u>Seafoam Paint - 02</u>	<u>9/22/15</u>	<u>1305</u>	<u>Paint</u>	<u>AD</u>	<u>Bathroom</u>
<u>73</u>	<u>Green Paint - 03</u>	<u>9/22/15</u>	<u>1310</u>	<u>Paint</u>	<u>AD</u>	<u>Garage area</u>
<u>74</u>	<u>Black Paint - 04</u>	<u>9/22/15</u>	<u>1315</u>	<u>Paint</u>	<u>AD</u>	<u>Garage area</u>
<u>75</u>	<u>Brown Paint - 05</u>	<u>9/22/15</u>	<u>1320</u>	<u>Paint</u>	<u>AD</u>	<u>Front of office</u>
<u>76</u>	<u>Green Paint - 06</u>	<u>9/22/15</u>	<u>1325</u>	<u>Paint</u>	<u>AD</u>	<u>Office dry wall</u>
<u>77</u>	<u>Lt Blue Paint - 07</u>	<u>9/22/15</u>	<u>1330</u>	<u>Paint</u>	<u>AD</u>	<u>Garage Area</u>
<u>78</u>	<u>DK Blue Paint - 08</u>	<u>9/22/15</u>	<u>1405</u>	<u>Paint</u>	<u>AD</u>	<u>Garage Area</u>
<u>79</u>	<u>Gray Paint - 09</u>	<u>9/22/15</u>	<u>1405</u>	<u>Paint</u>	<u>AD</u>	<u>Office door molding</u>
<u>80</u>	<u>White Paint - 10</u>	<u>9/22/15</u>	<u>1415</u>	<u>Paint</u>	<u>AD</u>	<u>Back of Bathroom</u>

Preservative Code: P = Plastic, A = Amber Glass, V = Vial, G = Glass, B = Bacteria Cup, C = Cube, O = Other, E = Encore, D = BOD Bottle, W/E = Zn Ac/NaOH, O = Other

Westboro: Certification No: MA935
Mansfield: Certification No: MA015

Container Type: P
Preservative: A

Relinquished By: [Signature] Date/Time: 9/25/15 1245
[Signature] Date/Time: 9/25/15 1907
[Signature] Date/Time: 9/27/15 2010
[Signature] Date/Time: 9/24/15 0040

Received By: [Signature] Date/Time: 9/25/15 2215
[Signature] Date/Time: 9/27/15 1907
[Signature] Date/Time: 9/27/15 2010
[Signature] Date/Time: 9/24/15 0040

Please print clearly, legibly and completely. Samples can not be logged in and turnaround time clock will not start until any ambiguities are resolved. BY EXECUTING THIS COC, THE CLIENT HAS READ AND AGREES TO BE BOUND BY ALPHA'S TERMS & CONDITIONS. (See reverse side.)

NEW YORK STATE DEPARTMENT OF HEALTH
WADSWORTH CENTER



Expires 12:01 AM April 01, 2016
Issued April 01, 2015

CERTIFICATE OF APPROVAL FOR LABORATORY SERVICE

Issued in accordance with and pursuant to section 502 Public Health Law of New York State

DR. THOMAS R. MCKEE
AMERISCI RICHMOND
13635 GENITO RD
MIDLOTHIAN, VA 23112

NY Lab Id No: 10984

is hereby APPROVED as an Environmental Laboratory for the category
ENVIRONMENTAL ANALYSES SOLID AND HAZARDOUS WASTE
All approved subcategories and/or analytes are listed below.

Miscellaneous

Asbestos in Friable Material	Item 198.1 of Manual EPA 600/M4/82/020
Asbestos in Non-Friable Material-PLM	Item 198.6 of Manual (NOB by PLM)
Asbestos in Non-Friable Material-TEM	Item 198.4 of Manual

Serial No.: 52221

Property of the New York State Department of Health. Certificates are valid only at the address shown, must be conspicuously posted, and are printed on secure paper. Continued accreditation depends on successful ongoing participation in the Program. Consumers are urged to call (516) 485-6570 to verify the laboratory's accreditation status.

New York State – Department of Labor

Division of Safety and Health
License and Certificate Unit
State Campus, Building 12
Albany, NY 12240

ASBESTOS HANDLING LICENSE

SJB Services, Inc.

60 Miller Street

Cortland, NY 13045

FILE NUMBER: 01-0326

LICENSE NUMBER: 29433

LICENSE CLASS: RESTRICTED

DATE OF ISSUE: 04/16/2015

EXPIRATION DATE: 04/30/2016

Duly Authorized Representative – David Verdon:

This license has been issued in accordance with applicable provisions of Article 30 of the Labor Law of New York State and of the New York State Codes, Rules and Regulations (12 NYCRR Part 56). It is subject to suspension or revocation for a (1) serious violation of state, federal or local laws with regard to the conduct of an asbestos project, or (2) demonstrated lack of responsibility in the conduct of any job involving asbestos or asbestos material.

This license is valid only for the contractor named above and this license or a photocopy must be prominently displayed at the asbestos project worksite. This license verifies that all persons employed by the licensee on an asbestos project in New York State have been issued an Asbestos Certificate, appropriate for the type of work they perform, by the New York State Department of Labor.



Eileen M. Franko, Director
For the Commissioner of Labor

**CORPORATE/
BUFFALO OFFICE**
5167 South Park Avenue
Hamburg, NY 14075
Phone: (716)-649-8110
Fax: (716) 649-8051

ALBANY OFFICE
P.O. Box 2199
Ballston Spa, NY 12020

5 Knabner Road
Mechanicville, NY 12118
Phone: (518) 899-7491
Fax: (518) 899-7496

CORTLAND OFFICE
60 Miller Street
Cortland, NY 13045
Phone: (607) 758-7182
Fax: (607) 758-7183

ROCHESTER OFFICE
555 Summit Point Drive
Henrietta, NY 14467
Phone: (585) 359-2730
Fax: (585) 359-9688

STATE OF NEW YORK DEPARTMENT OF LABOR
ASBESTOS CERTIFICATE

NY
LABOR



ANDREW J KOONS
CLASS(EXPIRES)
C ATEC(03/16) D INSP(03/16)
H PM' (03/16)

DATE 11-24-15
BA004 12 474675

MUST BE CARRIED ON ASBESTOS PROJECTS



01213 000415357 00

EYES HAZ
HAIR BRO
HGT 5' 01"

IF FOUND RETURN TO:
NYSDEL - LSC UNIT
ROOM 161A BUILDING 12
STATE OFFICE CAMPUS
ALBANY NY 12240