

Final- Approved

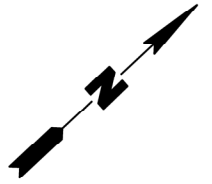

EXCHANGE STREET (60.0')

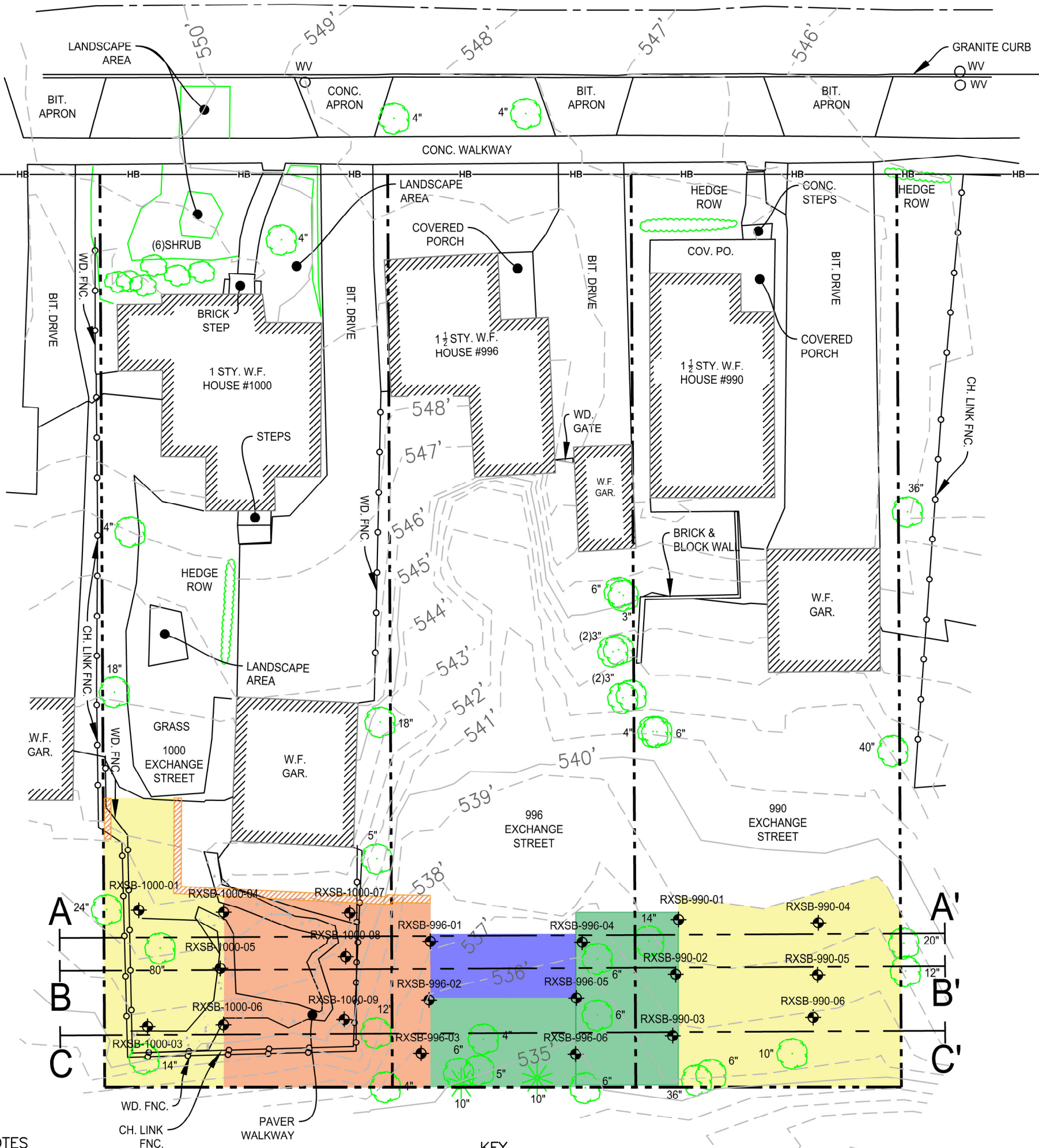

NOTES

- HORIZONTAL DATUM IS REFERENCED TO THE NORTH AMERICAN DATUM OF 1983 (NAD83), NY WESTERN ZONE, US SURVEY FEET. ESTABLISHED BY UTILIZING THE NEW YORK STATE DEPARTMENT OF TRANSPORTATION REAL TIME NETWORK (NYSNET RTN).
- VERTICAL DATUM IS REFERENCED TO THE NORTH AMERICAN VERTICAL DATUM OF 1988 (NAVD88).
- INFORMATION SHOWN HERE ON WAS SURVEYED ON JUNE 21, 2021.
- RIGHT OF WAY AND PROPERTY LINES ARE SHOWN FROM VISIBLE FIELD EVIDENCE AND CURRENT DEEDS OF RECORD. SURVEY IS NOT FOR TRANSFER OF TITLE.
- UTILITIES HERE ON ARE SHOWN FROM VISIBLE FIELD EVIDENCE & INFORMATION PROVIDED BY OTHERS.
- BASE MAP SOURCE: WENDEL'S EXISTING CONDITIONS SURVEY JUNE 21, 2021 PROJECT NO. 494505 DWG NO. V-100
- TERMINAL EXCAVATION DEPTHS WILL BE OVER DUG IN SOME AREAS TO SIMPLIFY THE EXCAVATION FOR SUBCONTRACTOR COMPLETION
- ACTUAL LIMITS OF EXCAVATION AT 1000 EXCHANGE WILL BE BASED ON A SAFE DISTANCE FROM THE STRUCTURES AS DETERMINED BY AN ENGINEER

LEGEND

	BORING LOCATION	540	MAJOR CONTOURS
	CONIFEROUS TREE	538	MINOR CONTOURS
	DECIDUOUS TREE		PROPERTY LINE
	SHRUB		FENCE LINE
	WATER VALVE		

KEY

	REQUIRED DEPTH OF EXCAVATION 0-1 FT BGS (SEE NOTE 7)		REQUIRED DEPTH OF EXCAVATION 0-4 FT BGS (SEE NOTE 7)
	REQUIRED DEPTH OF EXCAVATION 0-2 FT BGS (SEE NOTE 7)		REQUIRED DEPTH OF EXCAVATION 0-6 FT BGS (SEE NOTE 7)
	LIMIT OF EXCAVATION NEAR STRUCTURES		



Title:		
SITE PLAN - EXISTING CONDITIONS		
990, 996, AND 1000 EXCHANGE STREET ROCHESTER, NY		
Prepared for ExxonMobil Environmental and Property Solutions Company		
	Compiled by: CC Project Mgr: GV File: 0172.0180M013.108.XX.DWG	Date: 07/20/2021 Scale: AS SHOWN Project: 0172.0180M013
FIGURE		1

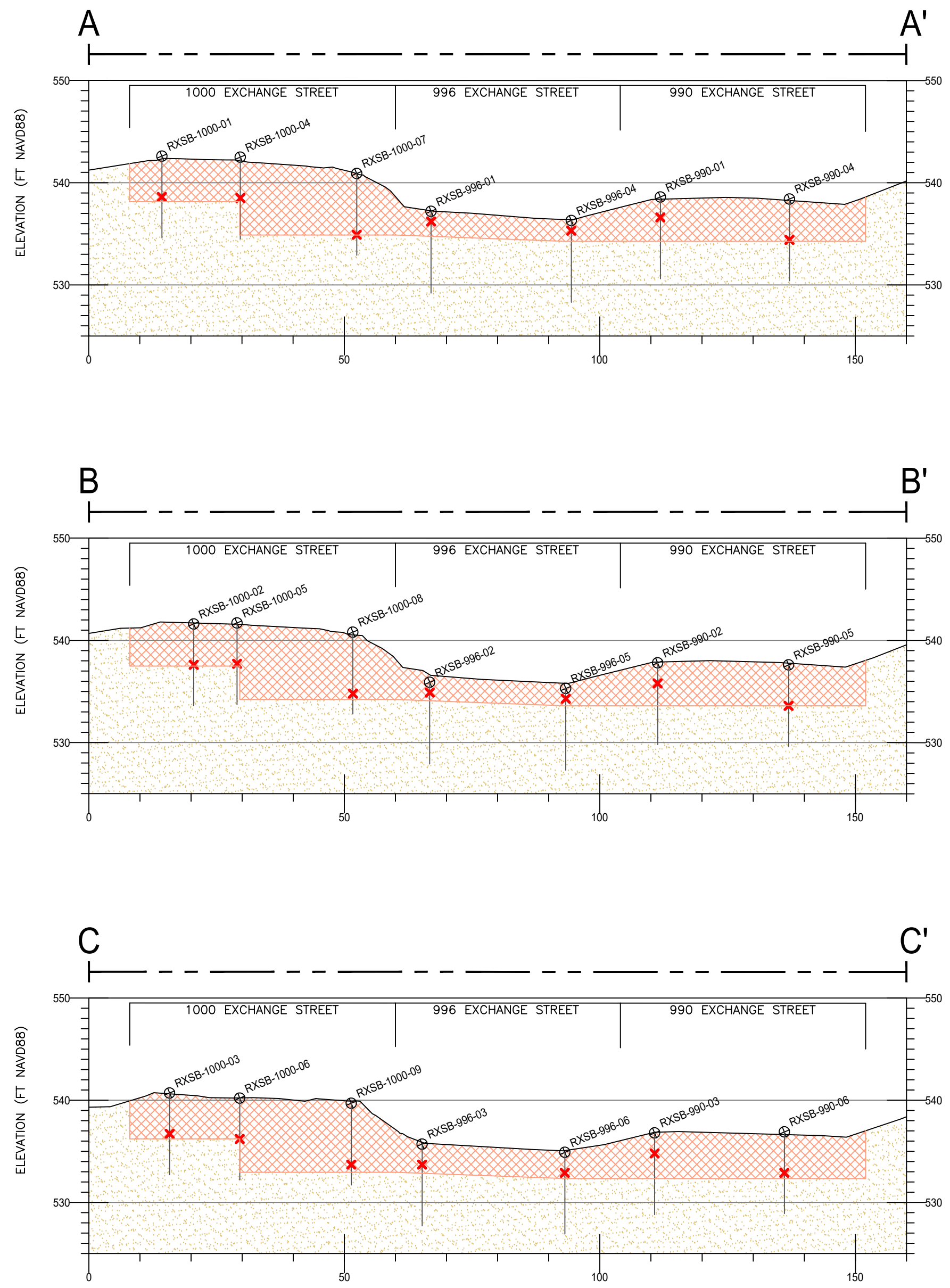

PROFILE LEGEND
VERTICAL EXAGGERATION = 2X

TYPICAL SOIL BORING

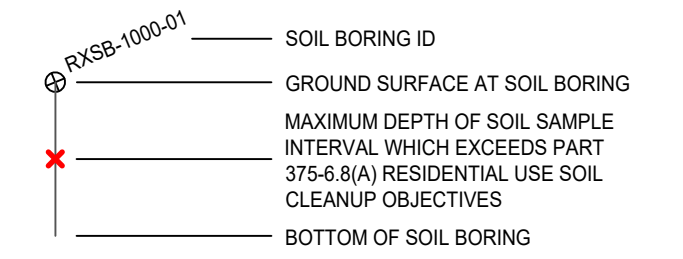

SOIL TYPES

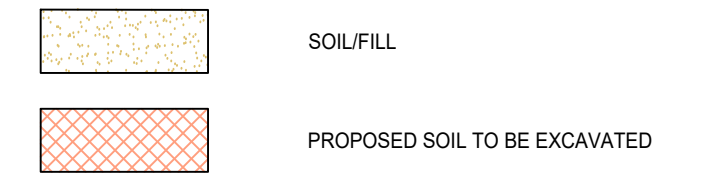

DRAFT

SOURCE INFORMATION

1. BASE MAP SOURCE: WENDEL'S EXISTING CONDITIONS SURVEY JUNE 21, 2021 PROJECT NO. 494505 DWG NO. V-100 SCALE 1"=20'.

NOTES

1. TERMINAL EXCAVATION DEPTHS WILL BE OVER DUG IN SOME AREAS TO SIMPLIFY THE EXCAVATION FOR SUBCONTRACTOR COMPLETION

Title:			
SITE PROFILES - EXCAVATION AREAS			
990, 996 AND 1000 EXCHANGE STREET ROCHESTER, NY			
Prepared for:			
EXXONMOBIL OIL CORP - MKTG & REF			
Compiled by: GV	Date: 10-04-2021	PLATE	
Prepared by: WH	Scale: AS SHOWN	2	
Project Mgr: GV	Project: 0172.0180M013		
File: 0172.0180M013.108.XX.DWG			

T:\PROJECTS\EXXONMOBIL_T2\ROCHESTER, NY\ACQUIN OIL TERMINAL\MATERIAL\2014-005\10_01\ONE FLINT STREET LLC (DHD)_LEG-000\RESIDENTIAL PROPERTIESEXCAVATION DRAWINGS\2021-10-01\REVISION\0172.0180M013.108.XX.DWG

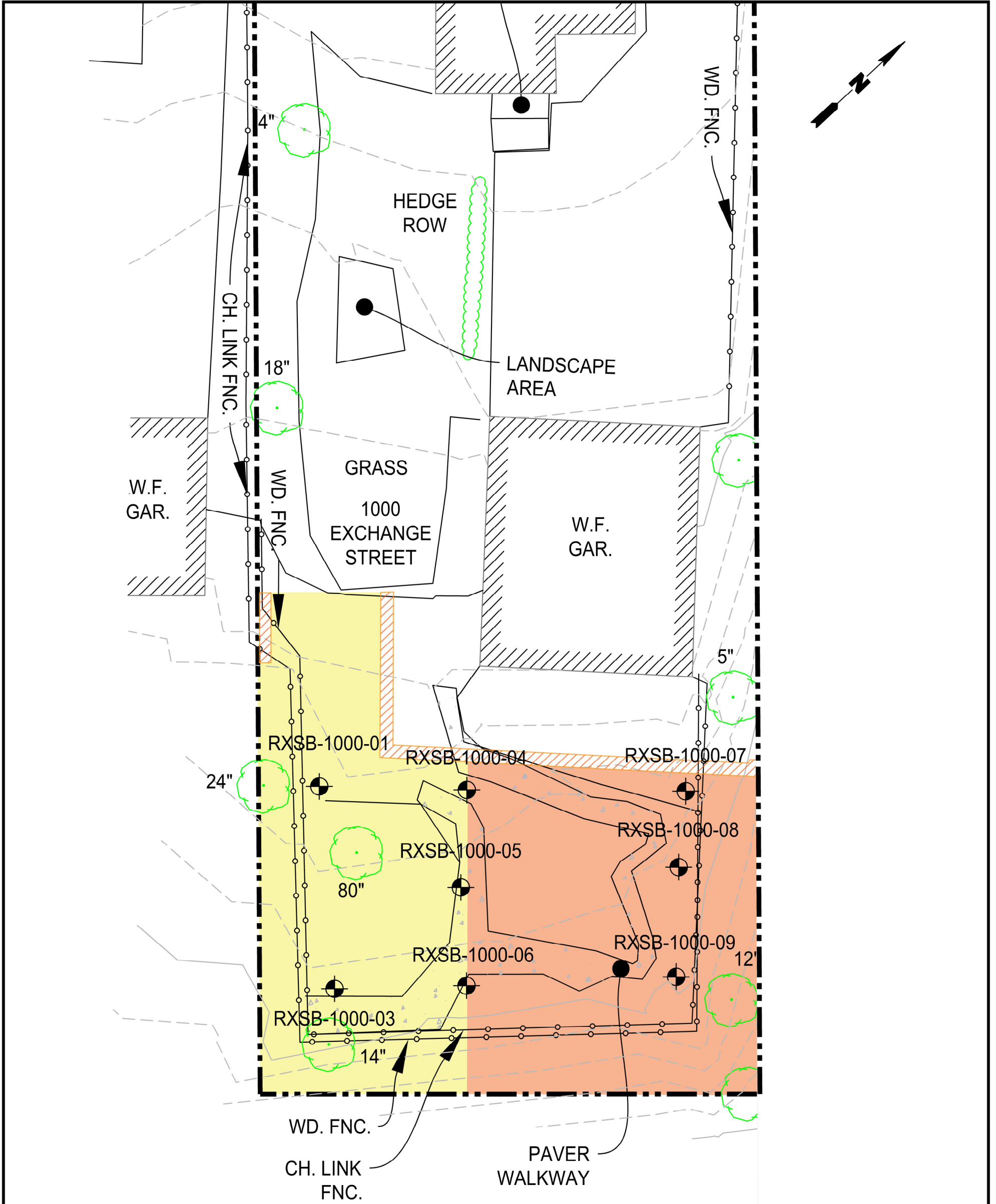

NOTES

1. HORIZONTAL DATUM IS REFERENCED TO THE NORTH AMERICAN DATUM OF 1983 (NAD83), NY WESTERN ZONE, US SURVEY FEET. ESTABLISHED BY UTILIZING THE NEW YORK STATE DEPARTMENT OF TRANSPORTATION REAL TIME NETWORK (NYSNET RTN).
2. VERTICAL DATUM IS REFERENCED TO THE NORTH AMERICAN VERTICAL DATUM OF 1988 (NAVD88).
3. INFORMATION SHOWN HERE ON WAS SURVEYED ON JUNE 21, 2021.
4. RIGHT OF WAY AND PROPERTY LINES ARE SHOWN FROM VISIBLE FIELD EVIDENCE AND CURRENT DEEDS OF RECORD. SURVEY IS NOT FOR TRANSFER OF TITLE.
5. UTILITIES HERE ON ARE SHOWN FROM VISIBLE FIELD EVIDENCE & INFORMATION PROVIDED BY OTHERS.
6. BASE MAP SOURCE: WENDEL'S EXISTING CONDITIONS SURVEY JUNE 21, 2021 PROJECT NO. 494505 DWG NO. V-100
7. TERMINAL EXCAVATION DEPTHS WILL BE OVER DUG IN SOME AREAS TO SIMPLIFY THE EXCAVATION FOR SUBCONTRACTOR COMPLETION
8. ACTUAL LIMITS OF EXCAVATION AT 1000 EXCHANGE WILL BE BASED ON A SAFE DISTANCE FROM THE STRUCTURES AS DETERMINED BY AN ENGINEER
9. THE PLANNED EXCAVATION ON 1000 EXCHANGE STREET WAS EVALUATED RELATIVE TO THE GARAGE STRUCTURES ON 1000 AND 1010 EXCHANGE STREET DURING THE DESIGN PHASE. AS NO DRAWINGS ARE AVAILABLE TO DOCUMENT THE DETAILS OF THE GARAGE FOUNDATIONS FOR EITHER STRUCTURE, THEY WERE ASSUMED TO BE SLAB ON GRADE CONSTRUCTION. TYPE C SOIL WAS ASSUMED. BASED ON THAT EVALUATION, THE FOLLOWING EXCAVATION OFFSETS APPLY TO THE TWO PROPERTIES:
 - NO EXCAVATION SHALL OCCUR WITHIN 10 FEET OF THE GARAGE ON 1000 EXCHANGE STREET
 - NO EXCAVATION SHALL OCCUR WITHIN 7 FEET OF THE GARAGE ON 1010 EXCHANGE STREET
 ADDITIONALLY, TRENCH BOXES WILL BE USED WHILE EXCAVATING BETWEEN 10 AND 15 FEET AWAY FROM THE 1000 EXCHANGE STREET GARAGE AS SLOPING THE EXCAVATION IS NOT FEASIBLE AND EXCAVATION WILL BE BACKFILLED IMMEDIATELY

LEGEND

- BORING LOCATION 540
- CONIFEROUS TREE 538
- DECIDUOUS TREE
- SHRUB
- WATER VALVE
- MAJOR CONTOURS
- MINOR CONTOURS
- PROPERTY LINE
- FENCE LINE

KEY

- REQUIRED DEPTH OF EXCAVATION 0-2 FT BGS (SEE NOTE 7)
- LIMIT OF EXCAVATION NEAR STRUCTURES
- REQUIRED DEPTH OF EXCAVATION 0-4 FT BGS (SEE NOTE 7)
- REQUIRED DEPTH OF EXCAVATION 0-6 FT BGS (SEE NOTE 7)

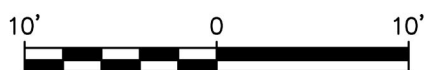

Title: **SITE PLAN - EXISTING CONDITIONS**

990, 996, AND 1000 EXCHANGE STREET
ROCHESTER, NY

Prepared for
ExxonMobil Environmental and Property Solutions Company

Compiled by: CC	Date: 07/20/2021	FIGURE 1
Prepared by: CC	Scale: AS SHOWN	
Project Mgr: GV	Project: 0172.0180M013	
File: 0172.0180M013.108.XX.DWG		

DRAFT

Table 1. Summary of Soil Analytical Data. ExxonMobil; Rochester, New York.

Table with columns for Sample ID, Sample Depth (ft bgs), Lab Sample ID, Sample Date, and various metal and organic compound concentrations (e.g., Aluminum, Arsenic, Barium, Beryllium, Cadmium, Calcium, Chromium, Cobalt, Copper, Iron, Lead, Magnesium, Manganese, Nickel, Potassium, Selenium, Silver, Sodium, Thallium, Vanadium, Zinc, Mercury, and various VOCs).

Table 1. Summary of Soil Analytical Data. ExxonMobil; Rochester, New York.

Table with columns for Sample ID, Sample Depth (ft bgs), Lab Sample ID, Sample Date, and various VOCs (mg/kg) across different depths and locations. Includes a list of Volatile Organic Compounds and their concentrations.

Notes:
in or ft bgs = Inches or Feet below ground surface.
% = Percent.
mg/kg = Milligrams per kilogram.
Red Text indicate value above Part 375-6.8(a) Unrestricted Use Soil Cleanup Objectives.
Orange highlighted cells indicate value above Part 375-6.8(a) Residential Use Soil Cleanup Objectives.
- = Sample not analyzed.
ND = Not detected.
NS = No standard currently established.
U = Not detected above laboratory detection limit.
U = Laboratory reporting limit exceeds the applicable regulatory standard or criteria being utilized.
J = Indicates result is less than the RL but greater than or equal to the MDL and the concentration is an approximate value.
Bold = Detected concentration.
When the applicable state standard applies to mixed isomers and the laboratory reports individual isomers, the total standard is listed for each isomer.



Table 1. Summary of Soil Analytical Data. ExxonMobil; Rochester, New York.

Table with columns for Sample ID, Sample Depth (ft bgs), Lab Sample ID, Sample Date, and various chemical analytes (Metals, Semi-volatile Organic Compounds) across multiple sampling locations (RXSB-1000-05 to RXSB-1000-09).

Table 1. Summary of Soil Analytical Data. ExxonMobil; Rochester, New York.

Table with columns for Sample ID, Depth (ft bgs), Lab Sample ID, Sample Date, and various VOCs (mg/kg) including 1,1,1-Trichloroethane, 1,1,2-Trichloroethane, etc.

Notes: in or ft bgs = Inches or Feet below ground surface. % = Percent. mg/kg = Milligrams per kilogram. Red Text indicate value above Part 375-6.8(a) Unrestricted Use Soil Cleanup Objectives.

DRAFT

Table 1. Summary of Soil Analytical Data. ExxonMobil; Rochester, New York.

Table with columns for Sample ID, Sample Depth (ft bgs), Lab Sample ID, Sample Date, and various chemical analytes (Metals, Semi-volatile Organic Compounds) with their respective concentrations and units.

DRAFT

Table 1. Summary of Soil Analytical Data. ExxonMobil; Rochester, New York.

Table with columns for Sample ID, Sample Depth (ft bgs), Lab Sample ID, Sample Date, and various chemical compounds (Volatile Organic Compounds) with their respective concentrations in mg/kg across multiple sampling locations.

Notes:
in or ft bgs = Inches or Feet below ground surface.
% = Percent.
mg/kg = Milligrams per kilogram.
Red Text indicate value above Part 375-6.8(a) Unrestricted Use Soil Cleanup Objectives.
Orange highlighted cells indicate value above Part 375-6.8(a) Residential Use Soil Cleanup Objectives.
--- = Sample not analyzed.
ND = Not detected.
NS = No standard currently established.
U = Not detected above laboratory detection limit.
U = Laboratory reporting limit exceeds the applicable regulatory standard or criteria being utilized.
J = Indicates result is less than the RL but greater than or equal to the MDL and the concentration is an approximate value.
Bold = Detected concentration.
When the applicable state standard applies to mixed isomers and the laboratory reports individual isomers, the total standard is listed for each isomer.

Table 1. Summary of Soil Analytical Data. ExxonMobil; Rochester, New York.

Table with columns for Sample ID, Sample Depth (ft bgs), Lab Sample ID, Sample Date, and various chemical analytes (Metals, Semi-Volatile Organic Compounds) with their respective concentrations and units.

DRAFT

Table 1. Summary of Soil Analytical Data. ExxonMobil; Rochester, New York.

Table with columns for Sample ID, Sample Depth (ft bgs), Lab Sample ID, Sample Date, and various chemical compounds (e.g., Volatile Organic Compounds, Acetone, Benzene, etc.) with their respective concentrations in mg/kg.

Notes:
in or ft bgs = Inches or Feet below ground surface.
% = Percent.
mg/kg = Milligrams per kilogram.
Red Text indicate value above Part 375-6.8(a) Unrestricted Use Soil Cleanup Objectives.
Orange highlighted cells indicate value above Part 375-6.8(a) Residential Use Soil Cleanup Objectives.
-- = Sample not analyzed.
ND = Not detected.
NS = No standard currently established.
U = Not detected above laboratory detection limit.
U = Laboratory reporting limit exceeds the applicable regulatory standard or criteria being utilized.
J = Indicates result is less than the RL but greater than or equal to the MDL and the concentration is an approximate value.
Bold = Detected concentration.
When the applicable state standard applies to mixed isomers and the laboratory reports individual isomers, the total standard is listed for each isomer.



Table 1. Summary of Soil Analytical Data. ExxonMobil; Rochester, New York.

Table with columns for Sample ID, Depth, Lab Sample ID, Sample Date, and 20 columns of analytical data for various compounds like VOCs, SVOCs, and PCBs.

Notes: in or ft bgs = Inches or Feet below ground surface. % = Percent. mg/kg = Milligrams per kilogram. Red Text indicate value above Part 375-6.8(a) Unrestricted Use Soil Cleanup Objectives. Orange highlighted cells indicate value above Part 375-6.8(a) Residential Use Soil Cleanup Objectives.