

October 11, 2004

**MAESTRI SITE  
NYSDEC SITE No. 7-34-025**

Dear Residents of Alhan Parkway:

This notice is part of our continuing effort to keep you informed of activities at the Maestri Inactive Hazardous Waste Site. Stauffer Management Company (SMC) representatives sampled the groundwater at the four (4) off-site monitoring wells (MW-16, MW-17, MW-18 and MW-20) located between the homes in Alhan Parkway (#145 through 151) and shown on the attached drawing (Figure 1). Notification was issued to those residences on April 12<sup>th</sup> with the sampling conducted on April 27, 2004. The analytical results showed no contaminants (volatile or semi volatile compounds using EPA method 860/8270) detected in any of the wells sampled, as was the case in 1999 when these wells were sampled. In June 2004, SMC transmitted the most recent analytical results to the NYS Departments of Environmental Conservation (NYSDEC ) and Health (NYSDOH).

The NYSDEC and NYSDOH have reviewed the well data and approved abandonment of four (4) monitoring wells (MW-16, MW-17, MW-18 and MW-20).

SMC requested two additional off-site wells (MW-15 located next to MW-16 and MW-19 located next to MW-18) and shown on Figure 1 be reviewed by the NYSDEC and NYSDOH for abandonment. NYSDEC requested that these wells be sampled and if no contaminants (volatile or semi volatile compounds using EPA method 860/8270) were detected then they could also be abandoned. SMC sampled these wells on September 30, 2004. No contaminants were detected in either of the wells sampled. SMC transmitted the analytical results to the NYSDEC and NYSDOH.

Abandonment will involve removing MW-20 and restoring the surrounding distributed area which is anticipated to be approximately 4' x 4'. Due to limited access of the remaining wells (MW-15 through 19) abandonment will be achieved by tremi grouting the wells (filling and sealing the wells with grout).

**STAUFFER MANAGEMENT COMPANY LLC**

Environmental Services & Operations  
1800 Concord Pike  
Wilmington, DE 19850-5437

The activities described above will occur on October 14, 2004 and take one day to complete.

The well analytical data is available upon request to the NYSDEC.

If you have any questions or concerns please do not hesitate to contact the following people:

Tom Haldas	Project Manager SMC	1-302-886-4238
David Chiusano	NYSDEC	1-518-402-9813

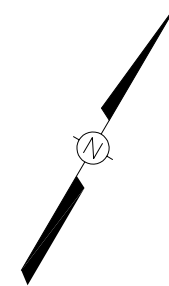
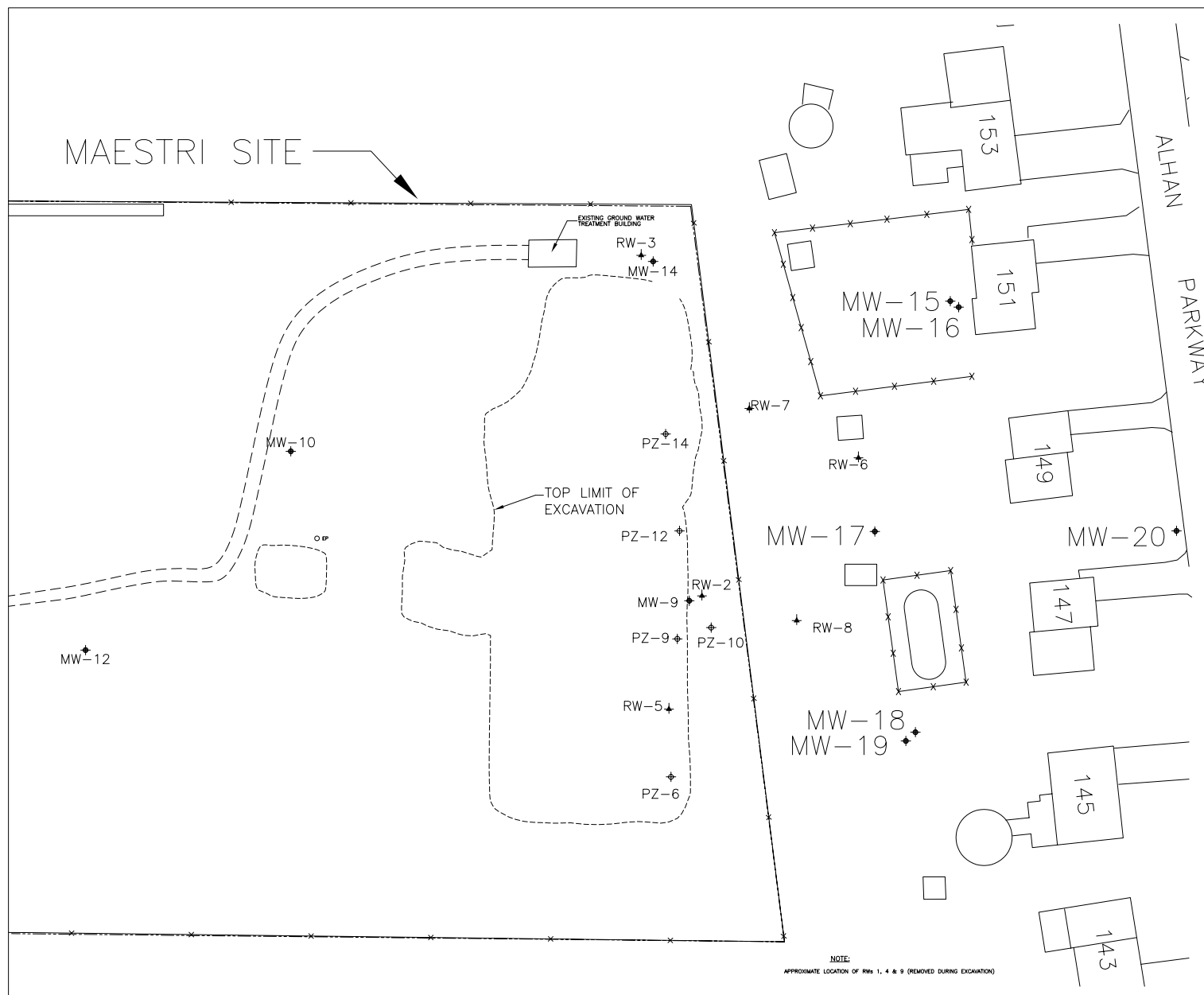

- LEGEND**
- ♦ MONITORING WELL
  - ♦ RECOVERY WELL
  - ♦ PIEZOMETER
  - MAESTRI SITE PROPERTY
  - BOUNDARY
  - 8' HIGH SECURITY FENCE
  - ° EP ELECTRIC POLE

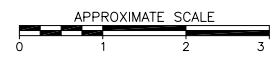

STAUFFER  
MANAGEMENT COMPANY

BASE MAP PROVIDED BY IT CORPORATION

FIGURE 1

GROUNDWATER WELL LOCATIONS

MAESTRI SITE  
904 STATE FAIR BLVD.  
GEDDES, NEW YORK