

**Public Meeting  
Invitation**

**Wednesday, January  
27, 1999  
7:00 p.m.**

**Plattsburgh City Hall  
City Hall Plaza  
Plattsburgh, NY**



*The NYS Departments of Environmental Conservation and Health (NYSDEC and NYSDOH) will discuss the Proposed Remedial Action Plan (PRAP) for Operable Unit #2 of the Cumberland Bay Sludge Bed - Wilcox Dock Site. At the meeting representatives from NYSDEC and NYSDOH will:*

- describe results of detailed site investigations;
- explain the Proposed Remedial Action Plan (PRAP);
- answer your questions about the PRAP;
- receive your verbal or written comments about the proposal.

**Public Comment  
Period**

**From:** January 15, 1999  
**To:** February 16, 1999

Edwards

**FACT SHEET**

Cumberland Bay Sludge Bed

Wilcox Dock Site, Operable Unit - 2  
Site # 5-10-017 Plattsburgh, NY

January 1999

NYSDEC, Region 5, Clinton County

**Remedial Action Proposed  
for the Cumberland Bay  
Sludge Bed - Wilcox Dock  
Site, Operable Unit # 2**



**Public Meeting, Comment Period Announced**



The New York State Department of Environmental Conservation (NYSDEC), working cooperatively with the New York State Department of Health (NYSDOH), has proposed No Further Action as the preferred remedy for Operable Unit # 2 of the Cumberland Bay Sludge Bed - Wilcox Dock Site in Plattsburgh, New York.

**The Proposed Action:** Operable Unit # 2 of the Cumberland Bay Sludge Bed - Wilcox Dock Site consists of the Cumberland Bay beaches and the former beach debris disposal area at the Cumberland Bay State Park. Under this proposal, the current beach cleaning Interim Remedial Measure (IRM) will continue, however, no additional remedial activities are required. The proposal is described in the site's "Proposed Remedial Action Plan" (PRAP). The PRAP was developed following the Remedial Investigation for Operable Unit # 2.

*The full PRAP is available for your review at the document repositories listed below.*

**Your Opportunities to Comment on the Proposed Remedy:** Release of the PRAP begins a process to finalize selection of the remedy for Operable Unit # 2. *Your comments and input about the proposed remedy are important and encouraged.*

Your oral and written comments about the PRAP are welcome at the **public meeting** (see sidebar) and during a **public comment period** which runs until February 16, 1999. Written comments also may be sent until the end of the comment period by addressing them to:

Mr. Robert Edwards  
NYSDEC Division of Hazardous Waste Remediation  
50 Wolf Road, Albany, NY 12233-7010

**What Happens Next:** All comments received during the public comment period will be considered as the remedy for Operable Unit #2 of the Cumberland Bay Sludge Bed Site is finalized. Public input will be factored into a Record of Decision (ROD) which will describe the remedy selected and why it was chosen. A Responsiveness Summary will be prepared to provide response to public comments received. Work will then continue to design the selected remedy.

**Document Repositories:** (To access the complete PRAP and other site information.)

Plattsburgh Public Library; Oak and Brinkerhoff St. Plattsburgh, NY 12901

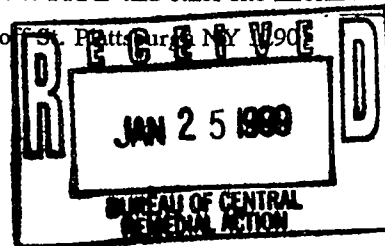

NYSDEC Region 5 Headquarters; Route 86, Raybrook, NY 12907

NYSDEC Central Office; 50 Wolf Rd. Albany NY 12233

**For More Information:** Call or write the following staff for more information about:

**Meeting/Comment Period/PRAP:**

Mr. Robert Edwards  
NYSDEC, Div. Environmental Remediation,  
50 Wolf Road, Albany, NY 12233-7010  
(518)457-5677; 1(800)342-9296

**Health-Related Concerns:**

Mr. Richard Fedigan  
NYSDOH, BEEI,  
2 University Place,  
Albany, NY 12203-3313 (518)458-6306;  
1(800)458-1158, ext. 306

## Summary of Proposed Remedial Action

The Proposed Remedial Action Plan (PRAP) describes the method preferred by NYSDEC and NYSDOH to remediate hazardous waste contamination for Operable Unit # 2 of the Cumberland Bay Sludge Bed - Wilcox Dock Site (see map of site on page 4). The proposed action was chosen following a detailed investigation of the site.

Elements of the proposed plan include:

- Continuation of the current beach cleaning IRM.
- No Remedial Action is warranted at the former beach debris disposal area at the Cumberland Bay State Park.
- No additional remedial action is required for the beaches of Cumberland Bay other than the beach cleaning IRM.

## Site Investigation

NYSDEC concluded a detailed investigation of the Cumberland Bay beaches and the former beach debris disposal at the Cumberland Bay State Park in 1997 and 1998 per current New York State and United States Environmental Protection Agency guidelines and requirements.

Highlights of the remedial investigation included:

- soil borings and soil sampling and analysis at the former beach debris disposal area; beach sampling and analysis (includes surface and subsurface beach sands);
- habitat survey/mapping;
- environmental risk assessment;
- human health risk assessment.

## Site History

The Cumberland Bay Sludge Bed - Wilcox Dock Site is located in the Cumberland Bay of Lake Champlain within the City of Plattsburgh. The bed is composed of wood pulp, wood chip debris and other processing wastes from local wood processing industries. These processing waste discharges occurred for several decades creating the sludge bed. Untreated waste disposal ended in the 1970's. Environmental sampling of the sludge bed in 1992 detected high concentrations of polychlorinated biphenyls (PCBs) in the sludge.

NYSDEC and NYSDOH conducted additional sampling and analysis during 1993 and 1994 and confirmed the PCB contamination of the sludge bed and the contamination of the debris washing up on the beaches of Cumberland Bay.

The site was added to the Registry of Inactive Hazardous Waste Disposal Sites in 1994, the beach cleaning IRM was initiated in 1995, a remedial investigation /feasibility study of the sludge bed was completed and a Record of Decision was signed in 1997 for the sludge bed remediation (OU-1).

The remedial investigation for OU-2 was completed in 1998. The results of the remedial investigation indicate that the beach sands are not contaminated above NYSDEC action levels and that the current beach cleaning IRM is sufficient to address the potential health risk from the contaminated debris washing up on the beaches from the sludge bed.

The remedial investigation also determined that the former beach debris disposal did receive contaminated debris from the beaches, however, the concentrations were also below NYSDEC action levels.

Based on the results of the RI, previous investigations and the ongoing IRM, the NYSDEC is proposing that no further action as the preferred remedial alternative for Operable Unit #2 of the site. The current beach cleaning IRM will continue until it is determined unnecessary by the NYSDOH.

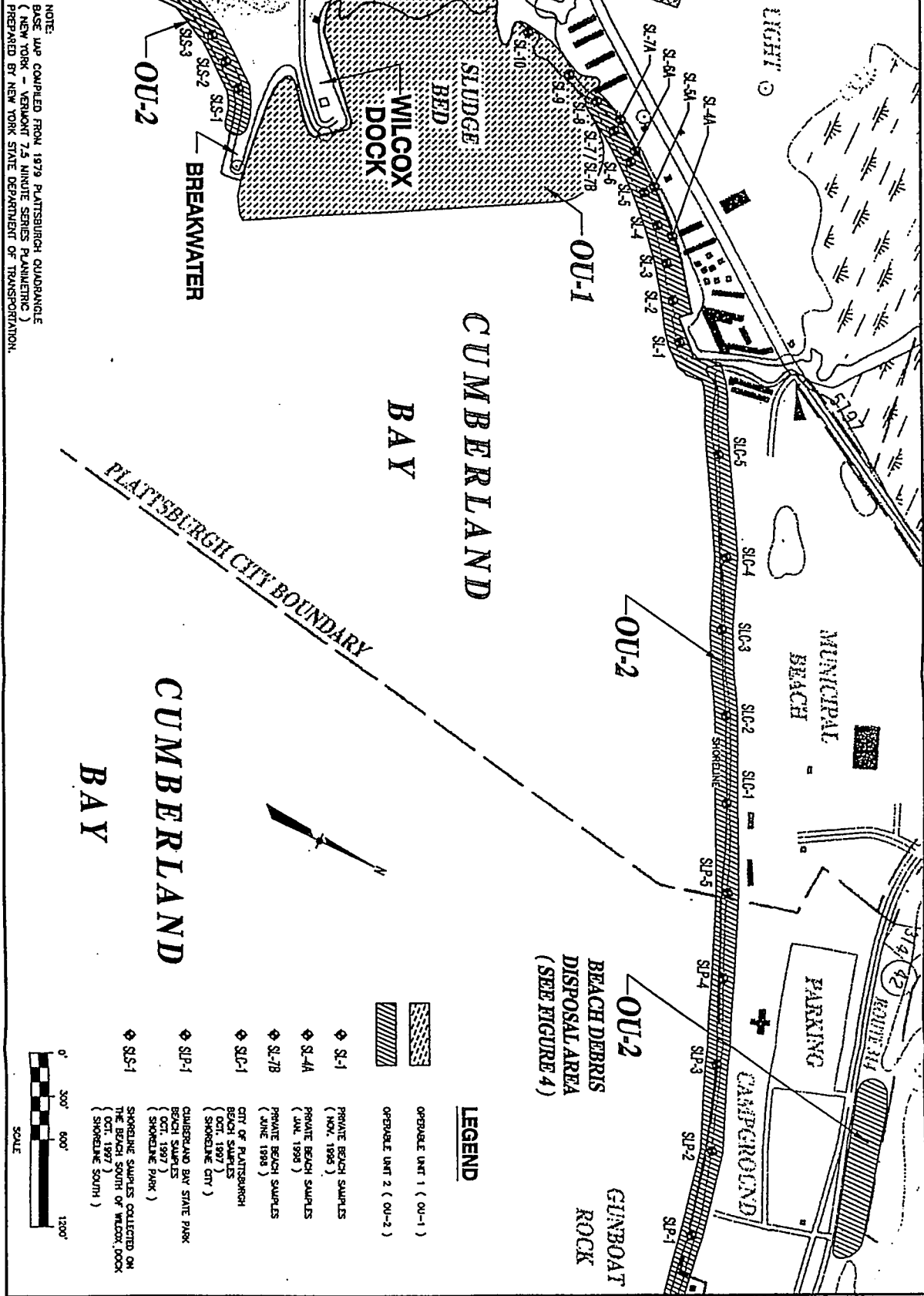

NOTE:  
 BASE MAP COMPILED FROM 1979 PLATTSBURGH QUADRANGLE  
 ( NEW YORK - VERMONT 7.5 MINUTE SERIES PLANIMETRIC )  
 PREPARED BY NEW YORK STATE DEPARTMENT OF TRANSPORTATION.

CUMBERLAND BAY

CUMBERLAND BAY

◆ SLP-1 CUMBERLAND BAY STATE PARK  
 BEACH SAMPLES  
 ( JUNE 1998 )  
 ( SHORELINE PARK )  
 ◆ SLP-4 CUMBERLAND BAY STATE PARK  
 BEACH SAMPLES  
 ( OCT. 1997 )  
 ( SHORELINE SOUTH )

◆ SL-1 PRIVATE BEACH SAMPLES  
 ( NOV. 1995 )  
 ◆ SL-4A PRIVATE BEACH SAMPLES  
 ( JAN. 1998 )  
 ◆ SL-7B PRIVATE BEACH SAMPLES  
 ( JUNE 1998 )  
 ◆ SLP-1 CTR. OF PLATTSBURGH  
 BEACH SAMPLES  
 ( OCT. 1997 )  
 ( SHORELINE CITY )

▨ OPERABLE UNIT 1 ( OU-1 )  
 ▨ OPERABLE UNIT 2 ( OU-2 )

**LEGEND**

OU-2 BEACH DEBRIS DISPOSAL AREA (SEE FIGURE 4)

**FIGURE 2**  
**OPERABLE UNITS**