



---

**REMEDIAL CONSTRUCTION**

---

**FINAL REMEDIATION REPORT**

---

**WORK ASSIGNMENT D004440-19**

**CAMP SUMMIT REMEDIATION SITE  
TOWN OF FULTON  
CONTRACT D005595**

**SITE NO. 4-48-006  
SCHOHARIE COUNTY, NY**

Prepared for:  
NEW YORK STATE  
DEPARTMENT OF ENVIRONMENTAL CONSERVATION  
625 Broadway, Albany, New York

---

**DIVISION OF ENVIRONMENTAL REMEDIATION**

---

**URS Corporation**  
77 Goodell Street  
Buffalo, New York 14203

**Final  
March 2007**

**CAMP SUMMIT REMEDIAL CONSTRUCTION**

**D004440-19**

**FINAL REMEDIATION REPORT**

**FOR**

**CONSTRUCTION PHASE ENGINEERING SERVICES**

**CAMP SUMMIT REMEDIAL CONSTRUCTION**

**DEC SITE NO. 4-48-006**

**FULTON (T), SCHOHARIE (C), NEW YORK**

**SUBMITTED BY:**

**URS CORPORATION  
77 GOODELL STREET  
BUFFALO, NEW YORK 14203**

**MARCH 2007**

**CERTIFICATION OF CONSTRUCTION QUALITY ASSURANCE**  
**AT**  
**CAMP SUMMIT**  
**REMEDIAL ACTION CONSTRUCTION**  
**TOWN OF FULTON, SCHOHARIE COUNTY, NEW YORK**

URS Corporation (URS) personnel and its subcontractors have inspected the Camp Summit Site Remedial Construction according to generally accepted practices. Based on field observations and inspections made by onsite personnel, field and laboratory test data, and data provided by the Contractor and its subcontractors, URS certifies that the remedial action construction at the site has been performed in substantial compliance with the NYSDEC approved Contract Documents, Record of Decision, and as stated in this report.

SEAL

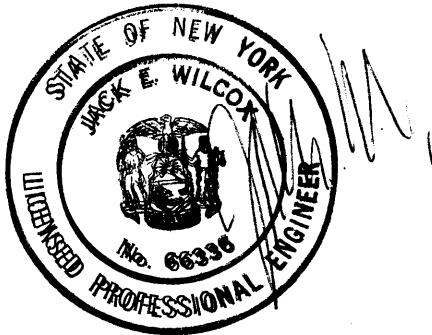

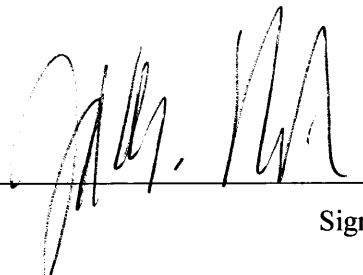
  
\_\_\_\_\_  
Signature

MARCH 2007

## TABLE OF CONTENTS

	<u>Page No.</u>
CERTIFICATION	
1.0 INTRODUCTION .....	1-1
1.1 Remedial Construction Contractors .....	1-1
1.2 Site Description .....	1-2
1.3 Description of the Remedial Action.....	1-2
2.0 PRE-CONSTRUCTION ACTIVITIES .....	2-1
2.1 Pre-Construction Meeting.....	2-1
3.0 CONSTRUCTION ACTIVITIES.....	3-1
3.1 Narrative Description of Construction .....	3-2
3.2 Submittals.....	3-6
3.2.1 Shop Drawings.....	3-6
3.2.2 Plans.....	3-7
3.3 Geosynthetics.....	3-7
3.3.1 Construction .....	3-7
3.4 Pre-Engineered Buildings.....	3-7
3.4.1 Contract Modifications.....	3-7
3.4.2 Construction .....	3-8
3.5 Final Cover .....	3-9
3.5.1 Contract Modifications.....	3-9
3.5.2 Construction .....	3-9
3.5.3 CQA/CQC Testing and Results.....	3-9
3.6 Utilities .....	3-9
3.6.1 Electric and Telephone.....	3-9
3.6.2 Water.....	3-10
3.7 Other Items .....	3-10
3.7.1 Perimeter Access Road.....	3-10
3.7.2 Stormwater Management System .....	3-10
3.8 Confirmatory Sampling .....	3-10
3.9 Final Charge Orders.....	3-11

## **APPENDICES**

- Appendix A Bid Tabulation and Schedule of Values
- Appendix B Meeting Minutes (on CD)
- Appendix C Daily Inspection Reports and Photo Logs (on CD)
- Appendix D Daily Air Monitoring Reports and Station Location Maps (on CD)
- Appendix E Daily Health and Safety Reports (on CD)
- Appendix F Groundwater and Soil Sampling Analytical Reports (on CD), Confirmation Sampling Maps
- Appendix G Documentation Sampling Summary, Analytical Reports, and Location Maps (on CD)
- Appendix H Monitoring Well Boring Logs, Well Construction Diagrams, Development Logs, Field Notes, and Chains of Custody (on CD)
- Appendix I Submittal Log
- Appendix J All PCOs, PCO Log, Change Order #1 (on CD)
- Appendix K All Requests for Information (RFIs) and Responses

## **RECORD DRAWINGS**

(Will Be Submitted Under Separate Cover)

## **DATA USABILITY SUMMARY REPORTS (DUSRS)**

(Will Be Submitted Under Separate Cover)

## **ENGINEER DAILY INSPECTION REPORTS AND PHOTOGRAPH LOG**

(Submitted Under Separate Cover on March 1, 2007)

**FINAL REMEDIATION REPORT**  
**CAMP SUMMIT REMEDIAL CONSTRUCTION**  
**NYSDEC SITE NO. 4-48-006**

**1.0 INTRODUCTION**

This report documents the remedial activities completed at the Camp Summit Site. URS Corporation (URS) provided construction engineering and oversight services under New York State Department of Environmental Conservation (NYSDEC) Work Assignment No. D004440-19.

This report was prepared in accordance with the Project Management Work Plan and Budget for Construction Phase Engineering Services (URS, March 2006)). In accordance with Task 2 as outlined in this plan, this report includes a site description, the name of the Contractor, the amount of the low bid, a brief narrative summary of the work performed at the site, a summary of the major variations from the Contract Documents, and a discussion of any change orders including the dollar value of change orders. The report also includes a discussion of the construction activities which occurred at the site. The bid tabulation and schedule of values are included in Appendix A.

**1.1 Remedial Construction Contractors**

The Remedial Action was performed under contract: D005595.

- Contract for General Construction, awarded to the approved low bidder, D.A. Collins Environmental Services, Mechanicville, NY, (DAC) for a bid amount of \$2,449,991.00.

The date established for commencement of the project in the Notice to Proceed was March 31, 2006. The project was deemed substantially complete on November 7, 2006.

## **1.2 Site Description**

Camp Summit is located within a New York Reforestation Area in a rural area in the foothills of the Catskill Mountains near the Town of Fulton, Schoharie County, New York. Adjacent to the remediation work zone is an active shock incarceration facility operated by the Department of Corrections. The Site is bordered on the southeast by additional State-owned land while the remainder of the Site is bordered by private property, some of which is used for residential purposes.

## **1.3 Description of the Remedial Action**

The remedial action was designed to address the threats to public health and the environment identified during the remedial investigation and pre-design investigation. The remedial action consisted of the following major components by the general construction contractor:

- Preparation and implementation of necessary plans including, Erosion and Sedimentation Control Plan, Environmental Protection Plan, and site Health and Safety Plan (HASp).
- Relocation of existing treated lumber piles and placement within cell boundaries.
- Disposal of the following materials into the onsite cell prior to the multi-layer cap construction: Demolished buildings and foundations, chipped trees, excavated waste, other debris, and excavated soil which was considered contaminated.
- Completion of rough grading, placement and compaction of stripped and/or excavated onsite materials, and placement and compaction of clean off-site soil to regrade the landfill.
- Construction of a multi-layer cap over the entire landfill and tie into perimeter trench and drainage features.
- Construction of permanent drainage swales, channels, gutters, culverts, and related structures for control of site-related drainage.

- Regrading and stabilization of existing slopes adjacent to the landfill where necessary.
- Construction of a gas collection system with cap vents.
- Creation of crushed stone-paved roads onsite and, where necessary, repair of existing paved roads from damage due to construction activities.
- Removal from site all contractor equipment, temporary facilities and utilities connections, and restoration of site to original or specified conditions.
- Disposal of all treated construction water including dewatering and decontamination water.
- Construction of two pole barns onsite, one for DEC equipment storage, and one for Department of Corrections (DOC) wood storage.



## **2.0 PRE-CONSTRUCTION ACTIVITIES**

### **2.1 Pre-Construction Meeting**

On February 8, 2006, a pre-construction meeting was held at the NYSDEC offices at 625 Broadway, Albany, NY. In attendance were representatives of NYSDEC, DAC and URS. Items of discussion included the following: the responsibilities of project participants and lines of communication; Minority/Women's Business Enterprises (M/WBE) and Equal Employment Opportunity (EEO) goals; contract time; progress schedules; working hours; approval of subcontractors; maintenance of as-built drawings; submittal requirements; changes in the work; payments; completion of the work and final acceptance; dispute resolution; limits of disturbance; easement requirements; pollution liability insurance. All meeting minutes are included on CD in Appendix B.

### **3.0 CONSTRUCTION ACTIVITIES**

The majority of the remedial construction was performed in accordance with the Contract Documents (including the two addenda issued prior to bid award). The following paragraphs contain a general description of the construction, and a discussion of the significant variations (administrative agreements, field clarifications, change orders, approved substitutions, etc.) from the Contract Documents (plans and specifications). URS maintained a resident engineer/inspector on site during all construction activities. A complete set of daily reports and photographs were submitted under separate cover to NYSDEC on March 1, 2007 and have also been included on CD in Appendix C.

Included in this section, where applicable, are discussions of the results of any Construction Quality Assurance/Construction Quality Control (CQA/CQC) testing, and the means and methods of construction. A discussion of change orders and their associated value is included.

The Record Drawings/Maps to be submitted under separate cover include:

- Record Drawings prepared by DAC from the redline mark-ups maintained during construction.
- The Record Drawings of the polyethylene membrane (cap) prepared by Chenango, the geosynthetic installation subcontractor.
- Maps and survey notes prepared by DAC's independent land surveyor, Lawson Surveying and Mapping, before and after remediation.
- The manual redline drawings maintained during construction.

### **3.1 Narrative Description of Construction**

Following the Notice to Proceed letter dated March 31, 2006, the General Contractor set up temporary facilities during the third week of May 2006. These facilities included job trailers for the contractor and URS/NYSDEC.

- Contractor delivered decontamination trailer, excavators, bull dozers, foam truck, water truck, wood chipper, compactor roller, end dump truck and a lockable container for Contractor's hand tools.
- Orange construction fencing was installed around the proposed work limit area. No one but authorized personnel of DEC, URS and DAC could enter the fenced perimeter except for deliveries necessary for remediation activities.
- Silt fence and hay bales were placed on the northern end of the site to protect existing pond from rainfall and construction activity runoff.
- Contractor video taped the access road to the site. Roadway surface would have to be replaced to original integrity had any damage occurred during construction operations.
- AMEC Environmental and DEC set up air monitoring stations at areas designated in the pre-construction meeting. Air monitoring was performed daily during of construction operations. Three permanent sites were selected for placement of the air monitors. Two mobile units were also used. The permanent locations were the water tower, the Chapel, and the Origin of Life building. The two mobile units were placed, depending on daily wind directions, up wind and down wind. All air monitoring data and maps depicting air monitoring station locations are included on CD in Appendix D. Daily Health and Safety Reports are included on CD in Appendix E.
- Surveyors laid out cell area and areas that required remediation/excavation.
- Contractor removed all unused wood treatment supplies from wood working buildings. Supplies were stock piled on pallets for removal and offsite disposal.

- The demolition plans for the wood buildings were approved on June 7, 2006. Contractor immediately demolished structures and stockpiled them in the cell area in preparation for chipping operations.
- All ferrous material was separated from the wood piles and taken off site for recycling/disposal.
- Building foundations were hoe rammed into manageable pieces. The foundation pieces and the chipped building materials were spoiled within the cell area.
- Fractionalization (frac) tanks arrived onsite and were assembled just south of the outlet area to the pond. The frac tanks were used to treat rain and groundwater that ponded/collected in the remedial excavations. Water was pumped to the tanks, treated through carbon and sand filters, sampled, and tested before discharging to the pond or on top of the cell to aid in compaction. Analytical data from the groundwater data is included in Appendix F.
- Contractor began remedial excavation in designated areas. Material was stockpiled in cell area. Soil sampling and daily air monitoring continued as per plan.
- Excavated areas and cell stockpile areas received a foam coating and poly cover at the end of each work day. A water truck was used for site dust control during construction operations. Water for dust control was pumped from Summit Lake with approval. Rain water collected in the excavations was pumped into the frac tanks for treatment.
- After excavation areas were completed and sampled as per plan, the test results were received and reviewed by URS chemists. Determinations were made where additional excavation was necessary, i.e. in localized areas that exceeded parameters as specified in the Contract. Additional material was then removed and again sent for testing and review. After passing test results contractor was given the approval to backfill the excavated area(s). All soil sampling analytical data is included in Appendix F. Analytical results from documentation sampling completed during excavation are included in Appendix G. Data Usability Summary Reports (DUSRs) will be completed by URS for confirmation soil sampling and submitted under separate cover.

- While waiting for excavated soil test results from the walls and bottoms of excavations, Contractor shaped the cap area to line and grade as per plan. Surveyors laid out toe of slopes and fill areas.
- Contractor began backfilling with pre-approved fill material. Material was brought to the site using (end-dump) dump trucks, fill was placed in the excavations, spread in 8-inch lifts, and compacted with a 20-ton vibratory roller to finished grade.
- Contractor continued to grade surface of the cell in preparation of placement of the 6-inch gas vent layer.
- Surveyors and the on-site inspector confirmed cap elevation and side slopes.
- Contractor installed two gas vent risers at the top of cap as per plan.
- Contractor began placing gas vent sand at the toe of the cell area and worked material to the top of the cap. Depth of sand placement was checked by Contractor's grade foreman and the onsite inspector. Material was compacted using the 20-ton vibratory roller.
- Contractor continued to backfill remediation areas.
- Gas vent layer was completed. Subcontractor, Chenango Contracting, Inc., was onsite to approve gas vent layer prior to installing the geomembrane layer. The gas vent layer was approved to accept geosynthetics by their QA/QC representative.
- Contractor excavated the anchor trench for the geosynthetics along the perimeter of the cell area. Contractor also excavated trench for sanitary sewage line and an area for the septic tank for DEC's office building.
- Chenango installed the geosynthetic clay liner (GCL) in a south to north panel layout, GCL material was distributed across the cap area using a rubber tracked bobcat. Field welds and destructive testing patches were tested by the QA/QC representative and approved.

- Chenango then placed the Cushion Geotextile over the GCL making sure to stagger the seams of the two materials. The cap area was surveyed for payment. The survey is included in the Record Drawings.
- Approved barrier protection material was hauled to the cap area and placed in the same fashion as the gas vent sand (stockpile material placed at toe of cell, then spread material to top of cap). Fill was placed in three 6-inch lifts. Every lift was compacted and tested for the required density prior to placing the following lift. Construction Technology performed the testing and recording results. Results were sent to URS by DAC.
- The cap perimeter interceptor swale was constructed, and 18-inch corrugated metal pipe (CMP) drainage culverts were installed as per plan. Culverts received stone aprons at both the inlet and outlet ends. An additional culvert was installed along with a catch basin on the southwest corner of the site to control rain water ponding that occurred along the west side of the access road in front of DOC water treatment plant.
- Contractor completed excavation and grading throughout site. All heavy equipment taken off site except a rubber tire backhoe for site cleanup operations.
- With drainage swales completed, contractor placed approved topsoil on the barrier protection layer and any other areas that required topsoil per plan. Topsoil was placed in 6-inch lifts.
- Subcontractor Hydroseed-It® came onsite to hydro seed the cap area, drainage swale, and other areas disturbed during construction operations. Grass has taken in all seeded areas. In agreement with DAC, URS and DEC, the disturbed areas around the DEC office and the contractors trailer will receive topsoil and seed in the spring of 2007.
- Surveyors laid out pole barn locations as requested by DEC and DOC. Contractor excavated pole foundations as per approved plans.
- Two pole barns were delivered to the site for Contractor's erection. One 40' x 80' for DEC equipment storage and a 25' x 100' for DOC wood storage. These two structures differ from what was proposed in the original Contract. The Contract called for a 30' x

30' pole barn salt storage shed. The salt shed was substituted for the other two pole barns, the costs are included in Proposed Change Order No. 10.

- Aquifer Drilling and Testing installed and developed seven monitoring wells. Depths and well results were forwarded to URS. URS provided baseline sampling for all wells. Boring logs and well construction diagrams from DAC are included on CD in Appendix H. Field Notes, Development Logs, and Chains of Custody from URS are also included in Appendix H.
- Contractor installed 4" underdrain pipe under access road because of water problems in the area. Roadway was graded with subbase material and compacted.
- The DEC had a pre-engineered office building, manufactured by Corecraft, delivered to the site. Contractor erected the building on a previously constructed foundation provided by DEC.
- Erection consisted of placing the pre-engineered building on its foundation, building the porch, installing trusses, sheeting, placing roof shingles, and installation of remaining siding.
- Water, septic tank, and electrical connections were also made to the DEC office building.
- Contractor removed temporary electric and telephone connections and demobilized office trailer.

## **3.2 Submittals**

### **3.2.1 Shop Drawings**

The approved shop drawings document many of the minor details of the actual remediation construction (e.g., pole barns and DEC's pre-engineering building, etc.). Those details are not discussed in this report.

The required shop drawings were received from DAC, and reviewed by URS, in a timely manner. All the required shop drawings were ultimately approved by URS. Copies of all approved shop drawings were submitted to DEC. A submittal log is included in Appendix I.

### **3.2.2 Plans**

Prior to commencement of general construction, the plans required by the Contract Documents were submitted by DAC and approved. Those plans included their Work Plan, HASP, Erosion and Sediment Control Plan, Sampling and QA/QC Plan, Spill Control Plan, and the Environmental Protection Plan.

### **3.3 Geosynthetics**

#### **3.3.1 Construction**

Subcontractor Chenango Contracting, Inc. installed the GCL layer and the cushion geotextile layer over the gas vent layer as per plan.

Seams of the GCL and the cushion geotextile were destructively and non-destructively tested in accordance with the Contract Specifications. The results of all testing met the Contract requirements.

### **3.4 Pre-Engineered Buildings**

#### **3.4.1 Contract Modifications**

Three pre-engineered buildings were called for in the Contract Documents, a NYSDEC office building, a DEC pole barn and a salt shed kit for DOC. DAC was having difficulties finding a pre-manufactured building to fit the 24' x 30' foundation that DEC had already poured for their office in



April 2006. DAC received quotes from different suppliers in the range of \$100,000.00 to \$137,000.00 for a building.

DEC contacted Corecraft, a subsidiary of Mid Orange Correctional Facility, manufacturers of prefabricated buildings. Mid Orange informed DAC that they could supply a unit for approximately \$67,000.00 (see Proposed Change Order 010). DEC forwarded this information to NYSDEC. NYSDEC found this price reasonable.

Another addition/substitution was a pole barn for DOC wood storage.

The agreement was finalized with DEC to receive a 40' x 80' equipment storage pole barn and a pre-manufactured office, and for DOC to receive a 25' x 100' wood storage pole barn, and a 30' x 30' salt storage pole barn. DAC erected the two pole barns and an office building. DOC will construct the salt shed themselves.

### **3.4.2 Construction**

The three pole barns were delivered in "kit" form. The salt shed was delivered to DOC. DAC erected two of the pole barns as well as the DEC office building.

Surveyors laid out the pole barn locations and DAC carpenters laid out pole locations and foundations. Poles were erected and concrete footings were poured. Header beams were installed as were trusses and lateral bracing. Metal roofing, siding and sliding doors were installed. DEC's pole barn will receive a concrete slab for its finished flooring. DOC's pole barn floor will remain unfinished and left with a crushed stone floor.

DEC's office was delivered in three deliveries, the east and west sides of the building were delivered on two loads and the trusses on another. DAC set the building on the foundation already formed and poured by DEC. DAC installed the trusses, siding, roofing, and flooring. DAC was also responsible for electrical, telephone, water hookups and the septic tank installation.

### **3.5 Final Cover**

#### **3.5.1 Contract Modifications**

The final cover, including the gas vent layer, was constructed in close conformance with the Contract Documents. No substitutions, variances, or change orders were approved for that portion of the Contract.

#### **3.5.2 Construction**

Final cover components were placed, and seamed or compacted, in accordance with the methods specified in the Contract Documents.

#### **3.5.3 COA/COC Testing and Results**

In-place density testing was performed where required, on the gas vent sand layer and the barrier protection layer. All such testing met the specified criteria.

D.A. Collins submitted a second set of geotechnical results for the gas vent sand on September 22, 2006. They were not contractually obligated to submit this second set. Geotechnical tests were only required once per 2,500 cubic yards of material placed. D.A. Collins withdrew the second set of results at Progress Meeting #11 on Tuesday, November 7, 2006.

### **3.6 Utilities**

#### **3.6.1 Electric and Telephone**

Electric and telephone service to the office building was installed by Dave VanHusen Inc. Electric was installed via buried wires from Eagle Heights Road.

### **3.6.2 Water**

Water service to the office building was installed by Jim Van Husen, Inc. beneath the access road from the wood working building. The installed waterline was disinfected and tested in accordance with the specifications.

### **3.7 Other Items**

#### **3.7.1 Perimeter Access Road**

The alignment of the perimeter access road is as per plan.

#### **3.7.2 Stormwater Management System**

With the following exception, the stormwater management system, including the swales, and the perimeter drainage channels, culverts, etc., was constructed in conformance with the Contract Documents:

- An additional 18-inch CMP and catch basin were installed at the southwest corner of the site. The catch basin was installed in front of the water treatment building and the pipe outlets under the access road to the cap drainage swale as shown as shown on the Record Drawings.

### **3.8 Confirmatory Sampling**

Figures depicting the confirmation sampling locations and contaminant exceedances for all excavation areas are depicted in the diagrams in Appendix F.

### **3.9 Final Charge Orders**

A final change order has been negotiated for the General Contract. All Proposed Change Orders (PCOs), a PCO Log, and Change Order No. 1 appear on CD in Appendix J Change Order No. 1 is summarized below:

#### **General Contract**

The new Contract Price for the general Contract is \$2,347,461.34, which is \$102,529.66 less than the Original Contract Price. Changes for this Contract, all of which appear in Change Order No. 1, include the following items:

Steel road plates over the water lines for extra protection (\$4,253.42 increase). This cost appears in PCO #001.

A power pole in Area G was removed and the lines were relocated (\$3,541.23 increase). This cost appears in PCO #003.

Additional grading was completed with the construction of the second pole barn onsite and at the southwestern access road to the site (\$28,037.29 increase). This cost appears in PCO #006.

Credit for grading at the salt storage shed. The shed was never constructed and NYSDEC was credited the Contract amount for grading around the salt storage shed (\$3,240.82 decrease).

Fabric and subbase were installed at the pole barns (\$7,043.90 increase). This cost appears in PCO #007.

Installation of septic tank and drain line onsite and installation of millings at DOC pole barn apron (\$9,039.26 increase). This cost appears in PCO #008.

A ditch line was excavated down the access road near the main entrance in order to control water runoff (\$3,296.24 increase). This cost appears in PCO #009.

Two pole barns were constructed onsite and numerous additions were made to the NYSDEC permanent office building (\$86,239.27 increase). This cost appears in PCO #010.

A catch basin was installed onsite (\$2,379.63 increase). This cost appears in PCO #011.

A 4" underdrain pipe was installed across the main access road to alleviate a water infiltration problem there (\$3,459.43 increase). This cost appears in PCO #012.

Concrete was poured for the floor of the 40' x 80' pole barn (\$17,879.42 increase). This cost appears in PCO #013.

Additional silt fence was installed at the site due to heavy rains (\$726.22 increase). This cost appears in PCO #014.

Paving was completed at the NYSDEC parking lot, the northern parking area for the NYSDEC, and at the NYSDEC pole barn (\$16,827.30 increase). This cost appears in PCO #015.

Additional topsoil and hydroseed were placed onsite due to additional excavation and the movement of pole barns (\$50,628.55 increase). This cost appears in PCO #016.

During remediation activity, no soil exhibited characteristics that required off-site disposal by incineration. The Contract amount associated with off-site disposal by incineration has been credited to NYSDEC as a result (\$332,640.00 decrease).

**APPENDIX A**

**BID TABULATION AND SCHEDULE OF VALUES**

**New York State Department of Environmental Conservation  
Camp Summit Site Remedial Construction  
Contract Number D005595, NYS Site Number 4-48-006**

Payment Item Number	Description	Estimated Quantity	Unit	ENGINEER'S ESTIMATE		D.A. Collins Environmental Services, LLC		National Environmental Services Corp.		EQ Northeast, Inc.		Scientech, LLC	
				Unit Price	Total Amount	Unit Price	Total Amount	Unit Price	Total Amount	Unit Price	Total Amount	Unit Price	Total Amount
UC-1	Excavation of Areas of Concern	10,785	CY	\$ 20.67	\$ 222,923.00	\$ 4.00	\$ 43,140.00	\$ 50.00	\$ 539,250.00	\$ 11.00	\$ 118,635.00	\$ 55.00	\$ 593,175.00
UC-2	Backfill of Areas of Concern	10,785	CY	\$ 27.44	\$ 295,932.00	\$ 13.00	\$ 140,205.00	\$ 15.00	\$ 161,775.00	\$ 30.00	\$ 323,550.00	\$ 28.56	\$ 308,019.60
UC-3	Sampling and Analysis												
UC-3a	Post Remediation Sampling	156	Each	\$ 72.50	\$ 11,310.00	\$ 955.00	\$ 148,980.00	\$ 100.00	\$ 15,600.00	\$ 60.00	\$ 9,360.00	\$ 92.19	\$ 14,381.64
UC-3b	Laboratory Confirmation Analysis SVOCs - EPA 8270C	156	Each	\$ 479.45	\$ 74,794.00	\$ 176.00	\$ 27,456.00	\$ 255.00	\$ 39,780.00	\$ 200.00	\$ 31,200.00	\$ 167.54	\$ 26,136.24
UC-3c	Laboratory Confirmation Analysis VOCs - EPA 8260B	156	Each	\$ 258.62	\$ 40,344.00	\$ 74.00	\$ 11,544.00	\$ 100.00	\$ 15,600.00	\$ 100.00	\$ 15,600.00	\$ 90.75	\$ 14,157.00
UC-3d	Laboratory Confirmation Analysis Metals - EPA 6010/7471A	156	Each	\$ 90.25	\$ 14,079.00	\$ 28.00	\$ 4,368.00	\$ 100.00	\$ 15,600.00	\$ 70.00	\$ 10,920.00	\$ 30.61	\$ 4,775.16
UC-3e	Laboratory Confirmation Analysis Dioxins/Furans - EPA 8290	156	Each	\$ 1,268.78	\$ 197,929.00	\$ 682.00	\$ 106,392.00	\$ 800.00	\$ 124,800.00	\$ 900.00	\$ 140,400.00	\$ 879.09	\$ 137,138.04
UC-4	Excavated Soil Characterization	27	Each	\$ 2,446.15	\$ 66,046.00	\$ 1,000.00	\$ 27,000.00	\$ 500.00	\$ 13,500.00	\$ 900.00	\$ 24,300.00	\$ 1,510.04	\$ 40,771.08
UC-5	Monitoring Well - Decommissioning	7	Each	\$ 813.71	\$ 5,696.00	\$ 750.00	\$ 5,250.00	\$ 1,000.00	\$ 7,000.00	\$ 700.00	\$ 4,900.00	\$ 1,204.57	\$ 8,431.99
UC-6	Monitoring Well - Replacement	7	Each	\$ 4,910.57	\$ 34,374.00	\$ 1,500.00	\$ 10,500.00	\$ 1,000.00	\$ 7,000.00	\$ 1,500.00	\$ 10,500.00	\$ 1,762.14	\$ 12,334.98
UC-7	Off-site Disposal												
UC-7a	Off-site Disposal - Direct Landfill	1,224	Ton	\$ 246.93	\$ 302,240.00	\$ 140.00	\$ 171,360.00	\$ 160.00	\$ 195,840.00	\$ 155.00	\$ 189,720.00	\$ 165.93	\$ 203,098.32
UC-7b	Off-site Disposal - Pretreatment by Stabilization/Landfill	1,188	Ton	\$ 336.72	\$ 400,023.00	\$ 170.00	\$ 201,960.00	\$ 181.00	\$ 215,028.00	\$ 225.00	\$ 267,300.00	\$ 200.29	\$ 237,944.52
UC-7c	Off-site Disposal - Incineration	1,188	Ton	\$ 925.98	\$ 1,100,064.00	\$ 280.00	\$ 332,640.00	\$ 250.00	\$ 297,000.00	\$ 400.00	\$ 475,200.00	\$ 559.88	\$ 665,137.44
UC-8	On-site Consolidation Area Construction	10,110	CY	\$ 16.48	\$ 166,618.00	\$ 2.50	\$ 25,275.00	\$ 5.00	\$ 50,550.00	\$ 8.00	\$ 80,880.00	\$ 14.40	\$ 145,584.00
UC-9	Drainage Control	1,430	LF	\$ 51.12	\$ 73,107.00	\$ 24.00	\$ 34,320.00	\$ 30.00	\$ 42,900.00	\$ 50.00	\$ 71,500.00	\$ 29.26	\$ 41,841.80
UC-10	Landfill Cap												
UC-10a	Sand Layer	7,700	SY	\$ 4.82	\$ 37,141.00	\$ 4.25	\$ 32,725.00	\$ 5.50	\$ 42,350.00	\$ 15.00	\$ 115,500.00	\$ 5.68	\$ 43,736.00
UC-10b	GCL Layer	7,700	SY	\$ 11.45	\$ 88,152.00	\$ 7.50	\$ 57,750.00	\$ 10.00	\$ 77,000.00	\$ 10.00	\$ 77,000.00	\$ 8.99	\$ 69,223.00
UC-10c	LLDPE Geomembrane	7,700	SY	\$ 17.83	\$ 137,295.00	\$ 6.75	\$ 51,975.00	\$ 10.00	\$ 77,000.00	\$ 8.00	\$ 61,600.00	\$ 8.58	\$ 66,066.00
UC-10d	Geotextile Cushion	7,700	SY	\$ 3.75	\$ 28,906.00	\$ 3.50	\$ 26,950.00	\$ 5.00	\$ 38,500.00	\$ 5.00	\$ 38,500.00	\$ 4.90	\$ 37,730.00
UC-10e	Barrier Protection Layer	7,700	SY	\$ 15.15	\$ 116,680.00	\$ 12.50	\$ 96,250.00	\$ 7.00	\$ 53,900.00	\$ 25.00	\$ 192,500.00	\$ 14.82	\$ 114,114.00
UC-10f	Topsoil	7,700	SY	\$ 7.28	\$ 56,065.00	\$ 5.25	\$ 40,425.00	\$ 3.50	\$ 26,950.00	\$ 20.00	\$ 154,000.00	\$ 7.21	\$ 55,517.00
UC-10g	Hydroseed/Fertilizer/Mulch	7,700	SY	\$ 0.74	\$ 5,670.00	\$ 7.40	\$ 56,980.00	\$ 1.00	\$ 7,700.00	\$ 2.00	\$ 15,400.00	\$ 0.74	\$ 5,698.00
UC-10h	Gas Vents	2	Each	\$ 1,473.00	\$ 2,946.00	\$ 1,740.00	\$ 3,480.00	\$ 1,000.00	\$ 2,000.00	\$ 2,000.00	\$ 4,000.00	\$ 1,324.50	\$ 2,649.00
UC-11	Culvert	50	LF	\$ 70.82	\$ 3,541.00	\$ 112.00	\$ 5,600.00	\$ 100.00	\$ 5,000.00	\$ 200.00	\$ 10,000.00	\$ 129.66	\$ 6,483.00
UC-12	Access Road	1,900	SY	\$ 21.24	\$ 40,359.00	\$ 9.50	\$ 18,050.00	\$ 15.00	\$ 28,500.00	\$ 25.00	\$ 47,500.00	\$ 8.69	\$ 16,511.00
UC-13	Miscellaneous Topsoil/Vegetative Cover	8,160	SY	\$ 9.59	\$ 78,260.00	\$ 6.35	\$ 51,816.00	\$ 2.50	\$ 20,400.00	\$ 18.00	\$ 146,880.00	\$ 7.01	\$ 57,201.60
UC-14	Health and Safety	120	Day	\$ 295.29	\$ 35,435.00	\$ 1,300.00	\$ 156,000.00	\$ 300.00	\$ 36,000.00	\$ 400.00	\$ 48,000.00	\$ 814.91	\$ 97,789.20

New York State Department of Environmental Conservation  
 Camp Summit Site Remedial Construction  
 Contract Number D005595, NYS Site Number 4-48-006

Payment Item Number	Description	Estimated Quantity	Unit	ENGINEER'S ESTIMATE		D.A. Collins Environmental Services, LLC		National Environmental Services Corp.		EQ Northeast, Inc.		Scientech, LLC	
				Unit Price	Total Amount	Unit Price	Total Amount	Unit Price	Total Amount	Unit Price	Total Amount	Unit Price	Total Amount
UC-15	Levels of Protection					\$	-	\$	-	\$	-	\$	-
UC-15a	Modified Level D Protection	1	Man/Day	\$ 20.00	\$ 20.00	\$ 200.00	\$ 200.00	\$ 100.00	\$ 100.00	\$ 200.00	\$ 200.00	\$ 123.00	\$ 123.00
UC-15b	Level C Protection	1	Man/Day	\$ 52.00	\$ 52.00	\$ 600.00	\$ 600.00	\$ 1,500.00	\$ 1,500.00	\$ 300.00	\$ 300.00	\$ 331.00	\$ 331.00
UC-15c	Level B Protection	1	Man/Day	\$ 519.00	\$ 519.00	\$ 800.00	\$ 800.00	\$ 2,000.00	\$ 2,000.00	\$ 500.00	\$ 500.00	\$ 870.00	\$ 870.00
LS-1	Erosion and Sediment Control	1	LS	\$ 26,917.00	\$ 26,917.00	\$ 30,000.00	\$ 30,000.00	\$ 10,000.00	\$ 10,000.00	\$ 10,000.00	\$ 10,000.00	\$ 21,361.00	\$ 21,361.00
LS-2	Groundwater Management/Treatment	1	LS	\$ 186,849.00	\$ 186,849.00	\$ 60,000.00	\$ 60,000.00	\$ 130,000.00	\$ 130,000.00	\$ 50,000.00	\$ 50,000.00	\$ 67,633.00	\$ 67,633.00
LS-3	Demolition	1	LS	\$ 50,805.00	\$ 50,805.00	\$ 50,000.00	\$ 50,000.00	\$ 10,000.00	\$ 10,000.00	\$ 30,000.00	\$ 30,000.00	\$ 163,186.00	\$ 163,186.00
LS-4	Mobilization/Demobilization (Limited to 5% of the Grand Total Bid)	1	LS	\$ 195,000.00	\$ 195,000.00	\$ 120,000.00	\$ 120,000.00	\$ 100,000.00	\$ 100,000.00	\$ 140,000.00	\$ 140,000.00	\$ 173,529.00	\$ 173,529.00
LS-5	Site Facilities	1	LS	\$ 228,085.00	\$ 228,085.00	\$ 300,000.00	\$ 300,000.00	\$ 180,000.00	\$ 180,000.00	\$ 160,000.00	\$ 160,000.00	\$ 137,198.00	\$ 137,198.00
<b>GRAND TOTAL BID</b>				<b>\$</b>	<b>4,324,176.00</b>	<b>\$</b>	<b>2,449,991.00</b>	<b>\$</b>	<b>2,590,123.00</b>	<b>\$</b>	<b>3,075,845.00</b>	<b>\$</b>	<b>3,589,875.61</b>
Pollution Liability Insurance						\$	4,300.00			\$	30,000.00		\$ 20,000.00



D.A. Collins Environmental Services  
Camp Summit Site Remedial Construction  
Project No. 2005514

1/15/2007

Application #8

Schedule of Values

Item	Description	Est. Qty.	Units	Unit Price	December '06 Qty. / % Invoice Total	Total Qty. / % To Date	Total Invoiced To Date	Approved Contract	Quantity Remaining	Budget Remaining	Projected Quantity	Projected Contract
UC-1	Excavation of Areas of Concern	10,785	CY	\$ 4.00		12,687	\$ 50,748.00	\$ 43,140.00	-1,902	\$ (7,608.00)	12,687	\$ 50,748.00
UC-2	Backfill of Areas of Concern	10,785	CY	\$ 13.00		12,687	\$ 164,931.00	\$ 140,205.00	-1,902	\$ (24,726.00)	12,687	\$ 164,931.00
UC-3a	Post Remediation Sampling	156	Each	\$ 995.00		132	\$ 126,060.00	\$ 148,980.00	24	\$ 22,920.00	132	\$ 126,060.00
UC-3b	SVOCs	156	Each	\$ 176.00		32	\$ 5,632.00	\$ 27,456.00	124	\$ 21,824.00	32	\$ 5,632.00
UC-3c	Laboratory - VOCs	156	Each	\$ 74.00		18	\$ 1,332.00	\$ 11,544.00	138	\$ 10,212.00	18	\$ 1,332.00
UC-3d	Laboratory - Metals	156	Each	\$ 28.00		75	\$ 2,100.00	\$ 4,368.00	81	\$ 2,268.00	75	\$ 2,100.00
UC-3e	Laboratory - Dioxins/Furans	156	Each	\$ 682.00		16	\$ 10,912.00	\$ 106,392.00	140	\$ 95,480.00	16	\$ 10,912.00
UC-4	Excavated Soil Characterization	27	Each	\$ 1,000.00		0	\$ -	\$ 27,000.00	27	\$ 27,000.00	0	\$ -
UC-5	Monitoring Well - Decommissioning	7	Each	\$ 750.00		5	\$ 3,750.00	\$ 5,250.00	2	\$ 1,500.00	5	\$ 3,750.00
UC-6	Monitoring Well - Replacement	7	Each	\$ 1,500.00		7	\$ 10,500.00	\$ 10,500.00	0	\$ -	7	\$ 10,500.00
UC-7a	Off-site Disposal - Direct Landfill	1,224	Ton	\$ 140.00		0	\$ -	\$ 171,360.00	1,224	\$ 171,360.00	0	\$ -
UC-7b	Off-site Disposal - Pre-treatment by Stabilization/Landfill	1,188	Ton	\$ 170.00		0	\$ -	\$ 201,960.00	1,188	\$ 201,960.00	0	\$ -
UC-7c	Off-site Disposal - Incineration	1,188	Ton	\$ 280.00		0	\$ -	\$ 332,640.00	1,188	\$ 332,640.00	0	\$ -
UC-8	On-site Consol. Area Construction	10,110	CY	\$ 2.50		12,687	\$ 31,717.50	\$ 25,275.00	-2,577	\$ (6,442.50)	12,687	\$ 31,717.50
UC-9	Drainage Control	1,430	LF	\$ 24.00		1,549	\$ 37,176.00	\$ 34,320.00	-119	\$ (2,856.00)	1,549	\$ 37,176.00
UC-10a	Sand Layer	7,700	SY	\$ 4.25		8,096	\$ 34,408.00	\$ 32,725.00	-396	\$ (1,683.00)	8,096	\$ 34,408.00
UC-10b	GCL Layer	7,700	SY	\$ 7.50		8,096	\$ 60,720.00	\$ 57,750.00	-396	\$ (2,970.00)	8,096	\$ 60,720.00
UC-10c	LLDPE Geomembrane	7,700	SY	\$ 6.75		8,096	\$ 54,648.00	\$ 51,975.00	-396	\$ (2,673.00)	8,096	\$ 54,648.00
UC-10d	Geotextile Cushion	7,700	SY	\$ 3.50		8,096	\$ 28,336.00	\$ 26,950.00	-396	\$ (1,386.00)	8,096	\$ 28,336.00
UC-10e	Barrier Protection Layer	7,700	SY	\$ 12.50		8,096	\$ 101,200.00	\$ 96,250.00	-396	\$ (4,950.00)	8,096	\$ 101,200.00
UC-10f	Topsoil	7,700	SY	\$ 5.25		8,096	\$ 42,504.00	\$ 40,425.00	-396	\$ (2,079.00)	8,096	\$ 42,504.00
UC-10g	Hydroseed/Fertilizer/Mulch	7,700	SY	\$ 7.40		8,096	\$ 59,910.40	\$ 56,980.00	-396	\$ (2,930.40)	8,096	\$ 59,910.40
UC-10h	Gas Vents	2	Each	\$ 1,740.00		2	\$ 3,480.00	\$ 3,480.00	0	\$ 0	2	\$ 3,480.00
UC-11	Culvert	50	LF	\$ 112.00		239	\$ 26,768.00	\$ 5,600.00	-189	\$ (21,168.00)	239	\$ 26,768.00
UC-12	Access Road	1,900	SY	\$ 9.50		1,900	\$ 18,050.00	\$ 18,050.00	0	\$ 0	1,900	\$ 18,050.00
UC-13	Misc. Topsoil/Vegetative Cover	8,160	SY	\$ 6.35		16,133	\$ 102,444.55	\$ 51,816.00	-7,973	\$ (50,628.55)	16,133	\$ 102,444.55
UC-14	Health and Safety	120	Day	\$ 1,300.00		79	\$ 102,700.00	\$ 156,000.00	41	\$ 53,300.00	79	\$ 102,700.00
UC-15a	Modified Level D Protection	1	Man/Day	\$ 200.00		0%	\$ -	\$ 200.00	100%	\$ 200.00	0%	\$ -
UC-15b	Level C Protection	1	Man/Day	\$ 600.00		0%	\$ -	\$ 600.00	100%	\$ 600.00	0%	\$ -
UC-15c	Level B Protection	1	Man/Day	\$ 800.00		0%	\$ -	\$ 800.00	100%	\$ 800.00	0%	\$ -
LS-1	Erosion and Sediment Control	1	LS	\$ 30,000.00		100%	\$ 30,000.00	\$ 30,000.00	0%	\$ -	100%	\$ 30,000.00
LS-2	Groundwater Management/Treatment	1	LS	\$ 60,000.00		100%	\$ 60,000.00	\$ 60,000.00	0%	\$ -	100%	\$ 60,000.00
LS-3	Demolition	1	LS	\$ 50,000.00		100%	\$ 50,000.00	\$ 50,000.00	0%	\$ -	100%	\$ 50,000.00
LS-4	Mobilization / Demobilization	1	LS	\$ 120,000.00		100%	\$ 120,000.00	\$ 120,000.00	0%	\$ -	100%	\$ 120,000.00
LS-5	Site Facilities and Services	1	LS	\$ 300,000.00		100%	\$ 300,000.00	\$ 300,000.00	0%	\$ -	100%	\$ 300,000.00
PLJ	Pollution Liability Insurance	1	LS	\$ 4,300.00		100%	\$ 4,300.00	\$ 4,300.00	0%	\$ -	100%	\$ 4,300.00
CO-01	Change Order 1	1	LS	\$ 179,481.79		90%	\$ 161,533.61	\$ 179,481.79	10%	\$ 17,951.18	100%	\$ 179,481.79
							\$ 1,306,461.06	\$ 2,454,291.00	\$ 809,363.55	\$ 1,824,489.24		

**APPENDIX B**

**MEETING MINUTES (on CD)**

**APPENDIX C**

**DAILY INSPECTION REPORTS AND PHOTOGRAPH**

**LOGS (on CD)**

**APPENDIX D**

**DAILY AIR MONITORING REPORTS AND STATION  
LOCATION MAPS (on CD)**

## **APPENDIX E**

### **DAILY HEALTH AND SAFETY REPORTS (on CD)**

## **APPENDIX F**

# **GROUNDWATER AND SOIL SAMPLING ANALYTICAL REPORTS, CONFIRMATION SAMPLING MAPS, GROUNDWATER DISCHARGE CRITERIA (on CD)**

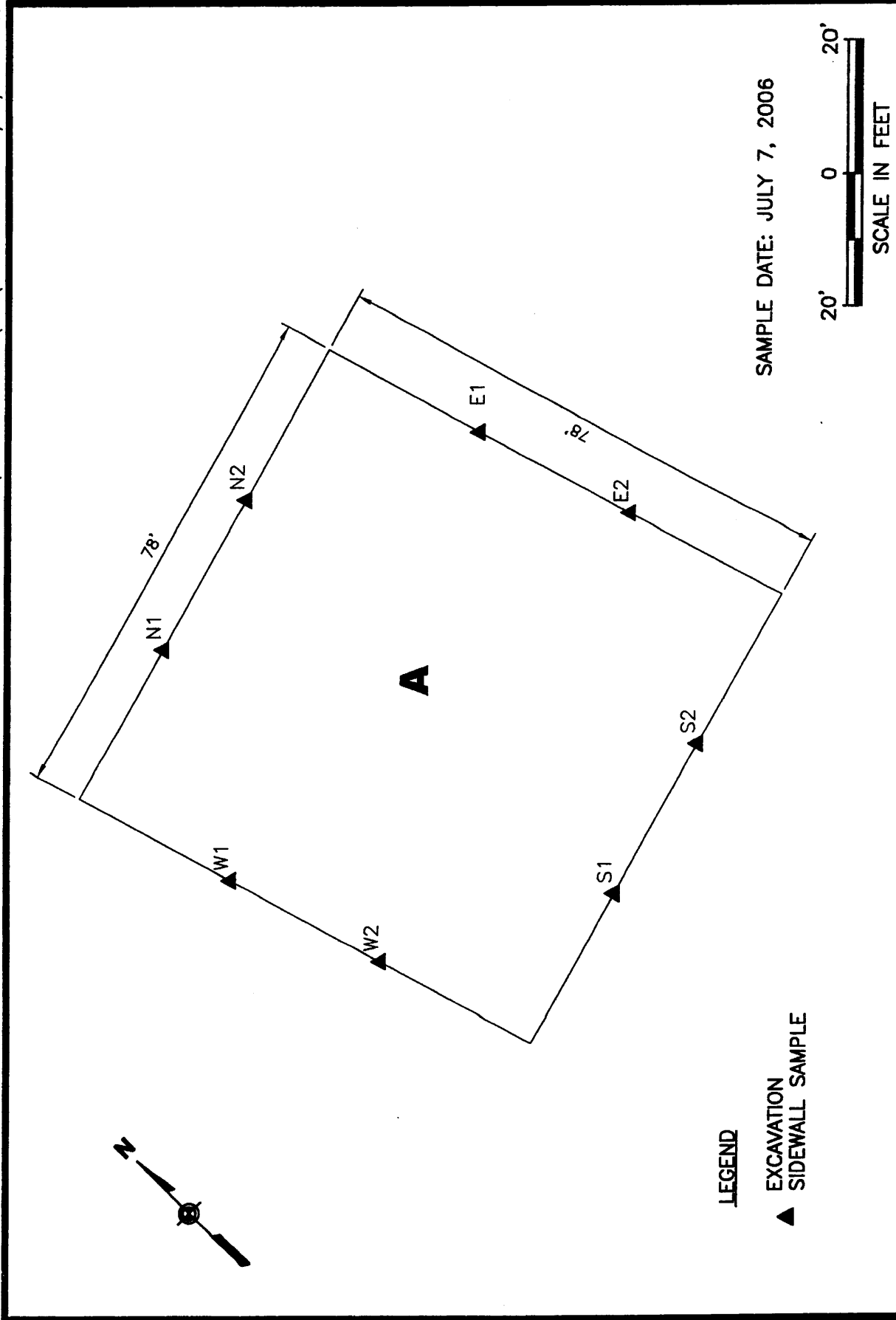

SAMPLE DATE: JULY 7, 2006

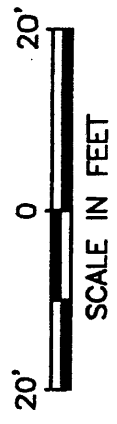

CAMP SUMMIT  
INITIAL EXCAVATION BOUNDARIES -- AREA A

FIGURE A-1

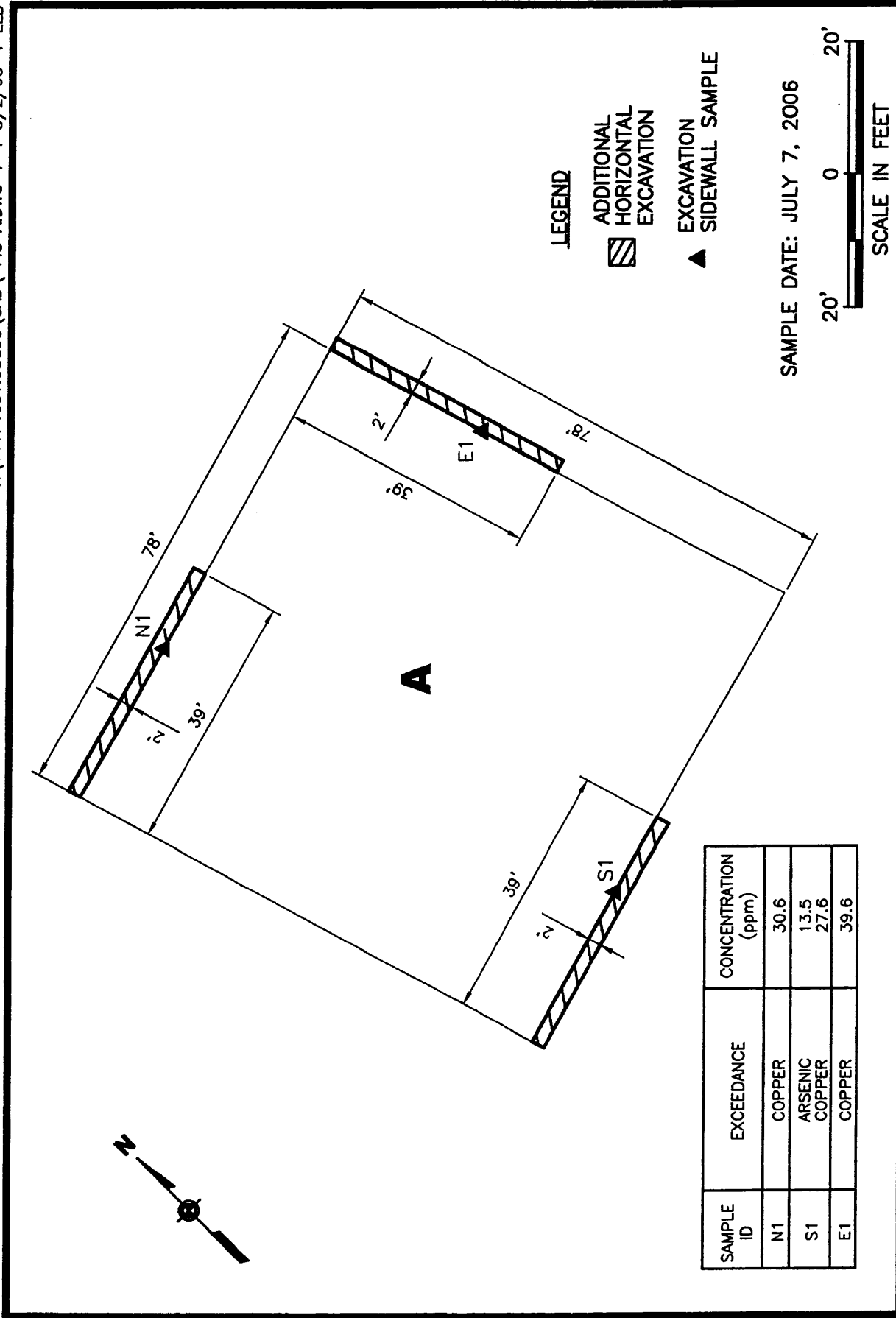

SAMPLE ID	EXCEEDANCE	CONCENTRATION (ppm)
N1	COPPER	30.6
S1	ARSENIC	13.5
	COPPER	27.6
E1	COPPER	39.6



CAMP SUMMIT  
FIRST OVER-EXCAVATION - AREA A

FIGURE A-2



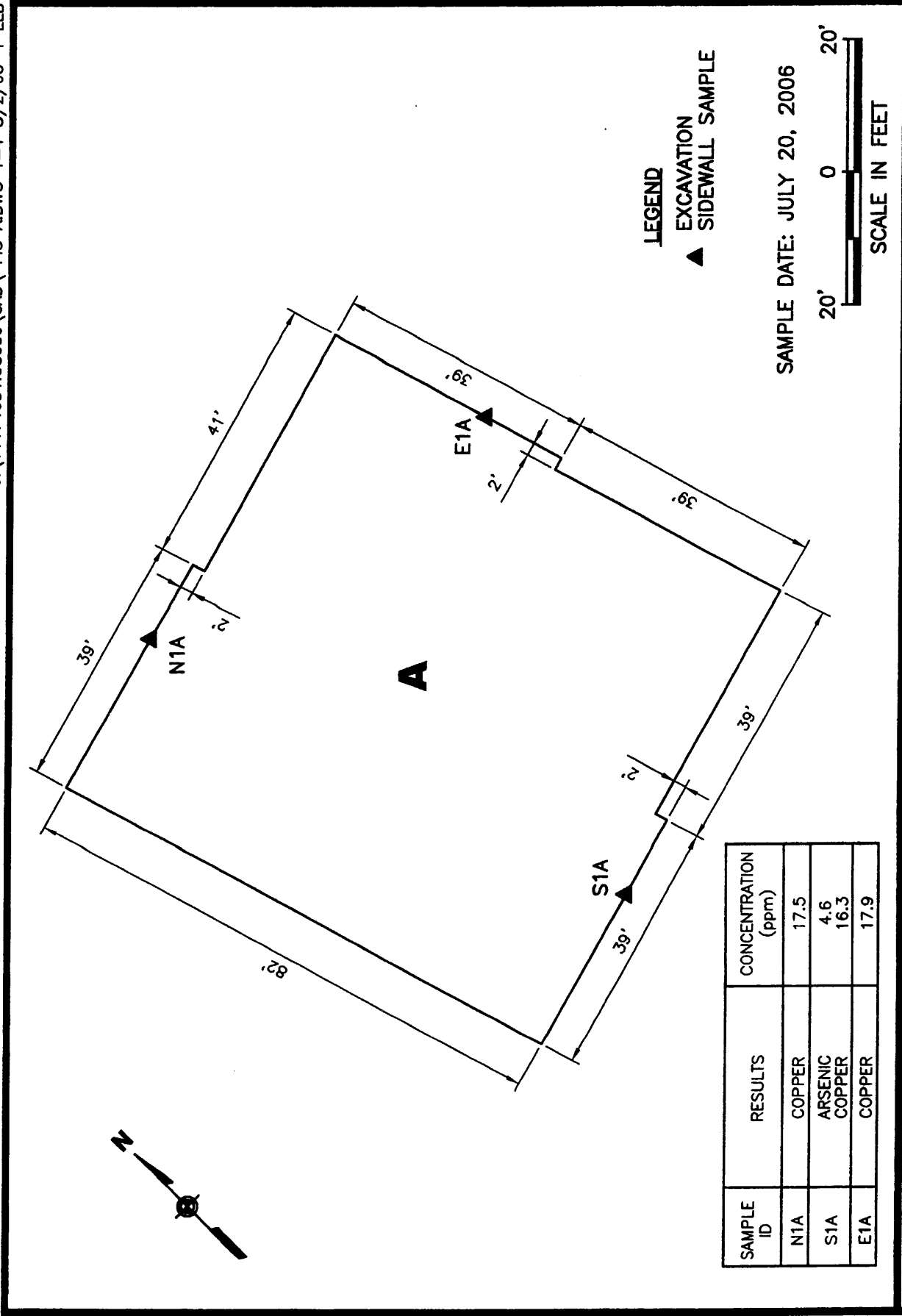

SAMPLE ID	RESULTS	CONCENTRATION (ppm)
N1A	COPPER	17.5
S1A	ARSENIC	4.6
E1A	COPPER	17.9



CAMP SUMMIT  
FINAL BOUNDARIES - AREA A

FIGURE A-3

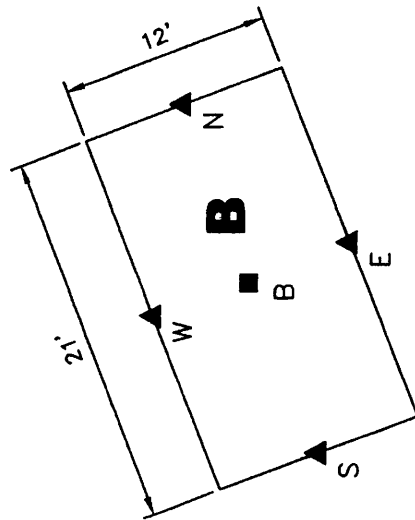
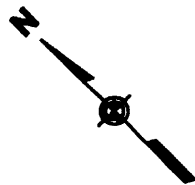

**LEGEND**

- ▲ EXCAVATION SIDEWALL SAMPLE
- EXCAVATION BOTTOM SAMPLE

SAMPLE DATE: JULY 10, 2006

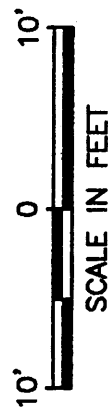

CAMP SUMMIT  
INITIAL EXCAVATION BOUNDARIES - AREA B

FIGURE B--1

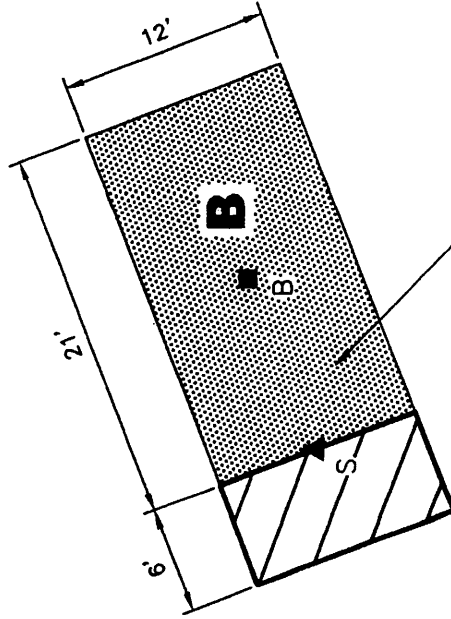
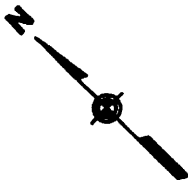

EXCAVATE 2' VERTICALLY  
OR TO BEDROCK (WHICH  
EVER IS LESS)

**LEGEND**

 ADDITIONAL  
HORIZONTAL  
EXCAVATION

 ADDITIONAL  
VERTICAL  
EXCAVATION

 EXCAVATION  
SIDEWALL SAMPLE

 EXCAVATION  
BOTTOM SAMPLE

SAMPLE ID	EXCEEDANCE	CONCENTRATION (ppm)
S	TEF DIOXIN	0.0012
B	ARSENIC	52.5

SAMPLE DATE: JULY 10, 2006

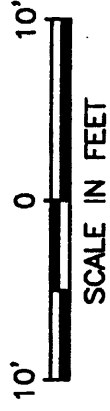

CAMP SUMMIT  
FIRST OVER-EXCAVATION - AREA B

FIGURE B-2

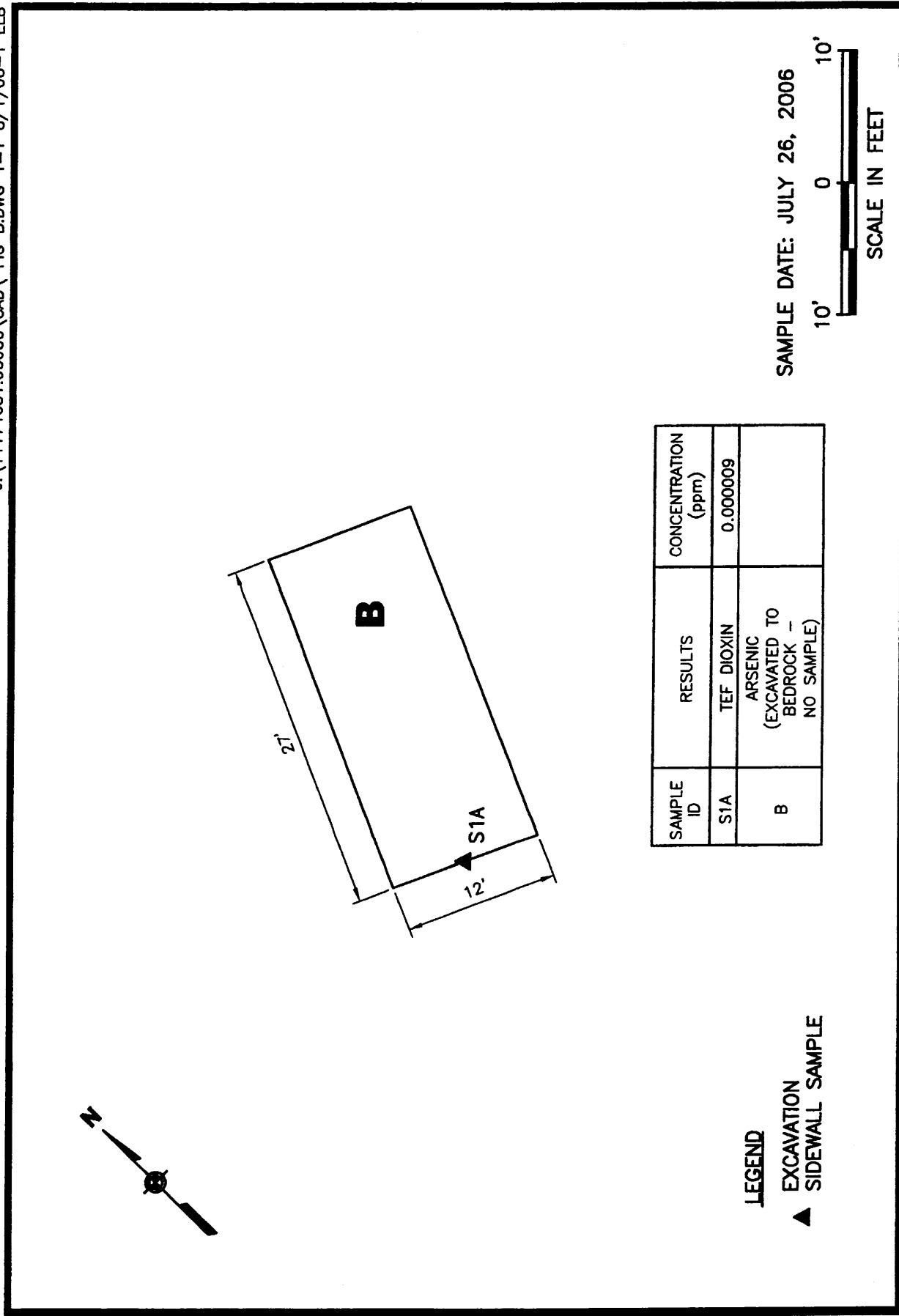

SAMPLE DATE: JULY 26, 2006



SAMPLE ID	RESULTS	CONCENTRATION (ppm)
S1A	TEF DIOXIN	0.000009
B	ARSENIC (EXCAVATED TO BEDROCK - NO SAMPLE)	

**LEGEND**  
 ▲ EXCAVATION  
 ▲ SIDEWALL SAMPLE



CAMP SUMMIT  
 FINAL BOUNDARIES - AREA B

FIGURE B-3

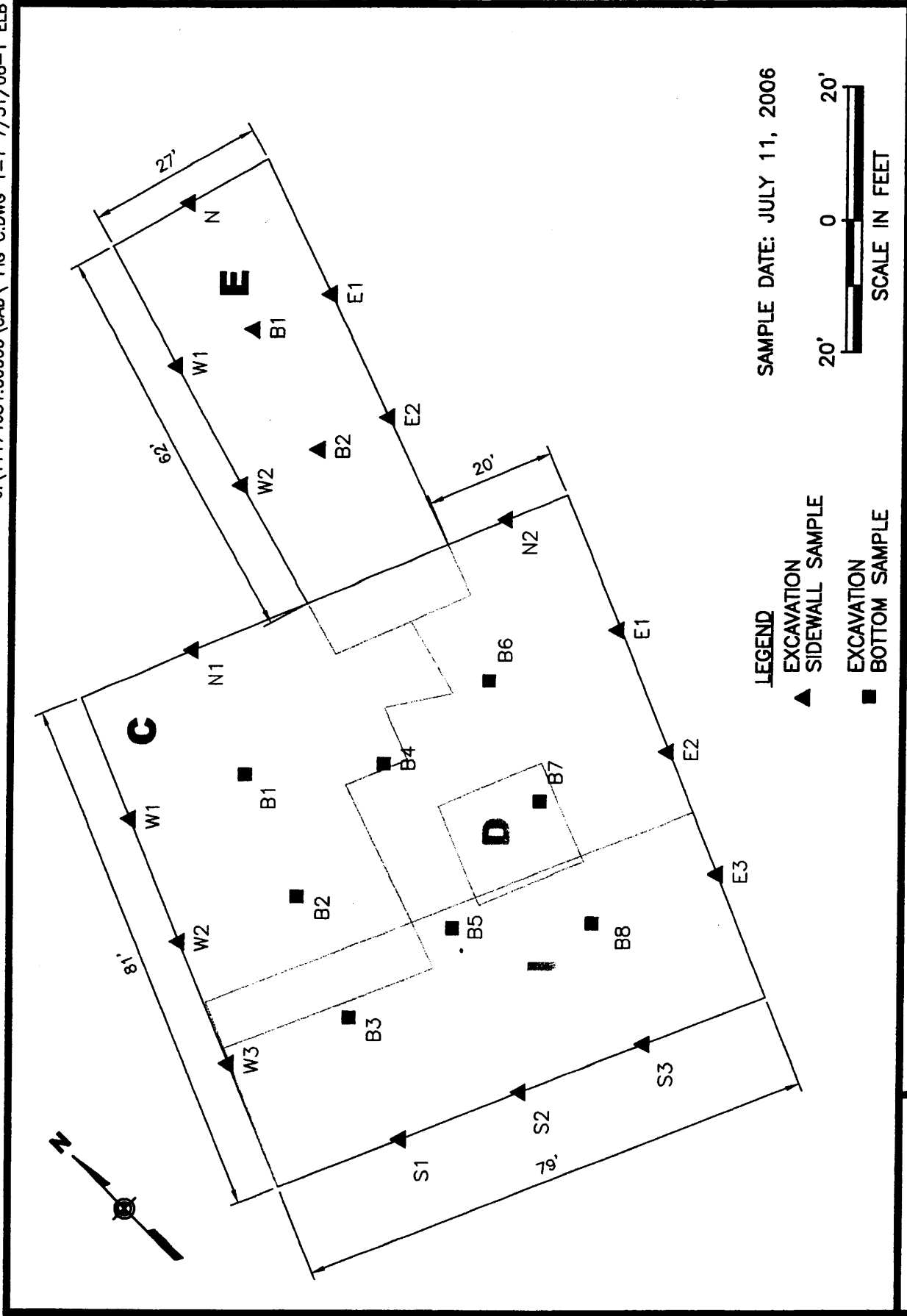

SAMPLE DATE: JULY 11, 2006

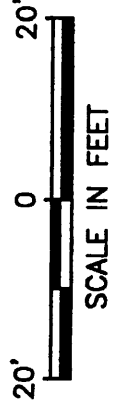

**LEGEND**  
▲ EXCAVATION SUMMIT  
■ SIDEWALL SAMPLE  
■ EXCAVATION BOTTOM SAMPLE

INITIAL EXCAVATION BOUNDARIES - AREAS C AND E

FIGURE C-1



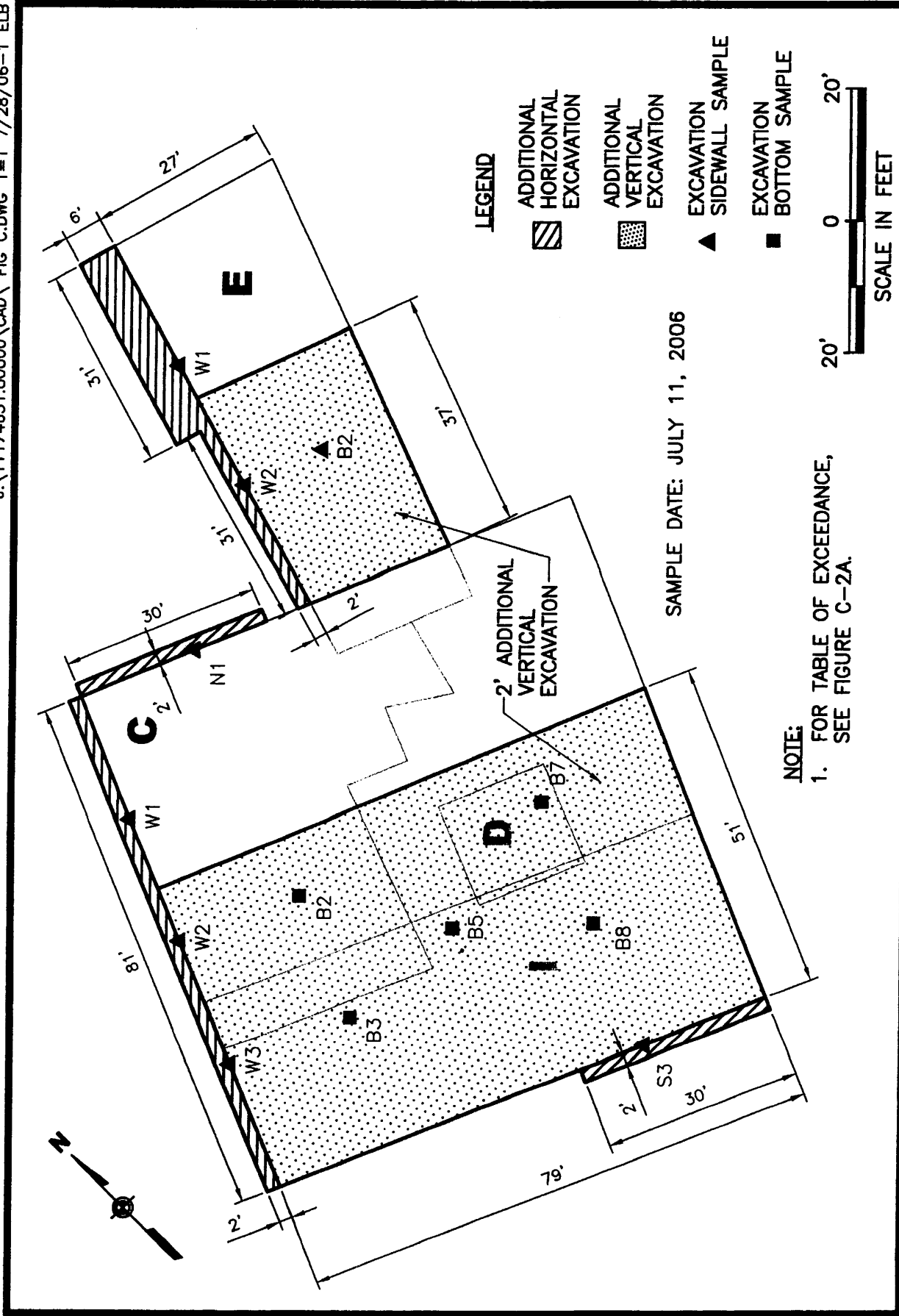

CAMP SUMMIT  
 FIRST OVER-EXCAVATION - AREAS C AND E

FIGURE C-2

AREA "C"		
SAMPLE ID	EXCEEDANCE	CONCENTRATION (ppm)
N1	ARSENIC COPPER	13.0 72.6
S3	ARSENIC	12.9
W1	ARSENIC COPPER	72.8 248
W2	ARSENIC	14.7
W3	ARSENIC	13.8
B2	ARSENIC	15.2
B3	ARSENIC	13.4
B5	ARSENIC	12.9
B7	ARSENIC	12.7
B8	ARSENIC	12.8

AREA "E"		
SAMPLE ID	EXCEEDANCE	CONCENTRATION (ppm)
W1	PENTACHLOROPHENOL	1.6
W2	ARSENIC	13.4
B2	ARSENIC	13.4

**NOTE:**

1. FOR PLAN VIEW, SEE FIGURE C-2.

SAMPLE DATE: JULY 11, 2006



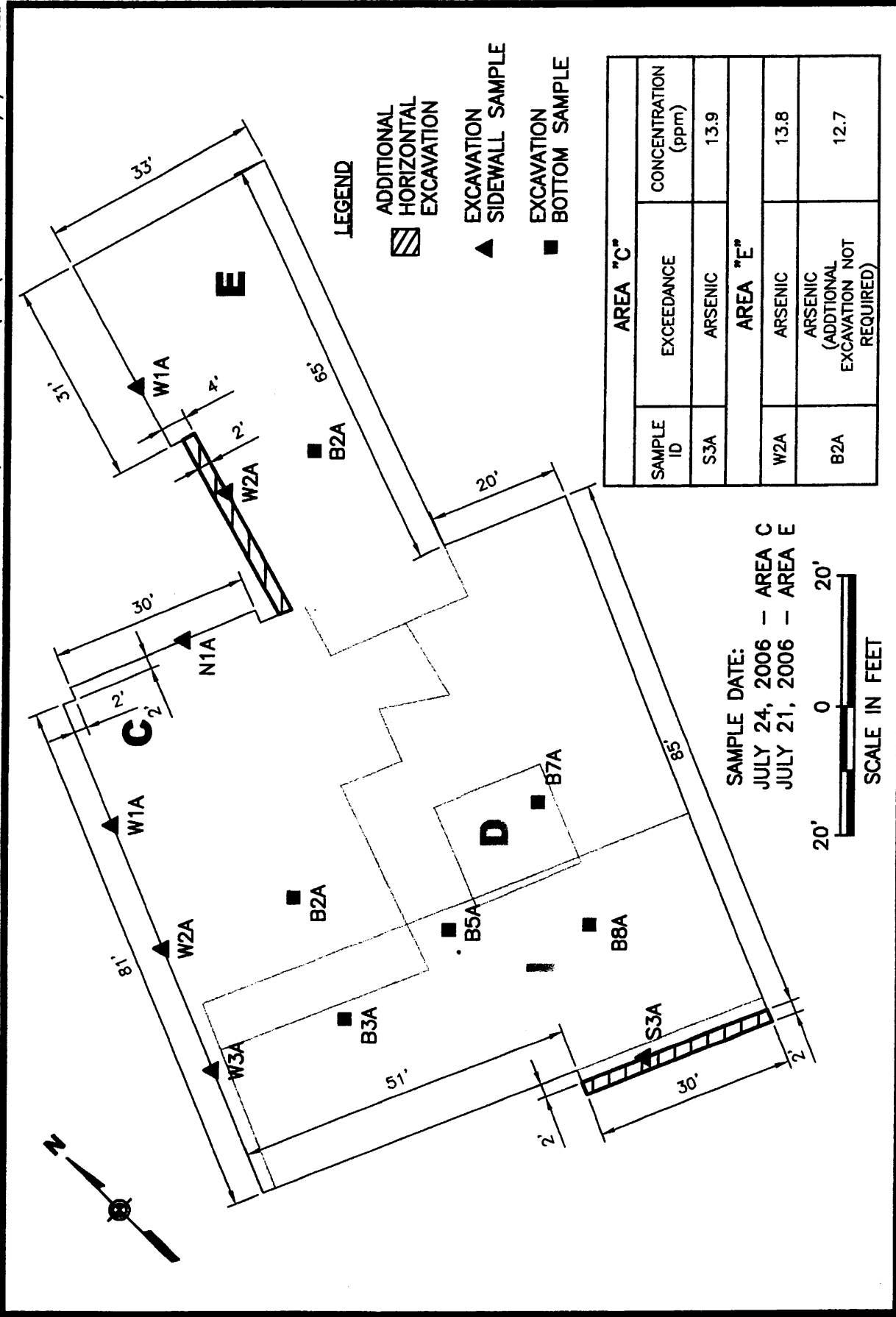

CAMP SUMMIT  
 SECOND OVER-EXCAVATION - AREA C AND E

FIGURE C-3



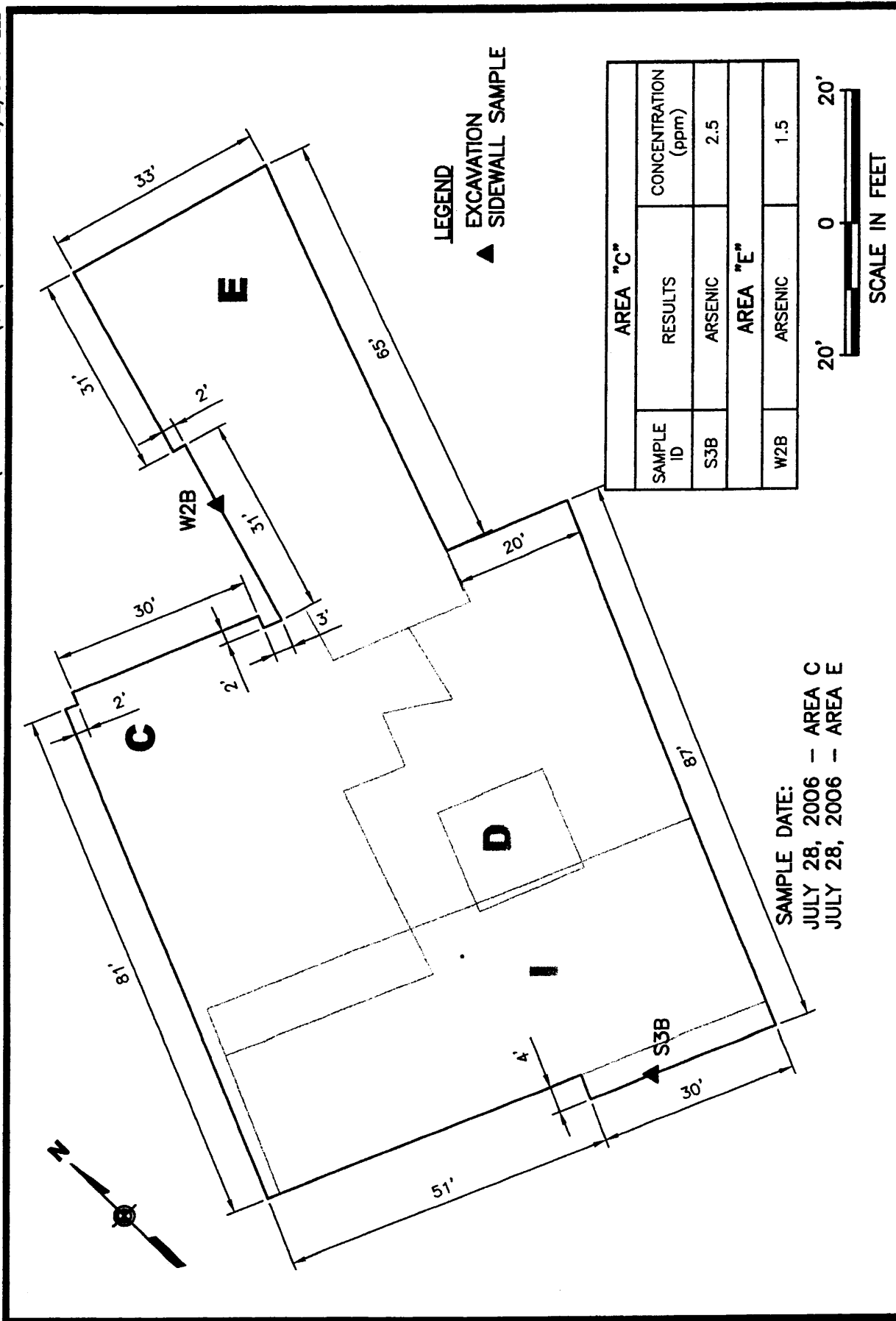

**LEGEND**  
 ▲ EXCAVATION  
 ▲ SIDEWALL SAMPLE

AREA "C"		CONCENTRATION (ppm)	
SAMPLE ID	RESULTS		
S3B	ARSENIC	2.5	
AREA "E"			
W2B	ARSENIC	1.5	

SAMPLE DATE:  
 JULY 28, 2006 - AREA C  
 JULY 28, 2006 - AREA E



CAMP SUMMIT  
 FINAL BOUNDARIES - AREA C AND E

FIGURE C-4

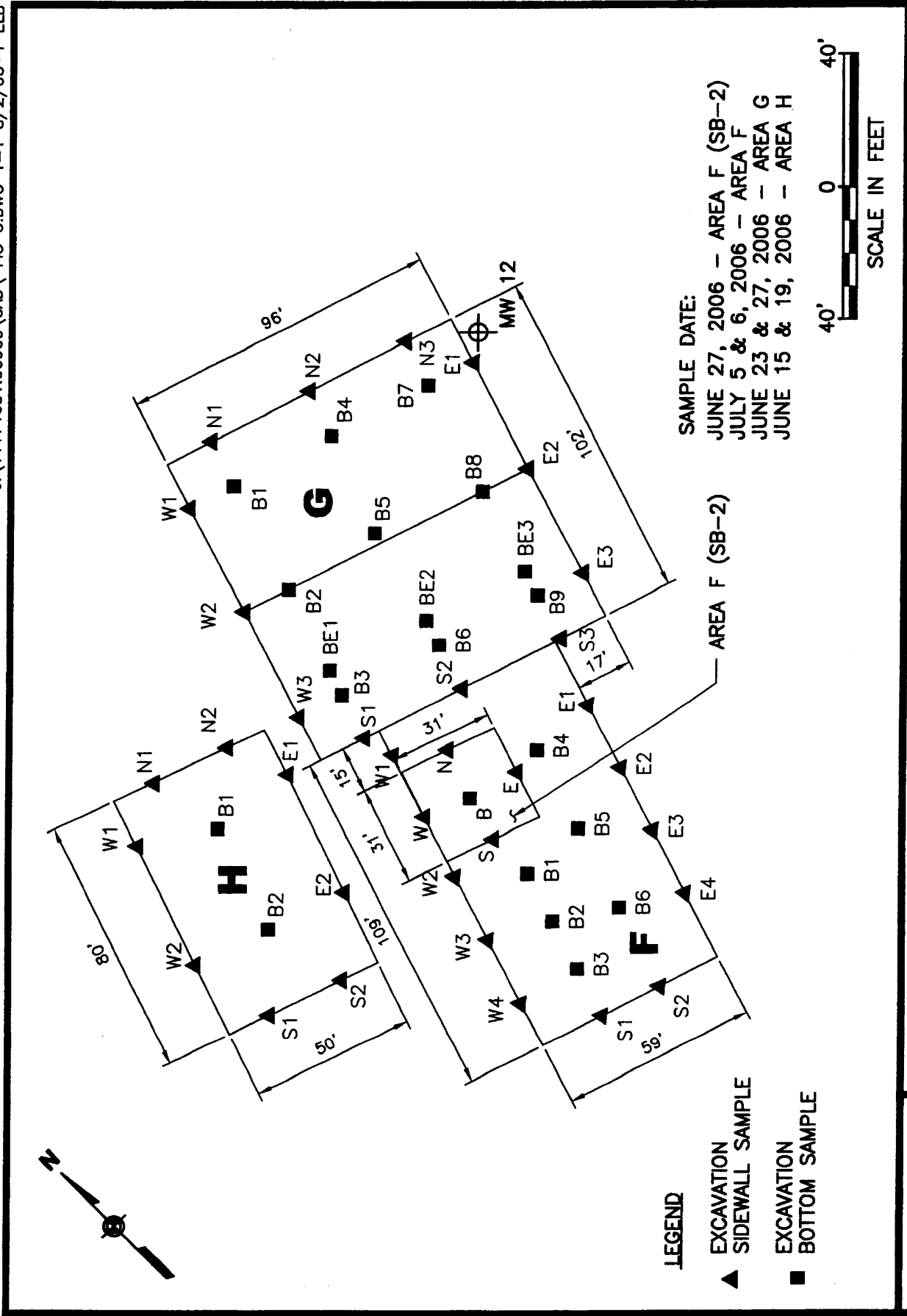

**LEGEND**

- ▲ EXCAVATION SIDEWALL SAMPLE
- EXCAVATION BOTTOM SAMPLE

**SAMPLE DATE:**  
 JUNE 27, 2006 - AREA F (SB-2)  
 JULY 5 & 6, 2006 - AREA F  
 JUNE 23 & 27, 2006 - AREA G  
 JUNE 15 & 19, 2006 - AREA H

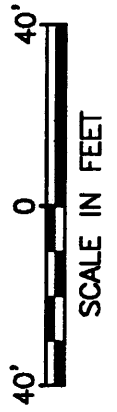

INITIAL EXCAVATION BOUNDARIES - AREAS F, G AND H

FIGURE G-1



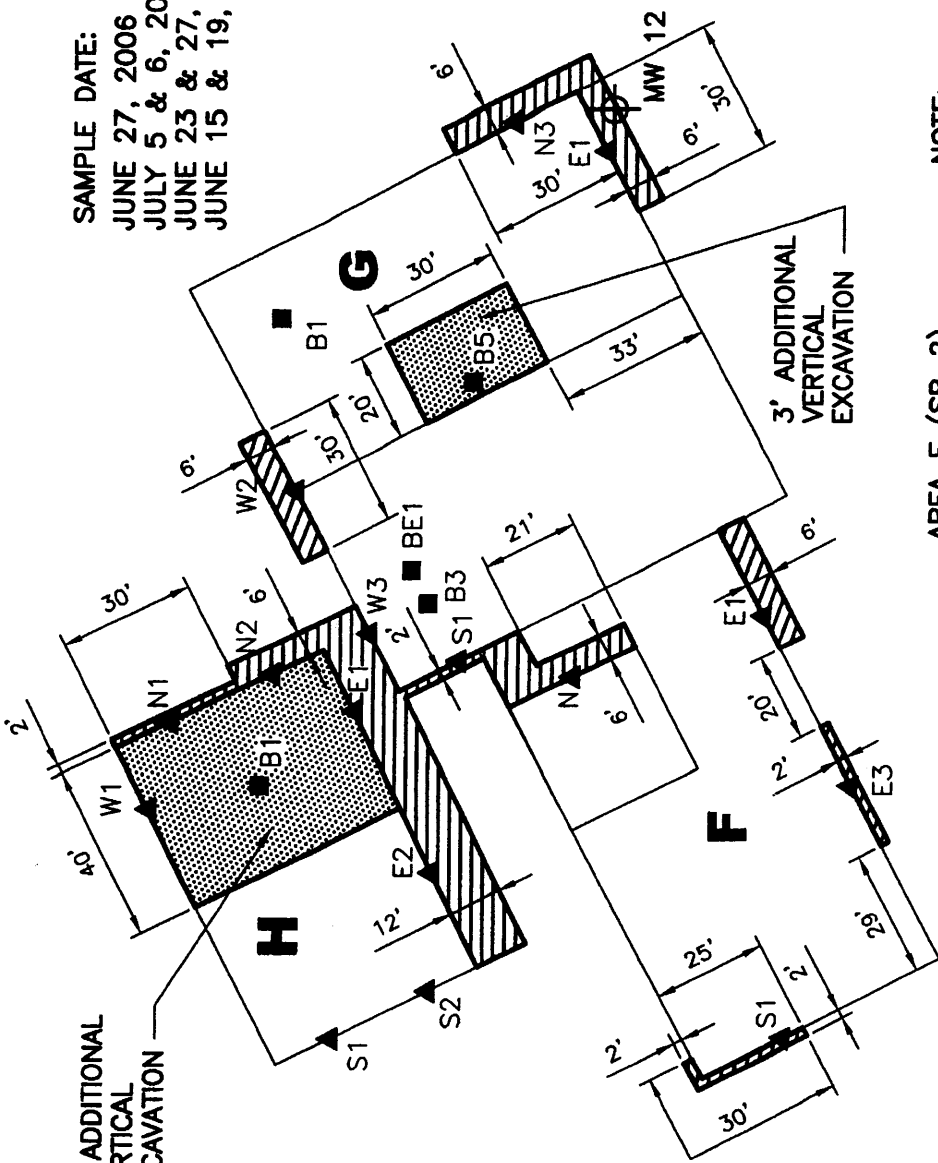

**SAMPLE DATE:**  
 JUNE 27, 2006 - AREA F (SB-2)  
 JULY 5 & 6, 2006 - AREA F  
 JUNE 23 & 27, 2006 - AREA G  
 JUNE 15 & 19, 2006 - AREA H



2' ADDITIONAL  
 VERTICAL  
 EXCAVATION

3' ADDITIONAL  
 VERTICAL  
 EXCAVATION

**LEGEND**

-  ADDITIONAL HORIZONTAL EXCAVATION
-  ADDITIONAL VERTICAL EXCAVATION
-  EXCAVATION SIDEWALL SAMPLE
-  EXCAVATION BOTTOM SAMPLE

AREA F (SB-2)

**NOTE:**

1. FOR TABLE OF EXCEEDANCE, SEE FIGURE G-2A.

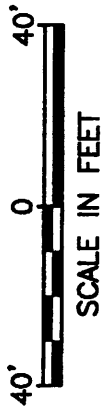

CAMP SUMMIT  
 FIRST OVER-EXCAVATION - AREAS F, G AND H

FIGURE G-2

AREA "F"		
SAMPLE ID	EXCEEDANCE	CONCENTRATION (ppm)
N	PENTACHLOROPHENOL	1.2
W	ARSENIC	13.9
S1	ARSENIC	13.6
E1	TEF DIOXIN	0.0018
E3	ARSENIC	12.6

AREA "G"		
SAMPLE ID	EXCEEDANCE	CONCENTRATION (ppm)
N3	PENTACHLOROPHENOL	2.4
S1	COPPER	40.1
E1	TEF DIOXIN	0.011
	PENTACHLOROPHENOL	1.7
W2	ACETONE	0.37
W3	ARSENIC	13.9
B1	ARSENIC	13.2
B3	ARSENIC	12.9
B5	PENTACHLOROPHENOL	1.3
BE1	ARSENIC	13.2

SAMPLE DATE:  
 JUNE 27, 2006 - AREA F (SB-2)  
 JULY 5 & 6, 2006 - AREA F  
 JUNE 23 & 27, 2006 - AREA G  
 JUNE 15 & 19, 2006 - AREA H

AREA "H"		
SAMPLE ID	EXCEEDANCE	CONCENTRATION (ppm)
N1	COPPER	33.1
N2	COPPER	57.1
S1	ARSENIC	15.5
S2	ARSENIC COPPER	13.1 26.9
E1	PENTACHLOROPHENOL	2.0
E2	PENTACHLOROPHENOL	5.5
W1	ARSENIC	13.2
B1	COPPER	221

**NOTE:**

1. FOR PLAN VIEW, SEE FIGURE G-2.

△ OVER EXCAVATION NOT REQUIRED PER  
 PROGRESS MEETING ON JULY 6, 2006.



SAMPLE DATE:  
 JULY 17, 2006 - AREA F  
 JULY 12, 2006 - AREA H

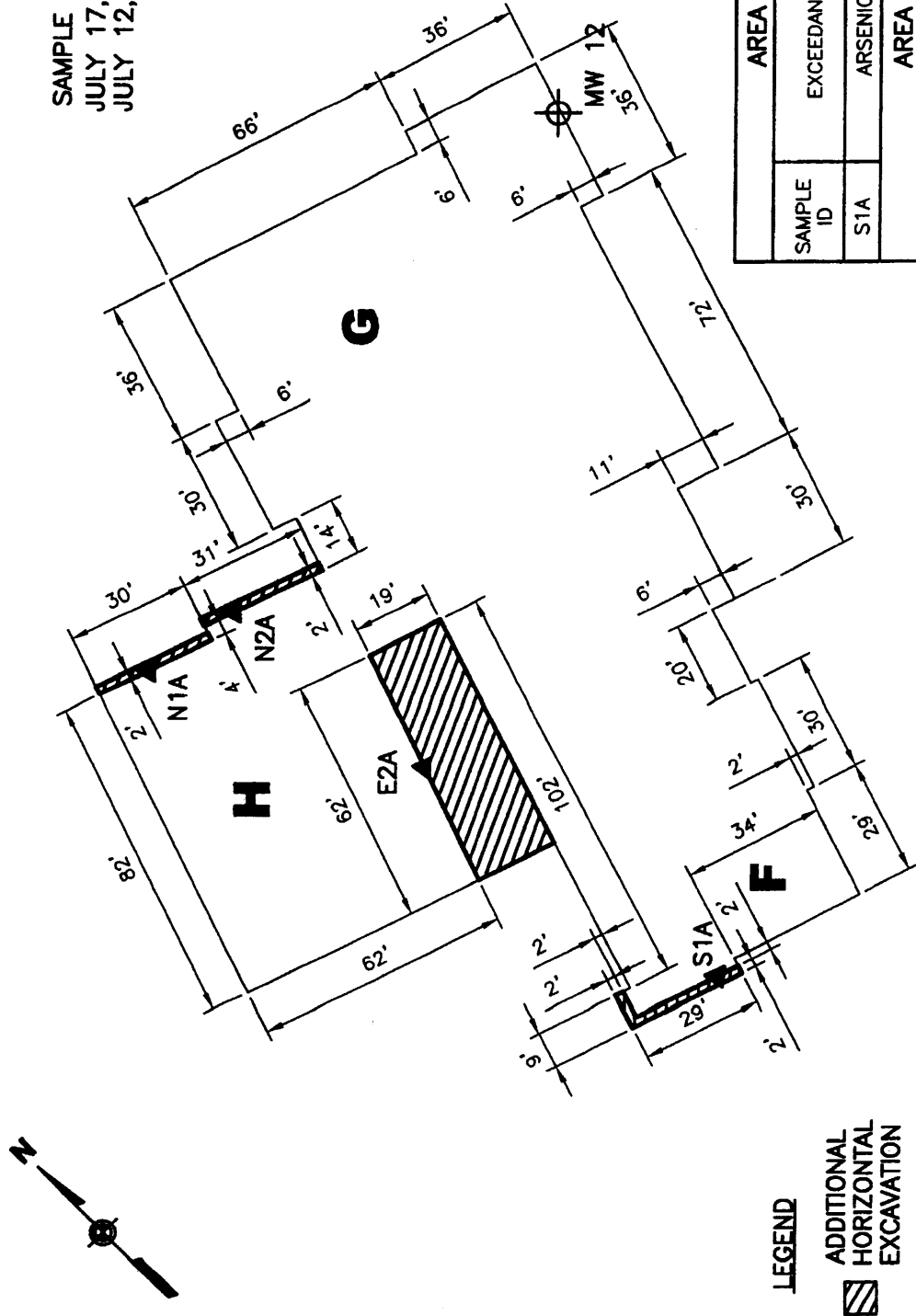

AREA "F"		CONCENTRATION (ppm)
SAMPLE ID	EXCEEDANCE	
S1A	ARSENIC	13.5
AREA "H"		
EZA	PENTACHLOROPHENOL	9.8
N1A	ARSENIC	16.2
N2A	ARSENIC	14.6

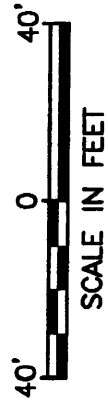

- LEGEND**
- ADDITIONAL HORIZONTAL EXCAVATION
  - EXCAVATION SIDEWALL SAMPLE



CAMP SUMMIT  
 SECOND OVER-EXCAVATION - AREAS F, G AND H

FIGURE G-3

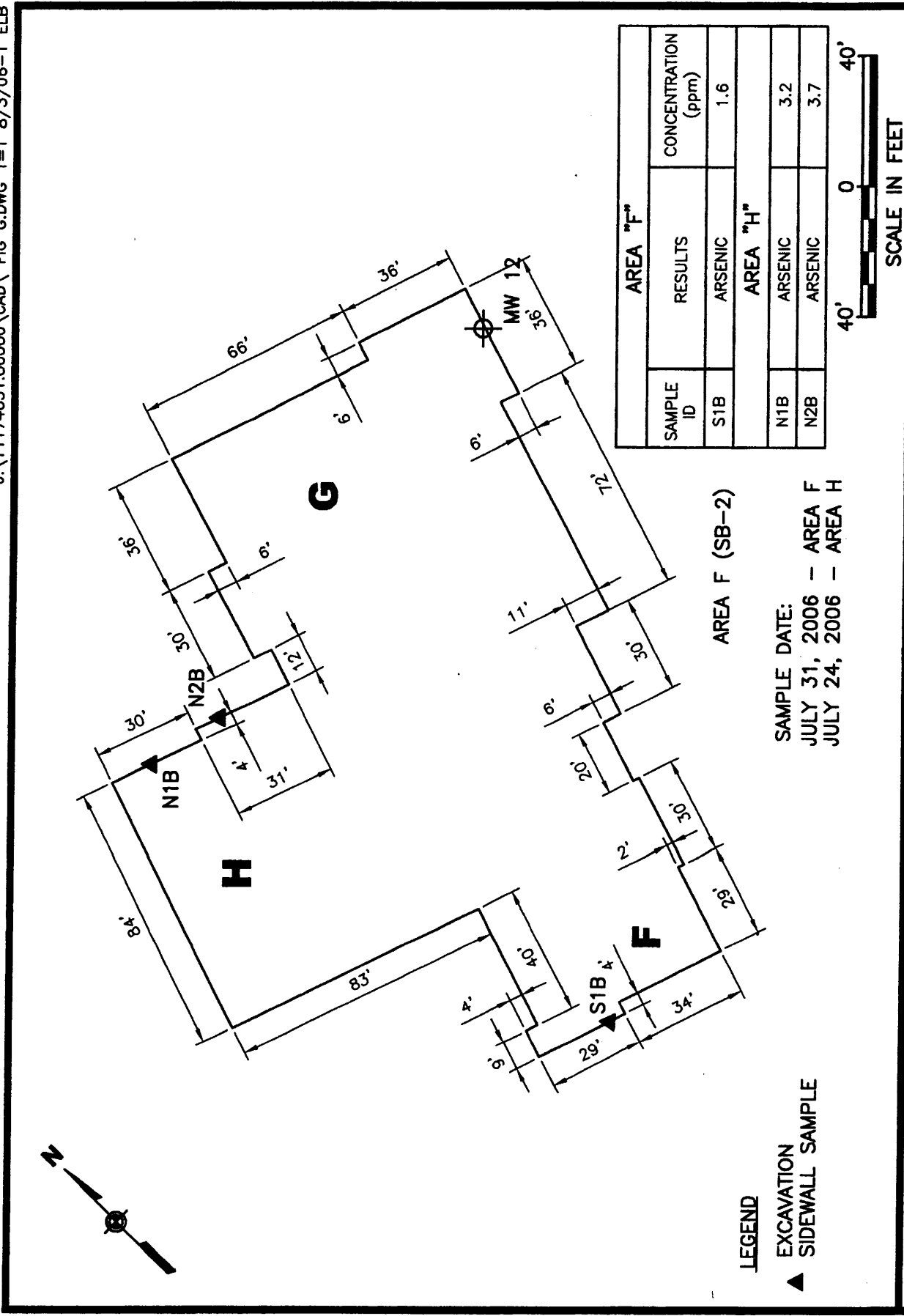

**CAMP SUMMIT**  
**FINAL BOUNDARIES - AREAS F, G AND H**

**FIGURE G-4**

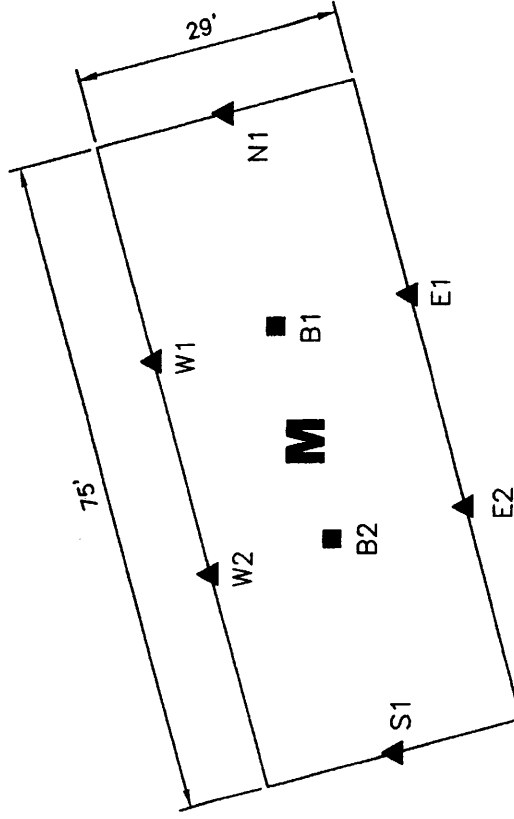
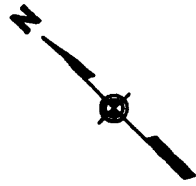

**LEGEND**

- ▲ EXCAVATION SIDEWALL SAMPLE
- EXCAVATION BOTTOM SAMPLE

SAMPLE DATE: JULY 7, 2006

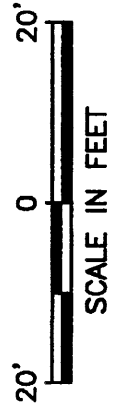

CAMP SUMMIT  
INITIAL EXCAVATION BOUNDARIES - AREA M

FIGURE M-1

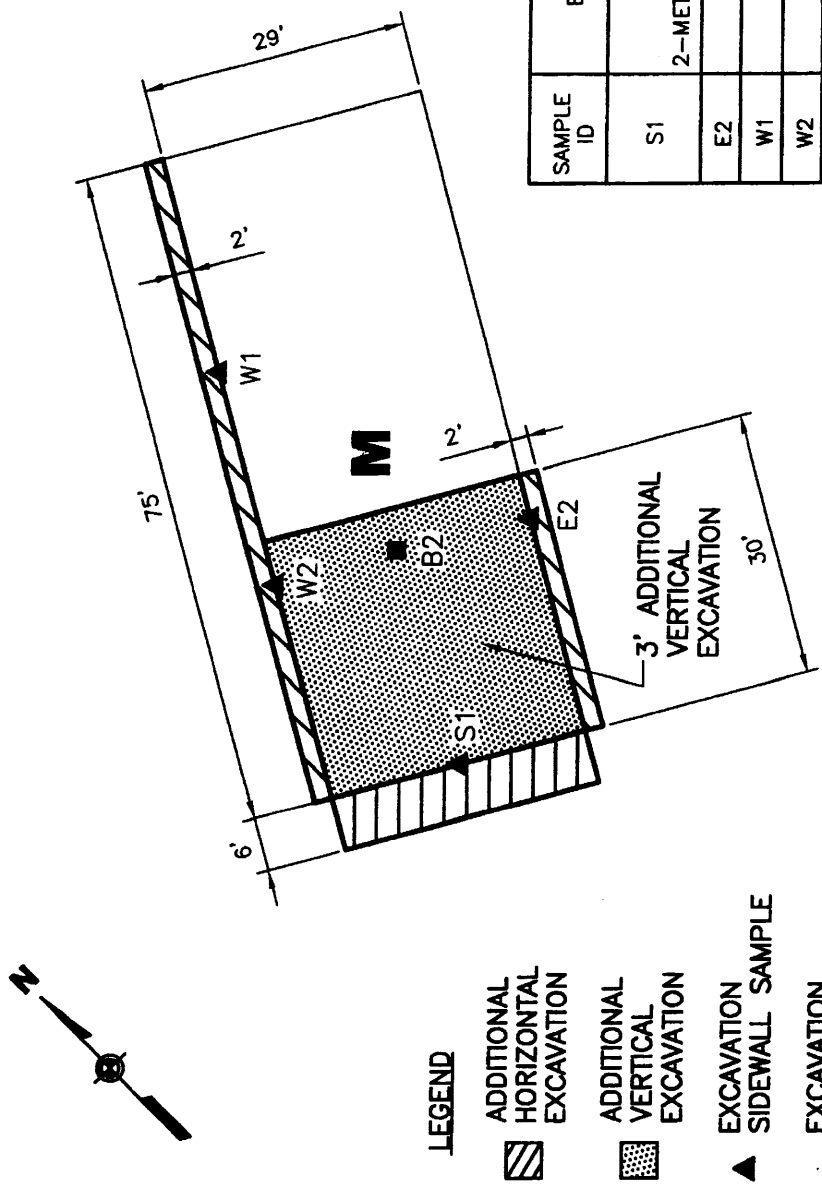

SAMPLE ID	EXCEEDANCE	CONCENTRATION (ppm)
S1	ARSENIC	36.7
	COPPER	130
	2-METHYLNAPHTHALENE	5.6
E2	ARSENIC	13.5
W1	ARSENIC	15.2
W2	ARSENIC	13.9
B2	ARSENIC	12.9
	PENTACHLOROPHENOL	7.2

SAMPLE DATE: JULY 7, 2006

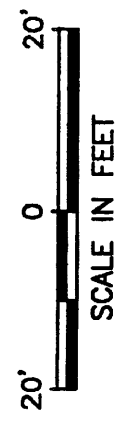



CAMP SUMMIT  
FIRST OVER-EXCAVATION - AREA M

FIGURE M-2

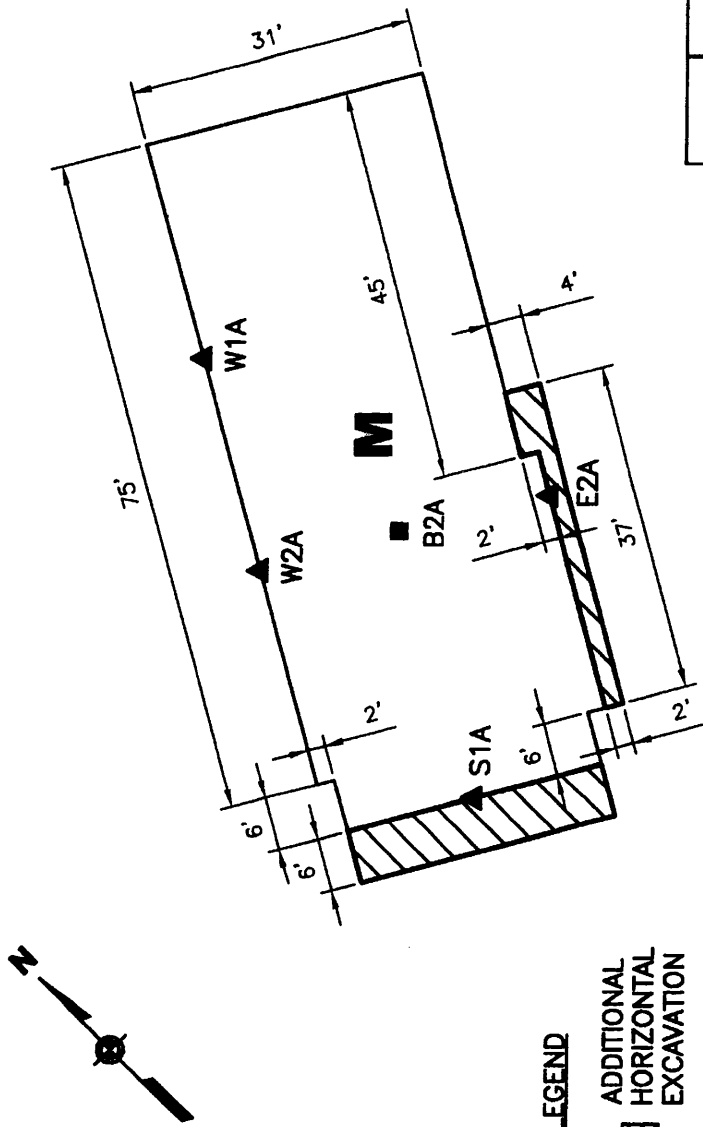



**LEGEND**

-  ADDITIONAL HORIZONTAL EXCAVATION
-  EXCAVATION SIDEWALL SAMPLE
-  EXCAVATION BOTTOM SAMPLE

SAMPLE ID	EXCEEDANCE	CONCENTRATION (ppm)
S1A	ARSENIC	13.1
E2A	2-METHYLNAPHTHALENE	11.0
	ARSENIC	13.1

SAMPLE DATE: JULY 19, 2006

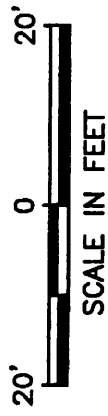

CAMP SUMMIT  
SECOND OVER-EXCAVATION - AREA M

FIGURE M-3

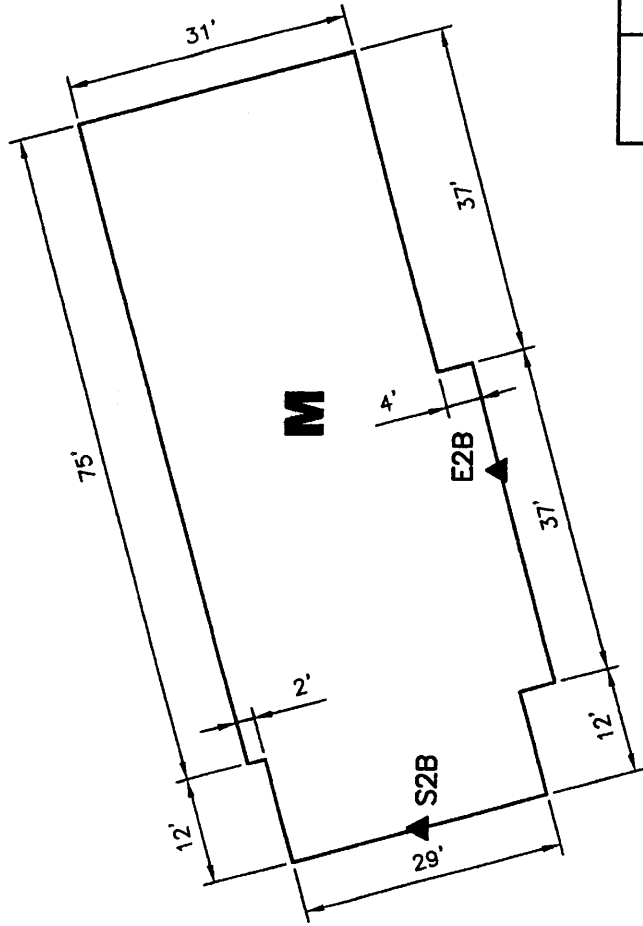
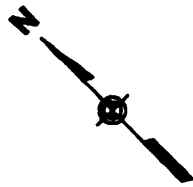

**LEGEND**

- ▲ EXCAVATION
- ▲ SIDEWALL SAMPLE

SAMPLE ID	RESULTS	CONCENTRATION (ppm)
S2B	ARSENIC 2-METHYLNAPHTHALENE	3.3 <0.3
E2B	ARSENIC	2.0

SAMPLE DATE: JULY 28, 2006

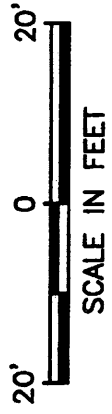

CAMP SUMMIT  
FINAL BOUNDARIES - AREA M

FIGURE M-4

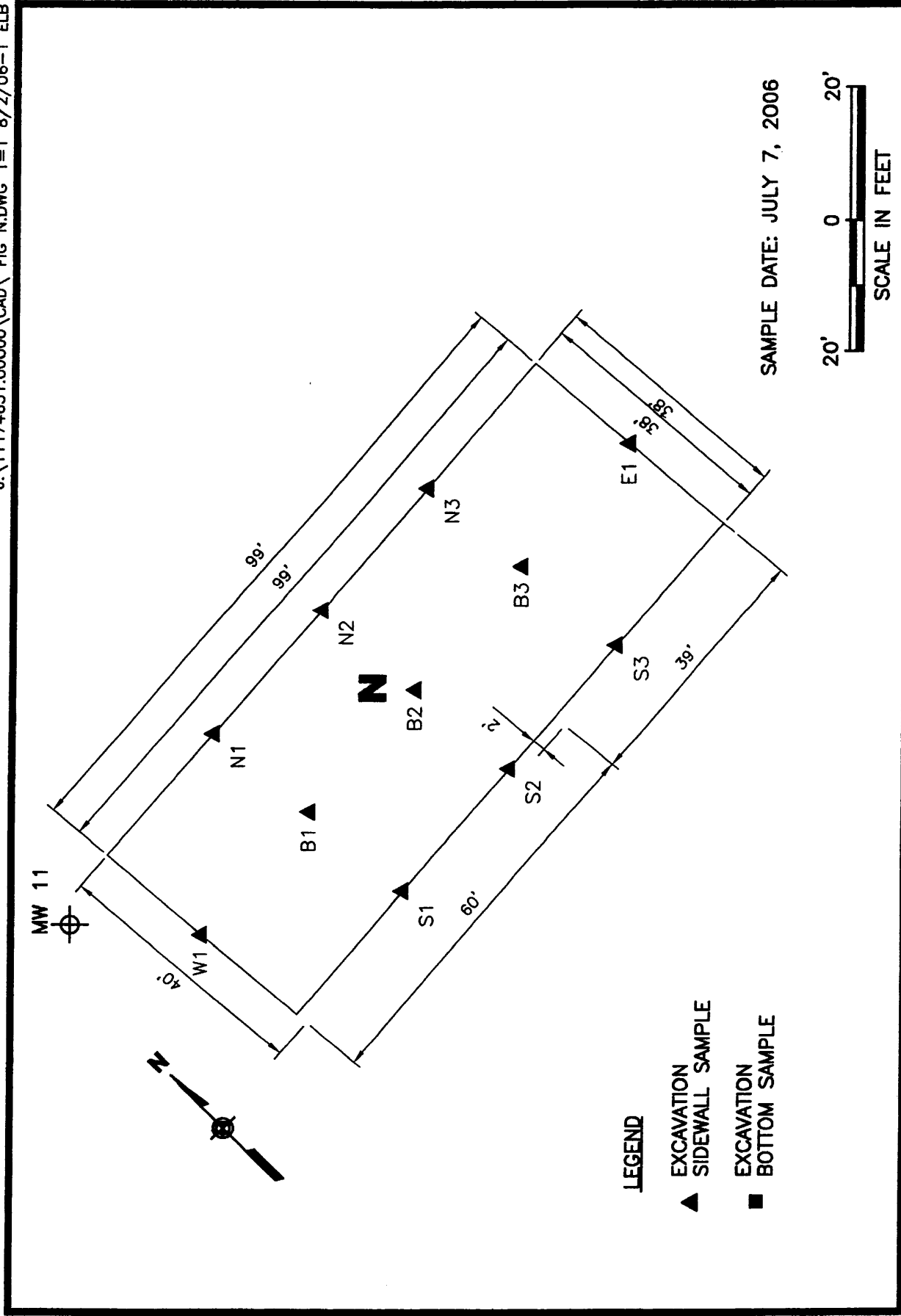

CAMP SUMMIT  
INITIAL EXCAVATION BOUNDARIES - AREA N

FIGURE N-1

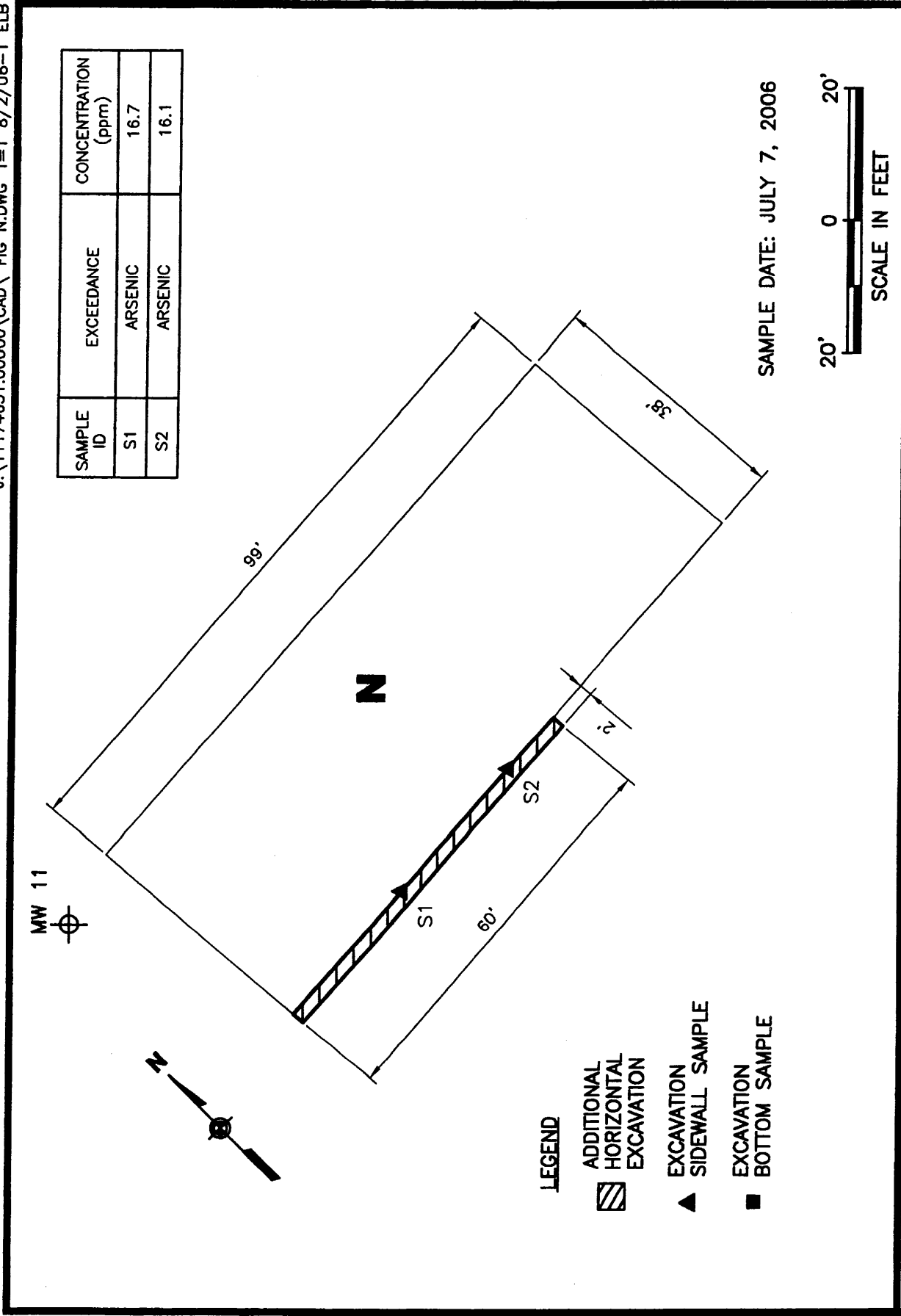

SAMPLE ID	EXCEEDANCE	CONCENTRATION (ppm)
S1	ARSENIC	16.7
S2	ARSENIC	16.1

**LEGEND**

▨ ADDITIONAL HORIZONTAL EXCAVATION

▲ EXCAVATION SIDEWALL SAMPLE

■ EXCAVATION BOTTOM SAMPLE



CAMP SUMMIT  
FIRST OVER-EXCAVATION - AREA N

FIGURE N-2

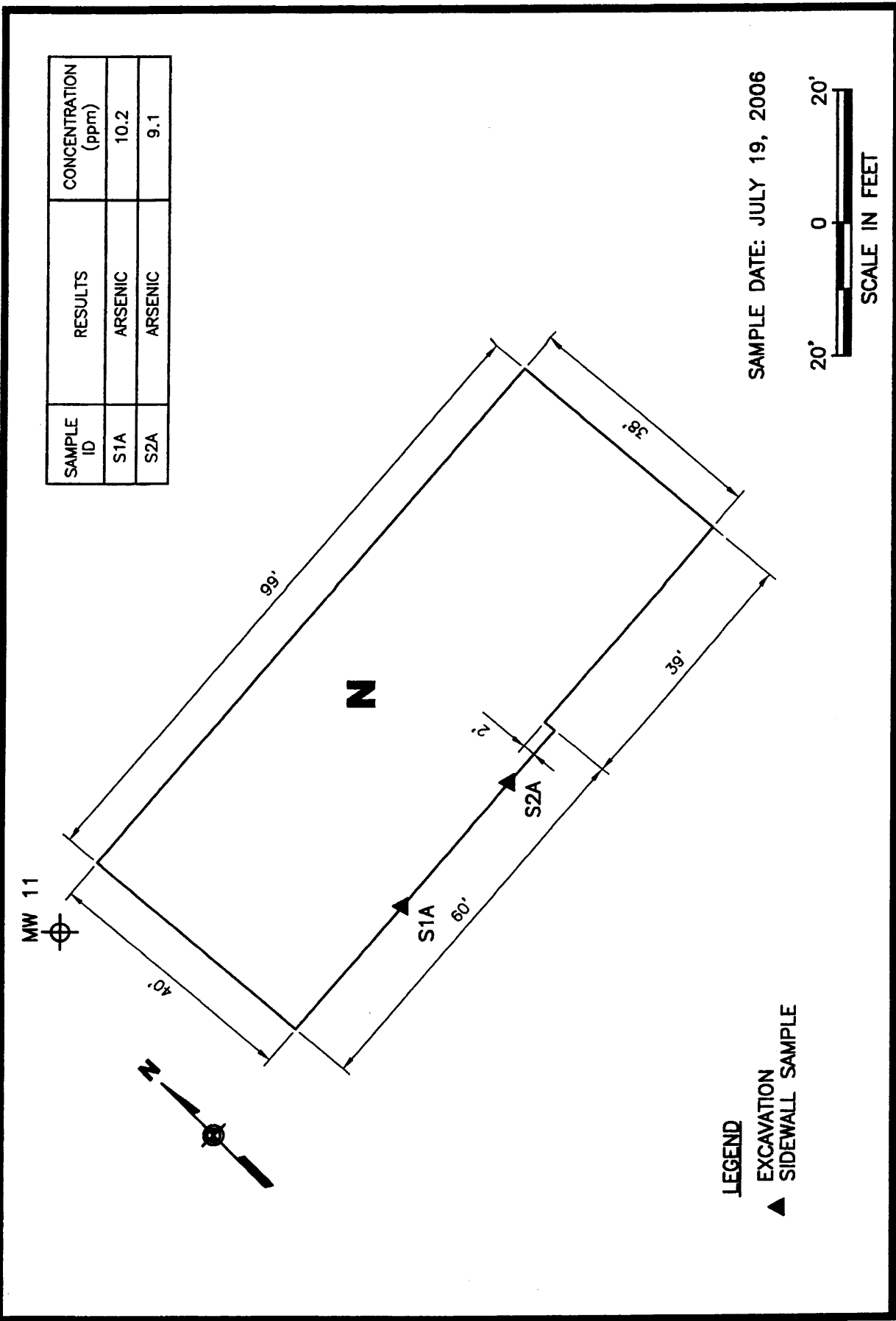

**URS** FINAL BOUNDARIES - AREA N **FIGURE N-3**

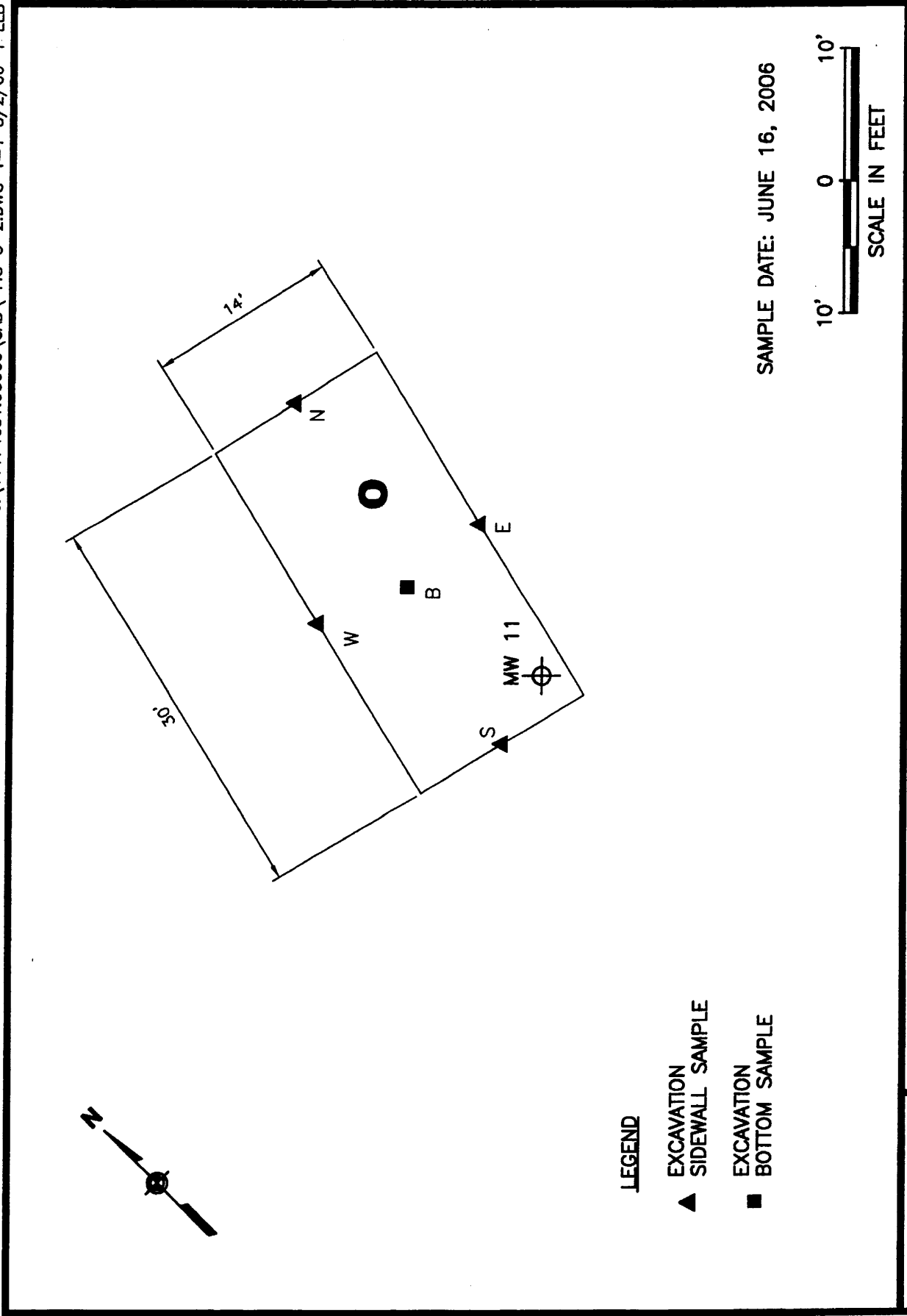

CAMP SUMMIT  
INITIAL EXCAVATION BOUNDARIES -- AREA O

FIGURE O-1

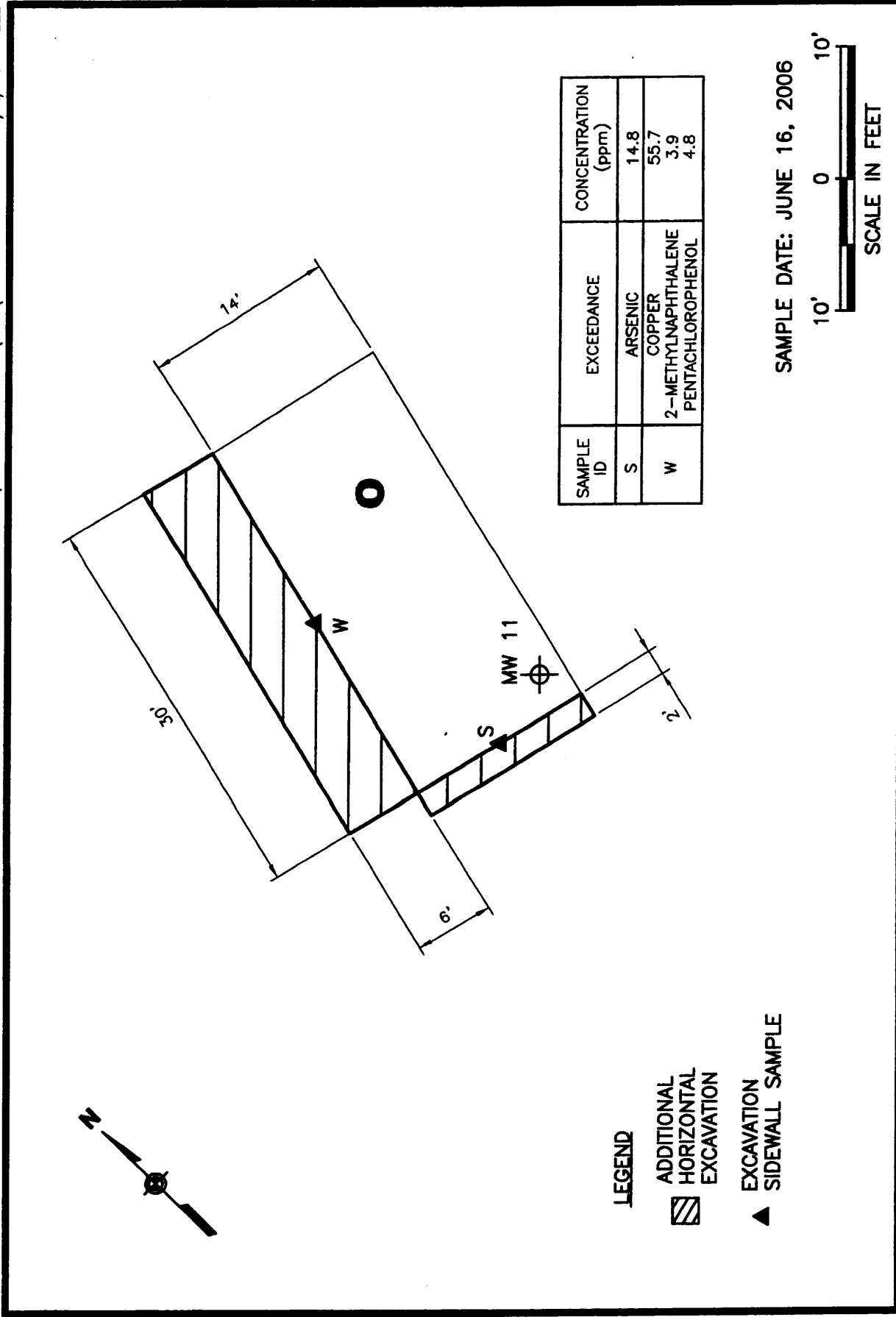

SAMPLE ID	EXCEEDANCE	CONCENTRATION (ppm)
S	ARSENIC	14.8
W	COPPER	55.7
	2-METHYLNAPHTHALENE	3.9
	PENTACHLOROPHENOL	4.8

SAMPLE DATE: JUNE 16, 2006



**LEGEND**

 ADDITIONAL HORIZONTAL EXCAVATION  
 EXCAVATION SIDEWALL SAMPLE



CAMP SUMMIT  
FIRST OVER-EXCAVATION - AREA 0

FIGURE 0-2

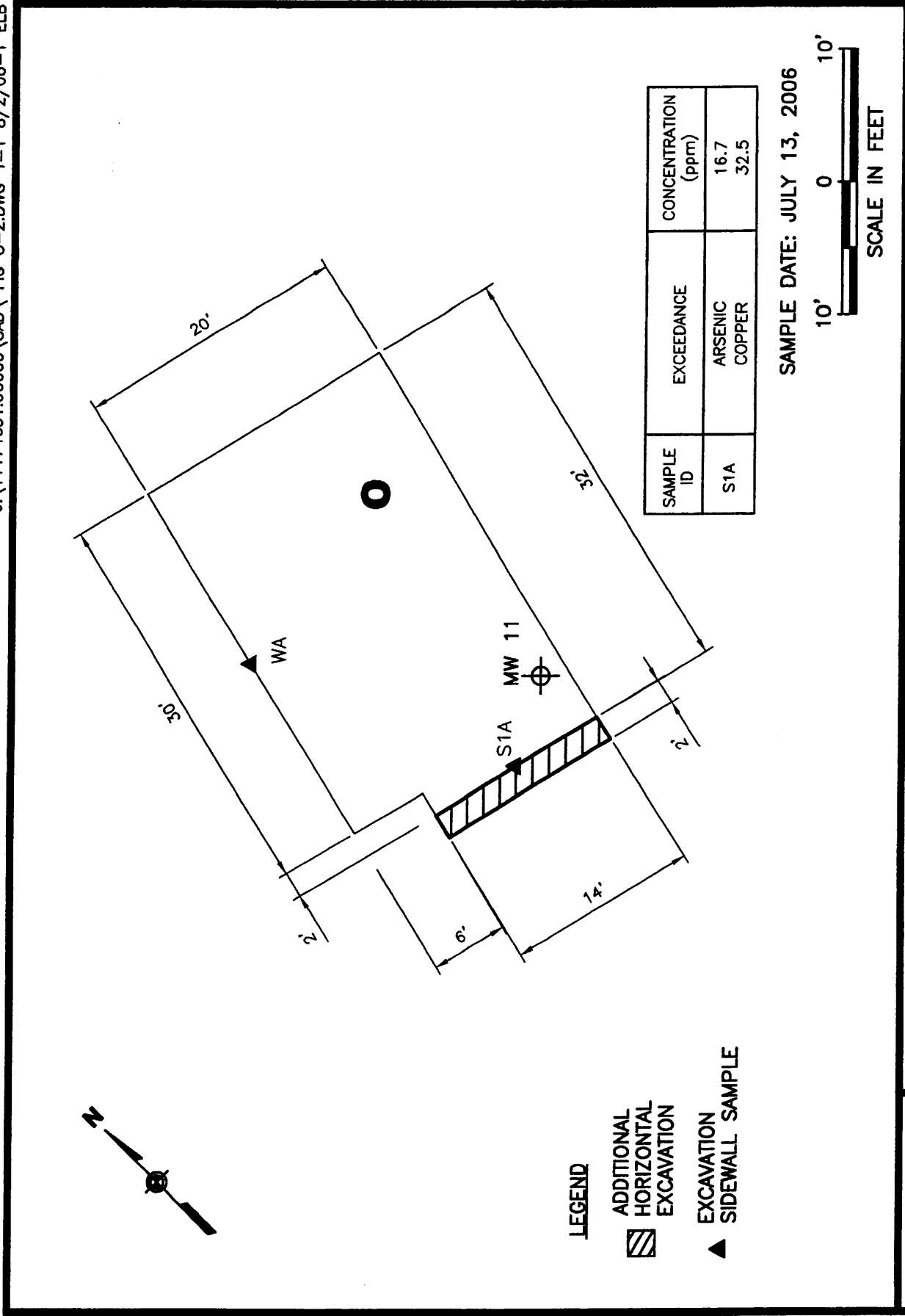

SAMPLE ID	EXCEEDANCE	CONCENTRATION (ppm)
S1A	ARSENIC COPPER	16.7 32.5

SAMPLE DATE: JULY 13, 2006

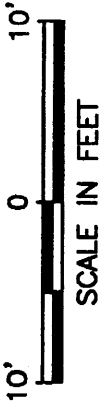

**LEGEND**

-  ADDITIONAL HORIZONTAL EXCAVATION
-  EXCAVATION SIDEWALL SAMPLE



CAMP SUMMIT  
SECOND OVER-EXCAVATION - AREA O

FIGURE O-3



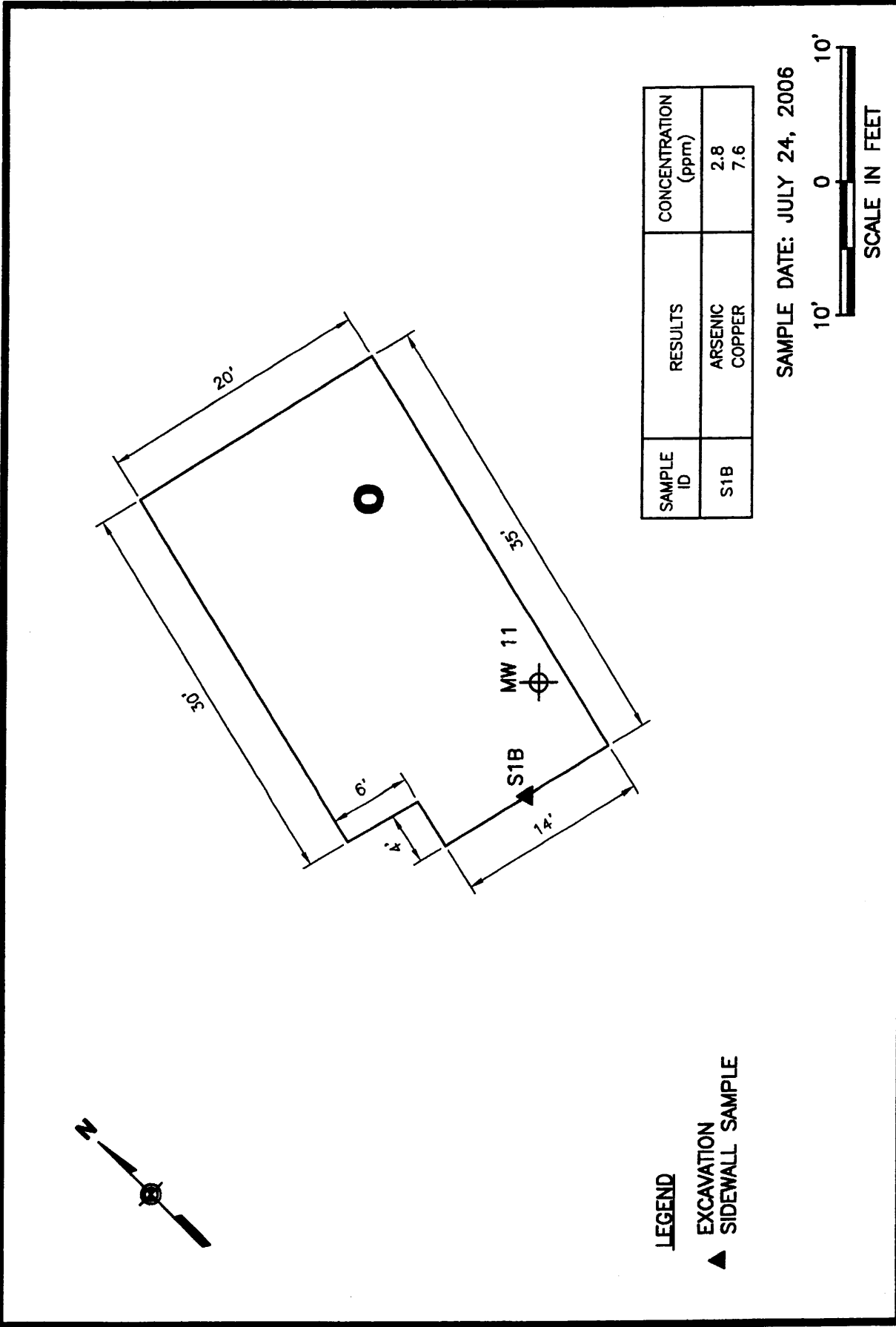

**LEGEND**

- ▲ EXCAVATION
- ▲ SIDEWALL SAMPLE

SAMPLE ID	RESULTS	CONCENTRATION (ppm)
S1B	ARSENIC COPPER	2.8 7.6

SAMPLE DATE: JULY 24, 2006



CAMP SUMMIT  
FINAL BOUNDARIES - AREA 0

FIGURE 0-4

**APPENDIX G**

**DOCUMENTATION SAMPLING SUMMARY,  
ANALYTICAL REPORTS, AND LOCATION MAPS AND  
CHAINS OF CUSTODY (on CD)**

**APPENDIX H**

**MONITORING WELL BORING LOGS, WELL  
CONSTRUCTION DIAGRAMS, DEVELOPMENT LOGS,  
FIELD NOTES, AND CHAINS OF CUSTODY (on CD)**

**APPENDIX I**  
**SUBMITTAL LOG**



**URS CORPORATION**  
 77 Goodell Street  
 Buffalo, New York 14203  
 (716) 856-5636

**PROJECT** *Camp Summit Remedial Construction* 4-48-006  
**OWNER** *New York State Department of Environmental Conservation*  
**URS CORPORATION JOB NO.** 11174631

Shop Drawing and Materials Submittal Control Form		Title and Location		Contract No.:		Contract No.:	
Shop Drawing Number	Contractor's Submittal Number	Description of Material	Supplier or Manufacturer	Received by		Date Returned To Contractor	Remarks
				URS Corp.	Action		
				Date	By	Date	By
1035-01	2.0	Health and Safety Plan		09/08/05	CD	10/19/05	SN
1035-01.1	2.0A	Health and Safety Plan		02/24/06	CD	03/13/06	SN
1035-01.2	2.0B	Health and Safety Plan		04/20/06	CD	04/26/06	CW
1035-01.3	2.0C	Health and Safety Plan		05/04/06	CD	05/08/06	CW
	38.0	Daily Health and Safety Monitoring Data		10/13/06	CW	11/01/06	KJ
01035-02	28.0	Analytical Results of Soil Testing Beneath Decontamination Pad		6/22/2006	CD	07/14/06	CW
		Plan of Remediation for Soil Beneath decontamination pad, as applicable					
01035-03	28.0 #2	Health and Safety, Documentation Sampling Week 1		6/26/2006	CD	7/14/2006	CW
01035-04	28.0 #3	Health and Safety, Documentation Sampling Weeks 2 & 3		7/17/2006	CD	7/31/2006	CW
01035-03.1	28.0 #2A	Health and Safety, Documentation Sampling Week 1		8/1/2006	CD	11/5/2006	KJ
01035-04.1	28.0 #3A	Health and Safety, Documentation Sampling Week 2		8/1/2006	CD	11/5/2006	KJ
01035-05	28.0 #4	Health and Safety, Documentation Sampling Week 3		8/1/2006	CD	11/5/2006	KJ
01035-06	28.0 #5	Health and Safety, Documentation Sampling Week 4		8/1/2006	CD	11/5/2006	KJ
01035-07	28.0 #6	Health and Safety, Documentation Sampling Week 5		8/1/2006	CD	11/5/2006	KJ
01035-08	28.0 #7	Health and Safety, Documentation Sampling		8/28/2006	CD	11/5/2006	KJ
01035-09	28.0 #8	Health and Safety, Documentation Sampling		11/27/2006	CD	11/1/2007	KJ
	38.0 A	Daily Health and Safety Monitoring Data		11/27/2006	CD	1/25/2007	KJ
	38.0 B	Daily Health and Safety Monitoring Data		2/2/2007	CD	2/13/2007	KJ

Action Code: A) No Exceptions Taken B) Revise as Noted C) Amend & Resubmit D) Rejected for Reasons Stated F) For Information Only





**URS CORPORATION**  
 77 Goodell Street  
 Buffalo, New York 14203  
 (716) 856-5636

PROJECT: *nit Remedial Construction* 4-48-006  
 OWNER: *ment of Environmental Conservation*  
 URS CORPORATION JOB NO. 11174631

URS Shop Drawing and Materials Submittal Control Form		Title and Location				Contract No.:	D004440-19	
Shop Drawing Number	Contractor's Submittal Number	Description of Material	Supplier or Manufacturer	Received by				Date Returned To Contractor
				URS Corp.	Action			
				Date	By	Code	Date	By
		Survey and Control Monuments						
		Inspection and Calibration Certificates						
		Subsurface Structure Locations and Elevations						
		Utility Locations and Elevations						
		Grade Control Stakes and Description for Use Area of Consolidation						
	35.0 #2	Field Notes and Data		2/27/2007	CD	A	3/9/2007	KJ
01051-1	35.0	Pre-Construction Topo Survey Drawings		8/3/2006	CW	C	9/1/2006	RP
01051-1	35.0A	Pre-Construction Topo Survey Drawings		9/22/2006	CD	A	10/24/2006	RP

Action Code: A) No Exceptions Taken B) Revise as Noted C) Amend & Resubmit D) Rejected for Reasons Stated F) For Information Only

**SPECIFICATION SECTION 01051 Survey**



**URS CORPORATION**  
 77 Goodell Street  
 Buffalo, New York 14203  
 (716) 856-5636

**PROJECT** Camp Summit Remedial Construction 4-48-006  
**OWNER** New York State Department of Environmental Conservation  
**URS CORPORATION JOB NO.** 11174631

URS Shop Drawing and Materials Submittal Control Form		Title and Location		Contract No.: D004440-19			
Shop Drawing Number	Contractor's Submittal Number	Description of Material	Supplier or Manufacturer	Received by		Date Returned To Contractor	Remarks
				URS Corp. Date	By Code		
01305-01	1.0	Work Plan		9/8/2005	CD C	10/19/2005 CW	
01305-01.1	1.0A	Work Plan		2/22/2006	CD A	3/13/2006 CW	forwarded to Mason for DOCS 5/3/06 w/ CAMP
		Schedule					Updated Schedules submitted at Progress Meetings
	4.9	Sampling Plan		9/8/2005	CD C	10/19/2005 CW	<b>moved to 01405</b>
		Spill Reponse Plan					Submitted as Submittal #10A. Approved on 04/26/06
01305-02	12.0	Contingency Plan		9/8/2005	CD C	10/19/2005 SN	submitted as one document with Health&Safety Plan. (01035)
01305-02.1	12.0	Contingency Plan		2/24/2006	CD C	2/28/2006 SM	
01305-02.2	12.0A	Contingency Plan		4/10/2006	CD A	4/26/2006 CW	
		Technical Submittal Schedule					
	11.0	Community Protection Plan					
	11.0A	Community Protection Plan		4/11/2006	CD A	4/27/2006 CW	

Action Code: A) No Exceptions Taken B) Revise as Noted C) Amend & Resubmit D) Rejected for Reasons Stated F) For Information Only

**SPECIFICATION SECTION**

**01305 Contractor Submittals**





**URS CORPORATION**  
 77 Goodell Street  
 Buffalo, New York 14203  
 (716) 856-5636

**PROJECT** Camp Summit Remedial Construction 4-48-006  
**OWNER** New York State Department of Environmental Conservation  
**URS CORPORATION JOB NO.** 11174631

URS Shop Drawing and Materials Submittal Control Form		Title and Location				Contract No.:	Remarks
		Contractor:		D.A. Collins Environmental Se			
Shop Drawing Number	Contractor's Submittal Number	Description of Material	Supplier or Manufacturer	Received by		Date Returned To Contractor	
				URS Corp.	Action		
				Date	By		
01400-01	3.0	Quality Assurance/Quality Control Plan		09/29/05	CD	10/19/05	
01400-01.1	3.0A	Quality Assurance/Quality Control Plan		04/10/06	CD	05/02/06	
1400-01.2	3.0B	Quality Assurance/Quality Control Plan		05/19/06	CD	06/02/06	verbal request for additional laboratory certifications
1400-01.2	3.0B	Quality Control Plan - Attachment 1		06/05/06	CD	07/13/06	Both 3.0B and Attachment 1 returned
		Testing Laboratory Information					Requirements fulfilled as a result of submittal 3.0B
		Inspection Report of Laboratory					Requirements fulfilled as a result of submittal 3.0B
		Certificate of Testing Equipment Calibration					Requirements fulfilled as a result of submittal 3.0B
		Credentials of Onsite Personnel					Requirements fulfilled as a result of submittal 3.0B
		Inspections and Test Reports					Requirements fulfilled as a result of submittal 3.0B
		Copies of Product Test Reports					Requirements fulfilled as a result of submittal 3.0B
		Copies of All Laboratory Test Data					Requirements fulfilled as a result of submittal 3.0B
		Quality Control Procedures for Individual Submittals					Requirements fulfilled as a result of submittal 3.0B

**Action Code:** A) No Exceptions Taken B) Revise as Noted C) Amend & Resubmit D) Rejected for Reasons Stated F) For Information Only

**SPECIFICATION SECTION**

**01400 Contractor Quality Control**



**URS CORPORATION**  
 77 Goodell Street  
 Buffalo, New York 14203  
 (716) 856-5636

**PROJECT** Camp Summit Remedial Construction 4-48-006  
**OWNER** New York State Department of Environmental Conservation  
**URS CORPORATION JOB NO.** 11174631

URS Shop Drawing and Materials Submittal Control Form		Title and Location		Contract No.:					
Contractor:		D.A. Collins Environmental Service		D004440-19					
Shop Drawing Number	Contractor's Submittal Number	Description of Material	Supplier or Manufacturer	Received by		Date Returned To Contractor	Remarks		
				URS Corp.	Action				
				Date	By	Date	By		
01405-01	4.0	Sampling Plan		09/28/05	CD C	10/18/05	CW	10/19/05	
01405-01.1	4.0A	Sampling Plan		04/10/06	CD C	04/25/06	CW	04/25/06	
01405-01.2	4.0B	Sampling Plan		05/04/06	CD A	05/08/06	CW	05/08/06	forwarded to Mason for DOCS 5/11/06
		Analytical Results - Form Is							Confirmation Sampling Analytical Reports were submitted in accordance with the Contract Documents.
01405-02	32.0	Staging Area & Test Pit (Slab 49) - Analytical Results		06/26/06	CD A	07/14/06	CW	07/17/06	
01405-02.1	32.0A	Staging Area & Test Pit (Slab 49) - Analytical Results		08/01/06	CD A	08/09/06	CW	08/09/06	
01405-03	35.0 #s 1-9	Sampling - Excavation Confirmation Sample Results		08/03/06	CW				Lab reports delivered in boxes to Site for Progress Meeting #6, 1 set each (not 6 sets)
1405-03.1	34.0 #9A	Excavation Confirmation Sample Results (Corrected Confirmation Samples)		08/16/06	CD				Confirmation Sampling Analytical Reports were submitted in accordance with the Contract Documents.
	34.0 #10	Excavation Confirmation Sample Results		08/16/06	CD				1 set only.

Action Code: A) No Exceptions Taken B) Revise as Noted C) Amend & Resubmit D) Rejected for Reasons Stated F) For Information Only



**URS CORPORATION**  
 77 Goodell Street  
 Buffalo, New York 14203  
 (716) 856-5636

**PROJECT** Camp Summit Remedial Construction 4-48-006  
**OWNER** New York State Department of Environmental Conservation  
**URS CORPORATION JOB NO.** 11174631

URS Shop Drawing and Materials Submittal Control Form		Title and Location				Contract No.: D004440-19	Remarks		
Shop Drawing Number	Contractor's Submittal Number	Description of Material	Supplier or Manufacturer	Received by	Date Returned To Contractor				
				URS Corp.	Action				
				Date	By	Code	Date	By	
01510-01	13.0	Permanent Engineer/NYSDEC Field Office: Shop Drawings and Foundation Requirements		02/22/06	CD	C	02/28/06	JN	Submittal closed at Progress Meeting #11, 11/07/06
		Electricity Supply and Lighting							Submittal closed at Progress Meeting #11, 11/07/06
		Water Supply							Submittal closed at Progress Meeting #11, 11/07/06
		Facilities Site Plan							Submittal closed at Progress Meeting #11, 11/07/06
		Detailed Schedule							Submittal closed at Progress Meeting #11, 11/07/06
		Shop Drawings							Submittal closed at Progress Meeting #11, 11/07/06
01510-03	18.0	Pole Barn Kit: Details of Materials and Required Construction		05/19/06	CD	C	5/31/2006	CW	Final approval pending submittal of cost information (Costs in PCO #10, Approved)
1510-03.01	18.0A	Pole Barns		06/22/06	CD	A	7/14/2006	CW	mailed to Contractor (Revise and Resubmit resubmitted 2/21/07)
1510-03.02	18.0 #2	Pole Barns - Engineering Calcs & Drawings		08/28/06	CD	C	1/22/2007	KJ	mailed to Contractor (Revise and Resubmit comment has been rescinded)
1510-03.02	18.0 #2	Pole Barns - Engineering Calcs & Drawings		08/28/06	CD	A	2/21/2007	KJ	mailed to Contractor
01510-03.02	18.0 #3	Pole Barns - Truss Drawings		01/26/07	KJ	A	2/2/2007	KJ	mailed to Contractor
01510-02	14.0	Salt Storage Shed Kit: Details of Materials and Required Construction		2/22/2006	CD	C	2/28/2006	JN	Submittal closed at Progress Meeting #11, 11/07/06
		Description Radio Communication System							Submittal closed at Progress Meeting #11, 11/07/06
		List of Authorized Personnel							
		Log of All Security Incidents							
		Standard Operating Procedure for Foreseeable Contingencies							

Action Code: A) No Exceptions Taken B) Revise as Noted C) Amend & Resubmit D) Rejected for Reasons Stated F) For Information Only



**URS CORPORATION**  
 77 Goodell Street  
 Buffalo, New York 14203  
 (716) 856-5636

**PROJECT** Camp Summit Remedial Construction 4-48-006  
**OWNER** New York State Department of Environmental Conservation  
**URS CORPORATION JOB NO.** 11174631

URS Shop Drawing and Materials Submittal Control Form		Title and Location				Contract No.:	Remarks	
		Contractor:		D.A. Collins Environmental Se				D004440-19
Shop Drawing Number	Contractor's Submittal Number	Description of Material	Supplier or Manufacturer	Received by			Date Returned To Contractor	
				URS Corp.	Action			
				Date	By	Date		
<b>01520-01</b>	31.0	Aerial Photographs		6/22/2006	CD	A	7/10/2006 CW	7/10/2006 email, hard copy returned 7/13/06
		Ground Photographs						Produced by URS
<b>01520-02</b>	31.0 #2	Final Photographs		11/27/2006	CD	A	12/14/2006 KJ	1/25/2007 mailed to Contractor
		Photograph Album						Produced by URS

**Action Code:** A) No Exceptions Taken B) Revise as Noted C) Amend & Resubmit D) Rejected for Reasons Stated F) For Information Only

**SPECIFICATION SECTION 01520 Project Photographs**

N:\1173713\Excel\Submittals\Camp Summit Submittal Log\01520  
 Last Revised: 3/8/2007, 6:15 PM









**URS CORPORATION**  
 77 Goodell Street  
 Buffalo, New York 14203  
 (716) 856-5636

PROJECT Camp Summit Remedial Construction 4-48-006  
 OWNER New York State Department of Environmental Conservation  
 URS CORPORATION JOB NO. 11174631

URS		Title and Location		Contract No.:				
Shop Drawing and Materials Submittal Control Form		Contractor: D.A. Collins Environmental Set		D004440-19				
Shop Drawing Number	Contractor's Submittal Number	Description of Material	Supplier or Manufacturer	Received by			Date Returned To Contractor	Remarks
				URS Corp. Date	By	Code		
		Red-line Drawings		12/20/2006	KJ	A		Contractor and Engineer shared redlines in the field
		Record Drawings Geomembrane Layer		2/5/2007	CD	C	2/22/2007	
		Record Construction Drawings		2/7/2007	KJ	C	2/22/2007	Hard copy returned on 2/22/07
		Electronic Copy, Record Drawings		2/7/2007	KJ	C	2/22/2007	Hard copy returned on 2/22/07

Action Code: A) No Exceptions Taken B) Revise as Noted C) Amend & Resubmit D) Rejected for Reasons Stated F) For Information Only











**URS CORPORATION**  
 77 Goodell Street  
 Buffalo, New York 14203  
 (716) 856-5636

**PROJECT** *Camp Summit Remedial Construction* 4-48-006  
**OWNER** *New York State Department of Environmental Conservation*  
**URS CORPORATION JOB NO.** 11174631

Shop Drawing and Materials Submittal Control Form		Title and Location		Contract No.:		Remarks
Shop Drawing Number	Contractor's Submittal Number	Description of Material	Supplier or Manufacturer	Contractor:		
				URS Corp.	D.A. Collins Environmental Ser	
				Received by	Date Returned To Contractor	
				Date	By	
02210-3	25.0	Off-site Materials		6/8/2006	CD	7/17/2006
		Stockpile Locations				
		Analytical Certification/Test Results				
02210-02	29.0	Filling and Grading - Gas Vent Sand - Analytical & Geotechnical Results		6/22/2006	CD	7/14/2006
02210-02	29.0, #2	Filling and Grading - Barrier Protection Layer - Analytical & Geotechnical Results		6/22/2006	CD	7/14/2006
02210-02	29.0, #2A	Filling and Grading - Barrier Protection Layer - Moisture Density Relations		8/22/2006	CD	9/5/2006
02210-02	29.0, #3	Filling and Grading - Lancaster Common Fill - Analytical & Geotechnical Results		6/29/2006	CD	7/14/2006
		Laboratory Test Reports				
		Equipment				
02210-01	24.0	Traffic Layout		6/5/2006	CD	7/17/2006
02210-01.1	24.0 A	Traffic Layout (Borrow Source Locations)		8/10/2006	CD	8/11/2006
02210-02	29.0, #5	Filling and Grading - Gas Vent Sand and Barrier Protection Layer - Geotechnical Results		9/22/2006	CD	
02210-02	29.0, #6	Filling and Grading - Barrier Protection Layer and Crusher Run - Geotechnical Results		12/12/2006	CD	1/25/2007

Action Code: A) No Exceptions Taken B) Revise as Noted C) Amend & Resubmit D) Rejected for Reasons Stated F) For Information Only













**URS CORPORATION**  
 77 Goodell Street  
 Buffalo, New York 14203  
 (716) 856-5636

**PROJECT** Camp Summit Remedial Construction 4-48-006  
**OWNER** New York State Department of Environmental Conservation  
**URS CORPORATION JOB NO.** 11174631

Shop Drawing and Materials Submittal Control Form		Title and Location						
Shop Drawing Number	Contractor's Submittal Number	Description of Material	Supplier or Manufacturer	Contractor: D.A. Collins Environmental Seal		Contract No.: D004440-19		
				Received by	Remarks			
URS Corp.		Action		Date Returned To Contractor		Remarks		
Date	By	Code	Date	By	Date	By	Remarks	
02371-01	16.0	Geomembrane		CD	4/10/2006	CD	4/25/2006	
02371-01.01	16.0A	Geomembrane		CD	6/19/2006	CD	7/10/2006	email, hard copy returned 7/13/06
02371-01.02	16.0 #2	Geomembrane (Manufacturing QA In-Plant Sampling/Inspection Report and Conformance Test Results)		CW	8/3/2006	A	8/9/2006	
02371-01.03	16.0 #3	Geomembrane (roll certifications, shipment inspection sheet, and resin certification)		CD	8/7/2006	A	8/9/2006	
02371-01.03	16.0 #4	Geomembrane - Poly-Flex 40-mil LLDPE - Destruct Sample Test Results		CD	8/22/2006	A	9/1/2006	
02371-01.03	16.0 #5	Geomembrane - Installation QA/QC Documentation		CD	2/5/2007	C	2/22/2007	Hard copy returned on 2/22/07
02371-01	16.0	Manufacturing Company/Contact		CD	4/10/2006	CD		Submitted and approved with submittal 16.0.
02371-02	16.0	Manufacturer's Instructions		CD	4/10/2006	CD		Submitted and approved with submittal 16.0.
02371-03	16.0	Manufacturer's Experience		CD	4/10/2006	CD		Submitted and approved with submittal 16.0.
02371-04	16.0	Installer's Experience		CD	4/10/2006	CD		Submitted and approved with submittal 16.0.
02371-05	16.0	Certifications		CD	4/10/2006	CD		Submitted and approved with submittal 16.0.
02371-06	16.0	Geomembrane Panel Layout		CD	4/10/2006	CD		Submitted and approved with submittal 16.0A.
02371-07	16.0	Conformance with Specifications		CD	4/10/2006	CD		Submitted and approved with submittal 16.0 #2.
02371-08	16.0	Manufacturer's Test Results		CD	4/10/2006	CD		Submitted and approved with submittal 16.0 #2.
02371-09	16.0	Resin Certification		CD	4/10/2006	CD		Submitted and approved with submittal 16.0 #3.
02371-10	16.0	Seaming Tool Information		CD	4/10/2006	CD		Submitted and approved with submittal 16.0.
02371-11	16.0	Plan of Mitigative Measures		CD	4/10/2006	CD		Submitted and approved with submittal 16.0.
02371-12	16.0	Geomembrane Installation Work Plan		CD	4/10/2006	CD		Submitted and approved with submittal 16.0.
02371-13	16.0	Field Testing Methods		CD	4/10/2006	CD		Submitted and approved with submittal 16.0.
02371-14	16.0	Manufacturer's Acceptable Repair Methods		CD	4/10/2006	CD		Submitted and approved with submittal 16.0.
02371-15	16.0	Proposed Quality Control Forms		CD	4/10/2006	CD		Submitted and approved with submittal 16.0.
02371-16	16.0	Manufacturer's Certification Form for Specialty Items		CD	4/10/2006	CD		Submitted and approved with submittal 16.0A.
02371-17	16.0	Applicable Interface Shear Test Results		CD	4/10/2006	CD		Submitted and approved with submittal 36.0 #2.
02371-18	16.0	Warranty Blank		CD	4/10/2006	CD		Submitted and approved with submittal 16.0A.



**URS CORPORATION**  
 77 Goodell Street  
 Buffalo, New York 14203  
 (716) 856-5636

**PROJECT** Camp Summit Remedial Construction 4-48-006  
**OWNER** New York State Department of Environmental Conservation  
**URS CORPORATION JOB NO.** 11174631

URS Shop Drawing and Materials Submittal Control Form		Title and Location		Contract No.: D004440-19			
Shop Drawing Number	Contractor's Submittal Number	Description of Material	Supplier or Manufacturer	Contractor: D.A. Collins Environmental Seal		Date Returned To Contractor	Remarks
				Received by	Action		
				URS Corp.			
				Date	By	Code	Date
02371-19	16.0	GAI Lab Accreditation		4/10/2006	CD		Submitted and approved with submittal 16.0
02371-20		Geomembrane Samples to Lab					Submitted and approved with submittal 36.0 #2.
02371-21		Schedule of Operations					Not Applicable
02371-22		Subgrade Certification					Submitted and approved with submittal 16.0 #5.
02371-23		Multiple Operations Notice					Not Applicable
02371-24		Alternative Field and Laboratory QC Testing					Not Applicable
02371-25	16.0 #5A	Calibration Certifications Field Equipment			CD	A	3/9/2007 KJ Hard copy returned on 3/9/07
02371-26		Daily Submittals					Submitted and approved with submittal 16.0 #5.
02371-27		Laboratory Test Results					Submitted and approved with submittal 16.0 #5.
02371-28		Weekly Submittals					
02371-29	16.0 #5	Final Report		2/5/2007	CD	C	2/22/2007 KJ Hard copy returned on 2/22/07
02371-30	16.0 #5	Record Drawings		2/5/2007	CD	C	2/22/2007 KJ Hard copy returned on 2/22/07

**Action Code: A) No Exceptions Taken B) Revise as Noted C) Amend & Resubmit D) Rejected for Reasons Stated F) For Information Only**

**02371 Geomembrane**

**SPECIFICATION SECTION**







**URS CORPORATION**  
 77 Goodell Street  
 Buffalo, New York 14203  
 (716) 856-5636

**PROJECT** nit Remedial Constructor 4-48-006  
**OWNER** ment of Environmental Conservator  
**URS CORPORATION JOB NO.** 11174631

URS Shop Drawing and Materials Submittal Control Form				Title and Location			Contract No.:	Remarks
Shop Drawing Number	Contractor's Submittal Number	Description of Material	Supplier or Manufacturer	Contractor: D.A. Collins Environmental Se				
				Received by	Action		Date Returned To Contractor	
				URS Corp.	Code	Date	By	
				Date				
		Well Construction Plan						Submitted and approved with submittal 37.0.
		Product Data						Products deemed appropriate in field by field representative.
<b>02733-02</b>	37.0 #2	Well Construction Diagrams		11/27/06	A	1/11/2007	KJ	Mailed to Contractor.
<b>02733-02</b>	37.0 #2	Boring Logs		11/27/06	A	1/11/2007	KJ	Mailed to Contractor.
<b>02733-02</b>		Well Development Logs		11/27/06				
<b>02733-01</b>	037.0	Monitoring Well Installation Procedures		9/12/2006	A	10/24/2006	KJ	Returned by hand to Contractor at Progress Meeting #11 on 11/07/06.

Action Code: A) No Exceptions Taken B) Revise as Noted C) Amend & Resubmit D) Rejected for Reasons Stated F) For Information Only



**URS CORPORATION**  
 77 Goodell Street  
 Buffalo, New York 14203  
 (716) 856-5636

**PROJECT** Camp Summit Remedial Construction 4-48-006  
**OWNER** New York State Department of Environmental Conservation  
**URS CORPORATION JOB NO.** 11174631

URS Shop Drawing and Materials Submittal Control Form		Title and Location				Contract No.:	Remarks		
Contractor:		D.A. Collins Environmental Ser		D004440-19					
Shop Drawing Number	Contractor's Submittal Number	Description of Material	Supplier or Manufacturer	Received by			Date Returned To Contractor		
				URS Corp.	Action				
				Date	By	Code	Date	By	
		Samples							Submitted and approved with submittal 33.0 #2.
		Analytical Test Results							Submitted and approved with submittal 33.0 #2.
		Laboratory Test Results							Submitted and approved with submittal 33.0 #2A.
		Seed Certifications							Submitted and approved with submittal 33.0.
		Material Data							Submitted and approved with submittal 33.0 #2A.
		Maintenance Instructions							Submitted and approved with submittal 33.0 #2A.
		Equipment List							Submitted and approved with submittal 33.0.
02900-1	33.0	Vegetative Soil and Turf		7/17/2006	CD	A	7/31/2006	CW	8/1/2006
02900-2	033.0 #2	Vegetative Soil and Turf Topsoil Analytical & Geotechnical		8/16/2006	CD	A	8/29/2006	CW, RP	8/29/2006
02900-3	033.0 #2A	Vegetative Soil and Turf		10/29/2006	CD	A	11/2/2006	RP	11/7/2006
									Returned by hand to Contractor at Progress Meeting #11 on 11/07/06.

Action Code: A) No Exceptions Taken B) Revise as Noted C) Amend & Resubmit D) Rejected for Reasons Stated F) For Information Only

**SPECIFICATION SECTION** **02900** **Vegetative Soil and Turf**



**URS CORPORATION**  
 77 Goodell Street  
 Buffalo, New York 14203  
 (716) 856-5636

**PROJECT** Camp Summit Remedial Construction 4-48-006  
**OWNER** New York State Department of Environmental Conservation  
**URS CORPORATION JOB NO.** 11174631

URS Shop Drawing and Materials Submittal Control Form		Title and Location							
Shop Drawing Number	Contractor's Submittal Number	Description of Material	Supplier or Manufacturer	Contractor:		Contract No.:	Date Returned To Contractor	Remarks	
				URS Corp.	D.A. Collins Environmental Serv				
				Date	By	Code	Date	By	
		Dewatering method, drawings, data and calculations							Submitted and approved with submittal 27.0A.
		All components of treatment system							Submitted and approved with submittal 27.0.
		Contingency procedures							Submitted and approved with submittal 27.0.
		Disposal methods of solid waste by products							
		Reports of Operations							
		Test results of analytical samples							All wastewater analytical results were submitted in accordance with the Contract Documents.
11304-01	27.0	Groundwater Treatment System		06/12/06	CD	C	6/19/2006	DM	6/19/2006
11304-01.1	27.0A	Groundwater Treatment System		6/21/2006	CD	A	6/21/2006	DM	7/10/2006
									email, hard copy returned 7/13/06

Action Code: A) No Exceptions Taken B) Revise as Noted C) Amend & Resubmit D) Rejected for Reasons Stated F) For Information Only

**SPECIFICATION SECTION** **11304** **Groundwater Treatment System**

**APPENDIX J**

**ALL PCOs, PCO LOG, CHANGE ORDER NO. 1 (on CD)**



# URS CORPORATION

URS Corporation

77 Goodell Street  
Buffalo, New York 14203  
Phone 716.856.5636 Fax 716.856.2545

Field Office

Camp Summit Remediation Site  
Fulton, New York  
Phone 518.287.1911 Fax 518.287.1920

## Proposed Change Order (PCO) Log

Camp Summit Remediation Site, NYSDEC Site No. 4-48-006

Date: March 6, 2007 (1:36PM)

Y = yes N = no TBD = to be determined

PCO No.	Initiated by / Date	Brief Description of Potential Change Order	Change Order Number	URS Response & Submittal Status	Cost Received, Cost Reviewed	Comments	Date Accepted or Rejected	Proposed Cost Increase or Decrease (per executed Change Order)	Time Increase or Decrease
001	DAC 10/12/06	Protecting existing water line underneath haul roads	CO #1	Accepted	Y, Y		11/01/06	\$4,253.42	0 day
002	DAC					Suspended			
003	DAC 10/12/06	Relocation of Area G power pole	CO #1	Accepted	Y, Y	Receipt from Richmond Power & Light is required	11/01/06	\$3,541.23	0 day
004	DAC 10/12/06	Backfill around DEC office area, grade where salt shed was, excavate and remove dirt with odor, backfill area				Suspended. This work will be completed at a unit cost.			
005	DAC					D.A. Collins will back charge Common Fill. PCO not issued.			
006	DAC 10/12/06	Grade for pole barns and approach area, grade ditch at southwest access road. (Incl. credit for salt shed grading. (\$3,240.82))	CO #1		Y, Y	Contract Amount for grading at Salt Shed has been subtracted from PCO Amount	01/05/07	\$24,796.47	0 day
007	DAC 10/12/06	Install fabric and subbase for pole barns	CO #1	Accepted	Y, Y		11/01/06	\$7,043.90	0 day

PC O. No.	Initiated by / Date	Brief Description of Potential Change Order	Change Order Number	URS Response & Submittal Status	Cost Received, Cost Reviewed	Comments	Date Accepted or Rejected	Cost Increase or Decrease (per executed Change Order)	Time Increase or Decrease
008	DAC 10/12/06	Excavate for piers and septic tank, set and backfill septic tank, excavate for septic drain line, backfill septic drain line and grade off, install millings at DOC's pole barn apron	CO #1	Accepted	Y,Y		11/01/06	\$9,039.26	0 day
009	DAC 10/12/06	Excavated ditch line down access road near main entrance	CO #1	Accepted	Y,Y		11/01/06	\$3,296.24	0 day
010	DAC 12/05/06	Time and materials for Pole Barn and DEC Office Building Construction	CO #1	Accepted	Y,Y		01/05/07	\$86,239.27	0 day
011	DAC 10/12/06	Install catch basin	CO #1	Accepted	Y,Y		11/01/06	\$2,379.63	0 day
012	DAC 11/07/06	Install under drain pipe and backfill under access road	CO #1	Accepted	Y,Y		01/05/07	\$3,459.43	0 day
013	DAC 12/05/06	Place concrete in DEC pole barn	CO #1	Accepted	Y,Y		01/05/07	\$17,879.42	0 day
014	DAC 11/07/06	Install additional silt fence	CO #1	Accepted	Y,Y		01/05/07	\$726.22	0 day
015	DAC 11/07/06	Paving DEC parking lot, parking area at the northern end of the site for DEC, apron for DEC barn	CO #1	Accepted	Y,Y		01/05/07	\$16,827.30	0 day
016	DAC 12/13/06	Increased Miscellaneous Topsoil/Vegetative Cover	CO #1	Accepted	Y,Y		01/05/07	\$50,628.55	0 day

**APPENDIX K**

**ALL REQUESTS FOR INFORMATION (RFIs) AND  
RESPONSES**

## Request for Information

Project No.: 4-48-006 RFI No: 001  
Project: Camp Summit Remedial Construction Date: 2/20/06

---

**Question:**

1. Does the Backfill characterization and Excavated contaminated soils destined for off-site disposal (waste characterization) shown in Table 01405-01, need to reported as a Category B deliverable?
  
2. Can Canadian laboratory analytical be utilized to stratify the waste characterization sample requirement?

**If the above question concerns an interpretation of the Contract Documents, the Contractor's interpretation is:**

**Contractor Suggestions:**

Submitted by (Sub): \_\_\_\_\_ Date: \_\_\_\_\_  
Submitted by (GC): \_\_\_\_\_ Date: \_\_\_\_\_

---

Received by (URS): \_\_\_\_\_ Date: \_\_\_\_\_

---

**Response:**

By \_\_\_\_\_ Date: \_\_\_\_\_

---

## Request for Information

Project No.: 4-48-006 RFI No: 001  
Project: Camp Summit Remedial Construction Date: 2/20/06

---

### Question:

1. Does the Backfill characterization and Excavated contaminated soils destined for off-site disposal (waste characterization) shown in Table 01405-01, need to reported as a Category B deliverable?
2. Can Canadian laboratory analytical be utilized to stratify the waste characterization sample requirement?

**If the above question concerns an interpretation of the Contract Documents, the Contractor's interpretation is:**

### **Contractor Suggestions:**

Submitted by (Sub): \_\_\_\_\_ Date: \_\_\_\_\_  
Submitted by (GC): \_\_\_\_\_ Date: \_\_\_\_\_

---

Received by (URS): Colin Wasteneys Date: February 22, 2006

---

### Response:

1. The intent of the Specification is that a minimum of 10% of each type of soil sample (i.e., post excavation confirmation sample, backfill characterization sample, or excavated contaminated soil for off-site disposal) shall be reported with Category B deliverables. Therefore, at least one soil sample per sample type shall be reported with Category B deliverables.
2. Use of a Canadian Laboratory for analysis of waste characterization samples is acceptable as long as the requirements of the disposal facility as well as local and federal agencies are met.

By Colin Wasteneys Date: February 28, 2006

---

## Request for Information

Project No.: 4-48-006 RFI No: 002  
Project: Camp Summit Remedial Construction Date: 2/20/06

---

**Question:**

1. The following information is required in order to fill out the waste profile information sheet:
  - a. Owner Name / Address
  - b. Contact Name
  - c. Site Name / Address
  - d. EPA ID#
  
2. We also need to know who has authority to sign:
  - a. Waste Profiles
  - b. Export/Import permit applications
  - c. Manifests

**If the above question concerns an interpretation of the Contract Documents, the Contractor's interpretation is:**

**Contractor Suggestions:**

Submitted by (Sub): \_\_\_\_\_ Date: \_\_\_\_\_  
Submitted by (GC): \_\_\_\_\_ Date: \_\_\_\_\_

---

Received by (URS): \_\_\_\_\_ Date: \_\_\_\_\_

---

**Response:**

By \_\_\_\_\_ Date: \_\_\_\_\_

---

## Request for Information

Project No.: 4-48-006 RFI No: 002  
Project: Camp Summit Remedial Construction Date: 2/20/06

---

**Question:**

1. The following information is required in order to fill out the waste profile information sheet:
  - a. Owner Name / Address
  - b. Contact Name
  - c. Site Name / Address
  - d. EPA ID#
  
2. We also need to know who has authority to sign:
  - a. Waste Profiles
  - b. Export/Import permit applications
  - c. Manifests

**If the above question concerns an interpretation of the Contract Documents, the Contractor's interpretation is:**

**Contractor Suggestions:**

Submitted by (Sub): \_\_\_\_\_ Date: \_\_\_\_\_  
Submitted by (GC): \_\_\_\_\_ Date: \_\_\_\_\_

---

Received by (URS): Colin Wasteneys Date: February 22, 2006

---

**Response:**

1.
  - a. Owner Name / Address - NYSDEC  
625 Broadway  
Albany, NY 12233
  - b. Contact Name Michael Mason
  - c. Site Name / Address Camp Summit

137 Eagle Heights Road  
Summit, NY 12175

d. EPA ID#

NYD987000866

2. See below for the appropriate signature authorizations:

- |                                      |  |
|--------------------------------------|--|
| 3. Waste Profiles                    | Michael Mason, NYSDEC or URS as agent for NYSDEC |
| 4. Export/Import permit applications | Michael Mason, NYSDEC                            |
| 5. Manifests                         | Michael Mason, NYSDEC or URS as agent for NYSDEC |

By Colin Wasteneys Date: February 28, 2006

---



## Request for Information

Project No.: 4-48-006 RFI No: 003  
Project: Camp Summit Remedial Construction Date: 2/20/06

---

**Question:**

1. In Supplementary Specification Section 02325 - Direct Shear Interface Testing, it states that a shear test needs to be performed on Barrier Protection Layer Soil / Geomembrane. The details do not show a Barrier Protection Layer Soil / Geomembrane interface. Is a direct shear test required for this interface?

**If the above question concerns an interpretation of the Contract Documents, the Contractor's interpretation is:**

**Contractor Suggestions:**

Submitted by (Sub): \_\_\_\_\_ Date: \_\_\_\_\_  
Submitted by (GC): \_\_\_\_\_ Date: \_\_\_\_\_

---

Received by (URS): \_\_\_\_\_ Date: \_\_\_\_\_

---

**Response:**

By \_\_\_\_\_ Date: \_\_\_\_\_

---

## Request for Information

Project No.: 4-48-006 RFI No: 003  
Project: Camp Summit Remedial Construction Date: 2/20/06

---

### **Question:**

1. In Supplementary Specification Section 02325 - Direct Shear Interface Testing, it states that a shear test needs to be performed on Barrier Protection Layer Soil / Geomembrane. The details do not show a Barrier Protection Layer Soil / Geomembrane interface. Is a direct shear test required for this interface?

**If the above question concerns an interpretation of the Contract Documents, the Contractor's interpretation is:**

### **Contractor Suggestions:**

Submitted by (Sub): \_\_\_\_\_ Date: \_\_\_\_\_

Submitted by (GC): \_\_\_\_\_ Date: \_\_\_\_\_

---

Received by (URS): Colin Wasteneys Date: February 22, 2006

---

### **Response:**

1. The Barrier Protection Layer (BPL)/Geomembrane interface is shown in Table 02325-1 because a cushion geotextile may be eliminated if the maximum particle size in the BPL is 3/8 inch, provided all other specification requirements (such as interface shear) of the BPL are met. Refer to Section 02210, paragraph 2.02C1 where it indicates the condition where no cushion geotextile is necessary.

By Colin Wasteneys Date: February 28, 2006

---

## Request for Information

Project No.: 4-48-006 RFI No: 004  
Project: Camp Summit Remedial Construction Date: 5/03/06

---

**Question:**

Questions from NYS DEC office building subcontractors.

1. The AC and heating duct work is shown on drawing A3 coming up from the basement but it does not show where the duct work goes in the building. Who is responsible for the installation?
2. How takes care of the water and sewer? Does the building contractor just have to hook it up or are they responsible for the installation.
3. Are there any specs on the counter and cabinets?

**If the above question concerns an interpretation of the Contract Documents, the Contractor's interpretation is:**

**Contractor Suggestions:**

Submitted by (Sub): \_\_\_\_\_ Date: \_\_\_\_\_  
Submitted by (GC): \_\_\_\_\_ Date: \_\_\_\_\_

---

Received by (URS): \_\_\_\_\_ Date: \_\_\_\_\_

---

**Response:**

By \_\_\_\_\_ Date: \_\_\_\_\_

---

## Request for Information

Project No.: 4-48-006 RFI No: 004  
Project: Camp Summit Remedial Construction Date: 5/9/06

---

### Question:

Questions from NYS DEC office building subcontractors.

1. The AC and heating duct work is shown on drawing A3 coming up from the basement but it does not show where the duct work goes in the building. Who is responsible for the installation?
2. How takes care of the water and sewer? Does the building contractor just have to hook it up or are they responsible for the installation.
3. Are there any specs on the counter and cabinets?

**If the above question concerns an interpretation of the Contract Documents, the Contractor's interpretation is:**

### **Contractor Suggestions:**

Submitted by (Sub): \_\_\_\_\_ Date: \_\_\_\_\_

Submitted by (GC): Scott Serviss Date: 5/3/06

Received by (URS): Colin Wasteneys Date: 5/3/06

### Response:

1. The Contractor is responsible for design and installation of the heating and air conditioning systems. The duct(s) shown on the drawing show the location where the Contractor may run ducts from the basement to the attic.
2. The Contractor is responsible for the complete water hook up, from source to to the building systems. The Contractor will be responsible to make the septic connection at the 4" pipe in the basement. The rest of the septic system will be by others.
3. The Cabinetry to be ARISTOKRAFT Cabinetry (Stock Building Supply)

Style: Westbury, Wood Type: Oak, Finish: Wheat

OR

KRAFTMAID Cabinetry (The Home Depot)  
Style: Solid Raised, Wood Type: Oak, Finish: Honey Spice.

Base Cabinets: 1-36" sink base, 2-30" base units  
Wall Cabinets: 1- 36"x24" bridge unit, 2-30"x30" wall units

Counter top to be High Quality Laminate. WILSONART Laminate, matte finish.

By Peter Sproul, NYSDEC Division of Operations

Date: 5/9/06