

Workplan, hw 360003, 1995-08.

CPPlan. pdf

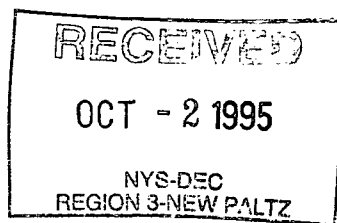

NYSDEC Site ID # 360003

Citizen Participation Plan

for the

Magna Metals Site Inactive Hazardous Waste Disposal Site Town of Cortlandt Westchester County, New York

Prepared by:



FOSTER WHEELER ENVIRONMENTAL CORPORATION

August 1995

NYSDEC Site ID # 360003

Citizen Participation Plan

for the

Magna Metals Site
Inactive Hazardous Waste Disposal Site
Town of Cortlandt
Westchester County, New York

Prepared by:



FOSTER WHEELER ENVIRONMENTAL CORPORATION

August 1995

TABLE OF CONTENTS

	Page
1.0 INTRODUCTION	1-1
2.0 BACKGROUND	2-1
2.1 Site Location and Description	2-1
2.2 Abbreviated Site History	2-1
3.0 PROJECT DESCRIPTION	3-1
3.1 Overview	3-1
3.2 RI/FS Program	3-1
3.3 Habitat-Based Assessment	3-2
3.4 Remedial Investigation/Feasibility Study Report	3-2
3.5 Project Schedule	3-2
4.0 CONTACT LIST	4-1
4.1 Surrounding Properties	4-1
4.2 Local Officials	4-1
4.3 Local Media	4-1
5.0 IDENTIFICATION OF PROJECT CONTACTS	5-1
6.0 DOCUMENT REPOSITORY	6-1
6.1 Location of Repository	6-1
6.2 List of Documents	6-1
7.0 DESCRIPTION OF CITIZEN PARTICIPATION ACTIVITIES FOR EACH ELEMENT OF THE REMEDIAL PROGRAM	7-1
7.1 FSAP Fact Sheet	7-1
7.2 RI/FS Report Fact Sheet	7-1
7.3 Public Meeting	7-1
8.0 GLOSSARY OF KEY TERMS AND MAJOR PROGRAM ELEMENTS	8-1
8.1 Glossary of Key Terms	8-1
8.2 Definitions of Significant Remedial Program Elements and Terms	8-2

APPENDIX A Public Contact List

LIST OF FIGURES

Figure 2-1	Location Map	2-2
Figure 2-2	Site Plan	2-3
Figure 3-1	Project Schedule	3-3

1.0 INTRODUCTION

Presented herein is the Citizen Participation Plan (CPP) for the Remedial Investigation/Feasibility Study (RI/FS) to be performed at the Magna Metals site (the site) by Foster Wheeler Environmental Corporation (Foster Wheeler Environmental). The site is a Class 2 on the New York State Registry of Inactive Hazardous Waste Disposal Sites. The purpose of the RI/S being performed at the site is to access the nature and extent of contamination, identify contaminant migration pathways, determine possible environmental/ecological risks and evaluate remedial alternatives. Foster Wheeler Environmental will be working with the New York State Department of Environmental Conservation (NYSDEC) and New York State Department of Health (NYSDOH) during implementation of the RI/FS. NYSDEC's role will include oversight of the field activities and review of the reports generated by Foster Wheeler Environmental. NYSDOH will provide additional input on the proposed field activities with particular emphasis on any potential public health issues.

As part of the RI/FS program, Foster Wheeler Environmental will conduct a citizen participation program. The citizen participation program promotes public understanding of NYSDEC's and NYSDOH's responsibilities, planning activities and remedial activities. It provides an opportunity for the public to provide input into the RI/FS process ensuring that the remedial program is comprehensive, addresses the public needs and concerns and is protective of human health and the environment.

2.0 BACKGROUND

2.1 Site Location and Description

The site is located in the Town of Cortlandt, Westchester County, New York near the intersection of Furnace Dock Road and Maple Avenue. Nearby towns include Peekskill, two miles northeast and Croton-on-the-Hudson, five miles southwest. The Hudson River is located three miles west of the site. Road access to the site is more than adequate as several routes are available including Route 9/9A, Bear Mountain Parkway, and the Taconic Parkway (see Figure 2-1).

Locally, the site is part of a larger commercial property having several operating businesses which currently include: Con Edison and Silverman Furniture. The Croton Egg Farm is located west of the site. To the north, south and east are residential areas. Also to the north-northwest is an inactive emery mine. A wetland area with a stream, a tributary and on-site pond is located between the site and residential area south of the site. Figure 2-2 presents the site plan.

2.2 Abbreviated Site History

This section summarizes the existing information. One of the goals of the RI/FS to be conducted is to complete the data gaps evident in the following historical discussion.

Metal plating, polishing, and lacquering operations were conducted at the Magna Metals site from 1955 to 1979. The site was formerly owned by ISC Properties, Inc. and is currently owned by Baker Properties, Inc. During operation, iron, lead, copper, nickel, and zinc chlorides, cyanides, and sulfates were discharged to a series of leaching pits. Spent trichloroethylene (TCE) was drummed and removed, but some was allegedly discharged to the septic system.

A water pollution investigation was performed in October 1978 by the Westchester County Health Department (WCHD). Five standing/wastewater samples were taken on October 3, 1978 and analyzed for pH, iron, copper, zinc, cadmium, chromium, cyanide, lead, manganese, and nickel. Concentrations of nickel, cyanide, zinc, copper, and iron exceeded groundwater standards. Lead concentrations exceeded groundwater standards in one sample, however, the detection limit used in the lead analyses was higher than the groundwater standard. Thus, lead concentrations could have been above the groundwater standards but below the detection limit. Soil and bottom sediment samples were collected on the site and upstream and downstream of the site on October 13, 1978. These samples were analyzed for the same parameters as the water samples taken earlier in the month. Zinc and copper were the only metals present above the common range for native soils and oral exposure health based criteria. These metals were found in the two soil samples downslope of the wastewater overflow or site effluent.

WCHD returned on December 15, 1978 with NYSDEC and took five core samples from the sewage overflow area. These samples were analyzed for lead, copper, zinc, chromium and manganese. Zinc concentrations were above the common range for native soils in two samples. Copper concentrations also exceeded the common range for native soils in two samples. The other metals were found in concentrations below or within their common range for native soils.

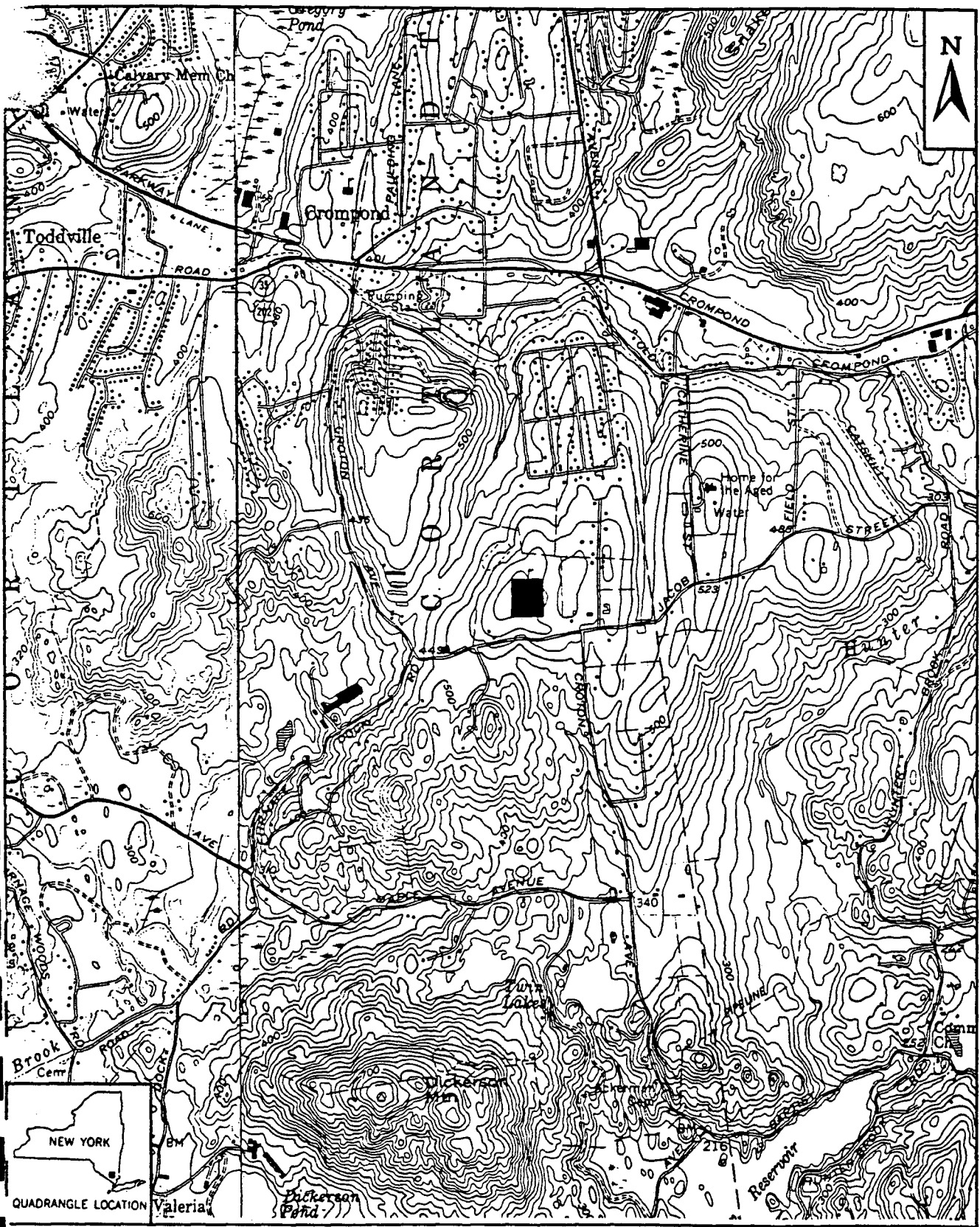

SCALE: 1" = 2000'

FOSTER  WHEELER
 FOSTER WHEELER ENVIRONMENTAL CORPORATION

ISC PROPERTIES
 MAGNA METALS SITE
 SITE LOCATION MAP

FIGURE 2-1

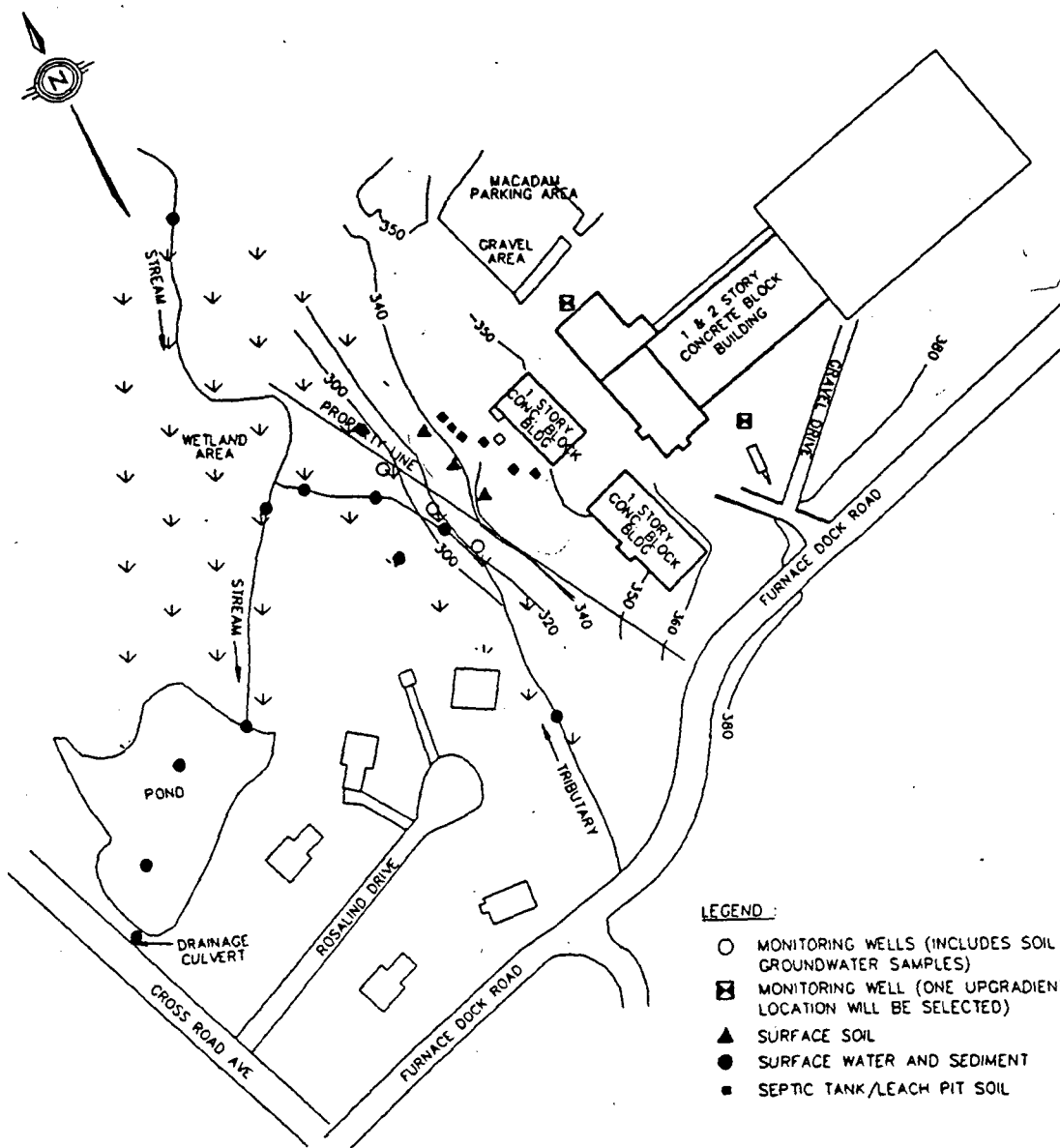

LEGEND:

- MONITORING WELLS (INCLUDES SOIL AND GROUNDWATER SAMPLES)
- ⊠ MONITORING WELL (ONE UPGRADIENT LOCATION WILL BE SELECTED)
- ▲ SURFACE SOIL
- SURFACE WATER AND SEDIMENT
- SEPTIC TANK/LEACH PIT SOIL

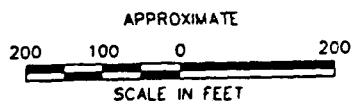

SURFACE FEATURES FROM WESTCHESTER COUNTY, DEPARTMENT OF PLANNING AERIAL PHOTOGRAPH, SPRING 1990

TOPOGRAPHIC INTERPRETATION FROM NYSDEC, 1983

■ 6 TANKS/PITS LOCATED AS OF 3/28/91



SCALE: 1" = 2000'

FOSTER  WHEELER
FOSTER WHEELER ENVIRONMENTAL CORPORATION

ISC PROPERTIES
MAGNA METALS SITE
SITE PLAN

FIGURE 2-2

Metal plating operations ceased in June 1979. That same month, NYSDEC ordered the industrial sludge to be removed from the pits on site. By the end of 1979, the leach pits (not septic and holding tanks) had been emptied by suction hose.

On August 19, 1982, William Cosulich Consulting collected four leaching pit samples for selected trace metals, cyanides, phenols, sulfate, nitrates, and chlorides analyses by General Testing Corporation. The results indicated no apparent metal leaching problems. Sulfates, nitrates and chlorides were present at concentrations less than New York State (NYS) Ambient Water Quality Standards of 250, 10 and 250 ppm (parts per million). In addition, these inorganics generally have low toxicity and are present as background constituents.

On December 29, 1982 and February 1, 2, and March 15, 1983, the WCHD conducted additional water pollution investigations on the property and in Furnace Brook immediately to the west of the property. Except for aesthetic considerations of iron and manganese concentrations at several locations, trace metals in surface water were not found to be elevated (i.e., when compared to NYS Ambient Water Quality Standards). However, several chlorinated volatile organics were detected in Furnace Brook; of major concern were the levels of trichloroethylene (TCE) in the septic tank, a leaching pit off the septic tank and at downstream locations along Furnace Brook and an unnamed tributary.

On May 15, 1984 the NYSDEC Division of Environmental Enforcement resampled the site, specifically for metals and volatile organic analytes (VOAs). Sludge, sediment and/or surface water samples were collected at four locations along the brook/tributary, the septic tank, and three sludge pits. By comparing sediment/sludge sample results to typical soil background levels and surface water sample results to NYS Ambient Water Quality Standards, several observations can be made. Trace metals in sediment samples indicated similar trends, i.e., the 12 priority pollutants were essentially present at background levels (copper was slightly elevated). Sludge samples collected from two pits, however, contained elevated arsenic, selenium, cadmium, chromium, copper, nickel, silver and zinc. EP toxicity tests for the two sludge samples resulted in concentrations below the allowable maximum EP toxicity concentration (and mostly less than detection limit). The results of trace metal analyses for NYSDEC samples basically confirm findings by the WCHD that metals known to be in the leaching pits have apparently not reached Furnace Brook. Sediment and sludge samples also contained high levels of some volatiles; acetone, trichloroethene, and trans-1,2-dichloroethene were seen in the brook sediments. Xylenes, ethylbenzene, and trichloroethene were detected in sludge samples collected from two pits.

Water samples were also analyzed for pesticides and PCBs. ^{Surface water samples analyzed} Analyses for 12 of the 13 priority pollutant metals analyzed in the surface water samples consistently resulted in low concentrations (i.e., mostly less than detection limits); water samples from the septic tank and sludge pit did contain elevated arsenic, selenium, copper, nickel, and zinc concentrations. Pesticides and PCBs were not detected in any of the water samples. The results of VOA analyses showed extremely elevated trichloroethene levels in the septic tank (15,000 ppb) as well as a high concentration (190 ppb) in one pit. Trans-1,2-dichloroethene was detected downstream and in the septic tank. Downstream elevated levels of vinyl chloride and trans-1,2-dichloroethene were also detected (ppb - parts per billion).

ISC Properties has entered into a consent order for the development and implementation of a Remedial Investigation and preparation of a Feasibility Study. A RI/FS Work Plan was incorporated into the Consent Order. ISC Properties has contracted Foster Wheeler Environmental Corporation to conduct the RI/FS.

3.0 PROJECT DESCRIPTION

3.1 Overview

A Remedial Investigation/Feasibility Study (RI/FS) will be performed at the Magna Metals site. The RI determines the nature and extent of contamination through sampling activities which include sampling of soils, groundwater, sediment, and surface water. The information gathered is used to identify contaminant migration pathways and also to determine if the site poses a threat to human health and/or the environment. Results from these analyses are used to develop potential remedial alternatives in a FS. From the list of potential alternatives, a remedial remedy is selected based upon input from NYSDEC, NYSDOH, and public review and comment. The RI/FS results in a Record of Decision (ROD), issued by NYSDEC. The ROD describes how the remedy was chosen and how it will be implemented.

3.2 RI/FS Program

The RI/FS program includes the following tasks:

- Field Investigation
- Habitat Based Assessment
- Remedial Investigation Report
- Feasibility Study

3.2.1 The field investigation will consist of the following subtasks:

- **Leach Pits/Septic Tank/Holding Tank Sampling** - A total of seven samples will be collected from four leach pits, two septic tanks, and one holding tank. One sample will be collected at the bottom of each pit from the 0-2' interval. Soil samples will be collected from the visually most contaminated interval outside the tank or at the approximate tank bottom interval.
- **Surface Water and Sediment Sampling** - A total of 12 locations will be sampled for surface water and sediment. Four of the samples will be collected from the tributary, two samples will be collected after the confluence of the stream and tributary; two samples will be collected from the pond; one sample will be collected at the culvert along Cross Roads Avenue; two samples will be collected in the wetlands area, and one sample upgradient from the stream.
- **Surface Soil Sampling** - Three surface soil samples will be collected west of the septic/holding tanks (i.e., on the downgradient side). The samples will be collected from the midpoint of the slope. One upgradient sample will be collected to establish background levels.
- **Monitoring Well Installation and Groundwater Sampling** - The monitoring well and groundwater sampling program is designed to provide groundwater sampling points immediately downgradient of the source area and a sampling point upgradient to provide background data for comparative analytical purposes. Downgradient wells will be positioned to intercept groundwater flow from the disposal area in the overburden aquifer. Since a large

topographic low area lies west of the site, groundwater flow is anticipated to be in a westerly direction. Therefore, three monitoring wells will be installed west of the site, and one well will be placed upgradient to establish background conditions.

- **Hydraulic Conductivity Testing** - Conductivity testing will be performed on four of the monitoring wells to estimate hydraulic parameters of the overburden at the site. Hydraulic conductivity parameters are used to estimate rate of groundwater movement through the site.
- **Topographic and Sample Location Survey** - Site surveying and mapping will be conducted. Monitoring well elevations will be surveyed to the nearest hundredth foot. Topographic mapping, if required, will include a 800' x 800' base map using a five-foot contour interval showing all major features such as wetland area, streams, tributaries, drainage channels, and structural features such as roads, buildings, fences, etc.

3.3 Habitat-Based Assessment

A habitat-based assessment (HBA) shall be performed in accordance with guidance provided by the New York State Department of Environmental Conservation (NYSDEC) in *Fish and Wildlife Impact Analysis for Inactive Hazardous Waste Sites* (NYSDEC, 1991). The objectives of a Step I - site description is to identify wildlife resources that may be affected by site-related contaminants and to provide appropriate information for designing remedial investigation of these resources. Step I provides information in the form of maps, site descriptions, and resource value (e.g., recreational, significant habitat) descriptions. Objective of the Step II - contaminant-specific analysis is to determine the impacts of site-related contaminants on fish and wildlife resources. The goal of a Step II analysis is either to demonstrate the impacts on resources due to contaminants are minimal or, if significant impacts exist, to determine the impacts site-related contaminants have on productivity and diversity of fish and wildlife resources.

3.4 Remedial Investigation/Feasibility Study Report

Following completion of the work described above, a RI report will be prepared. Included in this report will be the following:

- Discussion of field investigation activities
- Presentation of analytical results for all media tested
- Evaluation of data summarizing and analyzing relevant site data to define the nature and extent of contamination
- Habitat-based assessment

Based on the results of the RI, a feasibility study report will be prepared. Its purpose is to develop and select an appropriate range of remedial alternatives, and make a recommendation of a preferred remedial alternative, to meet the remedial objectives for the site.

3.5 Project Schedule

The anticipated project schedule with major project milestones and their tentative completion dates is presented on Figure 3-1. The project's duration will be approximately 18 months.

**MAGNA METALS SITE
PROJECT SCHEDULE**

Figure 3-1

Task	Anticipated Date
RI/FS Field Sampling and Analysis Plan approved	October 1995
Public Notification Fact Sheet associated with Field Sampling and Analysis Plan	January 1996
Field Work	April-July 1996
Draft RI Report	November 1996
Final RI Report (incorporating NYSDEC comments)	January 1997
Draft FS Report	March 1997
Final FS Report (incorporating NYSDEC comments)	May 1997
Public notification RI/FS Fact Sheet	June 1997
Draft Proposed Remedial Action Plan (PRAP)	July 1997
Public Meeting	August 1997
Finalize FS and PRAP (incorporating public comments)	October 1997

4.0 CONTACT LIST

The following contact lists have been developed to ensure that public officials, organizations, and private citizens are informed of activities at the site. The lists may be supplemented as needed.

4.1 Surrounding Properties

The properties which lie along the perimeter of the former Magna Metals facility have been included in the public contact list shown in Appendix A. Both owners and occupants will be informed of activities occurring at the site.

4.2 Local Officials

City, county, and state officials have been included on the public contact list (Appendix A) and will be informed of the work conducted at the site.

4.3 Local Media

A list of local newspapers was included in the public contact list shown in Appendix A.

5.0 IDENTIFICATION OF PROJECT CONTACTS

For Technical Information:

Daniel Bendell
Project Manager
NYSDEC Region 3
21 South Putt Corners Road
New Paltz, NY 12561
(914) 255-5453

Mark Sielski
Project Manager
Foster Wheeler Environmental Corporation
1290 Wall Street West
Lyndhurst, NJ 07071
(201) 842-7244

For General Information:

Erin O'Dell-Keller
Citizen Participation Specialist
NYSDEC Region 3
21 South Putt Corners Road
New Paltz, NY 12561
(914) 256-3154

Bruce Bentley
Citizen Participation Specialist
NYSDEC
50 Wolf Road
Albany, NY 12561
(518) 485-8792

Toll-free hazardous waste remediation site information: (800) 342-9296

For Health Related Information:

Joseph Crua
Environmental Health Specialist
NYS Department of Health
2 University Place
Albany, NY 12203
(518) 458-6305

Nina Knapp
Health Liaison Program
NYS Department of Health
2 University Place
Albany, NY 12203
(518) 458-6402

NYSDOH toll-free number: (800) 458-1158, ext. 402

6.0 DOCUMENT REPOSITORY

6.1 Location of Repository

Documents relevant to the RI/FS at the Magna Metals site will be stored in the reference room at the public library in Montrose. The address of the library is:

Hendrick Hudson Library
1 Kings Ferry Road
Montrose, NY 10548
(914) 739-5654

The hours at the library are as follows:

Monday, Tuesday, Thursday, Friday	9:30 am - 5:00 pm
Wednesday	12:00 pm - 8:00 pm
Saturday	10:00 am - 5:00 pm
Sunday	2:00 pm - 5:00 pm (Sept.-June only)

The documents will be stored at the reference desk and may be obtained by requesting the files for the Magna Metals site.

Document repositories also include the following two NYSDEC offices:

NYSDEC Region 3
21 South Putt Corners Road
New Paltz, NY 12561
(914) 255-5453

NYSDEC Central Office
50 Wolf Road
Albany, NY
(518) 485-8792

6.2 List of Documents

The following documents will be stored at the repository as they become available, and once they have been approved by the NYSDEC:

- Consent order
- Field Sampling and Analysis Plan
- Remedial Investigation Report
- Feasibility Study
- Quality Assurance Plan
- All responsiveness summaries
- Site-specific citizen participation plan
- All fact sheets, newsletters, etc.

Other site documents may be added as appropriate.

7.0 DESCRIPTION OF CITIZEN PARTICIPATION ACTIVITIES FOR EACH ELEMENT OF THE REMEDIAL PROGRAM

This section describes the specific citizen participation activities that will be carried out during the Magna Metals site remedial program. They are based on New York State regulation Part 375-1.5 (May 1992) which sets forth requirements for citizen participation during hazardous waste site programs, and the NYSDEC policy document New York State Inactive Hazardous Waste Site Citizen Participation Plan (August 1988).

These citizen participation activities may be modified and additional activities may be conducted as NYSDEC gains additional insight into local interest in citizen participation and the remedial program or as the technical program and information about the site changes.

At the completion of the RI/FS process, NYSDEC will prepare a ROD for the site, detailing the remedial action chosen and the decision process used. At that time, the Citizen Participation Plan will be reviewed and updated to address the specific citizen participation activities to be conducted during design and construction of the remedial program. NYSDEC policy requirements and options for these activities are detailed in its statewide citizen participation plan referenced above.

7.1 RI/FS Work Plan Fact Sheet

Following approval of the Work Plan by NYSDEC, a fact sheet will be prepared which will announce the availability of the Work Plan. The fact sheet will include project contacts, briefly describes the site history, the work already performed, the current conditions at the site, the field activities to be conducted as part of the RI, and the preparation of the RI report. The fact sheet will also include a listing of document repositories and project contacts. The fact sheet will be approved by NYSDEC and the New York State Department of Health (NYSDOH) and distributed by NYSDEC. A copy will be placed in the document repository for public access and a copy will be mailed to everyone on the public contact list.

7.2 RI/FS Report Fact Sheet

The second fact sheet will be issued during the preparation of the RI/FS report and will be mailed to everyone on the public contact list. The purpose of the fact sheet will be to describe the status of the project and the results of the RI/FS. The fact sheet will contain a list of the tasks that have been completed. Field problems, such as drilling conditions, severe weather, or equipment breakdowns will also be noted. A summary of soil and groundwater data collected during the RI and an analysis of this data will be presented. In addition, the remedial alternatives evaluated will be discussed. The RI/FS Report fact sheet will be prepared by NYSDEC and distributed to the entire public contact list. The fact sheet will also serve as the public meeting notice and will announce the date, time, and place of the public meeting.

7.3 Public Meeting

Upon completion of the Feasibility Study (FS), a proposed Remedial Action Plan (PRAP) will be prepared by NYSDEC. Following NYSDEC approval, the PRAP will be available for public review. A public meeting will then be held. The purpose of the meeting will be to discuss the findings of the FS and the PRAP. Following issuance of the PRAP by the NYSDEC, there will be a 30-day comment period on the PRAP, during which NYSDEC will accept written and oral comments on the plan. A responsiveness summary, which provides responses to the comments and questions raised during the public comment period, will be prepared by NYSDEC as part of the ROD.

The public meeting announcements will be sent three weeks prior to the meeting to the daily and weekly newspapers generally circulated in the Cortlandt area. The meeting will be conducted by NYSDEC, and representatives from NYSDOH and Foster Wheeler Environmental will attend.

8.0 GLOSSARY OF KEY TERMS AND MAJOR PROGRAM ELEMENTS

8.1 Glossary of Key Terms

Citizen Participation - A process to inform and involve the interested/affected public in the decision-making process during identification, assessment and remediation of inactive hazardous waste sites. This process helps to assure that the best decisions are made from environmental, human health, economic, social and political perspectives.

Citizen Participation Plan - A document that describes the site-specific citizen participation activities that will take place to complement the technical (remedial) activities. It also provides site background and rationale for the selected citizen participation program for the site. A plan may be updated or altered as public interest or the technical aspects of the program change.

Citizen Participation Specialist - A NYSDEC staff member within the Office of Public Affairs who provides guidance, evaluation and assistance to help the project manager carry out his/her site-specific citizen participation program.

Contact List - Names, addresses and/or telephone numbers of individuals, groups, organizations, and media interested and/or affected by a particular hazardous waste site. Compiled and updated by NYSDEC. Interest in the site, stage of remediation, and other factors guide how comprehensive the list becomes. Used to assist NYSDEC to inform and involve the interested/affected public.

Document Repository - Typically, a regional NYSDEC office and/or public building, such as a library, near a particular site, at which documents related to remedial and citizen participation activities at the site are available for public review. Provides access to documents at times and a location convenient to the public.

Information Sheet - A written discussion of a site's remedial process, or some part of it, prepared by NYSDEC for the public in easily understandable language. The information sheet may be prepared for the "general" public or a particular segment. Uses may include, for example: discussion of an element of the remedial program, opportunities for public involvement, availability of a report or other information, or announcement of a public meeting. The information sheet may be mailed to all or part of the interested public, distributed at meetings and availability sessions or sent on an "as requested" basis.

Order on Consent (Consent Order) - A legal and enforceable negotiated agreement between NYSDEC and responsible parties where responsible parties agree to undertake investigation and cleanup or pay for the costs of investigation and cleanup work at a site. The order includes a description of the remedial actions to be undertaken at the site and a schedule for implementation.

Classification 2a - A temporary classification for a site known or suspected to contain hazardous waste. Most likely the site will require a Phase I and Phase II investigation to obtain more information. Based on the results, the site then would be reclassified or removed from the state registry if found not to contain hazardous wastes.

Classification 3 - A site which has hazardous waste confirmed, but not a significant threat to the public health or environment - action may be deferred.

Classification 4 - A site which has been properly closed - requires continued management.

Classification 5 - A site which has been properly closed, with no evidence of present or potential adverse impact - no further action required.

Toll-Free "800" Telephone Information Number - Provides cost-free access to NYSDEC by members of the public who have questions, concerns or information about a particular hazardous waste site. Calls are taken and recorded 24 hours a day, and a NYSDEC staff member contacts the caller as soon as possible (usually the same day).

8.2 Definitions of Significant Remedial Program Elements and Terms

Site Placed on Registry of Inactive Hazardous Waste Sites - Each inactive site known or suspected or containing hazardous waste must be included in the registry. Therefore, all sites which state or county environmental or public health agencies identify as known or suspected to have received hazardous waste should be listed in the registry as they are identified. Whenever possible, NYSDEC carries out an initial evaluation at the site before listing.

Remedial Investigation (RI) - A process to determine the nature and extent of contamination by collecting data and analyzing the site. It includes sampling and monitoring, as necessary, and includes the gathering of sufficient information to determine the necessity for, and proposed extent of, a remedial program for the site.

Feasibility Study (FS) - A process for developing, evaluating and selecting remedial actions and using data gathered during the remedial investigation to: define the objectives of the remedial program for the site and broadly develop remedial action alternatives; perform an initial screening of these alternatives; and perform a detailed analysis of a limited number of alternatives which remain after the initial screening stage.

Remedial Design - Once a remedial action has been selected, technical drawings and specifications for remedial construction at a site are developed, as specified in the final RI/FS report. Design documents are used to bid and construct the chosen remedial actions. The remedial design is prepared by consulting engineers with experience in inactive hazardous waste disposal site remedial actions.

Construction - Contractors are selected for construction work to carry out the designed remedial alternative. Construction may be as straightforward as excavation of contaminated soil with disposal at a permitted hazardous waste facility. On the other hand, it may involve groundwater management or other technologies. Construction costs may vary from several thousand dollars to many millions of dollars, depending on the size of the site, the soil, groundwater and other conditions, and the nature of the wastes.

Monitoring/Maintenance - Denotes post-closure activities to insure continued effectiveness of the remedial actions. Typical monitoring/maintenance activities include quarterly inspection by an

engineering technician; measurement of water levels in monitoring wells; or collection of groundwater samples and analysis for factors showing the condition of water, presence of toxic substances, or other indicators of possible pollution from the site.

Delisting - Removal of a site from the state registry based on studies.

**APPENDIX A
MEGNA METAL SITE
PUBLIC CONTACT LIST**

NEIGHBORING PROPERTY OWNERS

(Source: Tax Assessor's Office)

- | | | | |
|----|--|-----|--|
| 1. | Pet Products Inc.
161 Riverdale Way
Yonkers, NY | 10. | William and Angela Grazianni
4 Rosalind Drive
Cortland Manor, NY 10566 |
| 2. | Tilak and Geeta Agerwala
16 Cross Road
Cortland Manor, NY 10566 | 11. | Arlene Apostolou
6 Rosalind Drive
Peekskill, NY 10566 |
| 3. | Joseph and Marilyn Brass
14 Cross Road
Peekskill, NY 10566 | 12. | Anthony and Kathleen Pisarri
3 Rosalind Drive
Peekskill, NY 10566 |
| 4. | Kevin and Susan McDermott
12 Cross Road
Peekskill, NY 10566 | 13. | Thomas and Nancy Olesczuk
1 Rosalind Drive
Peekskill, NY 10566 |
| 5. | John and Maria Rice
10 Cross Road
Cortland Manor, NY 10566 | 14. | Ronald and Catherine Westervelt
1 Cross Road
Peekskill, NY 10566 |
| 6. | Bruce and Lillian Toll
11 Cross Road
Peekskill, NY 10566 | 15. | Charles and Joan Cartalemi
3 Cross Road
Peekskill, NY 10566 |
| 7. | Peter Charles and Andrea Gerord
Schecheter
9 Cross Road
Peekskill, NY 10566 | 16. | Daniel and Sitawant Solomon
5 Cross Road
Peekskill, NY 10566 |
| 8. | Shanker and Uma Krishnamurthy
8 Cross Road
Peekskill, NY 10566 | 17. | Serge and Raphaelle Sondak
7 Cross Road
Peekskill, NY 10566 |
| 9. | Francis and Hannrah Jessie
2 Rosalind Drive
Cortland Manor, NY 10566 | 18. | Nicalo F. Longano
507 Furnace Dock Road
Peekskill, NY 10566 |

**APPENDIX A
MEGNA METAL SITE
PUBLIC CONTACT LIST (Cont'd)**

- | | | |
|-----|--|--|
| 19. | Harold and Melanie Forman
509 Furnace Dock Road
Peekskill, NY 10566 | c/o Jeanne Pacchiana
205 Stone Hill Road
Pound Ridge, NY |
| 20. | Douglas and Diane Angst
515 Furnace Dock Road
Peekskill, NY 10566 | 26. Chris and Carmella Spano
235 Croton Avenue
Peekskill, NY 10566 |
| 21. | Robert and Nona Murphy
517 Furnace Dock Road
Peekskill, NY 10566 | 27. Gregory Plane and Diana Vicari
529 Furnace Dock Road
Peekskill, NY 10566 |
| 22. | Cecelia Endico
519 Furnace Dock Road
Peekskill, NY 10566 | 28. Frank and Antonette Macri
235 Furnace Dock Road
Peekskill, NY 10566 |
| 23. | Ronald J. Endico
521 Furnace Dock Road
Peekskill, NY 10566 | 29. Croton Realty & Development Inc.
150 - 250 Croton Avenue
Peekskill, NY 10566 |
| 24. | Christopher and Carmella Spano
235 Croton Avenue
Peekskill, NY 10566 | 30. Lake Mohegon Fire District
Furnace Woods Station
260 Croton Avenue
Cortland Manor, NY 10566 |
| 25. | Country Life Holdings Inc. | |

Business Currently Operating On-Site:

Address: 510-534 Furnace Dock Road
Cortland Manor, NY 10566

Consolidated Edison
Haggerty Millwork Corporation
Polymedco, Inc.
Silverman Furniture
Himbus II Corp.
Advanced Precision Technology, Inc.

**APPENDIX A
MAGNA METALS SITE
PUBLIC CONTACT LIST (Cont'd)**

Local, County, State Officials

County and State Officials

United States Senator: The Honorable Alphonse D'Amato
1259 Federal Bldg.
Syracuse, NY 13260
(315) 423-5471

Washington, DC
(202) 224-6542

70 Penn Plaza, Suite 600
New York, NY 10001
(212) 736-7627

The Honorable Daniel P. Moynihan
Guarantee Bldg., Suite 203
28 Church Street
Buffalo, NY 14202
(716) 551-4097

405 Lexington Ave., 62nd Fl
New York, NY 10174
(212) 661-5150

Washington, DC
(202) 224-4451

United States Congressional
Representative:

Sue W. Kelly
1037 Longworth
Washington, DC 20515
(202) 225-5441

**APPENDIX A
MAGNA METALS SITE
PUBLIC CONTACT LIST (Cont'd)**

NY State Senators:	Board of Elections (914) 285-5700
	Vincent Leibell III Legislative Office Bldg. District Room 812 1008 Main Street Albany, NY 12247 Peekskill, NY 10566 (518) 455-3111 (914) 736-7101
NY State Assemblyman:	Sandra R. Galef 2 Church Street Ossining, NY 10562 (914) 941-1111
Westchester County Executive:	The Honorable Andrew P. O'Rourke Michaelian Office Building 1 White Plains, NY (914) 285-2900
Westchester County Clerk:	Leonard Spano 110 Grove Street White Plains, NY (914) 285-3080
Westchester County Legislator Representing Buchanan:	Timothy Carey 236 Tate Avenue Buchanan, NY (914) 737-8470
Westchester County Legislature Chairman:	Stephen T. Tenore Board of Legislatures 148 Martine Avenue White Plains, NY 10601 (914) 285-2826

APPENDIX A
MAGNA METALS SITE
PUBLIC CONTACT LIST (Cont'd)

Westchester County Legislature
Clerk:

Patricia S. Gorski
Board of Legislatures
148 Martine Avenue
White Plains, NY 10601
(914) 285-2805

Town of Cortlandt Officials

Supervisor:

Linda Puglisi
Supervisor's Office
Van Wyck Avenue
Croton-on-Hudson, NY
(914) 737-1002

Town Clerk:

Harriot L. Boyle
1 Heady Street
Cortland Manor, NY
(914) 734-1020

Town Council:

Joseph Cerretto
George Oros
Ann Lindau
Rosemary Boyl

1 Heady Street
Cortland Manor, NY
(914) 737-1002

Town Comptroller:

Glenn Cestaro
1 Heady Street
Cortland Manor, NY
(914) 734-1070

Village of Buchanan Officials

Mayor:

Alfred J. Donohue
236 Tate Avenue
Buchanan, NY
(914) 737-1033

**APPENDIX A
MAGNA METALS SITE
PUBLIC CONTACT LIST (Cont'd)**

Clerk: 236 Tate Avenue
Buchanan, NY
(914) 737-1033

Trustees: Gary Bath
Theresa Knickerbocker
Michael Snyder
Joseph Tropiano
236 Tate Avenue
Buchanan, NY
(914) 737-1033

City of Peekskill Officials

Mayor: 840 Main Street
Peekskill, NY
(914) 737-3400

Clerk: 840 Main Street
Peekskill, NY
(914) 737-3400

NYSDEC Regional Director: Jean McGrane
21 South Putt Corners Road
New Paltz, NY 12561
(914) 256-3003

Local Media

1. The Evening Start
825 Commerce Street
Yorktown, NY 10598
2. The Cortlandt Observer
P.O. Box 8
Yorktown, NY 10598
3. Peekskill Harold
P.O. Box 2550
Peekskill, NY 10566

APPENDIX A
MAGNA METALS SITE
PUBLIC CONTACT LIST (Cont'd)

4. Croton Cortlandt Gazette
P.O. Box 247
Croton, NY 10520
5. News Director
WFAS 1230 AM/WFAS 103.9 FM
P.O. Box 551
White Plains, NY 10602
6. News Director
WVIP 1310 AM/WVIP 106.3 FM
Radio Circle
Mt. Kisco, NY 10549
7. City Editor
North County News
1520 Front Street
Yorktown Heights, NY 10598
8. City Editor
Westchester County Press
P.O. Box 1631
White Plains, NY 10602
9. Glenn I. Sapir
Ashmark Communications Inc.
P.O. Box 74
Shrub Oak, NY 10588
10. News Director
WMJV 105.5 FM/WPUT 1510 AM
P.O. Box 105.5
Patterson, NY 12563
11. News Director
WOSS 91.1 FM
29 South Highland Avenue
Ossining, NY 10562

**APPENDIX A
MAGNA METALS SITE
PUBLIC CONTACT LIST (Cont'd)**

12. Mike Bennett
WHUD 100.7 FM/WLNA 1420 AM
Radio Terrace
Peekskill, NY 10566

13. City Editor
Portchester Guide
P.O. Box 1309
Port Chester, NY 10573

14. City Editor
Scarsdale Inquirer
P.O. Box 418
Scarsdale, NY 10583

15. City Editor
Westmore News
38 Broad Street
Port Chester, NY 10573

16. News Director
WEOK 1390 AM/WPDH 101.5 FM
P.O. Box 416
Poughkeepsie, NY 12602

17. City Editor
Upriver/Downriver
25 Broadway
Kingston, NY 12401

18. News Director
WARY 88.1 FM
P.O. Box 258
Valhalla, NY 10595

19. News Director
WRTN 93.5 FM/WVOX 1460 AM
1 Broadcast Forum
New Rochelle, NY 10801

**APPENDIX A
MAGNA METALS SITE
PUBLIC CONTACT LIST (Cont'd)**

20. City Editor
The Ledger
P.O. Box 188
Cross River, NY 10518
21. City Editor
Suburban Street News
199 Main Street
White Plains, NY 10601
22. Marlene Aig
Associated Press
148 Martine Avenue, CB Press
White Plains, NY 10601
23. News Director
WSPK 104.7 FM
475 South Avenue
Beacon, NY 12508
24. News Director
WTBY-TV
P.O. Box 534
Fishkill, NY 12524
25. News Director
WXPS 107.1 FM
444 Bedford Road
Pleasantville, NY 10670
26. City Editor
Gannett Suburban Newspaper
1 Gannett Drive
White Plains, NY 10604
27. News Director
Cablevision of Westchester
2013 Crompond Road
Yorktown Heights, NY 10598

**APPENDIX A
MAGNA METALS SITE
PUBLIC CONTACT LIST (Cont'd)**

28. News Director
UA Columbia Cablevision
609 Center Avenue
Mamaroneck, NY 10543
29. City Editor
The Peekskill Herald
P.O. Box 2250
Peekskill, NY 10566
30. City Editor
Putnam County News & Recorder
86 Main Street
Cold Spring, NY 10516
31. Canuso
WVOS Radio
P.O. Box 178
Greeley, PA 18425
32. City Editor
Tucker Communications
P.O. Box 1000
Cross River, NY 10518
33. News Director
Cablevision of Westchester
1150 Yonkers Avenue
Yonkers, NY 10704
34. News Director
Paragon Cable
P.O. Box 10094
Newburgh, NY 12552
35. City Editor
Pennysaver
1761 Front Street
Yorktown Heights, NY 10598

**APPENDIX A
MAGNA METALS SITE
PUBLIC CONTACT LIST (Cont'd)**

36. News Director
WNYK 88.7 FM
Nyack College
Nyack, NY 10960
37. City Editor
Harrison Independent
38 Larkin Place
Yonkers, NY 10701
38. News Director
Cablevision of Westchester
116 N. Main Street
Port Chester, NY 10573
39. News Director
Continental Cablevision
1053 Park Street
Peekskill, NY 10566
40. City Editor
The Enterprise
P.O. Box 278
Hasting-on-Hudson, NY 10706
41. City Editor
Bronx Press Review
1924 Cross Bronx Expressway
Bronx, NY 10472
42. City Editor
New Pennysaver Group Inc.
200 Airport Executive Park
Spring Valley, NY 10977

**APPENDIX A
MAGNA METALS SITE
PUBLIC CONTACT LIST (Cont'd)**

Environmental Groups, Business Organizations, and Other Interested Parties

Hudson River Foundation for Science and Environmental Research, Inc.
122 East 42nd Street
Suite 1901
New York, NY 10168

Hudson Riverkeeper
P.O. Box 130
Garrison, NY 10524

Hudson River Sloop Clearwater, Inc.
112 Market Street
Poughkeepsie, NY 12601

Scenic Hudson, Inc.
9 Vassar Street
Poughkeepsie, NY 12601

Richard Morse, State Superfund Management Board
Legislative Programs & Counsel Staff, NYS Assembly
Room 520, State Capitol
Albany, NY 12224

Judith Enck, State Superfund Management Board
NYPIRG
184 Washington Avenue
Albany, NY 12210

Laura Tessier
Westchester County EMC
414 Michaelian Office Bldg.
White Plains, NY 10601

Elizabeth Sluder
Westchester County EMC
414 Michaelian Office Bldg.
White Plains, NY 10601

**APPENDIX A
MAGNA METALS SITE
PUBLIC CONTACT LIST (Cont'd)**

Cortlandt CAC
John Felt
Planning Dept.
Municipal Bldg.
Croton-on-Hudson, NY 10529

Lois Lee
Cortlandt CAC
204 Furnace Dock Road
Peekskill, NY 10566

Westchester League of Women Voters
Rochambeau School
228 Fisher Avenue
White Plains, NY 10606
Attn: Hillary Kitasi

Chase Manhattan Bank
1 New York Plaza
13th Floor
New York, NY 10081

Baker Capital
485 Washington Avenue
Pleasantville, NY 10570

Unicorn Industries
7 Corporate Drive
Peekskill, NY 10566

END

FOSTER  WHEELER

FOSTER WHEELER ENVIRONMENTAL CORPORATION