

336007

3/92

New York State Department of Environmental Conservation  
Division of Hazardous Waste Remediation  
Bureau of Hazardous Site Control  
Additions/Change to Registry Summary of Approvals

Site Name Orange County Sanitary L.F. DEC I.D. Number 336007

Current Classification ZU

Activity  Add as Class  Reclassify to 2  Delist Category  Modify

Approvals.

Regional Hazardous Waste Engineer Yes  No

NYSDOH Yes  No

DEE Yes  No

BHSC: a. Investigation Section Yes  No

b. Site Control Section Rick / Marini Date 7/19/91

c. Director [Signature] Date 9/6/91

DHWR Assistant Director Charles Haddad Date 3/11/92

*File mailed  
3/14/92*

• 1991~92 •



# ADDITIONS/CHANGES TO REGISTRY OF INACTIVE HAZARDOUS WASTE DISPOSAL SITES

1. SITE NAME Orange County Sanitary Landfill		2. SITE NO. 336007	3. TOWN Goshen	4. COUNTY Orange
5. REGION 3	6. CLASSIFICATION Current <u>2a</u> / Proposed <u>2</u>	7. ACTIVITY <input type="checkbox"/> Add <input checked="" type="checkbox"/> Reclassify <input type="checkbox"/> Delist <input type="checkbox"/> Modify		

8a. DESCRIBE LOCATION OF SITE (Attach U.S.G.S. Topographic Map showing site location).  
Site is located on Route 17M, Town of Goshen, Orange County.  
(See Attachment 1.1)

b. Quadrangle Middletown c. Site Latitude 41°23'N Longitude 74°24'W d. Tax Map Number 16-1-1.1-3

9a. BRIEFLY DESCRIBE THE SITE (Attach site plan showing disposal/sampling locations)  
The site is an active municipal landfill that accepts mixed municipal waste, sewage sludge, waste oil, septic tank pumpings and industrial sludges. Various amounts of industrial hazardous waste have been disposed at the site.  
(See Attachment 1.2)

b. Area 75 acres c. EPA ID Number NYD000861195 d. PA/SI  Yes  No

e. Completed  Phase I  Phase II  PSA  Sampling

10. BRIEFLY LIST THE TYPE AND QUANTITY OF THE HAZARDOUS WASTE AND THE DATES THAT IT WAS DISPOSED OF AT THIS SITE  
Still bottom residues (flash point below 100°F): 18 drums. Acids (nitric, hydrofluoric and glacial acetic): several gallons. Tetrachloroethylene (PCE): 1 ton. Solvents (methanol, ethanol, toluene, benzene): 4 tons. Filters containing PCE: 20 pounds.

11a. SUMMARIZED SAMPLING DATA ATTACHED  
 Air  Groundwater  Surface Water  Soil  Waste  EP Tox  TCLP.

b. List contravened parameters and values  
See Attachment 1.2

12. SITE IMPACT DATA

a. Nearest surface water Distance 100-200 ft. Direction Flow to the NE Classification D

b. Nearest groundwater Depth 12-70 ft. Flow Direction variable  Sole Source  Primary  Principal

c. Nearest water supply Distance 1000-1500 ft. Direction variable Active  Yes  No

d. Nearest building Distance 500 ft. Direction SW Use \_\_\_\_\_

e. Crops or livestock on site?  Yes  No

f. Exposed hazardous waste?  Yes  No

g. Controlled site access?  Yes  No

h. Documented fish or wildlife mortality?  Yes  No

i. Impact on special status fish or wildlife resource?  Yes  No  No

j. Within a State Economic Development Zone?  Yes  No

k. For Class 2a: Code \_\_\_\_\_ Health Model Score \_\_\_\_\_

l. For Class 2: Priority Category II

m. HRS Score \_\_\_\_\_

n. Significant Threat  Yes  No  Unknown

13. SITE OWNER'S NAME  
Orange Co. DPW

14. ADDRESS  
Rt. 17M, PO Box 509  
Goshen, NY 10924-0509

15. TELEPHONE NUMBER  
(914) 294-7951

16. PREPARER  
Mauricio Roma, Engineer Geologist, DHWR - Region 3  
Name, Title and Organization

March 28, 1991  
Date

*[Signature]*  
Signature

17. APPROVED  
*Richard W. Dana*, Chief, Bureau of Technical Services, DEE  
Name, Title and Organization

4/30/91  
Date

*Richard W. Dana*  
Signature

NEW YORK STATE DEPARTMENTS OF ENVIRONMENTAL CONSERVATION AND HEALTH  
INACTIVE HAZARDOUS WASTE DISPOSAL SITE PRIORITY RANKING WORKSHEET

SITE # 336007 SITE NAME Orange Co. Sanitary Landfill

- ° Priority I - Top priority sites; supersede all others. Priority I can be assigned if any of the following criteria is met:
- a) A sole source or primary aquifer, or a public or private water supply is being contaminated or threatened, or
  - b) Human exposure to contaminants has been identified which represents a Significant health risk as determined by DOH, or
  - c) There is a bioaccumulation of site contaminants in flora or fauna which results in a health advisory, or
  - d) Site contaminants are at levels that are acutely toxic to fish or wildlife or have caused documented fish or wildlife mortality, or
  - e) An expedient response could measurably reduce the threat to health or the environment, reduce the scope of a corrective action, or reduce potential remedial costs.
- ° Priority II - Important sites. Priority II can be assigned if any of the following criteria is met:
- a) A Class AA or a Class A surface water body or a principal aquifer is being contaminated or threatened; however, no existing water supply has been contaminated, or
  - b) There is a bioaccumulation of site contaminants in flora or fauna which results in advisory or actionable levels but below levels necessitating a health advisory, or
  - c) Site contaminants are at levels chronically toxic to fish/wildlife, or
  - d) Endangered, threatened or rare species, significant habitats, designated coastal zone areas or regulated wetlands are being impacted by releases from the site, or
  - e) The site is identified by the International Joint Commission (IJC) as a component in a Remedial Action Plan (RAP), or
  - f) The site is within a State Economic Development Zone or is targeted for local government supported development and the developer has expressed a willingness to enter into a consent order with DEC to finance investigation and remediation.
- ° Priority III - General Site Category. Priority III will be assigned unless one or more of the site prioritization criteria, specified above, apply to a site. When resources become available, after remedial needs for Priority I and II sites have been accommodated, remediation of sites under this category can be considered.

COMMENT \_\_\_\_\_  
\_\_\_\_\_  
\_\_\_\_\_

Filled out by (Name): Mauricio Roma Date: March 26, 1991



ANALYTICAL DATA AVAILABLE:

Air- Surface Water-X Groundwater-X Soil- Sediment-

CONTRAVENTION OF STANDARDS:

Groundwater-X Drinking Water- Surface Water- Air-

LEGAL ACTION:

TYPE..: Consent Order State- X Federal-  
STATUS: Negotiation in Progress- Order Signed- X

REMEDIAL ACTION:

Proposed- Under design- In Progress-X Completed-  
NATURE OF ACTION: Cap

GEOTECHNICAL INFORMATION:

SOIL TYPE: Normanskill Fm. sand, gravel, clay  
GROUNDWATER DEPTH: 12 to 70 feet

ASSESSMENT OF ENVIRONMENTAL PROBLEMS:

The site is surrounded by the Wallkill River. DEC inspection reports indicate that leachate had entered the river. Groundwater standards had been contravened.

ASSESSMENT OF HEALTH PROBLEMS:

Area drinking water is obtained from individual groundwater wells. There is a potential for site-related groundwater contamination to reach some wells resulting in exposures. Under Part 360 permit requirements, Orange County has identified 96 wells and sampled 75 (21 well owners refused). Lead was detected at elevated concentrations in 13 of the wells sampled. The lead detected in these wells may be due to the leaching of this metal from the solder used in well and household plumbing. Orange County has also performed a door-to-door health survey of area residents as required by its permit. Results are pending for both studies. Public access to the site is restricted. Odor complaints have been received. The cap planned for the landfill will include a gas collection system which will be connected to the existing collection/treatment system. The landfill cap will reduce the potential for odors and the migration of gas from the landfill.

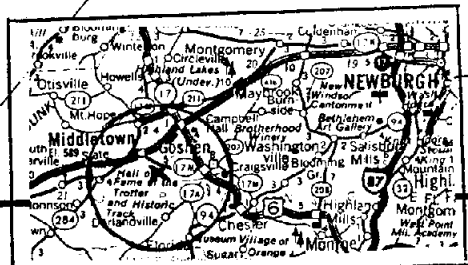
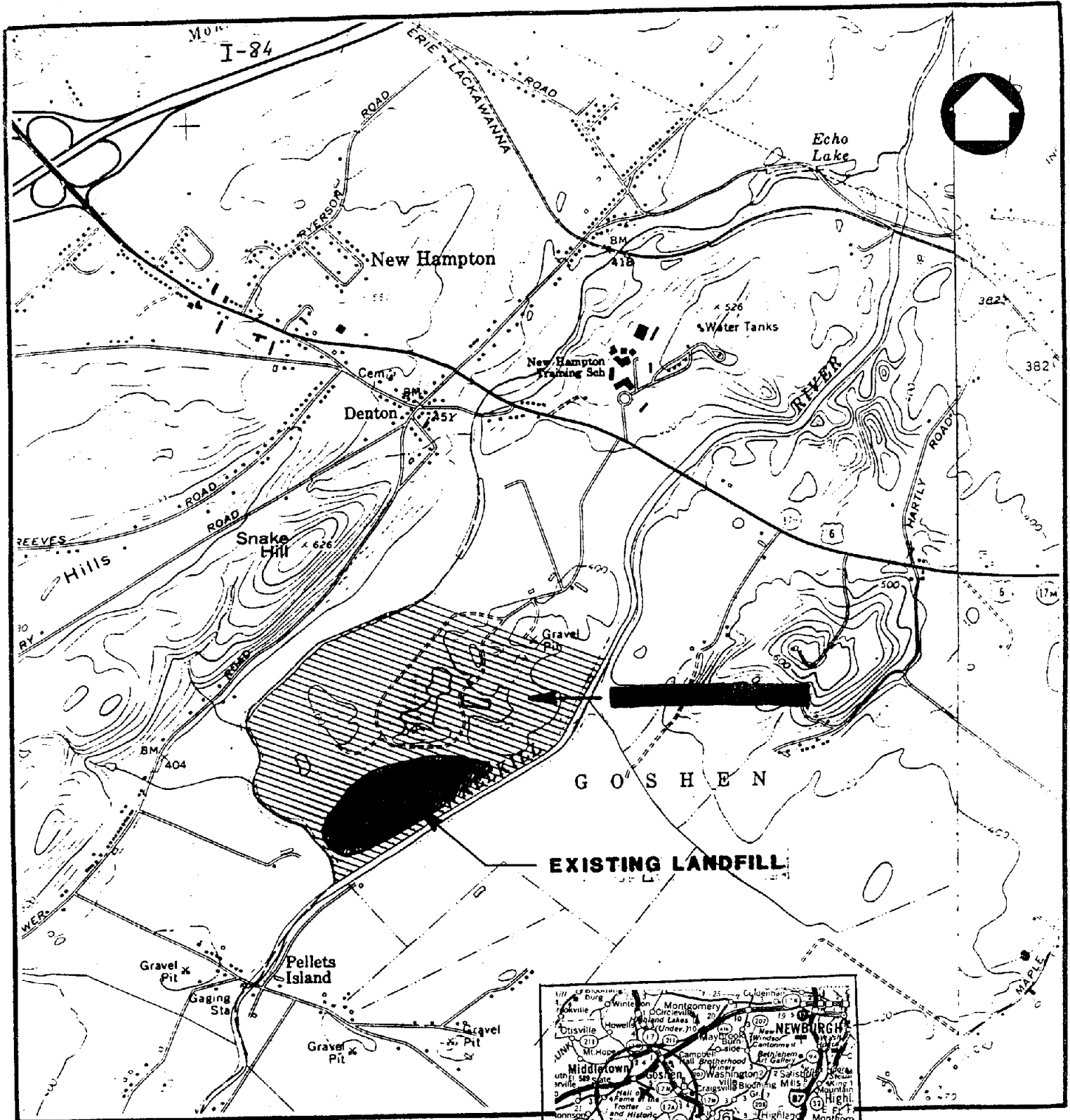

SCALE : 1" = 2000'  
 TOPOGRAPHY TAKEN FROM  
 1957 GOSHEN, N. Y.  
 1969 MIDDLETOWN, N. Y.  
 QUADRANGLES  
 7.5 MIN. SERIES



FIGURE 1-1  
 ORANGE COUNTY LANDFILL  
 LOCATION MAP  
 ATTACHMENT 1.1

# ENGINEERING INVESTIGATIONS AT INACTIVE HAZARDOUS WASTE SITES

## PHASE 1 INVESTIGATION

Orange County Landfill  
Site No 336007  
Goshen, Orange County  
Final - June, 1988



Prepared for :  
New York State  
Department of  
Environmental Conservation

50 Wolf Road, Albany, New York 12233  
Thomas C. Jorling, Commissioner

Division of Hazardous Waste Remediation  
Michael J. O'Toole, P. E., Director

Prepared by:  
Gibbs & Hill, Inc.



1. EXECUTIVE SUMMARY

The Orange County Sanitary Landfill (New York I.D. No. 336007, EPA I.D. No. NYD000861195) is a 300 acre site. At present, 75 acres have been landfilled (Figure 1). The landfill is owned and operated by the Orange County Department of Public Works, and has been since operation began September 30, 1974. The site accepts mixed municipal waste, sewage sludge, waste oil, septic tank pumpings and industrial sludges. An estimated 4,000,000 cubic yards of waste has been dumped at the landfill during the last 14 years.

NYSDEC monthly inspections from 1979 to the present consistently found uncontrolled leachate visible on the site, leachate entering surface water, soil erosion and other drainage problems, and refuse protruding through daily or final cover. Leachate at the site is currently being collected in a siltation pond and recirculated onto the landfill. However, an Order on Consent was imposed by the NYSDEC, which requires interim leachate management, states that "recirculation of leachate onto the landfill will not be approved."

An EPA Potential Hazardous Waste Site Identification and Preliminary Assessment performed in March 1980 indicated that 165 gallons per year of drummed waste lube and hydraulic oils have been dumped at the landfill. The one documented case of hazardous waste dumping at the site was several gallons of acid etching materials at the landfill. The constituents of this material were nitric, hydrofluoric, and glacial acetic acid.

The Right-To-Know (RTK) Program shows that one ton of tetrachloroethylene and four tons of waste solvents and still bottom residues have been brought to the Orange County Landfill

A potable water well is located next to the weighing station and three other sample wells and one pond are within the site boundaries (Figure 2). Groundwater tests performed two weeks

**HYDROGEOLOGIC INVESTIGATION  
REPORT RELATING TO THE EXISTING  
ORANGE COUNTY SANITARY LANDFILL**

Prepared for the

**ORANGE COUNTY DEPARTMENT  
OF PUBLIC WORKS  
ORANGE COUNTY, NEW YORK**

JULY 1988



**WEHRAN ENGINEERING  
CONSULTING ENGINEERS**

## EXECUTIVE SUMMARY

This report was prepared for the Orange County Department of Public Works and addresses hydrogeologic and water quality issues relative to the existing Orange County Sanitary Landfill. The study conducted was in response to an Order on Consent signed between Orange County and the New York State Department of Environmental Conservation (NYSDEC) on December 31, 1986.

Subsequent to extensive collaboration with the NYSDEC, a work plan for the investigation of the existing landfill was prepared with the following objectives:

- . To further define the geology and hydrogeology of the site around the existing landfill.
- . Define the impacts of the existing landfill on groundwater and surface water quality.
- . To assess the relationship of the landfill within the more regional context with regard to groundwater flow relationships and water quality impacts.

In order to accomplish these goals, a field investigation program was completed which included:

- . A surface and downhole geophysical program directed at identifying any contamination plume.
- . The installation of groundwater monitoring wells followed by a round of water quality sampling and analysis.
- . Surface water sampling and analysis upgradient and downgradient of the existing facility.
- . An assessment of off-site hydrogeologic flow relationships and water quality impacts.



**WehranEnviroTech**

---

**WATER QUALITY ASSESSMENT  
FOR THE ORANGE COUNTY SANITARY  
LANDFILL**

Prepared For  
**ORANGE COUNTY DEPARTMENT  
OF PUBLIC WORKS**  
Goshen, New York

---

October 1990

Wehran-New York, Inc.  
Middletown, New York

*Environmental Engineers • Scientists • Constructors*

*( See other side for  
executive summary )*

NEW YORK STATE DEPARTMENT OF ENVIRONMENTAL CONSERVATION  
DIVISION OF SOLID AND HAZARDOUS WASTE

50 WOLF ROAD  
ALBANY, NEW YORK 12233



TRANSPORTER FORM  
PART - I

HAZARDOUS WASTE DISPOSAL QUESTIONNAIRE

PLEASE COMPLETE AND RETURN TO THE ABOVE ADDRESS, ATTENTION: RTK PROCESSING UNIT, ROOM 525

COMPANY NAME		EPA ID NUMBER:	
COMPANY MAILING ADDRESS	HAUL #: 3A-061	STATE	ZIP CODE
PLANT NAME (if different)	220 FROZEN BRIDGE ROAD	ACT NAME	TELEPHONE
PLANT ADDRESS (if different) STREET	NEWBURGH NY 12550	STATE	ZIP CODE
PRINCIPAL BUSINESS OF PLANT			

PLEASE ANSWER THE FOLLOWING QUESTIONS:

CHECK ONE

Tφ3φφ 7φ1

1. DID YOUR COMPANY, INCLUDING PREVIOUS OWNERS/OPERATORS OF YOUR COMPANY, TRANSPORT INDUSTRIAL WASTE, (SEE INSTRUCTIONS) BETWEEN JANUARY 1, 1952-DECEMBER 31, 1981?

YES  
 NO

IF THE ANSWER IS YES COMPLETE QUESTIONS 1, 2, 3, 4 AND TRANSPORTER FORM PART-II.  
IF THE ANSWER IS NO COMPLETE QUESTIONS 1 AND 4 AND RETURN THIS FORM

2. HAS THE NAME OF YOUR COMPANY CHANGED DUE TO A CHANGE IN OWNERSHIP, CORPORATE NAME OR OPERATOR NAME, ETC. IF YES, LIST ALL NAMES BY WHICH THE COMPANY HAS BEEN IDENTIFIED SINCE JANUARY 1, 1952 TO THE PRESENT.

YES  
 NO

_____	_____
_____	_____
_____	_____
NAME, ADDRESSES, AND TELEPHONE NUMBERS	DATES

3. DESCRIBE THE DOCUMENTS FROM WHICH DATA THAT IS INCLUDED ON PART-II WAS OBTAINED (SEE INSTRUCTIONS).

_____	_____
_____	_____
_____	_____
DOCUMENT DESCRIPTION	DATES

4. I HEREBY CERTIFY THAT TO THE BEST OF MY KNOWLEDGE AND BELIEF THAT INFORMATION SUPPLIED IS TRUE AND COMPLETE. FALSE STATEMENTS SUBMITTED ON THIS DOCUMENT ARE PUNISHABLE PURSUANT TO SECTION 210.45 OF THE PENAL LAW.

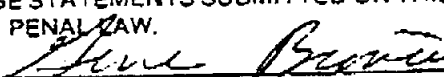
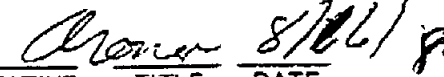
NAME OF OWNER/OPERATOR, PARTNER OFFICER OR AUTHORIZED REPRESENTATIVE      TITLE      DATE

      914 561-4545

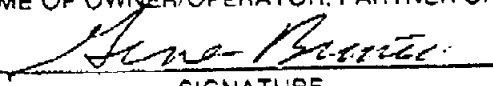
SIGNATURE      BUSINESS PHONE

NEW YORK STATE DEPARTMENT OF ENVIRONMENTAL CONSERVATION  
 DIVISION OF SOLID AND HAZARDOUS WASTE

50 WOLF ROAD  
 ALBANY, NEW YORK 12233

HAZARDOUS WASTE DISPOSAL QUESTIONNAIRE



GENERATOR FORM  
 PART - I

PLEASE COMPLETE AND RETURN TO THE ABOVE ADDRESS. ATTENTION: RTK PROCESSING UNIT, ROOM 525

COMPANY NAME		ICS CODE EPA ID NUMBER	
RAY JAC CLEANERS S. CRUDDLE 429 BROADWAY NEWBURGH STREET		ICS #: 3004565	
CITY	STATE	ZIP CODE	
	CONTACT NAME	TELEPHONE	
CITY	STATE	ZIP CODE	
PRINCIPAL BUSINESS OF PLANT			

PLEASE ANSWER THE FOLLOWING QUESTIONS:

RTK # G0308438

1. SINCE JANUARY 1, 1952 THRU DECEMBER 31, 1981, HAVE YOU OR ANY PREVIOUS OWNERS/OPERATORS OF THIS FACILITY GENERATED ANY HAZARDOUS WASTE (SEE INSTRUCTIONS) AT YOUR PRESENT FACILITY, PLANT, PROPERTY, ETC?

CHECK ONE

YES  
 NO

IF THE ANSWER IS YES COMPLETE QUESTIONS 1, 2, 3, 4 AND GENERATOR FORM PART - II  
 IF THE ANSWER IS NO COMPLETE QUESTIONS 1 AND 4 AND RETURN THIS FORM

2. HAS THE FACILITY AT THIS LOCATION CHANGED ITS NAME OR IDENTIFICATION BECAUSE THERE WAS A CHANGE IN OWNERSHIP, CORPORATE NAME OR OPERATOR NAME, ETC. IF YES LIST THE NAMES BY WHICH THIS FACILITY HAS BEEN IDENTIFIED SINCE JANUARY 1, 1952 TO THE PRESENT.

YES  
 NO

_____	_____
_____	_____
_____	_____
_____	_____
NAME, ADDRESSES, AND TELEPHONE NUMBERS	DATES

3. DESCRIBE THE DOCUMENTS FROM WHICH DATA THAT IS INCLUDED ON PART-II WAS OBTAINED (SEE INSTRUCTIONS).

_____	_____
_____	_____
_____	_____
_____	_____
DOCUMENT DESCRIPTION	DATES

N/A

4. I HEREBY CERTIFY THAT TO THE BEST OF MY KNOWLEDGE AND BELIEF THAT INFORMATION SUPPLIED IS TRUE AND COMPLETE. FALSE STATEMENTS SUBMITTED ON THIS DOCUMENT ARE PUNISHABLE PURSUANT TO SECTION 210.45 OF THE PENAL LAW.

RAY JAC CLEANERS CORP - FRANCIS P. O'HAGAN      V.P.      4/14/84  
 NAME OF OWNER/OPERATOR, PARTNER OFFICER OR AUTHORIZED REPRESENTATIVE      TITLE      DATE  
Francis P. O'Hagan      (914) 562-3380  
 SIGNATURE      BUSINESS PHONE



DATE 10/5/84

**GENERATOR FORM  
PART - II**

NAME Hercules, Inc.		ICS NUMBER - EPA ID NUMBER 0100638/NY0064329444	
ADDRESS 33 Sprague Avenue			
CITY Middletown,	STATE NY	ZIP 10940	

1. HAZARDOUS WASTE DISPOSAL SITE (SEE INSTRUCTIONS)	2. DESCRIPTION OF HAZARDOUS WASTES DEPOSITED AT THIS LOCATION (SEE INSTRUCTIONS)	3. EPA WASTE CODE	4. WASTE DISPOSED OF QUANTITY OF WASTE (TONS) Approximate	FORM <input type="checkbox"/> LIQUID <input type="checkbox"/> SOLID <input type="checkbox"/> DRUM	5. WASTE DISPOSAL DATES	6. TRANSPORTER OF HAZARDOUS WASTE (SEE INSTRUCTIONS)
Middletown Dump Do. son Avenue Middletown, NY	Waste Solvents - Methanol, Ethanol, Toluene, Benzene Still Bottom Residue 1	-	400	X	1952 to 1964	Company Vehicle
Middletown Landfill Dolson Avenue (Same site as above)	Same 2	-	50	X	1964 to 1968	Company Vehicle
Town of Walkill Landfill Tarbull Road Near Bloomingburg, NY	Still Bottom Residue with smaller amounts of waste solvent 3	-	Unknown	X	1969	Company Vehicle
Turi Landfill Route 17M Goshen, NY	Still Bottom Residue 4	-	180	X	1970 to 1979	Company Vehicle
Turi Landfill Route 17M Goshen, NY	Waste Solvents 5	-	50	X	1970 to 1974	Company Vehicle
Turi Landfill Route 17M Goshen, NY	ALLYL Iso Thio Cyanate 6	-	0.04	X	1970	Company Vehicle
Bidgeport, NJ	Waste Solvent	-	200	X	1974 to 1977	Rollins Environmental



GENERATOR FORM  
PART - II

DATE 10/5/84

NAME	ICS NUMBER - EPA ID NUMBER	
Mercedes, Inc	0100638/NY0064329444	
ADDRESS	33 Sprigue Avenue	
CITY	STATE	ZIP
Middletown,	NY	10940

1. HAZARDOUS WASTE DISPOSAL SITE (SEE INSTRUCTIONS)	2. DESCRIPTION OF HAZARDOUS WASTES DEPOSITED AT THIS LOCATION (SEE INSTRUCTIONS)	3. EPA WASTE CODE	4. WASTE QUANTITY OF WASTE (TONS) Approximately	FORM	5. WASTE DISPOSAL DATES	6. TRANSPORTER OF HAZARDOUS WASTE (SEE INSTRUCTIONS)
Orange County Landfill	Waste Solvent Still Bottom Residue <i>7</i>	-	4	X	1974	Company Vehicle
Turi Landfill Route 17N Goshen, NY	Still Bottom Residue <i>80</i>	-	10	X	1974 to 1979	Company Vehicle
Chemical Control Corp. Elizabeth, NJ	Water Layers Waste Solvents	-	50	X	1977	Gaess Environmental Services
Cannons Eng. Co. Bridgewater, MA	Waste Solvent	D001	36	X	1978	EarthLine
Northeast Solite Corp. Mt. Marion, NY	Waste Solvent <i>9</i>	F003 F005	160	X	1978 to 1981	ALL County
Waste Management Resources Emelle, AL	Still Bottom Residue Water Layers	D001 D002	23	X	1979 to 1981	Applied Technology
OMover Corp. Arvonnia, VA	Waste Solvent	D001	16	X	1981	Applied Technology



50 WOLF ROAD  
ALBANY, NEW YORK 12233



GENERATOR FORM  
PART - I

HAZARDOUS WASTE DISPOSAL QUESTIONNAIRE

PLEASE COMPLETE AND RETURN TO THE ABOVE ADDRESS, ATTENTION: RTK PROCESSING UNIT, ROOM 525

COMPANY NAME		ICS CODE EPA ID NUMBER	
RAY JAE CLEANERS S. CRUDDLE 429 BROADWAY NEWBURGH NEW YORK		ICS #: 3004565	
CITY	STATE	ZIP CODE	
	CONTACT NAME	TELEPHONE	
CITY	STATE	ZIP CODE	
PRINCIPAL BUSINESS OF PLANT			

PLEASE ANSWER THE FOLLOWING QUESTIONS:

RTK # G0308438

1. SINCE JANUARY 1, 1952 THRU DECEMBER 31, 1981, HAVE YOU OR ANY PREVIOUS OWNERS/OPERATORS OF THIS FACILITY GENERATED ANY HAZARDOUS WASTE (SEE INSTRUCTIONS) AT YOUR PRESENT FACILITY, PLANT, PROPERTY, ETC?

IF THE ANSWER IS YES COMPLETE QUESTIONS 1, 2, 3, 4 AND GENERATOR FORM PART - II  
IF THE ANSWER IS NO COMPLETE QUESTIONS 1 AND 4 AND RETURN THIS FORM

CHECK ONE

YES  
 NO

2. HAS THE FACILITY AT THIS LOCATION CHANGED ITS NAME OR IDENTIFICATION BECAUSE THERE WAS A CHANGE IN OWNERSHIP, CORPORATE NAME OR OPERATOR NAME, ETC. IF YES LIST THE NAMES BY WHICH THIS FACILITY HAS BEEN IDENTIFIED SINCE JANUARY 1, 1952 TO THE PRESENT.

_____	_____
_____	_____
_____	_____
_____	_____
NAME, ADDRESSES, AND TELEPHONE NUMBERS	DATES

YES  
 NO

3. DESCRIBE THE DOCUMENTS FROM WHICH DATA THAT IS INCLUDED ON PART-II WAS OBTAINED (SEE INSTRUCTIONS).

_____	_____
_____	_____
_____	_____
DOCUMENT DESCRIPTION	DATES

N/A

4. I HEREBY CERTIFY THAT TO THE BEST OF MY KNOWLEDGE AND BELIEF THAT INFORMATION SUPPLIED IS TRUE AND COMPLETE. FALSE STATEMENTS SUBMITTED ON THIS DOCUMENT ARE PUNISHABLE PURSUANT TO SECTION 210.45 OF THE PENAL LAW.

RAY JAE CLEANERS CORP - FRANCIS P. O'HAGAN  
NAME OF OWNER/OPERATOR, PARTNER OFFICER OR AUTHORIZED REPRESENTATIVE

V.P. 4/14/84  
TITLE DATE

Francis P. O'Hagan  
SIGNATURE

(914) 562-3380  
BUSINESS PHONE

**GENERATOR FORM  
PART - II**



DATE 10/5/84

NAME Hercules, Inc.	ICS NUMBER - EPA ID NUMBER 0100638/NY0064329444	
ADDRESS 33 Sprague Avenue	STATE NY	ZIP 10940
CITY Middletown		

1. HAZARDOUS WASTE DISPOSAL SITE (SEE INSTRUCTIONS)	2. DESCRIPTION OF HAZARDOUS WASTES DEPOSITED AT THIS LOCATION (SEE INSTRUCTIONS)	3. EPA WASTE CODE	4. WASTE DISPOSED OF QUANTITY OF WASTE (TONS) Approximate	FORM		5. WASTE DISPOSAL DATES	6. TRANSPORTER OF HAZARDOUS WASTE (SEE INSTRUCTIONS)
				LIQUID	SOLID		
Middletown Dump Lson Avenue Middletown, NY	Waste Solvents - Methanol, Ethanol, Toluene, Benzene Still Bottom Residue	-	400	X	X	1952 to 1964	Company Vehicle
Middletown Landfill Dolson Avenue (Same site as above)	Same	-	50	X	X	1964 to 1968	Company Vehicle
Town of Walkill Landfill Tarbull Road Near Bloomingburg, NY	Still Bottom Residue with smaller amounts of waste solvent	-	Unknown	X	X	1969	Company Vehicle
Turi Landfill Route 17M Goshen, NY	Still Bottom Residue	-	180	X	X	1970 to 1979	Company Vehicle
Turi Landfill Route 17M Goshen, NY	Waste Solvents	-	50	X	X	1970 to 1974	Company Vehicle
Turi Landfill Route 17M Goshen, NY	Allyl Iso Thio Cyanate	-	0.04	X	X	1970	Company Vehicle
Bridgeport, NJ	Waste Solvent	-	200	X	X	1974 to 1977	Rollins Environmental



28

## COUNTY OF ORANGE

### Department of Health

124 MAIN STREET (1887 BUILDING), GOSHEN, NEW YORK 10924-2199  
TEL: (914) 294-7961

Mary M. McPhillips  
County Executive

Sally Faith Dorfman, M.D., MSHSA  
Commissioner of Health

February 25, 1991

RE: Orange County Landfill  
Site Reclassification

Mr. Mauricio Roma  
Engineering Geologist  
New York State Department  
of Environmental Conservation  
21 South Putt Corners Road  
New Paltz, NY 12561-1696

Dear Sir:

The material which you presented appears to justify the reclassification of this site to Class 2. There is no indication of pollutant migration from the landfill area making this the appropriate time for further investigation to preclude exposure of the surrounding population to hazardous materials.

I have a question relative to the limits used as "State limits" in the tables. Specifically, lead and arsenic are shown at 25 ug/l yet Subpart 5-1 of the New York State Sanitary Code indicates drinking water maximum contaminant levels of 50 ug/l for each of these heavy metals. It has been my impression that drinking water standards are the criteria used. The change in limit would not eliminate consideration of these contaminants but would reduce the number of existing test wells where an excess value is found.

Another thought that comes to mind in relation to arsenic is the potential for prior use of the material in the farming and orchard activities in the area.

Very truly yours,

M. J. Schleifer, P.E.  
Assistant Commissioner

MJS:dlb

cc: Dr. Dorfman  
File

YY

NEW YORK STATE DEPARTMENT OF ENVIRONMENTAL CONSERVATION  
DIVISION OF SOLID AND HAZARDOUS WASTE

50 WOLF ROAD  
ALBANY, NEW YORK 12233



GENERATOR FORM  
PART - I

HAZARDOUS WASTE DISPOSAL QUESTIONNAIRE

PLEASE COMPLETE AND RETURN TO THE ABOVE ADDRESS, ATTENTION: RTK PROCESSING UNIT, ROOM 525

COMPANY NAME		ICS CODE EPA ID NUMBER	
RAY JAE CLEANERS S. CRUDDLE 429 BROADWAY NEWBURGH NEW YORK		ICS #: 3004565	NY 12550
CITY	STATE	CONTACT NAME	TELEPHONE
CITY	STATE		ZIP CODE
PRINCIPAL BUSINESS OF PLANT			

PLEASE ANSWER THE FOLLOWING QUESTIONS:

RTK # G0308438

1. SINCE JANUARY 1, 1952 THRU DECEMBER 31, 1981, HAVE YOU OR ANY PREVIOUS OWNERS/OPERATORS OF THIS FACILITY GENERATED ANY HAZARDOUS WASTE (SEE INSTRUCTIONS) AT YOUR PRESENT FACILITY, PLANT, PROPERTY, ETC?

CHECK ONE

YES  
 NO

IF THE ANSWER IS YES COMPLETE QUESTIONS 1, 2, 3, 4 AND GENERATOR FORM PART - II  
IF THE ANSWER IS NO COMPLETE QUESTIONS 1 AND 4 AND RETURN THIS FORM

2. HAS THE FACILITY AT THIS LOCATION CHANGED ITS NAME OR IDENTIFICATION BECAUSE THERE WAS A CHANGE IN OWNERSHIP, CORPORATE NAME OR OPERATOR NAME, ETC. IF YES LIST THE NAMES BY WHICH THIS FACILITY HAS BEEN IDENTIFIED SINCE JANUARY 1, 1952 TO THE PRESENT.

YES  
 NO

_____	_____
_____	_____
_____	_____
_____	_____
NAME, ADDRESSES, AND TELEPHONE NUMBERS	DATES

3. DESCRIBE THE DOCUMENTS FROM WHICH DATA THAT IS INCLUDED ON PART-II WAS OBTAINED (SEE INSTRUCTIONS).

_____	_____
_____	_____
_____	_____
_____	_____
DOCUMENT DESCRIPTION	DATES

N/A

4. I HEREBY CERTIFY THAT TO THE BEST OF MY KNOWLEDGE AND BELIEF THAT INFORMATION SUPPLIED IS TRUE AND COMPLETE. FALSE STATEMENTS SUBMITTED ON THIS DOCUMENT ARE PUNISHABLE PURSUANT TO SECTION 210.45 OF THE PENAL LAW.

RAY JAE CLEANERS CORP - FRANCIS P. O'HAGAN  
NAME OF OWNER/OPERATOR, PARTNER OFFICER OR AUTHORIZED REPRESENTATIVE

V.P. 4/14/84  
TITLE DATE

Francis P. O'Hagan (914) 592-3380  
SIGNATURE BUSINESS PHONE

Reference: Gibbs & Hill, Inc., June 1988. Phase 1 Investigation,  
Orange County Landfill (336007) Page 7 of 9

in comparison to regional flow, are a result of leachate mounding within the landfill and the close proximity of the Cheechunck Channel. Hydrologic influences can cause localize changes in groundwater flow.

The aquifer of concern is the Esker Aquifer consisting of up to 90 feet of sand and gravel. Although the Esker Aquifer is the aquifer of concern which has a potential yield of up to 120 gpm [A-10-2-2, Well 123-424-1], it is not a sole source aquifer. The bedrock within the region is also tapped for potable purposes and yields in excess of 50 gpm have been reported. [A-10-2-2, Well 123-428-3].

#### 4.4 Site Contamination

##### Waste Types and Quantities

The site accepts mixed municipal waste, sewage sludge, waste oil, septic tank pumpings, and industrial wastes [A-4-1-2]. Presently, 1100 tons per day of municipal wastes are received, some of it from other Counties and states. In 1980, the landfill accepted about 750 tons of waste per day [A-2-2-8]. An estimated 4,000,000 cubic yards of waste has been dumped at the landfill during the last 14 years.

An EPA Potential Hazardous Waste Site Identification and Preliminary Assessment performed in March 1980 indicated that the Minisink Rubber Company (no longer on the list of active users) dumped 165 gallons per year of drummed waste lube and hydraulic oils at the landfill [A-11-2-5]. This dumping is also mentioned in a Hazardous Waste Site Investigation report prepared in June 1980 [A-2-2-8].

The one documented case of hazardous waste dumping at the site was by Kievas Cooperage, a carter not licensed to transport hazardous waste. On March 30, 1979 this carter dumped several

336007  
 Source: Crane Co. Landfill Phase-1 Investigation Report, June 1988. Prepared by Gibbs & Hill, Inc.

336000  
 336001  
 336002  
 336003  
 336004  
 336005  
 336006  
 336007  
 336008  
 336009  
 336010  
 336011  
 336012  
 336013  
 336014  
 336015  
 336016  
 336017  
 336018  
 336019  
 336020  
 336021  
 336022  
 336023  
 336024  
 336025  
 336026  
 336027  
 336028  
 336029  
 336030  
 336031  
 336032  
 336033  
 336034  
 336035  
 336036  
 336037  
 336038  
 336039  
 336040  
 336041  
 336042  
 336043  
 336044  
 336045  
 336046  
 336047  
 336048  
 336049  
 336050  
 336051  
 336052  
 336053  
 336054  
 336055  
 336056  
 336057  
 336058  
 336059  
 336060  
 336061  
 336062  
 336063  
 336064  
 336065  
 336066  
 336067  
 336068  
 336069  
 336070  
 336071  
 336072  
 336073  
 336074  
 336075  
 336076  
 336077  
 336078  
 336079  
 336080  
 336081  
 336082  
 336083  
 336084  
 336085  
 336086  
 336087  
 336088  
 336089  
 336090  
 336091  
 336092  
 336093  
 336094  
 336095  
 336096  
 336097  
 336098  
 336099  
 336100  
 336101  
 336102  
 336103  
 336104  
 336105  
 336106  
 336107  
 336108  
 336109  
 336110  
 336111  
 336112  
 336113  
 336114  
 336115  
 336116  
 336117  
 336118  
 336119  
 336120  
 336121  
 336122  
 336123  
 336124  
 336125  
 336126  
 336127  
 336128  
 336129  
 336130  
 336131  
 336132  
 336133  
 336134  
 336135  
 336136  
 336137  
 336138  
 336139  
 336140  
 336141  
 336142  
 336143  
 336144  
 336145  
 336146  
 336147  
 336148  
 336149  
 336150  
 336151  
 336152  
 336153  
 336154  
 336155  
 336156  
 336157  
 336158  
 336159  
 336160  
 336161  
 336162  
 336163  
 336164  
 336165  
 336166  
 336167  
 336168  
 336169  
 336170  
 336171  
 336172  
 336173  
 336174  
 336175  
 336176  
 336177  
 336178  
 336179  
 336180  
 336181  
 336182  
 336183  
 336184  
 336185  
 336186  
 336187  
 336188  
 336189  
 336190  
 336191  
 336192  
 336193  
 336194  
 336195  
 336196  
 336197  
 336198  
 336199  
 336200

REGISTRY SITE CODE	WASTE QUESTIONNAIRE RTK PROCESSING UNIT	RTK Site Code with waste type	COMPANY NAME	WASTE DESCRIPTION	IDENTITY
336000	UNKNOWN		AAK BROOKS & PERKINS CO	TRITITE 14-2	336000.0
336001	UNKNOWN		TEXACO INC	TANK BOTTOMS FUEL OIL #6 UN - IN 1993 CONTAMINATE	336001.0
336002	UNKNOWN		CHESTER CARLE CORPORATION	3X & 4X SOLUTION OF LUBRO OIL - 63X FATTY OILS	336002.0
336003	UNKNOWN		NEW YORK TELEPHONE COMPANY - NEWBURGH, NY	PCB WASTE	336003.0
336004	UNKNOWN		NEW YORK TELEPHONE - GREENWOOD LAKE, NY	PCB WASTE	336004.0
336005	UNKNOWN		SUN REFINING AND MARKETING COMPANY	LEADED GASOLINE TANK BOTTOMS	336005.0
336006	UNKNOWN		BALCHEN CORPORATION	WASTE FROM THE CLEANING OF THERMAL TANKS	336006.0
336007	UNKNOWN		SYNTEX BEAUTY CARE INC.	WASTE FROM MONOMER PRODUCTION	336007.0
336008	UNKNOWN		SPENCE ENGINEERING CO INC	FLAMMABLE LIQ, DILUTER, CORROSIVE MATERIALS, MIXTURE B, ETC.	336008.0
336009	UNKNOWN		MORIL OIL NEWBURGH TERMINAL	USED WAREL (MINERAL SPIRITS)	336009.0
336010	UNKNOWN		STARPLATE INC	REFRIGERATOR SLUDGE AND OIL CONTAINING TRICHLOROTHENE	336010.0
336011	UNKNOWN		PFM DIV HEROLLES INC	SPECIAL CLEANING SOLUTION FROM METAL FINISHING	336011.0
336012	UNKNOWN		RAY JAC CLEANERS	WASTE SOLVENTS-STILL BOTTOM RESIDUE	336012.0
336013	UNKNOWN		RIS DYE-CLEANING CORP. (FOOTWEAR CLEANERS)	FILTER CARTRIDGES WITH PERCHLOROETHYLENE	336013.0
336014	UNKNOWN		AMERIDA HESS, ROSSINI NY	TETRACHLOROETHYLENE	336014.0
336015	UNKNOWN		STAR EXPANSION INDUSTRIES CORP.	NO 6 OIL MIXED WITH SAND + BIRT	336015.0
336016	UNKNOWN		STAUFFER CHEMICAL COMPANY	LUBRITOL CYANIDE SOLUTION	336016.0
336017	UNKNOWN		REYNOLDS METALS CO (WALKILL CAN PLANT)	SLURRY, SOLID PAC AND POWDERED MATERIALS - SEE FTUJ	336017.0
336018	UNKNOWN		WIDEN PRODUCTS + KOLMAR LABS (3177723)	WASTE FLAMMABLE MATERIAL	336018.0
336019	UNKNOWN		PFM DIV HEROLLES INC	CHROME OXIDE GREEN COLORS	336019.0
336020	UNKNOWN		PFM DIV HEROLLES INC	WASTE SOLVENTS	336020.0
336021	UNKNOWN		PFM DIV HEROLLES INC	ALLYL ISO THIO CYANATE	336021.0
336022	UNKNOWN		PFM DIV HEROLLES INC	STILL BOTTOM RESIDUE	336022.0
336023	UNKNOWN		PFM DIV HEROLLES INC	STILL BOTTOM RESIDUE WITH SMALL AMTS OF WASTE SOLVENTS	336023.0
336024	UNKNOWN		CAD BATTERIES DIVISION	WASTE WATER CONTAMINATED WITH LEAD	336024.0
336025	UNKNOWN		REDFIELD CHEMICALS INC	ACETONE, TOLUENE, XYLIDE, METH CL, FRETUMBERATION, STYRENE, DMCS,	336025.0
336026	UNKNOWN		KUP ENTERPRISES INC A GARNERIE INDUSTRY	UNKNOWN-POSSIBLY PLASTISOLS, SOLVENTS, ETC	336026.0
336027	UNKNOWN		NEW YORK STATE PARKS & RECREATION	TRUCK STORAGE-TYRM. PLASTISOLS	336027.0
336028	UNKNOWN		A & M PRODUCTS CO. INC.	ROT, RECYCLE, MECHACHROME, SODIUM ARSENATE, POTASSIUM, PESTICIDES	336028.0
336029	UNKNOWN		IMM CORP (EAST FISHKILL)	PLAYING BATH SLUDGES	336029.0
336030	UNKNOWN		XEROX CORP, RT 303, PLAXMELT, NY 10913	MIXED WASTE SOLVENTS	336030.0
336031	UNKNOWN		R & R SANITATION	BOX 120, (5X HALO HYDROCARBONS, CASUAL WASTES, UNKNOWN)	336031.0
336032	UNKNOWN		R & R SANITATION	ESTER, ALCOHOL, ETHER, KETONE, ALKYL RESIDUES	336032.0
336033	UNKNOWN		R & R SANITATION	MIXED SOLVENT	336033.0
336034	UNKNOWN		R & R SANITATION	MIXED SOLVENT FLAMMABLE	336034.0
336035	UNKNOWN		R & R SANITATION	PAINT PIGMENT RESIDUE FLAMMABLE	336035.0
336036	UNKNOWN		R & R SANITATION	OIL, OIL SLUDGE, EMULSIONS	336036.0
336037	UNKNOWN		R & R SANITATION	ESTER, ALCOHOL, ETHER, KETONE, BLEND RESIDUE	336037.0
336038	UNKNOWN		R & R SANITATION	MIXED SOLVENTS FLAMMABLE	336038.0
336039	UNKNOWN		NY NEWS	INK	336039.0
336040	UNKNOWN		NY POST	INK	336040.0
336041	UNKNOWN		PHILIPS DORCF	OIL	336041.0
336042	UNKNOWN		POLYCHROME	MIXER, TRANSMISSION, AND MATERIAL TO OIL	336042.0
336043	UNKNOWN		COCA-COLA BOTTLING CO OF NY INC/NEW WINDSOR		336043.0
336044	UNKNOWN		R & R SANITATION		336044.0
336045	UNKNOWN				336045.0
336046	UNKNOWN				336046.0
336047	UNKNOWN				336047.0
336048	UNKNOWN				336048.0
336049	UNKNOWN				336049.0
336050	UNKNOWN				336050.0
336051	UNKNOWN				336051.0
336052	UNKNOWN				336052.0
336053	UNKNOWN				336053.0
336054	UNKNOWN				336054.0
336055	UNKNOWN				336055.0
336056	UNKNOWN				336056.0
336057	UNKNOWN				336057.0
336058	UNKNOWN				336058.0
336059	UNKNOWN				336059.0
336060	UNKNOWN				336060.0
336061	UNKNOWN				336061.0
336062	UNKNOWN				336062.0
336063	UNKNOWN				336063.0
336064	UNKNOWN				336064.0
336065	UNKNOWN				336065.0
336066	UNKNOWN				336066.0
336067	UNKNOWN				336067.0
336068	UNKNOWN				336068.0
336069	UNKNOWN				336069.0
336070	UNKNOWN				336070.0
336071	UNKNOWN				336071.0
336072	UNKNOWN				336072.0
336073	UNKNOWN				336073.0
336074	UNKNOWN				336074.0
336075	UNKNOWN				336075.0
336076	UNKNOWN				336076.0
336077	UNKNOWN				336077.0
336078	UNKNOWN				336078.0
336079	UNKNOWN				336079.0
336080	UNKNOWN				336080.0
336081	UNKNOWN				336081.0
336082	UNKNOWN				336082.0
336083	UNKNOWN				336083.0
336084	UNKNOWN				336084.0
336085	UNKNOWN				336085.0
336086	UNKNOWN				336086.0
336087	UNKNOWN				336087.0
336088	UNKNOWN				336088.0
336089	UNKNOWN				336089.0
336090	UNKNOWN				336090.0
336091	UNKNOWN				336091.0
336092	UNKNOWN				336092.0
336093	UNKNOWN				336093.0
336094	UNKNOWN				336094.0
336095	UNKNOWN				336095.0
336096	UNKNOWN				336096.0
336097	UNKNOWN				336097.0
336098	UNKNOWN				336098.0
336099	UNKNOWN				336099.0
336100	UNKNOWN				336100.0

336007)

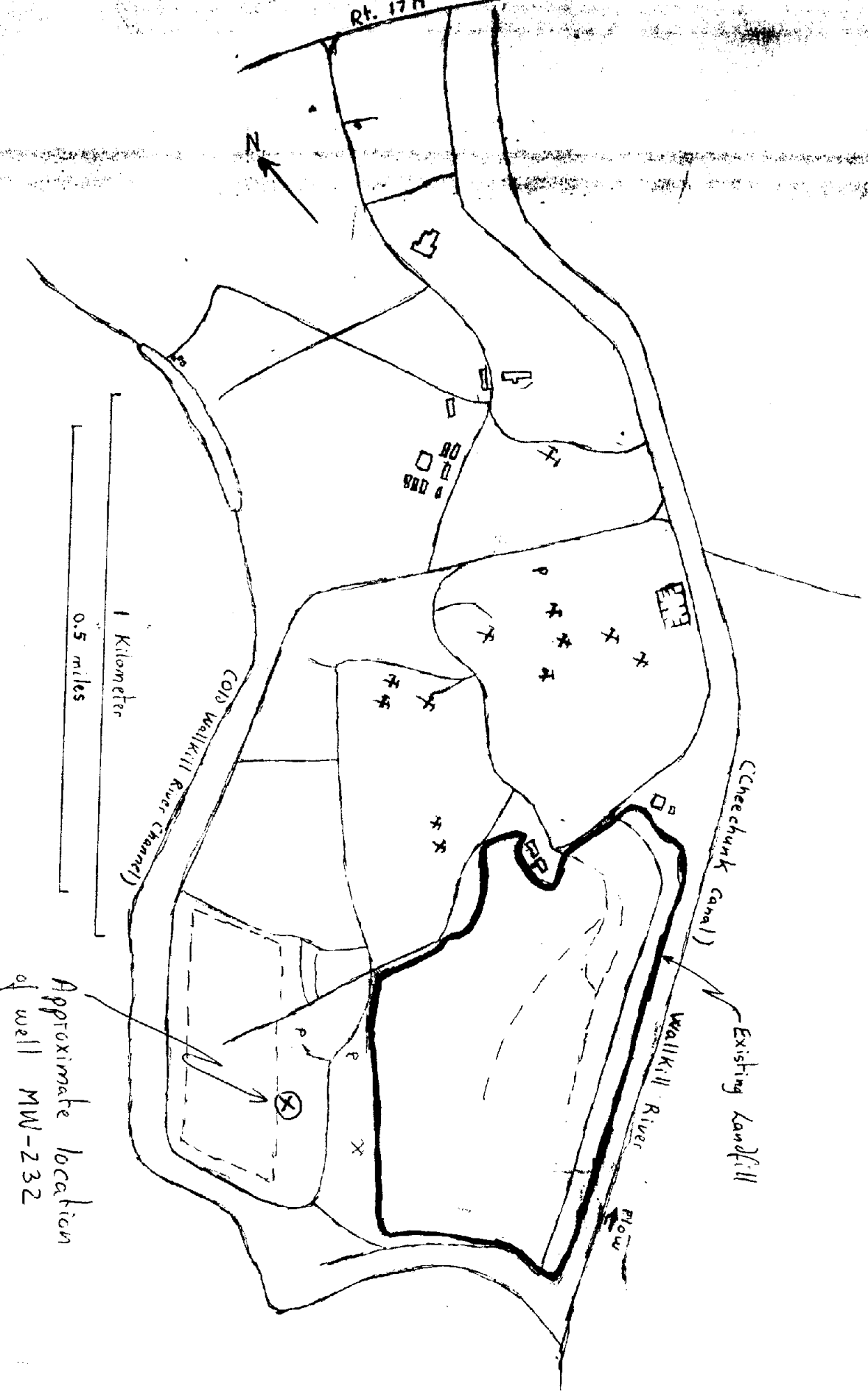

Approximate location  
of well MW-232

Basemap prepared  
by M. Roma (NYSDEC)  
Features are based on  
July 27, 1990 aerial photo