

<b>PROJECT:</b>	Former Fulton MGP – Parcels III and IV (Site No.: 224051)
<b>ADDRESS:</b>	545 Sackett St., Brooklyn, NY
<b>PREPARED BY:</b>	Roux Environmental Engineering and Geology, D.P.C.
<b>DATE:</b>	January 29, 2024
<b>WEATHER:</b>	Temp: 33-41°F, Cloudy, RH: 83% Pressure: 29.80" in Hg Wind: @ 12 mph
<b>TIME:</b>	07:00 – 15:30

### Project Team

#### General Contractor and Subcontractors:

- Mega Contracting Group, LLC (Mega)
- Creamer Environmental, Inc. (CEI)

#### Engineers and Consultants:

- Roux Environmental Engineering and Geology, D.P.C. (Roux)
- GZA GeoEnvironmental Inc. of New York (GZANY)
- WSP USA (WSP)

### Remedial Action Work Summary

#### Work Activities Performed Onsite:

- Load out and disposal of material from waste characterization grids WC-2 and WC-3.
- Installation of support of excavation (SOE).

#### Contractor Work Performed Onsite:

Creamer Environmental, Inc. (CEI) exported 22 trucks (~484 tons) of urban fill with CVOCs from waste characterization grid WC-2 (0-5 and 5-10) and WC-3 (0-5) to Waste Management Fairless. CEI continued breaking surface concrete and downsizing material for future load out and disposal in grids WC-3. CEI continued installation and welding the SOE walers/ bracing in the Gas Holder 3 excavation area and continued installing the lagging wall between Gas Holder 3 and 4. While excavating in WC-2 and WC-3 a subsurface structure was discovered that appeared to be a remnant pipe fitting and/or connection at an elevation of approximately +5' NAVD88. Further investigation into the structure will be conducted in the coming days.

The vapor management system (VMS) associated with the tension fabric structure (TFS) was operated throughout the day. Dust and odor control measures (wetting, tarping, limiting vehicle speeds, etc.) were performed as needed, to ensure there were no impacts to the neighborhood. All truck tires were cleaned before leaving the Site, to ensure no material was tracked onto the surrounding streets. Exposed soils were covered with Atmos odor suppressing foam and/or poly sheeting at the end of the day.

#### Air Monitoring:

- No VOC or dust exceedances were observed from the community air monitoring program (CAMP).
- GZANY to provide a summary report of CAMP activities separately.

#### Erosion and Sediment Control:

- None.

#### Sampling Conducted:

- None.

#### Other Items of Note:

- Construction activities were observed as part of the ongoing combined sewer overflow (CSO) project west of Nevins Street.

**DAILY STATUS REPORT**

<b>PROJECT:</b>	Former Fulton MGP – Parcels III and IV (Site No.: 224051)
<b>ADDRESS:</b>	545 Sackett St., Brooklyn, NY
<b>PREPARED BY:</b>	Roux Environmental Engineering and Geology, D.P.C.
<b>DATE:</b>	January 29, 2024
<b>WEATHER:</b>	Temp: 33-41°F, Cloudy, RH: 83% Pressure: 29.80" in Hg Wind: @ 12 mph
<b>TIME:</b>	07:00 – 15:30

**Imported Material**

Name - Location	Source	During This Reporting Period		Total	
		Loads	Tons	Loads	Tons
Vulcan ASTM #3 (1 ½" Stone)	Vulcan Hamburg Quarry			10	255.36
Vulcan ASTM #57 (3/4" Stone)	Vulcan Hamburg Quarry			5	126.76
Vulcan General Fill	Vulcan Wantage Quarry			639	16,112.13

**Exported Material**

Material	Facility	During This Reporting Period		Total	
		Loads	Tons	Loads	Tons
TCE Impacted Haz Hot Spots	CWM Emelle			7	161.72
Cd Impacted Haz Material from WC-5	CWM Emelle			3	49.45
Pb Impacted Haz from Parcel IV Hot Spot	CWM Emelle			25	536.72
Cd Impacted Haz Material from WC-5	Clean Earth NJ			16	397.75
Concrete for Recycling	Bayshore			23	421.87
Concrete for Landfill	WM Fairless			63	~1,415.93
Urban Fill for CVOC Orange Zone (Lot 17)	WM Fairless Urban Fill-OZ			47	~1034
Urban Fill for CVOC Orange Zone (Lot 49)	WM Fairless Urban Fill-OZ			24	~528
Non-Haz Urban Fill (Lot 17)	Clean Earth Carteret			42	~924
Non-Haz Urban Fill (Lot 49)	Clean Earth Carteret			73	~1,606
MGP soil with TCE>25 ppm	Clean Earth ESMI			181	~3,906
	CE Southeast Pennsylvania			8	~176
Non-Haz MGP Impacted (TCLP Benzene > 0.5)	CE Southeast Pennsylvania			8	~237.97
Non-Haz MGP Impacted (TCLP Benzene < 0.5)	CE Southeast Pennsylvania			58	~1,276
Non-Haz Contaminated Urban Fill	WM Fairless	22	~484	262	~5,604.69
Non-Haz Urban Fill	Clean Earth Carteret -BZ			40	~857
Non-Haz MGP Impacted	Clean Earth of New Castle			35	~770
MGP Impacted (TCLP Benzene 0.2<x<0.5 mg/l)	CE Southeast Pennsylvania			5	~110

**Exported Material Truck Log**

Number	Excavation Grid	Disposal Facility	Disposal Profile	Manifest Number	Trucking Company	Truck License Plate
1	WC-2 (0-8)	WM Fairless	Urban Fill with CVOCs	13270040	Valiant	AU919Z
2	WC-2 (0-8)	WM Fairless	Urban Fill with CVOCs	13270041	Valiant	AY190P
3	WC-2 (0-8)	WM Fairless	Urban Fill with CVOCs	13270042	Valiant	AY559J
4	WC-2 (0-8)	WM Fairless	Urban Fill with CVOCs	13270043	V&E	AY698R
5	WC-2 (0-8)	WM Fairless	Urban Fill with CVOCs	13270044	V&E	AY260E
6	WC-2 (0-8)	WM Fairless	Urban Fill with CVOCs	13270045	V&E	AY774E
7	WC-2 (0-8)	WM Fairless	Urban Fill with CVOCs	13270046	Valiant	AX675K
8	WC-2 (0-8)	WM Fairless	Urban Fill with CVOCs	13270047	Valiant	AY561J
9	WC-2 (0-8)	WM Fairless	Urban Fill with CVOCs	13270048	Valiant	AY192P
10	WC-2 (0-8)	WM Fairless	Urban Fill with CVOCs	13270049	Valiant	AY912F
11	WC-2 (0-8)	WM Fairless	Urban Fill with CVOCs	13270050	V&E	AW259D

**DAILY STATUS REPORT**

<b>PROJECT:</b>	Former Fulton MGP – Parcels III and IV (Site No.: 224051)
<b>ADDRESS:</b>	545 Sackett St., Brooklyn, NY
<b>PREPARED BY:</b>	Roux Environmental Engineering and Geology, D.P.C.
<b>DATE:</b>	January 29, 2024
<b>WEATHER:</b>	Temp: 33-41°F, Cloudy, RH: 83% Pressure: 29.80" in Hg Wind: @ 12 mph
<b>TIME:</b>	07:00 – 15:30

12	WC-2 (0-8)	WM Fairless	Urban Fill with CVOCs	13270051	Valiant	AY560J
13	WC-2 (0-8)	WM Fairless	Urban Fill with CVOCs	13270052	Valiant	AW189P
14	WC-2 (0-8)	WM Fairless	Urban Fill with CVOCs	13270053	V&E	AW641V
15	WC-2 (0-8)	WM Fairless	Urban Fill with CVOCs	13270054	Valiant	AY193P
16	WC-2 (0-8)	WM Fairless	Urban Fill with CVOCs	13270055	Valiant	AY387N
17	WC-2 (0-8)	WM Fairless	Urban Fill with CVOCs	13270056	Valiant	AW383F
18	WC-2 (0-8)	WM Fairless	Urban Fill with CVOCs	13270057	V&E	AY259D
19	WC-3 (0-8)	WM Fairless	Urban Fill with CVOCs	13270058	Valiant	AX676K
20	WC-3 (0-8)	WM Fairless	Urban Fill with CVOCs	13270059	Valiant	AY399C
21	WC-3 (0-8)	WM Fairless	Urban Fill with CVOCs	13270060	Valiant	AY191P
22	WC-3 (0-8)	WM Fairless	Urban Fill with CVOCs	13270061	V&E	AY436A

**Dewatering**

<b>Time</b>	<b>Totalizer Reading</b>
7:00	40,131,200
15:30	40,131,200
Water treated and discharged since last report:	0 gallons

**Anticipated Upcoming Work Activities**

Survey excavation in WC-2 and WC-3. Import of clean fill and backfill completed excavation areas in WC-2 and WC-3. Continued installation of SOE in Gas Holder 3 area and prep work for future material load out from Gas Holder 3 excavation area.

<b>PROJECT:</b>	Former Fulton MGP – Parcels III and IV (Site No.: 224051)
<b>ADDRESS:</b>	545 Sackett St., Brooklyn, NY
<b>PREPARED BY:</b>	Roux Environmental Engineering and Geology, D.P.C.
<b>DATE:</b>	January 29, 2024
<b>WEATHER:</b>	Temp: 33-41°F, Cloudy, RH: 83% Pressure: 29.80" in Hg Wind: @ 12 mph
<b>TIME:</b>	07:00 – 15:30

### Site Layout

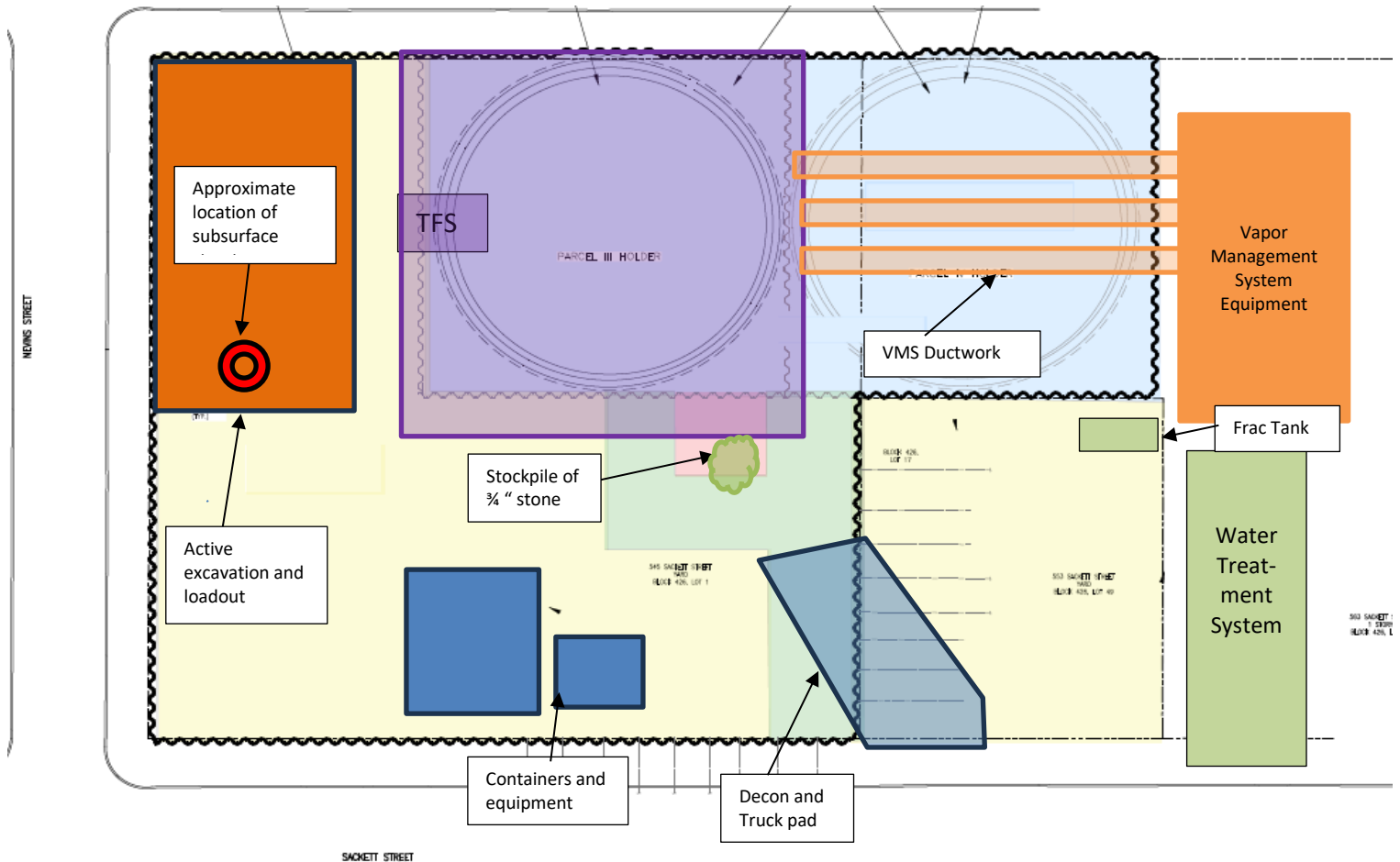

<b>PROJECT:</b>	Former Fulton MGP – Parcels III and IV (Site No.: 224051)
<b>ADDRESS:</b>	545 Sackett St., Brooklyn, NY
<b>PREPARED BY:</b>	Roux Environmental Engineering and Geology, D.P.C.
<b>DATE:</b>	January 29, 2024
<b>WEATHER:</b>	Temp: 33-41°F, Cloudy, RH: 83% Pressure: 29.80" in Hg Wind: @ 12 mph
<b>TIME:</b>	07:00 – 15:30

### Excavation Diagram

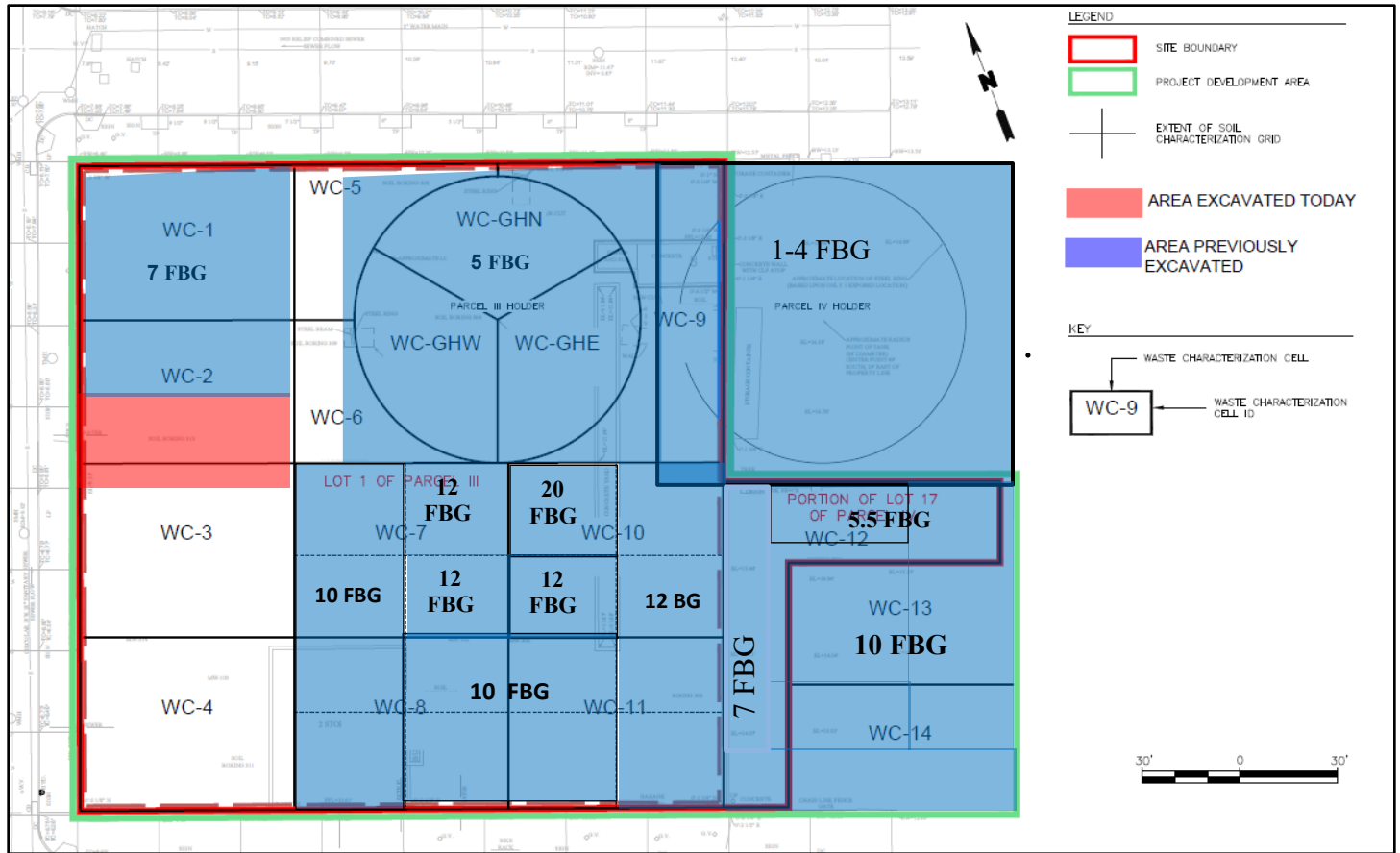



<b>PROJECT:</b>	Former Fulton MGP – Parcels III and IV (Site No.: 224051)
<b>ADDRESS:</b>	545 Sackett St., Brooklyn, NY
<b>PREPARED BY:</b>	Roux Environmental Engineering and Geology, D.P.C.
<b>DATE:</b>	January 29, 2024
<b>WEATHER:</b>	Temp: 33-41°F, Cloudy, RH: 83% Pressure: 29.80" in Hg Wind: @ 12 mph
<b>TIME:</b>	07:00 – 15:30



**Photo 1:**  
Looking southwest, view of CEI excavating material in waste characterization grid WC-3, with discovered subsurface structure at the bottom of the excavation.



**Photo 2:**  
Looking southeast, view CEI cleaning tires and securing tarp on trucks for offsite transport of excavated material.