

PROJECT:	Former Fulton MGP – Parcels III and IV (Site No.: 224051)
ADDRESS:	545 Sackett St., Brooklyn, NY
PREPARED BY:	Roux Environmental Engineering and Geology, D.P.C.
DATE:	April 24, 2023
WEATHER:	Temp: 48 – 60°F Sunny, RH: 61% Pressure: 30.05" Hg Wind: NW @ 4 mph
TIME:	07:00 – 15:30

Project Team

General Contractor and Subcontractors:

- Mega Contracting Group, LLC (Mega)
- Creamer Environmental, Inc. (CEI)
- Aquifer, Drilling and Testing-Cascade Env (ADT)

Engineers and Consultants:

- Roux Environmental Engineering and Geology, D.P.C. (Roux)
- GZA GeoEnvironmental Inc. (GZA)

Remedial Action Work Summary

Work Activities Performed Onsite:

- Loaded out material from the hazardous lead hot spots on Parcel IV for disposal to CMW Emelle.
- Loaded out material from waste characterization grid WC-GH4-1(0-5) on Parcel IV for disposal at Clean Earth New Castle.
- Loaded out concrete from Parcel IV for disposal to Waste Management Fairless.
- Installation of sentinel groundwater monitoring wells.

Contractor Work Performed Onsite:

Creamer Environmental, Inc (CEI) exported material for offsite disposal. One truck (approximately 22 tons) of hazardous lead from hot spot on Parcel IV was shipped to CMW Emelle facility. This completed the removal of hazardous lead material on Parcel IV. Six trucks (approximately 132 tons) of non-hazardous MGP impacted material from waste characterization grid WC-GH4-1(0-5) were shipped to Clean Earth New Castle (CENC) facility. Four trucks of concrete (approximately 88 tons) from Parcel IV were shipped to Waste Management Fairless facility. CEI inspected and cleaned all transport trucks to ensure DOT requirements were met and no material was tracked off-site. After load outs were completed for the day, CEI continued processing concrete and soil grading activities on Parcel IV, in preparation of support of excavation (SOE) sheet pile installation.

Sentinel ground water monitoring wells installation continued. ADT installed groundwater monitoring well SW-03D on Degraw Street and advanced augers for well SW-04D on Sackett Street.

CEI conducted dust and odor control measurements (wetting, tarping, limiting vehicle speeds, etc.) during the workday to ensure there were no impacts to the neighborhood. No work was performed inside the tension fabric structure (TFS) and the vapor managements system (VMS) was not operated today.

Air Monitoring:

- No VOC or dust exceedances were observed from the community air monitoring program (CAMP).
- GZA will provide a summary report of CAMP activities.

Erosion and Sediment Control

- Erosion and sediments controls were inspected to confirm all elements are operational and functional.

Sampling Conducted:

- None

Other Items of Note:

- Construction and drilling activities were observed as part of the ongoing CSO project west of Nevins Street.

**DAILY STATUS REPORT**

PROJECT:	Former Fulton MGP – Parcels III and IV (Site No.: 224051)
ADDRESS:	545 Sackett St., Brooklyn, NY
PREPARED BY:	Roux Environmental Engineering and Geology, D.P.C.
DATE:	April 24, 2023
WEATHER:	Temp: 48 – 60°F Sunny, RH: 61% Pressure: 30.05" Hg Wind: NW @ 4 mph
TIME:	07:00 – 15:30

Imported Material

Name - Location	Source	During This Reporting Period		Total	
		Loads	Tons	Loads	Tons
Vulcan ASTM #3 (1 ½" Stone)	Vulcan Hamburg Quarry		26.03	7	179.3
Vulcan General Fill	Vulcan Wantage Quarry		231.12	95	2417.38

Exported Material

Material	Facility	During This Reporting Period		Total	
		Loads	Tons	Loads	Tons
Concrete for Recycling	Bayshore			20	421.87
Concrete for Landfill	WM Fairless	4	~88	55	~1,268.59
TCE Impacted Haz Hot Spots	CWM Emelle			7	161.72
Cd Impacted Haz Material from WC-5	CWM Emelle			3	49.45
Pb impacted Haz from Parcel IV Hot Spot	CMW Emelle	1	~22	25	~550
Cd Impacted Haz Material from WC-5	Clean Earth NJ			16	397.75
Non-Haz Contaminated Urban Fill	WM Fairless			99	~2,090
MGP soil with TCE>25 ppm	Clean Earth ESMI			113	~2,494
Non-Haz MGP Impacted	Clean Earth New Castle	6	~132	34	~748

Exported Material Truck Log

Number	Excavation Grid	Disposal Facility	Disposal Profile	Manifest Number	Trucking Company	Truck License Plate
1	Pb Hot Spot Parcel IV	CMW Emelle	Pb-Haz Hot Spot	7276668	Horwith	AG92028
2	Parcel IV Concrete	WM Fairless	WM Fairless Concrete – Parcel IV	12500980	V&E	AY260E
3	Parcel IV Concrete	WM Fairless	WM Fairless Concrete – Parcel IV	12500981	V&E	AY259E
4	WC-GH4-1(0-5)	CENC	Non-Haz MGP Soil	2823635	Mesa	AY391G
5	WC-GH4-1(0-5)	CENC	Non-Haz MGP Soil	2823636	Mesa	AS420W
6	WC-GH4-1(0-5)	CENC	Non-Haz MGP Soil	2823637	Mesa	AU927B
7	WC-GH4-1(0-5)	CENC	Non-Haz MGP Soil	2823638	Mesa	AU714R
8	WC-GH4-1(0-5)	CENC	Non-Haz MGP Soil	2823639	Mesa	AX177N
9	WC-GH4-1(0-5)	CENC	Non-Haz MGP Soil	2823640	H&M	AU674V
10	Parcel IV Concrete	WM Fairless	WM Fairless Concrete – Parcel IV	12500982	V&E	AY260E
11	Parcel IV Concrete	WM Fairless	WM Fairless Concrete – Parcel IV	12500983	V&E	AY259E

PROJECT:	Former Fulton MGP – Parcels III and IV (Site No.: 224051)
ADDRESS:	545 Sackett St., Brooklyn, NY
PREPARED BY:	Roux Environmental Engineering and Geology, D.P.C.
DATE:	April 24, 2023
WEATHER:	Temp: 48 – 60°F Sunny, RH: 61% Pressure: 30.05" Hg Wind: NW @ 4 mph
TIME:	07:00 – 15:30

Dewatering

Time	Totalizer Volume (gallons)*
NA	2,364,306
Water treated and discharged since last report:	0 gallons

Anticipated Upcoming Work Activities

Continued cut down and load out of MGP impacted material from Parcel IV. Continued installation of sentinel groundwater monitoring well network.

Site Layout

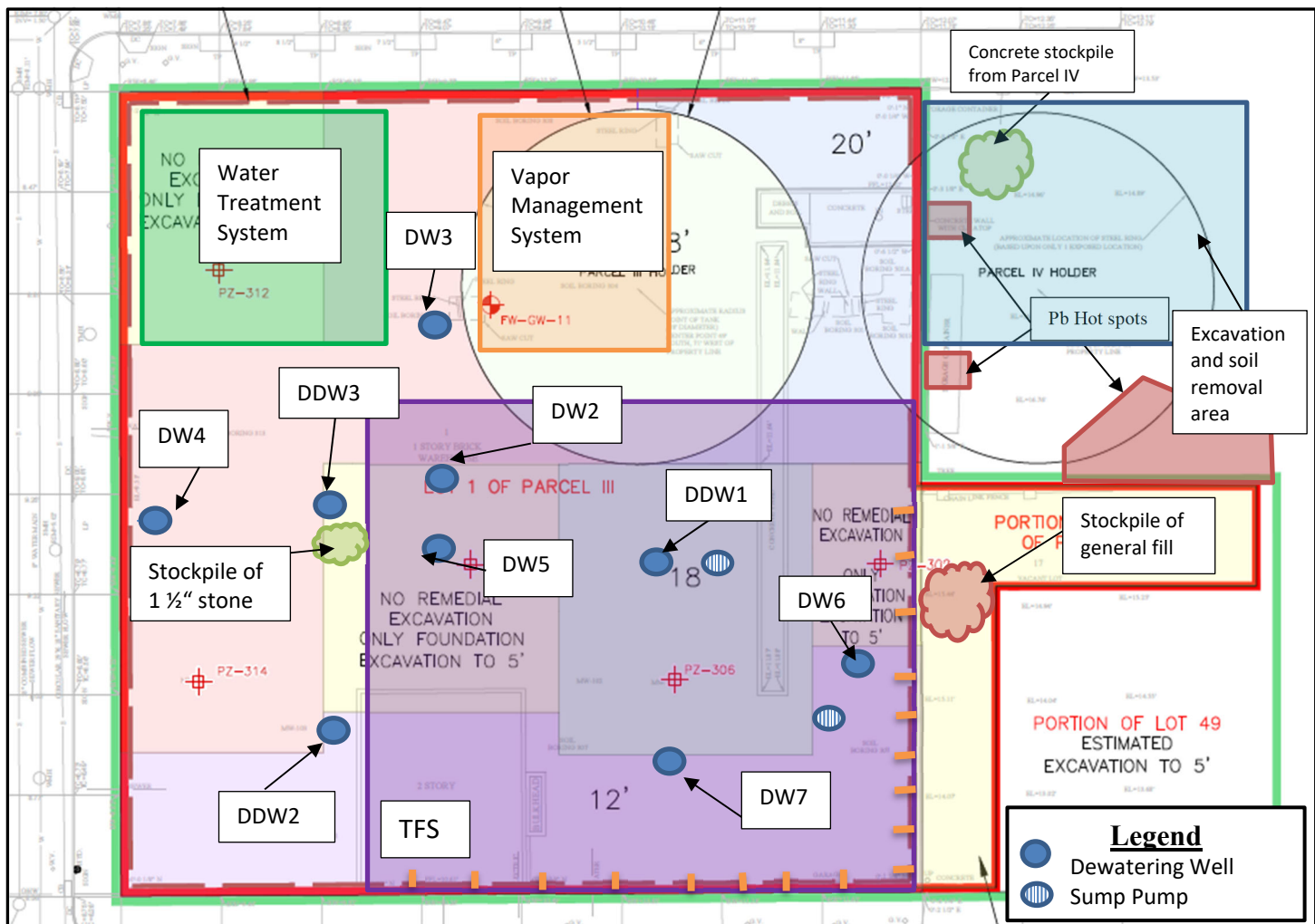

PROJECT:	Former Fulton MGP – Parcels III and IV (Site No.: 224051)
ADDRESS:	545 Sackett St., Brooklyn, NY
PREPARED BY:	Roux Environmental Engineering and Geology, D.P.C.
DATE:	April 24, 2023
WEATHER:	Temp: 48 – 60°F Sunny, RH: 61% Pressure: 30.05" Hg Wind: NW @ 4 mph
TIME:	07:00 – 15:30

Excavation Diagram

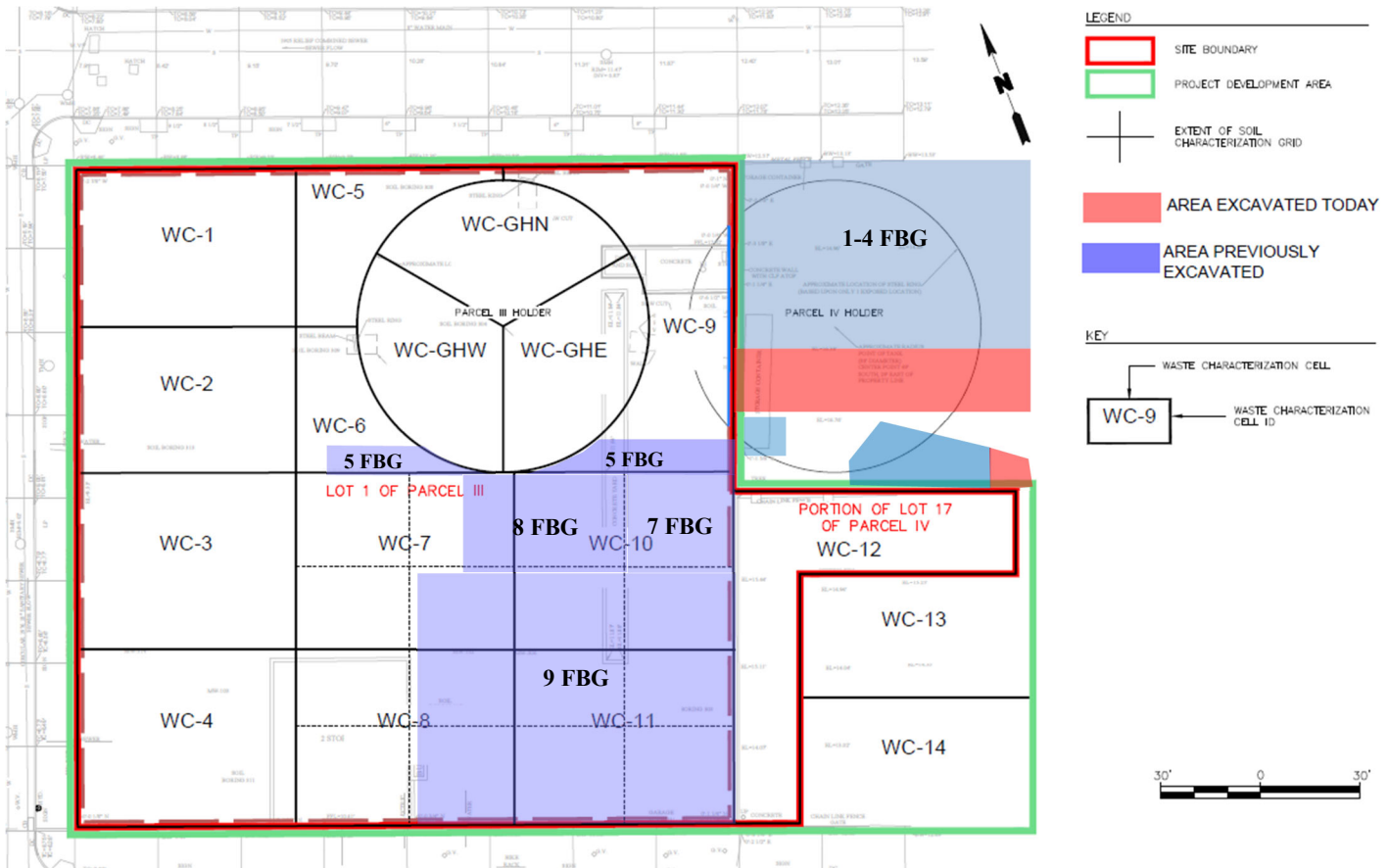

PROJECT:	Former Fulton MGP – Parcels III and IV (Site No.: 224051)
ADDRESS:	545 Sackett St., Brooklyn, NY
PREPARED BY:	Roux Environmental Engineering and Geology, D.P.C.
DATE:	April 24, 2023
WEATHER:	Temp: 48 – 60°F Sunny, RH: 61% Pressure: 30.05" Hg Wind: NW @ 4 mph
TIME:	07:00 – 15:30

Photographs of Onsite Work



Photo 1:

CEI loading material from waste characterization grid WC-GH4-1(0-5) from Parcel IV, for disposal to Clean Earth of New Castle facility.



Photo 2:

Sentinel groundwater monitoring well SW-03D installed by ADT along Degraw Street.