

<b>PROJECT:</b>	Former Fulton MGP – Parcels III and IV (Site No.: 224051)
<b>ADDRESS:</b>	545 Sackett St., Brooklyn, NY
<b>PREPARED BY:</b>	Roux Environmental Engineering and Geology, D.P.C.
<b>DATE:</b>	March 13, 2023
<b>WEATHER:</b>	Temp: 34 - 44°F Overcast, RH: 92% Pressure: 29.94" Hg Wind: E @ 7 mph
<b>TIME:</b>	07:00 – 15:30

### Project Team

#### *General Contractor and Subcontractors:*

- Mega Contracting Group, LLC
- Creamer Environmental, Inc. (CEI)
- Aarco Environmental Services Inc (Aarco)

#### *Engineers and Consultants:*

- Roux Environmental Engineering and Geology, D.P.C. (Roux)
- GZA GeoEnvironmental. Inc.

### Remedial Action Work Summary

#### Work Activities Performed Onsite:

- Pre-trenching prior to installation of support of excavation (SOE), along the east and north side of the former Gas Holder 4.
- Waste characterization and lead delineation sampling on Parcel IV (Lot 17)

#### Contractor Work Performed Onsite:

Creamer Environmental, Inc (CEI) began pre-trenching along the east side of the proposed cofferdam of former Gas Holder 4. The former concrete building slab was removed and stockpiled for future disposal. CEI excavated 47 linear feet along the east side of Gas Holder 4, removing and stockpiling obstructions encountered where future SOE sheeting installation is to occur. Excavated soil was placed back to the pre-trench excavation area and all exposed soil was covered with plastic sheeting at the end of the day. Measures to control dust (wetting, tarping, limiting vehicle speeds, etc.) and vapor/ odor suppression (foam) were implemented as needed. No work was conducted inside the tension fabric structure (TFS). The vapor managements system (VMS) was not operated during today's work.

Roux and Aarco completed waste characterization and lead delineation sampling on Parcel IV. Eight (8) soil borings to seven (7) feet below grade were completed to vertically and horizontally delineate hazardous levels of lead towards the southeast of former Gas Holder 4. Three (3) soil borings were completed to 20 feet below grade to analyze soil for tin and boron to meet disposal facility requirements for three of the waste characterization grids on Parcel IV.

#### Air Monitoring:

- No community air monitoring program (CAMP) exceedances were observed during the day.
- GZA GeoEnvironmental. Inc. will provide a summary report for CAMP activities.

#### Erosion and Sediment Control

- Erosion and sediment controls were inspected to ensure that silt fence and filter sock were undamaged and operational.

#### Sampling Conducted:

- 32 soil samples for lead delineation on Parcel IV around soil boring WC-15-08a to be analyzed for TCLP and total lead:
  - WC-15-08a\_N3 (1-2) [submitted to the laboratory on hold]
  - WC-15-08a\_N3 (2-3)
  - WC-15-08a\_N3 (3-5)[submitted to the laboratory on hold]
  - WC-15-08a\_N3 (5-7) [submitted to the laboratory on hold]
  - WC-15-08a\_N4 (1-2) [submitted to the laboratory on hold]
  - WC-15-08a\_N4 (2-3) [submitted to the laboratory on hold]
  - WC-15-08a\_N4 (3-5) [submitted to the laboratory on hold]
  - WC-15-08a\_N4 (5-7) [submitted to the laboratory on hold]

<b>PROJECT:</b>	Former Fulton MGP – Parcels III and IV (Site No.: 224051)
<b>ADDRESS:</b>	545 Sackett St., Brooklyn, NY
<b>PREPARED BY:</b>	Roux Environmental Engineering and Geology, D.P.C.
<b>DATE:</b>	March 13, 2023
<b>WEATHER:</b>	Temp: 34 - 44°F Overcast, RH: 92% Pressure: 29.94" Hg Wind: E @ 7 mph
<b>TIME:</b>	07:00 – 15:30

- WC-15-08a\_N5 (1-2) [submitted to the laboratory on hold]
- WC-15-08a\_N5 (2-3) [submitted to the laboratory on hold]
- WC-15-08a\_N5 (3-5) [submitted to the laboratory on hold]
- WC-15-08a\_N5 (5-7) [submitted to the laboratory on hold]
- WC-15-08a\_N6 (1-2) [submitted to the laboratory on hold]
- WC-15-08a\_N6 (2-3) [submitted to the laboratory on hold]
- WC-15-08a\_N6 (3-5) [submitted to the laboratory on hold]
- WC-15-08a\_N6 (5-7) [submitted to the laboratory on hold]
- WC-15-08a\_NW1 (1-2) [submitted to the laboratory on hold]
- WC-15-08a\_NW1 (2-3)
- WC-15-08a\_NW1 (3-5)[submitted to the laboratory on hold]
- WC-15-08a\_NW1 (5-7) [submitted to the laboratory on hold]
- WC-15-08a\_NW2 (1-2) [submitted to the laboratory on hold]
- WC-15-08a\_NW2 (2-3) [submitted to the laboratory on hold]
- WC-15-08a\_NW2 (3-5) [submitted to the laboratory on hold]
- WC-15-08a\_NW2 (5-7) [submitted to the laboratory on hold]
- WC-15-08a\_NW3 (1-2) [submitted to the laboratory on hold]
- WC-15-08a\_NW3 (2-3) [submitted to the laboratory on hold]
- WC-15-08a\_NW3 (3-5) [submitted to the laboratory on hold]
- WC-15-08a\_NW3 (5-7) [submitted to the laboratory on hold]
- WC-15-08a\_NW4 (1-2) [submitted to the laboratory on hold]
- WC-15-08a\_NW4 (2-3) [submitted to the laboratory on hold]
- WC-15-08a\_NW4 (3-5) [submitted to the laboratory on hold]
- WC-15-08a\_NW4 (5-7) [submitted to the laboratory on hold]

- 12 waste characterization samples from grids WC-GH4-1, WC-GH-2 and WC-15 to be analyzed for tin and boron:
  - WC-GH4-1 Sn, B (0-5)
  - WC-GH4-1 Sn, B (5-10)
  - WC-GH4-1 Sn, B (10-15)
  - WC-GH4-1 Sn, B (15-20)
  - WC-GH4-2 Sn, B (0-5)
  - WC-GH4-2 Sn, B (5-10)
  - WC-GH4-2 Sn, B (10-15)
  - WC-GH4-2 Sn, B (15-20)
  - WC-15 Sn, B (0-5)
  - WC-15 Sn, B (5-10)
  - WC-15 Sn, B (10-15)
  - WC-15 Sn, B (15-20)

Other Items of Note:

- None

<b>PROJECT:</b>	Former Fulton MGP – Parcels III and IV (Site No.: 224051)
<b>ADDRESS:</b>	545 Sackett St., Brooklyn, NY
<b>PREPARED BY:</b>	Roux Environmental Engineering and Geology, D.P.C.
<b>DATE:</b>	March 13, 2023
<b>WEATHER:</b>	Temp: 34 - 44°F Overcast, RH: 92% Pressure: 29.94" Hg Wind: E @ 7 mph
<b>TIME:</b>	07:00 – 15:30

**Imported Material**

Name - Location	Source	During This Reporting Period		Total	
		Loads	Tons	Loads	Tons
Vulcan ASTM #3 (1 ½" Stone)	Vulcan Hamburg Quarry		26.03	7	179.3
Vulcan General Fill	Vulcan Wantage Quarry		231.12	95	2417.38

**Exported Material**

Material	Facility	During This Reporting Period		Total	
		Loads	Tons	Loads	Tons
Concrete for Recycling	Bayshore			20	421.87
Concrete for Landfill	WM Fairless			37	~872.59
TCE Impacted Haz Hot Spot	CWM Emelle			7	161.72
Cd Impacted Haz Material from WC-5	CWM Emelle			3	49.45
Cd Impacted Haz Material from WC-5	Clean Earth NJ			16	397.75
Non-Haz Contaminated Urban Fill	WM Fairless			99	~2,090
MGP soil with TCE>25 ppm	Clean Earth ESMI			112	~2,472

**Truck Log**

Number	Excavation Grid	Disposal Facility	Disposal Profile	Manifest Number	Trucking Company	Truck License Plate

**Dewatering**

Time	Totalizer Volume (gallons)*
7:11 AM	2,364,306
15:01 PM	2,364,306
Water treated and discharged since last report:	0 gallons

**Anticipated Upcoming Work Activities**

Pre-trenching around former Gas Holder IV to remove obstructions before installing steel sheeting for support of excavation

<b>PROJECT:</b>	Former Fulton MGP – Parcels III and IV (Site No.: 224051)
<b>ADDRESS:</b>	545 Sackett St., Brooklyn, NY
<b>PREPARED BY:</b>	Roux Environmental Engineering and Geology, D.P.C.
<b>DATE:</b>	March 13, 2023
<b>WEATHER:</b>	Temp: 34 - 44°F Overcast, RH: 92% Pressure: 29.94" Hg Wind: E @ 7 mph
<b>TIME:</b>	07:00 – 15:30

### Site Layout

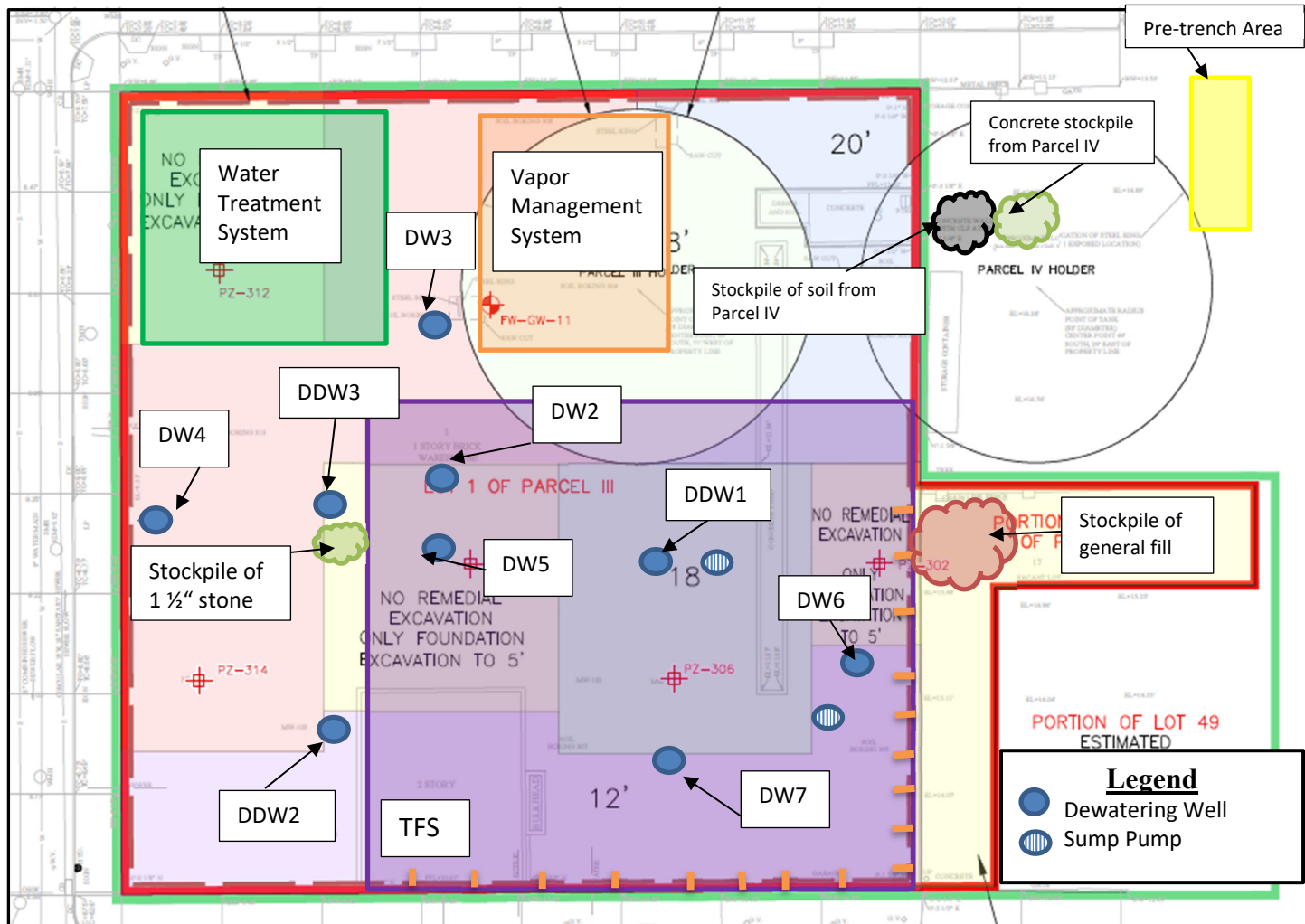

<b>PROJECT:</b>	Former Fulton MGP – Parcels III and IV (Site No.: 224051)
<b>ADDRESS:</b>	545 Sackett St., Brooklyn, NY
<b>PREPARED BY:</b>	Roux Environmental Engineering and Geology, D.P.C.
<b>DATE:</b>	March 13, 2023
<b>WEATHER:</b>	Temp: 34 - 44°F Overcast, RH: 92% Pressure: 29.94" Hg Wind: E @ 7 mph
<b>TIME:</b>	07:00 – 15:30

### Excavation Diagram

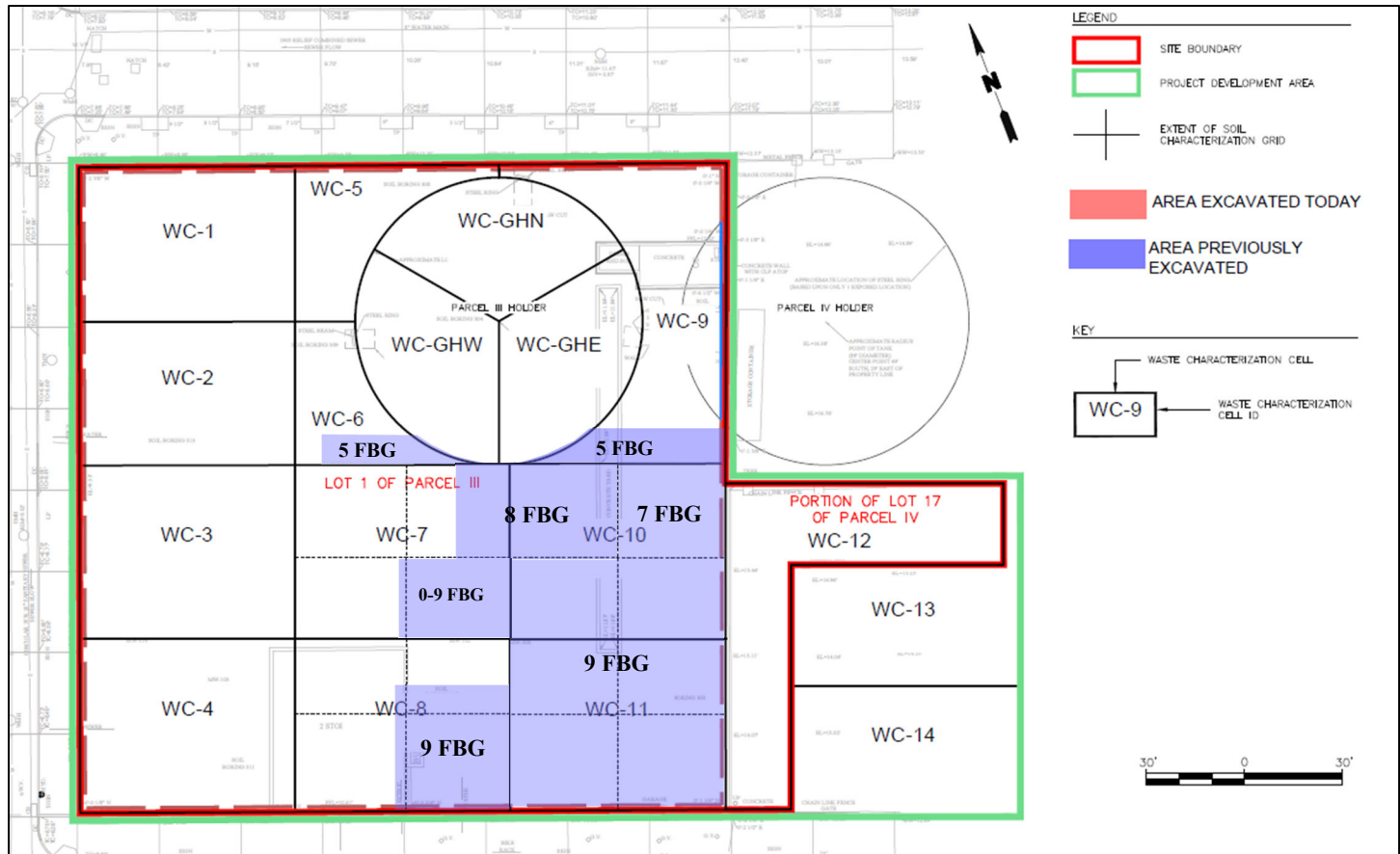

<b>PROJECT:</b>	Former Fulton MGP – Parcels III and IV (Site No.: 224051)
<b>ADDRESS:</b>	545 Sackett St., Brooklyn, NY
<b>PREPARED BY:</b>	Roux Environmental Engineering and Geology, D.P.C.
<b>DATE:</b>	March 13, 2023
<b>WEATHER:</b>	Temp: 34 - 44°F Overcast, RH: 92% Pressure: 29.94" Hg Wind: E @ 7 mph
<b>TIME:</b>	07:00 – 15:30

**Photographs of Onsite Work**



**Photo 1:**

CEI pre-trenching along the east side of Gas Holder 4. Odor suppression foam was applied on stockpiled material.



**Photo 2:**

Aarco completed soil borings to collect soil samples which will be analyzed lead, tin and/or boron.