

PROJECT:	Former Fulton MGP – Parcels III and IV (Site No.: 224051)
ADDRESS:	545 Sackett St., Brooklyn, NY
PREPARED BY:	Roux Environmental Engineering and Geology, D.P.C.
DATE:	February 28, 2023
WEATHER:	Temp: 34-39°F, Snow (AM)/Overcast (PM), RH: 97% Pressure: 29.66" Hg Wind: NE @ 11 mph
TIME:	07:00 – 15:30

Project Team

General Contractor and Subcontractors:

- Mega Contracting Group, LLC
- Creamer Environmental, Inc. (CEI)

Engineers/Consultants

- Roux Environmental Engineering and Geology, D.P.C.
- GZA GeoEnvironmental, Inc.

Remedial Action Work Summary

Work Activities Performed Onsite:

- Loaded out material for disposal to Waste Management Fairless and Clean Earth ESMI, from WC-11(8-10') and WC-10(0-5'), respectively;
- Excavated and stockpiled of soil from waste characterization Grids WC-7 (0-5)' for future soil disposal to Clean Earth ESMI;
- Continued dewatering and pumping test from dewatering wells DW5 and DW7.

Contractor Work Performed Onsite:

Creamer Environmental, Inc (CEI) loaded out eight (8) trucks of material from inside the TFS. Seven (7) loads of manufactured gas plant impacted soil with trichloroethylene > 25 ppm from waste characterization grid WC-10(0-5'), approximately 154 tons, were sent to Clean Earth ESMI. An additional load, approximately 22 tons, of non-hazardous urban fill, from waste characterization grid WC-11(8-10') was sent to Waste Management Fairless. All transport trucks were cleaned and inspected before leaving the site to ensure no fill material was tracked off-site.

CEI excavated and stockpiled material from waste characterization grid WC-7(0-5)' for future soil disposal to Clean Earth ESMI. CEI operated the vapor management system (VMS) while work was conducted inside the TFS. Dust control measures (wetting, tarping, limiting vehicle speeds, etc.) were conducted, as needed.

CEI continued dewatering and the pumping test from dewatering wells DW5 and DW7. All recovered water was sent to the water treatment system (WTS) for processing and discharge to the New York City combined sewer system. Since the last report, approximately 91,415 gallons of treated water was discharged.

Air Monitoring:

- No community air monitoring program (CAMP) exceedances were observed during the day.
- GZA GeoEnvironmental, Inc. will provide a summary report for CAMP activities.

Erosion and Sediment Control

- Erosion and sediment controls were inspected to ensure that silt fence and filter sock were undamaged and operational.

Sampling Conducted:

- None.

Other Items of Note:

- None.

PROJECT:	Former Fulton MGP – Parcels III and IV (Site No.: 224051)
ADDRESS:	545 Sackett St., Brooklyn, NY
PREPARED BY:	Roux Environmental Engineering and Geology, D.P.C.
DATE:	February 28, 2023
WEATHER:	Temp: 34-39°F, Snow (AM)/Overcast (PM), RH: 97% Pressure: 29.66" Hg Wind: NE @ 11 mph
TIME:	07:00 – 15:30

Imported Material

Name - Location	Source	During This Reporting Period		Total	
		Loads	Tons	Loads	Tons
Vulcan ASTM #3 (1 ½" Stone)	Vulcan Hamburg Quarry			5	127.83
Vulcan General Fill	Vulcan Wantage Quarry			71	1,800.42

Exported Material

Material	Facility	During This Reporting Period		Total	
		Loads	Tons	Loads	Tons
Concrete for Recycling	Bayshore			20	421.87
Concrete for Landfill	WM Fairless			37	~872.59
TCE Impacted Haz Hot Spot	CWM Emelle			7	161.72
Cd Impacted Haz Material from WC-5	CWM Emelle			3	49.45
Cd Impacted Haz Material from WC-5	Clean Earth NJ			16	397.75
Non-Haz Contaminated Urban Fill	WM Fairless	1	~22	89	~1,958
MGP soil with TCE>25 ppm	Clean Earth ESMI	7	~154	64	~1,438

Truck Log

Number	Excavation Grid	Disposal Facility	Disposal Profile	Manifest Number	Trucking Company	Truck License Plate
1	WC-10 (0-5)'	ESMI-TCE >25	MGP soil with TCE>25 ppm	BUG000059	V&E	AY259E
2	WC-10 (0-5)'	ESMI-TCE >25	MGP soil with TCE>25 ppm	BUG000060	V&E	AW259D
3	WC-10 (0-5)'	ESMI-TCE >25	MGP soil with TCE>25 ppm	BUG000061	V&E	AY774E
4	WC-10 (0-5)'	ESMI-TCE >25	MGP soil with TCE>25 ppm	BUG000062	V&E	AY260E
5	WC-11 (8-10)	WM Fairless	Non-haz urban fill	12228240	Calderon	AX580L
6	WC-10 (0-5)'	ESMI-TCE >25	MGP soil with TCE>25 ppm	BUG000063	V&E	AW358B
7	WC-10 (0-5)'	ESMI-TCE >25	MGP soil with TCE>25 ppm	BUG000064	V&E	AX709B
8	WC-10 (0-5)'	ESMI-TCE >25	MGP soil with TCE>25 ppm	BUG000065	V&E	AW641V

Dewatering

Time	Totalizer Volume (gallons)*
7:11 AM	547,642
12:40 PM	570,001
14:51 PM	570,010
Water treated and discharged since last report:	91,415 (including 69,047 overnight)

Anticipated Upcoming Work Activities

Soil excavation and export to Clean Earth ESMI and Waste Management Fairless facilities. Dewatering and pumping test will continue.

PROJECT:	Former Fulton MGP – Parcels III and IV (Site No.: 224051)
ADDRESS:	545 Sackett St., Brooklyn, NY
PREPARED BY:	Roux Environmental Engineering and Geology, D.P.C.
DATE:	February 28, 2023
WEATHER:	Temp: 34-39°F, Snow (AM)/Overcast (PM), RH: 97% Pressure: 29.66" Hg Wind: NE @ 11 mph
TIME:	07:00 – 15:30

Site Layout

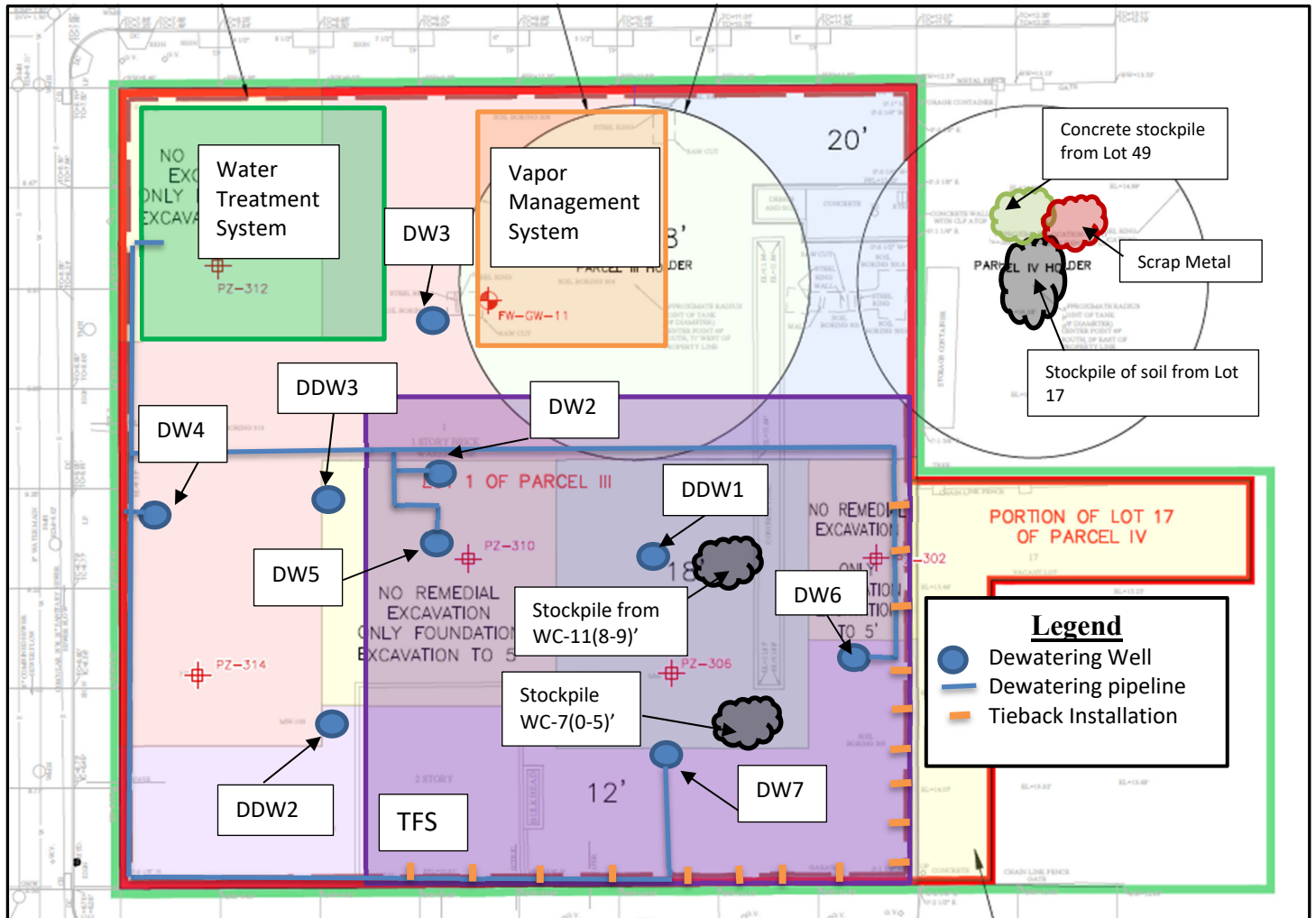

PROJECT:	Former Fulton MGP – Parcels III and IV (Site No.: 224051)
ADDRESS:	545 Sackett St., Brooklyn, NY
PREPARED BY:	Roux Environmental Engineering and Geology, D.P.C.
DATE:	February 28, 2023
WEATHER:	Temp: 34-39°F, Snow (AM)/Overcast (PM), RH: 97% Pressure: 29.66" Hg Wind: NE @ 11 mph
TIME:	07:00 – 15:30

Excavation Diagram

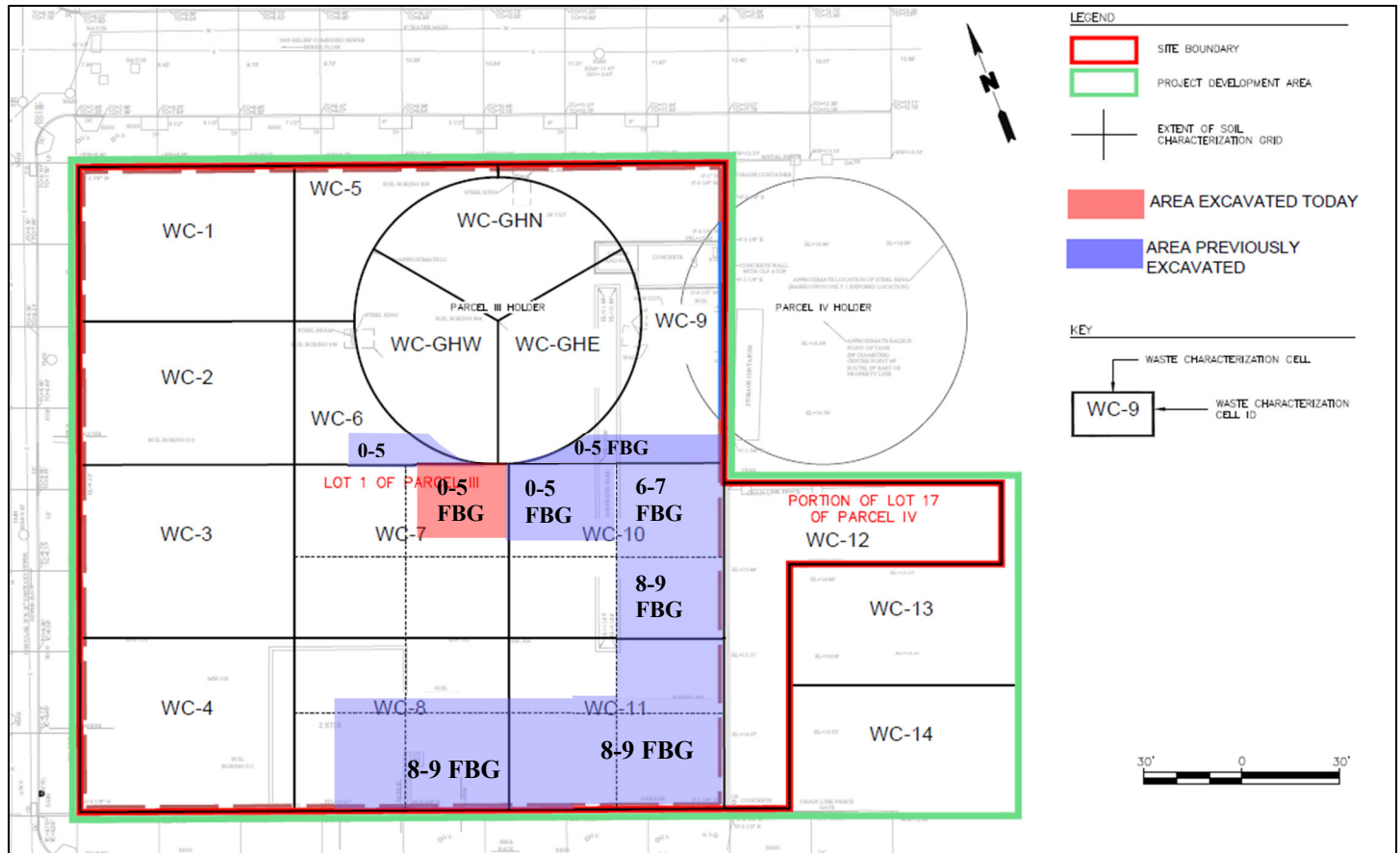

PROJECT:	Former Fulton MGP – Parcels III and IV (Site No.: 224051)
ADDRESS:	545 Sackett St., Brooklyn, NY
PREPARED BY:	Roux Environmental Engineering and Geology, D.P.C.
DATE:	February 28, 2023
WEATHER:	Temp: 34-39°F, Snow (AM)/Overcast (PM), RH: 97% Pressure: 29.66" Hg Wind: NE @ 11 mph
TIME:	07:00 – 15:30

Photographs of Onsite Work



Photo 1:

CEI loading out soil for disposal to Clean Earth ESMI facility.



Photo 2:

CEI excavating and stockpiling soil from waste characterization grid WC-7(0-5') for soil disposal to Clean Earth ESMI facility.