

COUNTY OF SUFFOLK



ROBERT J. GAFFNEY
SUFFOLK COUNTY EXECUTIVE

DEPARTMENT OF HEALTH SERVICES

MARY E. HIBBERD, M.D., M.P.H.
COMMISSIONER

May 20, 1996

CERTIFIED MAIL - R.R.R.
P-570-958-005

Messrs. Vincent or Christopher Marino
2701 Boulder Park Court
Winston Salem, North Carolina 27101

Re: ***Precision Concepts Building***
26 Precision Drive, Shirley, NY

Gentlemen:

As a result of this department's efforts to determine suspect industrial sources of pollution, facility inspections and sampling during the past few months were accomplished in the North Shirley industrial complex.

On April 17, 1996, representatives of this department secured samples from several property leaching systems. In addition, samples were also taken of the visible soil from the obviously breached interior collection pit located adjacent to the building's east wall. Review of the laboratory analyses identified one area of concern that you are being directed to remediate, since you were the previous occupant and property owner.

The following compounds were found at concentrations indicative of unpermitted discharges of industrial waste.

INTERIOR COLLECTION PIT
(VISIBLE SOIL SURROUNDING PIT DUE TO ERODED CONCRETE)

<u>Metal</u>		<u>Organic</u>	
Aluminum	270 ppm	1,1,1-Trichloroethane	72 ppb
Barium	20 ppm	Tetrachloroethene	210 ppb
Beryllium	80 ppm -		
Chromium	200 ppm		
Copper	4,600 ppm -		
Iron	3,000 ppm -		
Lead	320 ppm		
Manganese	10 ppm		
Nickel	50 ppm		
Silver	28 ppm		
Zinc	90 ppm		

Messrs. Vincent or Christopher Marino
May 20, 1996
Page 2

This directive requires the removal of the concrete collection pit so that an adequate soil extraction is accomplished. It is expected that this procedure be completed by July 9, 1996.

Kindly notify this office **three working days** in advance of the scheduled cleanup date so that one of our representatives may be present. If the county is unable to secure **end point** samples, your environmental contractor will be required to obtain them for analysis by a New York State approved laboratory in an effort to determine the adequacy of the remediation.

For a complete and up-to-date listing of licensed scavengers, you should contact the Division of Regulatory Affairs, Waste Transporter Section of the New York State Department of Environmental Conservation at (518)457-3254. The hiring of a cesspool pumping service which is not licensed to haul toxic industrial waste is a violation of state and county law and may subject both you and the non-licensed hauler to civil liability (fines). It is your responsibility to determine if the scavenger is licensed to haul industrial waste. Since this work may require a Federal Industrial Waste Generator's Permit before pumpout is accomplished, you should contact the USEPA, Permit Administration Branch, Region II, Room 432, Jacob K. Javits Federal Building, New York, New York 10278, or by telephone at (212)264-9881 to expedite your request so that the cleanout can be executed within the time frame allotted.

Fees for removal of toxic materials may vary between scavengers; therefore, you may wish to secure written estimates for your cleanout. This, however, is not to be construed that the department will accept delays in this matter.

Failure to comply with the directives set forth in this letter by July 9, 1996 will result in this matter being scheduled for a Formal Administrative Hearing, at which time the department will be seeking the imposition of the maximum penalties of \$500/day for each and every violation of the Suffolk County Sanitary Code including, but not limited to, failure to comply with the directives set forth in this letter. It is in your best interest to implement the remediation process outlined above.

If this department can be of any assistance in this regard, feel free to contact the undersigned at 854-2514.

Sincerely,



D.C. Gobbi, R.S.
Senior Public Health Engineer
Inspection Services Bureau

DCG:lc
Enc.

cc: Robert Seyfarth/SCDHS

COUNTY OF SUFFOLK



PATRICK G. HALPIN
SUFFOLK COUNTY EXECUTIVE

DEPARTMENT OF HEALTH SERVICES

DAVID HARRIS, M.D., M.P.H.
COMMISSIONER

June 15, 1990

Precision Concepts, Inc.
26 Precision Drive
Shirley, New York 11967

Attention: Gerry Ancsanyi

As a result of this department's continued efforts to ensure that existing state and county regulations promulgated to reduce groundwater contamination are being adhered to, sampling of the industrial leaching pool and sanitary system servicing your facility was conducted on May 3, 1990.

Review of the sanitary system laboratory results showed the following metal & organic compounds to be in excess of existing state and county discharge standards and guidelines.

1,1 Dichloroethane	83 ppb
Toluene	330 ppb
Copper	5.8 mg/l
Iron	7.4 mg/l
Chromium	1.1 mg/l
Zinc	13.0 mg/l
Lead	8.5 mg/l
Cadmium	.07 mg/l
Silver	.11 mg/l

Since your firm encountered sanitary system backup last week, this department discussed immediate pump-out and disposal measures with you in an effort to alleviate this problem. One alternative was to receive disposal acceptance at the county operated Bergen Point S.T.P. facility. Approval was granted by their representative, Robert Falk, on June 12, 1990 to have contents of the septic tank and associated leaching pool transported for disposal.

Considering your knowledge of existing governmental regulations concerning unpermitted discharges of industrial waste, this office will not hesitate to schedule an administrative hearing should further infractions be recorded.

Precision Concepts, Inc.
Page 2
June 15, 1990

Feel free to contact the undersigned should you have any questions in this regard.

Very truly yours,



D. C. Gobbi, Senior Public Health Sanitarian
Inspection Services
Environmental Engineering & Pollution Control

DCG:jw

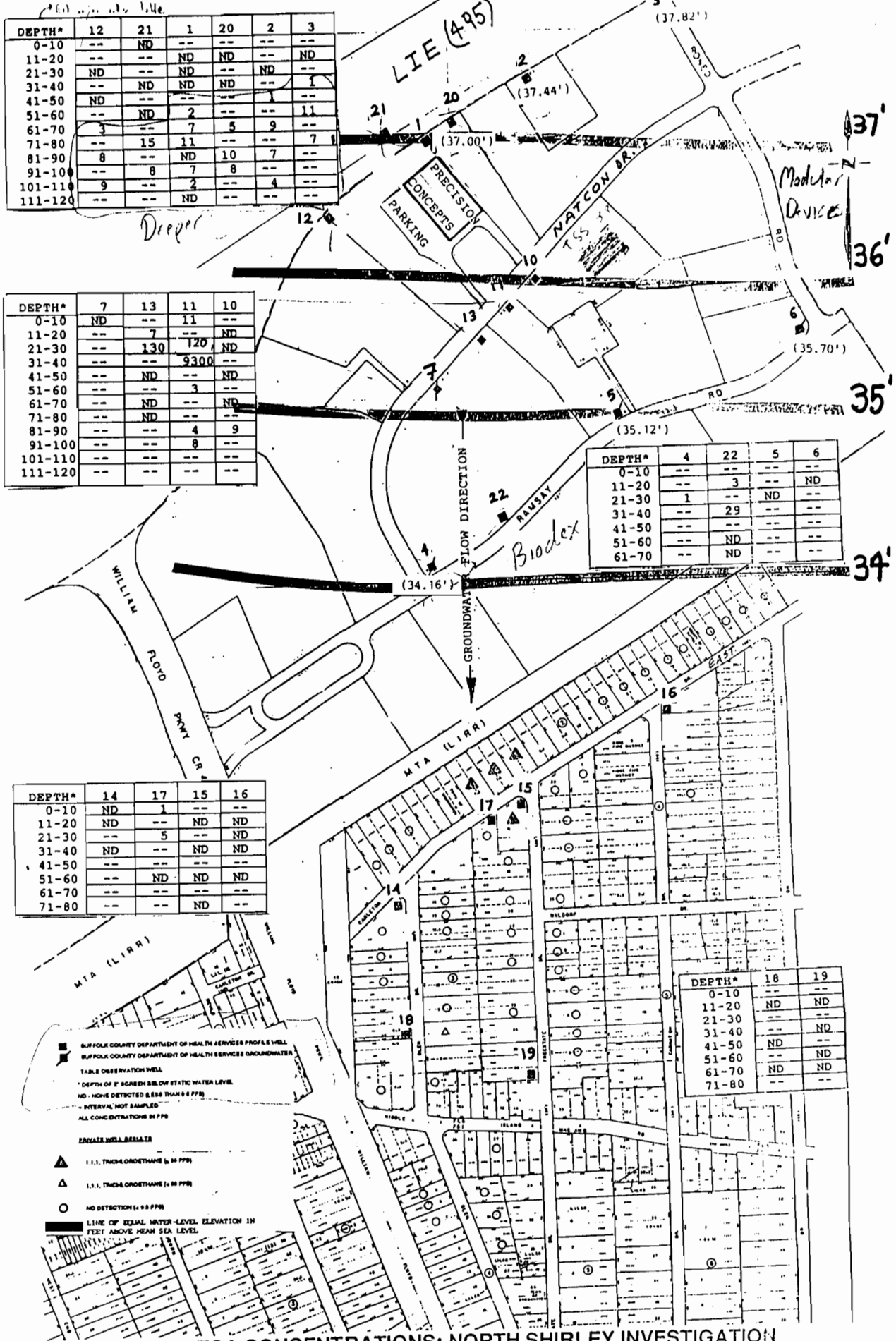

FIG. 1 TCA CONCENTRATIONS: NORTH SHIRLEY INVESTIGATION

Figure 1, 1990 SCDHS Groundwater Monitoring

LONG ISLAND EXPRESSWAY

○ MONITOR WELL proposed

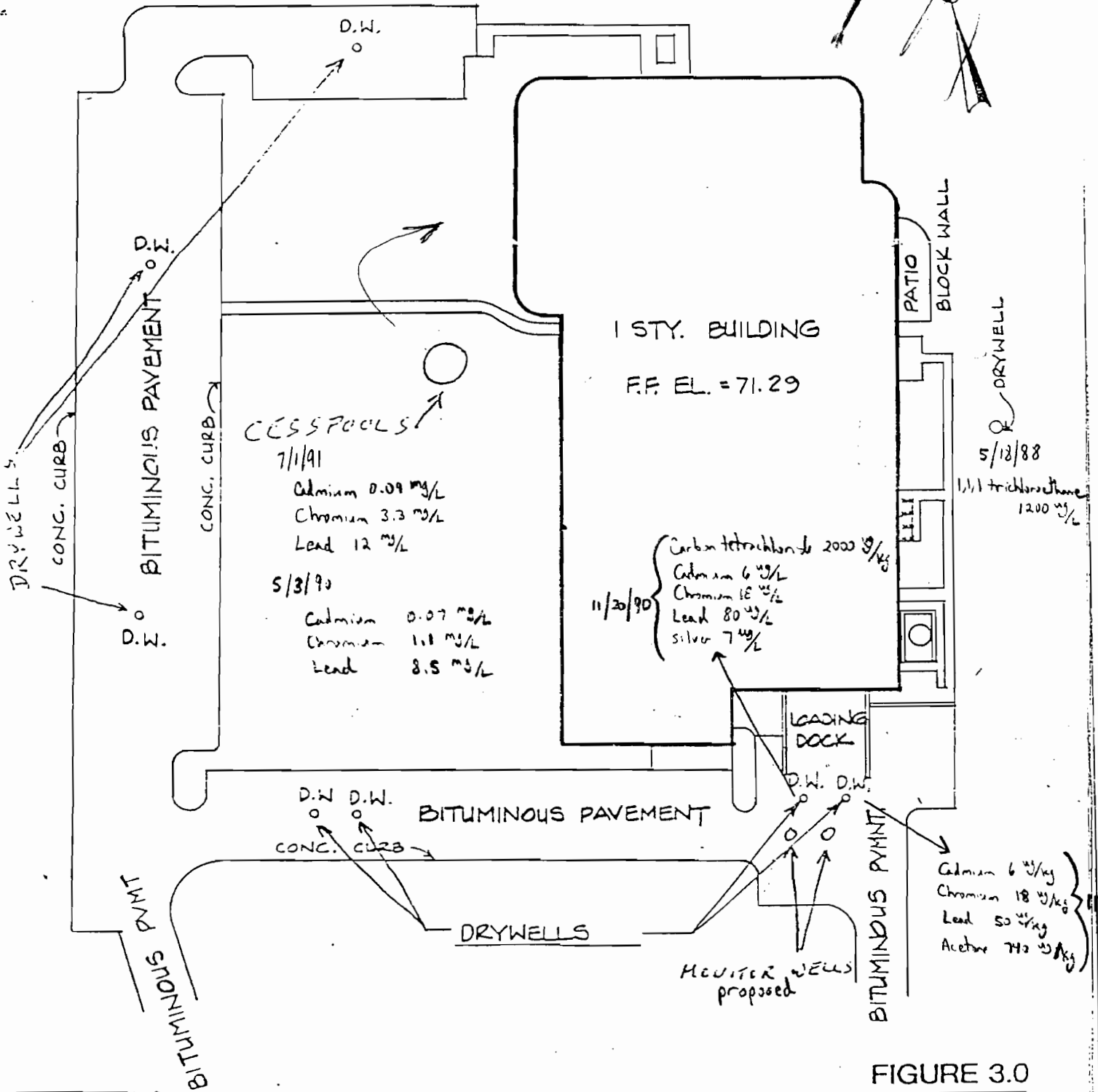

FIGURE 3.0

LOCATION OF DRYWELLS TO BE SAMPLED

LIFE SUPPORT SCIENCES INC.

284 PULASKI ROAD
GREENLAWN, NEW YORK 11740
(516) 540-1900
FAX (516) 540-1917

FYI

BOB

SCDHS Sampling Results

Precision Concepts
26 Precision Dr.
Shirley, NY

Sample Location	Date	Matrix	Results
Main Sanitary System	5/3/90	liquid	11 ppb dichloroethane 83 ppb toluene
	11/16/90	liquid	440 ppb toluene
	7/1/91	liquid	1100 ppb toluene
* Loading Dock Storm Drain (west)	11/16/90	liquid	nothing detected
	11/20/90	sludge	490 ppb chloroform 2000 ppb carbon tetrachloride
	7/1/91	liquid	nothing detected
* Loading Dock Storm Drain (east)	11/20/90	sludge	740 ppb acetone
	7/1/91	liquid	nothing detected
* Drain (east of curb by loading dock)	11/20/90	soil	nothing detected
* Cooling Water Leaching Pool (east of building)	5/3/90	liquid	nothing detected
	5/18/88	liquid	1200 ppb trichloroethane
	11/16/90	liquid	nothing detected

* no remedial measures taken

FAP JUL 31 1991

SUFFOLK COUNTY DEPARTMENT OF HEALTH SERVICES
DIVISION OF MEDICAL-LEGAL INVESTIGATIONS & FORENSIC SCIENCES
PUBLIC & ENVIRONMENTAL HEALTH LABORATORY

SAMPLING ANALYSIS REQUEST/CHAIN OF CUSTODY

Field Number: 1 WP 7-1 Laboratory Number: I W 791 001
 Collected By: Walter T. Petrula Assisted By: Brian Cook
 Affiliation: SCDH Date: 7/1/91 Time: 11:50 am
 Facility/Name: Precision Concepts
 Location: 26 Precision Dr, Shirley
 Point of Collection: Sanitary septic tank w/s of bldg
 Remarks: _____

Analysis Requested (By Department)

Air Pollution

- Volatile Organic Hydrocarbons
- Asbestos (Bulk)

Hazardous Materials (Organics)

- Purgeable Halocarbons 1 (EPA 8240)
- Purgeable Halocarbons 2/ Aromatic Hydrocarbons (EPA 8240)

Level of Detection (EPA 8240 only)
 _____ 40 ppb 4 ppb

Flash Point (EPA 1010)

PCBs

Pesticides
 Specify Type: _____

Other: _____

Industrial Waste (Inorganics)

- Metals (Specify) Preserved
Cr Pb Cd Ni Ag Cu Fe Zn Mn

Chromium (Hexavalent)

E P Toxicity

Phenols

Cyanide Preserved

Chloride, Sulfate

Fluoride

Ammonia, Nitrate, Nitrite

T K N

Solids (SS, DS, TS)

M B A S, C O D

T O C

Oil & Grease

pH Indicate Field pH: 7

Total Number of Sample Containers Submitted (Must Equal No. of Boxes Checked): 02

Custody Section

Relinquished By:

Name Walter T. Petrula Date 7/1/91
 Signature Walter T. Petrula Time 1:30 pm

Received By:

Name _____ Date 7/1/91
 Signature _____ Time 1:30 pm

Name _____ Date _____ Name _____ Date _____
 Signature _____ Time _____ Signature _____ Time _____

Name _____ Date _____ Name _____ Date _____
 Signature _____ Time _____ Signature _____ Time _____

SUFFOLK COUNTY DEPARTMENT OF HEALTH SERVICES
 CENTER FOR FORENSIC SCIENCES
 PUBLIC & ENVIRONMENTAL HEALTH LABORATORY

JUL 31 1991

ORGANIC & FLASHPOINT ANALYSIS OF INDUSTRIAL & HAZARDOUS MATERIALS

Lab. No. IW- 791001
 Field No. 1WP 7-1

Date Completed 7-24-91
 EPA Method 8260/1010/

Name Precision Concepts, Shirley

sanisepic

Remarks 4ppb

Compound	ppb	Compound	ppb
[] <u>Purgeable Halocarbons1</u>			
Chlorodifluoromethane.....	_____	Acetone.....	<50
Dichlorodifluoromethane.....	_____	Methyl ethyl ketone.....	<50
Trichlorofluoromethane.....	_____	Methyl isobutyl ketone.....	<50
Vinyl Chloride.....	_____	Benzene.....	_____
Chloromethane.....	_____	Toluene.....	<u>1100</u>
Bromomethane.....	_____	Chlorobenzene.....	_____
Chloroethane.....	<u>*Note 1</u>	Ethylbenzene.....	_____
[] <u>Purgeable Halocarbons2/Aromatics</u>			
1,1-Dichloroethene.....	_____	Xylene(s).....	_____
Methylene Chloride.....	_____	Styrene.....	_____
Freon 113.....	—	Bromobenzene.....	_____
trans-1,2-Dichloroethene.....	_____	Chlorotoluene(s).....	<10
1,1-Dichloroethane.....	_____	n-Propylbenzene.....	<10
cis-1,2-Dichloroethene.....	_____	p-Ethyltoluene.....	_____
Bromochloromethane.....	—	1,3,5-Trimethylbenzene.....	_____
Chloroform.....	_____	tert-Butylbenzene.....	_____
2,2-Dichloropropane.....	—	1,2,4-Trimethylbenzene.....	_____
1,2-Dichloroethane.....	_____	1,3-Dichlorobenzene.....	_____
1,1,1-Trichloroethane.....	_____	1,4-Dichlorobenzene.....	_____
1,1-Dichloropropene.....	—	sec-Butylbenzene.....	_____
Carbon Tetrachloride.....	_____	p-Isopropyltoluene.....	_____
Dibromomethane.....	—	1,2-Dichlorobenzene.....	_____
1,2-Dichloropropane.....	<20	n-Butylbenzene.....	_____
Bromodichloromethane.....	_____	p-Diethylbenzene.....	_____
Trichloroethene.....	_____	1,2,4,5-Tetramethylbenzene..	_____
cis-1,3-Dichloropropene.....	_____	1,2,4-Trichlorobenzene.....	_____
trans-1,3-Dichloropropene.....	_____	Naphthalene.....	_____
1,1,2-Trichloroethane.....	_____	1,2,3-Trichlorobenzene.....	_____
1,3-Dichloropropane.....	_____	Isopropylbenzene.....	_____
Dibromochloromethane.....	<10	[] <u>Miscellaneous</u>	_____
1,2-Dibromoethane.....	<10	Vinyl acetate.....	_____
Tetrachloroethene.....	_____	2-Chloroethyl vinyl ether...	_____
1,1,1,2-Tetrachloroethane....	<10	Results are <4ppb for Purgeable Halocarbons2/Aromatics except where noted.	_____
Bromoform.....	<20		_____
1,1,2,2-Tetrachloroethane....	_____		_____
1,2,3-Trichloropropane.....	_____		_____
1,2-Dibromo-3-chloropropane..	<40		_____
Hexachlorobutadiene.....	_____		_____

*Note 1 - This compound was detected to be present. Notify Lab for Resample if quantitation is desired.

Analyst gja

[] Flash Point
 Pensky-Martens Closed Cup Flash Point _____ °C= _____ °F

Analyst _____

JUL 31 1991 ✓

SUFFOLK COUNTY DEPARTMENT OF HEALTH
 DIVISION OF MEDICAL LEGAL INVESTIGATION & FORENSIC SCIENCES
 PUBLIC & ENVIRONMENTAL HEALTH LABORATORY

FIELD NO. 1 W P 7-1

LAB NO. 1 W 791 001

DATE COMPLETED 7/12/91

NAME OF FIRM Precision Concepts, Shirley

REMARKS/INSTRUCTIONS

TEST	RESULT	TEST	RESULT MG/L	TEST	RESULT MG/L
pH (Field)		C.O.D.		Nickel	1.2
pH (Lab)		Cyanide		Palladium	<.1
TEST	RESULT	Phenols		Potassium	22.
	MG/LITER	METALS		»Selenium	<.1
Chloride		Aluminum	36.	Silicon	27.
Fluoride		Antimony	<.05	»Silver	<.04
Sulfate		»Arsenic	<.1	Sodium	55.
Sulfite		»Barium	2.	Strontium	<.2
Sulfide		Beryllium	<.02	Thallium	<.05
MBAS		Boron	1.	Tin	<.1
T.O.C.		»Cadmium	.07	Titanium	.2
Nitrate-N		Calcium	70.	Vanadium	<.4
Nitrite-N		»Chromium	3.3	Zinc	15.
Ammonia-N		Cobalt	<.5		
TKN		Copper	13.4	EP Toxicity	(»)
Total P		Iron	16.		
Total Solids		»Lead	12.		
Susp. Solids		Magnesium	11.		
Diss. Solids		Manganese	.3		
Oil & Grease		Molybdenum	<.9		

EP Toxicity includes all metals marked with »

AMP JUL 31 1991

SUFFOLK COUNTY DEPARTMENT OF HEALTH SERVICES
DIVISION OF MEDICAL-LEGAL INVESTIGATIONS & FORENSIC SCIENCES
PUBLIC & ENVIRONMENTAL HEALTH LABORATORY

SAMPLING ANALYSIS REQUEST/CHAIN OF CUSTODY

Field Number: 3WP7-1 Laboratory Number: I W 791 003
Collected By: Walter T. Petruke Assisted By: Brian Cant
Affiliation: SCDHS Date: 7/1/91 Time: 12:15pm
Facility/Name: Precision Concepts
Location: 26 Precision Dr, Shirley
Point of Collection: SD in truck ramp on s/s of bldg; Western most of 2nd train
Remarks: _____

Analysis Requested (By Department)

Air Pollution

- Volatile Organic Hydrocarbons
- Asbestos (Bulk)

Hazardous Materials (Organics)

- Purgeable Halocarbons 1 (EPA 8240)
- Purgeable Halocarbons 2/ Aromatic Hydrocarbons (EPA 8240)

Level of Detection (EPA 8240 only)
_____ 40 ppb 4 ppb

- Flash Point (EPA 1010)
- PCBs
- Pesticides
Specify Type: _____
- Other: _____

Industrial Waste (Inorganics)

- Metals (Specify) Preserved
Cr Pb Cd Ni Ag Cu Fe Zn Mn

- Chromium (Hexavalent)
- E P Toxicity
- Phenols
- Cyanide Preserved
- Chloride, Sulfate
- Fluoride
- Ammonia, Nitrate, Nitrite
- T K N
- Solids (SS, DS, TS)
- M B A S, C O D
- T O C
- Oil & Grease
- pH Indicate Field pH: 7

Total Number of Sample Containers Submitted (Must Equal No. of Boxes Checked): _____

Custody Section

Relinquished By:

Name Walter T. Petruke Date 7/1/91
Signature Walter Petruke Time 1:30pm

Received By:

Name _____ Date 7/1/91
Signature [Signature] Time 1:30pm

Name _____ Date _____ Name _____ Date _____
Signature _____ Time _____ Signature _____ Time _____

Name _____ Date _____ Name _____ Date _____
Signature _____ Time _____ Signature _____ Time _____

JUL 31 1991 OK

SUFFOLK COUNTY DEPARTMENT OF HEALTH
 DIVISION OF MEDICAL LEGAL INVESTIGATIONS & FORENSIC SCIENCES
 PUBLIC & ENVIRONMENTAL HEALTH LABORATORY

FIELD NO. 7917-1

LAB NO. 7917-3

DATE COMPLETED 7/1/91

NAME OF FIRM Provision Corp., Shirley

REMARKS/INSTRUCTIONS

TEST	RESULT	TEST	RESULT MG/L	TEST	RESULT MG/L
pH (Field)		C.O.D.		Nickel	<.1
pH (Lab)		Cyanide		Palladium	<.2
TEST	RESULT	Phenols		Potassium	.6
	MG/LITER	METALS		»Selenium	<.1
Chloride		Aluminum	<.2	Silicon	.7
Fluoride		Antimony	<.05	»Silver	<.02
Sulfate		»Arsenic	<.1	Sodium	3.3
Sulfite		»Barium	<.05	Strontium	<.4
Sulfide		Beryllium	<.01	Thallium	<.25
MBAS		Boron	-	Tin	<.1
T.O.C.		»Cadmium	<.02	Titanium	<.1
Nitrate-N		Calcium	7.2	Vanadium	<.05
Nitrite-N		»Chromium	<.05	Zinc	.1
Ammonia-N		Cobalt	<.05		
TKN		Copper	<.05	EP Toxicity	(»)
Total P		Iron	.7		
Total Solids		»Lead	<.2		
Susp. Solids		Magnesium	.9		
Diss. Solids		Manganese	.04		
Oil & Grease		Molybdenum	<.05		

EP Toxicity includes all metals marked with »

JUL 31 1991

ORGANIC & FLASHPOINT ANALYSIS OF INDUSTRIAL & HAZARDOUS MATERIALS

Lab. No. IW- 791003
 Field No. 3WP 7-1

Date Completed 7-24-91
 EPA Method 8260/1010/

Name Precision Concepts st drain

Remarks 4ppb

Compound	ppb	Compound	ppb
<input type="checkbox"/> <u>Purgeable Halocarbons1</u>			
Chlorodifluoromethane.....		Acetone.....	<u>450</u>
Dichlorodifluoromethane.....		Methyl ethyl ketone.....	<u>450</u>
Trichlorofluoromethane.....		Methyl isobutyl ketone.....	<u>450</u>
Vinyl Chloride.....		Benzene.....	
Chloromethane.....		Toluene.....	
Bromomethane.....		Chlorobenzene.....	
Chloroethane.....		Ethylbenzene.....	
		Xylene(s).....	
<input type="checkbox"/> <u>Purgeable Halocarbons2/Aromatics</u>			
1,1-Dichloroethene.....		Styrene.....	
Methylene Chloride.....		Bromobenzene.....	
Freon 113.....		Chlorotoluene(s).....	<u><10</u>
trans-1,2-Dichloroethene.....		n-Propylbenzene.....	<u><10</u>
1,1-Dichloroethane.....		p-Ethyltoluene.....	
cis-1,2-Dichloroethene.....		1,3,5-Trimethylbenzene.....	
Bromochloromethane.....		tert-Butylbenzene.....	
Chloroform.....		1,2,4-Trimethylbenzene.....	
2,2-Dichloropropane.....		1,3-Dichlorobenzene.....	
1,2-Dichloroethane.....		1,4-Dichlorobenzene.....	
1,1,1-Trichloroethane.....		sec-Butylbenzene.....	
1,1-Dichloropropene.....		p-Isopropyltoluene.....	
Carbon Tetrachloride.....		1,2-Dichlorobenzene.....	
Dibromomethane.....		n-Butylbenzene.....	
1,2-Dichloropropane.....	<u><20</u>	p-Diethylbenzene.....	
Bromodichloromethane.....		1,2,4,5-Tetramethylbenzene..	
Trichloroethene.....		1,2,4-Trichlorobenzene.....	
cis-1,3-Dichloropropene.....		Naphthalene.....	
trans-1,3-Dichloropropene.....		1,2,3-Trichlorobenzene.....	
1,1,2-Trichloroethane.....		<u>Isopropylbenzene</u>	
1,3-Dichloropropane.....		<input type="checkbox"/> <u>Miscellaneous</u>	
Dibromochloromethane.....	<u><10</u>	Vinyl acetate.....	
1,2-Dibromoethane.....	<u><10</u>	2-Chloroethyl vinyl ether..	
Tetrachloroethene.....			
1,1,1,2-Tetrachloroethane.....	<u><10</u>		
Bromoform.....	<u><20</u>		
1,1,2,2-Tetrachloroethane.....			
1,2,3-Trichloropropane.....			
1,2-Dibromo-3-chloropropane..	<u><40</u>		
Hexachlorobutadiene.....			

Results are <4ppb for Purgeable Halocarbons2/Aromatics except where noted.

Analyst aj/a

Flash Point
 Pensky-Martens Closed Cup Flash Point _____ °C = _____ °F

Analyst _____

JUL 31 1991

SUFFOLK COUNTY DEPARTMENT OF HEALTH SERVICES
DIVISION OF MEDICAL-LEGAL INVESTIGATIONS & FORENSIC SCIENCES
PUBLIC & ENVIRONMENTAL HEALTH LABORATORY

SAMPLING ANALYSIS REQUEST/CHAIN OF CUSTODY

Field Number: 2WPT-1 Laboratory Number: I W 791 002
Collected By: Walter T. Petrucci Assisted By: Brian Cook
Affiliation: SCDHS Date: 7/1/91 Time: 12:10 pm
Facility/Name: Precision Concepts
Location: 26 Precision Dr., Shirley
Point of Collection: SD in truck ramp on s/s of bldg. Eastern most of 2 drains
Remarks: _____

Analysis Requested (By Department)

Air Pollution

- Volatile Organic Hydrocarbons
- Asbestos (Bulk)

Hazardous Materials (Organics)

- Purgeable Halocarbons 1 (EPA 8240)
- Purgeable Halocarbons 2/ Aromatic Hydrocarbons (EPA 8240)

Level of Detection (EPA 8240 only)
_____ 40 ppb 4 ppb

- Flash Point (EPA 1010)
- PCBs
- Pesticides
Specify Type: _____
- Other: _____

Industrial Waste (Inorganics)

- Metals (Specify) Preserved
Cr Pb Cd Ni Ag Cu Fe Zn Mn

- Chromium (Hexavalent)
- E P Toxicity
- Phenols
- Cyanide Preserved
- Chloride, Sulfate
- Fluoride
- Ammonia, Nitrate, Nitrite
- T K N
- Solids (SS, DS, TS)
- M B A S, C O D
- T O C
- Oil & Grease
- pH Indicate Field pH: 7

Total Number of Sample Containers Submitted (Must Equal No. of Boxes Checked): 2

Custody Section

Relinquished By:

Name Walter T. Petrucci Date 7/1/91
Signature Walter T. Petrucci Time 1:30 pm

Received By:

Name _____ Date 7/1/91
Signature _____ Time 1:30 pm

Name _____ Date _____ Name _____ Date _____
Signature _____ Time _____ Signature _____ Time _____
Name _____ Date _____ Name _____ Date _____
Signature _____ Time _____ Signature _____ Time _____

APR JUL 3 1 1991 OK

SUFFOLK COUNTY DEPARTMENT OF HEALTH
 DIVISION OF MEDICAL LEGAL INVESTIGATIONS & FORENSIC SCIENCES
 PUBLIC & ENVIRONMENTAL HEALTH LABORATORY

FIELD NO. 2017-1

LAB NO. 300 19 10 R

DATE COMPLETED 7/15/91

NAME OF FIRM Freeport Concepts, Inc. Key

REMARKS/INSTRUCTIONS _____

TEST	RESULT	TEST	RESULT MG/L	TEST	RESULT MG/L
pH (Field)		C.O.D.		Nickel	<.1
pH (Lab)		Cyanide		Palladium	<.2
TEST	RESULT	Phenols		Potassium	.6
	MG/LITER	METALS		»Selenium	<.1
Chloride		Aluminum	<.05	Silicon	.5
Fluoride		Antimony	<.05	»Silver	<.02
Sulfate		»Arsenic	<.1	Sodium	3.7
Sulfite		»Barium	<.05	Strontium	<.1
Sulfide		Beryllium	<.01	Thallium	<.25
MBAS		Boron	-	Tin	<.1
T.O.C.		»Cadmium	<.02	Titanium	<.05
Nitrate-N		Calcium	7.9	Vanadium	<.05
Nitrite-N		»Chromium	<.05	Zinc	.1
Ammonia-N		Cobalt	<.1		
TKN		Copper	.1	EP Toxicity	(»)
Total P		Iron	.17		
Total Solids		»Lead	.2		
Susp. Solids		Magnesium	.6		
Diss. Solids		Manganese	.04		
Oil & Grease		Molybdenum	<.05		

EP Toxicity includes all metals marked with »

JUL 31 1991

ORGANIC & FLASHPOINT ANALYSIS OF INDUSTRIAL & HAZARDOUS MATERIALS

Lab. No. IW- 791002

Date Completed 7-24-91

Field No. 2WP7-1

EPA Method 8260/1010/

Name Precision Concepts std.

Remarks 4ppb

Compound	ppb	Compound	ppb
----------	-----	----------	-----

<input type="checkbox"/> <u>Purgeable Halocarbons1</u>			
Chlorodifluoromethane.....		Acetone.....	<u><50</u>
Dichlorodifluoromethane.....		Methyl ethyl ketone.....	<u><50</u>
Trichlorofluoromethane.....		Methyl isobutyl ketone.....	<u><50</u>
Vinyl Chloride.....		Benzene.....	
Chloromethane.....		Toluene.....	
Bromomethane.....		Chlorobenzene.....	
Chloroethane.....		Ethylbenzene.....	
		Xylene(s).....	
		Styrene.....	
<input type="checkbox"/> <u>Purgeable Halocarbons2/Aromatics</u>			
1,1-Dichloroethene.....		Bromobenzene.....	
Methylene Chloride.....		Chlorotoluene(s).....	<u><10</u>
Freon 113.....	<u>—</u>	n-Propylbenzene.....	<u><10</u>
trans-1,2-Dichloroethene.....		p-Ethyltoluene.....	
1,1-Dichloroethane.....		1,3,5-Trimethylbenzene.....	
cis-1,2-Dichloroethene.....		tert-Butylbenzene.....	
Bromochloromethane.....	<u>—</u>	1,2,4-Trimethylbenzene.....	
Chloroform.....		1,3-Dichlorobenzene.....	
2,2-Dichloropropane.....	<u>—</u>	1,4-Dichlorobenzene.....	
1,2-Dichloroethane.....	<u>—</u>	sec-Butylbenzene.....	
1,1,1-Trichloroethane.....		p-Isopropyltoluene.....	
1,1-Dichloropropene.....	<u>—</u>	1,2-Dichlorobenzene.....	
Carbon Tetrachloride.....		n-Butylbenzene.....	
Dibromomethane.....	<u>—</u>	p-Diethylbenzene.....	
1,2-Dichloropropane.....	<u><20</u>	1,2,4,5-Tetramethylbenzene.....	
Bromodichloromethane.....		1,2,4-Trichlorobenzene.....	
Trichloroethene.....		Naphthalene.....	
cis-1,3-Dichloropropene.....		1,2,3-Trichlorobenzene.....	
trans-1,3-Dichloropropene.....		Isopropyl benzene.....	
1,1,2-Trichloroethane.....			
1,3-Dichloropropane.....		<input type="checkbox"/> <u>Miscellaneous</u>	
Dibromochloromethane.....	<u><10</u>	Vinyl acetate.....	
1,2-Dibromoethane.....	<u><10</u>	2-Chloroethyl vinyl ether...	
Tetrachloroethene.....			
1,1,1,2-Tetrachloroethane.....	<u><10</u>		
Bromoform.....	<u><20</u>		
1,1,2,2-Tetrachloroethane.....			
1,2,3-Trichloropropane.....			
1,2-Dibromo-3-chloropropane..	<u><40</u>		
Hexachlorobutadiene.....			

Results are <4ppb for Purgeable Halocarbons2/Aromatics except where noted.

Analyst Gpa

Flash Point
Pensky-Martens Closed Cup Flash Point _____ °C = _____ °F

Analyst _____

SUFFOLK COUNTY DEPARTMENT OF HEALTH SERVICES
 DIVISION OF MEDICAL-LEGAL INVESTIGATIONS & FORENSIC SCIENCES
 PUBLIC & ENVIRONMENTAL HEALTH LABORATORY *FRP* MAY 18 1990
 SAMPLING ANALYSIS REQUEST/CHAIN OF CUSTODY

Field Number: 2BR5-3 Laboratory Number: I W 590013
 Collected By: B. ROBINSON Assisted By: _____
 Affiliation: SCDHS Date: 3 MAY 90 Time: 3:15P
 Facility/Name: PRECISION CONCEPTS INC.
 Location: 26 PRECISION DR SAIRLEY
 Point of Collection: SANITARY SYSTEM 20'S/20'W N/W COR OF BLG
 Remarks: _____

Analysis Requested (By Department)

Air Pollution

- Volatile Organic Hydrocarbons
- Asbestos (Bulk)

Hazardous Materials (Organics)

- Purgeable Halocarbons 1 (EPA 8240)
- Purgeable Halocarbons 2/ Aromatic Hydrocarbons (EPA 8240)
- Level of Detection (EPA 8240 only)
 40 ppb 4 ppb
- Flash Point (EPA 1010)
- PCBs
- Pesticides
Specify Type: _____
- Other: _____

Industrial Waste (Inorganics)

- Metals (Specify) Preserved
 Cr Pb Cd Ni Ag Cu Fe Zn Mn
- Chromium (Hexavalent)
- E P Toxicity
- Phenols
- Cyanide Preserved
- Chloride, Sulfate
- Fluoride
- Ammonia, Nitrate, Nitrite
- T K N
- Solids (SS, DS, TS)
- M B A S, C O D
- T O C
- Oil & Grease
- pH Indicate Field pH: 6

Total Number of Sample Containers Submitted (Must Equal No. of Boxes Checked): 2

Custody Section

Relinquished By:

Name: B. ROBINSON Date: 3 MAY 90
 Signature: [Signature] Time: 4:15P

Received By:

Name: Scott H. Mitchell Date: 5/13/90
 Signature: [Signature] Time: 4:15

Name _____	Date _____	Name _____	Date _____
Signature _____	Time _____	Signature _____	Time _____
Name _____	Date _____	Name _____	Date _____
Signature _____	Time _____	Signature _____	Time _____

SUFFOLK COUNTY DEPARTMENT OF HEALTH
 DIVISION OF MEDICAL LEGAL INVESTIGATIONS & FORENSIC SCIENCES
 PUBLIC & ENVIRONMENTAL HEALTH LABORATORY

LAB NO. IW- 590013

DATE COMPLETED 5/10/90

FIELD NO. 2BR53

RLC MAY 18 1990 *OC*

NAME Precision Concepts

REMARKS _____

pH.....
mg/L

Chloride.....

Sulfate.....

Nitrate.....

Nitrite.....

Ammonia.....

TKN.....

MBAS.....

TOC (Influent)..

TOC (Effluent)..

COD.....

Total Solids....

Susp. Solids....

Diss. Solids....

Fluoride.....

Cyanide.....

Phenols.....

Oil & Grease....

<input checked="" type="checkbox"/> Metals	mg/L
Copper.....	<u>5.8</u>
Iron.....	<u>7.4</u>
Chromium.....	<u>1.1</u>
Nickel.....	<u>.95</u>
Zinc.....	<u>13.</u>
Lead.....	<u>8.5</u>
Cadmium.....	<u>.07</u>
Silver.....	<u>.11</u>
Manganese.....	<u>.16</u>

Chromium⁺⁶....

EP Toxicity mg/L

Chromium.....

Lead.....

Cadmium.....

Silver.....

Lab. No. / In- 4330-44
 REC'D 5/18/88 By CF
 FIELD NO. 2FR5-15-C

DATE COMPLETED 5-18-88
 ANALYST S. J. Turturieri
 METHOD EPA 8240 / EPA-1010

SUFFOLK COUNTY DEPARTMENT OF HEALTH SERVICES
 DIVISION OF MEDICAL LEGAL INVESTIGATIONS & FORENSIC SCIENCES
 PUBLIC & ENVIRONMENTAL HEALTH LABORATORY

ORGANIC & FLASHPOINT ANALYSIS OF INDUSTRIAL & HAZARDOUS MATERIALS

Name PRECISION CONCEPTS INC.
 Location 16 PRECISION DR SHIRLEY NY
 Point of Collection COOLING H₂O POOL. E/SIDE OF BLDB
 Remarks SEE ALSO METALS

Compound	ppb	Compound	ppb
<input type="checkbox"/> <u>Purgeable Halocarbons 1</u>			
Dichlorodifluoromethane.....		Dibromochloromethane.....	< 40
Chloromethane.....		Tetrachloroethylene.....	< 40
Vinyl Chloride.....		Bromoform.....	< 100
Bromomethane.....		1,1,2,2 Tetrachloroethane.....	< 100
Chloroethane.....		Benzene.....	< 40
Trichlorofluoromethane.....		Toluene.....	< 40
2-Chloroethyl vinyl ether.....		Chlorobenzene.....	< 40
<input type="checkbox"/> <u>Purgeable Halocarbons 2/Aromatics</u>			
1,1 Dichloroethylene.....	< 40	Ethylbenzene.....	< 40
Methylene Chloride.....	< 40	Xylene(s).....	< 40
Freon 113.....	< 200	Styrene.....	< 40
1,1 Dichloroethane.....	< 40	Bromobenzene.....	< 40
cis-1,2 Dichloroethylene.....	< 40	Chlorotoluene(s).....	< 40
Chloroform.....	< 40	p-Ethyltoluene.....	< 40
1,2 Dichloroethane.....	< 40	1,3,5 Trimethylbenzene.....	< 40
1,1,1 Trichloroethane.....	1200	1,2,4 Trimethylbenzene.....	< 40
Carbon Tetrachloride.....	< 40	m-Dichlorobenzene.....	< 40
1,2 Dichloropropane.....	< 40	p-Dichlorobenzene.....	< 40
Bromodichloromethane.....	< 40	o-Dichlorobenzene.....	< 40
1,1,2 Trichloroethylene.....	< 40	p-Diethylbenzene.....	< 40
trans-1,3 Dichloropropene.....	< 40	1,2,4,5 Tetramethylbenzene.....	< 40
cis-1,3 Dichloropropene.....	< 150	1,2,4 Trichlorobenzene.....	< 40
1,1,2 Trichloroethane.....	< 100	1,2,3 Trichlorobenzene.....	< 40

Flash Point
 Pensky-Martens Closed Cup Flash Point _____ °C = _____ °F

During transport of the sample from collection point to laboratory, the chain of custody must not be broken. The sample should be delivered by the sample collector or a designated representative who will sign for the receipt, integrity, and transfer of the sample during shipment.

	Signature	Affiliation	Date	Time
1. Collected by	<u>[Signature]</u>	<u>SCDH5</u>	<u>5/18/88</u>	<u>1:00 PM</u>
2. Transferred to	<u>[Signature]</u>	<u>SCPEHL</u>	<u>5/18/88</u>	<u>2:30 pm</u>
3. Transferred to				
4. Transferred to				

Lab No. 10- 790153
 Field No. ALS-11
 Date 7-12-90
 Time _____
 Col. By Lunagazzo

Rec'd at Lab 7/13/90
 Public Water _____
 Private Well _____
 Other _____
 Exam. By JCF J. BH 7-17-90

SUFFOLK COUNTY
 DEPT OF HEALTH SERVICES

PUBLIC HEALTH LABORATORY
 DIVISION OF MEDICAL LEGAL INVESTIGATIONS & FORENSIC SCIENCES
 TRACE ORGANIC ANALYSIS OF WATER

(26)

Name SCHD

Address 225 RABRO N. Shaley

Sample Tap Kit ___ Bth ___ OT ___ Other Test well 79'

4 Vials ___ 2 Vials ___ Large ___ R. Markel

#	Compound	ppb	#	Compound	ppb
306	vinyl chloride	<u>1</u>	250	benzene	_____
305	methylene chloride	_____	251	toluene	_____
323	1,1 dichloroethane	<u>95</u>	258	chlorobenzene	_____
309	trans 1,2 dichl'ethene	_____	259	ethylbenzene	_____
300	chloroform	_____	254	o-xylene	_____
324	1,2 dichloroethane	_____	252	m-xylene	_____
321	1,1,1 trichloroethane	<u>9300</u>	253	p-xylene	_____
304	carbon tetrachloride	_____	255	total xylene	_____
294	1 bromo 2 chloroethane	_____	266	2-chlorotoluene (o)	_____
405	1,2 dichloropropane	_____	267	m-chlorotoluene	_____
310	trichloroethene	<u>3</u>	268	4-chlorotoluene (p)	_____
303	chlorodibromomethane	_____	265	total chlorotoluene	_____
293	1,2 dibromoethane	_____	419	1,3,5 trimethylbenzene	_____
420	2 bromo 1 chloropropan	_____	418	1,2,4 trimethylbenzene	_____
301	bromoform	_____	415	m,p-dichlorobenzene	_____
311	tetrachloroethene	<u>270</u>	412	1,2 dichlorobenzene (o)	_____
308	cis 1,2 dichloroethene	<u>0.7</u>	432	p-diethylbenzene	_____
320	freon 113	_____	435	1,2,4,5 tetramethylbenzene	_____
292	dibromomethane	_____	437	1,2,4 trichlorobenzene	_____
307	1,1 dichloroethene	<u>430</u>	438	1,2,3 trichlorobenzene	_____
302	bromodichloromethane	_____	600	ethenylbenzene (styrene)	_____
406	2,3 dichloropropene	_____	601	1 methylethylbenzene (cumene)	_____
407	cis dichloropropene	_____	602	n-propylbenzene	_____
408	trans dichloropropene	_____	603	tert-butylbenzene	_____
322	1,1,2 trichloroethane	_____	604	sec-butylbenzene	_____
409	1112 tetrachlo'ethane	_____	605	isopropyltoluene (p-cymene)	_____
295	s-tetrachloroethane	_____	606	n-butylbenzene	_____
433	1,2,3 trichloropropane	_____	607	hexachlorobutadiene	_____
450	2,2 dichloropropane	_____	608	1,2 dibromo 3-chloropropane	_____
451	1,3 dichloropropane	_____			
452	2 chlo'ethylvinylether	_____			

Result for each organic compound listed above is <0.5ppb except where noted.

SUFFOLK COUNTY DEPARTMENT OF HEALTH SERVICES
 DIVISION OF MEDICAL LEGAL INVESTIGATIONS & FORENSIC SCIENCES
 PUBLIC & ENVIRONMENTAL HEALTH LABORATORY

ORGANIC & FLASHPOINT ANALYSIS OF INDUSTRIAL & HAZARDOUS MATERIALS

Lab. No. IW- 590013
 Field No. 2 BR-5-3

Date Completed 5-15-90
 Method EPA 8240/EPA 1010/

Name Precision Concepts

FPC MAY 18 1990 o.c.
SANISYS

Remarks _____

Compound	ppb	Compound	ppb
<input type="checkbox"/> Purgeable Halocarbons 1			
Dichlorodifluoromethane.....	_____	Dibromochloromethane.....	< 40
Chloromethane.....	_____	Tetrachloroethylene.....	< 40
Vinyl Chloride.....	_____	Bromoform.....	< 100
Bromomethane.....	_____	1,1,2,2 Tetrachloroethane....	< 40
Chloroethane.....	_____	Benzene.....	< 40
Trichlorofluoromethane.....	_____	Toluene.....	→ 330 ←
2-Chloroethyl vinyl ether.....	_____	Chlorobenzene.....	< 40
<input type="checkbox"/> Purgeable Halocarbons 2/Aromatics			
1,1 Dichloroethylene.....	< 40	Ethylbenzene.....	< 40
Methylene Chloride.....	< 40	Xylene(s).....	< 40
Freon 113.....	< 100	Styrene.....	< 40
1,1 Dichloroethane.....	→ 83 ←	Bromobenzene.....	< 40
cis-1,2 Dichloroethylene.....	< 40	Chlorotoluene(s).....	< 100
Chloroform.....	< 100	p-Ethyltoluene.....	< 40
1,2 Dichloroethane.....	< 40	1,3,5 Trimethylbenzene.....	< 40
1,1,1 Trichloroethane.....	< 40	1,2,4 Trimethylbenzene.....	< 40
Carbon Tetrachloride.....	< 40	m-Dichlorobenzene.....	< 40
1,2 Dichloropropane.....	< 40	p-Dichlorobenzene.....	< 40
Bromodichloromethane.....	< 40	o-Dichlorobenzene.....	< 40
1,1,2 Trichloroethylene.....	< 40	p-Diethylbenzene.....	< 40
trans-1,3 Dichloropropene.....	< 40	1,2,4,5 Tetramethylbenzene...	< 40
cis-1,3 Dichloropropene.....	< 40	1,2,4 Trichlorobenzene.....	< 40
1,1,2 Trichloroethane.....	< 40	1,2,3 Trichlorobenzene.....	< 40

Analyst SJA

Polychlorinated Biphenyls

PCB 1016.....	_____	PCB 1254.....	_____
PCB 1221.....	_____	PCB 1260.....	_____
PCB 1232.....	_____	PCB 1262.....	_____
PCB 1242.....	_____		
PCB 1248.....	_____		

Analyst _____

Flash Point
 Pensky-Martens Closed Cup Flash Point _____ °C= _____ °F
 Analyst _____

SUFFOLK COUNTY DEPARTMENT OF HEALTH SERVICES
 DIVISION OF MEDICAL LEGAL INVESTIGATIONS & FORENSIC SCIENCES
 PUBLIC & ENVIRONMENTAL HEALTH LABORATORY

ORGANIC & FLASHPOINT ANALYSIS OF INDUSTRIAL & HAZARDOUS MATERIALS

Lab. No. IW- 1190042
 Field No. 2 BR 11-16

Date Completed 12-4-90
 Method EPA 8240/EPA 1010/

Name Precision Concepts DEC 21 1990 Septic tk

Remarks _____

Compound	ppb	Compound	ppb
<input type="checkbox"/> <u>Purgeable Halocarbons 1</u>			
Dichlorodifluoromethane.....		Dibromochloromethane.....	<100
Chloromethane.....		Tetrachloroethylene.....	<40
Vinyl Chloride.....		Bromoform.....	<40
Bromomethane.....		1,1,2,2 Tetrachloroethane....	<100
Chloroethane.....		Benzene.....	
Trichlorofluoromethane.....		Toluene.....	440
2-Chloroethyl vinyl ether.....		Chlorobenzene.....	<40
<input type="checkbox"/> <u>Purgeable Halocarbons 2/Aromatics</u>			
1,1 Dichloroethylene.....	—	Ethylbenzene.....	<40
Methylene Chloride.....	—	Xylene(s).....	<40
Freon 113.....	—	Styrene.....	<40
1,1 Dichloroethane.....	—	Bromobenzene.....	<40
cis-1,2 Dichloroethylene.....	—	Chlorotoluene(s).....	<40
Chloroform.....	—	p-Ethyltoluene.....	<40
1,2 Dichloroethane.....	—	1,3,5 Trimethylbenzene.....	<40
1,1,1 Trichloroethane.....	—	1,2,4 Trimethylbenzene.....	<40
Carbon Tetrachloride.....	—	m-Dichlorobenzene.....	<40
1,2 Dichloropropane.....	<40	p-Dichlorobenzene.....	<40
Bromodichloromethane.....	<40	o-Dichlorobenzene.....	<40
1,1,2 Trichloroethylene.....	<100	p-Diethylbenzene.....	<40
trans-1,3 Dichloropropene.....	<40	1,2,4,5 Tetramethylbenzene...	<40
cis-1,3 Dichloropropene.....	<40	1,2,4 Trichlorobenzene.....	<40
1,1,2 Trichloroethane.....	<100	1,2,3 Trichlorobenzene.....	<40

Analyst Gja

Polychlorinated Biphenyls

PCB 1016.....	PCB 1254.....
PCB 1221.....	PCB 1260.....
PCB 1232.....	PCB 1262.....
PCB 1242.....	
PCB 1248.....	

Analyst _____

Flash Point
 Pensky-Martens Closed Cup Flash Point _____ °C= _____ °F

Analyst _____

Santura
System

SUFFOLK COUNTY DEPARTMENT OF HEALTH
DIVISION OF MEDICAL LEGAL INVESTIGATIONS & FORENSIC SCIENCES
PUBLIC & ENVIRONMENTAL HEALTH LABORATORY

FIELD NO. 22211

LAB NO. 11-16-70

DATE COMPLETED 11/16/70

NAME OF FIRM WATERBURY

REMARKS/INSTRUCTIONS

TEST	RESULT	TEST	RESULT MG/L	TEST	RESULT MG/L
pH (Field)		C.O.D.		Nickel	.2
pH (Lab)		Cyanide		Palladium	<.05
TEST	RESULT	Phenols		Potassium	11.
	MG/LITER	METALS		»Selenium	<.05
Chloride		Aluminum	14.9	Silicon	9.6
Fluoride		Antimony	<.05	»Silver	<.02
Sulfate		»Arsenic	<.2	Sodium	21.
Sulfite		»Barium	.9	Strontium	.3
Sulfide		Beryllium	<.01	Thallium	<.25
MBAS		Boron	-	Tin	<.05
T.O.C.		»Cadmium	<.03	Titanium	<.1
Nitrate-N		Calcium	260.	Vanadium	<.2
Nitrite-N		»Chromium	.3	Zinc	6.7
Ammonia-N		Cobalt	<.2		
TKN		Copper	.48	EP Toxicity	(»)
Total P		Iron	19.		
Total Solids		»Lead	.8		
Susp. Solids		Magnesium	9.9		
Diss. Solids		Manganese	.26		
Oil & Grease		Molybdenum	<.05		

EP Toxicity includes all metals marked with »

SUFFOLK COUNTY DEPARTMENT OF HEALTH SERVICES
 DIVISION OF MEDICAL LEGAL INVESTIGATIONS & FORENSIC SCIENCES
 PUBLIC & ENVIRONMENTAL HEALTH LABORATORY

ORGANIC & FLASHPOINT ANALYSIS OF INDUSTRIAL & HAZARDOUS MATERIALS

Lab. No. IW- 1190045
 Field No. 2 BR 11-20

Date Completed 12-4-90
 Method EPA 8240/EPA 1010/

FHP DEC 21 1990 *OL*
 Judge-St dr.

Name Precision Concepts

Remarks _____

Compound	ppb	Compound	ppb
----------	-----	----------	-----

<input type="checkbox"/> Purgeable Halocarbons 1			
Dichlorodifluoromethane.....		Dibromochloromethane.....	<100
Chloromethane.....		Tetrachloroethylene.....	<40
Vinyl Chloride.....		Bromoform.....	<40
Bromomethane.....		1,1,2,2 Tetrachloroethane....	<100
Chloroethane.....		Benzene.....	<40
Trichlorofluoromethane.....		Toluene.....	<40
2-Chloroethyl vinyl ether.....		Chlorobenzene.....	<40
<input type="checkbox"/> Purgeable Halocarbons 2/Aromatics			
1,1 Dichloroethylene.....	<40	Ethylbenzene.....	<40
Methylene Chloride.....	<40	Xylene(s).....	<40
Freon 113.....	<100	Styrene.....	<40
1,1 Dichloroethane.....	<100	Bromobenzene.....	<40
cis-1,2 Dichloroethylene.....	<40	Chlorotoluene(s).....	<40
Chloroform.....	<40	p-Ethyltoluene.....	<40
1,2 Dichloroethane.....	<40	1,3,5 Trimethylbenzene.....	<40
1,1,1 Trichloroethane.....	<40	1,2,4 Trimethylbenzene.....	<40
Carbon Tetrachloride.....	<40	m-Dichlorobenzene.....	<40
1,2 Dichloropropane.....	<40	p-Dichlorobenzene.....	<40
Bromodichloromethane.....	<40	o-Dichlorobenzene.....	<40
1,1,2 Trichloroethylene.....	<100	p-Diethylbenzene.....	<40
trans-1,3 Dichloropropene.....	<40	1,2,4,5 Tetramethylbenzene...	<40
cis-1,3 Dichloropropene.....	<40	1,2,4 Trichlorobenzene.....	<40
1,1,2 Trichloroethane.....	<100	1,2,3 Trichlorobenzene.....	<40
		Acetone	<u>740</u>

Analyst Jfa

<input type="checkbox"/> Polychlorinated Biphenyls			
PCB 1016.....		PCB 1254.....	
PCB 1221.....		PCB 1260.....	
PCB 1232.....		PCB 1262.....	
PCB 1242.....			
PCB 1248.....			

Analyst _____

Flash Point
 Pensky-Martens Closed Cup Flash Point _____ °C= _____ °F
 Analyst _____

Ston Drain Study

SUFFOLK COUNTY DEPARTMENT OF HEALTH
 DIVISION OF MEDICAL LEGAL INVESTIGATIONS & FORENSIC SCIENCES
 PUBLIC & ENVIRONMENTAL HEALTH LABORATORY

FIELD NO. 1 BRU-20(90)

LAB NO. 1190094

DATE COMPLETED 12/6/90
 DEC 21 1990

NAME OF FIRM Franklin Corp

REMARKS/INSTRUCTIONS (See 1)

TEST	RESULT	TEST	RESULT MG/L	TEST	RESULT MG/L
pH (Field)		C.O.D.		Nickel	<10.
pH (Lab)		Cyanide		Palladium	<5.
TEST	RESULT	Phenols		Potassium	220.
	MG/LITER	METALS	<i>Mg/m/l</i>	»Selenium	<10.
Chloride		Aluminum	190.	Silicon	—
Fluoride		Antimony	<10.	»Silver	<1.
Sulfate		»Arsenic	<20.	Sodium	210.
Sulfite		»Barium	<10.	Strontium	<5.
Sulfide		Beryllium	<1.	Thallium	<25.
MBAS		Boron	5.	Tin	<10.
T.O.C.		»Cadmium	<2.	Titanium	100.
Nitrate-N		Calcium	350.	Vanadium	<5.
Nitrite-N		»Chromium	6.	Zinc	18.
Ammonia-N		Cobalt	<10.		
TKN		Copper	12.	EP Toxicity	(»)
Total P		Iron	2700.		
Total Solids		»Lead	<20.		
Susp. Solids		Magnesium	400.		
Diss. Solids		Manganese	50.		
Oil & Grease		Molybdenum	<5.		

EP Toxicity includes all metals marked with »

STORM DRAIN SLUDGE

SUFFOLK COUNTY DEPARTMENT OF HEALTH
 DIVISION OF MEDICAL LEGAL INVESTIGATIONS & FORENSIC SCIENCES
 PUBLIC & ENVIRONMENTAL HEALTH LABORATORY

FIELD NO. 3BR 11-20(90)

LAB NO. _____

DATE COMPLETED 12/6/90

NAME OF FIRM _____

F/11 DEC 21 1990 o.c. 69

REMARKS/INSTRUCTIONS _____ (So. 1)

TEST	RESULT	TEST	RESULT MG/L	TEST	RESULT MG/L
pH (Field)		C.O.D.		Nickel	160.
pH (Lab)		Cyanide		Palladium	<5.
TEST	RESULT	Phenols		Potassium	210.
	MG/LITER	METALS	<i>ugm/gm</i>	»Selenium	<20.
Chloride		Aluminum	3300.	Silicon	-
Fluoride		Antimony	<10.	»Silver	7.
Sulfate		»Arsenic	<50.	Sodium	160.
Sulfite		»Barium	<20.	Strontium	<10.
Sulfide		Beryllium	<1.	Thallium	<25.
MBAS		Boron	-	Tin	90.
T.O.C.		»Cadmium	6.	Titanium	130.
Nitrate-N		Calcium	4600.	Vanadium	<20.
Nitrite-N		»Chromium	18.	Zinc	<20.
Ammonia-N		Cobalt	<20.		
TKN		Copper	710.	EP Toxicity	(»)
Total P		Iron	8300.		
Total Solids		»Lead	80.		
Susp. Solids		Magnesium	3100		
Diss. Solids		Manganese	61.		
Oil & Grease		Molybdenum	<5.		

EP Toxicity includes all metals marked with »

SUFFOLK COUNTY DEPARTMENT OF HEALTH SERVICES
 DIVISION OF MEDICAL LEGAL INVESTIGATIONS & FORENSIC SCIENCES
 PUBLIC & ENVIRONMENTAL HEALTH LABORATORY

ORGANIC & FLASHPOINT ANALYSIS OF INDUSTRIAL & HAZARDOUS MATERIALS

Lab. No. IW- 1190046
 Field No. 3 BR 11-20

Date Completed 12-4-90
 Method EPA 8240/EPA 1010/

Name Precision Concepts

FJP DEC 21 1990 OL Sledge-SD

Remarks _____

Compound	ppb	Compound	ppb
<input type="checkbox"/> <u>Purgeable Halocarbons 1</u>			
Dichlorodifluoromethane.....		Dibromochloromethane.....	<80
Chloromethane.....		Tetrachloroethylene.....	<80
Vinyl Chloride.....		Bromofom.....	<80
Bromomethane.....		1,1,2,2 Tetrachloroethane....	<80
Chloroethane.....		Benzene.....	<80
Trichlorofluoromethane.....		Toluene.....	<80
2-Chloroethyl vinyl ether.....		Chlorobenzene.....	<80
<input type="checkbox"/> <u>Purgeable Halocarbons 2/Aromatics</u>			
1,1 Dichloroethylene.....	<80	Ethylbenzene.....	<80
Methylene Chloride.....	<80	Xylene(s).....	<80
Freon 113.....	<80	Styrene.....	<80
1,1 Dichloroethane.....	<80	Bromobenzene.....	<80
cis-1,2 Dichloroethylene.....	<80	Chlorotoluene(s).....	<160
Chloroform.....	→ <u>490</u> ←	p-Ethyltoluene.....	<80
1,2 Dichloroethane.....	<80	1,3,5 Trimethylbenzene.....	<80
1,1,1 Trichloroethane.....	<80	1,2,4 Trimethylbenzene.....	<80
Carbon Tetrachloride.....	→ <u>2000</u> ←	m-Dichlorobenzene.....	<80
1,2 Dichloropropane.....	<80	p-Dichlorobenzene.....	<80
Bromodichloromethane.....	<80	o-Dichlorobenzene.....	<80
1,1,2 Trichloroethylene.....	<80	p-Diethylbenzene.....	<80
trans-1,3 Dichloropropene.....	<160	1,2,4,5 Tetramethylbenzene...	<80
cis-1,3 Dichloropropene.....	<80	1,2,4 Trichlorobenzene.....	<80
1,1,2 Trichloroethane.....	<80	1,2,3 Trichlorobenzene.....	<80

Analyst Jfa

Polychlorinated Biphenyls

PCB 1016.....	PCB 1254.....
PCB 1221.....	PCB 1260.....
PCB 1232.....	PCB 1262.....
PCB 1242.....	
PCB 1248.....	

Analyst _____

Flash Point

Pensky-Martens Closed Cup Flash Point _____ °C= _____ °F

Analyst _____

Slow Drain Sludge

SUFFOLK COUNTY DEPARTMENT OF HEALTH
 DIVISION OF MEDICAL LEGAL INVESTIGATIONS & FORENSIC SCIENCES
 PUBLIC & ENVIRONMENTAL HEALTH LABORATORY

FIELD NO. 2 BR 11-20 (9.0)

LAB NO. 75

DATE COMPLETED 12/6/90

HP DEC 21 1990 *oc*

NAME OF FIRM _____

REMARKS/INSTRUCTIONS _____ (Soil)

TEST	RESULT	TEST	RESULT MG/L	TEST	RESULT MG/L
pH (Field)		C.O.D.		Nickel	20.
pH (Lab)		Cyanide		Palladium	<5.
TEST	RESULT	Phenols		Potassium	150.
	MG/LITER	METALS	<i>Mgm/gm</i>	»Selenium	<20.
Chloride		Aluminum	9800.	Silicon	—
Fluoride		Antimony	<20.	»Silver	4.
Sulfate		»Arsenic	<70.	Sodium	160.
Sulfite		»Barium	<20.	Strontium	<5.
Sulfide		Beryllium	<1.	Thallium	<25.
MBAS		Boron	25.	Tin	20.
T.O.C.		»Cadmium	6.	Titanium	60.
Nitrate-N		Calcium	3900.	Vanadium	<20.
Nitrite-N		»Chromium	18.	Zinc	110.
Ammonia-N		Cobalt	<20.		
TKN		Copper	80.	EP Toxicity	(»)
Total P		Iron	4600.		
Total Solids		»Lead	50.		
Susp. Solids		Magnesium	2600.		
Diss. Solids		Manganese	32.		
Oil & Grease		Molybdenum	<5.		

EP Toxicity includes all metals marked with »



F. COHALAN
County Executive

DAVID HARRIS M.D., M.P.H.
Commissioner

SUFFOLK COUNTY
DEPARTMENT OF HEALTH SERVICES

SUFFOLK COUNTY DEPARTMENT OF HEALTH SERVICES

15 Horseblock Place
Farmingville, N.Y. 11738
(516) 451-4633 *854-2502*

TO: MR. VINCENT MARINO - PRES. PRECISION CONCEPTS

MR./MS. BRIAN J ROBINSON

of this Department visited the above named

premises on MON 16 SEP 91 with reference to:

ATTACHED COPY OF LETTER DIRECTING PRECISION CONCEPTS
TO HAVE W-SIDE SANITARY CLEARED OUT BY 13 SEP 91.
PLEASE CALL ME OR MR. D. GOBBI TODAY OR TOMORROW
TO DISCUSS COMPLIANCE OF THIS MATTER

D. ROBINSON

No one answered when we called at _____ Please contact this department at (516) 451-4633 between 8:30 A.M. - 4:30 P.M. Monday through Friday (preferably between 8:30 A.M. and 10:00 A.M.)

Thank you.

18-154: 8/83

ceeded. As a result, it is expected that an immediate evaluation of your waste disposal practices be undertaken to ensure that these overages cease immediately. Violations of the Suffolk County Sanitary Code are subject to the imposition of a civil penalty of up to Five Hundred (\$500) dollars per violation. Environmental Conservation Law violations are also subject to a civil penalty.

Furthermore, due to the nature of this discharge, you are directed to have the liquid and solids pumped from said sanitary system by a licensed cesspool company by September 13, 1991.

Contaminated sanitary the county-operated proval is obtained (516) 852-4107. Ki advance of the cle may be present.

If this department free to contact the

Very truly yours,

D.C. Gobbi

D. C. Gobbi, Senior
Inspection Services
Environmental Engin
DCG: jw
cc: Robert Falk, F

SENDER:

- Complete items 1 and/or 2 for additional services.
- Complete items 3, and 4a & b.
- Print your name and address on the reverse of this form so that we can return this card to you.
- Attach this form to the front of the mailpiece, or on the back if space does not permit.
- Write "Return Receipt Requested" on the mailpiece below the article number.
- The Return Receipt Fee will provide you the signature of the person delivered to and the date of delivery.

I also wish to receive the following services (for an extra fee):

- Addressee's Address
- Restricted Delivery

Consult postmaster for fee.

3. Article Addressed to:

Precision Concepts
26 Precision Drive
Shirley, N. Y. 11967

Att: Mr. Gerry Ancsanyi

Mullie Triolo

5. Signature (Addressee)

6. Signature (Agent)

4a. Article Number

P 102 574 072

4b. Service Type

- | | |
|---|---|
| <input type="checkbox"/> Registered | <input type="checkbox"/> Insured |
| <input checked="" type="checkbox"/> Certified | <input type="checkbox"/> COD |
| <input type="checkbox"/> Express Mail | <input type="checkbox"/> Return Receipt for Merchandise |

7. Date of Delivery

8/26/91

8. Addressee's Address (Only if requested and fee is paid)

COUNTY OF SUFFOLK



PATRICK G. HALPIN
SUFFOLK COUNTY EXECUTIVE

DEPARTMENT OF HEALTH SERVICES

DAVID HARRIS, M.D., M.P.H.
COMMISSIONER

Precision Concepts
26 Precision Drive
Shirley, N.Y. 11967
Att: Gerry Ancsanyi:

August 22, 1991

CERTIFIED R.R.R.
P 102 574 072

On July 1, 1991 samples of industrial waste were taken from the sanitary septic system servicing your facility. Upon analysis, the following metal and organic parameters were found:

Toluene	1100 ppb	51
Aluminum	36.0 mg/l	33
Cadmium	.09 mg/l	10
Chromium	3.3 mg/l	10
Copper	13.4 mg/l	25
Iron	16.0 mg/l	10
Lead	12.0 mg/l	10
Zinc	15.0 mg/l	10

Please be advised that the above results indicate that state and county discharge standards and guidelines continue to be exceeded. As a result, it is expected that an immediate evaluation of your waste disposal practices be undertaken to ensure that these overages cease immediately. Violations of the Suffolk County Sanitary Code are subject to the imposition of a civil penalty of up to Five Hundred (\$500) dollars per violation. Environmental Conservation Law violations are also subject to a civil penalty.

Furthermore, due to the nature of this discharge, you are directed to have the liquid and solids pumped from said sanitary system by a licensed cesspool company by September 13, 1991. Contaminated sanitary waste may be transported and disposed of at the county-operated Bergen Point sewage treatment plant once approval is obtained from its representative, Robert Falk, P.E. (516) 852-4107. Kindly notify this office three working days in advance of the cleanup date so that one of our representatives may be present.

If this department can be of any assistance in this regard, feel free to contact the undersigned.

Very truly yours,

D. C. Gobbi, Senior Public Health Sanitarian
Inspection Services
Environmental Engineering & Pollution Control
DCG:jw
cc: Robert Falk, P.E.

16 SEP 91 - ATTACHED
MESSAGE LEFT TO
MR. MARIN'S SECRETARY
MARY ANN - (HE'S IN TALK)
NOTE - ALL MFRS EXCEPT
MEDICAL DIV HAS
RELOCATED TO
WILSTON - SALEM, NJ
ROBINSON

KARL MAIER
Vice President, Operations

26 PRECISION DRIVE • SHIRLEY, N.Y. 11967
516-924-1000 • TWX: 510-228-2611 • FAX: 516-924-1007

I.D. NO.		VIOLATIONS NOTED	
		YES <input checked="" type="checkbox"/> NO <input type="checkbox"/>	
OWNER/OFFICER		CONTACT	
VINCENT MARINO - PRES		KARL MAIER - VP GERRY A. KESAVYI	
ADDRESS		TOWN	
SHIRLEY		BROOKHAVEN	
ZIP		11967	
INSP.	HYDRO.	MAP COORD.	
	III	M-22	

MAILING ADDRESS		PROPERTY OWNER	
SAYVIC		VINCENT MARINO	
DATE	TIME	ORIG	RE. SAMPLE
30 NOV 87	2:00 P	PER	
INDUSTRY		SPOES OR NPOES PERMIT	
ELECTRONIC PARTS MFR		YES <input type="checkbox"/> NO <input checked="" type="checkbox"/> PERMIT NO.	
HEATING SYSTEM - MFG NAME		FUEL TYPE	FIRING RATE
ELECTRIC		NONE	NONE
NUMBER OF DRUMS		NUMBER OF TANKS	
INDOORS 9 OUTDOORS 8		4	
ABOVEGROUND UNDERGROUND		NUMBER OF OPEN PROCESS TANKS	
2		4	
SCAVENGER		PICK UP RECORDS AVAILABLE	VOLUME GENERATED
RESERVED FOR CHEM. WASTE TEL.		YES <input checked="" type="checkbox"/> NO <input type="checkbox"/>	6000 G PM SEP 87

- CESSPOOLS LOCATED ON EAST SIDE AND WEST SIDE OF BUILDING.

- TANK REGISTRATION HAD BEEN FILED WHEN CO WAS LOCATED IN BOHEMIA AND NEW BUILDING IN SHIRLEY WAS UNDER CONSTRUCTION

- PLANS FOR NEW OPERATIONS INCLUDE DISCHARGING NON-CONTACT COOLING - ADVISED THAT THIS MUST BE FILED FOR A PERMIT

- AREAS OF VIOLATIONS (IE, DROM STORAGE, FLOOR DRAINS AND DISCHARGES, EPS) DISCUSSED WITH MR. MAIER AND I STATED I WILL DISCUSS THIS SITUATION TO MY SUPERVISOR IN ORDER TO HAVE THE PROBLEMS RESOLVED.

INDUSTRIAL WASTES MUST NOT BE DISCHARGED TO THE GROUND OR DISPOSED OF IN A DUMPSTER, BUT MAY ONLY BE TRANSPORTED AND DISPOSED OF BY A LICENSED INDUSTRIAL WASTE SCAVENGER FOR AN APPROVED LIST CONTACT THE N.Y.S. D.E.C. AT 751 - 7900

REINSPECTION SCHEDULED ON OR AFTER _____ . FAILURE TO CORRECT UNSATISFACTORY CONDITIONS BY REINSPECTION DATE MAY RESULT IN A HEARING AND OR FINE.

PERMISSION IS GRANTED BY THIS FACILITY TO THE SUFFOLK COUNTY DEPARTMENT OF HEALTH SERVICES TO CONDUCT ROUTINE SAMPLING OF CESSPOOLS, STORMDRAINS, AND OTHER DISCHARGE POINTS AT THE FACILITY.

SIGN. OF PERSON REC. REPORT	TITLE	INSPECTOR
<i>[Signature]</i>	VP OPERATION	J. ROBINSON

NO.	PROCESS	CHEMICALS USED AND APPROXIMATE QUANTITY	DISCHARGE		
			LIQUID	AIR	CONTROL TYPE EP
1	REPAIRS ROOM	NOT OPERATIONAL	NONE	NONE	
2	LB MILL ROOM A. FURNACE B. SOLDERING	NONE - ELECTRIC HEAT EXHAUST VENTS	NONE	NONE	2
3	SM MILL ROOM A. HOT BONDING B. FURNACE	ELECTRIC HEATER HEAT EXHAUST VENTS	NONE	NONE	1
4	DEBURRING ROOM	CONTACT H ₂ O, ACID SOAPS	WASTE H ₂ O	H ₂ O	2
5	WAREHOUSE	PIPED THROUGH EXTERIOR WALL FROM 300-400'S STORAGE TANK IN EXTERIOR CONTAINMENT AREA.	NONE	NONE	
6	CONTAINMENT AREA - BERNEDY COVERED EXTERIOR & OIL	300-400'S - TRICHLOROETHANE STORAGE TANK 10,000'S WASTE HOLDING TANK	NONE	NONE	
7	LOADING DOCK - OUTSIDE	8-55'S DRUMS MARKED WASTE OIL			
8	PRESS ROOM -	29-55'S DRUMS OF USED TRICHLOR STORED ON PALATES			
9	OIL / DEBURRING ROOM - BERNEDY ENCLOSED	8-55'S DRUM DISPENSERS (OIL) 6-55'S UNOPENED OIL DRUMS			
10	FURNACE ROOM (BLUE M FURNACE)	2- DEGREASERS - TRICHLOROETHANE 1- TRICHLOROETHANE CLEANER PARTS HEAT TREATING	H ₂ O	H ₂ O	2



PRECISION CONCEPTS
 26 PRECISION DRIVE
 SHIRLEY
 INSPECTION
 4 MAY 90
 BROBILSON

○
 SANITARY

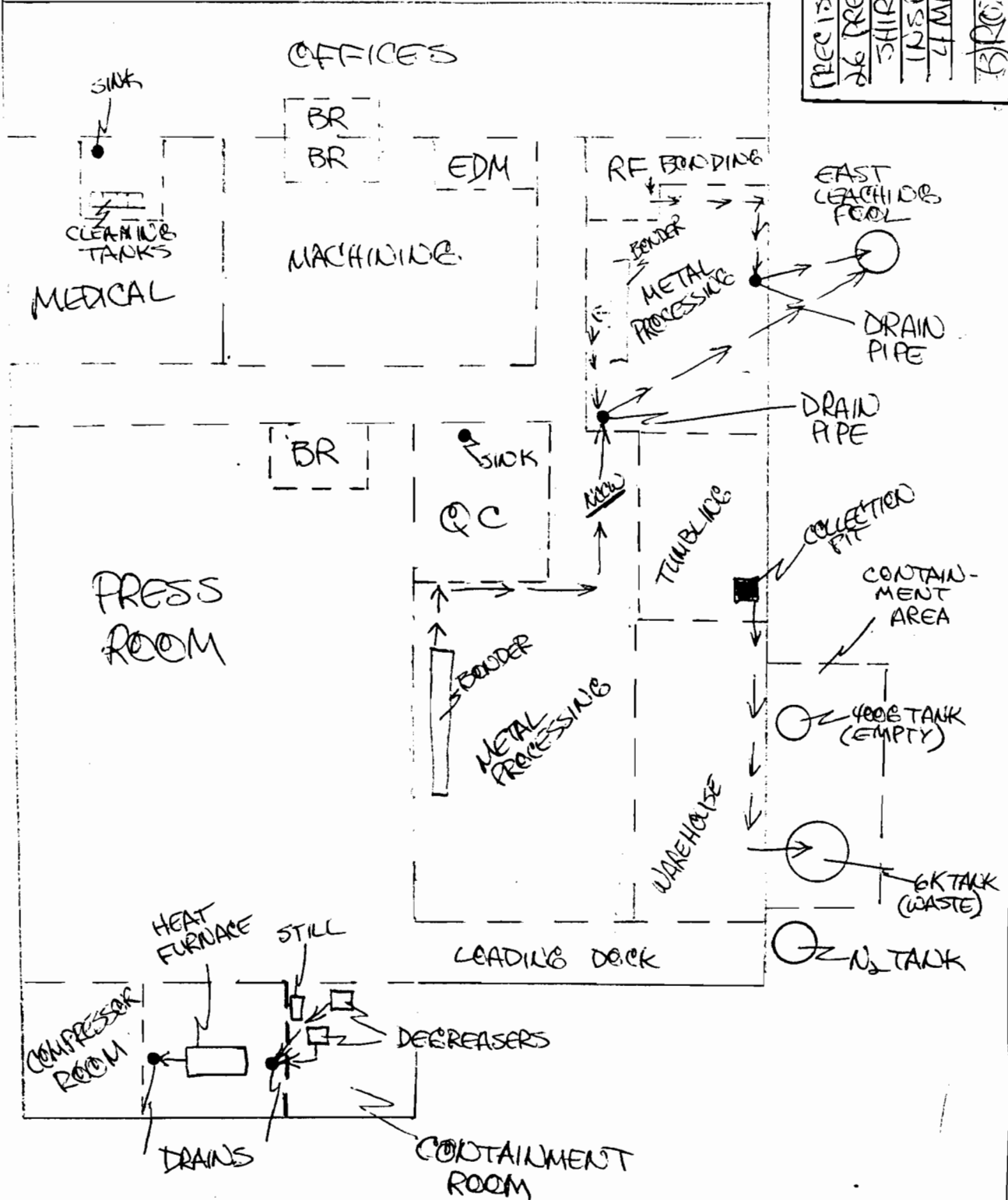

OFFICES
 BR
 BR
 EDM
 RE BONDING
 FENDER
 METAL PROCESSING
 MACHINING
 SINK
 CLEANING TANKS
 MEDICAL

BR
 SINK
 Q/C
 PRESS ROOM
 LEADING DECK
 METAL PROCESSING
 TUMBLING
 WAREHOUSE
 DRAIN PIPE
 DRAIN PIPE

COMPRESSOR ROOM
 HEAT FURNACE
 STILL
 DEGREASERS
 DRAINS
 CONTAINMENT ROOM

EAST LEACHING POOL
 DRAIN PIPE
 DRAIN PIPE
 COLLECTION PIT
 CONTAINMENT AREA
 400G TANK (EMPTY)
 6K TANK (WASTE)
 N₂ TANK

SUFFOLK COUNTY DEPARTMENT OF HEALTH SERVICES
 INDUSTRIAL WASTE AND HAZARDOUS MATERIALS CONTROL
 15 HORSEBLOCK PLACE, FARMINGVILLE, N.Y. 11738
 (516) 451-4633

R182

NAME OF FACILITY PRECISION CONCEPT INC		OWNER / V. MARINO - PRES OFFICER KARL MAIER - V.P.		VIOLATIONS NOTED YES NO	
COMPANY NAME SAME		CONTACT GERRY ANISANYI - MGR TEL. 924 1000			
PLANT ADDRESS 26 PRECISION DR.	VILLAGE SH	TOWN		ZIP 11967	
MAILING ADDRESS SAME	INSR. III	HYDRO. III	MAP COORD. M-2		
PROPERTY OWNER VINCENT MARINO					
DATE 4 MAY 90	TIME 11:30 A	ORIG. PER. RE. SAMPLE	ART. 7 YES NO	ART. 10 NO	ART. 12 NO 20438 H B H
INDUSTRY ELECTRONIC COMPONENT MFR		SPOES OR NPOES PERMIT YES NO PERMIT NO.			
HEATING SYSTEM - MFG NAME ELECTRIC		FUEL TYPE	FIRING RATE	TANK SIZE	
NUMBER OF DRUMS INDOORS 37 OUTDOORS	NUMBER OF TANKS ABOVEGROUND 12 UNDERGROUND	NUMBER OF OPEN PROCESS TANKS 4		SEWAGE SYSTEM PUBLIC PRIVATE	
SCAVENGER CPC / PRIDE SOLVENTS	PICK UP RECORDS AVAILABLE YES NO	VOLUME GENERATED 2			
INSPECTION PERFORMED BY BRIAN PHILLIPS - MAINTENANCE MECHANIC -					
WASTE P/U MANIFESTS PRESENTED AS FOLLOWS					
① 4 APR 90 (CPC) 13 DR TRICHLOR/TUMBLING SCUDGE ② 5 OCT 89 (CPC) 2 DR OILS					
③ 7 JULY 89 (CPC) 3 DR OILS ④ 26 JUNE 89 (PRIDE) 5 DR TRICHLOR					
⑤ 7 JUNE 89 (CPC) 3 DR OILS ⑥ 5 MAY 89 (CPC) 1 DR OILS					
⑦ 8 FEB 89 (PRIDE) 7 DR TRICHLOR					
→ MR. PHILLIPS STATED THAT NCCW THROUGHOUT METAL PROCESSING DISCHARGES TO E-SIDE LEACHING POOL - BUT WAS UNSURE OF OUTFALL FOR NCCW FROM DEGREASERS IN OIL CONTAINMENT ROOM.					
- AUX OTHER RINSE/CONTACT H ₂ O GOES TO TANK #1 WHICH IS CIRCULATED TO EVAPORATOR					
- STILL IN OIL CONTAINMENT ROOM REMAINS TRICHLOR & WASTE TO H&H					
CONT					
INDUSTRIAL WASTES MUST NOT BE DISCHARGED TO THE GROUND OR DISPOSED OF IN A DUMPSTER, BUT MAY ONLY BE TRANSPORTED AND DISPOSED OF BY A LICENSED INDUSTRIAL WASTE SCAVENGER FOR AN APPROVED LIST CONTACT THE N.Y.S. D.E.C. AT 751 - 7900					
REINSPECTION SCHEDULED ON OR AFTER _____ . FAILURE TO CORRECT UNSATISFACTORY CONDITIONS BY REINSPECTION DATE MAY RESULT IN A HEARING AND OR FINE.					
PERMISSION IS GRANTED BY THIS FACILITY TO THE SUFFOLK COUNTY DEPARTMENT OF HEALTH SERVICES TO CONDUCT ROUTINE SAMPLING OF CESSPOOLS, STORMDRAINS, AND OTHER DISCHARGE POINTS AT THE FACILITY.					
SIGN. OF PERSON REC. REPORT		TITLE B. ROBINSON INSPECTOR			

PROCESS	CHEMICALS USED AND APPROXIMATE QUANTITY	DISCHARGE	
		LIQUID	AIR CONTROL TYPE EP
1 OFFICES	FILES, RECORDS, DRAFTING, CAPTHERIA, BRX2	SLURRY	
2 MACHINERY/DIE MAKING	2- EDM MACHINE & A/O FILTER	HFH	
	2- 30 - BRINDERS, DRILL PRESSES (WIRE CR/S)		
	10 - CONTACT PRESSES		
	FINE WIRE WELDERS (ELECTRIC)		
3 METAL PROCESSING	RF BINDER & OVEN & DEGREASER (210G TRICHLOR) & NCCO	HFH/REFPRESS	
	2- HEAT TREATING, SOILDAGES (NCCO)		
	1- HOT BINDER NCCO		
	6- COLD BONDERS, BRUSHERS, CUTTERS		
	1- SOLDER LINE & WASH H2O	HOLDING TANK/HFH	
3 TUMBLING	5- TUMBLERS	HOLDING TANK	
	- BERMEED ROOM		
	- WASTE H2O FROM MEDICAL FROM MEDICAL TUMBLING		
	CRATING, SOLY DER, TANKATOR		
	HELD IN A 1000G TANKATOR		
	PUMPED TO EVAPOR	EVAPORATOR	
	1- 100G EVAPORATOR (10G/HR)	HFH	
	1- WASTE H2O COLLECTION PIT	HOLDING TANK/HFH	
4 WAREHOUSE	2- 55G WASTE SLUDGE	HFH	
	- COILED METAL STORAGE		
	- DISCHARGE DISPENSING VALVE FOR		
	11 TRICHLOROETHANE TACK (A/O)		
5 YARD	- CONTAINMENT AREA		
	1- CYCLONE SYSTEM TANK		
	1- 1000G WASTE HOLDING TACK		

SUFFOLK COUNTY DEPARTMENT OF HEALTH SERVICES
 INDUSTRIAL WASTE AND HAZARDOUS MATERIALS CONTROL
 15 HORSEBLOCK PLACE, FARMINGVILLE, N.Y. 11738
 (516) 451-4633

2082

I.D. NO.				
----------	--	--	--	--

NAME OF CITY PRECISION CONCEPTS INC		OWNER / OFFICER		VIOLATIONS NOTED YES NO	
COMPANY NAME		CONTACT		TEL.	
PLANT ADDRESS		VILLAGE	TOWN		ZIP
MAILING ADDRESS		INSR.	HYDRO.	MAP COORO.	
PROPERTY OWNER					
DATE 4 MAY 90	TIME 11:30 A	ORIG	PER.	RE.	SAMPLE
ART. 7 YES NO		ART. 10 NO		ART. 12 NO	
INDUSTRY		SPOES OR NPOES PERMIT		YES	NO
HEATING SYSTEM - MFG NAME		FUEL TYPE	FIRING RATE	TANK SIZE	
NUMBER OF DRUMS INDOORS OUTDOORS		NUMBER OF TANKS ABOVEGROUND UNDERGROUND		SEWAGE SYSTEM	PUBLIC PRIVATE
SCAVENGER		TEL.	PICK UP RECORDS AVAILABLE	YES	NO

- SAMPLES OBTAINED ON 3 MAY 90 FROM
 E-SIDE LEACHING POOL & W-SIDE SANITARY
 ACCOMPANIED BY B. PHILLIPS
 IBS-3 AND ABR5-3 ORGANICS & METALS

- DRAINS IN HEAT TREATING ROOM ITEM #9
 RECEIVING NCCW FROM DEGREASERS ARE
 SANITARY TYPE TO DEAD-END FRESH H₂O
 PIPES ON EITHER SIDE.

- METALS USED AT FACILITY ARE 10
 COPPER - BRASS, GOLD, SILVER

- MR. ANCSANYI NOTED FACILITY IS UNDER 90 DAY
 WASTE P/U CYCLE

INDUSTRIAL WASTES MUST NOT BE DISCHARGED TO THE GROUND OR DISPOSED OF
 IN A DUMPSTER, BUT MAY ONLY BE TRANSPORTED AND DISPOSED OF BY A LICENSED
 INDUSTRIAL WASTE SCAVENGER FOR AN APPROVED LIST CONTACT THE
 N.Y.S. D.E.C. AT 751 - 7900

REINSPECTION SCHEDULED ON OR AFTER _____ . FAILURE TO CORRECT UNSATISFACTORY CONDITIONS BY REINSPECTION DATE MAY
 RESULT IN A HEARING AND OR FINE.
 PERMISSION IS GRANTED BY THIS FACILITY TO THE SUFFOLK COUNTY DEPARTMENT OF HEALTH SERVICES TO CONDUCT ROUTINE SAMPLING
 OF CESSPOOLS, STORMDRAINS, AND OTHER DISCHARGE POINTS AT THE FACILITY.

SIGN. OF PERSON REC. REPORT <i>Monty Ancsanyi</i>	TITLE <i>Monty Ancsanyi</i> INSPECTOR
--	---------------------------------------

NO.	PROCESS	CHEMICALS USED AND APPROXIMATE QUANTITY	DISCHARGE	
			LIQUID	AIR CONTROL TYPE EP
6.	QC	TESTING EQUIPT.		
7	PRESS ROOM / METAL STAMPING	EXAM POLISHING BENCH & SINK 2- PRESSES & SELF CONTAINED LUBE/HYDRAULIC RESERVOIRS	SANITARY	
8	OIL STORAGE ROOM / CONTAINMENT AREA	24- 50# DEGREASING FLUIDS (PORTABLE) 13- 55# ASSORTED OILS 6- 20-30# DEGREASERS SOLID 1- 55# (1,1 TRICHLOROETHANE) 6- 55# WASTE MARKED "SAMPLED" 2- 20% CARBOXY NITRIC/PHOSPHORIC ACID (POLISHING SOLUTION-ELECTRO) 2- DEGREASERS & UCCO → PIPED TO DRAIN IN HEAT TREAT ROOM ?	HxH HxH	RECYCLED
9	HEAT TREATING	FURNACE & UCCO TO DRAIN ?		
10	LOADING DOCK	3- 55# (1,1 TRICHLOROETHANE) 1- 55# NaOH		
11	MEDICAL MFRS (FETAL MONITORING PROBE)	4- ASSEMBLY BENCHES 3- INJECTION MOLDERS (REALLY CLEANING/POLISHING)		
		1- 150# ELECTRO POLISH SOLN (NITRIC/PHOSPHORIC ACID) 3- RINSE HOT TACKS 1- WASH SINK	RECYC/EVAPORATOR SANITARY	HxH

5) ON

FAC ID NO: 20438

M-22 E-III

Principal Property Tax Code

District 200 Section 584.0 BLOCK 1 LOT 4. 1

Facility Name Facility Address

PRECISION CONCEPTS ROAD C YAPHANK
NY 0

Tank Owner Owner Address

PRECISION CONCEPTS 1595 OCEAN AVE BOHEMIA
NY 11716

Air ID No : Facility Code
Station Id : 0

1 = List Tanks 2 = Select Another Facility 3 = Exit to Primos

5/ 4/90

PAGE 1

TANKS LISTED FOR FACILITY # 20438

TNK NO	ABOVE or BELOW	IN or OUT	CAPACITY GALLON	MATERIAL/ OTHER MATERIAL	INST YR NEW USE	CONSTRUCTION DISP TYPE	MATER FILL TYPE	MATER 0
1	ABOVE	OUT	6000	IND WASTES	84 YES	FRP	PUMPED	89P
2	ABOVE	OUT	400	ORG SOLVENT	84 YES	PLN STL SUCT		89P
3	ABOVE	IN	1875	DRUM STORAGE	84 YES			89P

ENTER <RETURN> TO CONTINUE

SUFFOLK COUNTY DEPARTMENT OF HEALTH SERVICES

STANDARD WORKSHEET FOR DETERMINATION OF

TOXICITY OF CONTAMINATED POOLS

FIELD NO.: 2BR5-3 LAB NO.: _____ DATE: _____
 NAME OF FIRM: PRECISION CONCRETE INC
 ADDRESS OR LOCATION: 26 PRECISION DR. SHIRLEY 11967
 POINT OF COLLECTION: SANITARY SYSTEM EAST SIDE OF BLDG
 REMARKS/INSTRUCTIONS: TAX MAP-0200-584-1-4.11

PARAMETER OVER LIMIT: mg/l:	TOLUENE (330ppb)	ZINC (13.0ppm)	LEAD (8.5ppm)	CADMIUM (.01ppm)
1. TOXICITY MULTIPLIER (TM) X	= <u>2.5</u>	<u>5</u>	<u>5</u>	<u>5</u>
2. STRENGTH MULTIPLIER (SM) X	= <u>2</u> <u>5.0</u>	<u>2</u> <u>10</u>	<u>25</u> <u>125</u>	<u>2</u> <u>10</u>
3. DISTANCE TO GROUNDWATER (GW) <u>N</u> SOFT X	= <u>4</u> <u>20.0</u>	<u>4</u> <u>40</u>	<u>4</u> <u>500</u>	<u>4</u> <u>40</u>
4. HYDROGEOLOGICAL ZONE (HZ) <u>III</u> X	= <u>2</u> <u>40.0</u>	<u>2</u> <u>80</u>	<u>2</u> <u>1000</u>	<u>2</u> <u>80</u>
5. DISTANCE TO NEAREST WELL (DW) <u>N</u> 1200FT S X	= <u>1</u> <u>40.0</u>	<u>1</u> <u>80</u>	<u>1</u> <u>1000</u>	<u>1</u> <u>80</u>
TM X SM X GW X HZ X DW	= <u>40.0</u>	<u>80</u>	<u>1000</u>	<u>80</u>

If Score is greater than 200,
pump out is required.

25MAY-DISTANCE TO
GROUNDWATER &
NEAREST WELL
OBTAINED FROM
M. TREET
(DRINKING H₂O DUC)

NAME: B. ROBINSON
SIGNATURE: B. Robinson

RESEARCH COLLECTED IN [unclear] 7 JULY 1970
16 PRECISION DR.
SHIRLEY

SANITARY SYSTEM BREAK OUT

MET W MR. MARINO (PES), E. AUCSANYI (ELECTRICIAN),
B. PHILLIPS AND JOE (ROTOR SEWER & DRAIN, STAFFER)

ROTOR SEWER REP LOCATED 40' EXPOSED
3 CONCRETE COILS FOR LEAKING POOLS -
EACH ONE DISTANT FROM SANITARY TANK
COVERING ARE NORTH, SOUTH & WEST.

JOE INDICATED HE RESISTED TO SITE TO
LOCATE POOLS FOR OPERATION PURPOSES.

DIRECTED (MR.) HILL, MR. AUCSANYI, & MR. PHILLIPS
NOT TO AERATE POOLS - THAT CONTENTS OF
SANITARY SYSTEM (TANK & 3 POOLS) WOULD
HAVE TO PUMPED OUT, SYSTEM CLEANED, &
MATERIAL DISPOSED OF PROPERLY.

THROUGH DISCUSSION & CONFERENCE W
D. BOBBI, INDICATED HE WOULD ALLOW
SAMPLING OF ALL 4 POINTS BY PRIVATE
LAB TO DETERMINE IF ANY CONTENTS OF
ANY POINT COULD BE TRAK, SHORTED TO
EXTERIOR POINT.

MR. AUCSANYI CALLED ECG TEST LABS TO
HAVE SAMPLES TAKEN - AGREEMENT SCHEDULED
FOR TOMORROW AM TO SAMPLE FOR METALS.
DIRECTED THEM TO OBTAIN SAMPLES FROM
BOTTOM OF POOLS.

ROTOR SEWER REP CALLED ANTHONY MCRACKEN
(ALL STATE POWER VAC - MISTECHA-SES) TO INITIATE
ARRANGEMENT FOR TEMPORARY HOODING TANKS
FOR CONTENTS OF SANITARY SYSTEM.

ADVISED MR. AUCSANYI IT WILL TRY TO RETURN
IN AM TO WITNESS THE SAMPLING.

MR. WOSNYI OFFERS TO HAVE SYSTEM PUMPED OUT
BY [unclear] OF NEXT WEEK.

STAFFER

PRECISION CONCEPTS
26 PRECISION DR
SHIRLEY

6/11/90

MEAN: OUT

JUNE: MET J. B. PHILLIPS WHO STATED THEY ARE AWAITING SAMPLE RESULTS IN ORDER TO DETERMINE HOW THEY WILL PROCEED TO PUMPING OUT THEIR SANITARY SYSTEM - ADVISED TO CONTACT ME FOR INSPECTION OF PUMP/OUT.

MR. PHILLIPS NOTED HE INITIATED A POLICY REQUIRING FLOOR WASH H₂O FROM METALS PROCESS AREA TO BE PLACED IN WASTE STORAGE/ELAPORATION SYSTEM, NOTED THAT: SOLDERING IS PERFORMED IN METAL PROCESSING AND FLOORS ARE WASHED ON A REGULAR BASIS WHICH COULD CAUSE THE PG TO BE IN THE SANITARY SYSTEM.

(ROBINSON)

PRECISION CONCEPTS INC
26 PRECISION DR
SHIRLEY

12 JUNE 90
5:17 PM

SAMPLE/PUMP OUT

BASED ON SAMPLE RESULTS BY VOLUMETRIC TECHNIQUES OF SAMPLES TAKEN FROM SINK 90 OF THE SANITARY SYSTEM - ADVISED G. ANISCAYI HE WOULD, WITH R. FALK'S APPROVAL, HAVE THE 17540 LEXANE POOL PUMPED OUT AND TRANSPORTED TO BERGEN POINT. HOWEVER, THE SEPTIC TANK CONTENTS WOULD HAVE TO BE HANDLED BY AN INDUSTRIAL WASTE SCALDNER. DIRECTED HIM TO CONTACT ME SO I CAN WITNESS THE PUMP OUTS FOR ALL COMPONENTS.

ROBINSON

(SEE ATTACHED FAX COPIES OF RESULTS)

13 JUNE - SPOKE TO G. ANISCAYI WHO STATED HE RECEIVED LETTER FROM R. FALK AUTHORIZING FACILITY TO TRANSPORT CONTENTS OF SANITARY SYSTEM/SEPTIC TANK & 3 POOLS TO BERGEN POINT - STATED LESSPOOL 90 IS ON PREMISE NOW.

ROBINSON

18-235-2/89

COUNTY OF SUFFOLK



PATRICK G. HALPIN
SUFFOLK COUNTY EXECUTIVE

DEPARTMENT OF PUBLIC WORKS

JOSEPH P. HURLEY, P.E.
COMMISSIONER

June 12, 1990

Mr. Gerry Ancsanyi
Precision Concepts, Inc.
~~Z6 Precision Drive~~
Shirley, N.Y.

Re: Acceptability of Waste

Dear Mr. Ancsanyi:

This is written in response to your request to dispose of the contents of the sanitary system servicing your firm at the County's Bergen Point facility.

Based on an inspection by this office, and the results of samples collected 8 June 90, it has been determined that the waste is acceptable for disposal.

Please feel free to call if you have any questions on this.

Very truly yours,

Robert N. Falk
Permit Administrator

RNF:cs

cc: R. Carballeira
R. Strzepek
D. Gobbi ✓

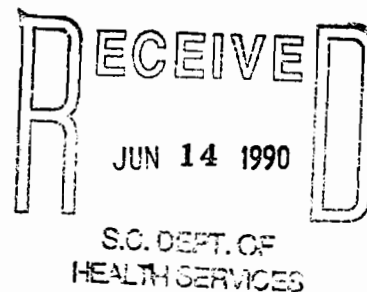



PATRICK J. HULPIN
SUFFOLK COUNTY EXECUTIVE

DEPARTMENT OF PUBLIC WORKS

JOSEPH P. MURLEY, P.E.
COMMISSIONER

CHARLES J. BARTHA, P.E.
CHIEF DEPUTY COMMISSIONER

REQUEST FOR TRANSMISSION BY FAX

DATE 6/22/90

DESTINATION Suffolk County Health Dept.

FAX NUMBER 732 1531

PERSON TO BE CONTACTED MR. Dennis Gobbi

NO. OF PAGES 3 including this page

REQUESTOR MR. Gobbi

COMMENTS _____

Sent by: J Date: _____

SCDPW
BERGEN POINT
FAX 587-5858

Su FFolk County Health Dept.

MR. DENNIS GObBI

RE: Coleman Delivery of PRESSION Concepts.

MR. Gobbi,

Please FIND Attached FAX FOR tickets showing delivery by Coleman of PRESSION Concepts.

The First load WAS Delivered by truck # 40 118-4, 4000 gals. on 6/13/90.

The Second load WAS Delivered on 6/14/90.

A Total of 8000 gallons WAS Delivered.

The Reason They were Delivered on Different Days, WAS THAT The Scavenger waste Facility At Bergen Point Reached capacity of 500,000 gals FOR THE DAY & closed AT 2:00 PM.

Therefore IT WAS Impossible FOR Coleman to Do both loads on the same Day.

Sincerely

Jay Smith

S.T.P. operator
Scavenger waste

119 COLEMAN
TRUCK # 04
GALLONS 4000 40R118-4

030011 FALSE STATEMENTS AND OMISSIONS MADE
HEREON ARE PUNISHABLE AS A CLASS A
MISDEMEANOR.



061390

COUNTY OF SUFFOLK
SCAVENGER WASTE DISPOSAL

SERVICED BY	BAY #
✓	817

DISCHARGE AUTHORIZATION

DRIVER'S SIGNATURE

SOURCE OF WASTE

PRECISION (SALE)

RES COMM
 AUTH IND

NAME

ADDRESS

RES COMM
 AUTH IND

NAME

ADDRESS

RES COMM
 AUTH IND

119 COLEMAN
TRUCK # 04
GALLONS 4000 40R113-4

030006 FALSE STATEMENTS AND OMISSIONS MADE
HEREON ARE PUNISHABLE AS A CLASS A
MISDEMEANOR.



061490

COUNTY OF SUFFOLK
SCAVENGER WASTE DISPOSAL

SERVICED BY	BAY #
MA	4

DISCHARGE AUTHORIZATION

DRIVER'S SIGNATURE

SOURCE OF WASTE

PRECISION (SALE)

RES COMM
 AUTH IND

NAME

ADDRESS

RES COMM
 AUTH IND

NAME

ADDRESS

RES COMM
 AUTH IND

PRECISION CONCEPTS, INC.
26 PRECISION DR.
SHIRLEY

MILITARY SYSTEM PUMP OUT

21 JUNE - SPOKE TO BERGEN PT RECORD DIV
WHO STATED THAT COLEMAN (SCHOOL
DISPOSED OF 5000 GAL FROM
PRECISION CONCEPTS - DISPOSAL
OCCURRED ON 13 & 14 JUNE (4K GAL EACH DAY)

DR

SPOKE TO G. ALSZCZY (PRECISION CONCEPTS)
WHO FAXED COPY OF PUMP OUT
RECEIPT (ATTACHED).

MR. ALSZCZY STATED THAT COLEMAN'S
INITIAL PUMP OUT WAS MID-DAY
13 JUNE AND ESTIMATED SIZE OF
TRUCK TO BE 4K GAL. NOTED THAT
SIMILAR TRUCK RETURNED TO
FACILITY LATE IN AFTERNOON TO
COMPLETE PUMP OUT AFTER FACILITY
AND BERGEN POINT HAD CLOSED.

DR

(NOTE - \$1700⁰⁰ CHARGE IS MATHEMATICALLY
A COST (AT COLEMAN'S RATES) FOR PUMP OUT
AND HYDRO JET OF 5000 GAL)



COLEMAN

Cesspool Service, Inc.
"Schwabs"

CENTER MORICHES SEPTIC SERVICE
Serving the Community for Half a Century!

22699
JAY
422 1211



1 Chapel Avenue
East Northogue, New York 11772
Tel: (716) 634-2052

P.O. Box 21
Center Moriches, New York 11834
378-2010 / 281-9088



St. Brian Robertson

CUSTOMER INFORMATION

Date 6/13/93

Locate cesspool Time
 Dig, expose, cover \$20.00 per ft
 If machine needed minimum \$150.00
 Septic Tank Cleaning
 per 1,000 \$25.00 minimum
 (septic pumped)
 up to 1,000 gal \$105.00
 Each additional 1,000 gal \$85.00
 Hydro Jet aeration method
 with 10 gal. chemicals for
 first 1,000 gal. \$105.00
 For each additional 1,000 gal. \$85.00
 Charges for Hydro Jet Method
 based on capacity of pool
 Extra Hose \$10.00
 Additional chemicals \$30.00 per 5 gal.
 Roto Root 1 line \$75.00 minimum
 Additional line \$55.00
 Hand Snake \$55.00
 Service Call \$50.00
 Call not cancelled \$75.00

\$

MANNER OF PAYMENT

Check _____
 Visa No. _____
 MasterCard _____
 C.O.D. _____
 Amt. Paid \$ _____ Recd. by _____

I, _____ hereby affirm that I am the owner, or user, of the individual Sewage Disposal Facility (septic tank, leaching facilities) located at the address of the residence and (1) That the facilities are designed to contain only sanitary sewage; (2) That I have not been notified by the Suffolk County Department of Health or the Nassau County Department of Health to have this system pumped by a licensed industrial hauler. That neither I nor any person in my family or in my employ have added any chemical, solvent waste or industrial wastes of any kind to the facility to be pumped and that I make this Statement knowing that the waste will be disposed of at a Municipal Septage Treatment Facility and that in the event that any chemical solvent waste or industrial waste of any kind have been added, legal action may be undertaken by the appropriate regulatory agency against any or all parties involved. I hereby affirm under penalty of perjury that information provided on this form is true to the best of my knowledge and belief. False statements made herein are punishable as a Class A misdemeanor pursuant to Section 210.45 of the Penal Law.

Labor

W/ 1/2" ROTO-ROOT
+ 3 HOSES
1000 GAL
W/ 1/2" ROTO-ROOT - 1/2" HOSE
+ 1/2" HOSE
1700.00

Customer's Signature _____ Date _____

ACKNOWLEDGEMENT AND WAIVER

I have requested a Coleman Septic Tank Truck to drive across my property. I will not hold Coleman responsible for any damages done by their truck. Also, if the Coleman truck should get stuck, I will pay for a tow truck to pull the truck out, and \$40.00 per hour for time lost waiting for the tow truck service.

X- [Signature]
 Customer's Signature

Driver is responsible to collect
 all C.O.D. orders — There will be a \$15.00
 service charge for all returned checks.

PURCHASER SHALL PROVIDE ACCESS TO JOB SITE. IT SHALL BE THE OBLIGATION OF THE PURCHASER TO INFORM THE SERVICE COMPANY OF ANY ABOVE OR BELOW GROUND OR HIDDEN PERILS. THE SELLER SHALL NOT BE RESPONSIBLE FOR DAMAGE ABOVE OR BELOW GROUND TO PROPERTY OR HIDDEN PERILS. SELLER ASSUMES LIABILITY REPRESENTATIVELY AND PERSONALLY FOR PAYMENT OF CONTRACT AMOUNT.

PAID
 6/13/93 1700

PRECEDENCE CONCERNS IN
NO PRECEDENCE IN
SHIRLEY

PUMP OUT FOLLOW UP

12 JULY - MET W B. HILLIS (MAINTENANCE SUPERVISOR)
WHO STATED THAT ON DATE OF
PUMP OUT HE WITNESSED THE EXPOSURE
OF SEPTIC TANK AND PEGS SUBSEQUENTLY
WITNESSED PUMPING OF SEPTIC TANK
AND THE INITIATION OF CLEANUP OF
THE PEGS. HOWEVER, DID NOT ADDRESS
THE COMPLETE PUMPING OF THE PEGS
BECAUSE THE OPERATION TERMINATED
AFTER FACILITY CLOSED.

NOTE - RECEIPT FOR VOLUME OF
PUMP OUT FROM WOLMAN (RESPIRO
SIC) TO FACILITY (DATED 13 JULY)
ROUGHLY CORRESPONDS TO VOLUME
DELIVERED TO BERGEN POINT AS
REPORTED BY J. SMITH (STP OPERATOR)

DRIBBS

PRECISION CONCRETE'S INC
21 PRECISION DR.
SHILLEY

DYE TESTING

30 JULY '90 - DYE TESTING OF TWO DRAINS
LOCATED IN HEAT TREATING FURNACE
ROOM AT SOUTH INTERIOR OF BLDG
RECEIVABLE WITH DRAIN DISCHARGED TO
THE PRIMARY SEPTIC TANK ON N/E SIDE
OF BLDG.

DRAIN ON EAST WALL RECEIVABLE & COOL
FROM DEBRIS IN ADJACENT ROOM WAS
TESTED & RED DYE. DRAIN ON WEST WALL
RECEIVABLE & COOL FROM DOOR BASKET ON
FURNACE WAS TESTED & YELLOW-GREEN DYE.

LEACHING POOL AT N/E SIDE OF
BLDG WAS UNCOVERED AND NO DYE
COULD BE VISUALIZED. DYE TESTING
PERFORMED BY PHILLIPS

PHILLIPS



ROBERT J. GAFFNEY
SUFFOLK COUNTY EXECUTIVE

DEPARTMENT OF HEALTH SERVICES

Mary E. Hibberd, M.D., M.P.H.
COMMISSIONER

FARMINGVILLE FAX MACHINE COVER SHEET

FAX NUMBER (516) 854-2505

FROM:

DATE: 4/23/92

NAME: D. GOBBI

PHONE NUMBER: 854-2514

NUMBER OF PAGES: 1 + COVER

TO:

NAME: VINCENT MARINO

COMPANY: PREC. CONCEPTS

FAX NUMBER: 516 924-1007

VERIFY NUMBER: _____

PRECISION CONCEPTS (934-1000)

26 PRECISION DR

SHIRLEY

PUMP-OUT

17 SEPT 91 - PHYSICALLY VERIFIED TAX MAP LOCATION OF FACILITY -

200/584/1/4.19

PROPERTY IS LISTED TO TOWN OF BROOK HAVEN INDUSTRIAL DEVELOPMENT AGENCY.

- SPOKE TO MR. MARINO'S SECRETARY WHO STATED HE WAS NOT IMMEDIATELY AVAILABLE - ASKED TO HAVE HIM CALL ME.

18 SEPT 91 - CALLED - LEFT MESSAGE FOR MR. MARINO TO CALL ME.

BJR

NOTE - FACILITY NEW ADDRESS
PRECISION CONCEPTS
2701 BOULDER PARK COURT
WINSTON-SALEM, N.C., 27101

- SPOKE TO MR. MARINO - DISCUSSED PUMP-OUT LETTER - REQUESTED HE CALL ME NEXT WEEK & PROGRESS REPORT - ALSO DISCUSSED DECOMMISSIONING OF STORAGE TANKS (IE - PLACING OUT OF SERVICE).

BJR

10 OCT 91 - MET J.B. PHILLIPS - DISCUSSED ABOVE - MR. MARINO IN N.C. TILL MID-OCT N.C. PHONE # 919-761-8572.

BJR

11 OCT 91 - CALLED - MARINO OUT OF COUNTRY TILL 8 OCT.
25 NOV - MR. MARINO OUT OF COUNTRY/STATE BJR

NO.	PROCESS	CHEMICALS USED AND APPROXIMATE QUANTITY	DISCHARGE	
			LIQUID	AIR CONTROL TYPE EP
11	COMPRESSOR ROOM	COOLING H₂O FOR COMPRESSORS CONDENSATION LINES - EXHAUST	H ₂ O	
12	GRESS ROOM	CUTTING MACHINES CUTTING OIL	H ₂ H	
13	TOOLING ROOMS (2)	PARTS GRINDING MACHINES VENTS MANIFOLDED TO EXTERIOR CYCLOWES		2
14	WIRE EDM ROOM	PARTS CUTTING - COOLING H ₂ O (CONTACT) FILTERED THEN DISCHARGED EVERY 5 MODS.	FLOOR DRAIN	
		DUI FILTERING RESIN (IRN 180)	H ₂ H	
15	TOOLING ROOM -	2 GRINDING MACHINES RUST-LICK 6-1066R GRINDING FLUID TO WASTE HOLDING TANK	H ₂ H	
		D-DEGREASER (TRICHLOR) 15G D-ELECTRO POLISHER	H ₂ H	1
		1-15G ACID BATH 3-15G H ₂ O BATH	REUSED H ₂ H	
		WIRE SINK - PARTS (DEGREASED) RINSING	FLOOR DRAIN	



**recision
oncepts, Inc.**

Precision Miniature Stampings
Contact Assemblies
• Brazing
• Welding
• Riveting

28 Precision Drive • Shirley, New York 11967 • (516) 924-1000 • FAX: 516-924-1007

FACSIMILE (FAX) LEAD SHEET

TO: MR. Gobbi
FROM: J. DiSanti
DATE: 5-13-92
NUMBER OF PAGES TO BE SENT: 2 INCLUDING THIS PAGE
SUBJECT MATTER: SEPTIC TANK

Hope to resolve this ASAP.

THANK YOU —



Your Single Source Manufacturer for
Clad Metals and Precision Stamping

PRECISION CONCEPTS, INC.

26 Precision Drive • Shirley, New York 11967 • (516) 924-1000 • FAX (516) 924-1007

May 13, 1992

Department of Public Works
335 Yaphank Avenue
Yaphank, New York 11980
Attention: Bob Falk

Dear Mr. Falk:

As per attached letter, we (Precision Concepts) are requesting an approval to bring 8,000 gallons of septic tank waste to your Bergen Point facility.

Once we have received your approval, we will then proceed to make arrangements for transportation.

Thank you for your cooperation, and if you have any questions, please feel free to call.

Very truly yours,
PRECISION CONCEPTS, INC.

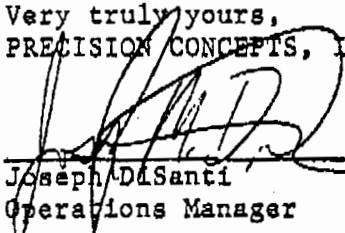

Joseph DiSanti
Operations Manager

JD/nk

PRECISION CONTRACTS INC
 20 PRECISION DR.
 SHIRLEY

6 MAY 92 - MET & TOMAS STATCH (TREASURER) TO
 DISCUSS PUMP OUT LETTER OF
 2/24/91. ALSO EXPLAINED THAT
 ABOVE/REMOVAL TANKS WILL HAVE TO
 BE DEMOLISHED, OUT OF SERVICE (WITH
 A 2 YEAR LIMIT) OR REMOVED.

MR. STATCH STATED HE WILL BRING
 BOTH MATTERS TO MR. MARIN'S ATTENTION
 AND CONTACT ME THE BEGINNING OF
 NEXT WEEK.

J. JOHNSON

26 MAY 92 - MET & MR. J. DI SANTI WHO STATED
 HE IS AWAITING NOTIFICATION FROM
 BALL ENERGY TO COORDINATE RESAMPLING
 OF SANITARY SYSTEM BY K. OLDHAM (OPA)
 TO DETERMINE WHETHER MATERIAL CAN
 BE TRANSPORTED TO BERGEN POINT. NOTED
 THAT A LICENSED SCRAPPER MUST BE
 USED IF MATERIAL IS NOT ACCEPTABLE
 FOR BERGEN POINT.

ALSO DISCUSSED REQUIREMENTS FOR
 A/O STORAGE TANKS WITH RESPECT TO
 DISMANTLING/REMOVAL OR REQUEST FOR
 T.O.S. - NOTED THAT T.O.S. IS ONLY
 VALID FOR 2 YRS. - GAVE MR. DI SANTI
 A COPY OF ART 25121C - RE ABANDONMENT/T.O.S.

JR

5/28/92 = DG Spoke with Joe DiSanti who indicated that sampling
 (924-1330) of septic tank is to be accomplished on 5/29/92 in the
 presence of Kevin Oldham.

3 JUNE 92 - S. YANUCK CALLED TO CONFIRM ABOVE SAMPLING JR



ROBERT J. GAFFNEY
SUFFOLK COUNTY EXECUTIVE

DEPARTMENT OF PUBLIC WORKS

STEPHEN G. HAYDUK, PE
COMMISSIONER

June 23, 1992

Mr. Joseph DiSanti, Operations Manager
Precision Concepts, Inc.
26 Precision Drive
Shirley, NY 11967

Re: Acceptability of Waste

Dear Mr. DiSanti:

This is written in response to your 13 May 92 request to dispose of the contents of the septic tank servicing your facility at the County's Bergen Point plant.

Based on a 29 May 92 inspection by this office and the results of a sample collected at that time it has been determined the material is acceptable for disposal.

Please contact this office prior to any planned pick-up and feel free to call if you have any questions.

Very truly yours,

Robert N. Falk
Permit Administrator

RNF:cs

- cc: R. Carballeira
- R. Strzepek
- D. Gobbi ✓
- S. Yanuck

RECEIVED
JUN 25 1992
S.C. DEPT. OF
HEALTH SERVICES

PRECISION CONCEPTS

23 JULY 91

-SPOKE TO J. DI SANTI WHO STATED HE WILL FAX RECEIPTS, ETC FOR W-SIDE SANITARY PUMP-OUT.

-ALSO STATED THEY ARE GOING TO PURSUE TOS STATUS FOR THE J-A/O TANKS LOCATED AT S/E COR OF BLDG. SOP & CRITERIA (ART 11) FOR TOS PREVIOUSLY GIVEN TO MR. DI SANTI.

(J) ROBINSON

TOM

		PHONE #
BRUCE WILSON	SCDHS	854 2546
Walter T. Petrule	SCDHS	854-2508
RICHARD MARKEL, RE.	SCDHS	853-3197
VINCENT MARINO (OWNER)		924-1000
RICHARD GALL		754-0396
CHARLIE RUSSO *	ATTY for Precision	265 7000

23 Apr 98 — called Marino — in meeting —
left message to call me —

23 Apr 98
FAX copy of letter dated 8/22/97 to Marino's secty

6 May 98 — called "Tom" re: above fax —
message to secretary.



RICHARD D. GALLI, P.E., P.C.
82 BROADWAY, GREENLAWN, N.Y. 11740

* file
Prec. Concepts

(516) 754-0396
FAX: (516) 754-7408

June 26, 1992

Mr. Joseph DiSanti, Operations Manager
Precision Concepts, Inc.
26 Precision Drive
Shirley, NY 11967

Re: Disposal of Septic Tank Waste

Mr. DiSanti:

Enclosed are the laboratory analysis result of a septic tank sample collected from the septic system. Also enclosed is a copy of a letter, June 23, 1991, from Robert Falk of the SC DPW to you, authorizing the disposal of septic tank contents at the Bergen Point Sewage Treatment Facility.

To expedite this matter, make an appointment with your cesspool service contractor for pump-out and notify Mr. Falk's office of the pump-out.

If you have any further questions please do not hesitate to call.

Sincerely,

Scott Yanuck,
Project Manager

COUNTY OF SUFFOLK



ROBERT J. GAFFNEY
SUFFOLK COUNTY EXECUTIVE

DEPARTMENT OF PUBLIC WORKS

STEPHEN G. HAYDUK, PE
COMMISSIONER

June 23, 1992

Mr. Joseph DiSanti, Operations Manager
Precision Concepts, Inc.
26 Precision Drive
Shirley, NY 11967

Re: Acceptability of Waste

Dear Mr. DiSanti:

This is written in response to your 13 May 92 request to dispose of the contents of the septic tank servicing your facility at the County's Bergen Point plant.

Based on a 29 May 92 inspection by this office and the results of a sample collected at that time it has been determined the material is acceptable for disposal.

Please contact this office prior to any planned pick-up and feel free to call if you have any questions.

Very truly yours,

Robert N. Falk
Permit Administrator

RNF:cs

cc: R. Carballeira
R. Strzepak
D. Gobbi
S. Yangck

652 4167

LIFE SUPPORT SCIENCES, INC.
Scientists Consulting in Environmental and Occupational Health
284 Pulaski Road, Greenlawn, New York 11740
516-547-8950 FAX 516-547-8955

*File
PRECISION
CONCEPTS*

August 11, 1993

Mr. Bruce Wilson, Legal Coordinator
Office of Environmental Engineering and Pollution Control
15 Horse Block Place
Farmingville, NY 11736

**Re: Environmental Investigation at Precision Concepts, Precision Drive, Shirley, New York;
Order On Consent No. IW-91-0001.**

Dear Mr. Wilson:

This letter is to confirm our telephone conversation on August 5, 1993. As we discussed, the Suffolk County Department of Health Services (SCDHS) does not wish to meet to discuss the reasons for nomination of the Precision Concepts site to the New York State Superfund program. During our conversation you stated that the outstanding Order-On-Consent, the probability of extensive remediation, which the New York State Department of Environmental Conservation (NYSDEC) is better equipped on a technical level to handle, and monitory issues were the primary factors that lead to the Superfund nomination.

All future correspondence pertinent to the Precision Concepts site will be made with the NYSDEC, exclusively.

Thank you for your cooperation in this matter.

Sincerely,

Life Support Sciences, Inc.



Michael C. Lewis
Safety, Health, & Environmental Technician

c: Charles C. Russo, Russo, Fox, and Karl
Vincent Marino, Precision Concepts
Sy Robbins, SCDHS

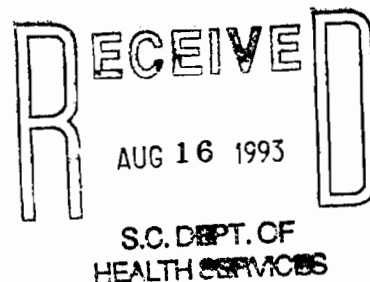

Data on other sites
within Industrial Park

FAX TRANSMISSION

SUFFOLK COUNTY OFFICE OF POLLUTION CONTROL

15 HORSEBLOCK PLACE
FARMINGVILLE, NY 11738-1220

631 854 2514

~~631 854 2505~~

631 FAI

To: MIKE MacCabe Date: 3/11/98
 Fax #: (518) 457-4198 Pages: 11, including
 From: DENNIS Golbi this cover sheet.
 Subject: INDUSTRIAL Remediation INFO

COMMENTS:

MIKE

As we discussed, FAXED data concerns depts (2000)
 efforts to remediate contaminated sites found
 in the North Shirley Industrial complex.
 CALL IF more info is needed

D. Golbi

COUNTY OF SUFFOLK



ROBERT J. GAFFNEY
SUFFOLK COUNTY EXECUTIVE

DEPARTMENT OF HEALTH SERVICES

MARY E. HIBBERD, M.D., M.P.H.
COMMISSIONER

April 4, 1996

CERTIFIED MAIL - R.R.R.
P-516-605-203

Modular Devices, Inc.
One Roned Road
Shirley, New York 11967

Attention: Mr. Steven Summer

Gentlemen:

This letter is to advise you that as a result of our routine inspection of businesses operating within Suffolk County, industrial sampling of your sanitary leaching system was accomplished on February 15, 1996.

Review of the laboratory analyses found the following compounds at concentrations indicative of unpermitted discharges of industrial waste:

SANITARY SEPTIC TANK (15' WEST OF BUILDING)
SLUDGE

<u>Organic</u>		<u>Metal</u>	
Toluene	5,500 ppb	Aluminum	230 μ gm/gm
p-Isopropyltoluene	2,500,000 ppb	Copper	30 μ gm/gm
		Zinc	140 μ gm/gm

LIQUID

<u>Organic</u>		<u>Metal</u>	
Toluene	290 ppb	Aluminum	24.0 mg/l
p-Isopropyltoluene	40,000 ppb	Barium	4.4 mg/l
		Cadmium	0.07 mg/l
		Iron	100.0 mg/l
		Lead	1.7 mg/l
		Manganese	1.0 mg/l
		Zinc	16.0 mg/l

These compounds are considered toxic or hazardous and are not to be discharged to the ground, sanitary system, storm drain or other leaching systems. The discharge of any liquid from an industrial process without having first obtained a SPDES Permit for that discharge is a violation of the New York State Environmental Conservation Law and Article 12 of the Suffolk County Sanitary Code, which was promulgated to protect the groundwater.

Due to the elevated levels found, YOU ARE DIRECTED to have all contaminated solids/sludge and liquids pumped from the referenced sanitary septic tank by an industrial waste hauler by June 6, 1996. Under the Suffolk County Code, you may be subject to the imposition of a \$500 civil penalty for each day that these contaminants are allowed to leach out from the subsurface collection systems. Kindly notify this office three working days in advance of the scheduled cleanup date so that one of our representatives may be present.

In addition, high-pressure washing or scraping of the interior walls is required to eliminate any residual contamination.

BE ADVISED that aeration and/or chemical treatment of any subsurface leaching system to enhance the leachability of hazardous material is not only a separate and distinct violation of Article 12, Section 1205 of the Suffolk County Sanitary Code, but is also considered a willful violation of the code which carries criminal penalties as well as administrative fines.

For a complete and up-to-date listing of licensed scavengers, you should contact the Division of Regulatory Affairs, Waste Transporter Section of the New York State Department of Environmental Conservation at (518)457-3254. The hiring of a cesspool pumping service which is not licensed to haul toxic industrial waste is a violation of state and county law and may subject both you and the non-licensed hauler to civil liability (fines). It is your responsibility to determine if the scavenger is licensed to haul industrial waste. Since this work may require a Federal Industrial Waste Generator's Permit before pumpout is accomplished, you should contact the USEPA, Permit Administration Branch, Region II, Room 432, Jacob K. Javits Federal Building, New York, New York 10278, or by telephone at (212)264-9881 to expedite your request so that the cleanout can be executed within the time frame allotted.

Fees for removal of toxic materials may vary between scavengers; therefore, you may wish to secure written estimates for your cleanout. This, however, is not to be construed that the department will accept delays in this matter.

Modular Devices, Inc.
April 4, 1996
Page 3

Failure to comply with the directives set forth in this letter by June 6, 1996 will result in this matter being scheduled for a Formal Administrative Hearing at which time the department will be seeking the imposition of the maximum penalties of \$500/day for each and every violation of the Suffolk County Sanitary Code including, but not limited to, failure to comply with the directives set forth in this letter. It is in your best interest to implement the remediation process outlined above.

If this department can be of any assistance in this regard, feel free to contact the undersigned at 854-2514.

Sincerely,



D.C. Gobbi, R.S.
Senior Public Health Sanitarian
Inspection Services Bureau

DCG:lc
Enclosure

cc: New York State DEC

COUNTY OF SUFFOLK



ROBERT J. GAFFNEY
SUFFOLK COUNTY EXECUTIVE

DEPARTMENT OF HEALTH SERVICES

MARY E. HIBBERD, M.D., M.P.H.
COMMISSIONER

April 4, 1996

CERTIFIED MAIL - R.R.R.
P-516-605-202

Metro Door
33 Precision Drive
Shirley, New York 11967

Attention: Mitch Bistyga, Executive Vice President

Gentlemen:

This letter is to advise you that as a result of our routine inspection of businesses operating within Suffolk County, industrial sampling of your sanitary leaching system was accomplished during February 1996.

Review of the laboratory analyses found the following compounds at concentrations indicative of unpermitted discharges of industrial waste:

SANITARY SEPTIC TANK
LIQUID

Metal

Aluminum	12.0 mg/l	Iron	35.0 mg/l
Cadmium	0.03 mg/l	Lead	0.4 mg/l
Copper	2.3 mg/l	Zinc	6.2 mg/l

SLUDGE

Organic

Toluene	4,000 ppb
Ethylbenzene	650 ppb
Xylene(s)	3,700 ppb
1,4-Dichlorobenzene	980 ppb
p-Isopropyltoluene	17,000 ppb

Metal

Aluminum	1,100 μ gm/gm
Barium	130 μ gm/gm
Cadmium	2 μ gm/gm
Copper	110 μ gm/gm
Iron	2,800 μ gm/gm
Lead	25 μ gm/gm
Manganese	25 μ gm/gm
Zinc	400 μ gm/gm

Metro Door
 April 4, 1996
 Page 2

SANITARY SEPTIC SYSTEM WESTERN OVERFLOW POOL
SLUDGE

Metal

Aluminum	1,200 $\mu\text{gm/gm}$	Iron	1,800 $\mu\text{gm/gm}$
Copper	15 $\mu\text{gm/gm}$	Zinc	10 $\mu\text{gm/gm}$

These compounds are considered toxic or hazardous and are not to be discharged to the ground, sanitary system, storm drain or other leaching systems. The discharge of any liquid from an industrial process without having first obtained a SPDES Permit for that discharge is a violation of the New York State Environmental Conservation Law and Article 12 of the Suffolk County Sanitary Code, which was promulgated to protect the groundwater.

Due to the elevated levels found, YOU ARE DIRECTED to have all contaminated solids/sludge and liquids pumped from only the septic tank by an industrial waste hauler by May 31, 1996. Under the Suffolk County Code, you may be subject to the imposition of a \$500 civil penalty for each day that these contaminants are allowed to leach out from the subsurface collection systems. The liquid portion may be acceptable at the Bergen Point Sewage Treatment facility. Contact Robert Falk at 852-4107 for approval prior to pumping this material. If the liquid is not acceptable to the Department of Public Works, it must be removed and disposed of by a licensed industrial waste hauler along with the sludge. Kindly notify this office three working days in advance of the scheduled cleanup date so that one of our representatives may be present.

In addition, high-pressure washing or scraping of the interior walls is required to eliminate any residual contamination.

BE ADVISED that aeration and/or chemical treatment of any subsurface leaching system to enhance the leachability of hazardous material is not only a separate and distinct violation of Article 12, Section 1205 of the Suffolk County Sanitary Code, but is also considered a willful violation of the code which carries criminal penalties as well as administrative fines.

For a complete and up-to-date listing of licensed scavengers, you should contact the Division of Regulatory Affairs, Waste Transporter Section of the New York State Department of Environmental Conservation at (518)457-3254. The hiring of a cesspool pumping service which is not licensed to haul toxic

COUNTY OF SUFFOLK



ROBERT J. GAFFNEY
SUFFOLK COUNTY EXECUTIVE

DEPARTMENT OF HEALTH SERVICES

MARY E. HIBBERD, M.D., M.P.H.
COMMISSIONER

April 8, 1996

CERTIFIED MAIL R.O.R.
P-516-605-208

Firematic Supply Company, Inc.
10 Ramsey Road
Shirley, New York 11967

Attention: Mr. Michael Hanrathy

Gentlemen:

This letter is to advise you that as a result of our routine inspection of businesses operating within Suffolk County, industrial sampling of the sanitary and industrial leaching systems was accomplished on February 9, 1996.

Review of the laboratory analyses found the following compounds at concentrations indicative of unpermitted discharges of industrial waste:

SANITARY SEPTIC TANK - LIQUID

Metal & Organic

p-Isopropyltoluene	1,100 ppb
Iron	0.9 mg/l

SLUDGE

<u>Organic</u>		<u>Metal</u>	
Toluene	3,000 ppb	Aluminum	220 μ gm/gm
1,4-Dichlorobenzene	5,300 ppb	Cadmium	2 μ gm/gm
p-Isopropyltoluene	490,000 ppb	Copper	40 μ gm/gm
		Iron	470 μ gm/gm
		Manganese	10 μ gm/gm
		Zinc	120 μ gm/gm

These compounds are considered toxic or hazardous and are not to be discharged to the ground, sanitary system, storm drain or other leaching systems. The discharge of any liquid from an industrial process without having first obtained a SPDES Permit for that discharge is a violation of the New York State Environmental Conservation Law and Article 12 of the Suffolk County Sanitary Code, which was promulgated to protect the groundwater.

COUNTY OF SUFFOLK



ROBERT J. GAFFNEY
SUFFOLK COUNTY EXECUTIVE

DEPARTMENT OF HEALTH SERVICES

MARY E. HIBBERD, M.D., M.P.H.
COMMISSIONER

April 8, 1996

CERTIFIED MAIL - R.R.R.
P-516-605-206

Mid Atlantic Graphics, Inc.
14 Ramsey Road
Shirley, New York 11967

Attention: Richard Reina

Gentlemen:

This letter is to advise you that as a result of our routine inspection of businesses operating within Suffolk County, industrial sampling of your sanitary leaching system was accomplished on February 21, 1996.

Review of the laboratory analyses found the following compounds at concentrations indicative of unpermitted discharges of industrial waste:

SANITARY SYSTEM OVERFLOW LEACHING POOL (OFFICE AREA SAN-SYS)
SLUDGE

<u>Organic</u>		<u>Metal</u>	
Toluene	300 ppb	Aluminum	3,100 µgm/gm
Xylene(s)	320 ppb	Barium	10 µgm/gm
b-Propylbenzene	790 ppb	Copper	10 µgm/gm
1,3,5-Trimethylbenzene	3,100 ppb	Iron	3,500 µgm/gm
1,2,4-Trimethylbenzene	4,900 ppb	Manganese	20 µgm/gm
p-Isopropyltoluene	3,000 ppb	Zinc	15 µgm/gm
1,2,4,5-Tetramethylbenzene	1,600 ppb		

These compounds are considered toxic or hazardous and are not to be discharged to the ground, sanitary system, storm drain or other leaching systems. The discharge of any liquid from an industrial process without having first obtained a SPDES Permit for that discharge is a violation of the New York State Environmental Conservation Law and Article 12 of the Suffolk County Sanitary Code, which was promulgated to protect the groundwater.

COUNTY OF SUFFOLK



ROBERT J. GAFFNEY
SUFFOLK COUNTY EXECUTIVE

DEPARTMENT OF HEALTH SERVICES

MARY E. HIBBERD, M.D., M.P.H.
COMMISSIONER

May 20, 1996

CERTIFIED MAIL - R.R.R.
P-570-958-005

Messrs. Vincent or Christopher Marino
2701 Boulder Park Court
Winston Salem, North Carolina 27101

Re: *Precision Concepts Building*
26 Precision Drive, Shirley, NY

Gentlemen:

As a result of this department's efforts to determine suspect industrial sources of pollution, facility inspections and sampling during the past few months were accomplished in the North Shirley industrial complex.

On April 17, 1996, representatives of this department secured samples from several property leaching systems. In addition, samples were also taken of the visible soil from the obviously breached interior collection pit located adjacent to the building's east wall. Review of the laboratory analyses identified one area of concern that you are being directed to remediate, since you were the previous occupant and property owner.

The following compounds were found at concentrations indicative of unpermitted discharges of industrial waste.

INTERIOR COLLECTION PIT
(VISIBLE SOIL SURROUNDING PIT DUE TO ERODED CONCRETE)

<u>Metal</u>		<u>Organic</u>	
Aluminum	270 ppm	1,1,1-Trichloroethane	72 ppb
Barium	20 ppm	Tetrachloroethene	210 ppb
Beryllium	80 ppm		
Chromium	200 ppm		
Copper	4,600 ppm		
Iron	3,000 ppm		
Lead	320 ppm		
Manganese	10 ppm		
Nickel	50 ppm		
Silver	28 ppm		
Zinc	90 ppm		

COUNTY OF SUFFOLK



ROBERT J. GAFFNEY
SUFFOLK COUNTY EXECUTIVE

DEPARTMENT OF HEALTH SERVICES

MARY E. HIBBERD, M.D., M.P.H.
COMMISSIONER

June 17, 1996

Metro Door
33 Precision Drive
Shirley, New York 11967

Attention: Mitch Bistyga

Re: *Environmental Remediation*

Gentlemen:

With reference to cleanup activities conducted by RGM on June 7, 1996 of the sanitary septic tank at your facility, you are being advised that an adequate extraction of contaminated liquids and solids was accomplished.

Please forward copies of all waste disposal manifest receipts so that our file is complete and accurate.

If you have any questions concerning this matter, please contact me at 854-2514.

Sincerely,

D.C. Gobbi, R.S.
Senior Public Health Sanitarian
Inspection Services Bureau

DCG/lc

cc: RGM/Steven Plofker

Sample Compliance Letter

COUNTY OF SUFFOLK



ROBERT J. GAFFNEY
SUFFOLK COUNTY EXECUTIVE

DEPARTMENT OF HEALTH SERVICES

MARY E. HIBBERD, M.D., M.P.H.
COMMISSIONER

May 10, 1996

Mr. Chris LaFemmina
New York State DEC
Bldg. 40
SUNY Campus
Stony Brook NY 11794

MAY 21 1996

Dear Mr. LaFemmina:

Enclosed are the sample results from Precision Concepts which we spoke about on the phone today.

Interior inspection of the facility also revealed a cap missing from a clean out fitting for one of the roof drains which leads to an underground leaching pool which has never been sampled. The fitting was taped closed. This pool is another possible discharge point that needs to be investigated.

Very truly yours,

James H. Pim, P.E.
Chief, Office of Groundwater Resources

JHP/pd
Enc.

COUNTY OF SUFFOLK



ROBERT J. GAFFNEY
SUFFOLK COUNTY EXECUTIVE

DEPARTMENT OF HEALTH SERVICES

MARY E. HIBBERD, M.D., M.P.H.
COMMISSIONER

MEMORANDUM

TO: James Pim, P.E.
FROM: Bob Seyfarth *BS*
DATE: May 8, 1996
SUBJECT: Sampling at Precision Concepts, Shirley

Attached please find a copy of the site sketch indicating sample locations at the above referenced facility along with the analytical results for samples collected by Mike Seaman and Dennis Gobbi on April 17, 1996.

The samples reveal heavy metal and chlorinated solvent contamination in the soils where the interior collection pit had deteriorated. Dennis will be following up with a letter to the Town of Brookhaven requiring soil removal from beneath the pit. No other locations had detectable concentrations of VOCs or elevated levels of heavy metals. Therefore no further action will be initiated by this office.

Your office may wish to perform another round of groundwater monitoring south of this facility to ensure that the source(s) of contamination at the site have been eliminated.

If any additional areas of concern arise, please contact me at 854-2504.

cc: J. Maloney, P.E.
F. Randall
D. Gobbi

LONG ISLAND EXPRESSWAY

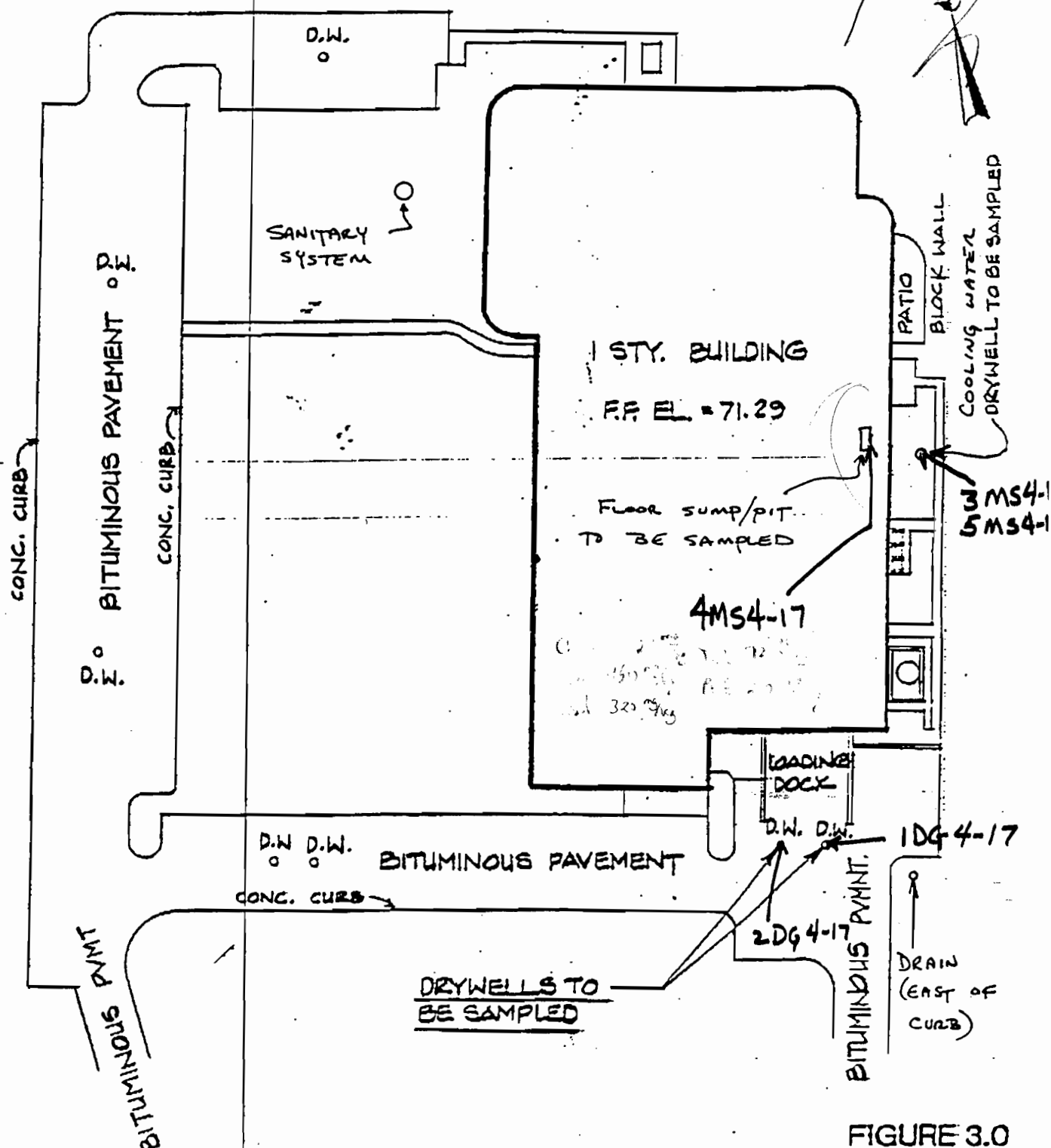

FIGURE 3.0

LOCATION OF DRYWELLS TO BE SAMPLED

SUFFOLK COUNTY DEPARTMENT OF HEALTH SERVICES
DIVISION OF MEDICAL-LEGAL INVESTIGATIONS & FORENSIC SCIENCES
PUBLIC & ENVIRONMENTAL HEALTH LABORATORY
NYSDOH LAB ID. NUMBER 10528

Date MAY 03 1996
Received from Lab
E. Curcio, P.H. San.

SAMPLING ANALYSIS REQUEST/CHAIN OF CUSTODY

Field Number: 106 4-17 Laboratory Number I W 496 077
Collected By: GOBB Assisted By: SEAMAN
Affiliation: S.D.O.H Date: 4/17/96 Time: 1155 AM
Facility/Name FORMER PRECISION CONCEPTS
Location: SHIRLEY
Point of Collection: EAST STORM DRAIN LEADING DOWN
Remarks: SOIL/SLUDGES

Analysis Requested (By Department)

Air Pollution

- Volatile Organic Hydrocarbons
- Asbestos (Bulk)
- Hazardous Materials (Organics)
- Purgeable Halocarbons 1 (EPA 8260)
- Purgeable Halocarbons 2/ Aromatic Hydrocarbons (EPA 8260)
- Preservation HCl Cooled to 4°C
- Level of Detection 40 ppb 4 ppb
- Flash Point (EPA 1010)
- Pesticides
- Specify Type: _____
- TCLP
- Other _____

Industrial Waste (Inorganics)

- Metals Preserved
- Chromium (Hexavalent)
- E P Toxicity
- TCLP
- Phenols
- Cyanide Preserved
- Chloride, Sulfate
- Fluoride
- Ammonia, Nitrate, Nitrite
- T K N
- Solids (SS, DS, TS)
- M B A S, C O D
- T O C
- Oil & Grease
- pH Indicate Field pH: _____

Total Number of Sample Containers Submitted 1

Custody Section

Relinquished By:

Name MICHAEL S SEAMAN Date 4/17/96
Signature [Signature] Time 2:15

Received By:

Name _____ Date 4-17-96
Signature [Signature] Time 3:15

Name _____ Date _____ Name _____ Date _____
Signature _____ Time _____ Signature _____ Time _____

Name _____ Date _____ Name _____ Date _____
Signature _____ Time _____ Signature _____ Time _____

CENTER FOR FORENSIC SCIENCES
 PUBLIC & ENVIRONMENTAL HEALTH LABORATORY
 NYSDOH LAB ID. NUMBER 10528

Date MAY 03 1996
 Received from Lab
 E. Curcio, P.H. San.

ORGANIC & FLASHPOINT ANALYSIS OF INDUSTRIAL & HAZARDOUS MATERIALS

Lab. No. IW- 496077
 Field No. 1 DE 4-17

Date Completed 4-30-96
 EPA Method (8260)1010/

Name Former Precision Concepts Shirley 7/4/96 - soil

Remarks _____

* Indicates TCLP Compounds

Compound	ppb	Compound	ppb
<input type="checkbox"/> Purgeable Halocarbons1			
Chlorodifluoromethane.....	_____	Acetone.....	<1300
Dichlorodifluoromethane.....	_____	*Methyl ethyl ketone.....	<1300
Trichlorofluoromethane.....	_____	Methyl isobutyl ketone.....	<1300
*Vinyl Chloride.....	_____	tert-Butyl methyl ether.....	_____
Chloromethane.....	_____	*Benzene.....	_____
Bromomethane.....	_____	Toluene.....	_____
Chloroethane.....	_____	*Chlorobenzene.....	_____
		Ethylbenzene.....	_____
		Xylene(s).....	_____
<input checked="" type="checkbox"/> Purgeable Halocarbons2/Aromatics			
*1,1-Dichloroethene.....	_____	Styrene.....	_____
Methylene Chloride.....	_____	Isopropylbenzene.....	_____
Freon 113.....	_____	Bromobenzene.....	_____
trans-1,2-Dichloroethene.....	_____	Chlorotoluene(s).....	_____
1,1-Dichloroethane.....	_____	n-Propylbenzene.....	_____
cis-1,2-Dichloroethene.....	_____	p-Ethyltoluene.....	_____
Bromochloromethane.....	_____	1,3,5-Trimethylbenzene.....	_____
*Chloroform.....	_____	tert-Butylbenzene.....	_____
2,2-Dichloropropane.....	<250	1,2,4-Trimethylbenzene.....	_____
1,2-Dichloroethane.....	_____	1,3-Dichlorobenzene.....	_____
1,1,1-Trichloroethane.....	_____	*1,4-Dichlorobenzene.....	_____
1,1-Dichloropropene.....	_____	sec-Butylbenzene.....	_____
*Carbon Tetrachloride.....	_____	p-Isopropyltoluene.....	_____
Dibromomethane.....	_____	*1,2-Dichlorobenzene.....	_____
1,2-Dichloropropane.....	_____	n-Butylbenzene.....	_____
Bromodichloromethane.....	_____	p-Diethylbenzene.....	_____
*Trichloroethene.....	_____	1,2,4,5-Tetramethylbenzene..	_____
cis-1,3-Dichloropropene.....	_____	1,2,4-Trichlorobenzene.....	_____
trans-1,3-Dichloropropene....	_____	Naphthalene.....	_____
1,1,2-Trichloroethane.....	_____	1,2,3-Trichlorobenzene.....	_____
1,3-Dichloropropane.....	_____		
Dibromochloromethane.....	_____	<input type="checkbox"/> Miscellaneous	
1,2-Dibromoethane.....	_____	Vinyl acetate.....	_____
*Tetrachloroethene.....	_____	2-Chloroethyl vinyl ether...	_____
1,1,1,2-Tetrachloroethane....	_____		
Bromoform.....	_____	RESULTS ARE <100ppb FOR PURGEABLE HALOCARBONS 2/AROMATICS -- EXCEPT WHERE NOTED.	
1,1,2,2-Tetrachloroethane....	_____		
1,2,3-Trichloropropane.....	_____		
1,2-Dibromo-3-chloropropane..	<250		
*Hexachlorobutadiene.....	_____		

Analyst GMA

Flash Point
 Pensky-Martens Closed Cup Flash Point _____ °C = _____ °F

Analyst _____

SUFFOLK COUNTY DEPARTMENT OF HEALTH SERVICES
DIVISION OF MEDICAL-LEGAL INVESTIGATIONS & FORENSIC SCIENCES
PUBLIC & ENVIRONMENTAL HEALTH LABORATORY
NYSDOH LAB ID. NUMBER 10528

Date MAY 03 1996
Received from Lab
E. Curcio, P.H. San.

SAMPLING ANALYSIS REQUEST/CHAIN OF CUSTODY

Field Number: 2064-17 Laboratory Number I W 496078
Collected By: 60801 Assisted By: SEAMAN
Affiliation: S.C.D.O.H Date: 4/11/96 Time: 12:10 PM
Facility/Name FORMER PRECISION CONCEPTS
Location: SHIRNY
Point of Collection: ~~WEST~~ STORM DRAIN LOADING DOCK
Remarks: SILTS/SLUDGES

Analysis Requested (By Department)

Air Pollution

- Volatile Organic Hydrocarbons
- Asbestos (Bulk)

Hazardous Materials (Organics)

- Purgeable Halocarbons 1 (EPA 8260)
- Purgeable Halocarbons 2/ Aromatic Hydrocarbons (EPA 8260)
- Preservation HCl Cooled to 4°C
- Level of Detection 40 ppb 4 ppb
- Flash Point (EPA 1010)
- Pesticides
- Specify Type: _____
- TCLP
- Other _____

Industrial Waste (Inorganics)

- Metals Preserved
- Chromium (Hexavalent)
- E P Toxicity
- TCLP
- Phenols
- Cyanide Preserved
- Chloride, Sulfate
- Fluoride
- Ammonia, Nitrate, Nitrite
- T K N
- Solids (SS, DS, TS)
- M B A S, C O D
- T O C
- Oil & Grease
- pH Indicate Field pH: _____

Total Number of Sample Containers Submitted _____

Custody Section

Relinquished By:

Name MICHAEL S SEAMAN Date 4/17/96
Signature [Signature] Time 3:15

Received By:

Name _____ Date 4-17-96
Signature [Signature] Time 3:15

Name _____ Date _____ Name _____ Date _____
Signature _____ Time _____ Signature _____ Time _____

Name _____ Date _____ Name _____ Date _____
Signature _____ Time _____ Signature _____ Time _____

SUFFOLK COUNTY DEPARTMENT OF HEALTH SERVICES
 CENTER FOR FORENSIC SCIENCES
 PUBLIC & ENVIRONMENTAL HEALTH LABORATORY
 NYSDOH LAB ID. NUMBER 10528

Date MAY 03 1996
 Received from Lab
 E. Curcio, P.H. San.

ORGANIC & FLASHPOINT ANALYSIS OF INDUSTRIAL & HAZARDOUS MATERIALS

Lab. No. IW- 1496078
 Field No. 2064-17

Date Completed 4-20-96
 EPA Method (8260)1010/

Name Former Precision Concepts St dr - sludge

Remarks _____

* Indicates TCLP Compounds

Compound	ppb	Compound	ppb
<input type="checkbox"/> Purgeable Halocarbons1			
Chlorodifluoromethane.....		Acetone.....	<1200
Dichlorodifluoromethane.....		*Methyl ethyl ketone.....	<1200
Trichlorofluoromethane.....		Methyl isobutyl ketone.....	<1200
*Vinyl Chloride.....		tert-Butyl methyl ether.....	
Chloromethane.....		*Benzene.....	
Bromomethane.....		Toluene.....	
Chloroethane.....		*Chlorobenzene.....	
		Ethylbenzene.....	
		Xylene(s).....	
<input checked="" type="checkbox"/> Purgeable Halocarbons2/Aromatics			
*1,1-Dichloroethene.....		Styrene.....	
Methylene Chloride.....		Isopropylbenzene.....	
Freon 113.....		Bromobenzene.....	
trans-1,2-Dichloroethene.....		Chlorotoluene(s).....	
1,1-Dichloroethane.....		n-Propylbenzene.....	
cis-1,2-Dichloroethene.....		p-Ethyltoluene.....	
Bromochloromethane.....		1,3,5-Trimethylbenzene.....	
*Chloroform.....		tert-Butylbenzene.....	
2,2-Dichloropropane.....	<250	1,2,4-Trimethylbenzene.....	
1,2-Dichloroethane.....		1,3-Dichlorobenzene.....	
1,1,1-Trichloroethane.....		*1,4-Dichlorobenzene.....	
1,1-Dichloropropene.....		sec-Butylbenzene.....	
*Carbon Tetrachloride.....		p-Isopropyltoluene.....	
Dibromomethane.....		*1,2-Dichlorobenzene.....	
1,2-Dichloropropane.....		n-Butylbenzene.....	
Bromodichloromethane.....		p-Diethylbenzene.....	
*Trichloroethene.....		1,2,4,5-Tetramethylbenzene..	
cis-1,3-Dichloropropene.....		1,2,4-Trichlorobenzene.....	
trans-1,3-Dichloropropene...		Naphthalene.....	
1,1,2-Trichloroethane.....		1,2,3-Trichlorobenzene.....	
1,3-Dichloropropane.....			
Dibromochloromethane.....		<input type="checkbox"/> Miscellaneous	
1,2-Dibromoethane.....		Vinyl acetate.....	
*Tetrachloroethene.....		2-Chloroethyl vinyl ether...	
1,1,1,2-Tetrachloroethane...			
Bromoform.....		RESULTS ARE <100ppb FOR PURGEABLE HALOCARBONS 2/AROMATICS -- EXCEPT WHERE NOTED.	
1,1,2,2-Tetrachloroethane...			
1,2,3-Trichloropropane.....			
1,2-Dibromo-3-chloropropane..	<250		
*Hexachlorobutadiene.....			

Analyst gmc

Flash Point
 Pensky-Martens Closed Cup Flash Point _____ °C = _____ °F

Analyst _____

DECATUR COUNTY DEPARTMENT OF HEALTH SERVICES
DIVISION OF MEDICAL-LEGAL INVESTIGATIONS & FORENSIC SCIENCES
PUBLIC & ENVIRONMENTAL HEALTH LABORATORY
NYSDOH LAB ID. NUMBER 10528

Date MAY 03 1996
Received from Lab
E. Curcio, P.H. San.

SAMPLING ANALYSIS REQUEST/CHAIN OF CUSTODY

Field Number: 3MS4-17 Laboratory Number I W 496079
Collected By: SEAMAN Assisted By: GOBAN
Affiliation: S.C.D.O.H. Date: 4/17/96 Time: 1130 PM
Facility/Name: FORMER PRECISION CONCEPTS
Location: SHMIEY
Point of Collection: LEELHING POOL
Remarks: SOIL

Analysis Requested (By Department)

Air Pollution

- Volatile Organic Hydrocarbons
- Asbestos (Bulk)
- Hazardous Materials (Organics)
- Purgeable Halocarbons 1 (EPA 8260)
- Purgeable Halocarbons 2/ Aromatic Hydrocarbons (EPA 8260)
- Preservation HCl Cooled to 4°C
- Level of Detection 40 ppb 4 ppb
- Flash Point (EPA 1010)
- Pesticides
- Specify Type: _____
- TCLP
- Other _____

Industrial Waste (Inorganics)

- Metals Preserved
- Chromium (Hexavalent)
- E P Toxicity
- TCLP
- Phenols
- Cyanide Preserved
- Chloride, Sulfate
- Fluoride
- Ammonia, Nitrate, Nitrite
- T K N
- Solids (SS, DS, TS)
- M B A S, C O D
- T O C
- Oil & Grease
- pH Indicate Field pH: _____

Total Number of Sample Containers Submitted 1

Custody Section

Relinquished By:

Name MICHAEL S. SEAMAN Date 4/17/96
Signature [Signature] Time 3:45 PM

Received By:

Name _____ Date 4-17-96
Signature [Signature] Time 3:58

Name _____ Date _____ Name _____ Date _____
Signature _____ Time _____ Signature _____ Time _____

Name _____ Date _____ Name _____ Date _____
Signature _____ Time _____ Signature _____ Time _____

CENTER FOR FORENSIC SCIENCES
PUBLIC & ENVIRONMENTAL HEALTH LABORATORY
NYSDOH LAB ID. NUMBER 10528

Date
Received from Lab
E. Curcio, P.H. San.

ORGANIC & FLASHPOINT ANALYSIS OF INDUSTRIAL & HAZARDOUS MATERIALS

Lab. No. IW- 496,079
Field No. 3ms4-17

Date Completed 4/27/86
EPA Method 8260/1010/

Name Former Precision Concepts L.P. soil

Remarks _____

* Indicates TCLP Compounds

Compound	ppb	Compound	ppb
<input type="checkbox"/> <u>Purgeable Halocarbons1</u>			
Chlorodifluoromethane.....	_____	Acetone.....	<u><500</u>
Dichlorodifluoromethane.....	_____	*Methyl ethyl ketone.....	<u><500</u>
Trichlorofluoromethane.....	_____	Methyl isobutyl ketone.....	<u><500</u>
*Vinyl Chloride.....	_____	tert-Butyl methyl ether.....	_____
Chloromethane.....	_____	*Benzene.....	_____
Bromomethane.....	_____	Toluene.....	_____
Chloroethane.....	_____	*Chlorobenzene.....	_____
		Ethylbenzene.....	_____
		Xylene(s).....	_____
		Styrene.....	_____
<input checked="" type="checkbox"/> <u>Purgeable Halocarbons2/Aromatics</u>			
*1,1-Dichloroethene.....	_____	Isopropylbenzene.....	_____
Methylene Chloride.....	_____	Bromobenzene.....	_____
Freon 113.....	_____	Chlorotoluene(s).....	_____
trans-1,2-Dichloroethene.....	_____	n-Propylbenzene.....	_____
1,1-Dichloroethane.....	_____	p-Ethyltoluene.....	_____
cis-1,2-Dichloroethene.....	_____	1,3,5-Trimethylbenzene.....	_____
Bromochloromethane.....	_____	tert-Butylbenzene.....	_____
*Chloroform.....	_____	1,2,4-Trimethylbenzene.....	_____
2,2-Dichloropropane.....	<u><100</u>	1,3-Dichlorobenzene.....	_____
1,2-Dichloroethane.....	<u><100</u>	*1,4-Dichlorobenzene.....	_____
1,1,1-Trichloroethane.....	_____	sec-Butylbenzene.....	_____
1,1-Dichloropropene.....	_____	p-Isopropyltoluene.....	_____
*Carbon Tetrachloride.....	<u><100</u>	*1,2-Dichlorobenzene.....	_____
Dibromomethane.....	_____	n-Butylbenzene.....	_____
1,2-Dichloropropane.....	_____	p-Diethylbenzene.....	_____
Bromodichloromethane.....	<u><100</u>	1,2,4,5-Tetramethylbenzene..	_____
*Trichloroethene.....	_____	1,2,4-Trichlorobenzene.....	_____
cis-1,3-Dichloropropene.....	_____	Naphthalene.....	_____
trans-1,3-Dichloropropene....	<u><100</u>	1,2,3-Trichlorobenzene.....	_____
1,1,2-Trichloroethane.....	_____		
1,3-Dichloropropane.....	_____	<input type="checkbox"/> <u>Miscellaneous</u>	
Dibromochloromethane.....	<u><100</u>	Vinyl acetate.....	_____
1,2-Dibromoethane.....	_____	2-Chloroethyl vinyl ether...	_____
*Tetrachloroethene.....	_____		
1,1,1,2-Tetrachloroethane....	<u><100</u>		
Bromoform.....	<u><100</u>		
1,1,2,2-Tetrachloroethane....	_____		
1,2,3-Trichloropropane.....	_____		
1,2-Dibromo-3-chloropropane..	<u><100</u>		
*Hexachlorobutadiene.....	_____		

**RESULTS ARE <40ppb FOR PURGEABLE
HALOCARBONS 2/AROMATICS
EXCEPT WHERE NOTED.**

Analyst R411

Flash Point
Pensky-Martens Closed Cup Flash Point _____ °C= _____ °F

Analyst _____

SUFFOLK COUNTY DEPARTMENT OF HEALTH SERVICES
 DIVISION OF MEDICAL-LEGAL INVESTIGATIONS & FORENSIC SCIENCES
 PUBLIC & ENVIRONMENTAL HEALTH LABORATORY
 NYSDOH LAB ID. NUMBER 10528

Date MAY 03 1996
 Received from Lab
 E. Curcio, P.H. San.

SAMPLING ANALYSIS REQUEST/CHAIN OF CUSTODY

Field Number: 4MS4-17 Laboratory Number I W 496080
 Collected By: SEAMAN Assisted By: GOBB
 Affiliation: S.C.D.O.H. Date: 4/17/96 Time: 1240 PM
 Facility/Name FORMER PRECISION CONCEPTS
 Location: SHIRLEY
 Point of Collection: INTERIOR COLLECTION PIT - 9 SIDES AERIALIZED
 Remarks: SOILS

Analysis Requested (By Department)

Air Pollution

- Volatile Organic Hydrocarbons
- Asbestos (Bulk)
- Hazardous Materials (Organics)
- Purgeable Halocarbons 1 (EPA 8260)
- Purgeable Halocarbons 2/ Aromatic Hydrocarbons (EPA 8260)
- Preservation HCl Cooled to 4°C
- Level of Detection 40 ppb 4 ppb
- Flash Point (EPA 1010)
- Pesticides
- Specify Type: _____
- TCLP
- Other _____

Industrial Waste (Inorganics)

- Metals Preserved
- Chromium (Hexavalent)
- E P Toxicity
- TCLP
- Phenols
- Cyanide Preserved
- Chloride, Sulfate
- Fluoride
- Ammonia, Nitrate, Nitrite
- T K N
- Solids (SS, DS, TS)
- M B A S, C O D
- T O C
- Oil & Grease
- pH Indicate Field pH: _____

Total Number of Sample Containers Submitted 2

Custody Section

Relinquished By:

Name MICHAEL S SEAMAN Date 4/17/96
 Signature [Signature] Time 3:55 PM

Received By:

Name _____ Date 4-17-96
 Signature [Signature] Time 3:55 PM

Name _____ Date _____ Name _____ Date _____
 Signature _____ Time _____ Signature _____ Time _____

Name _____ Date _____ Name _____ Date _____
 Signature _____ Time _____ Signature _____ Time _____

SUFFOLK COUNTY DEPARTMENT OF HEALTH SERVICES
 CENTER FOR FORENSIC SCIENCES
 PUBLIC & ENVIRONMENTAL HEALTH LABORATORY
 NYSDOH LAB ID. NUMBER 10528

Received from Lab
 E. Curcio, P.H. San.

ORGANIC & FLASHPOINT ANALYSIS OF INDUSTRIAL & HAZARDOUS MATERIALS

Lab. No. IW- 496080
 Field No. 4ms 4-17

Date Completed 4-30-96
 EPA Method (8260)1010/

Name Former Precision Concepts soil-int collection pit

Remarks _____

* Indicates TCLP Compounds

Compound	ppb	Compound	ppb
<input type="checkbox"/> <u>Purgeable Halocarbons1</u>			
Chlorodifluoromethane.....	_____	Acetone.....	<u>< 500</u>
Dichlorodifluoromethane.....	_____	*Methyl ethyl ketone.....	<u>< 500</u>
Trichlorofluoromethane.....	_____	Methyl isobutyl ketone.....	<u>< 500</u>
*Vinyl Chloride.....	_____	tert-Butyl methyl ether.....	_____
Chloromethane.....	_____	*Benzene.....	_____
Bromomethane.....	_____	Toluene.....	_____
Chloroethane.....	_____	*Chlorobenzene.....	_____
		Ethylbenzene.....	_____
		Xylene(s).....	_____
		Styrene.....	_____
<input checked="" type="checkbox"/> <u>Purgeable Halocarbons2/Aromatics</u>		Isopropylbenzene.....	_____
*1,1-Dichloroethene.....	_____	Bromobenzene.....	_____
Methylene Chloride.....	_____	Chlorotoluene(s).....	_____
Freon 113.....	_____	n-Propylbenzene.....	_____
trans-1,2-Dichloroethene.....	_____	p-Ethyltoluene.....	_____
1,1-Dichloroethane.....	_____	1,3,5-Trimethylbenzene.....	_____
cis-1,2-Dichloroethene.....	_____	tert-Butylbenzene.....	_____
Bromochloromethane.....	_____	1,2,4-Trimethylbenzene.....	_____
*Chloroform.....	_____	1,3-Dichlorobenzene.....	_____
2,2-Dichloropropane.....	<u><100</u>	*1,4-Dichlorobenzene.....	_____
1,2-Dichloroethane.....	_____	sec-Butylbenzene.....	_____
1,1,1-Trichloroethane.....	<u>72</u>	p-Isopropyltoluene.....	_____
1,1-Dichloropropene.....	_____	*1,2-Dichlorobenzene.....	_____
*Carbon Tetrachloride.....	_____	n-Butylbenzene.....	_____
Dibromomethane.....	_____	p-Diethylbenzene.....	_____
1,2-Dichloropropane.....	_____	1,2,4,5-Tetramethylbenzene..	_____
Bromodichloromethane.....	_____	1,2,4-Trichlorobenzene.....	_____
*Trichloroethene.....	_____	Naphthalene.....	_____
cis-1,3-Dichloropropene.....	_____	1,2,3-Trichlorobenzene.....	_____
trans-1,3-Dichloropropene....	_____		
1,1,2-Trichloroethane.....	_____		
1,3-Dichloropropane.....	_____	<input type="checkbox"/> <u>Miscellaneous</u>	
Dibromochloromethane.....	_____	Vinyl acetate.....	_____
1,2-Dibromoethane.....	_____	2-Chloroethyl vinyl ether...	_____
*Tetrachloroethene.....	<u>210</u>		
1,1,1,2-Tetrachloroethane....	_____		
Bromoform.....	_____		
1,1,2,2-Tetrachloroethane....	_____		
1,2,3-Trichloropropane.....	_____		
1,2-Dibromo-3-chloropropane..	<u><100</u>		
*Hexachlorobutadiene.....	_____		

RESULTS ARE <40ppb FOR PURGEABLE HALOCARBONS 2/AROMATICS EXCEPT WHERE NOTED.

Analyst Y/C.

Flash Point
 Pensky-Martens Closed Cup Flash Point _____ °C= _____ °F

Analyst _____

Suffolk County Department of Health Services
 Division of Medical-Legal Investigations & Forensic Sciences
 Public & Environmental Health Laboratory
 (Industrial Waste Solid Samples)

Date MAY 03 1996
 Received from Lab
 E. Curcio, P.H. San.

FIELD

Field No. 4MS 4-17
sjc

Laboratory

Lab No. IW-496180
sjc

Name of Firm Former Precision Concepts

Date Completed 4/25/96 *WJ*

Address or Location _____ *Stack - soil*
 _____ *- Interior collection pit*

Remarks/ Instructions _____

TEST	RESULT	TEST	RESULT ug/g (PPM)	TEST	RESULT ug/g (PPM)
pH (Field)		COD		Potassium	370 <i>260</i>
pH (Lab)		Cyanide		>Selenium	<10.
TEST	RESULT	Phenols		>Silver	28.
	ug/g (PPM)	<i>Ⓟ</i> METALS		Sodium	370.
Chloride		Aluminum	270.	Thallium	<25.
Fluoride		Antimony	<10.	Vanadium	<10.
Sulfate		>Arsenic	<10.	Zinc	90.
Sulfite		>Barium	20.		
Sulfide		Beryllium	80. <i>0.16 (0.2, 15)</i>	EP Toxicity	
MBAS		>Cadmium	<2.	TCLP	
TOC		Calcium	1400		
Nitrate - N		>Chromium	200. <i>10 (0.2, 40)</i>		
Nitrite - N		Cobalt	<15.		
Ammonia - N		Copper	4600. <i>25 (1-5)</i>		
TKN		Iron	3000.		
Total Solids		>Lead	320. <i>4-61</i>		
Susp. Solids		Magnesium	70.		
Diss. Solids		Manganese	10.		
TPH		Molybdenum	50.		
Oil & Grease		Nickel	50.		

EP Toxicity and TCLP includes all metals marked with >

SUFFOLK COUNTY DEPARTMENT OF HEALTH SERVICES
DIVISION OF MEDICAL-LEGAL INVESTIGATIONS & FORENSIC SCIENCES
PUBLIC & ENVIRONMENTAL HEALTH LABORATORY
NYSDOH LAB ID. NUMBER 10528

Date MAY 03 1996
Received from Lab
E. Curcio, P.H. San.

SAMPLING ANALYSIS REQUEST/CHAIN OF CUSTODY

Field Number: 5M34-17 Laboratory Number I W 496081
Collected By: SEAMAN Assisted By: GOODE
Affiliation: S.C.D.O.H Date: 4/17/96 Time: 140 PM
Facility/Name FORMER PRECISION CONCRETE
Location: SHIMLEY
Point of Collection: LEACHING POOL ~ 20' BELOW GRADE
Remarks: SOILS

Analysis Requested (By Department)

Air Pollution

- Volatile Organic Hydrocarbons
 Asbestos (Bulk)
- Hazardous Materials (Organics)
 Purgeable Halocarbons 1 (EPA 8260)
 Purgeable Halocarbons 2/ Aromatic Hydrocarbons (EPA 8260)
Preservation HCl Cooled to 4°C
Level of Detection 140 ppb 4 ppb
 Flash Point (EPA 1010)
 Pesticides
Specify Type: _____
 TCLP
 Other _____

Industrial Waste (Inorganics)

- Metals Preserved
 Chromium (Hexavalent)
 E P Toxicity
 TCLP
 Phenols
 Cyanide Preserved
 Chloride, Sulfate
 Fluoride
 Ammonia, Nitrate, Nitrite
 T K N
 Solids (SS, DS, TS)
 M B A S, C O D
 T O C
 Oil & Grease
 pH Indicate Field pH: _____

Total Number of Sample Containers Submitted 2

Custody Section

Relinquished By:

Name MICHAEL S SEAMAN Date 4/17/96
Signature [Signature] Time 3:58 PM

Received By:

Name _____ Date 4-17-96
Signature [Signature] Time 3:58

Name _____ Date _____ Name _____ Date _____
Signature _____ Time _____ Signature _____ Time _____

Name _____ Date _____ Name _____ Date _____
Signature _____ Time _____ Signature _____ Time _____

Suffolk County Department of Health Services
 Division of Medical-Legal Investigations & Forensic Sciences
 Public & Environmental Health Laboratory
 (Industrial Waste Solid Samples)

Date MAY 03 1996
 Received from Lab
 E. Curcio, P.H. San.

FIELD

Field No. 5MS 4-17

Laboratory

Lab No. JW-496081

Name of Firm former Precision Concepts

Date Completed 4/23/96
L.P. Soil

Address or Location _____

Remarks/ Instructions _____

TEST	RESULT	TEST	RESULT ug/g (PPM)	TEST	RESULT ug/g (PPM)
pH (Field)		COD		Potassium	—
pH (Lab)		Cyanide		>Selenium	<10.
TEST	RESULT	Phenols		>Silver	<2.
	ug/g (PPM)	<input checked="" type="checkbox"/> METALS		Sodium	170.
Chloride		Aluminum	1600.	Thallium	<25.
Fluoride		Antimony	<10.	Vanadium	<10.
Sulfate		>Arsenic	<10.	Zinc	<10.
Sulfite		>Barium	<10.		
Sulfide		Beryllium	<1.	EP Toxicity	-
MBAS		>Cadmium	<2.	TCLP	
TOC		Calcium	290.		
Nitrate - N		>Chromium	<10.		
Nitrite - N		Cobalt	<10.		
Ammonia - N		Copper	<10.		
TKN		Iron	1900.		
Total Solids		>Lead	<20.		
Susp. Solids		Magnesium	300.		
Diss. Solids		Manganese	30.		
TPH		Molybdenum	<10.		
Oil & Grease		Nickel	<10.		

EP Toxicity and TCLP includes all metals marked with >

NEW YORK STATE DEPARTMENT OF HEALTH SERVICES
 CENTER FOR FORENSIC SCIENCES
 PUBLIC & ENVIRONMENTAL HEALTH LABORATORY
 NYSDOH LAB ID. NUMBER 10528

DATE MAI 0 2 1990
 Received from Lab
 E. Curcio, P.H. San.

ORGANIC & FLASHPOINT ANALYSIS OF INDUSTRIAL & HAZARDOUS MATERIALS

Lab. No. IW- 496081
 Field No. 5m54-17

Date Completed 7/30/90
 EPA Method (8260)/1010/

Name Former Precision Concepts LP - soil

Remarks _____

* Indicates TCLP Compounds

Compound	ppb	Compound	ppb
<input type="checkbox"/> <u>Purgeable Halocarbons1</u>			
Chlorodifluoromethane.....	_____	Acetone.....	<u><500</u>
Dichlorodifluoromethane.....	_____	*Methyl ethyl ketone.....	<u><500</u>
Trichlorofluoromethane.....	_____	Methyl isobutyl ketone.....	<u><500</u>
*Vinyl Chloride.....	_____	tert-Butyl methyl ether.....	_____
Chloromethane.....	_____	*Benzene.....	_____
Bromomethane.....	_____	Toluene.....	_____
Chloroethane.....	_____	*Chlorobenzene.....	_____
		Ethylbenzene.....	_____
		Xylene(s).....	_____
<input checked="" type="checkbox"/> <u>Purgeable Halocarbons2/Aromatics</u>			
*1,1-Dichloroethene.....	_____	Styrene.....	_____
Methylene Chloride.....	_____	Isopropylbenzene.....	_____
Freon 113.....	_____	Bromobenzene.....	_____
trans-1,2-Dichloroethene.....	_____	Chlorotoluene(s).....	_____
1,1-Dichloroethane.....	_____	n-Propylbenzene.....	_____
cis-1,2-Dichloroethene.....	_____	p-Ethyltoluene.....	_____
Bromochloromethane.....	_____	1,3,5-Trimethylbenzene.....	_____
*Chloroform.....	_____	tert-Butylbenzene.....	_____
2,2-Dichloropropane.....	<u><100</u>	1,2,4-Trimethylbenzene.....	_____
1,2-Dichloroethane.....	<u><100</u>	1,3-Dichlorobenzene.....	_____
1,1,1-Trichloroethane.....	_____	*1,4-Dichlorobenzene.....	_____
1,1-Dichloropropene.....	_____	sec-Butylbenzene.....	_____
*Carbon Tetrachloride.....	<u><100</u>	p-Isopropyltoluene.....	_____
Dibromomethane.....	_____	*1,2-Dichlorobenzene.....	_____
1,2-Dichloropropane.....	_____	n-Butylbenzene.....	_____
Bromodichloromethane.....	_____	p-Diethylbenzene.....	_____
*Trichloroethene.....	_____	1,2,4,5-Tetramethylbenzene..	_____
cis-1,3-Dichloropropene.....	_____	1,2,4-Trichlorobenzene.....	_____
trans-1,3-Dichloropropene...	<u><100</u>	Naphthalene.....	_____
1,1,2-Trichloroethane.....	_____	1,2,3-Trichlorobenzene.....	_____
1,3-Dichloropropane.....	_____		
Dibromochloromethane.....	_____	<input type="checkbox"/> <u>Miscellaneous</u>	
1,2-Dibromoethane.....	_____	Vinyl acetate.....	_____
*Tetrachloroethene.....	_____	2-Chloroethyl vinyl ether...	_____
1,1,1,2-Tetrachloroethane...	_____		
Bromoform.....	<u><100</u>		
1,1,2,2-Tetrachloroethane...	_____		
1,2,3-Trichloropropane.....	_____		
1,2-Dibromo-3-chloropropane..	<u><100</u>		
*Hexachlorobutadiene.....	_____		

RESULTS ARE <40ppb FOR PURGEABLE HALOCARBONS 2/AROMATICS EXCEPT WHERE NOTED.

Analyst LLP

Flash Point
 Pensky-Martens Closed Cup Flash Point _____ °C= _____ °F

Analyst _____