

NEW YORK STATE DEPARTMENT OF ENVIRONMENTAL CONSERVATION
Division of Environmental Remediation

Inactive Hazardous Waste Disposal Report

April 1, 2002

Site Name: Huntington Landfill	Site Code: 152040
Class Code: 4 Region: 1 County: Suffolk	EPA Id: NYD980506844
Address: Town Line Road / Huntington, NY 11743	
Latitude: 40° 52' 42" Longitude: 73° 17' 18"	
Site Type: Landfill	Estimated Size: 54 Acres

Site Owner / Operator Information:

Current Owner(s) Name: Town of Huntington
Current Owner(s) Address: 100 Main Street / Huntington, NY 11743
Owner(s) during disposal: Town of Huntington
Operator(s) during disposal: Town of Huntington
Stated Operator(s) Address: 100 Main Street / Huntington, NY 11743
Hazardous Waste Disposal Period: From: 1935 To: 1989

Site Description:

This closed municipal landfill, located in the northwest portion of Suffolk County, has a confirmed leachate plume in the sole source aquifer. This plume has traveled at least two miles to the northeast. Private residential wells downgradient of the landfill have been contaminated with tetrachloroethylene (PCE) and landfill leachate parameters. These contaminants have also been detected in downgradient monitoring wells. There have been three phases of providing public water to residents whose wells have been or potentially will be impacted by the landfill leachate plume. A Consent Order for a full remedial program was signed on March 26, 1991. The order calls for capping of the landfill concurrent with a Remedial Investigation/Feasibility Study (RI/FS). The Town of Huntington has entered into a state assistance contract which provides for 75% grant funding of eligible costs. In December of 1991, the site boundary was modified to exclude the 12-acre leasehold property, now the site of the Town's resource recovery plant. The Interim Remedial Program (IRP) landfill cap design was completed in July of 1993 by the Town's consultant and approved for construction by the NYSDEC. A second "alternative" design was approved by the NYSDEC on August 3, 1994. The landfill closure system utilizing the "alternative" design (landfill cap and gas collection system) was constructed with the completion in August 1996. Previous environmental reports of the site include a NYSDEC Phase I and numerous groundwater sampling reports by the Town's consultants. The RI/FS was completed in November, 1995. A Record of Decision was signed in March, 1996. A public water supply protection/institutional controls remedy was selected. An outpost monitoring well upgradient of the Gun Club Road public supply well was constructed in January 1997. Monitoring reports are regularly submitted on this site by the Town.

Confirmed Hazardous Waste Disposal:

Heavy metals

Vapor degreasing solvents

Tetrachloroethylene (PCE or "perc.")

Quantity:

unknown

unknown

unknown

Analytical Data Available for:	Air	Groundwater	Surface Water	Sediment
Applicable Standards Exceeded in:	Groundwater	Drinking Water	Surface Water	Air
Geotechnical Information:				Depth to
Soil/Rock Type: Sand and gravel.				Groundwater: Range: 70 to 75 feet.

Legal Action: Type: State Consent Order -EQBA	Status: Order Signed
Remedial Action: Complete	Nature of action: Landfill cap + active gas collection & venting.

Assessment of Environmental Problems:

There is confirmed groundwater contamination at this site. A contaminant plume has moved off-site and affected private drinking water wells. The plume is discharging to the head waters of Sunken Meadow Creek approximately two miles to the northeast of the site.

Assessment of Health Problems:

Downgradient monitoring wells and some private wells were contaminated with inorganic and organic compounds associated with the landfill. At the request of the New York State Department of Health, homes with private wells contaminated with site-related compounds or threatened by the groundwater contaminant plume migrating from the landfill were connected to public water. The cap constructed on the landfill includes a gas collection/control system to prevent the off-site migration of landfill gas. The landfill cap will be maintained on a long-term basis to ensure proper function of the gas control system.

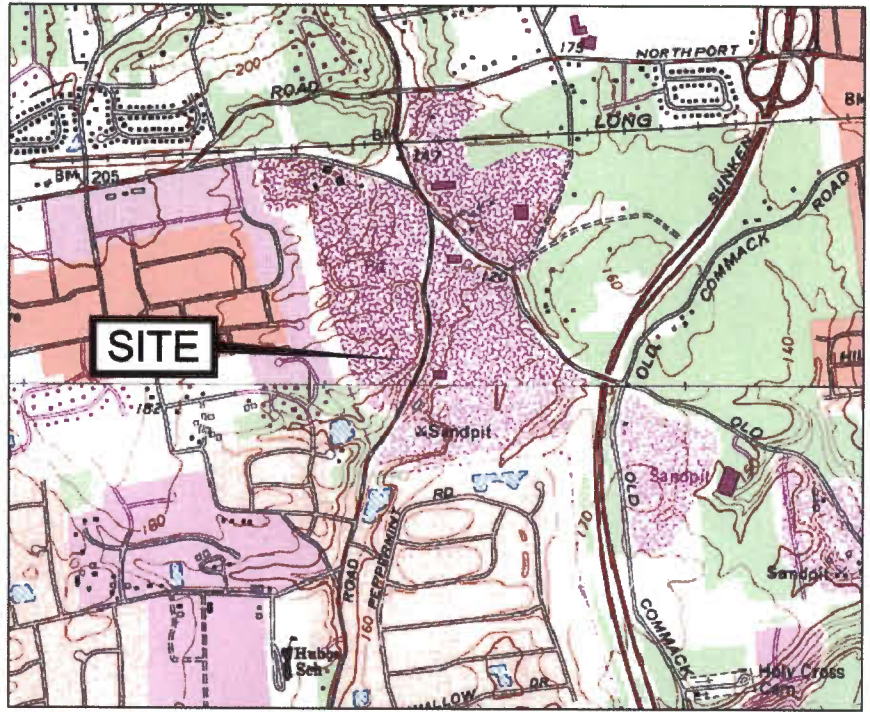

SITE LOCATOR
APPROXIMATE SCALE: 1" = 2000'

LEGEND

- MW-45 ⊕ MONITORING WELL
- EXT-2 ▲ CONTROL WELL
- CD-1 ⊗ CONDENSATE DRAIN
- HEADER PIPE
- ➔ DIRECTION OF LANDFILL GAS FLOW IN HEADER PIPE

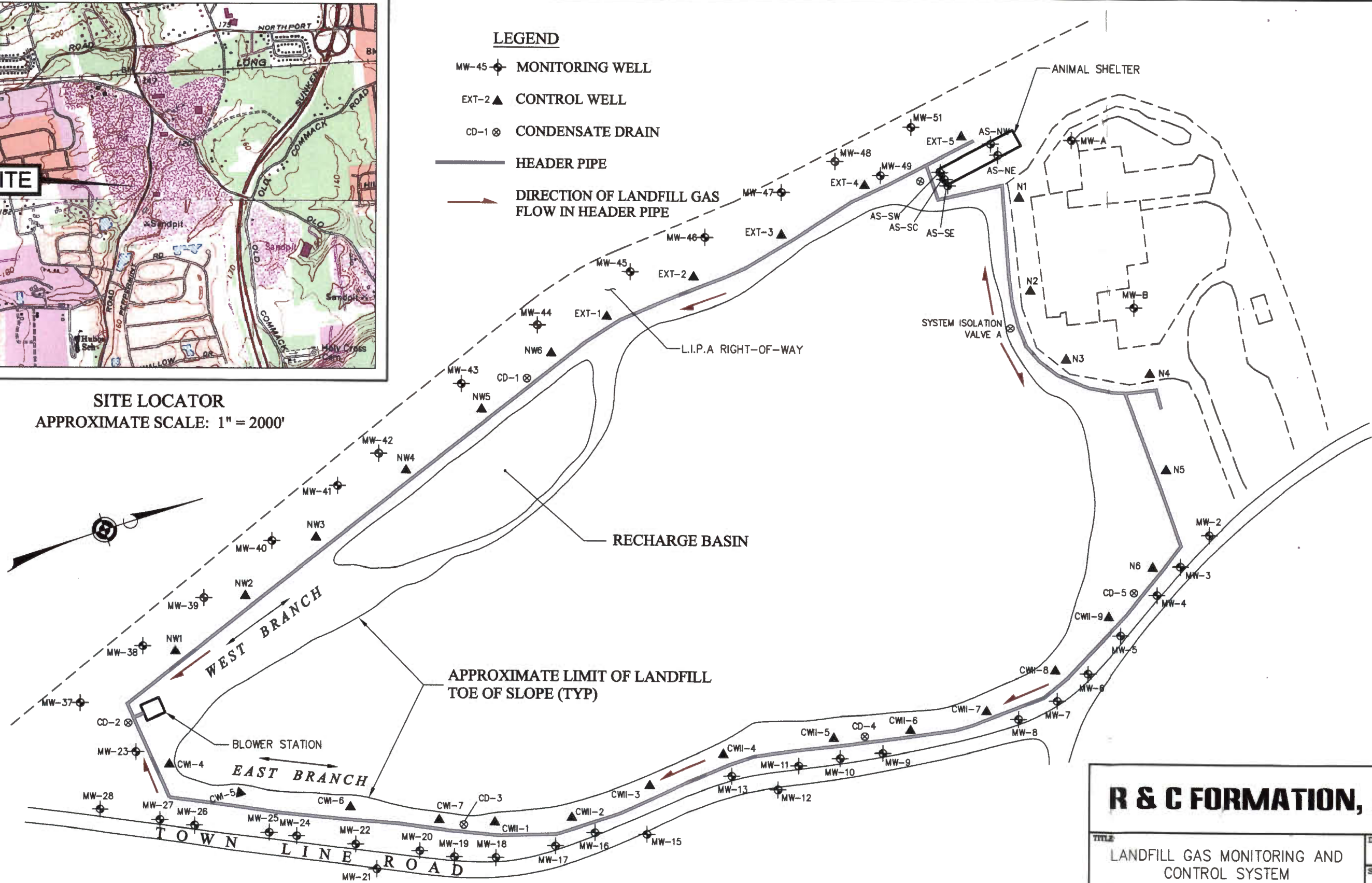

R & C FORMATION, LTD.	
TITLE LANDFILL GAS MONITORING AND CONTROL SYSTEM	DATE 9/22/03
FIGURE 1	SCALE AS SHOWN
DRAWING NO. 01006-1A	
APPR. BY: B.C.	

TOWN OF HUNTINGTON
EAST NORTHPORT LANDFILL
EAST NORTHPORT, NY