

Project: Spectrum Finishing - Remedial Action  
 Contractor: EnviroTrac Environmental Services  
 CDM Job No: D-006956 Site No. 1-52-029  
 CDM Project Manager: John Blaum

CDM  
 100 Crossways Park West  
 Woodbury, NY 11797  
 Telephone: 516.496.8400  
 Fax: 516.496.8864

**DAILY REPORT**

Day: 

S	<b>M</b>	T	W	TH	F	S
---	----------	---	---	----	---	---

  
 Date: 8-Jun-09  
 REPORT No. 159  
 PAGE No. 1

<b>WEATHER</b>	Clear	<b>Partly Cloudy</b>	Overcast	Rain	Snow
<b>TEMP L/H</b>		<b>66/74</b>			
<b>HUMIDITY</b>	Dry	Moderate	<b>High</b>		
<b>WIND</b>	Calm	<b>Light</b>	Moderate	High	
<b>WIND DIR</b>	N	E	S	W	
	<b>NE</b>	SE	SW	NW	

PREPARED BY: F.Robinson TITLE: Inspector

**AVERAGE FIELD FORCE**

Name of Contractor	Title	Hours Worked	Remarks
EnviroTrac	Construction Manager	1x8 hrs	M.Rose
EnviroTrac	Operator	2x8 hrs	J.Byrnes, B.Gimbel
EnviroTrac	Technician	1x8 hrs	K.Davies
Cork and Sons	Operator	1x8 hrs	G.Cork
Cork and Sons	Technician	2x8 hrs	J.Moreno, E.O'Connor
AARCO	Technician	2x3 hrs	M.Bonislowski, J.Morero

**EQUIPMENT AT THE SITE**

I = Idle W = Working

20" Storage Container - W	Cork and Sons: Mack Dump Truck - W
Case 621C Front End Loader - W	Cork and Sons: Case 580 Backhoe - W
CAT 430E Backhoe - W	Cork and Sons: Case CX225SR Excavator - W
CAT 226B skidder - W	AARCO: Guzzler Vac Truck - W

**HEALTH AND SAFETY**

Name	Time (From - To)	Task/Level of PPE
		All workers onsite were in level D-PPE

**CONSTRUCTION ACTIVITIES**

<b>Site Representative:</b> Frank Robinson - CDM
<b>Health and Safety Site Officer:</b> N/A
<b>DESCRIPTION OF WORK PERFORMED AND OBSERVED</b>
1- Tailgate H&S meeting performed before the start of the work day. 2 air monitoring stations were set up for dust and voc's.
2-EnviroTrac collected an end point sample from CP-9 using a hand auger to collect the sample. CP-10 was not samples as it was a septic tank and there was no sediment to sample. Samples will be analyzes for metal EPA 6010 and 7470 and volatiles EPA 8260.
3-Cork and Sons performed the following work: 60 Dale St.: Received a delivery of structures from LI Pre-Cast. Installed PST-5 and PCP-5A and piping from building sewer line to PST-5 and from PST-5 to PCP-5A.. PST-5 was in as hazardous soil area and the excavated material was segregated into the hazardous soil pile. No visible contamination was observed in the excavation.
4-EnviroTrac abandoned the following structures by breaking up the top part of the structure into the bottom of the structure and filling with on site clean material. 51 Cabot St.: DS-5; 61 Cabot St.: DS-4. 50 Dale St.: DS-8.
5-AARCO cleaned out CP-9 and 10 (60 Dale St.) of sludge and sediment.



x - Designates report is continued on additional pages

CDM Site Representative: F. Robinson

Project Manager: John Blaum

**PHOTOGRAPHIC LOG**

**Date: 06/08/09**

**CDM Job No. D-006956**

**Spectrum Finishing Remedial Action**

**SITE No. 1-52-029**

<b>PHOTO</b>	<b>DATE</b>	<b>TIME</b>	<b>DESCRIPTION</b>
100_0771.jpg	6/8/2009	AM	DS-5, 51 Cabot St, abandonment completed
100_0773.jpg	6/8/2009	AM	DS-5, 61 Cabot St, partially abandoned
100_0774.jpg	6/8/2009	AM	DS-4, 61 Cabot St., abandonment completed
100_0775.jpg	6/8/2009	AM	PST-5, 61 Dale St., tank and baffle wall installed
100_0777.jpg	6/8/2009	AM	DS-8, 51 Dale St., abandonment completed
100_0778.jpg	6/8/2009	PM	PCP-5A, 60 Dale St., structure installed
100_0779.jpg	6/8/2009	PM	PST-5, PCP-5A and piping installed, 60 Dale St.

# PHOTOS 6-08-09



100\_0771.jpg - DS-5, 51 Cabot St., abandonment completed



100\_0773.jpg - DS-4, 61 Cabot St., partially abandoned



**100\_0774.jpg - DS-4, 61 Cabot St., abandonment completed**



**100\_0775.jpg - PST-5, 60 Dale St., tank and baffle wall installed**



**100\_0777.jpg - DS-8, 50 Dale St., abandonment completed**



**100\_0778.jpg - PCP-5A, 60 Dale St., structure installed**



100\_0779.jpg - PST-5, PCP-5A and piping installed, 60 Dale St.

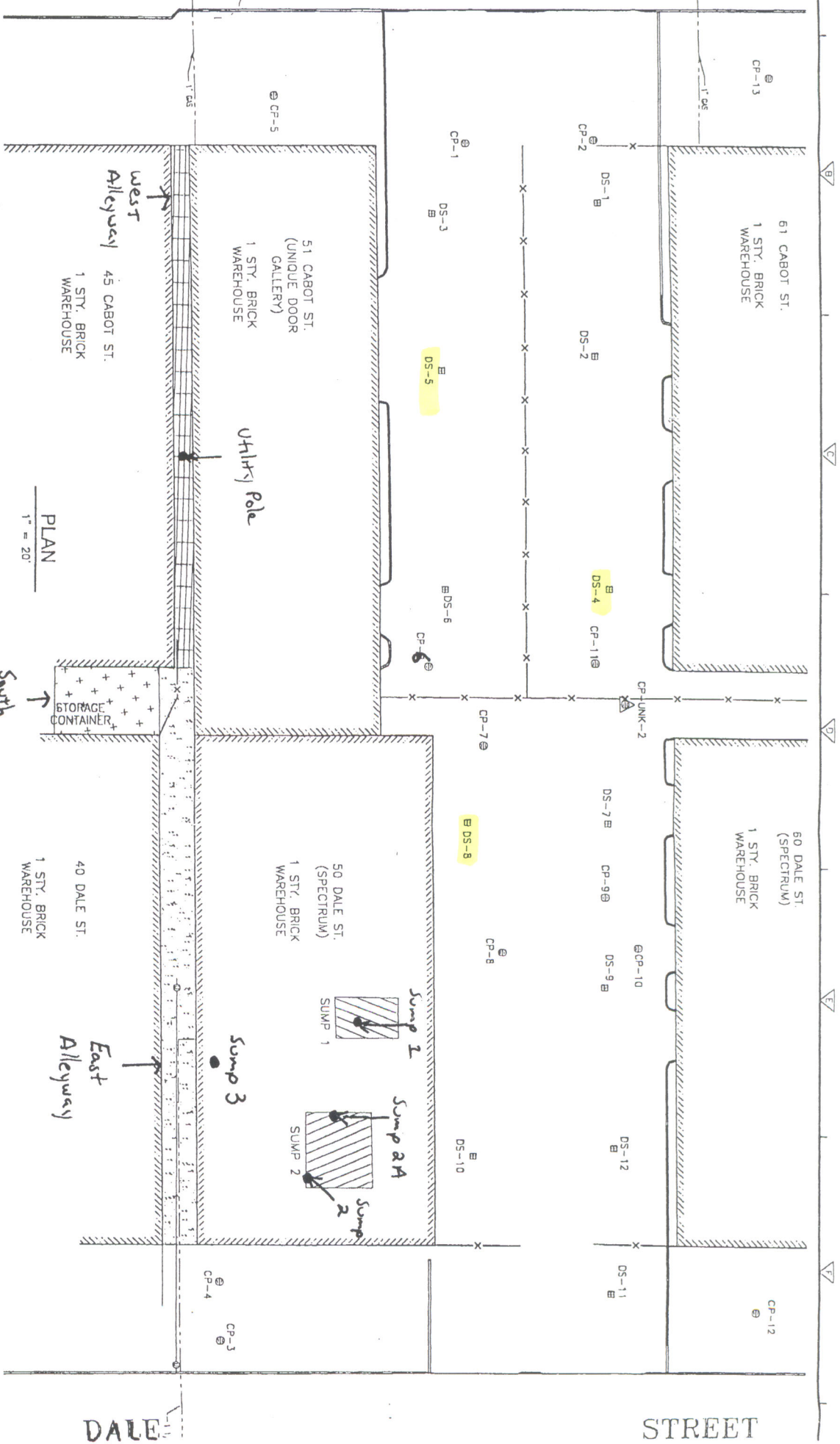

PLAN  
1" = 20'

6/8/09  
Work Areas

DALE

STREET

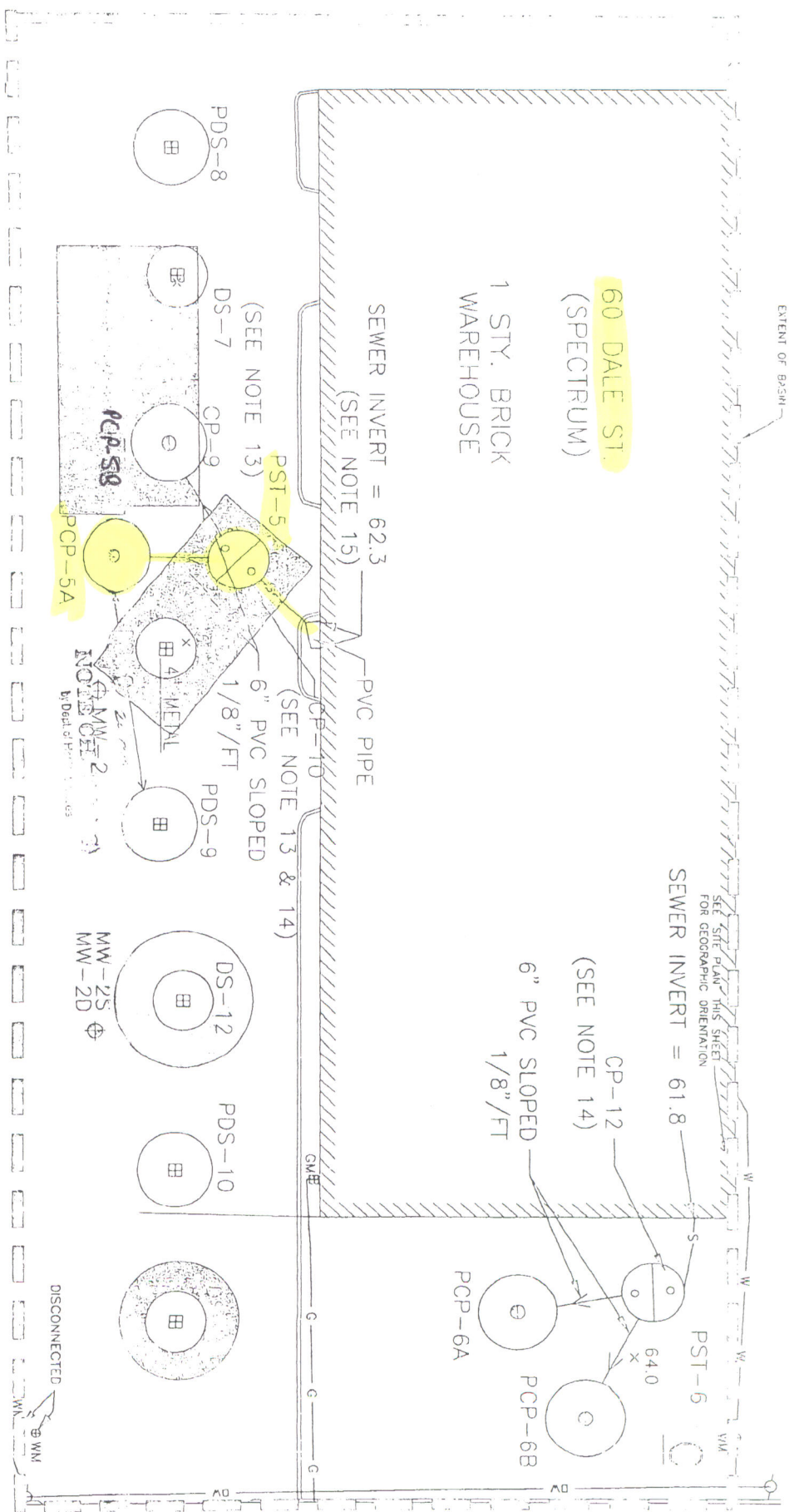

PLAN  
1" = 10'

6/8/09



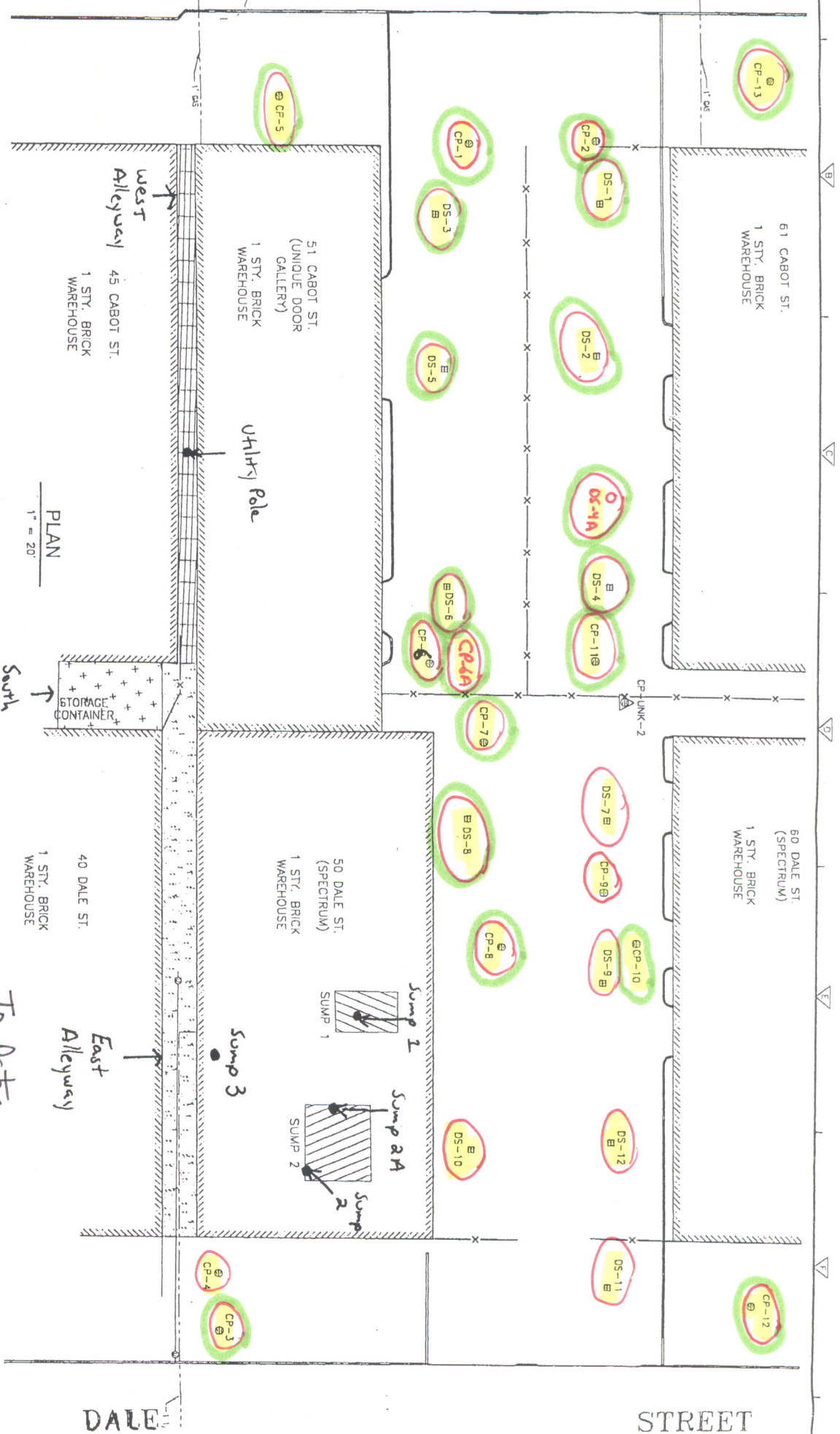

- To Date:
- Structures cleaned out
  - end point sampled
  - Abandoned

NOTE

CP-10 not sampled, it was a tank

<b>NON-HAZARDOUS WASTE MANIFEST</b>		1. Generator's US EPA ID No.	Manifest Doc. No. <b>46718</b>	2. Page 1 of
3. Generator's Name and Mailing Address <i>NISDEC 625 Broadway - 12th Floor Albany NY 12233</i>		5. Date Recd. <i>5/26/09</i>		
4. Generator's Phone ( )		6. US EPA ID Number		
5. Transporter 1 Company Name <b>AARCO ENVIRONMENTAL SERVICES CORP.</b>		6. US EPA ID Number <b>N Y R 0 0 0 1 0 7 3 2 6</b>		A. Transporter's Phone <b>631-586-5900</b>
7. Transporter 2 Company Name		8. US EPA ID Number		B. Transporter's Phone
9. Designated Facility Name and Site Address <i>Earth Care 170 N. 2nd St Deer Park NY</i>		10. US EPA ID Number		C. Facility's Phone
11. Waste Shipping Name and Description			12. Containers	13. Total Quantity
			No.	Type
a. <i>Septic system sludge (non haz-mat)</i>			<i>01</i>	<i>TT 0006 Y</i>
b.				
c.				
d.				
D. Additional Descriptions for Materials Listed Above <i>CA-9</i>			E. Handling Codes for Wastes Listed Above	
15. Special Handling Instructions and Additional Information <b>EMERGENCY PHONE # 631-586-5900</b>				
16. GENERATOR'S CERTIFICATION: I certify the materials described above on this manifest are not subject to federal regulations for reporting proper disposal of Hazardous Waste.				
Printed/Typed Name <i>Frank Robinson</i>		Signature <i>Frank Robinson (for NISDEC)</i>		Month Day Year <i>5 08 09</i>
17. Transporter 1 Acknowledgement of Receipt of Materials				
Printed/Typed Name <i>Michael Bonislawski</i>		Signature <i>B/M</i>		Month Day Year <i>06 08 09</i>
18. Transporter 2 Acknowledgement of Receipt of Materials				
Printed/Typed Name		Signature		Month Day Year
19. Discrepancy Indication Space				
20. Facility Owner or Operator: Certification of receipt of waste materials covered by this manifest except as noted in Item 19.				
Printed/Typed Name		Signature		Month Day Year

GENERATOR

TRANSPORTER

FACILITY

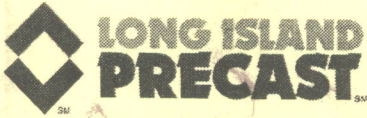

20 Stiriz Road • Brookhaven, NY 11719  
 Tel: (631) 286-0240 • Fax: (631) 286-6313

Order No.	Date <u>6-8</u> 200 <u>9</u>		
Sold To			
Ship To	<u>Cork</u>		
	<u>Gate St - W. Babylon</u>	VIA	<u>UPS</u>
QUANTITY	DESCRIPTION	PRICE	AMOUNT
	Concrete Covers		
<u>1</u>	8' x 4'6" Drain Ring <u>Baffle-wall</u>		
	8' x 4'0" Drain Ring		
	8' x 3'6" Drain Ring		
<u>1</u>	8' x 3'0" Drain Ring <u>Solid Ring</u>		
<u>1</u>	8' x 2'0" Drain Ring <u>MONO-BASE</u>		
	8' x 2'9" Dome		
	8' x 6" Slab		
<u>1</u>	8' x 8" Slab <u>w/20</u>		
	4' - 10" x Manhole w/ Steps		
	1000 gal. Septic Tank		
<u>2</u>	<u>10' x Low Dumps</u>		
	10' x 3' Drain Ring		
	10' x 4' Drain Ring		
<u>4</u>	10' x 5' Drain Ring		
	10' x 3'8" Dome		
<u>1</u>	10' x 8" Slab		
<u>2</u>	<u>6" EXI</u>		
<u>2</u>	1' Extension		
	2' Extension		
	Catch Basin		
<b>A SERVICE CHARGE OF 1.5% PER MONTH WILL BE ADDED TO ALL INVOICES 30 DAYS PAST DUE (AN ANNUAL RATE OF 18%)</b>		FREIGHT	
		TAX	
		TOTAL	
		All claims and returned goods MUST be accompanied by this bill	
<b>NS 57314</b>		Rec'd By	<u>[Signature]</u>