

Project: Spectrum Finishing - Remedial Action
 Contractor: EnviroTrac Environmental Services
 CDM Job No: D-006956 Site No. 1-52-029
 CDM Project Manager: John Blaum

CDM
 100 Crossways Park West
 Woodbury, NY 11797
 Telephone: 516.496.8400
 Fax: 516.496.8864

DAILY REPORT

Day:

S	M	T	W	TH	F	S
---	---	----------	---	----	---	---

 Date: 5-May-09
 REPORT No. 136
 PAGE No. 1

WEATHER	Clear	Partly Cloudy	Overcast	Rain	Snow
TEMP L/H		52/55			
HUMIDITY	Dry	Moderate	High		
WIND	Calm	Light	Moderate	High	
WIND DIR	N	E	S	W	
	NE	SE	SW	NW	

PREPARED BY: F.Robinson TITLE: Inspector

AVERAGE FIELD FORCE

Name of Contractor	Title	Hours Worked	Remarks
EnviroTrac	Construction Manager	1x8 hrs	M. Rose
EnviroTrac	Operator	2x8 hrs	B.Gimbel, J. Byrnes
EnviroTrac	Technician	2x8 hrs	K.Davies, R. Maletta

EQUIPMENT AT THE SITE

I = Idle W = Working

20" Storage Container - W	Komatsu PC78MR Excavator with concrete breaker - W
Case CX130 Excavator - W	
Case 621D Front End Loader - W	
Daewoo 450 skidder - W	

HEALTH AND SAFETY

Name	Time (From - To)	Task/Level of PPE
		All workers onsite were in level D-PPE

CONSTRUCTION ACTIVITIES

Site Representative: Frank Robinson - CDM
Health and Safety Site Officer: N/A
DESCRIPTION OF WORK PERFORMED AND OBSERVED
1-Tailgate H&S meeting performed before the start of the work day.
2-EnviroTrac continued to break up the stockpiled concrete for disposal.
3-The cover to CP-8 fell into the structure due to breaking up the concrete above it. A steel frame was not originally installed to keep the cover in place. A protective steel plate (from ARRCO's shop) was placed over the hole.
4-3 truckloads of concrete was transported to the disposal facility, Clean Earth, by J&D Trucking, Inc. of Vineland, NJ.

x - Designates report is continued on additional pages

CDM Site Representative: F. Robinson

Project Manager: John Blaum

PHOTOGRAPHIC LOG
5-May-09
CDM Job No. D-006956
Spectrum Finishing Remedial Action
SITE No. 1-52-029

PHOTO	DATE	TIME	DESCRIPTION
100_00550.jpg	5/5/2009	AM	CP-8 cover that fell in
100_00553.jpg	5/5/2009	AM	Steel plate covering CP-8 opening
100_00554.jpg	5/5/2009	AM	Loading concrete into dump truck for disposal
100_00555.jpg	5/5/2009	PM	Site at the end of the day with broken up concrete awaiting disposal

PHOTOS 5/05/09



100_00550.jpg - CP-8 cover that fell in



100_00553.jpg - Steel plate covering CP-8 opening



100_00554.jpg - Loading concrete into a dump truck for disposal



100_00555.jpg - Site at the end of the day with broken up concrete awaiting disposal.

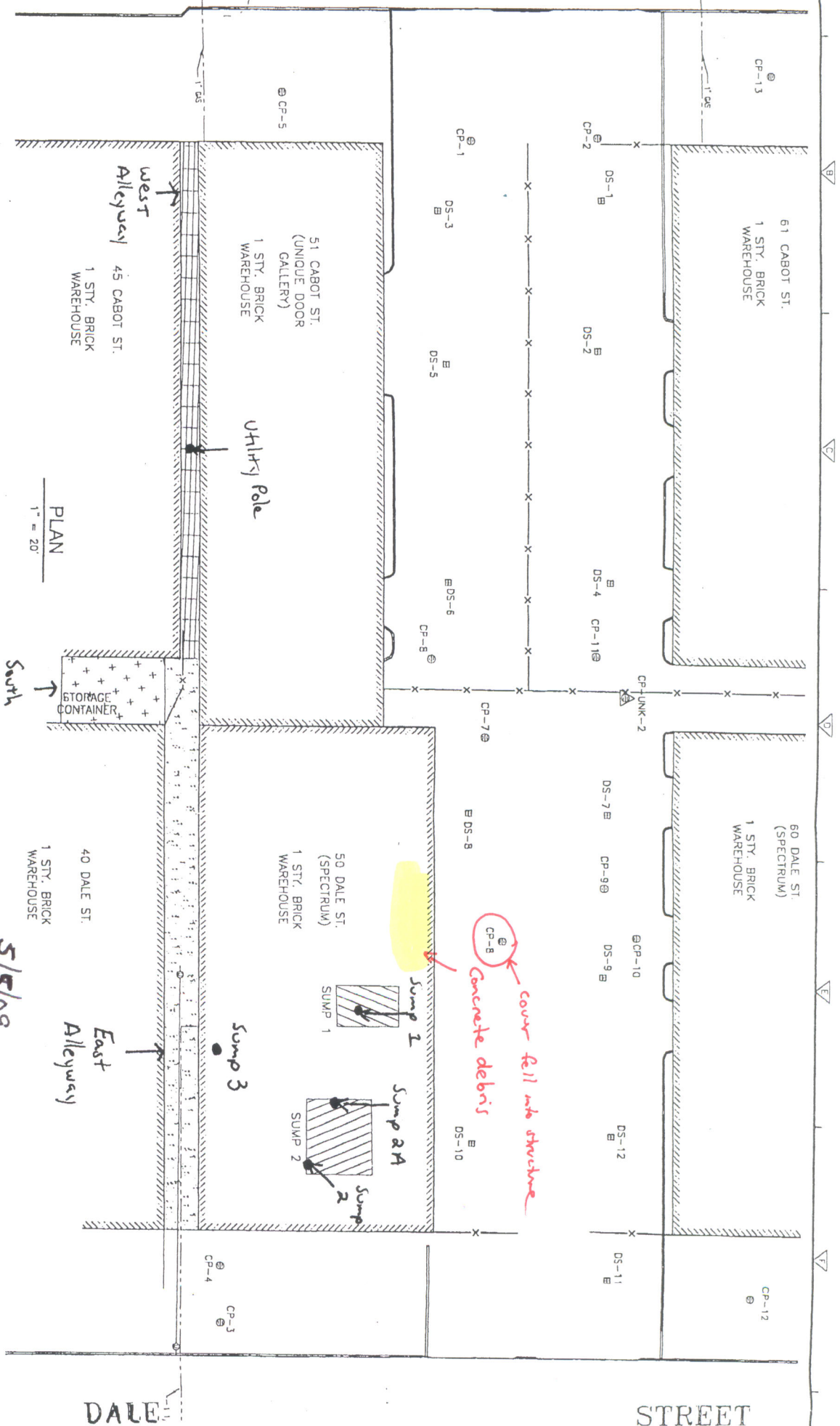

5/5/09
Work Areas

DALE

STREET

GENERATOR	NON-HAZARDOUS WASTE MANIFEST	1. Generator ID Number <i>273</i>	2. Page 1 of <i>1 of 1</i>	3. Emergency Response Phone <i>(631) 586-5900</i>	4. Waste Tracking Number <i>CEI 308000008519</i>
	5. Generator's Name and Mailing Address NYSDEC 625 Broadway - 12th Floor Albany, NY 10001 Generator's Phone: <i>(631) 586-5900</i>		Generator's Site Address (if different than mailing address) Spectrum Finishings 50 Dale Street West Babylon, NY 11702		
TRANSPORTER	6. Transporter 1 Company Name J & D TRUCKING INC. <i>#24</i>		U.S. EPA ID Number <i>178-000025567</i>		
	7. Transporter 2 Company Name		U.S. EPA ID Number		
DESIGNATED FACILITY	8. Designated Facility Name and Site Address Clean Earth of North Jersey, Inc. 105 Jacobus Ave South Kearny, NJ 07032 Facility's Phone: <i>(973) 344-4004</i>		U.S. EPA ID Number NJD991291105		
	9. Waste Shipping Name and Description		10. Containers		11. Total Quantity
	1. NON REGULATED MATERIAL ID27		No.	Type	12. Unit Wt./Vol.
	2.				
	3.				
	4.				
	13. Special Handling Instructions and Additional Information (1) 100% CONCRETE 3'X3'		CEI 308000008519 App: 093080773		
14. GENERATOR'S CERTIFICATION: I certify the materials described above on this manifest are not subject to federal regulations for reporting proper disposal of Hazardous Waste.					
Generator's/Officer's Printed/Typed Name <i>Frank Robinson</i>		Signature <i>Frank Robinson (NYSDEC)</i>		Month <i>05</i>	Day <i>05</i>
15. International Shipments <input type="checkbox"/> Import to U.S. <input type="checkbox"/> Export from U.S.		Port of entry/exit: _____ Date leaving U.S.: _____			
16. Transporter Acknowledgment of Receipt of Materials					
Transporter 1 Printed/Typed Name <i>ADDA GOUVER</i>		Signature <i>[Signature]</i>		Month <i>05</i>	Day <i>05</i>
Transporter 2 Printed/Typed Name		Signature		Month	Day
17. Discrepancy					
17a. Discrepancy Indication Space <input type="checkbox"/> Quantity <input type="checkbox"/> Type <input type="checkbox"/> Residue <input type="checkbox"/> Partial Rejection <input type="checkbox"/> Full Rejection					
Manifest Reference Number: _____					
17b. Alternate Facility (or Generator)		U.S. EPA ID Number			
Facility's Phone:					
17c. Signature of Alternate Facility (or Generator)				Month	Day
18. Designated Facility Owner or Operator: Certification of receipt of materials covered by the manifest except as noted in Item 17a					
Printed/Typed Name		Signature		Month	Day

18-AJ104R-CEX04

NON-HAZARDOUS WASTE MANIFEST	1. Generator ID Number	2. Page 1 of 1	3. Emergency Response Phone (631) 586-5900	4. Waste Tracking Number CEI 308000008521		
	5. Generator's Name and Mailing Address NYSDEC 625 Broadway -12th Floor Albany, NY 10001 Generator's Phone: (631) 586-5900		Generator's Site Address (if different than mailing address) Spectrum Finishings 50 Dale Street West Babylon, NY 11702			
6. Transporter 1 Company Name J & D TRUCKING INC.		7. Transporter 2 Company Name		U.S. EPA ID Number NJR 50002467		
8. Designated Facility Name and Site Address Clean Earth of North Jersey, Inc. 105 Jacobus Ave South Kearny, NJ 07032 Facility's Phone: (973) 344-4004		U.S. EPA ID Number NJ0991291105				
GENERATOR	9. Waste Shipping Name and Description	10. Containers		11. Total Quantity	12. Unit Wt./Vol.	
		No.	Type			
	1. NON REGULATED MATERIAL ID27		DT	27	Y	ID27
	2.					
	3.					
4.						
13. Special Handling Instructions and Additional Information (1) 100% CONCRETE 3'X3' CEI 308000008521 App: 093080773						
14. GENERATOR'S CERTIFICATION: I certify the materials described above on this manifest are not subject to federal regulations for reporting proper disposal of Hazardous Waste.						
Generator's/Offor's Printed/Typed Name Frank Robinson		Signature Frank Robinson (C.N. No. 09)		Month Day Year 05/05/09		
15. International Shipments <input type="checkbox"/> Import to U.S. <input type="checkbox"/> Export from U.S. Port of entry/exit: Date leaving U.S.:						
16. Transporter Acknowledgment of Receipt of Materials						
Transporter 1 Printed/Typed Name LEACH, E. C.		Signature [Signature]		Month Day Year 05/05/09		
Transporter 2 Printed/Typed Name		Signature		Month Day Year		
17. Discrepancy						
17a. Discrepancy Indication Space <input type="checkbox"/> Quantity <input type="checkbox"/> Type <input type="checkbox"/> Residue <input type="checkbox"/> Partial Rejection <input type="checkbox"/> Full Rejection						
Manifest Reference Number:						
17b. Alternate Facility (or Generator)				U.S. EPA ID Number		
Facility's Phone:						
17c. Signature of Alternate Facility (or Generator)				Month Day Year		
18. Designated Facility Owner or Operator: Certification of receipt of materials covered by the manifest except as noted in Item 17a						
Printed/Typed Name		Signature		Month Day Year		

NON-HAZARDOUS WASTE MANIFEST	1. Generator ID Number	2. Page 1 of 1 of 1	3. Emergency Response Phone (631) 586-5900	4. Waste Tracking Number CEI 308000008520	
	5. Generator's Name and Mailing Address NYSDEC 625 Broadway -12th Floor Albany, NY 10001 (631) 586-5900		Generator's Site Address (if different than mailing address) Spectrum Finishings 50 Dale Street West Babylon, NY 11702		
6. Transporter 1 Company Name J & D TRUCKING INC.			U.S. EPA ID Number VT8C00029967		
7. Transporter 2 Company Name			U.S. EPA ID Number		
8. Designated Facility Name and Site Address Clean Earth of North Jersey, Inc. 105 Jacobus Ave South Kearny, NJ 07032 Facility's Phone: (973) 344-4004			U.S. EPA ID Number NJD991291105		
9. Waste Shipping Name and Description		10. Containers		11. Total Quantity	12. Unit Wt./Vol.
		No.	Type		
1. NON REGULATED MATERIAL ID27			DT	86 Y	ID27
2.					
3.					
4.					
13. Special Handling Instructions and Additional Information (1) 100% CONCRETE 3'X3' CEI 308000008520 App: 093080773					
14. GENERATOR'S CERTIFICATION: I certify the materials described above on this manifest are not subject to federal regulations for reporting proper disposal of Hazardous Waste.					
Generator's/Offeror's Printed/Typed Name Frank Robinson			Signature Frank Robinson (Clean Earth)		Month Day Year 5 5 09
15. International Shipments <input type="checkbox"/> Import to U.S. <input type="checkbox"/> Export from U.S. Port of entry/exit: _____ Transporter Signature (for exports only): _____ Date leaving U.S.: _____					
16. Transporter Acknowledgment of Receipt of Materials					
Transporter 1 Printed/Typed Name CLAUDE GRAY			Signature Claude Gray		Month Day Year 5 5 09
Transporter 2 Printed/Typed Name			Signature		Month Day Year
17. Discrepancy					
17a. Discrepancy Indication Space <input type="checkbox"/> Quantity <input type="checkbox"/> Type <input type="checkbox"/> Residue <input type="checkbox"/> Partial Rejection <input type="checkbox"/> Full Rejection					
Manifest Reference Number: _____					
17b. Alternate Facility (or Generator)				U.S. EPA ID Number	
Facility's Phone: _____					
17c. Signature of Alternate Facility (or Generator)				Month Day Year	
18. Designated Facility Owner or Operator: Certification of receipt of materials covered by the manifest except as noted in Item 17a					
Printed/Typed Name			Signature		Month Day Year