

September 10, 2003

Mr. Joseph Jones  
Bureau of Eastern Remedial Action  
Division of Environmental Remediation  
New York State Department of  
Environmental Conservation  
625 Broadway  
Albany, NY 12233

Re: Site Numbers 1-30-009 and 1-30-053A  
Second Quarter 2003 Progress Report

File: 643.001

Dear Mr. Jones:

Enclosed please find three copies of the First Quarter 2002 Progress Report for the subject sites.

Should you have any questions regarding the enclosed, please feel free to contact Charlie Nehrig at 516-609-1052. Thank you.

Very truly yours,

BARTON & LOGUIDICE, P. C.

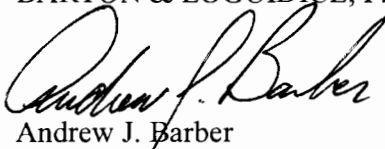

Andrew J. Barber  
Senior Managing Environmental Scientist

AJB/mfg

cc: G. Anders Carlson, Ph.D., NYSDOH, Albany, NY (2 copies)  
Robert Becherer, NYSDEC, Region 1, Stony Brook, NY (1 copy)  
John F. Byrne, Esq., NYSDEC-DEE, Tarrytown, NY (1 copy)  
James Harrington, NYSDEC, Albany, NY (1 copy)  
Charlie Nehrig, Photocircuits (1 copy)  
Louis Stans, Photocircuits (1 copy)  
Mark Pennington, Esq., Morgan, Lewis & Bockius (1 copy)

26, 22





**SECOND QUARTER 2003  
PROGRESS REPORT**

**PHOTOCIRCUITS AND FORMER PASS & SEYMOUR SITES  
31 & 45 SEA CLIFF AVENUE**

**SITE NUMBERS 1-30-009 AND 1-30-053A**

*Prepared for:*  
Photocircuits Corporation  
31 Sea Cliff Avenue  
Glen Cove, New York 11542



*Prepared by:*  
Barton and Loguidice, P.C.  
2 Corporate Plaza  
264 Washington Avenue Extension  
Albany, New York 12203

July, 2003

## **1.0 Introduction**

This Second Quarter 2003 Progress Report (2Q03) is being submitted pursuant to the 1997 Order on Consent between Photocircuits Corporation and the New York State Department of Environmental Conservation (NYSDEC).

During the Second Quarter of 2003, the following was accomplished:

- One groundwater sampling event was conducted for monitoring wells located on both the 31 and 45A Sea Cliff Avenue sites during the period of April 28-29.
- The Soil Vapor Extraction (SVE) and Air Sparging (AS) system at the 45A Sea Cliff Avenue site was modified, and operation was continued through the second quarter of 2003.
- Installation of the hydraulic control system was completed at the 31 Sea Cliff Avenue site, and the system was started.

## **2.0 Discussion of Results**

### **2.1 SVE System at 31 Sea Cliff Avenue**

The SVE system at the 31 Sea Cliff Avenue site was installed as an Interim Remedial Measure (IRM), and started operation in April 2000. The SVE system, equipped with the CatOx/scrubber for extracted vapor treatment, was restarted on July 21, 2000 and was operated continuously until August 2001 (except for a few brief periods for maintenance activities, and in March to mid-May, 2001 because of high water-table conditions). As discussed in the 2Q01 report, the results of vapor sample analyses and the photoionization detector (PID) readings demonstrate that contaminant mass removal versus time has clearly become asymptotic. We conclude that we have demonstrated that there is little or no residual contamination in the unsaturated zone, and that further contaminant removal from the unsaturated zone is infeasible. The SVE system is in the process of being decommissioned.

### **2.2 Bioremediation Pilot Test**

The bioremediation pilot test was started during the week of August 28, 2000 when Terra Systems conducted the injection of a nutrient solution (substrate) into the subsurface at the 31 Sea Cliff Avenue site. Following the injection, groundwater samples were collected from the following monitoring wells/points: MW-7, MW-14, SMP-1, DMP-1, SMP-3, DMP-3, SMP-4 and DMP-4. These wells/points were sampled again on October

18-19, December 20, 2000, March 27-28, 2001 and July 11-12, 2001; the March and July sampling events included several wells located along Sea Cliff Avenue (MW-8, MW-9, MW-12 and MW-13) along with the wells sampled during the previous events. By letter dated October 25, 2001, NYSDEC authorized an additional injection of substrate that had been recommended by Photocircuits. A first phase of additional substrate injection was conducted during the period of February 25 to March 3, 2002; during this period, slightly over 5,000 gallons of substrate was injected (as reported in the 1Q 02 report). On April 29, 2002, an additional injection of 5,777 gallons of substrate was injected using the injection points that had been installed during the February-March injection event. Sampling events conducted in 2002 were January 8-10, April 2-4, June 25-26 and October 2-3. Sampling in 2003 was conducted on January 13-15

The most recent sampling event was conducted on April 28-29, 2003; the results from the April 2003 sampling event are provided in Appendix A of this report (Note: well MW-7 was not sampled during this event as it was filled with oil substrate).

A status report on the pilot test (including the data from the samples collected in April 2003) was prepared by Terra Systems and is included as Appendix B of this report. The main conclusion of the report are as follows

- The addition of the edible oil substrate has enhanced the extent and rate of chlorinated solvent biodegradation at the site; degradation rates as high as 213 ug/L per day of total volatile organic compounds (TVOCs) have been observed in areas of higher concentration.
- A first order degradation half life of 456 days was calculated for the average total VOC concentration within the pilot cell area (January 2003 data); this degradation rate suggests that 90% of the total VOC mass within the pilot test cell will be removed within 43 months.
- The newly injected edible oil substrate appears to be adequately distributed.
- Bioremediation will be the primary treatment technology for contaminant destruction at the site.

### **2.3 IRM at 45 Sea Cliff Avenue**

As discussed in the 4Q 2000 report, SVE/AS equipment was procured and delivered to the site. The SVE/AS system consists of a 10 horsepower (hp) regenerative blower and 5 hp compressor, along with electrical controls, filters, moisture separators, and valves; the system is contained within an insulated trailer, which has been located just outside of Building 7. Following delivery, the system components were connected to the piping networks for the AS and SVE wells. Two 1200 lb activated carbon adsorbers were attached in series to the blower outlet to treat recovered vapors. The SVE system was

started on November 1, 2000; because the initial contaminant concentrations were relatively high, the AS portion of the system was not started. The AS component of this system was started on March 28, 2001. The system was down from April 20-24 due to an electrical problem. The system was down most of June and July due to equipment overheating; the system was re-started on July 30 and shut down on September 20.

Monitoring data was presented in the 2Q01 report, including data from sampling of individual SVE wells (March 2001) and sampling of total SVE system effluent over time. Prior to the start of the AS component, the relationship of total contaminant mass removal versus time was clearly becoming asymptotic. The start of the AS component increased contaminant mass recovery somewhat (see the April 2001 sample results). However, the results of the May vapor sample indicate that mass removal versus time relationship became asymptotic. We concluded at that time that we demonstrated that there is little or no residual contamination at that location, and that further contaminant removal is infeasible.

Based on results from the January 2002 groundwater sampling event, Photocircuits proposed extending the SVE/AS system at the 45A Sea Cliff Avenue site from the west side to the east side of Building 7. The basis for the extension of the system and the proposed piping and equipment layout were provided in the February 13, 2002 letter to NYSDEC.

The SVE wells and AS points were installed at the proposed locations on the east side of Building 7 in late February, 2002 in preparation for the extension of the system. After field evaluation, it was decided that it would be more efficient to move the aboveground portions of the system (equipment trailer, carbon vessels) to the east side of Building 7 rather than to extend their operation by piping from the west side to the east side of Building 7, as originally proposed. The trailer and carbon vessels were moved in April, and electrical service was also provided to the new location April. Piping and mechanical connections were completed in early May; the original blower malfunctioned and a smaller replacement blower was installed.

The SVE portion system was started on May 8, 2002, and a sample of the total system effluent, prior to treatment, was collected; tetrachloroethene was detected at a concentration of 5.3 ppmv. Another effluent sample was collected on June 26; tetrachloroethene was detected at a concentration of 142 ppmv and trichloroethene was detected at a concentration of 2 ppmv. Further sampling in 2002 was conducted on October 3, December 12 (tetrachloroethene was detected at 1.2 and 1.1 ppmv in these two samples, respectively). The AS portion of the system was started on December 11, 2002. A sample was collected on January 15, 2003, with tetrachloroethene detected at 1.0 ppmv.

On May 1, 2003, the system was modified to also extract vapor from monitoring well MW-4S. The well was fitted with a cap and connected to the SVE portion of the system. Samples of system effluent were collected on May 2 and May 28, 2003, with tetrachloroethene detected at 0.9 and 1.6 ppmv, respectively. Groundwater samples were

collected from monitoring wells located on the 45A Sea Cliff Avenue site (MW-1S, -2S, -3S and -4S) during the April 2003 groundwater sampling event, and the results are attached.

#### **2.4 Hydraulic Control along Sea Cliff Avenue**

A meeting was held with NYSDEC on October 11, 2001 to discuss the progress of the bioremediation pilot test. Although there was substantial disagreement between Photocircuits and the NYSDEC over the progress of the bioremediation pilot test and the need for groundwater remediation, Photocircuits agreed to review available options for containment of groundwater along the northern boundary of the Photocircuits site (31 Sea Cliff Avenue). Photocircuits conducted the review of remedial options, and by letter dated October 26, 2001, Photocircuits presented the results of the review. The recommended approach for the conditions at the Photocircuits site is the use of hydraulic control. Photocircuits submitted a work plan for the performance of pumping tests necessary for the design of a hydraulic control system on November 13, 2001; following receipt of verbal comments from NYSDEC, Photocircuits submitted a revised work plan on December 7, 2001. Approval for implementation of the work plan was received from NYSDEC by letter dated December 19, 2001. The pumping tests were performed in January, 2002 and the remedial design report was submitted to NYSDEC on April 11, 2002. NYSDEC approval of the remedial design was received in a letter dated September 19, 2002.

Four recovery wells were installed in January, 2003. The fifth recovery well could not be installed due to the proximity of numerous underground utility lines. Groundwater modeling conducted for the design of the hydraulic control system (appended to the remedial design report/work plan) indicates that configuration of the four wells is also capable of providing hydraulic control in the subject area. The wells were installed to depths of 80 feet below grade and were constructed as described in the work plan.

The pumps, piping and control systems were installed during the week of April 28, 2003. The layout of the piping and controls are provided on the attached figure. The system was started up on May 1, 2003, with each well pumping at an initial flow rate of one gallon per minute (gpm). On May 20, the pumping rate for each well was increased to three gpm. Water level measurements were collected prior to initiating pumping, after about three weeks pumping at one gpm and the day following the increase in pumping to three gpm; this data is provided in the attached tables and is plotted on the attached figures. These figures demonstrate that hydraulic control is being achieved in the area hydraulically downgradient of the bioremediation pilot test area, as evidenced by the alteration in the groundwater flow contours. Water quality samples were collected on May 20, and the data from the sample analyses is provided in the attached tables.

### **3.0 Schedule**

The planned schedule of activities for the next few months is attached.

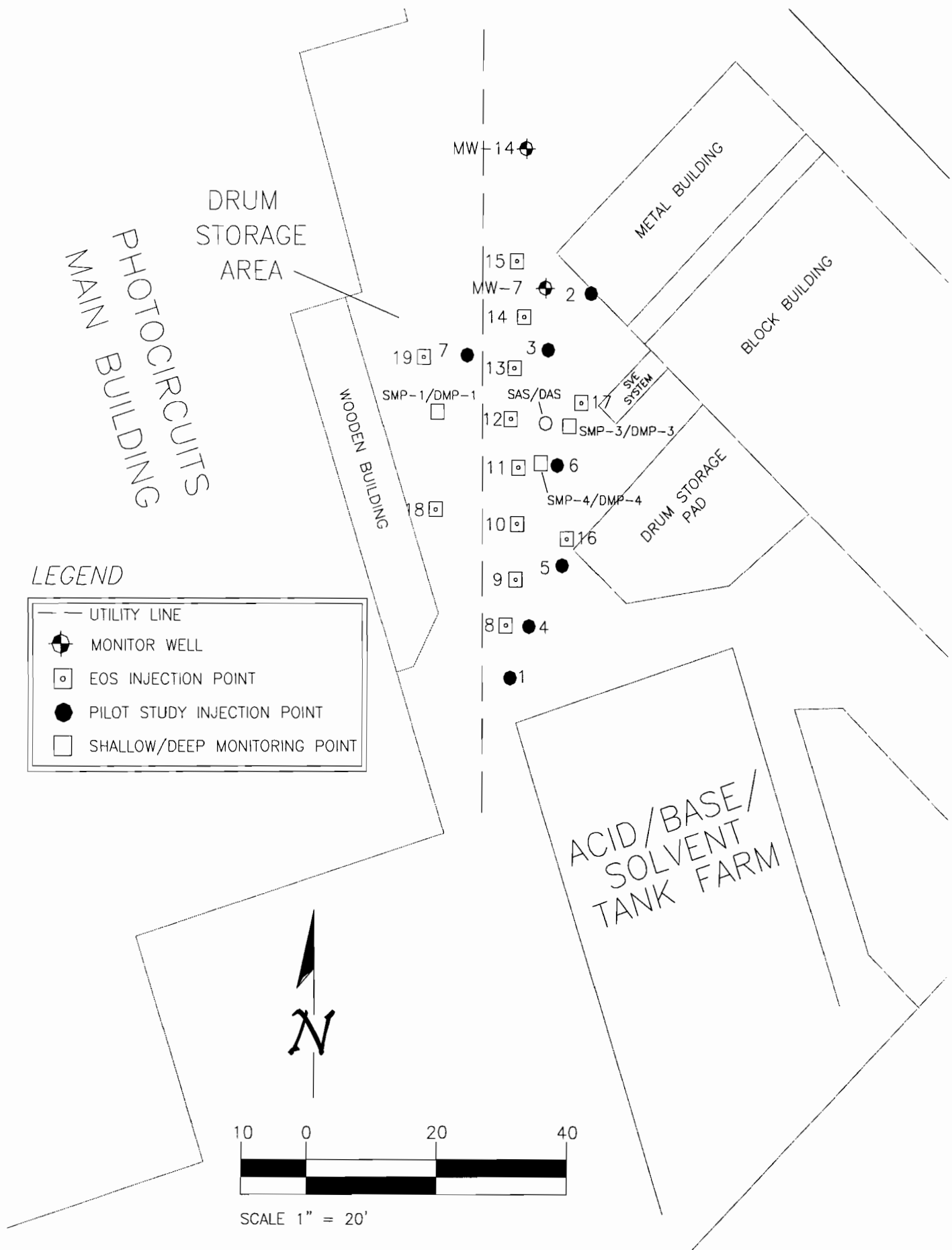

LEGEND

- — UTILITY LINE
- ⊕ MONITOR WELL
- EOS INJECTION POINT
- PILOT STUDY INJECTION POINT
- SHALLOW/DEEP MONITORING POINT

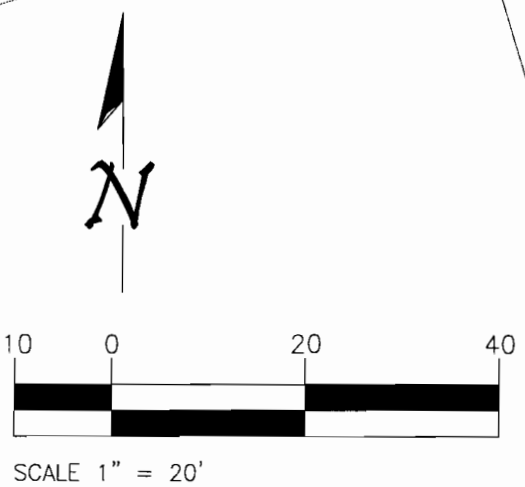



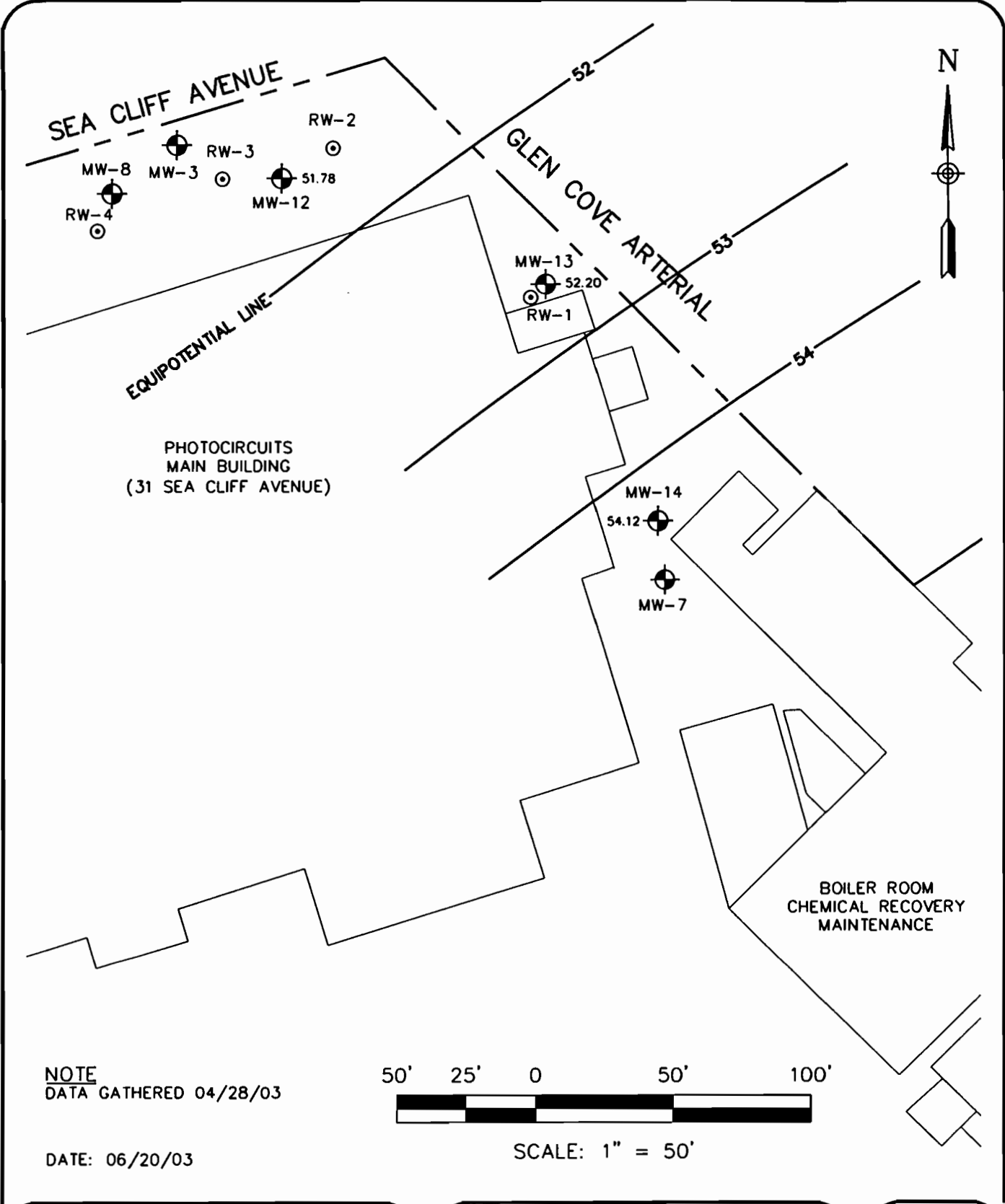

NOTE  
DATA GATHERED 04/28/03

DATE: 06/20/03



SCALE: 1" = 50'

**Barton & Loguidice, P.C.**  
Consulting Engineers  
2 Corporate Plaza 264 Washington Avenue Extension Albany, NY 12203-6352

PHOTOCIRCUITS CORP.  
**PIEZOMETRIC SURFACE FOR INTERMEDIATE DEPTH**  
INTERMEDIATE DEPTH  
PRIOR TO PUMPING  
TOWN OF GLEN COVE NASSAU COUNTY, NY

FIGURE  
**1**  
PROJECT NO.  
643.001

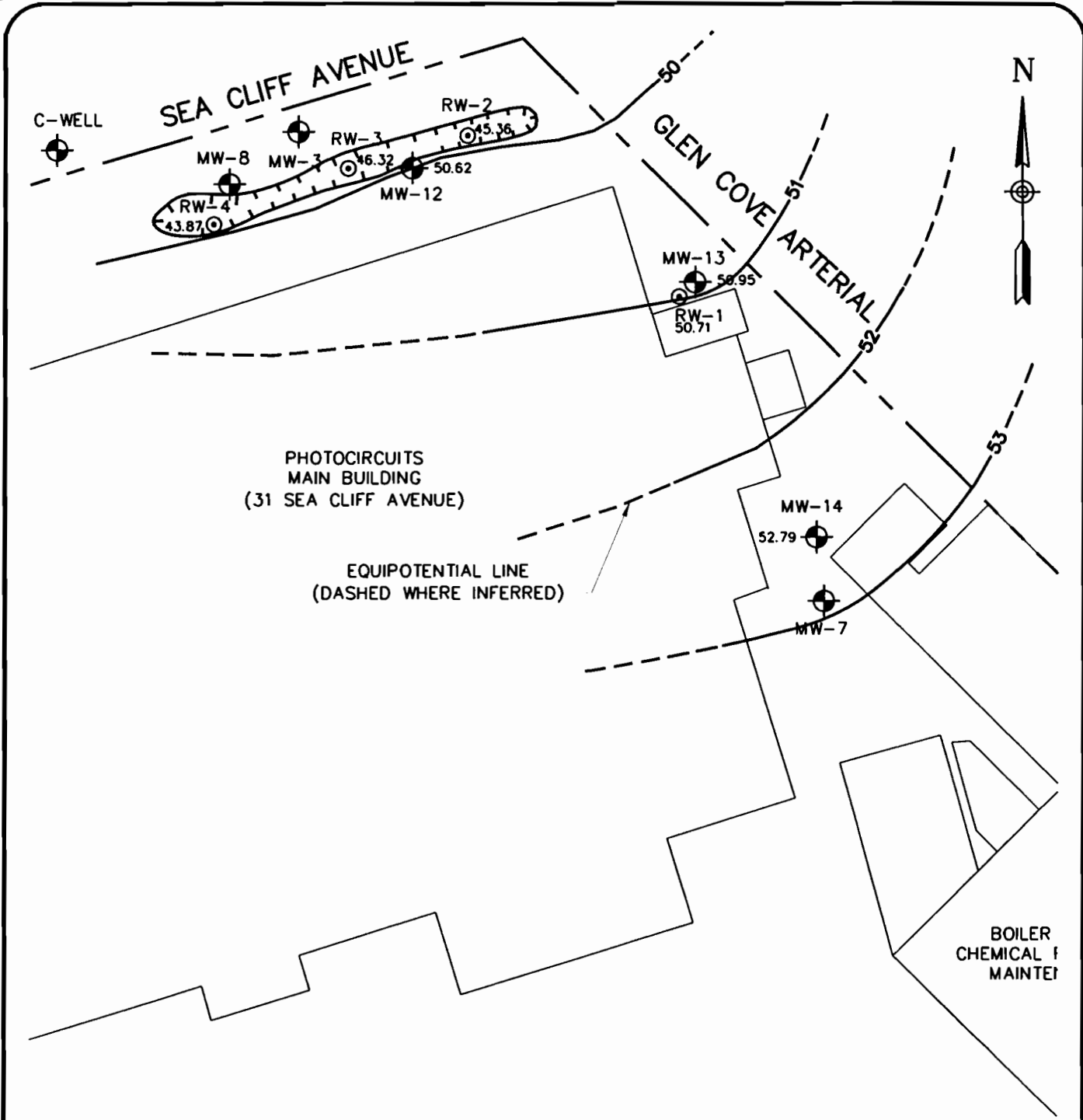

NOTE  
DATA GATHERED 05/20/03

DATE: 06/20/03



SCALE: 1" = 50'

**Barton**  
**& Loguidice, P.C.**  
Consulting Engineers

2 Corporate Plaza 264 Washington Avenue Extension Albany, NY 12203-6352

PHOTOCIRCUITS CORP.  
**PIEZOMETRIC SURFACE FOR  
INTERMEDIATE DEPTH**

INTERMEDIATE DEPTH  
PUMPING AT 1 GPM PER  
WELL FOR 3 WEEKS

TOWN OF GLEN COVE

NASSAU COUNTY, NY

FIGURE

2

PROJECT NO.

643.001

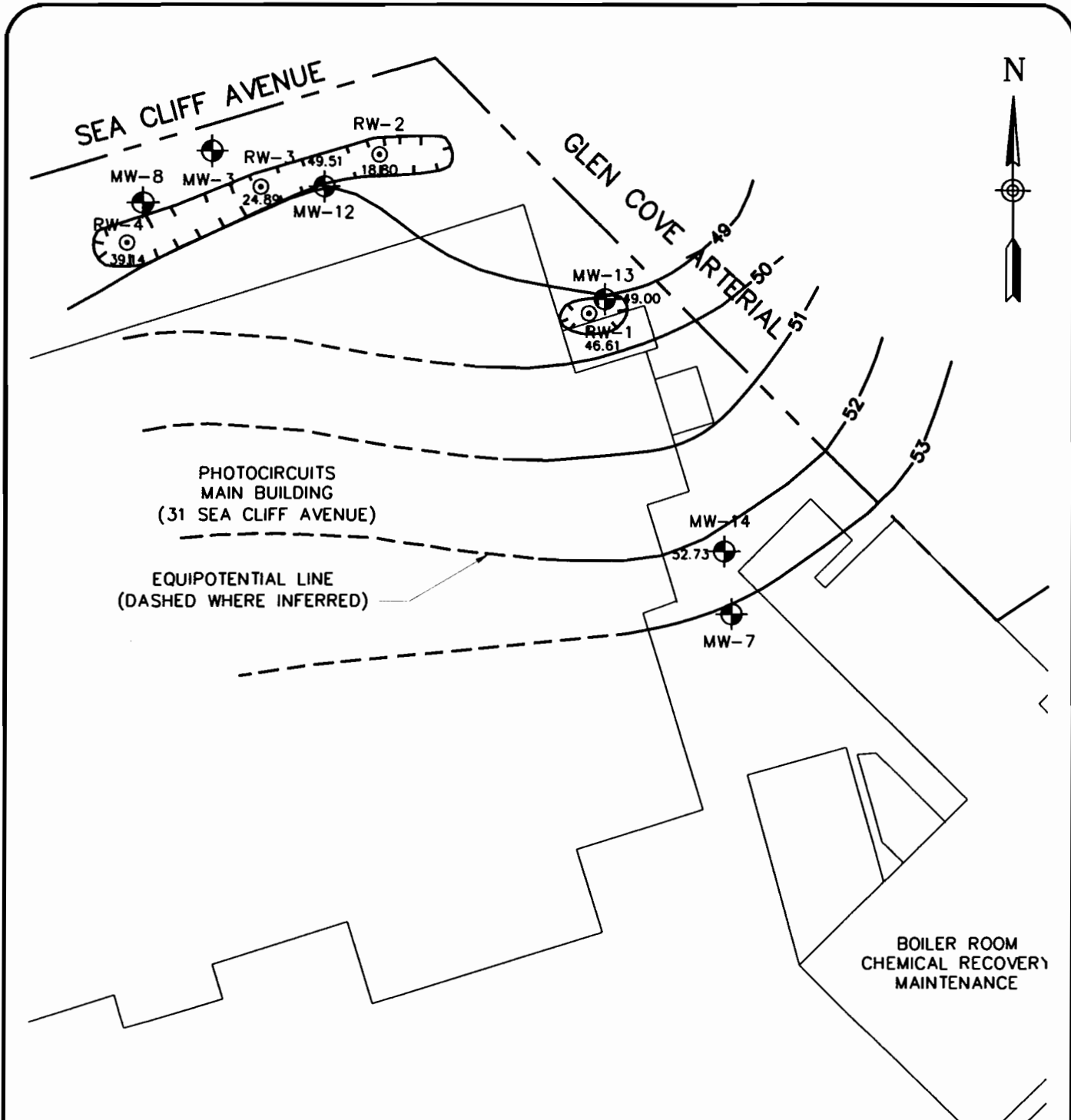

NOTE  
DATA GATHERED 05/21/03

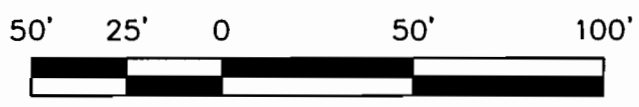

DATE: 06/20/03

SCALE: 1" = 50'

**Barton**  
**& L**oguidice, P.C.  
Consulting Engineers  
2 Corporate Plaza 264 Washington Avenue Extension Albany, NY 12203-6352

PHOTOCIRCUITS CORP.  
**PIEZOMETRIC SURFACE FOR INTERMEDIATE DEPTH**  
INTERMEDIATE DEPTH  
PUMPING AT 3 GPM PER WELL FOR 12 HOURS  
TOWN OF GLEN COVE NASSAU COUNTY, NY

FIGURE  
**3**  
PROJECT NO.  
643.001



# Environmental Testing Laboratories, Inc.

208 Route 109, Farmingdale NY 11735  
Phone - 631-249-1456 Fax - 631-249-8344

05/22/2003

**Custody Document: P1918**

Received: 04/29/2003 16:45  
Sampled by: DMJ/BDD

**Client: Photo Circuits**

31 Sea Cliff Avenue  
Glen Cove,  
NY 11542

**Project: Photocircuits Corp.**

31 Sea Cliff Avenue  
Glen Cove,  
NY 11542

**Manager: Andy Barber**

Respectfully submitted,

  
\_\_\_\_\_  
Quality Assurance Officer

NYS Lab ID # 10969  
NJ Cert. # 73812  
CT Cert. # PH0645  
MA Cert. # NY061  
PA Cert. # 68-535  
NH Cert. # 252592-BA  
RI Cert. # 161

The information contained in this report is confidential and intended only for the use of the client listed above. This report shall not be reproduced, except in full, without the written consent of Environmental Testing Laboratories, Inc.



# Environmental Testing Laboratories, Inc.

208 Route 109, Farmingdale NY 11735  
Phone - 631-249-1456 Fax - 631-249-8344

05/21/2003

## Volatile Compounds - EPA 8260B

### Sample: P1918-1

Client Sample ID: MW-8

Collected: 04/28/2003 18:35

Matrix: Liquid

Type: Grab

Remarks: See Case Narrative

Analyzed Date: 05/03/2003

### Analytical Results

Cas No	Analyte	File ID	MDL	Concentration	Units	Q
75-71-8	Dichlorodifluoromethane	A 941 -9744	0.58	0.58	ppb	U
75-45-6	Chlorodifluoromethane	A 941 -9744	0.62	0.62	ppb	U
74-87-3	Chloromethane	A 941 -9744	0.62	0.62	ppb	U
75-01-4	Vinyl Chloride	A 941 -9744	0.56	0.56	ppb	U
74-83-9	Bromomethane	A 941 -9744	0.90	0.90	ppb	U
75-00-3	Chloroethane	A 941 -9744	0.88	0.88	ppb	U
75-69-4	Trichlorofluoromethane	A 941 -9744	0.96	0.96	ppb	U
76-13-1	1,1,2-Trichlorotrifluoroethane	A 941 -9744	0.56	0.56	ppb	U
75-35-4	1,1-Dichloroethene	A 941 -9744	0.46	0.46	ppb	U
67-64-1	Acetone	A 941 -9744	2.82	2.82	ppb	U
75-15-0	Carbon disulfide	A 941 -9744	0.52	0.52	ppb	U
75-09-2	Methylene Chloride	A 941 -9744	0.30	0.30	ppb	U
156-60-5	trans-1,2-Dichloroethene	A 941 -9744	0.44	0.44	ppb	U
1634-04-4	Methyl t-butyl ether	A 941 -9744	0.11	0.11	ppb	U
75-34-3	1,1-Dichloroethane	A 941 -9744	0.44	0.44	ppb	U
590-20-7	2,2-Dichloropropane	A 941 -9744	0.74	0.74	ppb	U
156-59-2	cis-1,2-Dichloroethene	A 941 -9744	0.32	3.99	ppb	
78-93-3	2-Butanone	A 941 -9744	3.28	3.28	ppb	U
74-97-5	Bromochloromethane	A 941 -9744	0.13	0.13	ppb	U
67-66-3	Chloroform	A 941 -9744	0.38	0.38	ppb	U
71-55-6	1,1,1-Trichloroethane	A 941 -9744	0.44	0.44	ppb	U
56-23-5	Carbon Tetrachloride	A 941 -9744	0.64	0.64	ppb	U
563-58-6	1,1-Dichloropropene	A 941 -9744	0.80	0.80	ppb	U
71-43-2	Benzene	A 941 -9744	0.42	0.42	ppb	U
107-06-2	1,2-Dichloroethane	A 941 -9744	0.34	0.34	ppb	U
79-01-6	Trichloroethene	A 941 -9744	0.42	1.91	ppb	
78-87-5	1,2-Dichloropropane	A 941 -9744	0.30	0.30	ppb	U
74-95-3	Dibromomethane	A 941 -9744	0.14	0.14	ppb	U
75-27-4	Bromodichloromethane	A 941 -9744	0.17	0.17	ppb	U
110-75-8	2-Chloroethylvinylether	A 941 -9744	1.66	1.66	ppb	U
10061-01-5	cis-1,3-Dichloropropene	A 941 -9744	0.12	0.12	ppb	U
108-10-1	4-Methyl-2-pentanone	A 941 -9744	2.88	2.88	ppb	U
108-88-3	Toluene	A 941 -9744	0.40	0.40	ppb	U



# Environmental Testing Laboratories, Inc.

208 Route 109, Farmingdale NY 11735  
Phone - 631-249-1456 Fax - 631-249-8344

05/21/2003

## Volatile Compounds - EPA 8260B

**Sample: P1918-1**

Client Sample ID: MW-8

Matrix: Liquid

Remarks: See Case Narrative

Analyzed Date: 05/03/2003

Type: Grab

Collected: 04/28/2003 18:35

### Analytical Results

Cas No	Analyte	File ID	MDL	Concentration	Units	Q
96-12-8	1,2-Dibromo-3-chloropropane	A 941 -9744	0.50	0.50	ppb	U
120-82-1	1,2,4-Trichlorobenzene	A 941 -9744	0.28	0.28	ppb	U
87-68-3	Hexachlorobutadiene	A 941 -9744	0.38	0.38	ppb	U
91-20-3	Naphthalene	A 941 -9744	0.80	0.80	ppb	U
87-61-6	1,2,3-Trichlorobenzene	A 941 -9744	0.30	0.30	ppb	U

### Surrogate Results

Cas No	Analyte	File ID	% Recovery	QC Limits	Q
460-00-4	4-BROMOFLUOROBENZENE	A941-9744	96.0 %	( 86 - 118 )	
4774-33-8	DIBROMOFLUOROMETHANE	A941-9744	103.0 %	( 64 - 149 )	
2037-26-5	TOLUENE-D8	A941-9744	96.9 %	( 88 - 114 )	



# Environmental Testing Laboratories, Inc.

208 Route 109, Farmingdale NY 11735  
Phone - 631-249-1456 Fax - 631-249-8344

05/21/2003

## Volatile Compounds - EPA 8260B

### Sample: P1918-2

Client Sample ID: MW-12

Collected: 04/28/2003 18:45

Matrix: Liquid

Type: Grab

Remarks: See Case Narrative

Analyzed Date: 05/03/2003

### Analytical Results

Cas No	Analyte	File ID	MDL	Concentration	Units	Q
75-71-8	Dichlorodifluoromethane	A 941 -9745	0.58	0.58	ppb	U
75-45-6	Chlorodifluoromethane	A 941 -9745	0.62	0.62	ppb	U
74-87-3	Chloromethane	A 941 -9745	0.62	0.62	ppb	U
75-01-4	Vinyl Chloride	A 941 -9745	0.56	<b>75.3</b>	ppb	
74-83-9	Bromomethane	A 941 -9745	0.90	0.90	ppb	U
75-00-3	Chloroethane	A 941 -9745	0.88	0.88	ppb	U
75-69-4	Trichlorofluoromethane	A 941 -9745	0.96	0.96	ppb	U
76-13-1	1,1,2-Trichlorotrifluoroethane	A 941 -9745	0.56	0.56	ppb	U
75-35-4	1,1-Dichloroethene	A 941 -9745	0.46	<b>2.59</b>	ppb	
67-64-1	Acetone	A 941 -9745	2.82	2.82	ppb	U
75-15-0	Carbon disulfide	A 941 -9745	0.52	0.52	ppb	U
75-09-2	Methylene Chloride	A 941 -9745	0.30	0.30	ppb	U
156-60-5	trans-1,2-Dichloroethene	A 941 -9745	0.44	<b>3.84</b>	ppb	
1634-04-4	Methyl t-butyl ether	A 941 -9745	0.11	0.11	ppb	U
75-34-3	1,1-Dichloroethane	A 941 -9745	0.44	<b>38.6</b>	ppb	
590-20-7	2,2-Dichloropropane	A 941 -9745	0.74	0.74	ppb	U
156-59-2	cis-1,2-Dichloroethene	A 940 -9708	1.60	<b>369</b>	ppb	
78-93-3	2-Butanone	A 941 -9745	3.28	3.28	ppb	U
74-97-5	Bromochloromethane	A 941 -9745	0.13	0.13	ppb	U
67-66-3	Chloroform	A 941 -9745	0.38	0.38	ppb	U
71-55-6	1,1,1-Trichloroethane	A 941 -9745	0.44	0.44	ppb	U
56-23-5	Carbon Tetrachloride	A 941 -9745	0.64	0.64	ppb	U
563-58-6	1,1-Dichloropropene	A 941 -9745	0.80	0.80	ppb	U
71-43-2	Benzene	A 941 -9745	0.42	<b>2.04</b>	ppb	
107-06-2	1,2-Dichloroethane	A 941 -9745	0.34	0.34	ppb	U
79-01-6	Trichloroethene	A 941 -9745	0.42	<b>104</b>	ppb	
78-87-5	1,2-Dichloropropane	A 941 -9745	0.30	0.30	ppb	U
74-95-3	Dibromomethane	A 941 -9745	0.14	0.14	ppb	U
75-27-4	Bromodichloromethane	A 941 -9745	0.17	0.17	ppb	U
110-75-8	2-Chloroethylvinylether	A 941 -9745	1.66	1.66	ppb	U
10061-01-5	cis-1,3-Dichloropropene	A 941 -9745	0.12	0.12	ppb	U
108-10-1	4-Methyl-2-pentanone	A 941 -9745	2.88	2.88	ppb	U
108-88-3	Toluene	A 941 -9745	0.40	0.40	ppb	U





# Environmental Testing Laboratories, Inc.

208 Route 109, Farmingdale NY 11735  
Phone - 631-249-1456 Fax - 631-249-8344

05/21/2003

## Volatile Compounds - EPA 8260B

### Sample: P1918-2

Client Sample ID: MW-12

Collected: 04/28/2003 18:45

Matrix: Liquid

Type: Grab

Remarks: See Case Narrative

Analyzed Date: 05/03/2003

### Analytical Results

Gas No	Analyte	File ID	MDL	Concentration	Units	Q
10061-02-6	trans-1,3-Dichloropropene	A 941 -9745	0.24	0.24	ppb	U
79-00-5	1,1,2-Trichloroethane	A 941 -9745	0.30	0.30	ppb	U
127-18-4	Tetrachloroethene	A 941 -9745	0.76	0.76	ppb	U
142-28-9	1,3-Dichloropropane	A 941 -9745	0.080	0.080	ppb	U
591-78-6	2-Hexanone	A 941 -9745	2.88	2.88	ppb	U
124-48-1	Dibromochloromethane	A 941 -9745	0.088	0.088	ppb	U
106-93-4	1,2-Dibromoethane	A 941 -9745	0.19	0.19	ppb	U
108-90-7	Chlorobenzene	A 941 -9745	0.30	0.30	ppb	U
630-20-6	1,1,1,2-Tetrachloroethane	A 941 -9745	0.12	0.12	ppb	U
100-41-4	Ethylbenzene	A 941 -9745	0.24	0.24	ppb	U
108-38-3	m,p-xylene	A 941 -9745	0.48	0.48	ppb	U
95-47-6	o-xylene	A 941 -9745	0.24	0.24	ppb	U
100-42-5	Styrene	A 941 -9745	0.16	0.16	ppb	U
75-25-2	Bromoform	A 941 -9745	0.15	0.15	ppb	U
98-82-8	Isopropylbenzene	A 941 -9745	0.28	0.28	ppb	U
108-86-1	Bromobenzene	A 941 -9745	0.22	0.22	ppb	U
79-34-5	1,1,2,2-Tetrachloroethane	A 941 -9745	0.19	0.19	ppb	U
103-65-1	n-Propylbenzene	A 941 -9745	0.32	105	ppb	
96-18-4	1,2,3-Trichloropropane	A 941 -9745	0.094	0.094	ppb	U
622-96-8	p-Ethyltoluene	A 941 -9745	0.30	0.30	ppb	U
108-67-8	1,3,5-Trimethylbenzene	A 941 -9745	0.34	0.34	ppb	U
95-49-8	2-Chlorotoluene	A 941 -9745	0.30	145	ppb	
106-43-4	4-Chlorotoluene	A 941 -9745	0.14	5.95	ppb	
98-06-6	tert-Butylbenzene	A 941 -9745	0.24	0.24	ppb	U
95-63-6	1,2,4-Trimethylbenzene	A 941 -9745	0.30	0.30	ppb	U
135-98-8	sec-Butylbenzene	A 941 -9745	0.38	0.38	ppb	U
99-87-6	p-Isopropyltoluene	A 941 -9745	0.32	0.32	ppb	U
541-73-1	1,3-Dichlorobenzene	A 941 -9745	0.094	0.094	ppb	U
106-46-7	1,4-Dichlorobenzene	A 941 -9745	0.34	0.34	ppb	U
95-50-1	1,2-Dichlorobenzene	A 941 -9745	0.13	0.13	ppb	U
105-05-5	p-Diethylbenzene	A 941 -9745	0.34	0.34	ppb	U
104-51-8	n-Butylbenzene	A 941 -9745	0.52	0.52	ppb	U
95-93-2	1,2,4,5-Tetramethylbenzene	A 941 -9745	0.46	0.46	ppb	U



# Environmental Testing Laboratories, Inc.

208 Route 109, Farmingdale NY 11735

Phone - 631-249-1456 Fax - 631-249-8344

05/21/2003

## Volatile Compounds - EPA 8260B

### Sample: P1918-2

Client Sample ID: MW-12

Collected: 04/28/2003 18:45

Matrix: Liquid

Type: Grab

Remarks: See Case Narrative

Analyzed Date: 05/03/2003

### Analytical Results

Cas No	Analyte	File ID	MDL	Concentration	Units	Q
96-12-8	1,2-Dibromo-3-chloropropane	A 941 -9745	0.50	0.50	ppb	U
120-82-1	1,2,4-Trichlorobenzene	A 941 -9745	0.28	0.28	ppb	U
87-68-3	Hexachlorobutadiene	A 941 -9745	0.38	0.38	ppb	U
91-20-3	Naphthalene	A 941 -9745	0.80	0.80	ppb	U
87-61-6	1,2,3-Trichlorobenzene	A 941 -9745	0.30	0.30	ppb	U

### Surrogate Results

Cas No	Analyte	File ID	% Recovery	QC Limits	Q
460-00-4	4-BROMOFLUOROBENZENE	A940-9708	96.1 %	( 86 - 118)	
4774-33-8	DIBROMOFLUOROMETHANE	A940-9708	103.0 %	( 64 - 149)	
2037-26-5	TOLUENE-D8	A940-9708	97.6 %	( 88 - 114)	
460-00-4	4-BROMOFLUOROBENZENE	A941-9745	95.8 %	( 86 - 118)	
4774-33-8	DIBROMOFLUOROMETHANE	A941-9745	104.0 %	( 64 - 149)	
2037-26-5	TOLUENE-D8	A941-9745	96.8 %	( 88 - 114)	



# Environmental Testing Laboratories, Inc.

208 Route 109, Farmingdale NY 11735  
Phone - 631-249-1456 Fax - 631-249-8344

05/21/2003

## Volatile Compounds - EPA 8260B

### Sample: P1918-3

Client Sample ID: MW-13

Collected: 04/29/2003 08:50

Matrix: Liquid

Type: Grab

Remarks: See Case Narrative

Analyzed Date: 05/03/2003

## Analytical Results

Cas No	Analyte	File ID	MDL	Concentration	Units	Q
75-71-8	Dichlorodifluoromethane	A 941 -9746	0.58	0.58	ppb	U
75-45-6	Chlorodifluoromethane	A 941 -9746	0.62	0.62	ppb	U
74-87-3	Chloromethane	A 941 -9746	0.62	0.62	ppb	U
75-01-4	Vinyl Chloride	A 941 -9746	0.56	2.60	ppb	
74-83-9	Bromomethane	A 941 -9746	0.90	0.90	ppb	U
75-00-3	Chloroethane	A 941 -9746	0.88	0.88	ppb	U
75-69-4	Trichlorofluoromethane	A 941 -9746	0.96	0.96	ppb	U
76-13-1	1,1,2-Trichlorotrifluoroethane	A 941 -9746	0.56	0.56	ppb	U
75-35-4	1,1-Dichloroethene	A 941 -9746	0.46	0.46	ppb	U
67-64-1	Acetone	A 941 -9746	2.82	22.4	ppb	
75-15-0	Carbon disulfide	A 941 -9746	0.52	4.89	ppb	
75-09-2	Methylene Chloride	A 941 -9746	0.30	1.88	ppb	
156-60-5	trans-1,2-Dichloroethene	A 941 -9746	0.44	0.44	ppb	U
1634-04-4	Methyl t-butyl ether	A 941 -9746	0.11	0.11	ppb	U
75-34-3	1,1-Dichloroethane	A 941 -9746	0.44	8.85	ppb	
590-20-7	2,2-Dichloropropane	A 941 -9746	0.74	0.74	ppb	U
156-59-2	cis-1,2-Dichloroethene	A 941 -9746	0.32	135	ppb	
78-93-3	2-Butanone	A 941 -9746	3.28	3.28	ppb	U
74-97-5	Bromochloromethane	A 941 -9746	0.13	0.13	ppb	U
67-66-3	Chloroform	A 941 -9746	0.38	0.38	ppb	U
71-55-6	1,1,1-Trichloroethane	A 941 -9746	0.44	0.44	ppb	U
56-23-5	Carbon Tetrachloride	A 941 -9746	0.64	0.64	ppb	U
563-58-6	1,1-Dichloropropene	A 941 -9746	0.80	0.80	ppb	U
71-43-2	Benzene	A 941 -9746	0.42	0.42	ppb	U
107-06-2	1,2-Dichloroethane	A 941 -9746	0.34	0.34	ppb	U
79-01-6	Trichloroethene	A 941 -9746	0.42	12.1	ppb	
78-87-5	1,2-Dichloropropane	A 941 -9746	0.30	0.30	ppb	U
74-95-3	Dibromomethane	A 941 -9746	0.14	0.14	ppb	U
75-27-4	Bromodichloromethane	A 941 -9746	0.17	0.17	ppb	U
110-75-8	2-Chloroethylvinylether	A 941 -9746	1.66	1.66	ppb	U
10061-01-5	cis-1,3-Dichloropropene	A 941 -9746	0.12	0.12	ppb	U
108-10-1	4-Methyl-2-pentanone	A 941 -9746	2.88	2.88	ppb	U
108-88-3	Toluene	A 941 -9746	0.40	0.40	ppb	U



# Environmental Testing Laboratories, Inc.

208 Route 109, Farmingdale NY 11735  
Phone - 631-249-1456 Fax - 631-249-8344

05/21/2003

## Volatile Compounds - EPA 8260B

### Sample: P1918-3

Client Sample ID: MW-13

Collected: 04/29/2003 08:50

Matrix: Liquid

Type: Grab

Remarks: See Case Narrative

Analyzed Date: 05/03/2003

### Analytical Results

Cas No	Analyte	File ID	MDL	Concentration	Units	Q
10061-02-6	trans-1,3-Dichloropropene	A 941 -9746	0.24	0.24	ppb	U
79-00-5	1,1,2-Trichloroethane	A 941 -9746	0.30	0.30	ppb	U
127-18-4	Tetrachloroethene	A 941 -9746	0.76	13.0	ppb	
142-28-9	1,3-Dichloropropane	A 941 -9746	0.080	0.080	ppb	U
591-78-6	2-Hexanone	A 941 -9746	2.88	2.88	ppb	U
124-48-1	Dibromochloromethane	A 941 -9746	0.088	0.088	ppb	U
106-93-4	1,2-Dibromoethane	A 941 -9746	0.19	0.19	ppb	U
108-90-7	Chlorobenzene	A 941 -9746	0.30	0.30	ppb	U
630-20-6	1,1,1,2-Tetrachloroethane	A 941 -9746	0.12	0.12	ppb	U
100-41-4	Ethylbenzene	A 941 -9746	0.24	0.24	ppb	U
108-38-3	m,p-xylene	A 941 -9746	0.48	0.48	ppb	U
95-47-6	o-xylene	A 941 -9746	0.24	0.24	ppb	U
100-42-5	Styrene	A 941 -9746	0.16	0.16	ppb	U
75-25-2	Bromoform	A 941 -9746	0.15	0.15	ppb	U
98-82-8	Isopropylbenzene	A 941 -9746	0.28	0.28	ppb	U
108-86-1	Bromobenzene	A 941 -9746	0.22	0.22	ppb	U
79-34-5	1,1,1,2-Tetrachloroethane	A 941 -9746	0.19	0.19	ppb	U
103-65-1	n-Propylbenzene	A 941 -9746	0.32	2.70	ppb	
96-18-4	1,2,3-Trichloropropane	A 941 -9746	0.094	0.094	ppb	U
622-96-8	p-Ethyltoluene	A 941 -9746	0.30	0.30	ppb	U
108-67-8	1,3,5-Trimethylbenzene	A 941 -9746	0.34	0.34	ppb	U
95-49-8	2-Chlorotoluene	A 941 -9746	0.30	3.52	ppb	
106-43-4	4-Chlorotoluene	A 941 -9746	0.14	3.41	ppb	
98-06-6	tert-Butylbenzene	A 941 -9746	0.24	0.24	ppb	U
95-63-6	1,2,4-Trimethylbenzene	A 941 -9746	0.30	0.30	ppb	U
135-98-8	sec-Butylbenzene	A 941 -9746	0.38	0.38	ppb	U
99-87-6	p-Isopropyltoluene	A 941 -9746	0.32	0.32	ppb	U
541-73-1	1,3-Dichlorobenzene	A 941 -9746	0.094	0.094	ppb	U
106-46-7	1,4-Dichlorobenzene	A 941 -9746	0.34	0.34	ppb	U
95-50-1	1,2-Dichlorobenzene	A 941 -9746	0.13	0.13	ppb	U
105-05-5	p-Diethylbenzene	A 941 -9746	0.34	0.34	ppb	U
104-51-8	n-Butylbenzene	A 941 -9746	0.52	0.52	ppb	U
95-93-2	1,2,4,5-Tetramethylbenzene	A 941 -9746	0.46	0.46	ppb	U



# Environmental Testing Laboratories, Inc.

208 Route 109, Farmingdale NY 11735  
Phone - 631-249-1456 Fax - 631-249-8344

05/21/2003

## Volatile Compounds - EPA 8260B

### Sample: P1918-3

Client Sample ID: MW-13

Collected: 04/29/2003 08:50

Matrix: Liquid

Type: Grab

Remarks: See Case Narrative

Analyzed Date: 05/03/2003

### Analytical Results

Cas No	Analyte	File ID	MDL	Concentration	Units	Q
96-12-8	1,2-Dibromo-3-chloropropane	A 941 -9746	0.50	0.50	ppb	U
120-82-1	1,2,4-Trichlorobenzene	A 941 -9746	0.28	0.28	ppb	U
87-68-3	Hexachlorobutadiene	A 941 -9746	0.38	0.38	ppb	U
91-20-3	Naphthalene	A 941 -9746	0.80	0.80	ppb	U
87-61-6	1,2,3-Trichlorobenzene	A 941 -9746	0.30	0.30	ppb	U

### Surrogate Results

Cas No	Analyte	File ID	% Recovery	QC Limits	Q
460-00-4	4-BROMOFLUOROBENZENE	A941-9746	95.5 %	( 86 - 118 )	
4774-33-8	DIBROMOFLUOROMETHANE	A941-9746	105.0 %	( 64 - 149 )	
2037-26-5	TOLUENE-D8	A941-9746	98.3 %	( 88 - 114 )	



# Environmental Testing Laboratories, Inc.

208 Route 109, Farmingdale NY 11735  
Phone - 631-249-1456 Fax - 631-249-8344

05/21/2003

## Volatile Compounds - EPA 8260B

### Sample: P1918-4

Client Sample ID: MW-14

Collected: 04/28/2003 17:50

Matrix: Liquid

Type: Grab

Remarks: See Case Narrative

Analyzed Date: 05/02/2003

### Analytical Results

Cas No	Analyte	File ID	MDL	Concentration	Units	Q
75-71-8	Dichlorodifluoromethane	A 940 -9710	29.0	29.0	ppb	U
75-45-6	Chlorodifluoromethane	A 940 -9710	31.0	31.0	ppb	U
74-87-3	Chloromethane	A 940 -9710	31.0	31.0	ppb	U
75-01-4	Vinyl Chloride	A 940 -9710	28.0	342	ppb	
74-83-9	Bromomethane	A 940 -9710	45.0	45.0	ppb	U
75-00-3	Chloroethane	A 940 -9710	44.0	1290	ppb	
75-69-4	Trichlorofluoromethane	A 940 -9710	48.0	48.0	ppb	U
76-13-1	1,1,2-Trichlorotrifluoroethane	A 940 -9710	28.0	28.0	ppb	U
75-35-4	1,1-Dichloroethene	A 940 -9710	23.0	296	ppb	
67-64-1	Acetone	A 940 -9710	141	912	ppb	
75-15-0	Carbon disulfide	A 940 -9710	26.0	26.0	ppb	U
75-09-2	Methylene Chloride	A 940 -9710	15.0	15.0	ppb	U
156-60-5	trans-1,2-Dichloroethene	A 940 -9710	22.0	22.0	ppb	U
1634-04-4	Methyl t-butyl ether	A 940 -9710	5.30	5.30	ppb	U
75-34-3	1,1-Dichloroethane	A 940 -9710	22.0	8860	ppb	
590-20-7	2,2-Dichloropropane	A 940 -9710	37.0	37.0	ppb	U
156-59-2	cis-1,2-Dichloroethene	A 940 -9710	16.0	16.0	ppb	U
78-93-3	2-Butanone	A 940 -9710	164	164	ppb	U
74-97-5	Bromochloromethane	A 940 -9710	6.60	6.60	ppb	U
67-66-3	Chloroform	A 940 -9710	19.0	19.0	ppb	U
71-55-6	1,1,1-Trichloroethane	A 940 -9710	22.0	1630	ppb	
56-23-5	Carbon Tetrachloride	A 940 -9710	32.0	32.0	ppb	U
563-58-6	1,1-Dichloropropene	A 940 -9710	40.0	40.0	ppb	U
71-43-2	Benzene	A 940 -9710	21.0	21.0	ppb	U
107-06-2	1,2-Dichloroethane	A 940 -9710	17.0	17.0	ppb	U
79-01-6	Trichloroethene	A 940 -9710	21.0	21.0	ppb	U
78-87-5	1,2-Dichloropropane	A 940 -9710	15.0	15.0	ppb	U
74-95-3	Dibromomethane	A 940 -9710	7.20	7.20	ppb	U
75-27-4	Bromodichloromethane	A 940 -9710	8.40	8.40	ppb	U
110-75-8	2-Chloroethylvinylether	A 940 -9710	83.0	83.0	ppb	U
10061-01-5	cis-1,3-Dichloropropene	A 940 -9710	6.20	6.20	ppb	U
108-10-1	4-Methyl-2-pentanone	A 940 -9710	144	144	ppb	U
108-88-3	Toluene	A 940 -9710	20.0	20.0	ppb	U



# Environmental Testing Laboratories, Inc.

208 Route 109, Farmingdale NY 11735  
Phone - 631-249-1456 Fax - 631-249-8344

05/21/2003

## Volatile Compounds - EPA 8260B

### Sample: P1918-4

Client Sample ID: MW-14

Collected: 04/28/2003 17:50

Matrix: Liquid

Type: Grab

Remarks: See Case Narrative

Analyzed Date: 05/02/2003

### Analytical Results

Cas No	Analyte	File ID	MDL	Concentration	Units	Q
10061-02-6	trans-1,3-Dichloropropene	A 940 -9710	12.0	12.0	ppb	U
79-00-5	1,1,2-Trichloroethane	A 940 -9710	15.0	15.0	ppb	U
127-18-4	Tetrachloroethene	A 940 -9710	38.0	38.0	ppb	U
142-28-9	1,3-Dichloropropane	A 940 -9710	4.00	4.00	ppb	U
591-78-6	2-Hexanone	A 940 -9710	144	144	ppb	U
124-48-1	Dibromochloromethane	A 940 -9710	4.40	4.40	ppb	U
106-93-4	1,2-Dibromoethane	A 940 -9710	9.70	9.70	ppb	U
108-90-7	Chlorobenzene	A 940 -9710	15.0	15.0	ppb	U
630-20-6	1,1,1,2-Tetrachloroethane	A 940 -9710	6.10	6.10	ppb	U
100-41-4	Ethylbenzene	A 940 -9710	12.0	12.0	ppb	U
108-38-3	m,p-xylene	A 940 -9710	24.0	24.0	ppb	U
95-47-6	o-xylene	A 940 -9710	12.0	12.0	ppb	U
100-42-5	Styrene	A 940 -9710	8.00	8.00	ppb	U
75-25-2	Bromoform	A 940 -9710	7.30	7.30	ppb	U
98-82-8	Isopropylbenzene	A 940 -9710	14.0	14.0	ppb	U
108-86-1	Bromobenzene	A 940 -9710	11.0	11.0	ppb	U
79-34-5	1,1,2,2-Tetrachloroethane	A 940 -9710	9.40	9.40	ppb	U
103-65-1	n-Propylbenzene	A 940 -9710	16.0	16.0	ppb	U
96-18-4	1,2,3-Trichloropropane	A 940 -9710	4.70	4.70	ppb	U
622-96-8	p-Ethyltoluene	A 940 -9710	15.0	15.0	ppb	U
108-67-8	1,3,5-Trimethylbenzene	A 940 -9710	17.0	17.0	ppb	U
95-49-8	2-Chlorotoluene	A 940 -9710	15.0	15.0	ppb	U
106-43-4	4-Chlorotoluene	A 940 -9710	7.20	7.20	ppb	U
98-06-6	tert-Butylbenzene	A 940 -9710	12.0	12.0	ppb	U
95-63-6	1,2,4-Trimethylbenzene	A 940 -9710	15.0	15.0	ppb	U
135-98-8	sec-Butylbenzene	A 940 -9710	19.0	19.0	ppb	U
99-87-6	p-Isopropyltoluene	A 940 -9710	16.0	16.0	ppb	U
541-73-1	1,3-Dichlorobenzene	A 940 -9710	4.70	4.70	ppb	U
106-46-7	1,4-Dichlorobenzene	A 940 -9710	17.0	17.0	ppb	U
95-50-1	1,2-Dichlorobenzene	A 940 -9710	6.50	6.50	ppb	U
105-05-5	p-Diethylbenzene	A 940 -9710	17.0	17.0	ppb	U
104-51-8	n-Butylbenzene	A 940 -9710	26.0	26.0	ppb	U
95-93-2	1,2,4,5-Tetramethylbenzene	A 940 -9710	23.0	23.0	ppb	U



# Environmental Testing Laboratories, Inc.

208 Route 109, Farmingdale NY 11735

Phone - 631-249-1456 Fax - 631-249-8344

05/21/2003

## Volatile Compounds - EPA 8260B

**Sample: P1918-4**

Client Sample ID: MW-14

Matrix: Liquid

Remarks: See Case Narrative

Analyzed Date: 05/02/2003

Type: Grab

Collected: 04/28/2003 17:50

### Analytical Results

Cas No	Analyte	File ID	MDL	Concentration	Units	Q
96-12-8	1,2-Dibromo-3-chloropropane	A 940 -9710	25.0	25.0	ppb	U
120-82-1	1,2,4-Trichlorobenzene	A 940 -9710	14.0	14.0	ppb	U
87-68-3	Hexachlorobutadiene	A 940 -9710	19.0	19.0	ppb	U
91-20-3	Naphthalene	A 940 -9710	40.0	40.0	ppb	U
87-61-6	1,2,3-Trichlorobenzene	A 940 -9710	15.0	15.0	ppb	U

### Surrogate Results

Cas No	Analyte	File ID	% Recovery	QC Limits	Q
460-00-4	4-BROMOFLUOROBENZENE	A940-9710	96.0 %	( 86 - 118)	
4774-33-8	DIBROMOFLUOROMETHANE	A940-9710	104.0 %	( 64 - 149)	
2037-26-5	TOLUENE-D8	A940-9710	96.3 %	( 88 - 114)	





# Environmental Testing Laboratories, Inc.

208 Route 109, Farmingdale NY 11735  
Phone - 631-249-1456 Fax - 631-249-8344

05/21/2003

## Volatile Compounds - EPA 8260B

### Sample: P1918-5

Client Sample ID: SMP-1

Collected: 04/28/2003 18:00

Matrix: Liquid

Type: Grab

Remarks: See Case Narrative

Analyzed Date: 05/03/2003

### Analytical Results

Cas No	Analyte	File ID	MDL	Concentration	Units	Q
75-71-8	Dichlorodifluoromethane	A 941 -9747	0.58	0.58	ppb	U
75-45-6	Chlorodifluoromethane	A 941 -9747	0.62	0.62	ppb	U
74-87-3	Chloromethane	A 941 -9747	0.62	0.62	ppb	U
75-01-4	Vinyl Chloride	A 941 -9747	0.56	0.56	ppb	U
74-83-9	Bromomethane	A 941 -9747	0.90	0.90	ppb	U
75-00-3	Chloroethane	A 941 -9747	0.88	241	ppb	
75-69-4	Trichlorofluoromethane	A 941 -9747	0.96	0.96	ppb	U
76-13-1	1,1,2-Trichlorotrifluoroethane	A 941 -9747	0.56	0.56	ppb	U
75-35-4	1,1-Dichloroethene	A 941 -9747	0.46	0.46	ppb	U
67-64-1	Acetone	A 941 -9747	2.82	101	ppb	
75-15-0	Carbon disulfide	A 941 -9747	0.52	0.52	ppb	U
75-09-2	Methylene Chloride	A 941 -9747	0.30	2.75	ppb	
156-60-5	trans-1,2-Dichloroethene	A 941 -9747	0.44	0.44	ppb	U
1634-04-4	Methyl t-butyl ether	A 941 -9747	0.11	0.11	ppb	U
75-34-3	1,1-Dichloroethane	A 941 -9747	0.44	26.3	ppb	
590-20-7	2,2-Dichloropropane	A 941 -9747	0.74	0.74	ppb	U
156-59-2	cis-1,2-Dichloroethene	A 941 -9747	0.32	0.32	ppb	U
78-93-3	2-Butanone	A 941 -9747	3.28	3.28	ppb	U
74-97-5	Bromochloromethane	A 941 -9747	0.13	0.13	ppb	U
67-66-3	Chloroform	A 941 -9747	0.38	0.38	ppb	U
71-55-6	1,1,1-Trichloroethane	A 941 -9747	0.44	0.44	ppb	U
56-23-5	Carbon Tetrachloride	A 941 -9747	0.64	0.64	ppb	U
563-58-6	1,1-Dichloropropene	A 941 -9747	0.80	0.80	ppb	U
71-43-2	Benzene	A 941 -9747	0.42	24.4	ppb	
107-06-2	1,2-Dichloroethane	A 941 -9747	0.34	0.34	ppb	U
79-01-6	Trichloroethene	A 941 -9747	0.42	0.42	ppb	U
78-87-5	1,2-Dichloropropane	A 941 -9747	0.30	0.30	ppb	U
74-95-3	Dibromomethane	A 941 -9747	0.14	0.14	ppb	U
75-27-4	Bromodichloromethane	A 941 -9747	0.17	0.17	ppb	U
110-75-8	2-Chloroethylvinylether	A 941 -9747	1.66	1.66	ppb	U
10061-01-5	cis-1,3-Dichloropropene	A 941 -9747	0.12	0.12	ppb	U
108-10-1	4-Methyl-2-pentanone	A 941 -9747	2.88	2.88	ppb	U
108-88-3	Toluene	A 941 -9747	0.40	48.9	ppb	



# Environmental Testing Laboratories, Inc.

208 Route 109, Farmingdale NY 11735

Phone - 631-249-1456 Fax - 631-249-8344

05/21/2003

## Volatile Compounds - EPA 8260B

### Sample: P1918-5

Client Sample ID: SMP-1

Collected: 04/28/2003 18:00

Matrix: Liquid

Type: Grab

Remarks: See Case Narrative

Analyzed Date: 05/03/2003

## Analytical Results

Cas No	Analyte	File ID	MDL	Concentration	Units	Q
10061-02-6	trans-1,3-Dichloropropene	A 941 -9747	0.24	0.24	ppb	U
79-00-5	1,1,2-Trichloroethane	A 941 -9747	0.30	0.30	ppb	U
127-18-4	Tetrachloroethene	A 941 -9747	0.76	0.76	ppb	U
142-28-9	1,3-Dichloropropane	A 941 -9747	0.080	0.080	ppb	U
591-78-6	2-Hexanone	A 941 -9747	2.88	<b>6.98</b>	ppb	
124-48-1	Dibromochloromethane	A 941 -9747	0.088	0.088	ppb	U
106-93-4	1,2-Dibromoethane	A 941 -9747	0.19	0.19	ppb	U
108-90-7	Chlorobenzene	A 941 -9747	0.30	0.30	ppb	U
630-20-6	1,1,1,2-Tetrachloroethane	A 941 -9747	0.12	0.12	ppb	U
100-41-4	Ethylbenzene	A 941 -9747	0.24	0.24	ppb	U
108-38-3	m,p-xylene	A 941 -9747	0.48	0.48	ppb	U
95-47-6	o-xylene	A 941 -9747	0.24	0.24	ppb	U
100-42-5	Styrene	A 941 -9747	0.16	0.16	ppb	U
75-25-2	Bromoform	A 941 -9747	0.15	0.15	ppb	U
98-82-8	Isopropylbenzene	A 941 -9747	0.28	0.28	ppb	U
108-86-1	Bromobenzene	A 941 -9747	0.22	0.22	ppb	U
79-34-5	1,1,2,2-Tetrachloroethane	A 941 -9747	0.19	0.19	ppb	U
103-65-1	n-Propylbenzene	A 941 -9747	0.32	0.32	ppb	U
96-18-4	1,2,3-Trichloropropane	A 941 -9747	0.094	0.094	ppb	U
622-96-8	p-Ethyltoluene	A 941 -9747	0.30	0.30	ppb	U
108-67-8	1,3,5-Trimethylbenzene	A 941 -9747	0.34	0.34	ppb	U
95-49-8	2-Chlorotoluene	A 941 -9747	0.30	<b>10.1</b>	ppb	
106-43-4	4-Chlorotoluene	A 941 -9747	0.14	0.14	ppb	U
98-06-6	tert-Butylbenzene	A 941 -9747	0.24	0.24	ppb	U
95-63-6	1,2,4-Trimethylbenzene	A 941 -9747	0.30	0.30	ppb	U
135-98-8	sec-Butylbenzene	A 941 -9747	0.38	0.38	ppb	U
99-87-6	p-Isopropyltoluene	A 941 -9747	0.32	0.32	ppb	U
541-73-1	1,3-Dichlorobenzene	A 941 -9747	0.094	0.094	ppb	U
106-46-7	1,4-Dichlorobenzene	A 941 -9747	0.34	0.34	ppb	U
95-50-1	1,2-Dichlorobenzene	A 941 -9747	0.13	0.13	ppb	U
105-05-5	p-Diethylbenzene	A 941 -9747	0.34	0.34	ppb	U
104-51-8	n-Butylbenzene	A 941 -9747	0.52	0.52	ppb	U
95-93-2	1,2,4,5-Tetramethylbenzene	A 941 -9747	0.46	0.46	ppb	U



# Environmental Testing Laboratories, Inc.

208 Route 109, Farmingdale NY 11735  
Phone - 631-249-1456 Fax - 631-249-8344

05/21/2003

## Volatile Compounds - EPA 8260B

**Sample: P1918-5**

Client Sample ID: SMP-1

Collected: 04/28/2003 18:00

Matrix: Liquid

Type: Grab

Remarks: See Case Narrative

Analyzed Date: 05/03/2003

### Analytical Results

Cas No	Analyte	File ID	MDL	Concentration	Units	Q
96-12-8	1,2-Dibromo-3-chloropropane	A 941 -9747	0.50	0.50	ppb	U
120-82-1	1,2,4-Trichlorobenzene	A 941 -9747	0.28	0.28	ppb	U
87-68-3	Hexachlorobutadiene	A 941 -9747	0.38	0.38	ppb	U
91-20-3	Naphthalene	A 941 -9747	0.80	0.80	ppb	U
87-61-6	1,2,3-Trichlorobenzene	A 941 -9747	0.30	0.30	ppb	U

### Surrogate Results

Cas No	Analyte	File ID	% Recovery	QC Limits	Q
460-00-4	4-BROMOFLUOROBENZENE	A941-9747	95.9 %	( 86 - 118)	
4774-33-8	DIBROMOFLUOROMETHANE	A941-9747	103.0 %	( 64 - 149)	
2037-26-5	TOLUENE-D8	A941-9747	97.5 %	( 88 - 114)	



# Environmental Testing Laboratories, Inc.

208 Route 109, Farmingdale NY 11735  
Phone - 631-249-1456 Fax - 631-249-8344

05/21/2003

## Volatile Compounds - EPA 8260B

### Sample: P1918-6

Client Sample ID: DMP-1

Collected: 04/28/2003 18:05

Matrix: Liquid

Type: Grab

Remarks: See Case Narrative

Analyzed Date: 05/05/2003

## Analytical Results

Cas No	Analyte	File ID	MDL	Concentration	Units	Q
75-71-8	Dichlorodifluoromethane	A 943 -9799	0.58	0.58	ppb	U
75-45-6	Chlorodifluoromethane	A 943 -9799	0.62	0.62	ppb	U
74-87-3	Chloromethane	A 943 -9799	0.62	0.62	ppb	U
75-01-4	Vinyl Chloride	A 940 -9716	14.0	1020	ppb	
74-83-9	Bromomethane	A 943 -9799	0.90	0.90	ppb	U
75-00-3	Chloroethane	A 943 -9799	0.88	34.7	ppb	
75-69-4	Trichlorofluoromethane	A 943 -9799	0.96	0.96	ppb	U
76-13-1	1,1,2-Trichlorotrifluoroethane	A 943 -9799	0.56	0.56	ppb	U
75-35-4	1,1-Dichloroethene	A 943 -9799	0.46	4.70	ppb	
67-64-1	Acetone	A 943 -9799	2.82	86.0	ppb	
75-15-0	Carbon disulfide	A 943 -9799	0.52	3.10	ppb	
75-09-2	Methylene Chloride	A 943 -9799	0.30	4.87	ppb	
156-60-5	trans-1,2-Dichloroethene	A 943 -9799	0.44	5.75	ppb	
1634-04-4	Methyl t-butyl ether	A 943 -9799	0.11	0.11	ppb	U
75-34-3	1,1-Dichloroethane	A 940 -9716	11.0	401	ppb	
590-20-7	2,2-Dichloropropane	A 943 -9799	0.74	0.74	ppb	U
156-59-2	cis-1,2-Dichloroethene	A 940 -9716	8.00	1100	ppb	
78-93-3	2-Butanone	A 943 -9799	3.28	3.28	ppb	U
74-97-5	Bromochloromethane	A 943 -9799	0.13	0.13	ppb	U
67-66-3	Chloroform	A 943 -9799	0.38	0.38	ppb	U
71-55-6	1,1,1-Trichloroethane	A 943 -9799	0.44	0.44	ppb	U
56-23-5	Carbon Tetrachloride	A 943 -9799	0.64	0.64	ppb	U
563-58-6	1,1-Dichloropropene	A 943 -9799	0.80	0.80	ppb	U
71-43-2	Benzene	A 943 -9799	0.42	214	ppb	
107-06-2	1,2-Dichloroethane	A 943 -9799	0.34	0.34	ppb	U
79-01-6	Trichloroethene	A 943 -9799	0.42	5.53	ppb	
78-87-5	1,2-Dichloropropane	A 943 -9799	0.30	0.30	ppb	U
74-95-3	Dibromomethane	A 943 -9799	0.14	0.14	ppb	U
75-27-4	Bromodichloromethane	A 943 -9799	0.17	0.17	ppb	U
110-75-8	2-Chloroethylvinylether	A 943 -9799	1.66	1.66	ppb	U
10061-01-5	cis-1,3-Dichloropropene	A 943 -9799	0.12	0.12	ppb	U
108-10-1	4-Methyl-2-pentanone	A 943 -9799	2.88	2.88	ppb	U
108-88-3	Toluene	A 943 -9799	0.40	14.3	ppb	



# Environmental Testing Laboratories, Inc.

208 Route 109, Farmingdale NY 11735

Phone - 631-249-1456 Fax - 631-249-8344

05/21/2003

## Volatile Compounds - EPA 8260B

### Sample: P1918-6

Client Sample ID: DMP-1

Matrix: Liquid

Remarks: See Case Narrative

Analyzed Date: 05/05/2003

Type: Grab

Collected: 04/28/2003 18:05

### Analytical Results

Cas No	Analyte	File ID	MDL	Concentration	Units	Q
10061-02-6	trans-1,3-Dichloropropene	A 943 -9799	0.24	0.24	ppb	U
79-00-5	1,1,2-Trichloroethane	A 943 -9799	0.30	0.30	ppb	U
127-18-4	Tetrachloroethene	A 943 -9799	0.76	0.76	ppb	U
142-28-9	1,3-Dichloropropane	A 943 -9799	0.080	0.080	ppb	U
591-78-6	2-Hexanone	A 943 -9799	2.88	2.88	ppb	U
124-48-1	Dibromochloromethane	A 943 -9799	0.088	0.088	ppb	U
106-93-4	1,2-Dibromoethane	A 943 -9799	0.19	0.19	ppb	U
108-90-7	Chlorobenzene	A 943 -9799	0.30	0.30	ppb	U
630-20-6	1,1,1,2-Tetrachloroethane	A 943 -9799	0.12	0.12	ppb	U
100-41-4	Ethylbenzene	A 943 -9799	0.24	2.86	ppb	
108-38-3	m,p-xylene	A 943 -9799	0.48	3.55	ppb	
95-47-6	o-xylene	A 943 -9799	0.24	2.97	ppb	
100-42-5	Styrene	A 943 -9799	0.16	0.16	ppb	U
75-25-2	Bromoform	A 943 -9799	0.15	0.15	ppb	U
98-82-8	Isopropylbenzene	A 943 -9799	0.28	0.28	ppb	U
108-86-1	Bromobenzene	A 943 -9799	0.22	0.22	ppb	U
79-34-5	1,1,1,2-Tetrachloroethane	A 943 -9799	0.19	0.19	ppb	U
103-65-1	n-Propylbenzene	A 943 -9799	0.32	0.32	ppb	U
96-18-4	1,2,3-Trichloropropane	A 943 -9799	0.094	0.094	ppb	U
622-96-8	p-Ethyltoluene	A 943 -9799	0.30	0.30	ppb	U
108-67-8	1,3,5-Trimethylbenzene	A 943 -9799	0.34	0.34	ppb	U
95-49-8	2-Chlorotoluene	A 943 -9799	0.30	31.9	ppb	
106-43-4	4-Chlorotoluene	A 943 -9799	0.14	2.10	ppb	
98-06-6	tert-Butylbenzene	A 943 -9799	0.24	0.24	ppb	U
95-63-6	1,2,4-Trimethylbenzene	A 943 -9799	0.30	3.02	ppb	
135-98-8	sec-Butylbenzene	A 943 -9799	0.38	0.38	ppb	U
99-87-6	p-Isopropyltoluene	A 943 -9799	0.32	0.32	ppb	U
541-73-1	1,3-Dichlorobenzene	A 943 -9799	0.094	0.094	ppb	U
106-46-7	1,4-Dichlorobenzene	A 943 -9799	0.34	0.34	ppb	U
95-50-1	1,2-Dichlorobenzene	A 943 -9799	0.13	0.13	ppb	U
105-05-5	p-Diethylbenzene	A 943 -9799	0.34	0.34	ppb	U
104-51-8	n-Butylbenzene	A 943 -9799	0.52	0.52	ppb	U
95-93-2	1,2,4,5-Tetramethylbenzene	A 943 -9799	0.46	0.46	ppb	U



# Environmental Testing Laboratories, Inc.

208 Route 109, Farmingdale NY 11735  
Phone - 631-249-1456 Fax - 631-249-8344

05/21/2003

## Volatile Compounds - EPA 8260B

### Sample: P1918-6

Client Sample ID: DMP-1

Collected: 04/28/2003 18:05

Matrix: Liquid

Type: Grab

Remarks: See Case Narrative

Analyzed Date: 05/05/2003

### Analytical Results

Cas No	Analyte	File ID	MDL	Concentration	Units	Q
96-12-8	1,2-Dibromo-3-chloropropane	A 943 -9799	0.50	0.50	ppb	U
120-82-1	1,2,4-Trichlorobenzene	A 943 -9799	0.28	0.28	ppb	U
87-68-3	Hexachlorobutadiene	A 943 -9799	0.38	0.38	ppb	U
91-20-3	Naphthalene	A 943 -9799	0.80	4.18	ppb	
87-61-6	1,2,3-Trichlorobenzene	A 943 -9799	0.30	0.30	ppb	U

### Surrogate Results

Cas No	Analyte	File ID	% Recovery	QC Limits	Q
460-00-4	4-BROMOFLUOROBENZENE	A940-9716	95.5 %	( 86 - 118 )	
4774-33-8	DIBROMOFLUOROMETHANE	A940-9716	103.0 %	( 64 - 149 )	
2037-26-5	TOLUENE-D8	A940-9716	97.5 %	( 88 - 114 )	
460-00-4	4-BROMOFLUOROBENZENE	A943-9799	97.2 %	( 86 - 118 )	
4774-33-8	DIBROMOFLUOROMETHANE	A943-9799	103.0 %	( 64 - 149 )	
2037-26-5	TOLUENE-D8	A943-9799	96.8 %	( 88 - 114 )	



# Environmental Testing Laboratories, Inc.

208 Route 109, Farmingdale NY 11735  
Phone - 631-249-1456 Fax - 631-249-8344

05/21/2003

## Volatile Compounds - EPA 8260B

### Sample: P1918-7

Client Sample ID: SMP-3

Matrix: Liquid

Remarks: See Case Narrative

Analyzed Date: 05/02/2003

Type: Grab

Collected: 04/28/2003 18:10

### Analytical Results

Cas No	Analyte	File ID	MDL	Concentration	Units	Q
75-71-8	Dichlorodifluoromethane	A 940 -9717	2.90	2.90	ppb	U
75-45-6	Chlorodifluoromethane	A 940 -9717	3.10	3.10	ppb	U
74-87-3	Chloromethane	A 940 -9717	3.10	3.10	ppb	U
75-01-4	Vinyl Chloride	A 940 -9717	2.80	73.9	ppb	
74-83-9	Bromomethane	A 940 -9717	4.50	4.50	ppb	U
75-00-3	Chloroethane	A 940 -9717	4.40	1220	ppb	
75-69-4	Trichlorofluoromethane	A 940 -9717	4.80	4.80	ppb	U
76-13-1	1,1,2-Trichlorotrifluoroethane	A 940 -9717	2.80	2.80	ppb	U
75-35-4	1,1-Dichloroethene	A 940 -9717	2.30	239	ppb	
67-64-1	Acetone	A 940 -9717	14.1	256	ppb	
75-15-0	Carbon disulfide	A 940 -9717	2.60	2.60	ppb	U
75-09-2	Methylene Chloride	A 940 -9717	1.50	13.6	ppb	
156-60-5	trans-1,2-Dichloroethene	A 940 -9717	2.20	2.20	ppb	U
1634-04-4	Methyl t-butyl ether	A 940 -9717	0.53	0.53	ppb	U
75-34-3	1,1-Dichloroethane	A 943 -9800	11.0	5830	ppb	
590-20-7	2,2-Dichloropropane	A 940 -9717	3.70	3.70	ppb	U
156-59-2	cis-1,2-Dichloroethene	A 940 -9717	1.60	1.60	ppb	U
78-93-3	2-Butanone	A 940 -9717	16.4	16.4	ppb	U
74-97-5	Bromochloromethane	A 940 -9717	0.66	0.66	ppb	U
67-66-3	Chloroform	A 940 -9717	1.90	1.90	ppb	U
71-55-6	1,1,1-Trichloroethane	A 943 -9800	11.0	4510	ppb	
56-23-5	Carbon Tetrachloride	A 940 -9717	3.20	3.20	ppb	U
563-58-6	1,1-Dichloropropene	A 940 -9717	4.00	4.00	ppb	U
71-43-2	Benzene	A 940 -9717	2.10	2.10	ppb	U
107-06-2	1,2-Dichloroethane	A 940 -9717	1.70	1.70	ppb	U
79-01-6	Trichloroethene	A 940 -9717	2.10	2.10	ppb	U
78-87-5	1,2-Dichloropropane	A 940 -9717	1.50	1.50	ppb	U
74-95-3	Dibromomethane	A 940 -9717	0.72	0.72	ppb	U
75-27-4	Bromodichloromethane	A 940 -9717	0.84	0.84	ppb	U
110-75-8	2-Chloroethylvinylether	A 940 -9717	8.30	8.30	ppb	U
10061-01-5	cis-1,3-Dichloropropene	A 940 -9717	0.62	0.62	ppb	U
108-10-1	4-Methyl-2-pentanone	A 940 -9717	14.4	14.4	ppb	U
108-88-3	Toluene	A 940 -9717	2.00	32.2	ppb	



# Environmental Testing Laboratories, Inc.

208 Route 109, Farmingdale NY 11735  
Phone - 631-249-1456 Fax - 631-249-8344

05/21/2003

## Volatile Compounds - EPA 8260B

### Sample: P1918-7

Client Sample ID: SMP-3

Collected: 04/28/2003 18:10

Matrix: Liquid

Type: Grab

Remarks: See Case Narrative

Analyzed Date: 05/02/2003

### Analytical Results

Cas No	Analyte	File ID	MDL	Concentration	Units	Q
10061-02-6	trans-1,3-Dichloropropene	A 940 -9717	1.20	1.20	ppb	U
79-00-5	1,1,2-Trichloroethane	A 940 -9717	1.50	1.50	ppb	U
127-18-4	Tetrachloroethene	A 940 -9717	3.80	3.80	ppb	U
142-28-9	1,3-Dichloropropane	A 940 -9717	0.40	0.40	ppb	U
591-78-6	2-Hexanone	A 940 -9717	14.4	14.4	ppb	U
124-48-1	Dibromochloromethane	A 940 -9717	0.44	0.44	ppb	U
106-93-4	1,2-Dibromoethane	A 940 -9717	0.97	0.97	ppb	U
108-90-7	Chlorobenzene	A 940 -9717	1.50	1.50	ppb	U
630-20-6	1,1,1,2-Tetrachloroethane	A 940 -9717	0.61	0.61	ppb	U
100-41-4	Ethylbenzene	A 940 -9717	1.20	1.20	ppb	U
108-38-3	m,p-xylene	A 940 -9717	2.40	2.40	ppb	U
95-47-6	o-xylene	A 940 -9717	1.20	1.20	ppb	U
100-42-5	Styrene	A 940 -9717	0.80	0.80	ppb	U
75-25-2	Bromoform	A 940 -9717	0.73	0.73	ppb	U
98-82-8	Isopropylbenzene	A 940 -9717	1.40	1.40	ppb	U
108-86-1	Bromobenzene	A 940 -9717	1.10	1.10	ppb	U
79-34-5	1,1,2,2-Tetrachloroethane	A 940 -9717	0.94	0.94	ppb	U
103-65-1	n-Propylbenzene	A 940 -9717	1.60	1.60	ppb	U
96-18-4	1,2,3-Trichloropropane	A 940 -9717	0.47	0.47	ppb	U
622-96-8	p-Ethyltoluene	A 940 -9717	1.50	1.50	ppb	U
108-67-8	1,3,5-Trimethylbenzene	A 940 -9717	1.70	1.70	ppb	U
95-49-8	2-Chlorotoluene	A 940 -9717	1.50	1.50	ppb	U
106-43-4	4-Chlorotoluene	A 940 -9717	0.72	0.72	ppb	U
98-06-6	tert-Butylbenzene	A 940 -9717	1.20	1.20	ppb	U
95-63-6	1,2,4-Trimethylbenzene	A 940 -9717	1.50	1.50	ppb	U
135-98-8	sec-Butylbenzene	A 940 -9717	1.90	1.90	ppb	U
99-87-6	p-Isopropyltoluene	A 940 -9717	1.60	1.60	ppb	U
541-73-1	1,3-Dichlorobenzene	A 940 -9717	0.47	0.47	ppb	U
106-46-7	1,4-Dichlorobenzene	A 940 -9717	1.70	1.70	ppb	U
95-50-1	1,2-Dichlorobenzene	A 940 -9717	0.65	0.65	ppb	U
105-05-5	p-Diethylbenzene	A 940 -9717	1.70	1.70	ppb	U
104-51-8	n-Butylbenzene	A 940 -9717	2.60	2.60	ppb	U
95-93-2	1,2,4,5-Tetramethylbenzene	A 940 -9717	2.30	2.30	ppb	U





# Environmental Testing Laboratories, Inc.

208 Route 109, Farmingdale NY 11735  
Phone - 631-249-1456 Fax - 631-249-8344

05/21/2003

## Volatile Compounds - EPA 8260B

### Sample: P1918-7

Client Sample ID: SMP-3

Collected: 04/28/2003 18:10

Matrix: Liquid

Type: Grab

Remarks: See Case Narrative

Analyzed Date: 05/02/2003

### Analytical Results

Cas No	Analyte	File ID	MDL	Concentration	Units	Q
96-12-8	1,2-Dibromo-3-chloropropane	A 940 -9717	2.50	2.50	ppb	U
120-82-1	1,2,4-Trichlorobenzene	A 940 -9717	1.40	1.40	ppb	U
87-68-3	Hexachlorobutadiene	A 940 -9717	1.90	1.90	ppb	U
91-20-3	Naphthalene	A 940 -9717	4.00	4.00	ppb	U
87-61-6	1,2,3-Trichlorobenzene	A 940 -9717	1.50	1.50	ppb	U

### Surrogate Results

Cas No	Analyte	File ID	% Recovery	QC Limits	Q
460-00-4	4-BROMOFLUOROBENZENE	A940-9717	96.6 %	( 86 - 118 )	
4774-33-8	DIBROMOFLUOROMETHANE	A940-9717	104.0 %	( 64 - 149 )	
2037-26-5	TOLUENE-D8	A940-9717	98.0 %	( 88 - 114 )	
460-00-4	4-BROMOFLUOROBENZENE	A943-9800	96.2 %	( 86 - 118 )	
4774-33-8	DIBROMOFLUOROMETHANE	A943-9800	105.0 %	( 64 - 149 )	
2037-26-5	TOLUENE-D8	A943-9800	97.3 %	( 88 - 114 )	



# Environmental Testing Laboratories, Inc.

208 Route 109, Farmingdale NY 11735  
Phone - 631-249-1456 Fax - 631-249-8344

05/21/2003

## Volatile Compounds - EPA 8260B

### Sample: P1918-8

Client Sample ID: DMP-3

Collected: 04/28/2003 18:15

Matrix: Liquid

Type: Grab

Remarks: See Case Narrative

Analyzed Date: 05/02/2003

### Analytical Results

Cas No	Analyte	File ID	MDL	Concentration	Units	Q
75-71-8	Dichlorodifluoromethane	A 940 -9718	5.80	5.80	ppb	U
75-45-6	Chlorodifluoromethane	A 940 -9718	6.20	6.20	ppb	U
74-87-3	Chloromethane	A 940 -9718	6.20	6.20	ppb	U
75-01-4	Vinyl Chloride	A 940 -9718	5.60	146	ppb	
74-83-9	Bromomethane	A 940 -9718	9.00	9.00	ppb	U
75-00-3	Chloroethane	A 940 -9718	8.80	1600	ppb	
75-69-4	Trichlorofluoromethane	A 940 -9718	9.60	9.60	ppb	U
76-13-1	1,1,2-Trichlorotrifluoroethane	A 940 -9718	5.60	5.60	ppb	U
75-35-4	1,1-Dichloroethene	A 940 -9718	4.60	36.2	ppb	
67-64-1	Acetone	A 940 -9718	28.2	173	ppb	
75-15-0	Carbon disulfide	A 940 -9718	5.20	5.20	ppb	U
75-09-2	Methylene Chloride	A 940 -9718	3.00	34.7	ppb	
156-60-5	trans-1,2-Dichloroethene	A 940 -9718	4.40	4.40	ppb	U
1634-04-4	Methyl t-butyl ether	A 940 -9718	1.06	1.06	ppb	U
75-34-3	1,1-Dichloroethane	A 943 -9801	22.0	8320	ppb	
590-20-7	2,2-Dichloropropane	A 940 -9718	7.40	7.40	ppb	U
156-59-2	cis-1,2-Dichloroethene	A 940 -9718	3.20	42.7	ppb	
78-93-3	2-Butanone	A 940 -9718	32.8	32.8	ppb	U
74-97-5	Bromochloromethane	A 940 -9718	1.32	1.32	ppb	U
67-66-3	Chloroform	A 940 -9718	3.80	3.80	ppb	U
71-55-6	1,1,1-Trichloroethane	A 940 -9718	4.40	1510	ppb	
56-23-5	Carbon Tetrachloride	A 940 -9718	6.40	6.40	ppb	U
563-58-6	1,1-Dichloropropene	A 940 -9718	8.00	8.00	ppb	U
71-43-2	Benzene	A 940 -9718	4.20	4.20	ppb	U
107-06-2	1,2-Dichloroethane	A 940 -9718	3.40	3.40	ppb	U
79-01-6	Trichloroethene	A 940 -9718	4.20	4.20	ppb	U
78-87-5	1,2-Dichloropropane	A 940 -9718	3.00	3.00	ppb	U
74-95-3	Dibromomethane	A 940 -9718	1.44	1.44	ppb	U
75-27-4	Bromodichloromethane	A 940 -9718	1.68	1.68	ppb	U
110-75-8	2-Chloroethylvinylether	A 940 -9718	16.6	16.6	ppb	U
10061-01-5	cis-1,3-Dichloropropene	A 940 -9718	1.24	1.24	ppb	U
108-10-1	4-Methyl-2-pentanone	A 940 -9718	28.8	28.8	ppb	U
108-88-3	Toluene	A 940 -9718	4.00	22.5	ppb	



# Environmental Testing Laboratories, Inc.

208 Route 109, Farmingdale NY 11735  
Phone - 631-249-1456 Fax - 631-249-8344

05/21/2003

## Volatile Compounds - EPA 8260B

### Sample: P1918-8

Client Sample ID: DMP-3

Collected: 04/28/2003 18:15

Matrix: Liquid

Type: Grab

Remarks: See Case Narrative

Analyzed Date: 05/02/2003

### Analytical Results

Cas No	Analyte	File ID	MDL	Concentration	Units	Q
10061-02-6	trans-1,3-Dichloropropene	A 940 -9718	2.40	2.40	ppb	U
79-00-5	1,1,2-Trichloroethane	A 940 -9718	3.00	3.00	ppb	U
127-18-4	Tetrachloroethene	A 940 -9718	7.60	21.5	ppb	
142-28-9	1,3-Dichloropropane	A 940 -9718	0.80	0.80	ppb	U
591-78-6	2-Hexanone	A 940 -9718	28.8	28.8	ppb	U
124-48-1	Dibromochloromethane	A 940 -9718	0.88	0.88	ppb	U
106-93-4	1,2-Dibromoethane	A 940 -9718	1.94	1.94	ppb	U
108-90-7	Chlorobenzene	A 940 -9718	3.00	3.00	ppb	U
630-20-6	1,1,1,2-Tetrachloroethane	A 940 -9718	1.22	1.22	ppb	U
100-41-4	Ethylbenzene	A 940 -9718	2.40	2.40	ppb	U
108-38-3	m,p-xylene	A 940 -9718	4.80	4.80	ppb	U
95-47-6	o-xylene	A 940 -9718	2.40	2.40	ppb	U
100-42-5	Styrene	A 940 -9718	1.60	1.60	ppb	U
75-25-2	Bromoform	A 940 -9718	1.46	1.46	ppb	U
98-82-8	Isopropylbenzene	A 940 -9718	2.80	2.80	ppb	U
108-86-1	Bromobenzene	A 940 -9718	2.20	2.20	ppb	U
79-34-5	1,1,2,2-Tetrachloroethane	A 940 -9718	1.88	1.88	ppb	U
103-65-1	n-Propylbenzene	A 940 -9718	3.20	3.20	ppb	U
96-18-4	1,2,3-Trichloropropane	A 940 -9718	0.94	0.94	ppb	U
622-96-8	p-Ethyltoluene	A 940 -9718	3.00	3.00	ppb	U
108-67-8	1,3,5-Trimethylbenzene	A 940 -9718	3.40	3.40	ppb	U
95-49-8	2-Chlorotoluene	A 940 -9718	3.00	3.00	ppb	U
106-43-4	4-Chlorotoluene	A 940 -9718	1.44	1.44	ppb	U
98-06-6	tert-Butylbenzene	A 940 -9718	2.40	2.40	ppb	U
95-63-6	1,2,4-Trimethylbenzene	A 940 -9718	3.00	3.00	ppb	U
135-98-8	sec-Butylbenzene	A 940 -9718	3.80	3.80	ppb	U
99-87-6	p-Isopropyltoluene	A 940 -9718	3.20	3.20	ppb	U
541-73-1	1,3-Dichlorobenzene	A 940 -9718	0.94	0.94	ppb	U
106-46-7	1,4-Dichlorobenzene	A 940 -9718	3.40	3.40	ppb	U
95-50-1	1,2-Dichlorobenzene	A 940 -9718	1.30	1.30	ppb	U
105-05-5	p-Diethylbenzene	A 940 -9718	3.40	3.40	ppb	U
104-51-8	n-Butylbenzene	A 940 -9718	5.20	5.20	ppb	U
95-93-2	1,2,4,5-Tetramethylbenzene	A 940 -9718	4.60	4.60	ppb	U



# Environmental Testing Laboratories, Inc.

208 Route 109, Farmingdale NY 11735  
Phone - 631-249-1456 Fax - 631-249-8344

05/21/2003

## Volatile Compounds - EPA 8260B

### Sample: P1918-8

Client Sample ID: DMP-3

Collected: 04/28/2003 18:15

Matrix: Liquid

Type: Grab

Remarks: See Case Narrative

Analyzed Date: 05/02/2003

### Analytical Results

Cas No	Analyte	File ID	MDL	Concentration	Units	Q
96-12-8	1,2-Dibromo-3-chloropropane	A 940 -9718	5.00	5.00	ppb	U
120-82-1	1,2,4-Trichlorobenzene	A 940 -9718	2.80	2.80	ppb	U
87-68-3	Hexachlorobutadiene	A 940 -9718	3.80	3.80	ppb	U
91-20-3	Naphthalene	A 940 -9718	8.00	8.00	ppb	U
87-61-6	1,2,3-Trichlorobenzene	A 940 -9718	3.00	3.00	ppb	U

### Surrogate Results

Cas No	Analyte	File ID	% Recovery	QC Limits	Q
460-00-4	4-BROMOFLUOROBENZENE	A940-9718	95.7 %	( 86 - 118)	
4774-33-8	DIBROMOFLUOROMETHANE	A940-9718	103.0 %	( 64 - 149)	
2037-26-5	TOLUENE-D8	A940-9718	95.5 %	( 88 - 114)	
460-00-4	4-BROMOFLUOROBENZENE	A943-9801	96.1 %	( 86 - 118)	
4774-33-8	DIBROMOFLUOROMETHANE	A943-9801	103.0 %	( 64 - 149)	
2037-26-5	TOLUENE-D8	A943-9801	96.9 %	( 88 - 114)	



# Environmental Testing Laboratories, Inc.

208 Route 109, Farmingdale NY 11735  
Phone - 631-249-1456 Fax - 631-249-8344

05/21/2003

## Volatile Compounds - EPA 8260B

### Sample: P1918-9

Client Sample ID: SMP-4

Collected: 04/28/2003 18:20

Matrix: Liquid

Type: Grab

Remarks: See Case Narrative

Analyzed Date: 05/05/2003

### Analytical Results

Cas No	Analyte	File ID	MDL	Concentration	Units	Q
75-71-8	Dichlorodifluoromethane	A 943 -9802	1.45	1.45	ppb	U
75-45-6	Chlorodifluoromethane	A 943 -9802	1.55	1.55	ppb	U
74-87-3	Chloromethane	A 943 -9802	1.55	1.55	ppb	U
75-01-4	Vinyl Chloride	A 943 -9802	1.40	10.1	ppb	
74-83-9	Bromomethane	A 943 -9802	2.25	2.25	ppb	U
75-00-3	Chloroethane	A 940 -9719	13.2	1010	ppb	
75-69-4	Trichlorofluoromethane	A 943 -9802	2.40	2.40	ppb	U
76-13-1	1,1,2-Trichlorotrifluoroethane	A 943 -9802	1.40	1.40	ppb	U
75-35-4	1,1-Dichloroethene	A 943 -9802	1.15	1.15	ppb	U
67-64-1	Acetone	A 943 -9802	7.05	433	ppb	
75-15-0	Carbon disulfide	A 943 -9802	1.30	1.30	ppb	U
75-09-2	Methylene Chloride	A 943 -9802	0.75	9.85	ppb	
156-60-5	trans-1,2-Dichloroethene	A 943 -9802	1.10	1.10	ppb	U
1634-04-4	Methyl t-butyl ether	A 943 -9802	0.26	0.26	ppb	U
75-34-3	1,1-Dichloroethane	A 943 -9802	1.10	80.4	ppb	
590-20-7	2,2-Dichloropropane	A 943 -9802	1.85	1.85	ppb	U
156-59-2	cis-1,2-Dichloroethene	A 943 -9802	0.80	31.0	ppb	
78-93-3	2-Butanone	A 943 -9802	8.20	8.20	ppb	U
74-97-5	Bromochloromethane	A 943 -9802	0.33	0.33	ppb	U
67-66-3	Chloroform	A 943 -9802	0.95	0.95	ppb	U
71-55-6	1,1,1-Trichloroethane	A 943 -9802	1.10	8.54	ppb	
56-23-5	Carbon Tetrachloride	A 943 -9802	1.60	1.60	ppb	U
563-58-6	1,1-Dichloropropene	A 943 -9802	2.00	2.00	ppb	U
71-43-2	Benzene	A 943 -9802	1.05	1.05	ppb	U
107-06-2	1,2-Dichloroethane	A 943 -9802	0.85	0.85	ppb	U
79-01-6	Trichloroethene	A 943 -9802	1.05	9.80	ppb	
78-87-5	1,2-Dichloropropane	A 943 -9802	0.75	0.75	ppb	U
74-95-3	Dibromomethane	A 943 -9802	0.36	0.36	ppb	U
75-27-4	Bromodichloromethane	A 943 -9802	0.42	0.42	ppb	U
110-75-8	2-Chloroethylvinylether	A 943 -9802	4.15	4.15	ppb	U
10061-01-5	cis-1,3-Dichloropropene	A 943 -9802	0.31	0.31	ppb	U
108-10-1	4-Methyl-2-pentanone	A 943 -9802	7.20	7.20	ppb	U
108-88-3	Toluene	A 943 -9802	1.00	1.00	ppb	U



# Environmental Testing Laboratories, Inc.

208 Route 109, Farmingdale NY 11735  
Phone - 631-249-1456 Fax - 631-249-8344

05/21/2003

## Volatile Compounds - EPA 8260B

### Sample: P1918-9

Client Sample ID: SMP-4

Collected: 04/28/2003 18:20

Matrix: Liquid

Type: Grab

Remarks: See Case Narrative

Analyzed Date: 05/05/2003

### Analytical Results

Cas No	Analyte	File ID	MDL	Concentration	Units	Q
10061-02-6	trans-1,3-Dichloropropene	A 943 -9802	0.60	0.60	ppb	U
79-00-5	1,1,2-Trichloroethane	A 943 -9802	0.75	0.75	ppb	U
127-18-4	Tetrachloroethene	A 943 -9802	1.90	102	ppb	
142-28-9	1,3-Dichloropropane	A 943 -9802	0.20	0.20	ppb	U
591-78-6	2-Hexanone	A 943 -9802	7.20	7.20	ppb	U
124-48-1	Dibromochloromethane	A 943 -9802	0.22	0.22	ppb	U
106-93-4	1,2-Dibromoethane	A 943 -9802	0.49	0.49	ppb	U
108-90-7	Chlorobenzene	A 943 -9802	0.75	0.75	ppb	U
630-20-6	1,1,1,2-Tetrachloroethane	A 943 -9802	0.31	0.31	ppb	U
100-41-4	Ethylbenzene	A 943 -9802	0.60	0.60	ppb	U
108-38-3	m,p-xylene	A 943 -9802	1.20	6.61	ppb	
95-47-6	o-xylene	A 943 -9802	0.60	0.60	ppb	U
100-42-5	Styrene	A 943 -9802	0.40	0.40	ppb	U
75-25-2	Bromoform	A 943 -9802	0.37	0.37	ppb	U
98-82-8	Isopropylbenzene	A 943 -9802	0.70	0.70	ppb	U
108-86-1	Bromobenzene	A 943 -9802	0.55	0.55	ppb	U
79-34-5	1,1,2,2-Tetrachloroethane	A 943 -9802	0.47	0.47	ppb	U
103-65-1	n-Propylbenzene	A 943 -9802	0.80	0.80	ppb	U
96-18-4	1,2,3-Trichloropropane	A 943 -9802	0.23	0.23	ppb	U
622-96-8	p-Ethyltoluene	A 943 -9802	0.75	0.75	ppb	U
108-67-8	1,3,5-Trimethylbenzene	A 943 -9802	0.85	0.85	ppb	U
95-49-8	2-Chlorotoluene	A 943 -9802	0.75	0.75	ppb	U
106-43-4	4-Chlorotoluene	A 943 -9802	0.36	0.36	ppb	U
98-06-6	tert-Butylbenzene	A 943 -9802	0.60	0.60	ppb	U
95-63-6	1,2,4-Trimethylbenzene	A 943 -9802	0.75	0.75	ppb	U
135-98-8	sec-Butylbenzene	A 943 -9802	0.95	0.95	ppb	U
99-87-6	p-Isopropyltoluene	A 943 -9802	0.80	0.80	ppb	U
541-73-1	1,3-Dichlorobenzene	A 943 -9802	0.23	0.23	ppb	U
106-46-7	1,4-Dichlorobenzene	A 943 -9802	0.85	0.85	ppb	U
95-50-1	1,2-Dichlorobenzene	A 943 -9802	0.32	0.32	ppb	U
105-05-5	p-Diethylbenzene	A 943 -9802	0.85	0.85	ppb	U
104-51-8	n-Butylbenzene	A 943 -9802	1.30	1.30	ppb	U
95-93-2	1,2,4,5-Tetramethylbenzene	A 943 -9802	1.15	1.15	ppb	U



# Environmental Testing Laboratories, Inc.

208 Route 109, Farmingdale NY 11735

Phone - 631-249-1456 Fax - 631-249-8344

05/21/2003

## Volatile Compounds - EPA 8260B

### Sample: P1918-9

Client Sample ID: SMP-4

Collected: 04/28/2003 18:20

Matrix: Liquid

Type: Grab

Remarks: See Case Narrative

Analyzed Date: 05/05/2003

### Analytical Results

Cas No	Analyte	File ID	MDL	Concentration	Units	Q
96-12-8	1,2-Dibromo-3-chloropropane	A 943 -9802	1.25	1.25	ppb	U
120-82-1	1,2,4-Trichlorobenzene	A 943 -9802	0.70	0.70	ppb	U
87-68-3	Hexachlorobutadiene	A 943 -9802	0.95	0.95	ppb	U
91-20-3	Naphthalene	A 943 -9802	2.00	2.00	ppb	U
87-61-6	1,2,3-Trichlorobenzene	A 943 -9802	0.75	0.75	ppb	U

### Surrogate Results

Cas No	Analyte	File ID	% Recovery	QC Limits	Q
460-00-4	4-BROMOFLUOROBENZENE	A940-9719	93.9 %	( 86 - 118 )	
4774-33-8	DIBROMOFLUOROMETHANE	A940-9719	101.0 %	( 64 - 149 )	
2037-26-5	TOLUENE-D8	A940-9719	98.4 %	( 88 - 114 )	
460-00-4	4-BROMOFLUOROBENZENE	A943-9802	95.1 %	( 86 - 118 )	
4774-33-8	DIBROMOFLUOROMETHANE	A943-9802	101.0 %	( 64 - 149 )	
2037-26-5	TOLUENE-D8	A943-9802	97.2 %	( 88 - 114 )	



# Environmental Testing Laboratories, Inc.

208 Route 109, Farmingdale NY 11735  
Phone - 631-249-1456 Fax - 631-249-8344

05/21/2003

## Volatile Compounds - EPA 8260B

### Sample: P1918-10

Client Sample ID: DMP-4

Matrix: Liquid

Remarks: See Case Narrative

Analyzed Date: 05/02/2003

Type: Grab

Collected: 04/28/2003 18:25

### Analytical Results

Cas No	Analyte	File ID	MDL	Concentration	Units	Q
75-71-8	Dichlorodifluoromethane	A 940 -9720	14.5	14.5	ppb	U
75-45-6	Chlorodifluoromethane	A 940 -9720	15.5	15.5	ppb	U
74-87-3	Chloromethane	A 940 -9720	15.5	15.5	ppb	U
75-01-4	Vinyl Chloride	A 940 -9720	14.0	14.0	ppb	U
74-83-9	Bromomethane	A 940 -9720	22.5	22.5	ppb	U
75-00-3	Chloroethane	A 940 -9720	22.0	5460	ppb	
75-69-4	Trichlorofluoromethane	A 940 -9720	24.0	24.0	ppb	U
76-13-1	1,1,2-Trichlorotrifluoroethane	A 940 -9720	14.0	14.0	ppb	U
75-35-4	1,1-Dichloroethene	A 940 -9720	11.5	11.5	ppb	U
67-64-1	Acetone	A 940 -9720	70.5	70.5	ppb	U
75-15-0	Carbon disulfide	A 940 -9720	13.0	13.0	ppb	U
75-09-2	Methylene Chloride	A 940 -9720	7.50	7.50	ppb	U
156-60-5	trans-1,2-Dichloroethene	A 940 -9720	11.0	11.0	ppb	U
1634-04-4	Methyl t-butyl ether	A 940 -9720	2.65	2.65	ppb	U
75-34-3	1,1-Dichloroethane	A 940 -9720	11.0	92.5	ppb	
590-20-7	2,2-Dichloropropane	A 940 -9720	18.5	18.5	ppb	U
156-59-2	cis-1,2-Dichloroethene	A 940 -9720	8.00	8.00	ppb	U
78-93-3	2-Butanone	A 940 -9720	82.0	82.0	ppb	U
74-97-5	Bromochloromethane	A 940 -9720	3.30	3.30	ppb	U
67-66-3	Chloroform	A 940 -9720	9.50	9.50	ppb	U
71-55-6	1,1,1-Trichloroethane	A 940 -9720	11.0	11.0	ppb	U
56-23-5	Carbon Tetrachloride	A 940 -9720	16.0	16.0	ppb	U
563-58-6	1,1-Dichloropropene	A 940 -9720	20.0	20.0	ppb	U
71-43-2	Benzene	A 940 -9720	10.5	10.5	ppb	U
107-06-2	1,2-Dichloroethane	A 940 -9720	8.50	8.50	ppb	U
79-01-6	Trichloroethene	A 940 -9720	10.5	10.5	ppb	U
78-87-5	1,2-Dichloropropane	A 940 -9720	7.50	7.50	ppb	U
74-95-3	Dibromomethane	A 940 -9720	3.60	3.60	ppb	U
75-27-4	Bromodichloromethane	A 940 -9720	4.20	4.20	ppb	U
110-75-8	2-Chloroethylvinylether	A 940 -9720	41.5	41.5	ppb	U
10061-01-5	cis-1,3-Dichloropropene	A 940 -9720	3.10	3.10	ppb	U
108-10-1	4-Methyl-2-pentanone	A 940 -9720	72.0	72.0	ppb	U
108-88-3	Toluene	A 940 -9720	10.0	10.0	ppb	U





# Environmental Testing Laboratories, Inc.

208 Route 109, Farmingdale NY 11735  
Phone - 631-249-1456 Fax - 631-249-8344

05/21/2003

## Volatile Compounds - EPA 8260B

Sample: P1918-10

Client Sample ID: DMP-4

Matrix: Liquid

Type: Grab

Collected: 04/28/2003 18:25

Remarks: See Case Narrative

Analyzed Date: 05/02/2003

### Analytical Results

Cas No	Analyte	File ID	MDL	Concentration	Units	Q
10061-02-6	trans-1,3-Dichloropropene	A 940 -9720	6.00	6.00	ppb	U
79-00-5	1,1,2-Trichloroethane	A 940 -9720	7.50	7.50	ppb	U
127-18-4	Tetrachloroethene	A 940 -9720	19.0	19.0	ppb	U
142-28-9	1,3-Dichloropropane	A 940 -9720	2.00	2.00	ppb	U
591-78-6	2-Hexanone	A 940 -9720	72.0	72.0	ppb	U
124-48-1	Dibromochloromethane	A 940 -9720	2.20	2.20	ppb	U
106-93-4	1,2-Dibromoethane	A 940 -9720	4.85	4.85	ppb	U
108-90-7	Chlorobenzene	A 940 -9720	7.50	7.50	ppb	U
630-20-6	1,1,1,2-Tetrachloroethane	A 940 -9720	3.05	3.05	ppb	U
100-41-4	Ethylbenzene	A 940 -9720	6.00	6.00	ppb	U
108-38-3	m,p-xylene	A 940 -9720	12.0	12.0	ppb	U
95-47-6	o-xylene	A 940 -9720	6.00	6.00	ppb	U
100-42-5	Styrene	A 940 -9720	4.00	4.00	ppb	U
75-25-2	Bromoform	A 940 -9720	3.65	3.65	ppb	U
98-82-8	Isopropylbenzene	A 940 -9720	7.00	7.00	ppb	U
108-86-1	Bromobenzene	A 940 -9720	5.50	5.50	ppb	U
79-34-5	1,1,2,2-Tetrachloroethane	A 940 -9720	4.70	4.70	ppb	U
103-65-1	n-Propylbenzene	A 940 -9720	8.00	8.00	ppb	U
96-18-4	1,2,3-Trichloropropane	A 940 -9720	2.35	2.35	ppb	U
622-96-8	p-Ethyltoluene	A 940 -9720	7.50	7.50	ppb	U
108-67-8	1,3,5-Trimethylbenzene	A 940 -9720	8.50	8.50	ppb	U
95-49-8	2-Chlorotoluene	A 940 -9720	7.50	7.50	ppb	U
106-43-4	4-Chlorotoluene	A 940 -9720	3.60	3.60	ppb	U
98-06-6	tert-Butylbenzene	A 940 -9720	6.00	6.00	ppb	U
95-63-6	1,2,4-Trimethylbenzene	A 940 -9720	7.50	7.50	ppb	U
135-98-8	sec-Butylbenzene	A 940 -9720	9.50	9.50	ppb	U
99-87-6	p-Isopropyltoluene	A 940 -9720	8.00	8.00	ppb	U
541-73-1	1,3-Dichlorobenzene	A 940 -9720	2.35	2.35	ppb	U
106-46-7	1,4-Dichlorobenzene	A 940 -9720	8.50	8.50	ppb	U
95-50-1	1,2-Dichlorobenzene	A 940 -9720	3.25	3.25	ppb	U
105-05-5	p-Diethylbenzene	A 940 -9720	8.50	8.50	ppb	U
104-51-8	n-Butylbenzene	A 940 -9720	13.0	13.0	ppb	U
95-93-2	1,2,4,5-Tetramethylbenzene	A 940 -9720	11.5	11.5	ppb	U



# Environmental Testing Laboratories, Inc.

208 Route 109, Farmingdale NY 11735

Phone - 631-249-1456 Fax - 631-249-8344

05/21/2003

## Volatile Compounds - EPA 8260B

**Sample: P1918-10**

Client Sample ID: DMP-4

Matrix: Liquid

Remarks: See Case Narrative

Analyzed Date: 05/02/2003

Type: Grab

Collected: 04/28/2003 18:25

### Analytical Results

Cas No	Analyte	File ID	MDL	Concentration	Units	Q
96-12-8	1,2-Dibromo-3-chloropropane	A 940 -9720	12.5	12.5	ppb	U
120-82-1	1,2,4-Trichlorobenzene	A 940 -9720	7.00	7.00	ppb	U
87-68-3	Hexachlorobutadiene	A 940 -9720	9.50	9.50	ppb	U
91-20-3	Naphthalene	A 940 -9720	20.0	20.0	ppb	U
87-61-6	1,2,3-Trichlorobenzene	A 940 -9720	7.50	7.50	ppb	U

### Surrogate Results

Cas No	Analyte	File ID	% Recovery	QC Limits	Q
460-00-4	4-BROMOFLUOROBENZENE	A940-9720	96.7 %	( 86 - 118)	
4774-33-8	DIBROMOFLUOROMETHANE	A940-9720	103.0 %	( 64 - 149)	
2037-26-5	TOLUENE-D8	A940-9720	97.1 %	( 88 - 114)	



# Environmental Testing Laboratories, Inc.

208 Route 109, Farmingdale NY 11735  
Phone - 631-249-1456 Fax - 631-249-8344

05/21/2003

## Volatile Compounds - EPA 8260B

**Sample: P1918-11**

Client Sample ID: MW-1S

Matrix: Liquid

Remarks: See Case Narrative

Analyzed Date: 05/05/2003

Type: Grab

Collected: 04/29/2003 13:30

### Analytical Results

Cas No	Analyte	File ID	MDL	Concentration	Units	Q
75-71-8	Dichlorodifluoromethane	A 943 -9803	0.58	0.58	ppb	U
75-45-6	Chlorodifluoromethane	A 943 -9803	0.62	0.62	ppb	U
74-87-3	Chloromethane	A 943 -9803	0.62	0.62	ppb	U
75-01-4	Vinyl Chloride	A 943 -9803	0.56	0.56	ppb	U
74-83-9	Bromomethane	A 943 -9803	0.90	0.90	ppb	U
75-00-3	Chloroethane	A 943 -9803	0.88	0.88	ppb	U
75-69-4	Trichlorofluoromethane	A 943 -9803	0.96	0.96	ppb	U
76-13-1	1,1,2-Trichlorotrifluoroethane	A 943 -9803	0.56	0.56	ppb	U
75-35-4	1,1-Dichloroethene	A 943 -9803	0.46	0.46	ppb	U
67-64-1	Acetone	A 943 -9803	2.82	2.82	ppb	U
75-15-0	Carbon disulfide	A 943 -9803	0.52	0.52	ppb	U
75-09-2	Methylene Chloride	A 943 -9803	0.30	0.30	ppb	U
156-60-5	trans-1,2-Dichloroethene	A 943 -9803	0.44	0.44	ppb	U
1634-04-4	Methyl t-butyl ether	A 943 -9803	0.11	0.11	ppb	U
75-34-3	1,1-Dichloroethane	A 943 -9803	0.44	0.44	ppb	U
590-20-7	2,2-Dichloropropane	A 943 -9803	0.74	0.74	ppb	U
156-59-2	cis-1,2-Dichloroethene	A 943 -9803	0.32	3.03	ppb	
78-93-3	2-Butanone	A 943 -9803	3.28	3.28	ppb	U
74-97-5	Bromochloromethane	A 943 -9803	0.13	0.13	ppb	U
67-66-3	Chloroform	A 943 -9803	0.38	0.38	ppb	U
71-55-6	1,1,1-Trichloroethane	A 943 -9803	0.44	0.44	ppb	U
56-23-5	Carbon Tetrachloride	A 943 -9803	0.64	0.64	ppb	U
563-58-6	1,1-Dichloropropene	A 943 -9803	0.80	0.80	ppb	U
71-43-2	Benzene	A 943 -9803	0.42	0.42	ppb	U
107-06-2	1,2-Dichloroethane	A 943 -9803	0.34	0.34	ppb	U
79-01-6	Trichloroethene	A 943 -9803	0.42	0.42	ppb	U
78-87-5	1,2-Dichloropropane	A 943 -9803	0.30	0.30	ppb	U
74-95-3	Dibromomethane	A 943 -9803	0.14	0.14	ppb	U
75-27-4	Bromodichloromethane	A 943 -9803	0.17	0.17	ppb	U
110-75-8	2-Chloroethylvinylether	A 943 -9803	1.66	1.66	ppb	U
10061-01-5	cis-1,3-Dichloropropene	A 943 -9803	0.12	0.12	ppb	U
108-10-1	4-Methyl-2-pentanone	A 943 -9803	2.88	2.88	ppb	U
108-88-3	Toluene	A 943 -9803	0.40	0.40	ppb	U



# Environmental Testing Laboratories, Inc.

208 Route 109, Farmingdale NY 11735

Phone - 631-249-1456 Fax - 631-249-8344

05/21/2003

## Volatile Compounds - EPA 8260B

### Sample: P1918-11

Client Sample ID: MW-1S

Matrix: Liquid

Remarks: See Case Narrative

Analyzed Date: 05/05/2003

Type: Grab

Collected: 04/29/2003 13:30

### Analytical Results

Cas No	Analyte	File ID	MDL	Concentration	Units	Q
10061-02-6	trans-1,3-Dichloropropene	A 943 -9803	0.24	0.24	ppb	U
79-00-5	1,1,2-Trichloroethane	A 943 -9803	0.30	0.30	ppb	U
127-18-4	Tetrachloroethene	A 943 -9803	0.76	10.0	ppb	
142-28-9	1,3-Dichloropropane	A 943 -9803	0.080	0.080	ppb	U
591-78-6	2-Hexanone	A 943 -9803	2.88	2.88	ppb	U
124-48-1	Dibromochloromethane	A 943 -9803	0.088	0.088	ppb	U
106-93-4	1,2-Dibromoethane	A 943 -9803	0.19	0.19	ppb	U
108-90-7	Chlorobenzene	A 943 -9803	0.30	0.30	ppb	U
630-20-6	1,1,1,2-Tetrachloroethane	A 943 -9803	0.12	0.12	ppb	U
100-41-4	Ethylbenzene	A 943 -9803	0.24	0.24	ppb	U
108-38-3	m,p-xylene	A 943 -9803	0.48	0.48	ppb	U
95-47-6	o-xylene	A 943 -9803	0.24	0.24	ppb	U
100-42-5	Styrene	A 943 -9803	0.16	0.16	ppb	U
75-25-2	Bromoform	A 943 -9803	0.15	0.15	ppb	U
98-82-8	Isopropylbenzene	A 943 -9803	0.28	0.28	ppb	U
108-86-1	Bromobenzene	A 943 -9803	0.22	0.22	ppb	U
79-34-5	1,1,1,2-Tetrachloroethane	A 943 -9803	0.19	0.19	ppb	U
103-65-1	n-Propylbenzene	A 943 -9803	0.32	0.32	ppb	U
96-18-4	1,2,3-Trichloropropane	A 943 -9803	0.094	0.094	ppb	U
622-96-8	p-Ethyltoluene	A 943 -9803	0.30	0.30	ppb	U
108-67-8	1,3,5-Trimethylbenzene	A 943 -9803	0.34	0.34	ppb	U
95-49-8	2-Chlorotoluene	A 943 -9803	0.30	0.30	ppb	U
106-43-4	4-Chlorotoluene	A 943 -9803	0.14	0.14	ppb	U
98-06-6	tert-Butylbenzene	A 943 -9803	0.24	0.24	ppb	U
95-63-6	1,2,4-Trimethylbenzene	A 943 -9803	0.30	0.30	ppb	U
135-98-8	sec-Butylbenzene	A 943 -9803	0.38	0.38	ppb	U
99-87-6	p-Isopropyltoluene	A 943 -9803	0.32	0.32	ppb	U
541-73-1	1,3-Dichlorobenzene	A 943 -9803	0.094	0.094	ppb	U
106-46-7	1,4-Dichlorobenzene	A 943 -9803	0.34	0.34	ppb	U
95-50-1	1,2-Dichlorobenzene	A 943 -9803	0.13	0.13	ppb	U
105-05-5	p-Diethylbenzene	A 943 -9803	0.34	0.34	ppb	U
104-51-8	n-Butylbenzene	A 943 -9803	0.52	0.52	ppb	U
95-93-2	1,2,4,5-Tetramethylbenzene	A 943 -9803	0.46	0.46	ppb	U



# Environmental Testing Laboratories, Inc.

208 Route 109, Farmingdale NY 11735

Phone - 631-249-1456 Fax - 631-249-8344

05/21/2003

## Volatile Compounds - EPA 8260B

**Sample: P1918-11**

Client Sample ID: MW-1S

Matrix: Liquid

Remarks: See Case Narrative

Analyzed Date: 05/05/2003

Type: Grab

Collected: 04/29/2003 13:30

### Analytical Results

Cas No	Analyte	File ID	MDL	Concentration	Units	Q
96-12-8	1,2-Dibromo-3-chloropropane	A 943 -9803	0.50	0.50	ppb	U
120-82-1	1,2,4-Trichlorobenzene	A 943 -9803	0.28	0.28	ppb	U
87-68-3	Hexachlorobutadiene	A 943 -9803	0.38	0.38	ppb	U
91-20-3	Naphthalene	A 943 -9803	0.80	0.80	ppb	U
87-61-6	1,2,3-Trichlorobenzene	A 943 -9803	0.30	0.30	ppb	U

### Surrogate Results

Cas No	Analyte	File ID	% Recovery	QC Limits	Q
460-00-4	4-BROMOFLUOROBENZENE	A943-9803	95.8 %	( 86 - 118 )	
4774-33-8	DIBROMOFLUOROMETHANE	A943-9803	102.0 %	( 64 - 149 )	
2037-26-5	TOLUENE-D8	A943-9803	97.1 %	( 88 - 114 )	



# Environmental Testing Laboratories, Inc.

208 Route 109, Farmingdale NY 11735  
Phone - 631-249-1456 Fax - 631-249-8344

05/21/2003

## Volatile Compounds - EPA 8260B

### Sample: P1918-12

Client Sample ID: MW-2S

Collected: 04/29/2003 14:00

Matrix: Liquid

Type: Grab

Remarks: See Case Narrative

Analyzed Date: 05/07/2003

### Analytical Results

Cas No	Analyte	File ID	MDL	Concentration	Units	Q
75-71-8	Dichlorodifluoromethane	C 960 -189	0.34	0.34	ppb	U
75-45-6	Chlorodifluoromethane	C 960 -189	0.30	0.30	ppb	U
74-87-3	Chloromethane	C 960 -189	0.28	0.28	ppb	U
75-01-4	Vinyl Chloride	C 960 -189	0.22	0.22	ppb	U
74-83-9	Bromomethane	C 960 -189	0.30	0.30	ppb	U
75-00-3	Chloroethane	C 960 -189	0.56	0.56	ppb	U
75-69-4	Trichlorofluoromethane	C 960 -189	0.26	0.26	ppb	U
76-13-1	1,1,2-Trichlorotrifluoroethane	C 960 -189	0.38	0.38	ppb	U
75-35-4	1,1-Dichloroethene	C 960 -189	0.32	0.32	ppb	U
67-64-1	Acetone	C 960 -189	3.16	3.16	ppb	U
75-15-0	Carbon disulfide	C 960 -189	0.26	0.26	ppb	U
75-09-2	Methylene Chloride	C 960 -189	0.32	1.86	ppb	
156-60-5	trans-1,2-Dichloroethene	C 960 -189	0.30	0.30	ppb	U
1634-04-4	Methyl t-butyl ether	C 960 -189	0.15	0.15	ppb	U
75-34-3	1,1-Dichloroethane	C 960 -189	0.19	0.19	ppb	U
590-20-7	2,2-Dichloropropane	C 960 -189	0.66	0.66	ppb	U
156-59-2	cis-1,2-Dichloroethene	C 960 -189	0.34	0.34	ppb	U
78-93-3	2-Butanone	C 960 -189	0.92	0.92	ppb	U
74-97-5	Bromochloromethane	C 960 -189	0.28	0.28	ppb	U
67-66-3	Chloroform	C 960 -189	0.14	0.14	ppb	U
71-55-6	1,1,1-Trichloroethane	C 960 -189	0.32	0.32	ppb	U
56-23-5	Carbon Tetrachloride	C 960 -189	0.24	0.24	ppb	U
563-58-6	1,1-Dichloropropene	C 960 -189	0.32	0.32	ppb	U
71-43-2	Benzene	C 960 -189	0.22	0.22	ppb	U
107-06-2	1,2-Dichloroethane	C 960 -189	0.24	0.24	ppb	U
79-01-6	Trichloroethene	C 960 -189	0.32	0.32	ppb	U
78-87-5	1,2-Dichloropropane	C 960 -189	0.22	0.22	ppb	U
74-95-3	Dibromomethane	C 960 -189	0.34	0.34	ppb	U
75-27-4	Bromodichloromethane	C 960 -189	0.22	0.22	ppb	U
110-75-8	2-Chloroethylvinylether	C 960 -189	0.38	0.38	ppb	U
10061-01-5	cis-1,3-Dichloropropene	C 960 -189	0.18	0.18	ppb	U
108-10-1	4-Methyl-2-pentanone	C 960 -189	1.62	1.62	ppb	U
108-88-3	Toluene	C 960 -189	0.18	0.18	ppb	U



# Environmental Testing Laboratories, Inc.

208 Route 109, Farmingdale NY 11735  
Phone - 631-249-1456 Fax - 631-249-8344

05/21/2003

## Volatile Compounds - EPA 8260B

### Sample: P1918-12

Client Sample ID: MW-2S

Collected: 04/29/2003 14:00

Matrix: Liquid

Type: Grab

Remarks: See Case Narrative

Analyzed Date: 05/07/2003

### Analytical Results

Cas No	Analyte	File ID	MDL	Concentration	Units	Q
10061-02-6	trans-1,3-Dichloropropene	C 960 -189	0.26	0.26	ppb	U
79-00-5	1,1,2-Trichloroethane	C 960 -189	0.28	0.28	ppb	U
127-18-4	Tetrachloroethene	C 960 -189	0.78	0.78	ppb	U
142-28-9	1,3-Dichloropropane	C 960 -189	0.20	0.20	ppb	U
591-78-6	2-Hexanone	C 960 -189	2.02	2.02	ppb	U
124-48-1	Dibromochloromethane	C 960 -189	0.22	0.22	ppb	U
106-93-4	1,2-Dibromoethane	C 960 -189	0.22	0.22	ppb	U
108-90-7	Chlorobenzene	C 960 -189	0.26	0.26	ppb	U
630-20-6	1,1,1,2-Tetrachloroethane	C 960 -189	0.22	0.22	ppb	U
100-41-4	Ethylbenzene	C 960 -189	0.22	0.22	ppb	U
108-38-3	m,p-xylene	C 960 -189	0.66	0.66	ppb	U
95-47-6	o-xylene	C 960 -189	0.26	0.26	ppb	U
100-42-5	Styrene	C 960 -189	1.94	1.94	ppb	U
75-25-2	Bromoform	C 960 -189	0.28	0.28	ppb	U
98-82-8	Isopropylbenzene	C 960 -189	0.19	0.19	ppb	U
108-86-1	Bromobenzene	C 960 -189	0.14	0.14	ppb	U
79-34-5	1,1,2,2-Tetrachloroethane	C 960 -189	0.18	0.18	ppb	U
103-65-1	n-Propylbenzene	C 960 -189	0.24	0.24	ppb	U
96-18-4	1,2,3-Trichloropropane	C 960 -189	0.56	0.56	ppb	U
622-96-8	p-Ethyltoluene	C 960 -189	0.24	0.24	ppb	U
108-67-8	1,3,5-Trimethylbenzene	C 960 -189	0.19	0.19	ppb	U
95-49-8	2-Chlorotoluene	C 960 -189	0.30	0.30	ppb	U
106-43-4	4-Chlorotoluene	C 960 -189	0.28	0.28	ppb	U
98-06-6	tert-Butylbenzene	C 960 -189	0.30	0.30	ppb	U
95-63-6	1,2,4-Trimethylbenzene	C 960 -189	0.22	0.22	ppb	U
135-98-8	sec-Butylbenzene	C 960 -189	0.22	0.22	ppb	U
99-87-6	p-Isopropyltoluene	C 960 -189	0.24	0.24	ppb	U
541-73-1	1,3-Dichlorobenzene	C 960 -189	0.17	0.17	ppb	U
106-46-7	1,4-Dichlorobenzene	C 960 -189	0.14	0.14	ppb	U
95-50-1	1,2-Dichlorobenzene	C 960 -189	0.22	0.22	ppb	U
105-05-5	p-Diethylbenzene	C 960 -189	0.22	0.22	ppb	U
104-51-8	n-Butylbenzene	C 960 -189	0.18	0.18	ppb	U
95-93-2	1,2,4,5-Tetramethylbenzene	C 960 -189	0.24	0.24	ppb	U



# Environmental Testing Laboratories, Inc.

208 Route 109, Farmingdale NY 11735  
Phone - 631-249-1456 Fax - 631-249-8344

05/21/2003

## Volatile Compounds - EPA 8260B

### Sample: P1918-12

Client Sample ID: MW-2S

Collected: 04/29/2003 14:00

Matrix: Liquid

Type: Grab

Remarks: See Case Narrative

Analyzed Date: 05/07/2003

### Analytical Results

Cas No	Analyte	File ID	MDL	Concentration	Units	Q
96-12-8	1,2-Dibromo-3-chloropropane	C 960 -189	0.30	0.30	ppb	U
120-82-1	1,2,4-Trichlorobenzene	C 960 -189	0.26	0.26	ppb	U
87-68-3	Hexachlorobutadiene	C 960 -189	0.74	0.74	ppb	U
91-20-3	Naphthalene	C 960 -189	0.92	0.92	ppb	U
87-61-6	1,2,3-Trichlorobenzene	C 960 -189	0.24	0.24	ppb	U

### Surrogate Results

Cas No	Analyte	File ID	% Recovery	QC Limits	Q
460-00-4	4-BROMOFLUOROBENZENE	C960-189	98.6 %	( 86 - 118)	*
4774-33-8	DIBROMOFLUOROMETHANE	C960-189	98.6 %	( 64 - 149)	
2037-26-5	TOLUENE-D8	C960-189	98.9 %	( 88 - 114)	





# Environmental Testing Laboratories, Inc.

208 Route 109, Farmingdale NY 11735  
Phone - 631-249-1456 Fax - 631-249-8344

05/21/2003

## Volatile Compounds - EPA 8260B

### Sample: P1918-13

Client Sample ID: MW-3S

Collected: 04/29/2003 12:00

Matrix: Liquid

Type: Grab

Remarks: See Case Narrative

Analyzed Date: 05/07/2003

### Analytical Results

Cas No	Analyte	File ID	MDL	Concentration	Units	Q
75-71-8	Dichlorodifluoromethane	C 960 -190	0.34	0.34	ppb	U
75-45-6	Chlorodifluoromethane	C 960 -190	0.30	0.30	ppb	U
74-87-3	Chloromethane	C 960 -190	0.28	0.28	ppb	U
75-01-4	Vinyl Chloride	C 960 -190	0.22	0.22	ppb	U
74-83-9	Bromomethane	C 960 -190	0.30	0.30	ppb	U
75-00-3	Chloroethane	C 960 -190	0.56	0.56	ppb	U
75-69-4	Trichlorofluoromethane	C 960 -190	0.26	0.26	ppb	U
76-13-1	1,1,2-Trichlorotrifluoroethane	C 960 -190	0.38	0.38	ppb	U
75-35-4	1,1-Dichloroethene	C 960 -190	0.32	0.32	ppb	U
67-64-1	Acetone	C 960 -190	3.16	3.16	ppb	U
75-15-0	Carbon disulfide	C 960 -190	0.26	0.26	ppb	U
75-09-2	Methylene Chloride	C 960 -190	0.32	2.24	ppb	
156-60-5	trans-1,2-Dichloroethene	C 960 -190	0.30	0.30	ppb	U
1634-04-4	Methyl t-butyl ether	C 960 -190	0.15	0.15	ppb	U
75-34-3	1,1-Dichloroethane	C 960 -190	0.19	0.19	ppb	U
590-20-7	2,2-Dichloropropane	C 960 -190	0.66	0.66	ppb	U
156-59-2	cis-1,2-Dichloroethene	C 960 -190	0.34	0.34	ppb	U
78-93-3	2-Butanone	C 960 -190	0.92	0.92	ppb	U
74-97-5	Bromochloromethane	C 960 -190	0.28	0.28	ppb	U
67-66-3	Chloroform	C 960 -190	0.14	0.14	ppb	U
71-55-6	1,1,1-Trichloroethane	C 960 -190	0.32	0.32	ppb	U
56-23-5	Carbon Tetrachloride	C 960 -190	0.24	0.24	ppb	U
563-58-6	1,1-Dichloropropene	C 960 -190	0.32	0.32	ppb	U
71-43-2	Benzene	C 960 -190	0.22	0.22	ppb	U
107-06-2	1,2-Dichloroethane	C 960 -190	0.24	0.24	ppb	U
79-01-6	Trichloroethene	C 960 -190	0.32	25.7	ppb	
78-87-5	1,2-Dichloropropane	C 960 -190	0.22	0.22	ppb	U
74-95-3	Dibromomethane	C 960 -190	0.34	0.34	ppb	U
75-27-4	Bromodichloromethane	C 960 -190	0.22	0.22	ppb	U
110-75-8	2-Chloroethylvinylether	C 960 -190	0.38	0.38	ppb	U
10061-01-5	cis-1,3-Dichloropropene	C 960 -190	0.18	0.18	ppb	U
108-10-1	4-Methyl-2-pentanone	C 960 -190	1.62	1.62	ppb	U
108-88-3	Toluene	C 960 -190	0.18	0.18	ppb	U



# Environmental Testing Laboratories, Inc.

208 Route 109, Farmingdale NY 11735  
Phone - 631-249-1456 Fax - 631-249-8344

05/21/2003

## Volatile Compounds - EPA 8260B

### Sample: P1918-13

Client Sample ID: MW-3S

Collected: 04/29/2003 12:00

Matrix: Liquid

Type: Grab

Remarks: See Case Narrative

Analyzed Date: 05/07/2003

### Analytical Results

Cas No	Analyte	File ID	MDL	Concentration	Units	Q
10061-02-6	trans-1,3-Dichloropropene	C 960 -190	0.26	0.26	ppb	U
79-00-5	1,1,2-Trichloroethane	C 960 -190	0.28	0.28	ppb	U
127-18-4	Tetrachloroethene	C 960 -190	0.78	4.03	ppb	
142-28-9	1,3-Dichloropropane	C 960 -190	0.20	0.20	ppb	U
591-78-6	2-Hexanone	C 960 -190	2.02	2.02	ppb	U
124-48-1	Dibromochloromethane	C 960 -190	0.22	0.22	ppb	U
106-93-4	1,2-Dibromoethane	C 960 -190	0.22	0.22	ppb	U
108-90-7	Chlorobenzene	C 960 -190	0.26	0.26	ppb	U
630-20-6	1,1,1,2-Tetrachloroethane	C 960 -190	0.22	0.22	ppb	U
100-41-4	Ethylbenzene	C 960 -190	0.22	0.22	ppb	U
108-38-3	m,p-xylene	C 960 -190	0.66	0.66	ppb	U
95-47-6	o-xylene	C 960 -190	0.26	0.26	ppb	U
100-42-5	Styrene	C 960 -190	1.94	1.94	ppb	U
75-25-2	Bromoform	C 960 -190	0.28	0.28	ppb	U
98-82-8	Isopropylbenzene	C 960 -190	0.19	0.19	ppb	U
108-86-1	Bromobenzene	C 960 -190	0.14	0.14	ppb	U
79-34-5	1,1,1,2-Tetrachloroethane	C 960 -190	0.18	0.18	ppb	U
103-65-1	n-Propylbenzene	C 960 -190	0.24	0.24	ppb	U
96-18-4	1,2,3-Trichloropropane	C 960 -190	0.56	0.56	ppb	U
622-96-8	p-Ethyltoluene	C 960 -190	0.24	0.24	ppb	U
108-67-8	1,3,5-Trimethylbenzene	C 960 -190	0.19	0.19	ppb	U
95-49-8	2-Chlorotoluene	C 960 -190	0.30	0.30	ppb	U
106-43-4	4-Chlorotoluene	C 960 -190	0.28	0.28	ppb	U
98-06-6	tert-Butylbenzene	C 960 -190	0.30	0.30	ppb	U
95-63-6	1,2,4-Trimethylbenzene	C 960 -190	0.22	0.22	ppb	U
135-98-8	sec-Butylbenzene	C 960 -190	0.22	0.22	ppb	U
99-87-6	p-Isopropyltoluene	C 960 -190	0.24	0.24	ppb	U
541-73-1	1,3-Dichlorobenzene	C 960 -190	0.17	0.17	ppb	U
106-46-7	1,4-Dichlorobenzene	C 960 -190	0.14	0.14	ppb	U
95-50-1	1,2-Dichlorobenzene	C 960 -190	0.22	0.22	ppb	U
105-05-5	p-Diethylbenzene	C 960 -190	0.22	0.22	ppb	U
104-51-8	n-Butylbenzene	C 960 -190	0.18	0.18	ppb	U
95-93-2	1,2,4,5-Tetramethylbenzene	C 960 -190	0.24	0.24	ppb	U



# Environmental Testing Laboratories, Inc.

208 Route 109, Farmingdale NY 11735

Phone - 631-249-1456 Fax - 631-249-8344

05/21/2003

## Volatile Compounds - EPA 8260B

### Sample: P1918-13

Client Sample ID: MW-3S

Collected: 04/29/2003 12:00

Matrix: Liquid

Type: Grab

Remarks: See Case Narrative

Analyzed Date: 05/07/2003

### Analytical Results

Cas No	Analyte	File ID	MDL	Concentration	Units	Q
96-12-8	1,2-Dibromo-3-chloropropane	C 960 -190	0.30	0.30	ppb	U
120-82-1	1,2,4-Trichlorobenzene	C 960 -190	0.26	0.26	ppb	U
87-68-3	Hexachlorobutadiene	C 960 -190	0.74	0.74	ppb	U
91-20-3	Naphthalene	C 960 -190	0.92	0.92	ppb	U
87-61-6	1,2,3-Trichlorobenzene	C 960 -190	0.24	0.24	ppb	U

### Surrogate Results

Cas No	Analyte	File ID	% Recovery	QC Limits	Q
460-00-4	4-BROMOFLUOROBENZENE	C960-190	98.7 %	( 86 - 118)	
4774-33-8	DIBROMOFLUOROMETHANE	C960-190	98.5 %	( 64 - 149)	
2037-26-5	TOLUENE-D8	C960-190	99.9 %	( 88 - 114)	



# Environmental Testing Laboratories, Inc.

208 Route 109, Farmingdale NY 11735  
Phone - 631-249-1456 Fax - 631-249-8344

05/21/2003

## Volatile Compounds - EPA 8260B

### Sample: P1918-14

Client Sample ID: MW-4S

Collected: 04/29/2003 15:10

Matrix: Liquid

Type: Grab

Remarks: See Case Narrative

Analyzed Date: 05/03/2003

### Analytical Results

Cas No	Analyte	File ID	MDL	Concentration	Units	Q
75-71-8	Dichlorodifluoromethane	A 942 -9761	2.90	2.90	ppb	U
75-45-6	Chlorodifluoromethane	A 942 -9761	3.10	3.10	ppb	U
74-87-3	Chloromethane	A 942 -9761	3.10	3.10	ppb	U
75-01-4	Vinyl Chloride	A 942 -9761	2.80	2.80	ppb	U
74-83-9	Bromomethane	A 942 -9761	4.50	4.50	ppb	U
75-00-3	Chloroethane	A 942 -9761	4.40	4.40	ppb	U
75-69-4	Trichlorofluoromethane	A 942 -9761	4.80	4.80	ppb	U
76-13-1	1,1,2-Trichlorotrifluoroethane	A 942 -9761	2.80	2.80	ppb	U
75-35-4	1,1-Dichloroethene	A 942 -9761	2.30	2.30	ppb	U
67-64-1	Acetone	A 942 -9761	14.1	14.1	ppb	U
75-15-0	Carbon disulfide	A 942 -9761	2.60	2.60	ppb	U
75-09-2	Methylene Chloride	A 942 -9761	1.50	1.50	ppb	U
156-60-5	trans-1,2-Dichloroethene	A 942 -9761	2.20	2.20	ppb	U
1634-04-4	Methyl t-butyl ether	A 942 -9761	0.53	0.53	ppb	U
75-34-3	1,1-Dichloroethane	A 942 -9761	2.20	2.20	ppb	U
590-20-7	2,2-Dichloropropane	A 942 -9761	3.70	3.70	ppb	U
156-59-2	cis-1,2-Dichloroethene	A 942 -9761	1.60	1.60	ppb	U
78-93-3	2-Butanone	A 942 -9761	16.4	16.4	ppb	U
74-97-5	Bromochloromethane	A 942 -9761	0.66	0.66	ppb	U
67-66-3	Chloroform	A 942 -9761	1.90	1.90	ppb	U
71-55-6	1,1,1-Trichloroethane	A 942 -9761	2.20	2.20	ppb	U
56-23-5	Carbon Tetrachloride	A 942 -9761	3.20	3.20	ppb	U
563-58-6	1,1-Dichloropropene	A 942 -9761	4.00	4.00	ppb	U
71-43-2	Benzene	A 942 -9761	2.10	2.10	ppb	U
107-06-2	1,2-Dichloroethane	A 942 -9761	1.70	1.70	ppb	U
79-01-6	Trichloroethene	A 942 -9761	2.10	21.8	ppb	
78-87-5	1,2-Dichloropropane	A 942 -9761	1.50	1.50	ppb	U
74-95-3	Dibromomethane	A 942 -9761	0.72	0.72	ppb	U
75-27-4	Bromodichloromethane	A 942 -9761	0.84	0.84	ppb	U
110-75-8	2-Chloroethylvinylether	A 942 -9761	8.30	8.30	ppb	U
10061-01-5	cis-1,3-Dichloropropene	A 942 -9761	0.62	0.62	ppb	U
108-10-1	4-Methyl-2-pentanone	A 942 -9761	14.4	14.4	ppb	U
108-88-3	Toluene	A 942 -9761	2.00	2.00	ppb	U



# Environmental Testing Laboratories, Inc.

208 Route 109, Farmingdale NY 11735  
Phone - 631-249-1456 Fax - 631-249-8344

05/21/2003

## Volatile Compounds - EPA 8260B

### Sample: P1918-14

Client Sample ID: MW-4S

Collected: 04/29/2003 15:10

Matrix: Liquid

Type: Grab

Remarks: See Case Narrative

Analyzed Date: 05/03/2003

### Analytical Results

Cas No	Analyte	File ID	MDL	Concentration	Units	Q
10061-02-6	trans-1,3-Dichloropropene	A 942 -9761	1.20	1.20	ppb	U
79-00-5	1,1,2-Trichloroethane	A 942 -9761	1.50	1.50	ppb	U
127-18-4	Tetrachloroethene	A 942 -9761	3.80	1420	ppb	
142-28-9	1,3-Dichloropropane	A 942 -9761	0.40	0.40	ppb	U
591-78-6	2-Hexanone	A 942 -9761	14.4	14.4	ppb	U
124-48-1	Dibromochloromethane	A 942 -9761	0.44	0.44	ppb	U
106-93-4	1,2-Dibromoethane	A 942 -9761	0.97	0.97	ppb	U
108-90-7	Chlorobenzene	A 942 -9761	1.50	1.50	ppb	U
630-20-6	1,1,1,2-Tetrachloroethane	A 942 -9761	0.61	0.61	ppb	U
100-41-4	Ethylbenzene	A 942 -9761	1.20	1.20	ppb	U
108-38-3	m,p-xylene	A 942 -9761	2.40	2.40	ppb	U
95-47-6	o-xylene	A 942 -9761	1.20	1.20	ppb	U
100-42-5	Styrene	A 942 -9761	0.80	0.80	ppb	U
75-25-2	Bromoform	A 942 -9761	0.73	0.73	ppb	U
98-82-8	Isopropylbenzene	A 942 -9761	1.40	1.40	ppb	U
108-86-1	Bromobenzene	A 942 -9761	1.10	1.10	ppb	U
79-34-5	1,1,2,2-Tetrachloroethane	A 942 -9761	0.94	0.94	ppb	U
103-65-1	n-Propylbenzene	A 942 -9761	1.60	1.60	ppb	U
96-18-4	1,2,3-Trichloropropane	A 942 -9761	0.47	0.47	ppb	U
622-96-8	p-Ethyltoluene	A 942 -9761	1.50	1.50	ppb	U
108-67-8	1,3,5-Trimethylbenzene	A 942 -9761	1.70	1.70	ppb	U
95-49-8	2-Chlorotoluene	A 942 -9761	1.50	1.50	ppb	U
106-43-4	4-Chlorotoluene	A 942 -9761	0.72	0.72	ppb	U
98-06-6	tert-Butylbenzene	A 942 -9761	1.20	1.20	ppb	U
95-63-6	1,2,4-Trimethylbenzene	A 942 -9761	1.50	1.50	ppb	U
135-98-8	sec-Butylbenzene	A 942 -9761	1.90	1.90	ppb	U
99-87-6	p-Isopropyltoluene	A 942 -9761	1.60	1.60	ppb	U
541-73-1	1,3-Dichlorobenzene	A 942 -9761	0.47	0.47	ppb	U
106-46-7	1,4-Dichlorobenzene	A 942 -9761	1.70	1.70	ppb	U
95-50-1	1,2-Dichlorobenzene	A 942 -9761	0.65	0.65	ppb	U
105-05-5	p-Diethylbenzene	A 942 -9761	1.70	1.70	ppb	U
104-51-8	n-Butylbenzene	A 942 -9761	2.60	2.60	ppb	U
95-93-2	1,2,4,5-Tetramethylbenzene	A 942 -9761	2.30	2.30	ppb	U



# Environmental Testing Laboratories, Inc.

208 Route 109, Farmingdale NY 11735  
Phone - 631-249-1456 Fax - 631-249-8344

05/21/2003

## Volatile Compounds - EPA 8260B

### Sample: P1918-14

Client Sample ID: MW-4S

Collected: 04/29/2003 15:10

Matrix: Liquid

Type: Grab

Remarks: See Case Narrative

Analyzed Date: 05/03/2003

### Analytical Results

Cas No	Analyte	File ID	MDL	Concentration	Units	Q
96-12-8	1,2-Dibromo-3-chloropropane	A 942 -9761	2.50	2.50	ppb	U
120-82-1	1,2,4-Trichlorobenzene	A 942 -9761	1.40	1.40	ppb	U
87-68-3	Hexachlorobutadiene	A 942 -9761	1.90	1.90	ppb	U
91-20-3	Naphthalene	A 942 -9761	4.00	4.00	ppb	U
87-61-6	1,2,3-Trichlorobenzene	A 942 -9761	1.50	1.50	ppb	U

### Surrogate Results

Cas No	Analyte	File ID	% Recovery	QC Limits	Q
460-00-4	4-BROMOFLUOROBENZENE	A942-9761	96.3 %	( 86 - 118)	
4774-33-8	DIBROMOFLUOROMETHANE	A942-9761	103.0 %	( 64 - 149)	
2037-26-5	TOLUENE-D8	A942-9761	96.9 %	( 88 - 114)	



# Environmental Testing Laboratories, Inc.

208 Route 109, Farmingdale NY 11735  
Phone - 631-249-1456 Fax - 631-249-8344

05/21/2003

## Total Iron by Method SW846 6010

### Sample: P1918-1

Client Sample ID: MW-8

Collected: 04/28/2003 18:35

Matrix: Liquid

Type: Grab

Remarks:

Analyzed Date: 05/02/2003

Preparation Date(s) : 05/01/2003

### Analytical Results

Cas No	Analyte	MDL	Concentration	Units	Q
7439-89-6	Iron	0.018	0.061	ppm	

### Sample: P1918-2

Client Sample ID: MW-12

Collected: 04/28/2003 18:45

Matrix: Liquid

Type: Grab

Remarks:

Analyzed Date: 05/02/2003

Preparation Date(s) : 05/01/2003

### Analytical Results

Cas No	Analyte	MDL	Concentration	Units	Q
7439-89-6	Iron	0.018	42.1	ppm	

### Sample: P1918-3

Client Sample ID: MW-13

Collected: 04/29/2003 08:50

Matrix: Liquid

Type: Grab

Remarks:

Analyzed Date: 05/02/2003

Preparation Date(s) : 05/01/2003

### Analytical Results

Cas No	Analyte	MDL	Concentration	Units	Q
7439-89-6	Iron	0.018	61.1	ppm	



# Environmental Testing Laboratories, Inc.

208 Route 109, Farmingdale NY 11735  
Phone - 631-249-1456 Fax - 631-249-8344

05/21/2003

## Total Iron by Method SW846 6010

### Sample: P1918-4

Client Sample ID: MW-14

Collected: 04/28/2003 17:50

Matrix: Liquid

Type: Grab

Remarks:

Analyzed Date: 05/02/2003

Preparation Date(s) : 05/01/2003

### Analytical Results

Cas No	Analyte	MDL	Concentration	Units	Q
7439-89-6	Iron	0.018	219	ppm	

### Sample: P1918-5

Client Sample ID: SMP-1

Collected: 04/28/2003 18:00

Matrix: Liquid

Type: Grab

Remarks:

Analyzed Date: 05/02/2003

Preparation Date(s) : 05/01/2003

### Analytical Results

Cas No	Analyte	MDL	Concentration	Units	Q
7439-89-6	Iron	0.018	42.2	ppm	

### Sample: P1918-6

Client Sample ID: DMP-1

Collected: 04/28/2003 18:05

Matrix: Liquid

Type: Grab

Remarks:

Analyzed Date: 05/02/2003

Preparation Date(s) : 05/01/2003

### Analytical Results

Cas No	Analyte	MDL	Concentration	Units	Q
7439-89-6	Iron	0.018	13.1	ppm	





# Environmental Testing Laboratories, Inc.

208 Route 109, Farmingdale NY 11735  
Phone - 631-249-1456 Fax - 631-249-8344

05/21/2003

## Total Iron by Method SW846 6010

### Sample: P1918-7

Client Sample ID: SMP-3

Collected: 04/28/2003 18:10

Matrix: Liquid

Type: Grab

Remarks:

Analyzed Date: 05/02/2003

Preparation Date(s) : 05/01/2003

### Analytical Results

Cas No	Analyte	MDL	Concentration	Units	Q
7439-89-6	Iron	0.018	9.00	ppm	

### Sample: P1918-8

Client Sample ID: DMP-3

Collected: 04/28/2003 18:15

Matrix: Liquid

Type: Grab

Remarks:

Analyzed Date: 05/02/2003

Preparation Date(s) : 05/01/2003

### Analytical Results

Cas No	Analyte	MDL	Concentration	Units	Q
7439-89-6	Iron	0.018	3.70	ppm	

### Sample: P1918-9

Client Sample ID: SMP-4

Collected: 04/28/2003 18:20

Matrix: Liquid

Type: Grab

Remarks:

Analyzed Date: 05/02/2003

Preparation Date(s) : 05/01/2003

### Analytical Results

Cas No	Analyte	MDL	Concentration	Units	Q
7439-89-6	Iron	0.018	209	ppm	



# Environmental Testing Laboratories, Inc.

208 Route 109, Farmingdale NY 11735  
Phone - 631-249-1456 Fax - 631-249-8344

05/21/2003

## Total Iron by Method SW846 6010

**Sample: P1918-10**

Client Sample ID: DMP-4

Collected: 04/28/2003 18:25

Matrix: Liquid

Type: Grab

Remarks:

Analyzed Date: 05/02/2003

Preparation Date(s) : 05/01/2003

### Analytical Results

Cas No	Analyte	MDL	Concentration	Units	Q
7439-89-6	Iron	0.018	62.1	ppm	



# Environmental Testing Laboratories, Inc.

208 Route 109, Farmingdale NY 11735  
Phone - 631-249-1456 Fax - 631-249-8344

05/21/2003

## Nitrogen/Nitrate - EPA 353.2

### Sample: P1918-1

Client Sample ID: MW-8

Collected: 04/28/2003 18:35

Matrix: Liquid

Type: Grab

Remarks:

Analyzed Date: 05/01/2003

### Analytical Results

Cas No	Analyte	MDL	Result	Units	Q
14797-55-8	Nitrate	0.025	6.14	ppm	

### Sample: P1918-2

Client Sample ID: MW-12

Collected: 04/28/2003 18:45

Matrix: Liquid

Type: Grab

Remarks:

Analyzed Date: 05/01/2003

### Analytical Results

Cas No	Analyte	MDL	Result	Units	Q
14797-55-8	Nitrate	0.025	0.10	ppm	

### Sample: P1918-3

Client Sample ID: MW-13

Collected: 04/29/2003 08:50

Matrix: Liquid

Type: Grab

Remarks:

Analyzed Date: 05/01/2003

### Analytical Results

Cas No	Analyte	MDL	Result	Units	Q
14797-55-8	Nitrate	0.025	0.57	ppm	



# Environmental Testing Laboratories, Inc.

208 Route 109, Farmingdale NY 11735  
Phone - 631-249-1456 Fax - 631-249-8344

05/21/2003

## Nitrogen/Nitrate - EPA 353.2

### Sample: P1918-4

Client Sample ID: MW-14

Collected: 04/28/2003 17:50

Matrix: Liquid

Type: Grab

Remarks:

Analyzed Date: 05/01/2003

### Analytical Results

Cas No	Analyte	MDL	Result	Units	Q
14797-55-8	Nitrate	0.025	0.025	ppm	

### Sample: P1918-5

Client Sample ID: SMP-1

Collected: 04/28/2003 18:00

Matrix: Liquid

Type: Grab

Remarks:

Analyzed Date: 05/01/2003

### Analytical Results

Cas No	Analyte	MDL	Result	Units	Q
14797-55-8	Nitrate	0.025	0.11	ppm	

### Sample: P1918-6

Client Sample ID: DMP-1

Collected: 04/28/2003 18:05

Matrix: Liquid

Type: Grab

Remarks:

Analyzed Date: 05/01/2003

### Analytical Results

Cas No	Analyte	MDL	Result	Units	Q
14797-55-8	Nitrate	0.025	0.088	ppm	



# Environmental Testing Laboratories, Inc.

208 Route 109, Farmingdale NY 11735  
Phone - 631-249-1456 Fax - 631-249-8344

05/21/2003

## Nitrogen/Nitrate - EPA 353.2

### Sample: P1918-7

Client Sample ID: SMP-3

Collected: 04/28/2003 18:10

Matrix: Liquid

Type: Grab

Remarks:

Analyzed Date: 05/01/2003

### Analytical Results

Cas No	Analyte	MDL	Result	Units	Q
14797-55-8	Nitrate	0.025	0.076	ppm	

### Sample: P1918-8

Client Sample ID: DMP-3

Collected: 04/28/2003 18:15

Matrix: Liquid

Type: Grab

Remarks:

Analyzed Date: 05/01/2003

### Analytical Results

Cas No	Analyte	MDL	Result	Units	Q
14797-55-8	Nitrate	0.025	0.051	ppm	

### Sample: P1918-9

Client Sample ID: SMP-4

Collected: 04/28/2003 18:20

Matrix: Liquid

Type: Grab

Remarks:

Analyzed Date: 05/01/2003

### Analytical Results

Cas No	Analyte	MDL	Result	Units	Q
14797-55-8	Nitrate	0.025	0.050	ppm	



# Environmental Testing Laboratories, Inc.

208 Route 109, Farmingdale NY 11735  
Phone - 631-249-1456 Fax - 631-249-8344

05/21/2003

## Nitrogen/Nitrate - EPA 353.2

**Sample: P1918-10**

Client Sample ID: DMP-4

Matrix: Liquid

Remarks:

Analyzed Date: 05/01/2003

Type: Grab

Collected: 04/28/2003 18:25

### Analytical Results

Cas No	Analyte	MDL	Result	Units	Q
14797-55-8	Nitrate	0.025	0.18	ppm	



# Environmental Testing Laboratories, Inc.

208 Route 109, Farmingdale NY 11735  
Phone - 631-249-1456 Fax - 631-249-8344

05/21/2003

## Sulfate - EPA 375.4

### Sample: P1918-1

Client Sample ID: MW-8

Collected: 04/28/2003 18:35

Matrix: Liquid

Type: Grab

Remarks:

Analyzed Date: 05/06/2003

### Analytical Results

Cas No	Analyte	MDL	Result	Units	Q
14808-79-8	Sulfate	1.12	28.1	ppm	

### Sample: P1918-2

Client Sample ID: MW-12

Collected: 04/28/2003 18:45

Matrix: Liquid

Type: Grab

Remarks:

Analyzed Date: 05/06/2003

### Analytical Results

Cas No	Analyte	MDL	Result	Units	Q
14808-79-8	Sulfate	5.58	244	ppm	

### Sample: P1918-3

Client Sample ID: MW-13

Collected: 04/29/2003 08:50

Matrix: Liquid

Type: Grab

Remarks:

Analyzed Date: 05/06/2003

### Analytical Results

Cas No	Analyte	MDL	Result	Units	Q
14808-79-8	Sulfate	5.58	442	ppm	



# Environmental Testing Laboratories, Inc.

208 Route 109, Farmingdale NY 11735  
Phone - 631-249-1456 Fax - 631-249-8344

05/21/2003

## Sulfate - EPA 375.4

### Sample: P1918-4

Client Sample ID: MW-14

Collected: 04/28/2003 17:50

Matrix: Liquid

Type: Grab

Remarks:

Analyzed Date: 05/06/2003

### Analytical Results

Cas No	Analyte	MDL	Result	Units	Q
14808-79-8	Sulfate	5.58	141	ppm	

### Sample: P1918-5

Client Sample ID: SMP-1

Collected: 04/28/2003 18:00

Matrix: Liquid

Type: Grab

Remarks:

Analyzed Date: 05/06/2003

### Analytical Results

Cas No	Analyte	MDL	Result	Units	Q
14808-79-8	Sulfate	1.12	25.2	ppm	

### Sample: P1918-6

Client Sample ID: DMP-1

Collected: 04/28/2003 18:05

Matrix: Liquid

Type: Grab

Remarks:

Analyzed Date: 05/06/2003

### Analytical Results

Cas No	Analyte	MDL	Result	Units	Q
14808-79-8	Sulfate	5.58	523	ppm	





# Environmental Testing Laboratories, Inc.

208 Route 109, Farmingdale NY 11735  
Phone - 631-249-1456 Fax - 631-249-8344

05/21/2003

## Sulfate - EPA 375.4

### Sample: P1918-7

Client Sample ID: SMP-3

Collected: 04/28/2003 18:10

Matrix: Liquid

Type: Grab

Remarks:

Analyzed Date: 05/06/2003

### Analytical Results

Cas No	Analyte	MDL	Result	Units	Q
14808-79-8	Sulfate	1.12	75.2	ppm	

### Sample: P1918-8

Client Sample ID: DMP-3

Collected: 04/28/2003 18:15

Matrix: Liquid

Type: Grab

Remarks:

Analyzed Date: 05/06/2003

### Analytical Results

Cas No	Analyte	MDL	Result	Units	Q
14808-79-8	Sulfate	27.9	1290	ppm	

### Sample: P1918-9

Client Sample ID: SMP-4

Collected: 04/28/2003 18:20

Matrix: Liquid

Type: Grab

Remarks:

Analyzed Date: 05/06/2003

### Analytical Results

Cas No	Analyte	MDL	Result	Units	Q
14808-79-8	Sulfate	5.58	119	ppm	



# Environmental Testing Laboratories, Inc.

208 Route 109, Farmingdale NY 11735  
Phone - 631-249-1456 Fax - 631-249-8344

05/21/2003

## Sulfate - EPA 375.4

**Sample: P1918-10**

Client Sample ID: DMP-4

Matrix: Liquid

Remarks:

Analyzed Date: 05/06/2003

Type: Grab

Collected: 04/28/2003 18:25

### Analytical Results

Cas No	Analyte	MDL	Result	Units	Q
14808-79-8	Sulfate	5.58	222	ppm	



# Environmental Testing Laboratories, Inc.

208 Route 109, Farmingdale NY 11735  
Phone - 631-249-1456 Fax - 631-249-8344

05/21/2003

## Total Organic Carbon - Method 415.1

### Sample: P1918-1

Client Sample ID: MW-8

Collected: 04/28/2003 18:35

Matrix: Liquid

Type: Grab

Remarks:

Analyzed Date: 05/20/2003

### Analytical Results

Cas No	Analyte	MDL	Result	Units	Q
	TOC	0.51	6.58	ppm	

### Sample: P1918-2

Client Sample ID: MW-12

Collected: 04/28/2003 18:45

Matrix: Liquid

Type: Grab

Remarks:

Analyzed Date: 05/20/2003

### Analytical Results

Cas No	Analyte	MDL	Result	Units	Q
	TOC	0.51	59.2	ppm	

### Sample: P1918-3

Client Sample ID: MW-13

Collected: 04/29/2003 08:50

Matrix: Liquid

Type: Grab

Remarks:

Analyzed Date: 05/20/2003

### Analytical Results

Cas No	Analyte	MDL	Result	Units	Q
	TOC	0.51	38.9	ppm	



# Environmental Testing Laboratories, Inc.

208 Route 109, Farmingdale NY 11735  
Phone - 631-249-1456 Fax - 631-249-8344

05/21/2003

## Total Organic Carbon - Method 415.1

### Sample: P1918-4

Client Sample ID: MW-14

Collected: 04/28/2003 17:50

Matrix: Liquid

Type: Grab

Remarks:

Analyzed Date: 05/20/2003

### Analytical Results

Cas No	Analyte	MDL	Result	Units	Q
	TOC	0.51	2650	ppm	

### Sample: P1918-5

Client Sample ID: SMP-1

Collected: 04/28/2003 18:00

Matrix: Liquid

Type: Grab

Remarks:

Analyzed Date: 05/20/2003

### Analytical Results

Cas No	Analyte	MDL	Result	Units	Q
	TOC	0.51	1280	ppm	

### Sample: P1918-6

Client Sample ID: DMP-1

Collected: 04/28/2003 18:05

Matrix: Liquid

Type: Grab

Remarks:

Analyzed Date: 05/20/2003

### Analytical Results

Cas No	Analyte	MDL	Result	Units	Q
	TOC	0.51	284	ppm	



# Environmental Testing Laboratories, Inc.

208 Route 109, Farmingdale NY 11735  
Phone - 631-249-1456 Fax - 631-249-8344

05/21/2003

## Total Organic Carbon - Method 415.1

### Sample: P1918-7

Client Sample ID: SMP-3

Collected: 04/28/2003 18:10

Matrix: Liquid

Type: Grab

Remarks:

Analyzed Date: 05/20/2003

### Analytical Results

Cas No	Analyte	MDL	Result	Units	Q
	TOC	0.51	184	ppm	

### Sample: P1918-8

Client Sample ID: DMP-3

Collected: 04/28/2003 18:15

Matrix: Liquid

Type: Grab

Remarks:

Analyzed Date: 05/20/2003

### Analytical Results

Cas No	Analyte	MDL	Result	Units	Q
	TOC	0.51	166	ppm	

### Sample: P1918-9

Client Sample ID: SMP-4

Collected: 04/28/2003 18:20

Matrix: Liquid

Type: Grab

Remarks:

Analyzed Date: 05/20/2003

### Analytical Results

Cas No	Analyte	MDL	Result	Units	Q
	TOC	0.51	1160	ppm	



# Environmental Testing Laboratories, Inc.

208 Route 109, Farmingdale NY 11735  
Phone - 631-249-1456 Fax - 631-249-8344

05/21/2003

## Total Organic Carbon - Method 415.1

**Sample: P1918-10**

Client Sample ID: DMP-4

Matrix: Liquid

Remarks:

Analyzed Date: 05/20/2003

Type: Grab

Collected: 04/28/2003 18:25

### Analytical Results

Cas No	Analyte	MDL	Result	Units	Q
	TOC	0.51	306	ppm	



# Environmental Testing Laboratories, Inc.

208 Route 109, Farmingdale NY 11735

Phone - 631-249-1456 Fax - 631-249-8344

05/21/2003

## Case Narrative

VOLATILES by EPA 8260:

The following compounds were calibrated at 25, 50, 100, 150 and 200 ppb levels in the initial calibration curve:

Acetone  
2-Butanone  
4-Methyl-2-pentanone  
2-Hexanone

M&P-Xylenes and 2-Chloroethylvinylether were calibrated at 10, 40, 100, 200 and 300 ppb levels.

All other compounds were calibrated at 5, 20, 50, 100 and 150 ppb levels.

P1918-4, -5 and -10: The pH of these samples was 6.0.

*Patricia Werner-Els*

---

*Reviewed By Quality Assurance Officer*



# Environmental Testing Laboratories, Inc.

208 Route 109, Farmingdale NY 11735

Phone - 631-249-1456 Fax - 631-249-8344

05/21/2003

## ORGANIC METHOD QUALIFIERS

Q - Qualifier - specified entries and their meanings are as follows:

- U - The analytical result is a non-detect.
- J - Indicates an estimated value. The concentration reported was detected below the Method Detection Limit.
- B - The analyte was found in the associated method blank as well as the sample. It indicates possible/probable blank contamination and warns the data user to take appropriate action.
- E - The concentration of the analyte exceeded the calibration range of the instrument.
- D - This flag indicates a system monitoring compound diluted out.

## INORGANIC METHOD QUALIFIERS

C - (Concentration) qualifiers are as follows:

- B - Entered if the reported value was obtained from a reading that was less than the Contract Required Detection Limit (CRDL) but greater than or equal to the Instrument Detection Limit (IDL).
- U - Entered when the analyte was analyzed for, but not detected.

Q - Qualifier specific entries and their meanings are as follows:

- E - Reported value is estimated because of the presence of interferences.

M - (Method) qualifiers are as follows:

- A - Flame AA
- AS - Semi-automated Spectrophotometric
- AV - Automated Cold Vapor AA
- C - Manual Spectrophotometric
- F - Furnace AA
- P - ICP
- T - Titrimetric

## OTHER QUALIFIERS

- ND - Not Detected
- NA - Not Applicable
- NR - Not Required
- \* - Outside Expected Range (NYCDEP Table I/II or Surrogate Limits)
- x - Outside Expected Range

## OTHER

- All soil and sediment samples are reported on a dry weight basis.





03-03173

P1918

Rec'd Date: 04/30/03 07:30

# CHAIN OF CUSTODY DOCUMENT

P 01918



Project Name: Photocircuits Project Manager: Andy Barber  
 Project Address: 31 Sen Cliff Ave, Glen Cove, NY  
 Client Photocircuits JIN: 643.001  Rush by 1 1

Sampler (Signature): DWJ/BDD (Print): Derek Sorden Bryce Dirgen

ID	Date	Time	Type	Matrix	Sample Location	Total #		418.1 - TRPH	PH/Flash/React	RCRA Metals	PCB/Pesticides	625/827/81N	624/8260/8021	MTBE	BTX/BTEX	601/602	83608	TOC	Nitrates	Sulfate	Sulfide
						Cont.	Cont.														
1	4/24/03	18:35	L		MW-8		6	X	X	X	X	X	X	X	X	X	X	X	X	X	X
2	4/24/03	18:45			MW-12		6	X	X	X	X	X	X	X	X	X	X	X	X	X	X
3	4/24/03	8:50			MW-13		6	X	X	X	X	X	X	X	X	X	X	X	X	X	X
4	4/24/03	17:50			MW-14		6	X	X	X	X	X	X	X	X	X	X	X	X	X	X
5	4/24/03	18:00			SMP-1		6	X	X	X	X	X	X	X	X	X	X	X	X	X	X
6	4/24/03	18:05			DMP-1		6	X	X	X	X	X	X	X	X	X	X	X	X	X	X
7	4/24/03	18:10			SMP-3		6	X	X	X	X	X	X	X	X	X	X	X	X	X	X
8	4/24/03	18:15			DMP-3		6	X	X	X	X	X	X	X	X	X	X	X	X	X	X
9	4/24/03	18:20			SMP-4		6	X	X	X	X	X	X	X	X	X	X	X	X	X	X
10	4/24/03	18:25			DMP-4		6	X	X	X	X	X	X	X	X	X	X	X	X	X	X
11	4/24/03	18:30			MW-15		2	X													
12	4/24/03	14:00			MW-25		2	X													
13	4/24/03	12:00			MW-35		2	X													
14	4/24/03	15:10			MW-45		2	X													
15																					

Received by (Signature): Thomas Magliarelli  
 Received for Lab by (Signature): Thomas Magliarelli  
 Number & Type of Containers: 5  
 Temp: 5  
 Comments & Special Instructions: 5



# Environmental Testing Laboratories, Inc.

208 Route 109, Farmingdale NY 11735

Phone - 631-249-1456 Fax - 631-249-8344

06/02/2003

**Custody Document: P1916**

Received: 05/22/2003 15:09

Sampled by: David Hanny

**Client: Photocircuits Corporation**

31 Sea Cliff Avenue  
Glen Cove,  
NY 11542

**Project: Photocircuits Corp.**

31 Sea Cliff Avenue  
Glen Cove,  
NY 11542

**Manager: Andy Barber**

Respectfully submitted,

  
Quality Assurance Officer

INITIALS
DATE #
COPY TO
Barton & Loggins - C

JUN 02 2003

ROUTE TO

NYS Lab ID # 10969  
NJ Cert. # 73812  
CT Cert. # PH0645  
MA Cert. # NY061  
PA Cert. # 68-535  
NH Cert. # 252592-BA  
RI Cert. # 161

The information contained in this report is confidential and intended only for the use of the client listed above. This report shall not be reproduced, except in full, without the written consent of Environmental Testing Laboratories, Inc.



# Environmental Testing Laboratories, Inc.

208 Route 109, Farmingdale NY 11735  
Phone - 631-249-1456 Fax - 631-249-8344

06/02/2003

## Volatiles - EPA 8260B in AIR

### Sample: P1916-6

Client Sample ID: 45 A Site Influent

Matrix: Air

Remarks: See Case Narrative

Analyzed Date: 05/29/2003

Type: Grab

Collected: 05/21/2003 11:50

Volume: 5.2 L

## Analytical Results

Cas No	Analyte	File ID	MDL	Concentration	Units	Q
75-71-8	Dichlorodifluoromethane	C 982 -685	0.018	0.018	mg/M3	U
74-87-3	Chloromethane	C 982 -685	0.012	0.012	mg/M3	U
75-01-4	Vinyl Chloride	C 982 -685	0.012	0.012	mg/M3	U
74-83-9	Bromomethane	C 982 -685	0.018	0.018	mg/M3	U
75-00-3	Chloroethane	C 982 -685	0.020	0.020	mg/M3	U
75-69-4	Trichlorofluoromethane	C 982 -685	0.0055	0.0055	mg/M3	U
75-35-4	1,1-Dichloroethene	C 982 -685	0.0081	0.0081	mg/M3	U
75-09-2	Methylene Chloride	C 982 -685	0.040	0.040	mg/M3	U
156-60-5	t-1,2-Dichloroethene	C 982 -685	0.012	0.012	mg/M3	U
75-34-3	1,1-Dichloroethane	C 982 -685	0.012	0.012	mg/M3	U
590-20-7	2,2-Dichloropropane	C 982 -685	0.0086	0.0086	mg/M3	U
156-59-2	c-1,2-Dichloroethene	C 982 -685	0.012	0.012	mg/M3	U
67-66-3	Chloroform	C 982 -685	0.0075	0.0075	mg/M3	U
74-97-5	Bromochloromethane	C 982 -685	0.016	0.016	mg/M3	U
71-55-6	1,1,1-Trichloroethane	C 982 -685	0.0089	<b>0.048</b>	mg/M3	
563-58-6	1,1-Dichloropropene	C 982 -685	0.032	0.032	mg/M3	U
56-23-5	Carbon Tetrachloride	C 982 -685	0.0086	0.0086	mg/M3	U
107-06-2	1,2 Dichloroethane	C 982 -685	0.014	0.014	mg/M3	U
71-43-2	Benzene	C 982 -685	0.0063	0.0063	mg/M3	U
79-01-6	Trichloroethene	C 982 -685	0.0098	<b>0.14</b>	mg/M3	
78-87-5	1,2-Dichloropropane	C 982 -685	0.0078	0.0078	mg/M3	U
75-27-4	Bromodichloromethane	C 982 -685	0.0046	0.0046	mg/M3	U
74-95-3	Dibromomethane	C 982 -685	0.0066	0.0066	mg/M3	U
10061-01-5	c-1,3-Dichloropropene	C 982 -685	0.023	0.023	mg/M3	U
108-88-3	Toluene	C 982 -685	0.0060	0.0060	mg/M3	U
10061-02-6	t-1,3-Dichloropropene	C 982 -685	0.023	0.023	mg/M3	U
79-00-5	1,1,2-Trichloroethane	C 982 -685	0.0049	0.0049	mg/M3	U
142-28-9	1,3-Dichloropropane	C 982 -685	0.0089	0.0089	mg/M3	U
127-18-4	Tetrachloroethene	C 983 -710	0.049	<b>10.8</b>	mg/M3	
124-48-1	Dibromochloromethane	C 982 -685	0.0052	0.0052	mg/M3	U
106-93-4	1,2-Dibromoethane	C 982 -685	0.0049	0.0049	mg/M3	U
108-90-7	Chlorobenzene	C 982 -685	0.0046	0.0046	mg/M3	U
630-20-6	1,1,1,2-Tetrachloroethane	C 982 -685	0.0055	0.0055	mg/M3	U



# Environmental Testing Laboratories, Inc.

208 Route 109, Farmingdale NY 11735

Phone - 631-249-1456 Fax - 631-249-8344

06/02/2003

## Volatiles - EPA 8260B in AIR

### Sample: P1916-6

Client Sample ID: 45 A Site Influent

Matrix: Air

Remarks: See Case Narrative

Analyzed Date: 05/29/2003

Type: Grab

Collected: 05/21/2003 11:50

Volume: 5.2 L

## Analytical Results

Cas No	Analyte	File ID	MDL	Concentration	Units	Q
100-41-4	Ethylbenzene	C 982 -685	0.0049	0.0049	mg/M3	U
108-38-3	m,p-xylene	C 982 -685	0.0075	0.0075	mg/M3	U
95-47-6	o-xylene	C 982 -685	0.0060	0.0060	mg/M3	U
100-42-5	Styrene	C 982 -685	0.0035	0.0035	mg/M3	U
98-82-8	Isopropylbenzene	C 982 -685	0.0029	0.0029	mg/M3	U
75-25-2	Bromoform	C 982 -685	0.0063	0.0063	mg/M3	U
79-34-5	1,1,2,2-Tetrachloroethane	C 982 -685	0.0092	0.0092	mg/M3	U
96-18-4	1,2,3-Trichloropropane	C 982 -685	0.021	0.021	mg/M3	U
103-65-1	n-Propylbenzene	C 982 -685	0.0063	0.0063	mg/M3	U
108-86-1	Bromobenzene	C 982 -685	0.0086	0.0086	mg/M3	U
108-67-8	1,3,5-Trimethylbenzene	C 982 -685	0.0049	0.0049	mg/M3	U
95-49-8	2-Chlorotoluene	C 982 -685	0.0058	0.0058	mg/M3	U
106-43-4	4-Chlorotoluene	C 982 -685	0.0092	0.0092	mg/M3	U
99-87-6	4-Isopropyltoluene	C 982 -685	0.0043	0.0043	mg/M3	U
95-63-6	1,2,4-trimethylbenzene	C 982 -685	0.0046	0.0046	mg/M3	U
135-98-8	sec-Butylbenzene	C 982 -685	0.0058	0.0058	mg/M3	U
98-06-6	tert-Butylbenzene	C 982 -685	0.0043	0.0043	mg/M3	U
541-73-1	1,3 Dichlorobenzene	C 982 -685	0.0055	0.0055	mg/M3	U
106-46-7	1,4-Dichlorobenzene	C 982 -685	0.0069	0.0069	mg/M3	U
104-51-8	n-Butylbenzene	C 982 -685	0.0063	0.0063	mg/M3	U
95-50-1	1,2-Dichlorobenzene	C 982 -685	0.0032	0.0032	mg/M3	U
96-12-8	1,2-Dibromo-3-chloropropane	C 982 -685	0.0069	0.0069	mg/M3	U
120-82-1	1,2,4-Trichlorobenzene	C 982 -685	0.0069	0.0069	mg/M3	U
87-68-3	Hexachlorobutadiene	C 982 -685	0.0035	0.0035	mg/M3	U
91-20-3	Naphthalene	C 982 -685	0.0060	0.0060	mg/M3	U
87-61-6	1,2,3-Trichlorobenzene	C 982 -685	0.024	0.024	mg/M3	U
1634-04-4	MTBE	C 982 -685	0.018	0.018	mg/M3	U



# Environmental Testing Laboratories, Inc.

208 Route 109, Farmingdale NY 11735  
Phone - 631-249-1456 Fax - 631-249-8344

06/02/2003

## Volatiles - EPA 8260B in AIR

### Sample: P1916-6

Client Sample ID: 45 A Site Influent

Matrix: Air

Remarks: See Case Narrative

Analyzed Date: 05/29/2003

Type: Grab

Collected: 05/21/2003 11:50

Volume: 5.2 L

### Surrogate Results

Cas No	Analyte	File ID	% Recovery	QC Limits	Q
460-00-4	4-BROMOFLUOROBENZENE	C982-685	98.7 %	( 77 - 128)	
4774-33-8	DIBROMOFLUOROMETHANE	C982-685	95.6 %	( 69 - 157)	
2037-26-5	TOLUENE-D8	C982-685	99.8 %	( 70 - 124)	
460-00-4	4-BROMOFLUOROBENZENE	C983-710	102.0 %	( 77 - 128)	
4774-33-8	DIBROMOFLUOROMETHANE	C983-710	102.0 %	( 69 - 157)	
2037-26-5	TOLUENE-D8	C983-710	101.0 %	( 70 - 124)	



# Environmental Testing Laboratories, Inc.

208 Route 109, Farmingdale NY 11735  
Phone - 631-249-1456 Fax - 631-249-8344

06/02/2003

## Volatile Compounds - EPA 8260B

### Sample: P1916-1

Client Sample ID: RW-1

Collected: 05/21/2003 10:45

Matrix: Liquid

Type: Grab

Remarks: See Case Narrative

Analyzed Date: 05/23/2003

### Analytical Results

Cas No	Analyte	File ID	MDL	Concentration	Units	Q
75-71-8	Dichlorodifluoromethane	C 978 -605	0.85	0.85	ppb	U
75-45-6	Chlorodifluoromethane	C 978 -605	0.75	0.75	ppb	U
74-87-3	Chloromethane	C 978 -605	0.70	0.70	ppb	U
75-01-4	Vinyl Chloride	C 978 -605	0.55	390	ppb	
74-83-9	Bromomethane	C 978 -605	0.75	0.75	ppb	U
75-00-3	Chloroethane	C 978 -605	1.40	1.40	ppb	U
75-69-4	Trichlorofluoromethane	C 978 -605	0.65	0.65	ppb	U
76-13-1	1,1,2-Trichlorotrifluoroethane	C 978 -605	0.95	0.95	ppb	U
75-35-4	1,1-Dichloroethene	C 978 -605	0.80	29.1	ppb	
67-64-1	Acetone	C 978 -605	7.90	7.90	ppb	U
75-15-0	Carbon disulfide	C 978 -605	0.65	0.65	ppb	U
75-09-2	Methylene Chloride	C 978 -605	0.80	9.66	ppb	
156-60-5	trans-1,2-Dichloroethene	C 978 -605	0.75	49.4	ppb	
1634-04-4	Methyl t-butyl ether	C 978 -605	0.37	0.37	ppb	U
75-34-3	1,1-Dichloroethane	C 978 -605	0.47	104	ppb	
590-20-7	2,2-Dichloropropane	C 978 -605	1.65	1.65	ppb	U
156-59-2	cis-1,2-Dichloroethene	A 973 -462	8.00	3130	ppb	
78-93-3	2-Butanone	C 978 -605	2.30	2.30	ppb	U
74-97-5	Bromochloromethane	C 978 -605	0.70	0.70	ppb	U
67-66-3	Chloroform	C 978 -605	0.36	0.36	ppb	U
71-55-6	1,1,1-Trichloroethane	C 978 -605	0.80	5.11	ppb	
56-23-5	Carbon Tetrachloride	C 978 -605	0.60	0.60	ppb	U
563-58-6	1,1-Dichloropropene	C 978 -605	0.80	0.80	ppb	U
71-43-2	Benzene	C 978 -605	0.55	5.91	ppb	
107-06-2	1,2-Dichloroethane	C 978 -605	0.60	0.60	ppb	U
79-01-6	Trichloroethene	A 973 -462	10.5	1470	ppb	
78-87-5	1,2-Dichloropropane	C 978 -605	0.55	0.55	ppb	U
74-95-3	Dibromomethane	C 978 -605	0.85	0.85	ppb	U
75-27-4	Bromodichloromethane	C 978 -605	0.55	0.55	ppb	U
110-75-8	2-Chloroethylvinylether	C 978 -605	0.95	0.95	ppb	U
10061-01-5	cis-1,3-Dichloropropene	C 978 -605	0.45	0.45	ppb	U
108-10-1	4-Methyl-2-pentanone	C 978 -605	4.05	4.05	ppb	U
108-88-3	Toluene	C 978 -605	0.46	5.22	ppb	



# Environmental Testing Laboratories, Inc.

208 Route 109, Farmingdale NY 11735  
Phone - 631-249-1456 Fax - 631-249-8344

06/02/2003

## Volatile Compounds - EPA 8260B

### Sample: P1916-1

Client Sample ID: RW-1

Collected: 05/21/2003 10:45

Matrix: Liquid

Type: Grab

Remarks: See Case Narrative

Analyzed Date: 05/23/2003

### Analytical Results

Cas No	Analyte	File ID	MDL	Concentration	Units	Q
10061-02-6	trans-1,3-Dichloropropene	C 978 -605	0.65	0.65	ppb	U
79-00-5	1,1,2-Trichloroethane	C 978 -605	0.70	0.70	ppb	U
127-18-4	Tetrachloroethene	C 978 -605	1.95	72.4	ppb	
142-28-9	1,3-Dichloropropane	C 978 -605	0.50	0.50	ppb	U
591-78-6	2-Hexanone	C 978 -605	5.05	5.05	ppb	U
124-48-1	Dibromochloromethane	C 978 -605	0.55	0.55	ppb	U
106-93-4	1,2-Dibromoethane	C 978 -605	0.55	0.55	ppb	U
108-90-7	Chlorobenzene	C 978 -605	0.65	0.65	ppb	U
630-20-6	1,1,1,2-Tetrachloroethane	C 978 -605	0.55	0.55	ppb	U
100-41-4	Ethylbenzene	C 978 -605	0.55	0.55	ppb	U
108-38-3	m,p-xylene	C 978 -605	1.65	1.65	ppb	U
95-47-6	o-xylene	C 978 -605	0.65	0.65	ppb	U
100-42-5	Styrene	C 978 -605	4.85	4.85	ppb	U
75-25-2	Bromoform	C 978 -605	0.70	0.70	ppb	U
98-82-8	Isopropylbenzene	C 978 -605	0.49	0.49	ppb	U
108-86-1	Bromobenzene	C 978 -605	0.36	0.36	ppb	U
79-34-5	1,1,1,2-Tetrachloroethane	C 978 -605	0.44	0.44	ppb	U
103-65-1	n-Propylbenzene	C 978 -605	0.60	143	ppb	
96-18-4	1,2,3-Trichloropropane	C 978 -605	1.40	1.40	ppb	U
622-96-8	p-Ethyltoluene	C 978 -605	0.60	0.60	ppb	U
108-67-8	1,3,5-Trimethylbenzene	C 978 -605	0.47	0.47	ppb	U
95-49-8	2-Chlorotoluene	C 978 -605	0.75	182	ppb	
106-43-4	4-Chlorotoluene	C 978 -605	0.70	0.70	ppb	U
98-06-6	tert-Butylbenzene	C 978 -605	0.75	0.75	ppb	U
95-63-6	1,2,4-Trimethylbenzene	C 978 -605	0.55	0.55	ppb	U
135-98-8	sec-Butylbenzene	C 978 -605	0.55	0.55	ppb	U
99-87-6	p-Isopropyltoluene	C 978 -605	0.60	0.60	ppb	U
541-73-1	1,3-Dichlorobenzene	C 978 -605	0.41	0.41	ppb	U
106-46-7	1,4-Dichlorobenzene	C 978 -605	0.34	0.34	ppb	U
95-50-1	1,2-Dichlorobenzene	C 978 -605	0.55	0.55	ppb	U
105-05-5	p-Diethylbenzene	C 978 -605	0.55	0.55	ppb	U
104-51-8	n-Butylbenzene	C 978 -605	0.44	0.44	ppb	U
95-93-2	1,2,4,5-Tetramethylbenzene	C 978 -605	0.60	0.60	ppb	U





# Environmental Testing Laboratories, Inc.

208 Route 109, Farmingdale NY 11735

Phone - 631-249-1456 Fax - 631-249-8344

06/02/2003

## Volatile Compounds - EPA 8260B

### Sample: P1916-1

Client Sample ID: RW-1

Collected: 05/21/2003 10:45

Matrix: Liquid

Type: Grab

Remarks: See Case Narrative

Analyzed Date: 05/23/2003

### Analytical Results

Cas No	Analyte	File ID	MDL	Concentration	Units	Q
96-12-8	1,2-Dibromo-3-chloropropane	C 978 -605	0.75	0.75	ppb	U
120-82-1	1,2,4-Trichlorobenzene	C 978 -605	0.65	0.65	ppb	U
87-68-3	Hexachlorobutadiene	C 978 -605	1.85	1.85	ppb	U
91-20-3	Naphthalene	C 978 -605	2.30	2.30	ppb	U
87-61-6	1,2,3-Trichlorobenzene	C 978 -605	0.60	0.60	ppb	U

### Surrogate Results

Cas No	Analyte	File ID	% Recovery	QC Limits	Q
460-00-4	4-BROMOFLUOROBENZENE	A973-462	98.2 %	( 89 - 110)	
4774-33-8	DIBROMOFLUOROMETHANE	A973-462	99.1 %	( 72 - 121)	
2037-26-5	TOLUENE-D8	A973-462	99.7 %	( 89 - 111)	
460-00-4	4-BROMOFLUOROBENZENE	C978-605	98.4 %	( 89 - 110)	
4774-33-8	DIBROMOFLUOROMETHANE	C978-605	92.5 %	( 72 - 121)	
2037-26-5	TOLUENE-D8	C978-605	101.0 %	( 89 - 111)	



# Environmental Testing Laboratories, Inc.

208 Route 109, Farmingdale NY 11735  
Phone - 631-249-1456 Fax - 631-249-8344

06/02/2003

## Volatile Compounds - EPA 8260B

### Sample: P1916-2

Client Sample ID: RW-2

Collected: 05/21/2003 10:50

Matrix: Liquid

Type: Grab

Remarks: See Case Narrative

Analyzed Date: 05/23/2003

### Analytical Results

Cas No	Analyte	File ID	MDL	Concentration	Units	Q
75-71-8	Dichlorodifluoromethane	C 978 -606	0.17	0.17	ppb	U
75-45-6	Chlorodifluoromethane	C 978 -606	0.15	4.00	ppb	
74-87-3	Chloromethane	C 978 -606	0.14	0.14	ppb	U
75-01-4	Vinyl Chloride	C 978 -606	0.11	113	ppb	
74-83-9	Bromomethane	C 978 -606	0.15	0.15	ppb	U
75-00-3	Chloroethane	C 978 -606	0.28	1.26	ppb	
75-69-4	Trichlorofluoromethane	C 978 -606	0.13	0.13	ppb	U
76-13-1	1,1,2-Trichlorotrifluoroethane	C 978 -606	0.19	0.19	ppb	U
75-35-4	1,1-Dichloroethene	C 978 -606	0.16	8.93	ppb	
67-64-1	Acetone	C 978 -606	1.58	1.58	ppb	U
75-15-0	Carbon disulfide	C 978 -606	0.13	0.13	ppb	U
75-09-2	Methylene Chloride	C 978 -606	0.16	0.16	ppb	U
156-60-5	trans-1,2-Dichloroethene	C 978 -606	0.15	5.22	ppb	
1634-04-4	Methyl t-butyl ether	C 978 -606	0.074	0.074	ppb	U
75-34-3	1,1-Dichloroethane	C 978 -606	0.095	94.7	ppb	
590-20-7	2,2-Dichloropropane	C 978 -606	0.33	0.33	ppb	U
156-59-2	cis-1,2-Dichloroethene	A 973 -463	8.00	547	ppb	
78-93-3	2-Butanone	C 978 -606	0.46	0.46	ppb	U
74-97-5	Bromochloromethane	C 978 -606	0.14	0.14	ppb	U
67-66-3	Chloroform	C 978 -606	0.072	0.072	ppb	U
71-55-6	1,1,1-Trichloroethane	C 978 -606	0.16	0.16	ppb	U
56-23-5	Carbon Tetrachloride	C 978 -606	0.12	0.12	ppb	U
563-58-6	1,1-Dichloropropene	C 978 -606	0.16	0.16	ppb	U
71-43-2	Benzene	C 978 -606	0.11	1.96	ppb	
107-06-2	1,2-Dichloroethane	C 978 -606	0.12	1.01	ppb	
79-01-6	Trichloroethene	A 973 -463	10.5	211	ppb	
78-87-5	1,2-Dichloropropane	C 978 -606	0.11	0.11	ppb	U
74-95-3	Dibromomethane	C 978 -606	0.17	0.17	ppb	U
75-27-4	Bromodichloromethane	C 978 -606	0.11	0.11	ppb	U
110-75-8	2-Chloroethylvinylether	C 978 -606	0.19	0.19	ppb	U
10061-01-5	cis-1,3-Dichloropropene	C 978 -606	0.090	0.090	ppb	U
108-10-1	4-Methyl-2-pentanone	C 978 -606	0.81	0.81	ppb	U
108-88-3	Toluene	C 978 -606	0.092	4.42	ppb	



# Environmental Testing Laboratories, Inc.

208 Route 109, Farmingdale NY 11735  
Phone - 631-249-1456 Fax - 631-249-8344

06/02/2003

## Volatile Compounds - EPA 8260B

### Sample: P1916-2

Client Sample ID: RW-2

Collected: 05/21/2003 10:50

Matrix: Liquid

Type: Grab

Remarks: See Case Narrative

Analyzed Date: 05/23/2003

### Analytical Results

Cas No	Analyte	File ID	MDL	Concentration	Units	Q
10061-02-6	trans-1,3-Dichloropropene	C 978 -606	0.13	0.13	ppb	U
79-00-5	1,1,2-Trichloroethane	C 978 -606	0.14	0.14	ppb	U
127-18-4	Tetrachloroethene	C 978 -606	0.39	44.5	ppb	
142-28-9	1,3-Dichloropropane	C 978 -606	0.099	0.099	ppb	U
591-78-6	2-Hexanone	C 978 -606	1.01	1.01	ppb	U
124-48-1	Dibromochloromethane	C 978 -606	0.11	0.11	ppb	U
106-93-4	1,2-Dibromoethane	C 978 -606	0.11	0.11	ppb	U
108-90-7	Chlorobenzene	C 978 -606	0.13	0.13	ppb	U
630-20-6	1,1,1,2-Tetrachloroethane	C 978 -606	0.11	0.11	ppb	U
100-41-4	Ethylbenzene	C 978 -606	0.11	0.11	ppb	U
108-38-3	m,p-xylene	C 978 -606	0.33	1.01	ppb	
95-47-6	o-xylene	C 978 -606	0.13	1.55	ppb	
100-42-5	Styrene	C 978 -606	0.97	0.97	ppb	U
75-25-2	Bromoform	C 978 -606	0.14	0.14	ppb	U
98-82-8	Isopropylbenzene	C 978 -606	0.097	0.097	ppb	U
108-86-1	Bromobenzene	C 978 -606	0.072	0.072	ppb	U
79-34-5	1,1,2,2-Tetrachloroethane	C 978 -606	0.088	0.088	ppb	U
103-65-1	n-Propylbenzene	C 978 -606	0.12	0.12	ppb	U
96-18-4	1,2,3-Trichloropropane	C 978 -606	0.28	0.28	ppb	U
622-96-8	p-Ethyltoluene	C 978 -606	0.12	0.12	ppb	U
108-67-8	1,3,5-Trimethylbenzene	C 978 -606	0.095	0.095	ppb	U
95-49-8	2-Chlorotoluene	A 973 -463	7.50	638	ppb	
106-43-4	4-Chlorotoluene	C 978 -606	0.14	51.1	ppb	
98-06-6	tert-Butylbenzene	C 978 -606	0.15	0.15	ppb	U
95-63-6	1,2,4-Trimethylbenzene	C 978 -606	0.11	0.11	ppb	U
135-98-8	sec-Butylbenzene	C 978 -606	0.11	0.11	ppb	U
99-87-6	p-Isopropyltoluene	C 978 -606	0.12	0.12	ppb	U
541-73-1	1,3-Dichlorobenzene	C 978 -606	0.083	0.083	ppb	U
106-46-7	1,4-Dichlorobenzene	C 978 -606	0.068	0.068	ppb	U
95-50-1	1,2-Dichlorobenzene	C 978 -606	0.11	0.11	ppb	U
105-05-5	p-Diethylbenzene	C 978 -606	0.11	0.11	ppb	U
104-51-8	n-Butylbenzene	C 978 -606	0.088	0.088	ppb	U
95-93-2	1,2,4,5-Tetramethylbenzene	C 978 -606	0.12	0.12	ppb	U



# Environmental Testing Laboratories, Inc.

208 Route 109, Farmingdale NY 11735  
Phone - 631-249-1456 Fax - 631-249-8344

06/02/2003

## Volatile Compounds - EPA 8260B

### Sample: P1916-2

Client Sample ID: RW-2

Collected: 05/21/2003 10:50

Matrix: Liquid

Type: Grab

Remarks: See Case Narrative

Analyzed Date: 05/23/2003

### Analytical Results

Cas No	Analyte	File ID	MDL	Concentration	Units	Q
96-12-8	1,2-Dibromo-3-chloropropane	C 978 -606	0.15	0.15	ppb	U
120-82-1	1,2,4-Trichlorobenzene	C 978 -606	0.13	0.13	ppb	U
87-68-3	Hexachlorobutadiene	C 978 -606	0.37	0.37	ppb	U
91-20-3	Naphthalene	C 978 -606	0.46	0.46	ppb	U
87-61-6	1,2,3-Trichlorobenzene	C 978 -606	0.12	0.12	ppb	U

### Surrogate Results

Cas No	Analyte	File ID	% Recovery	QC Limits	Q
460-00-4	4-BROMOFLUOROBENZENE	A973-463	97.4 %	( 89 - 110)	
4774-33-8	DIBROMOFLUOROMETHANE	A973-463	99.6 %	( 72 - 121)	
2037-26-5	TOLUENE-D8	A973-463	101.0 %	( 89 - 111)	
460-00-4	4-BROMOFLUOROBENZENE	C978-606	97.2 %	( 89 - 110)	
4774-33-8	DIBROMOFLUOROMETHANE	C978-606	92.6 %	( 72 - 121)	
2037-26-5	TOLUENE-D8	C978-606	101.0 %	( 89 - 111)	



# Environmental Testing Laboratories, Inc.

208 Route 109, Farmingdale NY 11735  
Phone - 631-249-1456 Fax - 631-249-8344

06/02/2003

## Volatile Compounds - EPA 8260B

### Sample: P1916-3

Client Sample ID: RW-3

Collected: 05/21/2003 10:55

Matrix: Liquid

Type: Grab

Remarks: See Case Narrative

Analyzed Date: 05/29/2003

### Analytical Results

Cas No	Analyte	File ID	MDL	Concentration	Units	Q
75-71-8	Dichlorodifluoromethane	A 973 -464	0.29	0.29	ppb	U
75-45-6	Chlorodifluoromethane	A 973 -464	0.31	0.31	ppb	U
74-87-3	Chloromethane	A 973 -464	0.31	0.31	ppb	U
75-01-4	Vinyl Chloride	A 973 -464	0.28	1.37	ppb	
74-83-9	Bromomethane	A 973 -464	0.45	0.45	ppb	U
75-00-3	Chloroethane	A 973 -464	0.44	0.44	ppb	U
75-69-4	Trichlorofluoromethane	A 973 -464	0.48	0.48	ppb	U
76-13-1	1,1,2-Trichlorotrifluoroethane	A 973 -464	0.28	0.28	ppb	U
75-35-4	1,1-Dichloroethene	A 973 -464	0.23	3.01	ppb	
67-64-1	Acetone	A 973 -464	1.41	1.41	ppb	U
75-15-0	Carbon disulfide	A 973 -464	0.26	2.67	ppb	
75-09-2	Methylene Chloride	A 973 -464	0.15	0.15	ppb	U
156-60-5	trans-1,2-Dichloroethene	A 973 -464	0.22	0.22	ppb	U
1634-04-4	Methyl t-butyl ether	A 973 -464	0.053	0.053	ppb	U
75-34-3	1,1-Dichloroethane	A 973 -464	0.22	5.56	ppb	
590-20-7	2,2-Dichloropropane	A 973 -464	0.37	0.37	ppb	U
156-59-2	cis-1,2-Dichloroethene	A 973 -464	0.16	23.3	ppb	
78-93-3	2-Butanone	A 973 -464	1.64	1.64	ppb	U
74-97-5	Bromochloromethane	A 973 -464	0.066	0.066	ppb	U
67-66-3	Chloroform	A 973 -464	0.19	0.19	ppb	U
71-55-6	1,1,1-Trichloroethane	A 973 -464	0.22	0.22	ppb	U
56-23-5	Carbon Tetrachloride	A 973 -464	0.32	0.32	ppb	U
563-58-6	1,1-Dichloropropene	A 973 -464	0.40	0.40	ppb	U
71-43-2	Benzene	A 973 -464	0.21	0.21	ppb	U
107-06-2	1,2-Dichloroethane	A 973 -464	0.17	0.17	ppb	U
79-01-6	Trichloroethene	A 973 -464	0.21	11.8	ppb	
78-87-5	1,2-Dichloropropane	A 973 -464	0.15	0.15	ppb	U
74-95-3	Dibromomethane	A 973 -464	0.072	0.072	ppb	U
75-27-4	Bromodichloromethane	A 973 -464	0.084	0.084	ppb	U
110-75-8	2-Chloroethylvinylether	A 973 -464	0.83	0.83	ppb	U
10061-01-5	cis-1,3-Dichloropropene	A 973 -464	0.062	0.062	ppb	U
108-10-1	4-Methyl-2-pentanone	A 973 -464	1.44	1.44	ppb	U
108-88-3	Toluene	A 973 -464	0.20	0.20	ppb	U



# Environmental Testing Laboratories, Inc.

208 Route 109, Farmingdale NY 11735  
Phone - 631-249-1456 Fax - 631-249-8344

06/02/2003

## Volatile Compounds - EPA 8260B

### Sample: P1916-3

Client Sample ID: RW-3

Collected: 05/21/2003 10:55

Matrix: Liquid

Type: Grab

Remarks: See Case Narrative

Analyzed Date: 05/29/2003

### Analytical Results

Cas No	Analyte	File ID	MDL	Concentration	Units	Q
10061-02-6	trans-1,3-Dichloropropene	A 973 -464	0.12	0.12	ppb	U
79-00-5	1,1,2-Trichloroethane	A 973 -464	0.15	0.15	ppb	U
127-18-4	Tetrachloroethene	A 973 -464	0.38	<b>3.85</b>	ppb	
142-28-9	1,3-Dichloropropane	A 973 -464	0.040	0.040	ppb	U
591-78-6	2-Hexanone	A 973 -464	1.44	1.44	ppb	U
124-48-1	Dibromochloromethane	A 973 -464	0.044	0.044	ppb	U
106-93-4	1,2-Dibromoethane	A 973 -464	0.097	0.097	ppb	U
108-90-7	Chlorobenzene	A 973 -464	0.15	0.15	ppb	U
630-20-6	1,1,1,2-Tetrachloroethane	A 973 -464	0.061	0.061	ppb	U
100-41-4	Ethylbenzene	A 973 -464	0.12	0.12	ppb	U
108-38-3	m,p-xylene	A 973 -464	0.24	0.24	ppb	U
95-47-6	o-xylene	A 973 -464	0.12	0.12	ppb	U
100-42-5	Styrene	A 973 -464	0.080	0.080	ppb	U
75-25-2	Bromoform	A 973 -464	0.073	0.073	ppb	U
98-82-8	Isopropylbenzene	A 973 -464	0.14	0.14	ppb	U
108-86-1	Bromobenzene	A 973 -464	0.11	0.11	ppb	U
79-34-5	1,1,1,2-Tetrachloroethane	A 973 -464	0.094	0.094	ppb	U
103-65-1	n-Propylbenzene	A 973 -464	0.16	0.16	ppb	U
96-18-4	1,2,3-Trichloropropane	A 973 -464	0.047	0.047	ppb	U
622-96-8	p-Ethyltoluene	A 973 -464	0.15	0.15	ppb	U
108-67-8	1,3,5-Trimethylbenzene	A 973 -464	0.17	0.17	ppb	U
95-49-8	2-Chlorotoluene	A 973 -464	0.15	<b>5.08</b>	ppb	
106-43-4	4-Chlorotoluene	A 973 -464	0.072	0.072	ppb	U
98-06-6	tert-Butylbenzene	A 973 -464	0.12	0.12	ppb	U
95-63-6	1,2,4-Trimethylbenzene	A 973 -464	0.15	0.15	ppb	U
135-98-8	sec-Butylbenzene	A 973 -464	0.19	0.19	ppb	U
99-87-6	p-Isopropyltoluene	A 973 -464	0.16	0.16	ppb	U
541-73-1	1,3-Dichlorobenzene	A 973 -464	0.047	0.047	ppb	U
106-46-7	1,4-Dichlorobenzene	A 973 -464	0.17	0.17	ppb	U
95-50-1	1,2-Dichlorobenzene	A 973 -464	0.065	0.065	ppb	U
105-05-5	p-Diethylbenzene	A 973 -464	0.17	0.17	ppb	U
104-51-8	n-Butylbenzene	A 973 -464	0.26	0.26	ppb	U
95-93-2	1,2,4,5-Tetramethylbenzene	A 973 -464	0.23	0.23	ppb	U



# Environmental Testing Laboratories, Inc.

208 Route 109, Farmingdale NY 11735  
Phone - 631-249-1456 Fax - 631-249-8344

06/02/2003

## Volatile Compounds - EPA 8260B

**Sample: P1916-3**

Client Sample ID: RW-3

Collected: 05/21/2003 10:55

Matrix: Liquid

Type: Grab

Remarks: See Case Narrative

Analyzed Date: 05/29/2003

### Analytical Results

Cas No	Analyte	File ID	MDL	Concentration	Units	Q
96-12-8	1,2-Dibromo-3-chloropropane	A 973 -464	0.25	0.25	ppb	U
120-82-1	1,2,4-Trichlorobenzene	A 973 -464	0.14	0.14	ppb	U
87-68-3	Hexachlorobutadiene	A 973 -464	0.19	0.19	ppb	U
91-20-3	Naphthalene	A 973 -464	0.40	0.40	ppb	U
87-61-6	1,2,3-Trichlorobenzene	A 973 -464	0.15	0.15	ppb	U

### Surrogate Results

Cas No	Analyte	File ID	% Recovery	QC Limits	Q
460-00-4	4-BROMOFLUOROBENZENE	A973-464	98.2 %	( 89 - 110)	
4774-33-8	DIBROMOFLUOROMETHANE	A973-464	98.6 %	( 72 - 121)	
2037-26-5	TOLUENE-D8	A973-464	101.0 %	( 89 - 111)	



# Environmental Testing Laboratories, Inc.

208 Route 109, Farmingdale NY 11735  
Phone - 631-249-1456 Fax - 631-249-8344

06/02/2003

## Volatile Compounds - EPA 8260B

### Sample: P1916-4

Client Sample ID: RW-4

Collected: 05/21/2003 11:00

Matrix: Liquid

Type: Grab

Remarks: See Case Narrative

Analyzed Date: 05/28/2003

### Analytical Results

Cas No	Analyte	File ID	MDL	Concentration	Units	Q
75-71-8	Dichlorodifluoromethane	C 980 -643	1.70	1.70	ppb	U
75-45-6	Chlorodifluoromethane	C 980 -643	1.50	1.50	ppb	U
74-87-3	Chloromethane	C 980 -643	1.40	1.40	ppb	U
75-01-4	Vinyl Chloride	C 980 -643	1.10	1.10	ppb	U
74-83-9	Bromomethane	C 980 -643	1.50	1.50	ppb	U
75-00-3	Chloroethane	C 980 -643	2.80	2.80	ppb	U
75-69-4	Trichlorofluoromethane	C 980 -643	1.30	1.30	ppb	U
76-13-1	1,1,2-Trichlorotrifluoroethane	C 980 -643	1.90	1.90	ppb	U
75-35-4	1,1-Dichloroethene	C 980 -643	1.60	1.60	ppb	U
67-64-1	Acetone	C 980 -643	15.8	15.8	ppb	U
75-15-0	Carbon disulfide	C 980 -643	1.30	1.30	ppb	U
75-09-2	Methylene Chloride	C 980 -643	1.60	1.60	ppb	U
156-60-5	trans-1,2-Dichloroethene	C 980 -643	1.50	<b>9.94</b>	ppb	
1634-04-4	Methyl t-butyl ether	C 980 -643	0.74	0.74	ppb	U
75-34-3	1,1-Dichloroethane	C 980 -643	0.95	<b>41.0</b>	ppb	
590-20-7	2,2-Dichloropropane	C 980 -643	3.30	3.30	ppb	U
156-59-2	cis-1,2-Dichloroethene	C 980 -643	1.70	<b>404</b>	ppb	
78-93-3	2-Butanone	C 980 -643	4.60	4.60	ppb	U
74-97-5	Bromochloromethane	C 980 -643	1.40	1.40	ppb	U
67-66-3	Chloroform	C 980 -643	0.72	0.72	ppb	U
71-55-6	1,1,1-Trichloroethane	C 980 -643	1.60	1.60	ppb	U
56-23-5	Carbon Tetrachloride	C 980 -643	1.20	1.20	ppb	U
563-58-6	1,1-Dichloropropene	C 980 -643	1.60	1.60	ppb	U
71-43-2	Benzene	C 980 -643	1.10	1.10	ppb	U
107-06-2	1,2-Dichloroethane	C 980 -643	1.20	1.20	ppb	U
79-01-6	Trichloroethene	C 980 -643	1.60	<b>182</b>	ppb	
78-87-5	1,2-Dichloropropane	C 980 -643	1.10	1.10	ppb	U
74-95-3	Dibromomethane	C 980 -643	1.70	1.70	ppb	U
75-27-4	Bromodichloromethane	C 980 -643	1.10	1.10	ppb	U
110-75-8	2-Chloroethylvinylether	C 980 -643	1.90	1.90	ppb	U
10061-01-5	cis-1,3-Dichloropropene	C 980 -643	0.90	0.90	ppb	U
108-10-1	4-Methyl-2-pentanone	C 980 -643	8.10	8.10	ppb	U
108-88-3	Toluene	C 980 -643	0.92	0.92	ppb	U





# Environmental Testing Laboratories, Inc.

208 Route 109, Farmingdale NY 11735  
Phone - 631-249-1456 Fax - 631-249-8344

06/02/2003

## Volatile Compounds - EPA 8260B

### Sample: P1916-4

Client Sample ID: RW-4

Collected: 05/21/2003 11:00

Matrix: Liquid

Type: Grab

Remarks: See Case Narrative

Analyzed Date: 05/28/2003

## Analytical Results

Cas No	Analyte	File ID	MDL	Concentration	Units	Q
10061-02-6	trans-1,3-Dichloropropene	C 980 -643	1.30	1.30	ppb	U
79-00-5	1,1,2-Trichloroethane	C 980 -643	1.40	1.40	ppb	U
127-18-4	Tetrachloroethene	C 980 -643	3.90	20.9	ppb	
142-28-9	1,3-Dichloropropane	C 980 -643	0.99	0.99	ppb	U
591-78-6	2-Hexanone	C 980 -643	10.1	10.1	ppb	U
124-48-1	Dibromochloromethane	C 980 -643	1.10	1.10	ppb	U
106-93-4	1,2-Dibromoethane	C 980 -643	1.10	1.10	ppb	U
108-90-7	Chlorobenzene	C 980 -643	1.30	1.30	ppb	U
630-20-6	1,1,1,2-Tetrachloroethane	C 980 -643	1.10	1.10	ppb	U
100-41-4	Ethylbenzene	C 980 -643	1.10	1.10	ppb	U
108-38-3	m,p-xylene	C 980 -643	3.30	3.30	ppb	U
95-47-6	o-xylene	C 980 -643	1.30	1.30	ppb	U
100-42-5	Styrene	C 980 -643	9.70	9.70	ppb	U
75-25-2	Bromoform	C 980 -643	1.40	1.40	ppb	U
98-82-8	Isopropylbenzene	C 980 -643	0.97	0.97	ppb	U
108-86-1	Bromobenzene	C 980 -643	0.72	0.72	ppb	U
79-34-5	1,1,2,2-Tetrachloroethane	C 980 -643	0.88	0.88	ppb	U
103-65-1	n-Propylbenzene	C 980 -643	1.20	1.20	ppb	U
96-18-4	1,2,3-Trichloropropane	C 980 -643	2.80	2.80	ppb	U
622-96-8	p-Ethyltoluene	C 980 -643	1.20	1.20	ppb	U
108-67-8	1,3,5-Trimethylbenzene	C 980 -643	0.95	0.95	ppb	U
95-49-8	2-Chlorotoluene	C 980 -643	1.50	11.6	ppb	
106-43-4	4-Chlorotoluene	C 980 -643	1.40	1.40	ppb	U
98-06-6	tert-Butylbenzene	C 980 -643	1.50	1.50	ppb	U
95-63-6	1,2,4-Trimethylbenzene	C 980 -643	1.10	1.10	ppb	U
135-98-8	sec-Butylbenzene	C 980 -643	1.10	1.10	ppb	U
99-87-6	p-Isopropyltoluene	C 980 -643	1.20	1.20	ppb	U
541-73-1	1,3-Dichlorobenzene	C 980 -643	0.83	0.83	ppb	U
106-46-7	1,4-Dichlorobenzene	C 980 -643	0.68	0.68	ppb	U
95-50-1	1,2-Dichlorobenzene	C 980 -643	1.10	1.10	ppb	U
105-05-5	p-Diethylbenzene	C 980 -643	1.10	1.10	ppb	U
104-51-8	n-Butylbenzene	C 980 -643	0.88	0.88	ppb	U
95-93-2	1,2,4,5-Tetramethylbenzene	C 980 -643	1.20	1.20	ppb	U



# Environmental Testing Laboratories, Inc.

208 Route 109, Farmingdale NY 11735

Phone - 631-249-1456 Fax - 631-249-8344

06/02/2003

## Volatile Compounds - EPA 8260B

**Sample: P1916-4**

Client Sample ID: RW-4

Matrix: Liquid

Remarks: See Case Narrative

Analyzed Date: 05/28/2003

Type: Grab

Collected: 05/21/2003 11:00

### Analytical Results

Cas No	Analyte	File ID	MDL	Concentration	Units	Q
96-12-8	1,2-Dibromo-3-chloropropane	C 980 -643	1.50	1.50	ppb	U
120-82-1	1,2,4-Trichlorobenzene	C 980 -643	1.30	1.30	ppb	U
87-68-3	Hexachlorobutadiene	C 980 -643	3.70	3.70	ppb	U
91-20-3	Naphthalene	C 980 -643	4.60	4.60	ppb	U
87-61-6	1,2,3-Trichlorobenzene	C 980 -643	1.20	1.20	ppb	U

### Surrogate Results

Cas No	Analyte	File ID	% Recovery	QC Limits	Q
460-00-4	4-BROMOFLUOROBENZENE	C980-643	96.1 %	( 89 - 110)	
4774-33-8	DIBROMOFLUOROMETHANE	C980-643	93.3 %	( 72 - 121)	
2037-26-5	TOLUENE-D8	C980-643	103.0 %	( 89 - 111)	



# Environmental Testing Laboratories, Inc.

208 Route 109, Farmingdale NY 11735

Phone - 631-249-1456 Fax - 631-249-8344

06/02/2003

## Volatile Compounds - EPA 8260B

### Sample: P1916-5

Client Sample ID: Trip Blank

Collected: 05/21/2003

Matrix: Liquid

Type: Grab

Remarks: See Case Narrative

Analyzed Date: 05/28/2003

### Analytical Results

Cas No	Analyte	File ID	MDL	Concentration	Units	Q
75-71-8	Dichlorodifluoromethane	C 980 -644	0.17	0.17	ppb	U
75-45-6	Chlorodifluoromethane	C 980 -644	0.15	0.15	ppb	U
74-87-3	Chloromethane	C 980 -644	0.14	0.14	ppb	U
75-01-4	Vinyl Chloride	C 980 -644	0.11	0.11	ppb	U
74-83-9	Bromomethane	C 980 -644	0.15	0.15	ppb	U
75-00-3	Chloroethane	C 980 -644	0.28	0.28	ppb	U
75-69-4	Trichlorofluoromethane	C 980 -644	0.13	0.13	ppb	U
76-13-1	1,1,2-Trichlorotrifluoroethane	C 980 -644	0.19	0.19	ppb	U
75-35-4	1,1-Dichloroethene	C 980 -644	0.16	0.16	ppb	U
67-64-1	Acetone	C 980 -644	1.58	1.58	ppb	U
75-15-0	Carbon disulfide	C 980 -644	0.13	0.13	ppb	U
75-09-2	Methylene Chloride	C 980 -644	0.16	0.16	ppb	U
156-60-5	trans-1,2-Dichloroethene	C 980 -644	0.15	0.15	ppb	U
1634-04-4	Methyl t-butyl ether	C 980 -644	0.074	0.074	ppb	U
75-34-3	1,1-Dichloroethane	C 980 -644	0.095	0.095	ppb	U
590-20-7	2,2-Dichloropropane	C 980 -644	0.33	0.33	ppb	U
156-59-2	cis-1,2-Dichloroethene	C 980 -644	0.17	0.17	ppb	U
78-93-3	2-Butanone	C 980 -644	0.46	0.46	ppb	U
74-97-5	Bromochloromethane	C 980 -644	0.14	0.14	ppb	U
67-66-3	Chloroform	C 980 -644	0.072	0.072	ppb	U
71-55-6	1,1,1-Trichloroethane	C 980 -644	0.16	0.16	ppb	U
56-23-5	Carbon Tetrachloride	C 980 -644	0.12	0.12	ppb	U
563-58-6	1,1-Dichloropropene	C 980 -644	0.16	0.16	ppb	U
71-43-2	Benzene	C 980 -644	0.11	0.11	ppb	U
107-06-2	1,2-Dichloroethane	C 980 -644	0.12	0.12	ppb	U
79-01-6	Trichloroethene	C 980 -644	0.16	0.16	ppb	U
78-87-5	1,2-Dichloropropane	C 980 -644	0.11	0.11	ppb	U
74-95-3	Dibromomethane	C 980 -644	0.17	0.17	ppb	U
75-27-4	Bromodichloromethane	C 980 -644	0.11	0.11	ppb	U
110-75-8	2-Chloroethylvinylether	C 980 -644	0.19	0.19	ppb	U
10061-01-5	cis-1,3-Dichloropropene	C 980 -644	0.090	0.090	ppb	U
108-10-1	4-Methyl-2-pentanone	C 980 -644	0.81	0.81	ppb	U
108-88-3	Toluene	C 980 -644	0.092	0.092	ppb	U



# Environmental Testing Laboratories, Inc.

208 Route 109, Farmingdale NY 11735  
Phone - 631-249-1456 Fax - 631-249-8344

06/02/2003

## Volatile Compounds - EPA 8260B

### Sample: P1916-5

Client Sample ID: Trip Blank

Collected: 05/21/2003

Matrix: Liquid

Type: Grab

Remarks: See Case Narrative

Analyzed Date: 05/28/2003

### Analytical Results

Cas No	Analyte	File ID	MDL	Concentration	Units	Q
10061-02-6	trans-1,3-Dichloropropene	C 980 -644	0.13	0.13	ppb	U
79-00-5	1,1,2-Trichloroethane	C 980 -644	0.14	0.14	ppb	U
127-18-4	Tetrachloroethene	C 980 -644	0.39	0.39	ppb	U
142-28-9	1,3-Dichloropropane	C 980 -644	0.099	0.099	ppb	U
591-78-6	2-Hexanone	C 980 -644	1.01	1.01	ppb	U
124-48-1	Dibromochloromethane	C 980 -644	0.11	0.11	ppb	U
106-93-4	1,2-Dibromoethane	C 980 -644	0.11	0.11	ppb	U
108-90-7	Chlorobenzene	C 980 -644	0.13	0.13	ppb	U
630-20-6	1,1,1,2-Tetrachloroethane	C 980 -644	0.11	0.11	ppb	U
100-41-4	Ethylbenzene	C 980 -644	0.11	0.11	ppb	U
108-38-3	m,p-xylene	C 980 -644	0.33	0.33	ppb	U
95-47-6	o-xylene	C 980 -644	0.13	0.13	ppb	U
100-42-5	Styrene	C 980 -644	0.97	0.97	ppb	U
75-25-2	Bromoform	C 980 -644	0.14	0.14	ppb	U
98-82-8	Isopropylbenzene	C 980 -644	0.097	0.097	ppb	U
108-86-1	Bromobenzene	C 980 -644	0.072	0.072	ppb	U
79-34-5	1,1,1,2-Tetrachloroethane	C 980 -644	0.088	0.088	ppb	U
103-65-1	n-Propylbenzene	C 980 -644	0.12	0.12	ppb	U
96-18-4	1,2,3-Trichloropropane	C 980 -644	0.28	0.28	ppb	U
622-96-8	p-Ethyltoluene	C 980 -644	0.12	0.12	ppb	U
108-67-8	1,3,5-Trimethylbenzene	C 980 -644	0.095	0.095	ppb	U
95-49-8	2-Chlorotoluene	C 980 -644	0.15	0.15	ppb	U
106-43-4	4-Chlorotoluene	C 980 -644	0.14	0.14	ppb	U
98-06-6	tert-Butylbenzene	C 980 -644	0.15	0.15	ppb	U
95-63-6	1,2,4-Trimethylbenzene	C 980 -644	0.11	0.11	ppb	U
135-98-8	sec-Butylbenzene	C 980 -644	0.11	0.11	ppb	U
99-87-6	p-Isopropyltoluene	C 980 -644	0.12	0.12	ppb	U
541-73-1	1,3-Dichlorobenzene	C 980 -644	0.083	0.083	ppb	U
106-46-7	1,4-Dichlorobenzene	C 980 -644	0.068	0.068	ppb	U
95-50-1	1,2-Dichlorobenzene	C 980 -644	0.11	0.11	ppb	U
105-05-5	p-Diethylbenzene	C 980 -644	0.11	0.11	ppb	U
104-51-8	n-Butylbenzene	C 980 -644	0.088	0.088	ppb	U
95-93-2	1,2,4,5-Tetramethylbenzene	C 980 -644	0.12	0.12	ppb	U



# Environmental Testing Laboratories, Inc.

208 Route 109, Farmingdale NY 11735  
Phone - 631-249-1456 Fax - 631-249-8344

06/02/2003

## Volatile Compounds - EPA 8260B

### Sample: P1916-5

Client Sample ID: Trip Blank

Collected: 05/21/2003

Matrix: Liquid

Type: Grab

Remarks: See Case Narrative

Analyzed Date: 05/28/2003

### Analytical Results

Cas No	Analyte	File ID	MDL	Concentration	Units	Q
96-12-8	1,2-Dibromo-3-chloropropane	C 980 -644	0.15	0.15	ppb	U
120-82-1	1,2,4-Trichlorobenzene	C 980 -644	0.13	0.13	ppb	U
87-68-3	Hexachlorobutadiene	C 980 -644	0.37	0.37	ppb	U
91-20-3	Naphthalene	C 980 -644	0.46	0.46	ppb	U
87-61-6	1,2,3-Trichlorobenzene	C 980 -644	0.12	0.12	ppb	U

### Surrogate Results

Cas No	Analyte	File ID	% Recovery	QC Limits	Q
460-00-4	4-BROMOFLUOROBENZENE	C980-644	95.4 %	( 89 - 110)	
4774-33-8	DIBROMOFLUOROMETHANE	C980-644	92.9 %	( 72 - 121)	
2037-26-5	TOLUENE-D8	C980-644	101.0 %	( 89 - 111)	



# Environmental Testing Laboratories, Inc.

208 Route 109, Farmingdale NY 11735

Phone - 631-249-1456 Fax - 631-249-8344

06/02/2003

## Case Narrative

8260:

The following compounds were calibrated at 25, 50, 100, 150 and 200 ppb levels in the initial calibration curve:

Acetone  
2-Butanone  
4-Methyl-2-pentanone  
2-Hexanone

M&P-Xylenes and 2-Chloroethylvinylether were calibrated at 10, 40, 100, 200 and 300 ppb levels.

All other compounds were calibrated at 5, 20, 50, 100 and 150 ppb levels.

*Patricia Werner-Els*

*Reviewed By Quality Assurance Officer*



# Environmental Testing Laboratories, Inc.

208 Route 109, Farmingdale NY 11735

Phone - 631-249-1456 Fax - 631-249-8344

06/02/2003

## ORGANIC METHOD QUALIFIERS

Q - Qualifier - specified entries and their meanings are as follows:

- U - The analytical result is a non-detect.
- J - Indicates an estimated value. The concentration reported was detected below the Method Detection Limit.
- B - The analyte was found in the associated method blank as well as the sample. It indicates possible/probable blank contamination and warns the data user to take appropriate action.
- E - The concentration of the analyte exceeded the calibration range of the instrument.
- D - This flag indicates a system monitoring compound diluted out.

## INORGANIC METHOD QUALIFIERS

C - (Concentration) qualifiers are as follows:

- B - Entered if the reported value was obtained from a reading that was less than the Contract Required Detection Limit (CRDL) but greater than or equal to the Instrument Detection Limit (IDL).
- U - Entered when the analyte was analyzed for, but not detected.

Q - Qualifier specific entries and their meanings are as follows:

- E - Reported value is estimated because of the presence of interferences.

M - (Method) qualifiers are as follows:

- A - Flame AA
- AS - Semi-automated Spectrophotometric
- AV - Automated Cold Vapor AA
- C - Manual Spectrophotometric
- F - Furnace AA
- P - ICP
- T - Titrimetric

## OTHER QUALIFIERS

- ND - Not Detected
- NA - Not Applicable
- NR - Not Required
- \* - Outside Expected Range (NYCDEP Table I/II or Surrogate Limits)
- x - Outside Expected Range

## OTHER

- All soil and sediment samples are reported on a dry weight basis.



03-03849

P1916

Rec'd Date: 05/22/03 15:09

CHAIN OF CUSTODY DOCUMENT



results to Andy Barber 578-218-1805

P 01916

Project Name: PhotoCircuits Project Manager: Andy Barzee

Project Address: 31 Sea Cliff Avenue Glen Cove NY  
Attn: Charlie Nehrjs

Client PhotoCircuits JIN: 643,001  Rush by 1/1

SAMPLE INFO Type: SS = Split Spoon; G = Grab; C = Composite; B = Blank  
Matrix: L = Liquid; S = Soil; SL = Sludge; A = Air; W = Waste  
\*Air - Vol. (Liters) Include: Flow (CFM)

ID	Date	Time	Type	Matrix	Sample Location	Total # Cont.	601/602	BTX/BTEX	MTBE	624/626/621 B	625/627/620 BN	PCB/Pesticides	Pet Prods./B100M	RCRA Metals	pH/Flash/React	418.1 - TRPH
1	5/21/03	1055	L		RW-1	2	X									
2		1050			RW-2	2	X									
3		1055			RW-3	2	X									
4		1100			RW-4	2	X									
5					TRIP BLANK	2	X									
6	5/21/03	1150		A	4S A SITE INFLUENT	1	X									
8																
9																
10																
11																
12																
13																
14																
15																

Relinquished by (Signature): David R. Barzee Date: 5/21/03

Printed Name & Agent: David Henry Barzee & Associates

QA/QC Type: Number & Type of Containers: 10 - Vials 1 - Teller Bag

Comments & Special Instructions

Sampler (Signature): David R. Barzee (Print): David Henry

Received by (Signature): Ken Berg Date: 5/22/03

Printed Name & Agent: Ken Berg

Date: 5-22-03 Time: 10:00

Preservatives: Hal - Vials Temp: 5°C