

LEGEND:

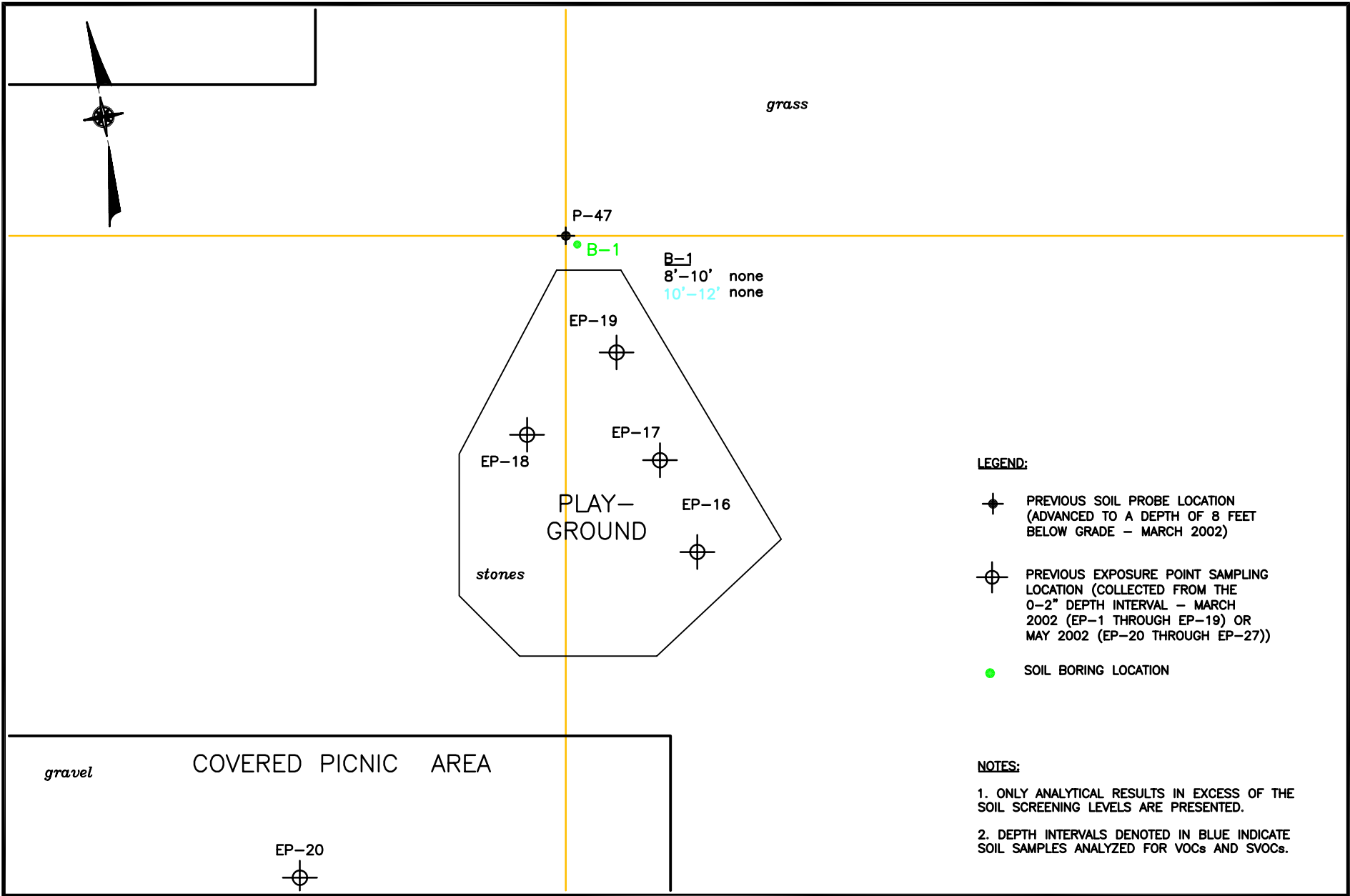

- PROPERTY LINE
- - - FENCE
- ⊕ PREVIOUS SOIL PROBE LOCATION (ADVANCED TO A DEPTH OF 8 FEET BELOW GRADE - MARCH 2002)
- ⊕ PREVIOUS EXPOSURE POINT SAMPLING LOCATION (COLLECTED FROM THE 0-2" DEPTH INTERVAL - MARCH 2002 (EP-1 THROUGH EP-19) OR MAY 2002 (EP-20 THROUGH EP-27))
- SOIL BORING LOCATION
- ⊕ MONITORING WELL LOCATION

- NOTES:**
- ALL VOC AND SVOC ANALYTICAL RESULTS REPORTED IN UNITS OF UG/KG (PPB). ALL METAL AND PCB ANALYTICAL RESULTS REPORTED IN UNITS OF MG/KG (PPM).
 - ONLY ANALYTICAL RESULTS IN EXCESS OF THE SOIL SCREENING LEVELS ARE PRESENTED.
 - COLORS:
 - PCB EXCEEDANCE
 - CHROMIUM EXCEEDANCE
 - ROHM METAL EXCEEDANCE (OTHER THAN CHROMIUM)
 - VOC OR SVOC EXCEEDANCE
 - DEPTH INTERVALS DENOTED IN BLUE INDICATE SOIL SAMPLES ANALYZED FOR VOCs AND SVOCs.

- ABBREVIATIONS:**
- Ac - Acetone
 - As - Arsenic
 - Ba - Barium
 - Cd - Cadmium
 - Cr - Chromium
 - Cu - Copper
 - Fe - Lead
 - Mg - Magnesium
 - Mn - Mercury
 - Ni - Nickel
 - Pb - Selenium
 - Zn - Zinc
 - Ac - Acetone
 - 1,1-D - 1,1-Dichloroethane
 - To - Toluene
 - Xy - Xylene
 - Ba - Benzo(a)anthracene
 - Be - Benzo(a)pyrene
 - Fl - Benzo(b)fluoranthene
 - Fl - Benzo(k)fluoranthene
 - Ch - Chrysene
 - Di - Dibenzo(a,h)anthracene
 - Me - Mercury
 - 4-M - 4-Methylphenol
 - P - Phenol



LEGEND:

-  PREVIOUS SOIL PROBE LOCATION (ADVANCED TO A DEPTH OF 8 FEET BELOW GRADE - MARCH 2002)
-  PREVIOUS EXPOSURE POINT SAMPLING LOCATION (COLLECTED FROM THE 0-2" DEPTH INTERVAL - MARCH 2002 (EP-1 THROUGH EP-19) OR MAY 2002 (EP-20 THROUGH EP-27))
-  SOIL BORING LOCATION

NOTES:

1. ONLY ANALYTICAL RESULTS IN EXCESS OF THE SOIL SCREENING LEVELS ARE PRESENTED.
2. DEPTH INTERVALS DENOTED IN BLUE INDICATE SOIL SAMPLES ANALYZED FOR VOCs AND SVOCs.

TOWN OF OYSTER BAY
 BETHPAGE COMMUNITY PARK
 BETHPAGE, NEW YORK

SCALE: 1" = 15'

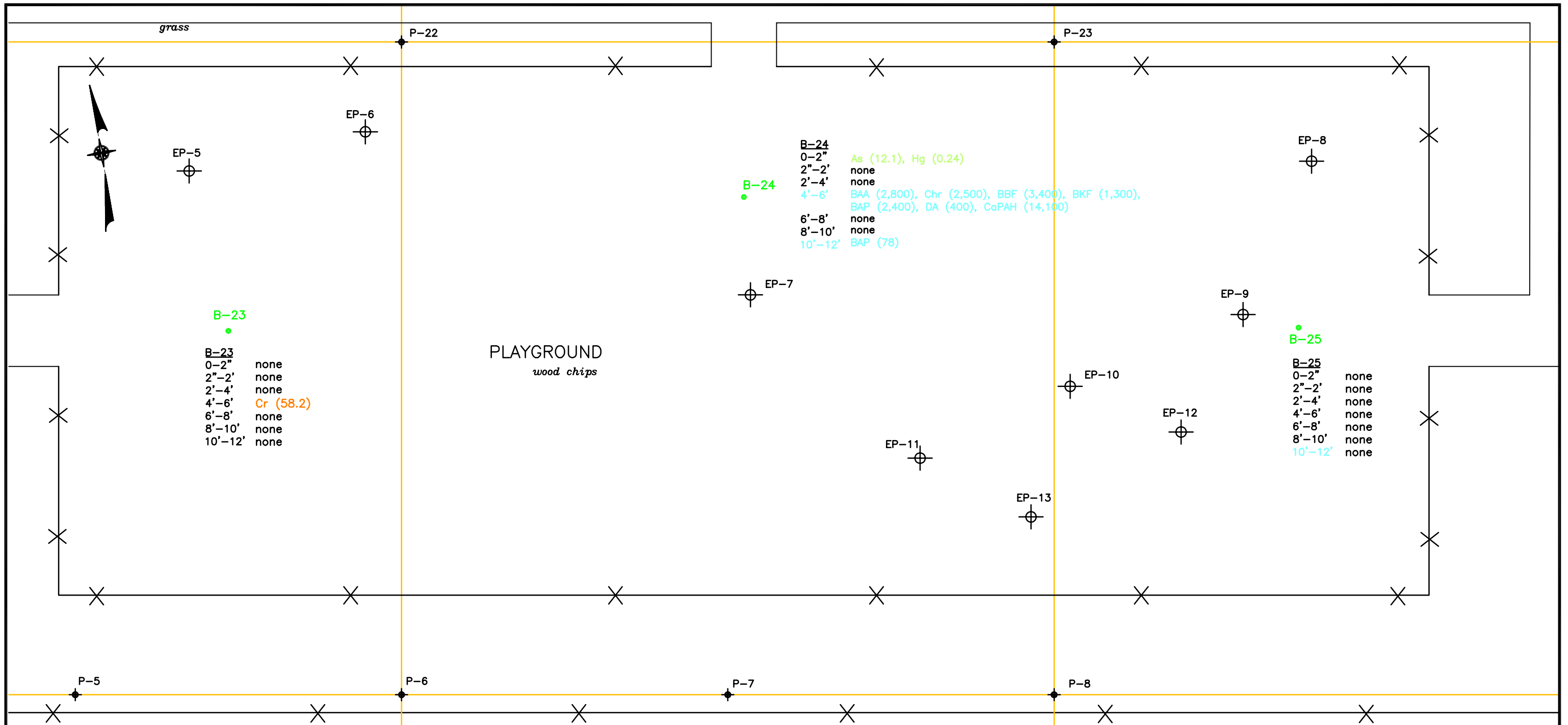

B-23
 0-2" none
 2"-2' none
 2'-4' none
 4'-6' Cr (58.2)
 6'-8' none
 8'-10' none
 10'-12' none

B-24
 0-2" As (12.1), Hg (0.24)
 2"-2' none
 2'-4' none
 4'-6' BAA (2,800), Chr (2,500), BBF (3,400), BKF (1,300), BAP (2,400), DA (400), CoPAH (14,100)
 6'-8' none
 8'-10' none
 10'-12' BAP (78)

B-25
 0-2" none
 2"-2' none
 2'-4' none
 4'-6' none
 6'-8' none
 8'-10' none
 10'-12' none

LEGEND:

- PROPERTY LINE
- X-X- FENCE
- ⊕ PREVIOUS SOIL PROBE LOCATION (ADVANCED TO A DEPTH OF 8 FEET BELOW GRADE - MARCH 2002)
- ⊕ PREVIOUS EXPOSURE POINT SAMPLING LOCATION (COLLECTED FROM THE 0-2" DEPTH INTERVAL - MARCH 2002 (EP-1 THROUGH EP-19) OR MAY 2002 (EP-20 THROUGH EP-27))
- SOIL BORING LOCATION

NOTES:

1. ALL VOC AND SVOC ANALYTICAL RESULTS REPORTED IN UNITS OF UG/KG (PPB). ALL METAL AND PCB ANALYTICAL RESULTS REPORTED IN UNITS OF MG/KG (PPM).
2. ONLY ANALYTICAL RESULTS IN EXCESS OF THE SOIL SCREENING LEVELS ARE PRESENTED.
3. COLORS:
 ORANGE - CHROMIUM EXCEEDANCE
 GREEN - RCRA METAL EXCEEDANCE (OTHER THAN CHROMIUM)
 BLUE - VOC OR SVOC EXCEEDANCE
4. DEPTH INTERVALS DENOTED IN BLUE INDICATE SOIL SAMPLES ANALYZED FOR VOCs AND SVOCs.

ABBREVIATIONS:
 As - Arsenic
 Cr - Chromium
 Hg - Mercury
 BAA - Benzo(a)anthracene
 BAP - Benzo(a)pyrene
 BBF - Benzo(b)fluoranthene
 BKF - Benzo(k)fluoranthene
 Chr - Chrysene
 DA - Dibenzo(a,h)anthracene

TOWN OF OYSTER BAY
 BETHPAGE COMMUNITY PARK
 BETHPAGE, NEW YORK

**SOUTH PLAYGROUND AREA
 SUMMARY OF EXCEEDANCES**

SCALE: 1" = 15'



FIGURE 4-3

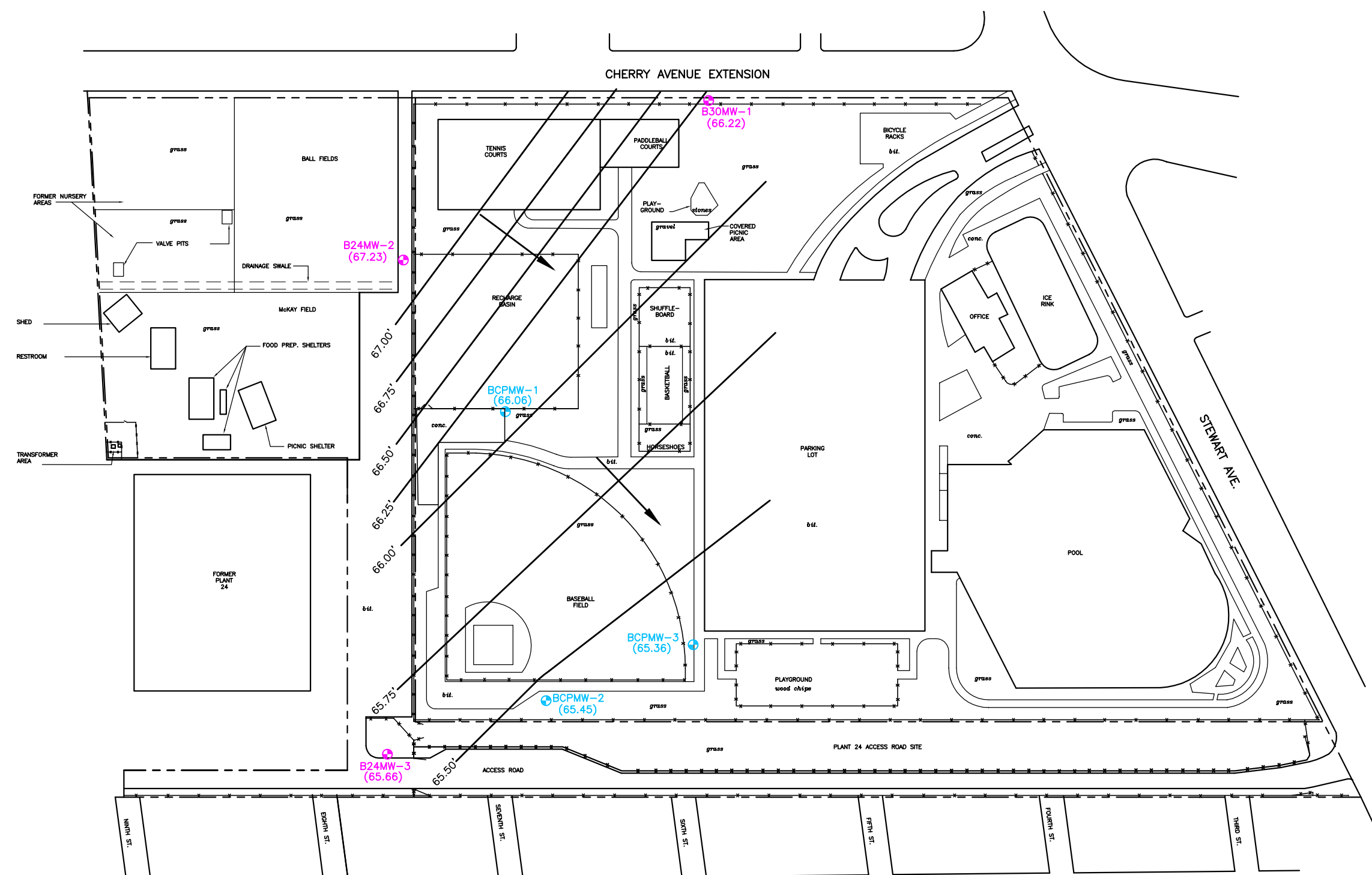

NOTES:

1. PARK FEATURES AND STRUCTURES DIGITIZED FROM A MARCH 14, 1974 AERIAL PHOTOGRAPH.
2. THE APPROXIMATE LOCATIONS AND DIMENSIONS OF THE PARK FEATURES AND STRUCTURES HAVE BEEN FIELD VERIFIED.

LEGEND:

- PROPERTY LINE
- x-x- FENCE
- x-x- TEMPORARY FENCE
- ⊕ MONITORING WELL LOCATION
- ⊙ OFF-SITE MONITORING WELL LOCATION
- 66.50' LINE OF EQUAL GROUNDWATER ELEVATION
- APPROXIMATE DIRECTION OF GROUNDWATER FLOW
- (65.45) GROUNDWATER ELEVATION IN FEET ABOVE MEAN SEA LEVEL (msl)

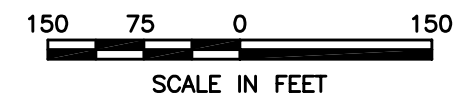

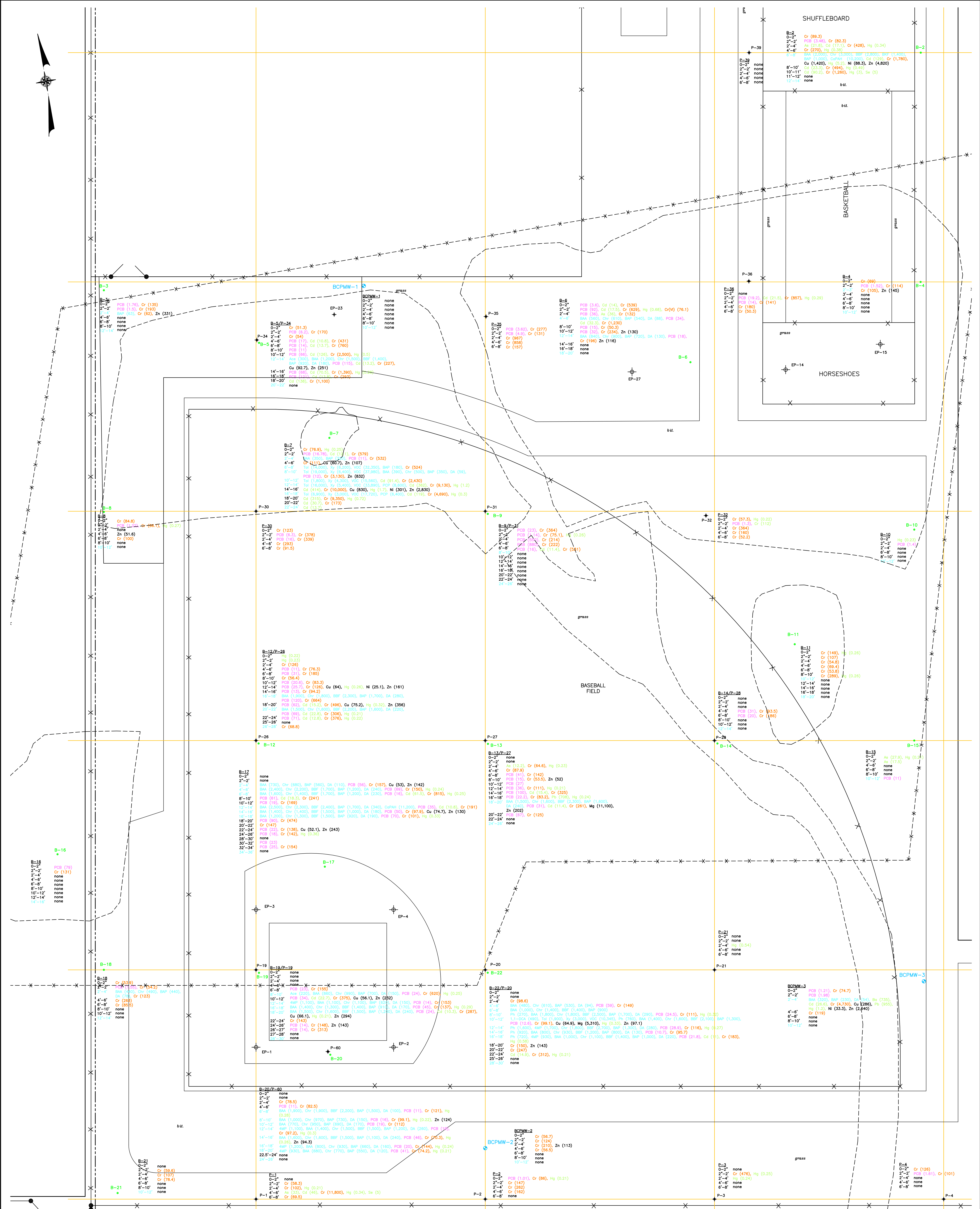

NOTES:

- ALL VOC AND SVOC ANALYTICAL RESULTS REPORTED IN UNITS OF UG/KG (PPB). ALL METAL AND PCB ANALYTICAL RESULTS REPORTED IN UNITS OF MG/KG (PPM).
- ONLY ANALYTICAL RESULTS IN EXCESS OF THE SOIL SCREENING LEVELS ARE PRESENTED.
- COLORS:
 - ORANGE - PCB EXCEEDANCE
 - GREEN - CHROMIUM EXCEEDANCE
 - RED - COPPER EXCEEDANCE (OTHER THAN CHROMIUM)
 - BLUE - VOC OR SVOC EXCEEDANCE
- DEPTH INTERVALS DENOTED IN BLUE INDICATE SOIL SAMPLES ANALYZED FOR VOCs AND SVOCs.

LEGEND:

- PROPERTY LINE
- FENCE
- FEATURES FROM APRIL 10, 1962 AERIAL PHOTOGRAPH
- FORMER FENCELINE FROM APRIL 10, 1962 AERIAL PHOTOGRAPH
- PREVIOUS SOIL PROBE LOCATION (ADVANCED TO A DEPTH OF 8 FEET BELOW GRADE - MARCH 2002)
- PREVIOUS EXPOSURE POINT SAMPLING LOCATION (COLLECTED FROM THE 0-2" DEPTH INTERVAL - MARCH 2002 (EP-1 THROUGH EP-19) OR MAY 2002 (EP-20 THROUGH EP-27))
- SOIL BORING LOCATION
- MONITORING WELL LOCATION

ABBREVIATIONS:

- Ac - Acetone
- As - Arsenic
- Ba - Barium
- Cd - Cadmium
- Cr - Chromium
- Cu - Copper
- Fe - Lead
- Mg - Magnesium
- Mn - Manganese
- Ni - Nickel
- Pb - Lead
- Se - Selenium
- Zn - Zinc
- 1,1 - 1,1-Dichloroethane
- Toluene
- Xylene
- Benzo(a)anthracene
- Benzo(a)pyrene
- Benzo(b)fluoranthene
- Benzo(k)fluoranthene
- Chrysene
- Dibenz(a,h)anthracene
- Fluorene
- 4-Methylphenol
- Pentachlorophenol
- Phenol

TOWN OF OYSTER BAY
 BETHPAGE COMMUNITY PARK
 BETHPAGE, NEW YORK
BASEBALL FIELD
COMPREHENSIVE SUMMARY OF EXCEEDANCES

SCALE: 1" = 15'