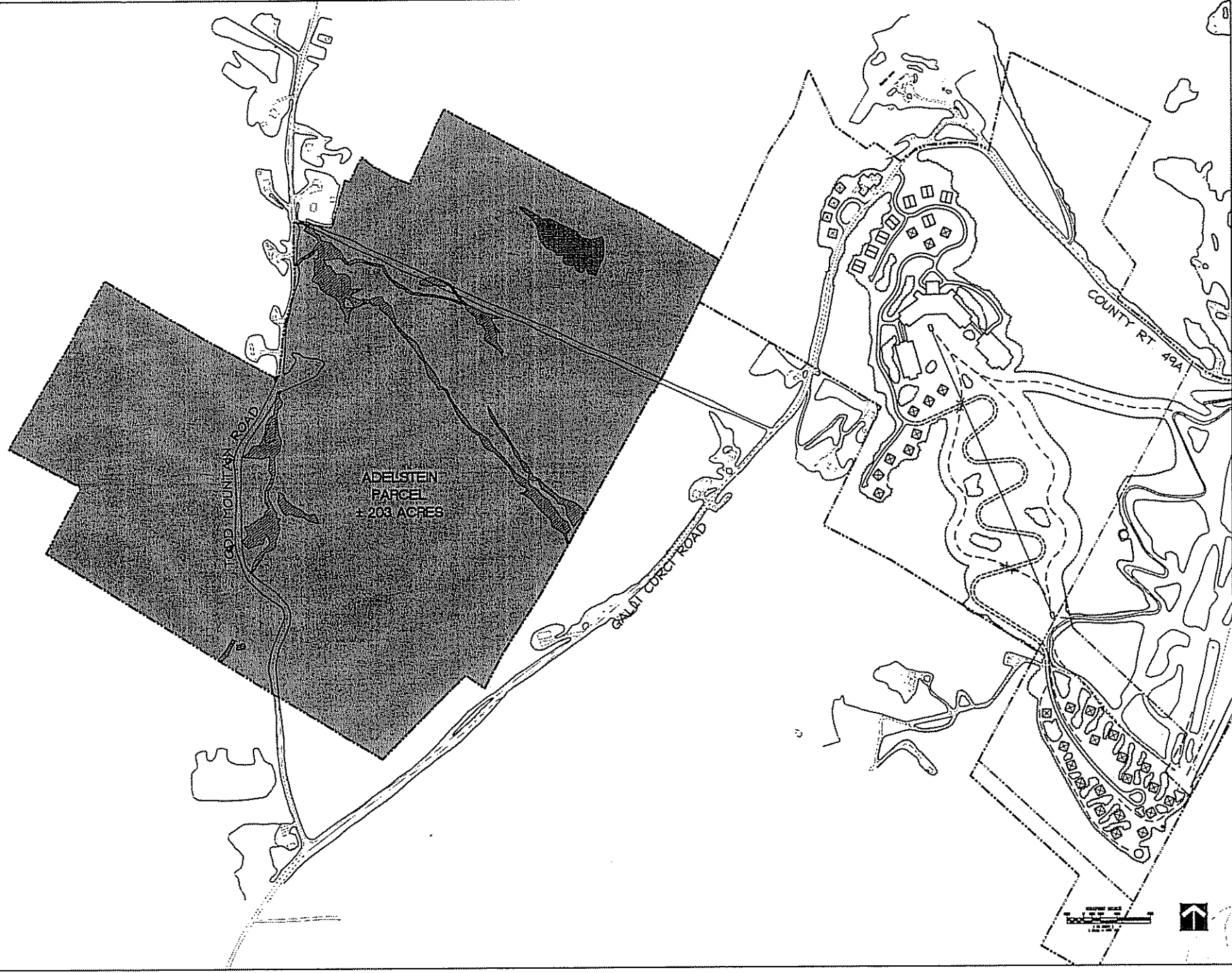

EXHIBIT K



ADELSTEIN
PARCEL
4.203 ACRES

TODD MOUNTAIN ROAD

GALAT CORSET ROAD

COUNTY RT. 49A

CSLA group
10/10/10
10/10/10
10/10/10
10/10/10



DATE	10/10/10
BY	10/10/10
CHECKED	10/10/10
SCALE	10/10/10
PROJECT	10/10/10
CLIENT	10/10/10
DESCRIPTION	10/10/10
REVISIONS	10/10/10
1	10/10/10
2	10/10/10
3	10/10/10
4	10/10/10
5	10/10/10
6	10/10/10
7	10/10/10
8	10/10/10
9	10/10/10
10	10/10/10
11	10/10/10
12	10/10/10
13	10/10/10
14	10/10/10
15	10/10/10
16	10/10/10
17	10/10/10
18	10/10/10
19	10/10/10
20	10/10/10

PREPARED FOR:
COLUMBIAN VENTURES LLC
PO BOX 807
MT VERNON, VT 05497

**ADELSTEIN CONSERVATION
EASEMENT**
AN AGREEMENT IN PRINCIPLE

10/10/10
10/10/10
10/10/10
10/10/10

K